

Maria Picnic Table Assembly

www.badideasupply.com
fixit@badideasupply.com



Parts List

Your Maria Picnic Table DIY Kit is constructed from 11 gauge steel and requires three boxes for safe shipping because of the size and weight of the pieces. Below you will find a description of the parts contained in each box followed by a recommended list of boards required to build a 6' long table.

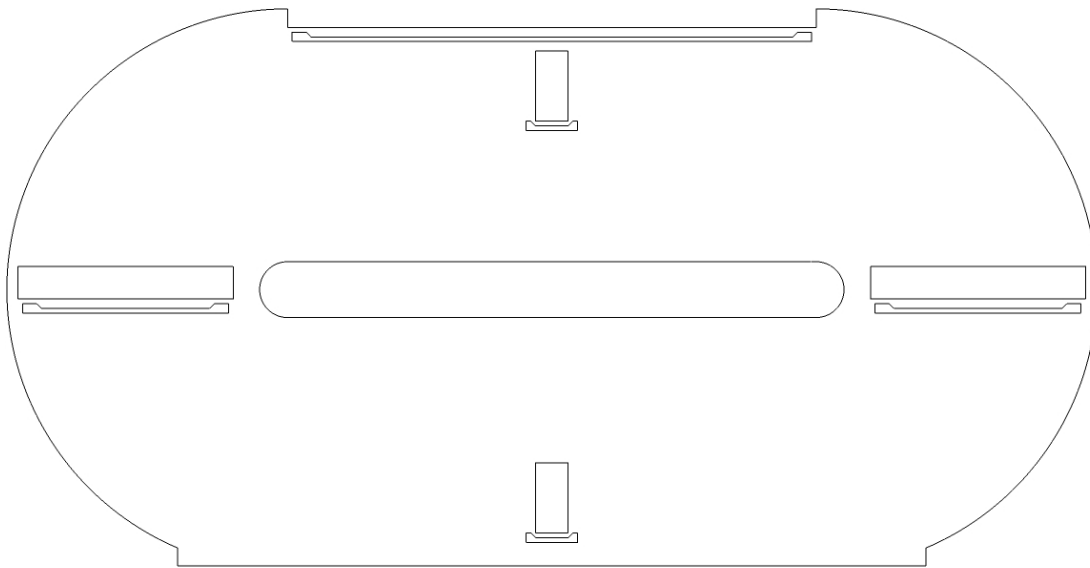

4x Face Plates



2x Top Table Board Brackets



4x Seat Board Brackets

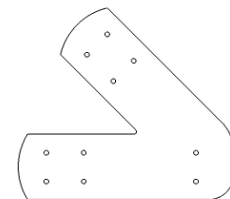

8x Brace Angle Board Brackets



4x Brace Board Brackets



Quantity 2 - 2x4 Boards For Angle Brace cut to 18-1/4"



Quantity 2 - 2x4 Boards For Top/Bottom Brace cut to 72"



Quantity 9 - 2x6 Boards For Table Top and Seats cut to 72"

Table Kit Description

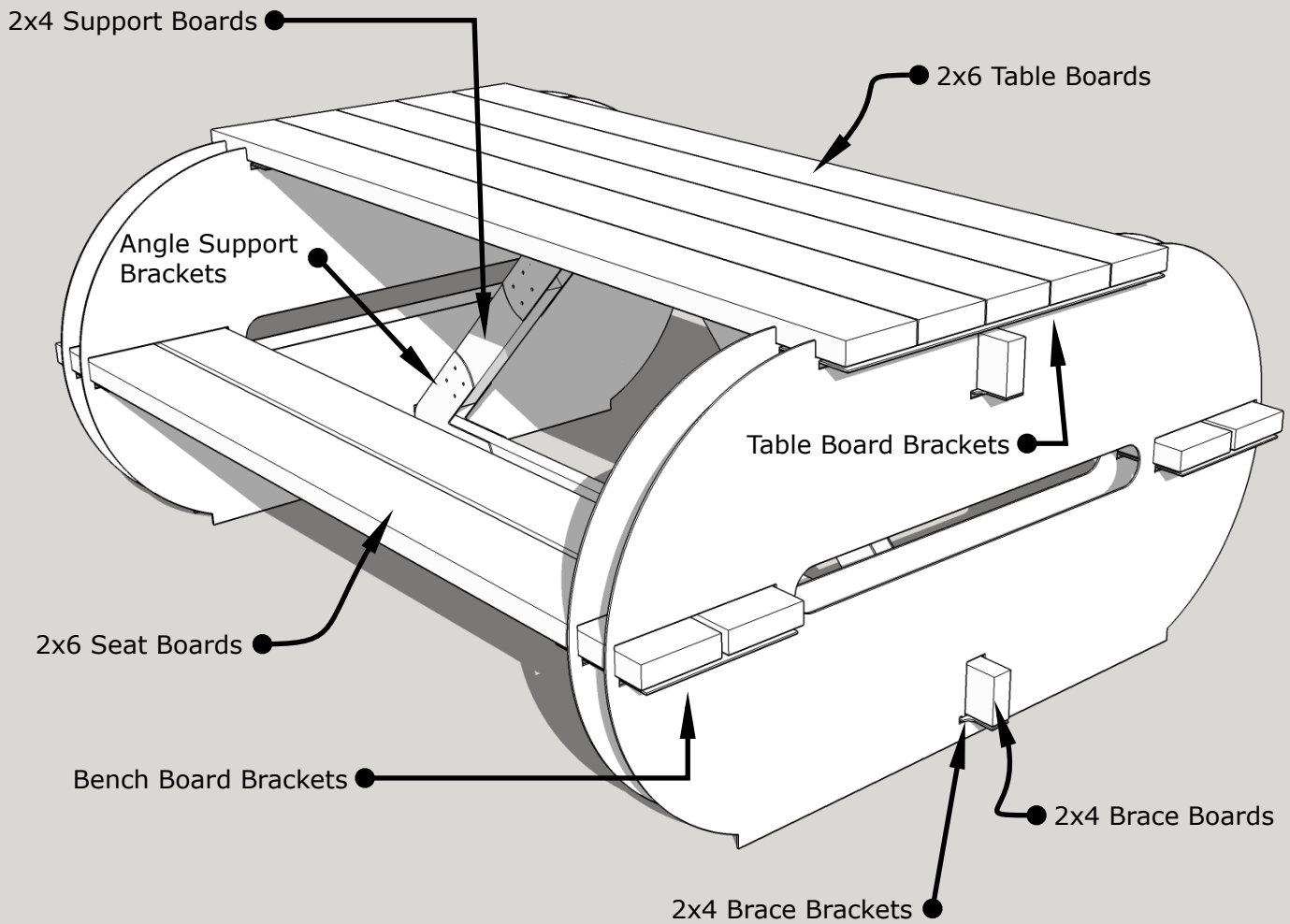

Bracket Installation

Below is an overview on how the board brackets install in the face plates using the tab and slot design. The table is shown upside down during assembly.

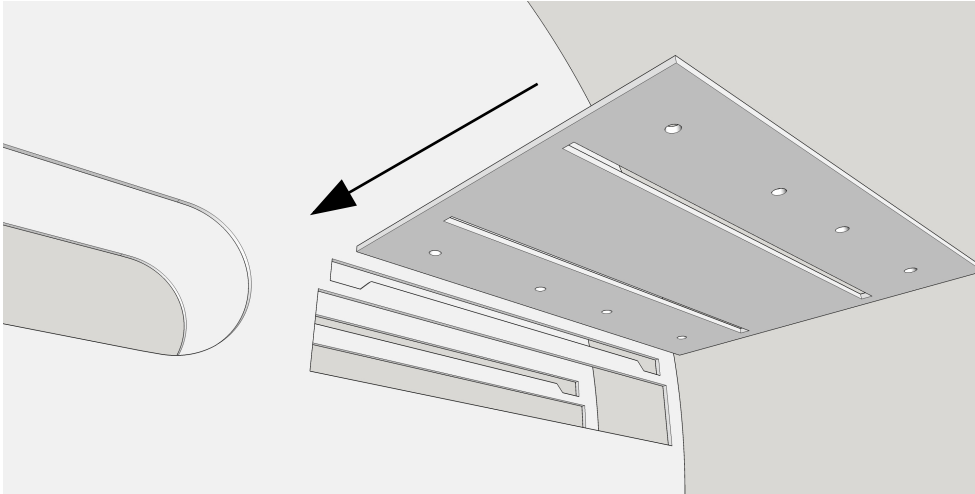

Slide the brackets into the slot

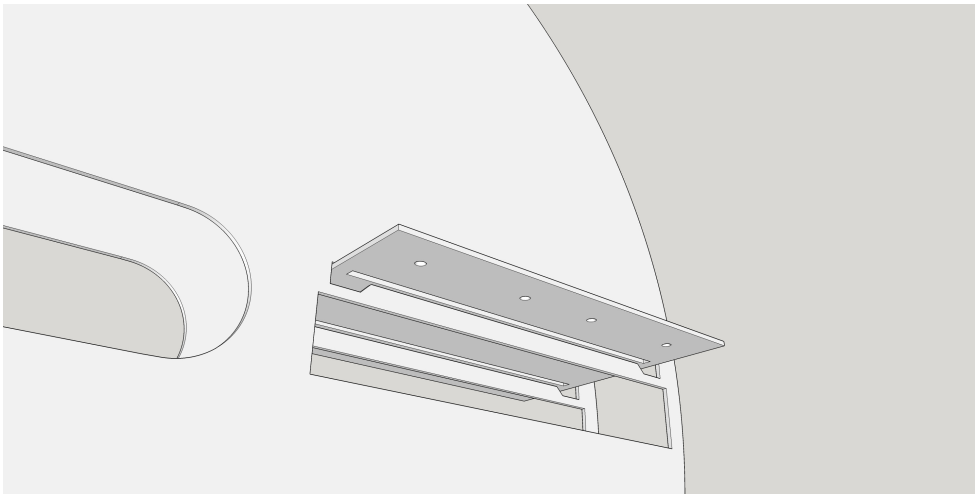

Center the slot in the bracket above the tabs in the face plate

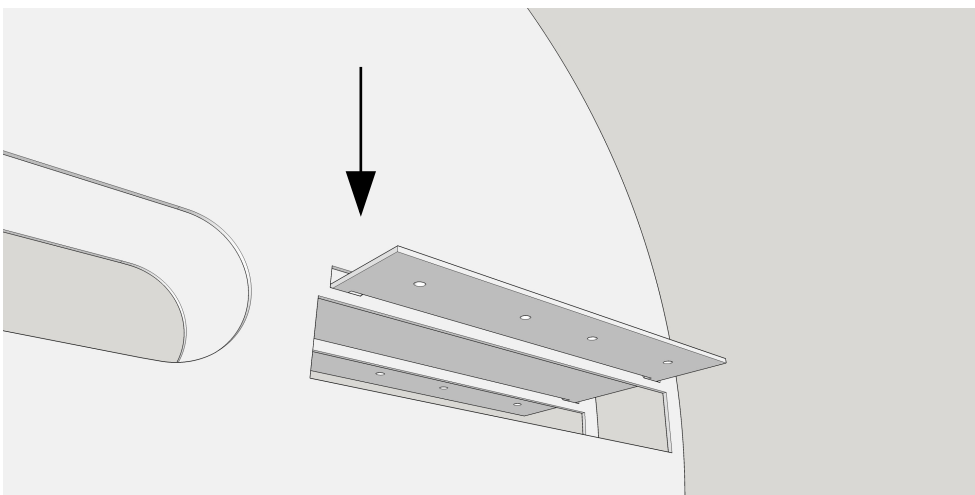

Slide the bracket down over the top of the tab to secure it in place.

Bracket Installation

Below is an overview of how the boards are secured to the table using the brackets. The table is shown upside down during assembly. Your choice of wood screw may vary based on the material you are using but for standard 2x6 or 2x4 boards we suggest using coated 1-1/2" screws.

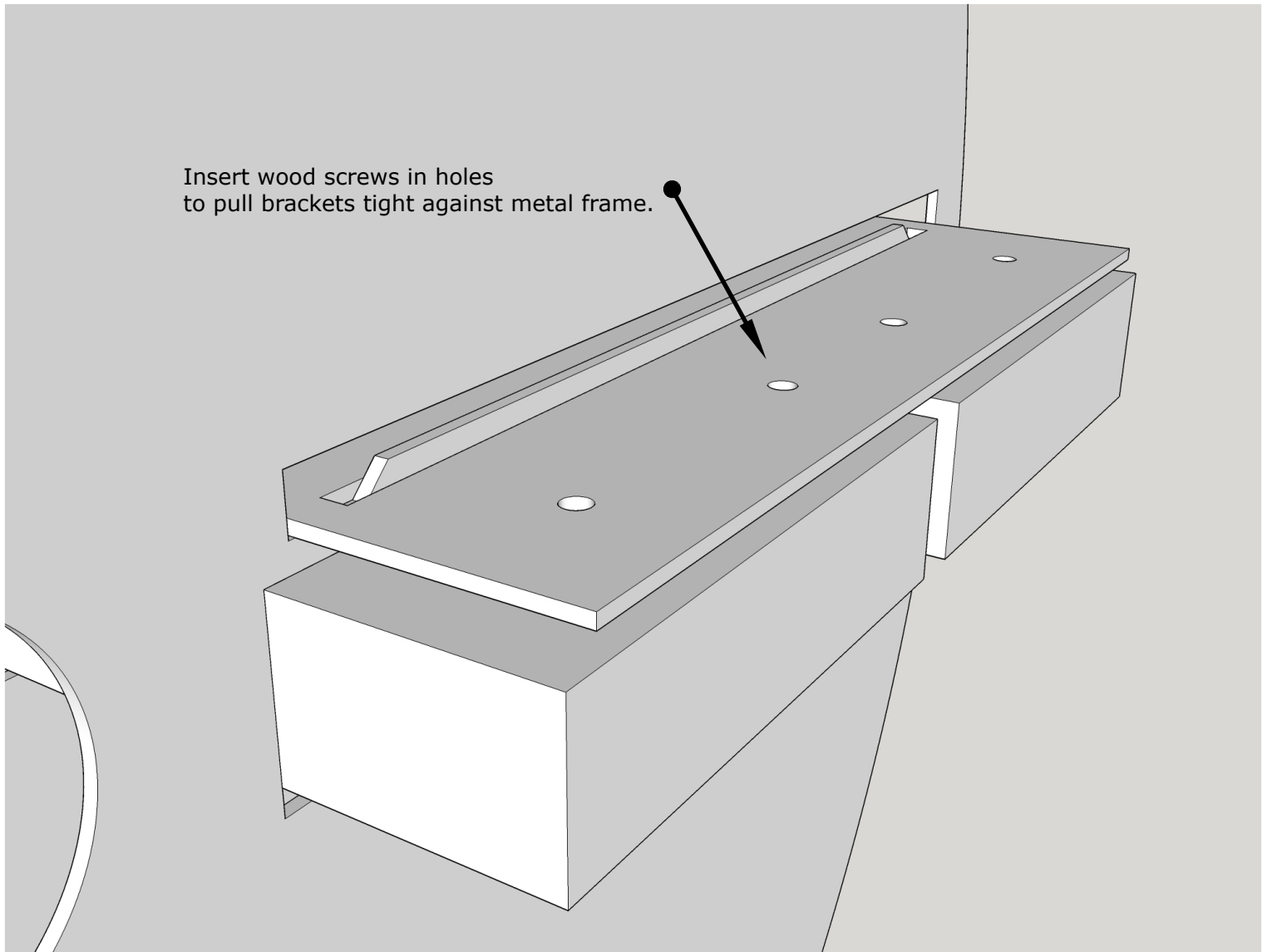

Angle Bracket Installation

Angle brackets are used to attach the top and bottom brace boards to stiffen the table and prevent side to side movement. There are matching brackets to attach on both sides of the boards using wood screws. The position of the brackets may vary depending on your tables length. The design of the brackets allow you to use boards with simple straight cuts without the need for more complicated miter cuts.

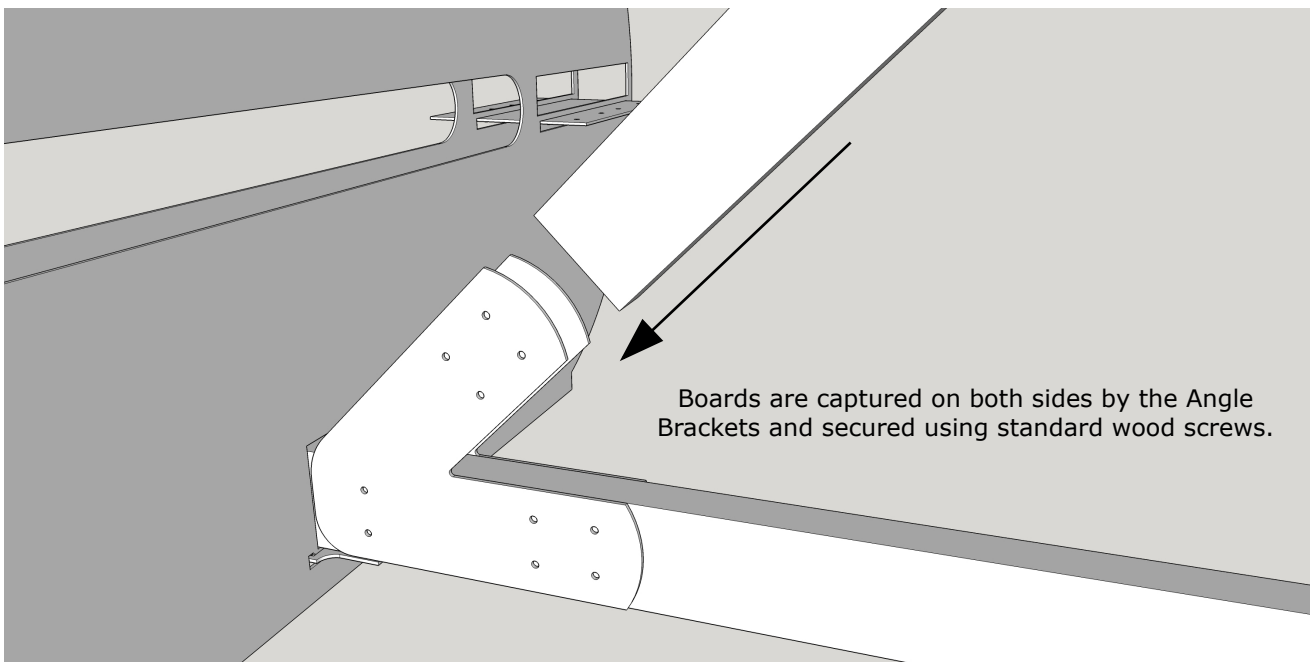
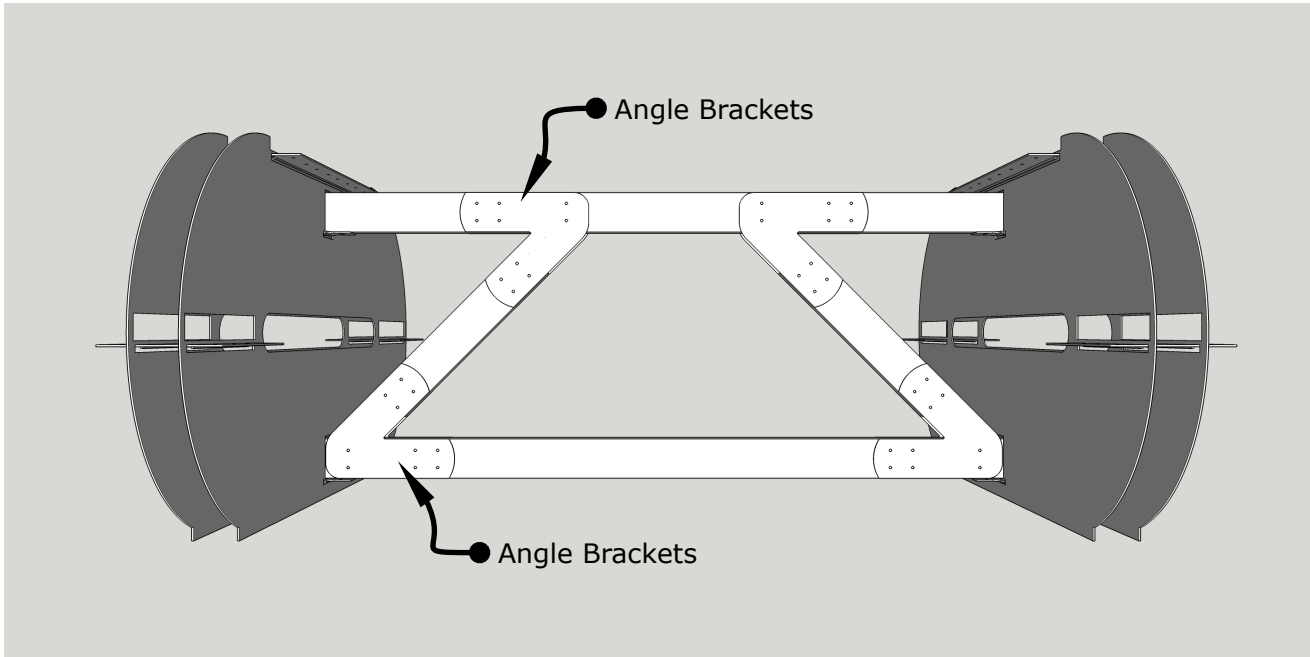
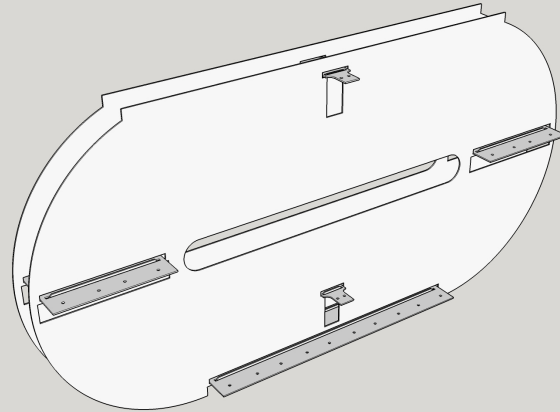

Table Assembly

1



Orient two end panels upside down and position them side by side. Slide the board brackets into position as shown on page 3. Have a second person support the assembly before moving to the next step.

2

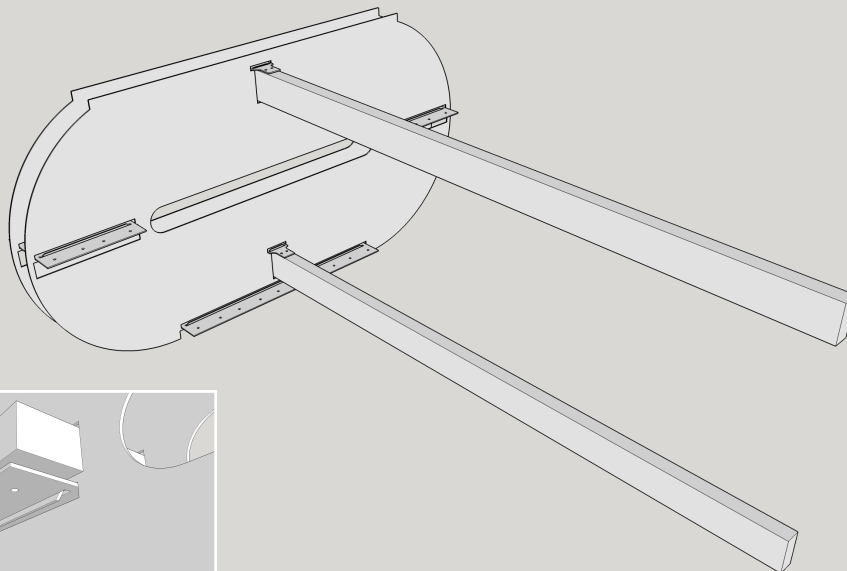

Insert the two support boards into position in the top and bottom openings. Flush the boards even with the end of the metal brackets as shown in the inset photo and secure with screws. Be sure to keep everything square during assembly.

Table Assembly

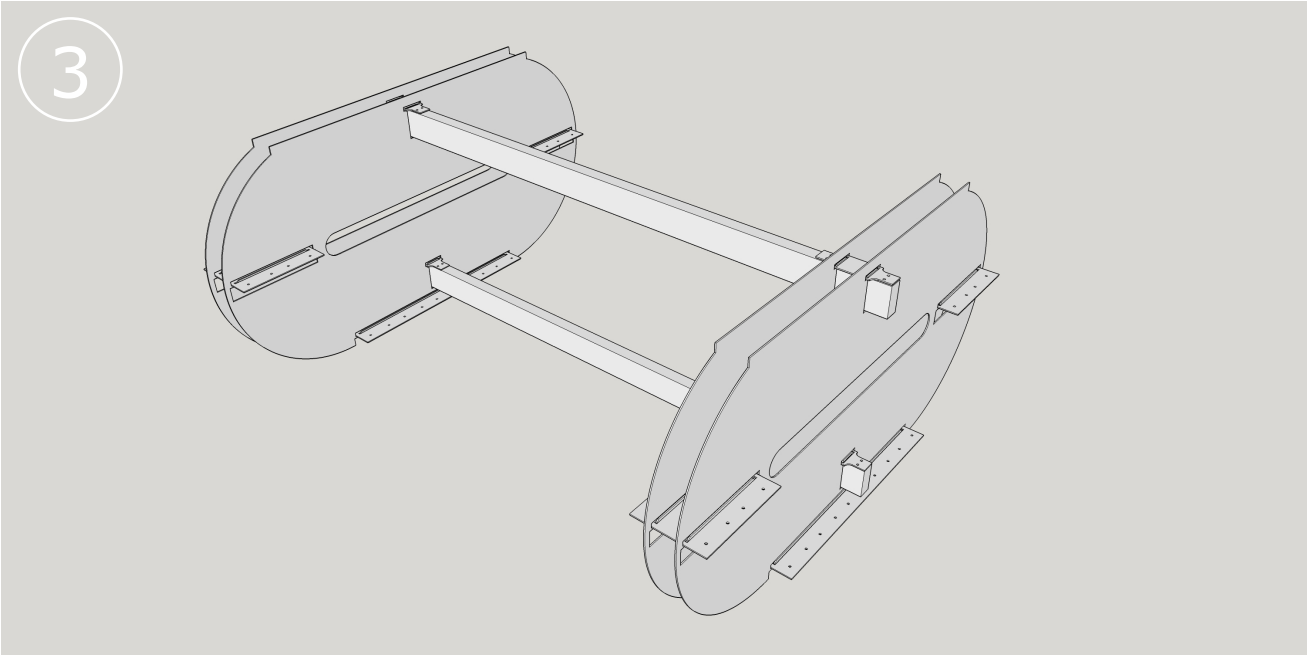

Repeat the panel assembly steps on the other side, taking care to keep the assembly square.

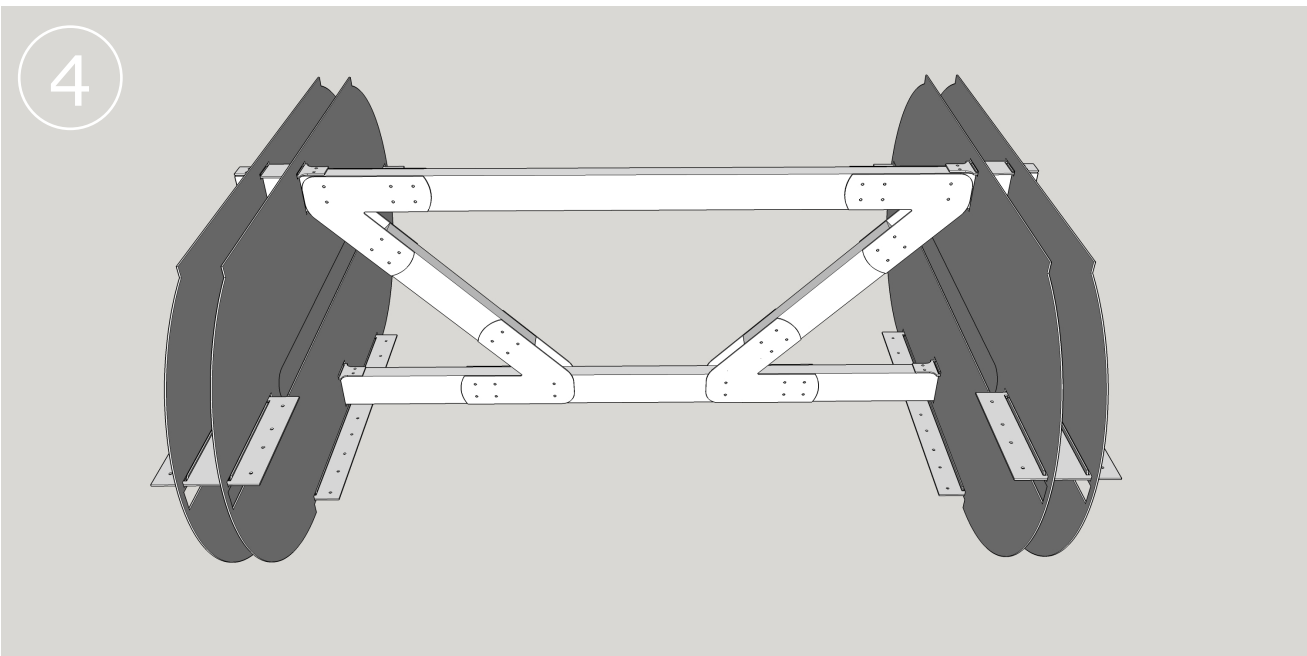

Attach the angle brackets to the top and bottom support boards as shown on page 5 (still) taking care to keep the assembly square.

Table Assembly

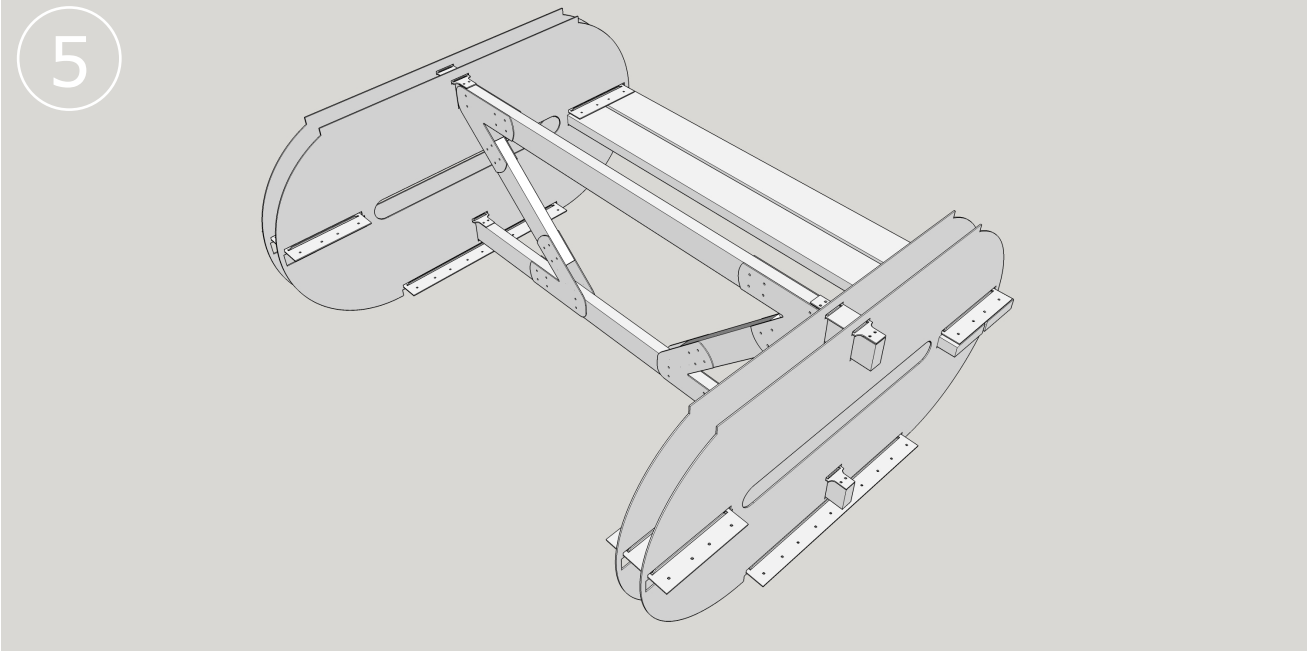

Attach the seat boards on one side using wood screws.

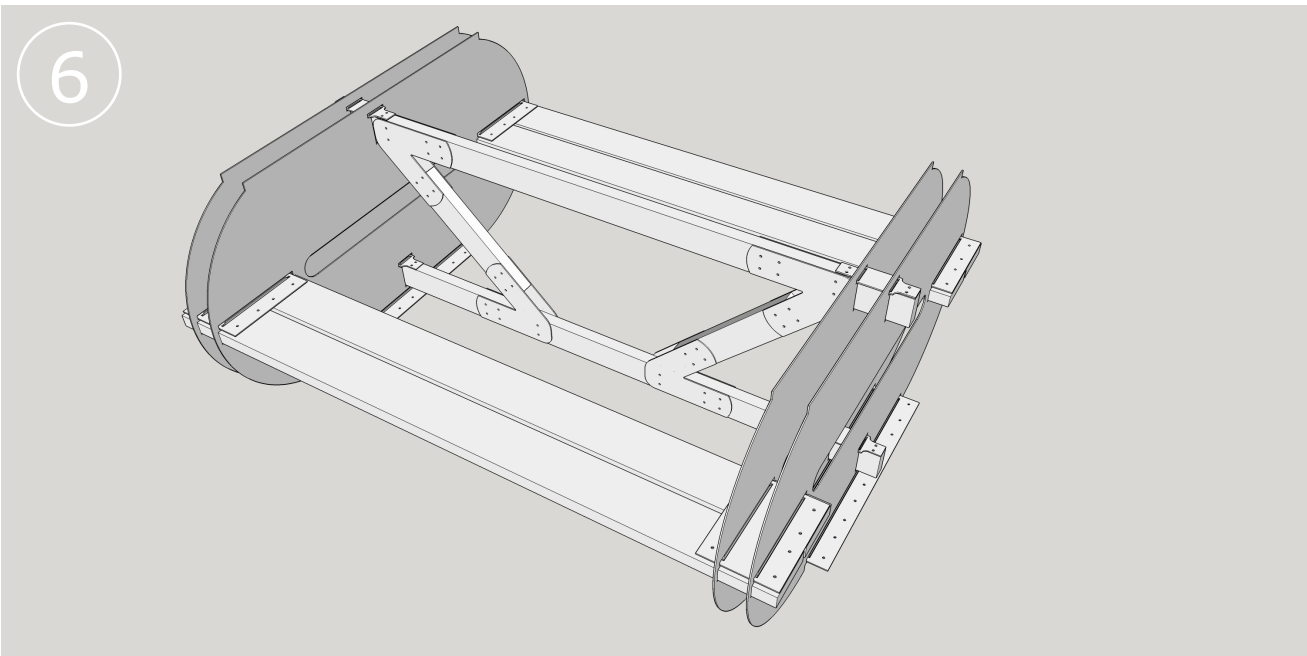

Repeat on the other side.

Table Assembly

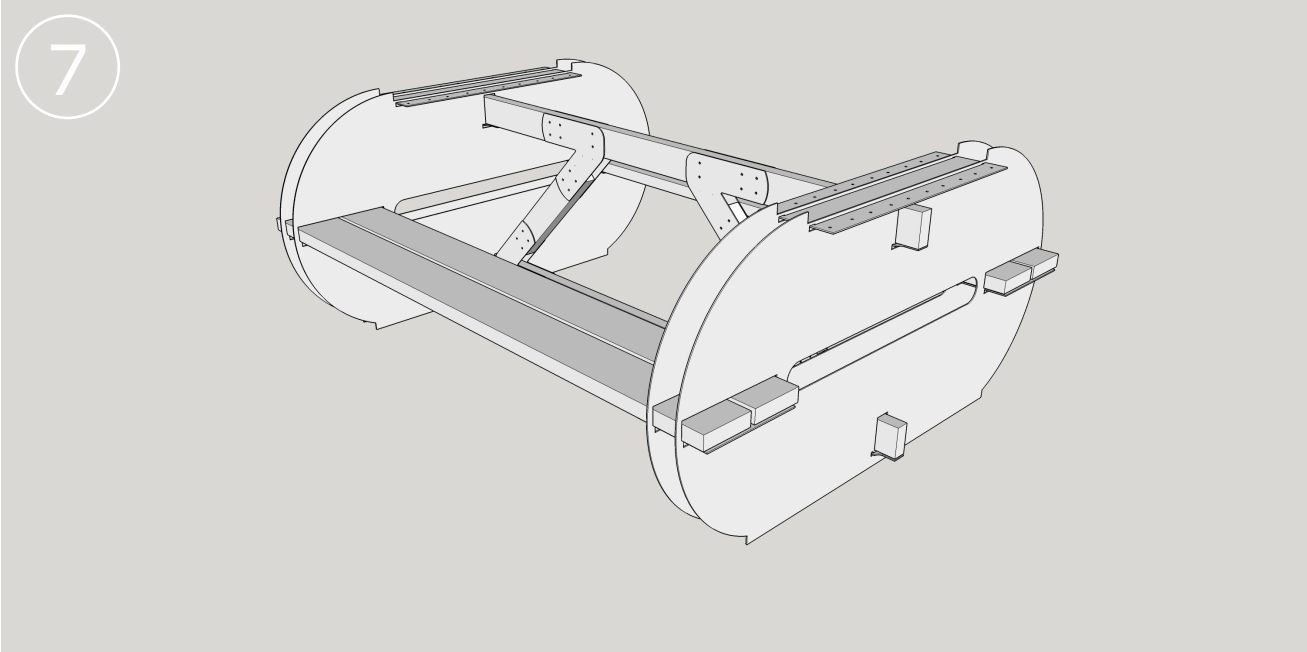

With the help of a second person roll the table over so that it is right side up.

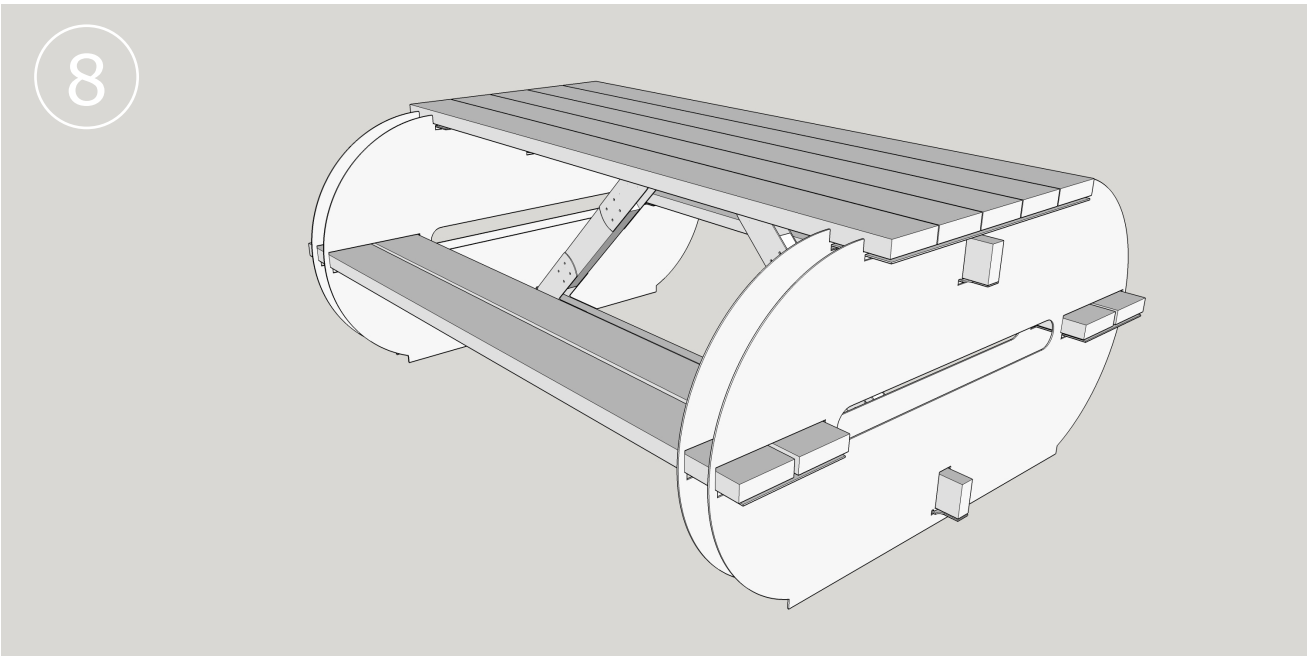

Complete assembly by laying out the top table boards into position. Be sure to space all of the boards appropriately before beginning to secure the boards using wood screws.

Caring For Your Maria Table

Every part of your DIY Table Kit was hand-rubbed with an FDA Approved polymerized linseed oil to provide a safe and natural finish to protect the steel from moisture designed to delay the natural rusting process.

If you wish to preserve the look of your product's original appearance then it will be necessary to periodically inspect and reapply the oil as it will degrade over time due to UV exposure from the sun. Simply clean your product with a dry cloth or warm water if necessary. Allow to dry completely. Use a staining pad or cloth rag to apply a very thin layer of linseed oil to all surfaces. Thoroughly buff when done to remove excess oil to prevent a gummy finish.

You may also choose to allow the metal to age beautifully through the natural Patina process. Patina is a weathering process which occurs when metal is exposed to oxygen and moisture that will gradually change bare steel from a bluish gray color to a dark reddish brown. This natural process varies the appearance of each piece making every metal piece unique.