



PSV exchange is the new collective name for PSV Repair and Service Exchange parts that share common criteria. To be included the product must be fully tested to PSV specifications which where possible are based on manufacturer recommendations. All PSV Exchange parts are competitively priced and protected with warranty. PSV Exchange products represent a cost efficient, reliable alternative to buying new.

We will be expanding our PSV Exchange range to include products from Rotating Electrics, Electronics, Wheelchair Access, Door Systems, Pneumatics and Denoxtronics (AdBlue).



**QUALITY**

To be included the product must be tested to PSV specifications which where possible are based on manufacturer recommendations.



**MANUFACTURER SUPPORT**

Where possible we work with the OE manufacturer to gain approvals and/or become official agent.



**OE COMPONENTS**

Where possible and when best for the job OE components are used.



**UPGRADES TO OE**

If we are aware of a common fault or failure we will seek to improve the product.



**STOCK AVAILABILITY**

Typically these products will be available from stock on a service exchange basis.



**WARRANTY**

All PSV Exchange products are supplied with a minimum 12 months warranty on the whole product.



**GREEN APPROACH**

PSV Exchange products offer a sustainable alternative to buying new.



**COST EFFICIENT**

PSV exchange products represent a cost efficient alternative to buying new.



Fogmaker is the only system to have passed Regulation 107 without re-ignition. The ability of the Fogmaker system to prevent re-ignition of engine fires is a key performance characteristic. While other fire suppression systems may extinguish some initial fires, allowing most operators to escape their equipment, 60% of such fires re-ignite, resulting in equipment loss and further endangering operators and other equipment.



Vehicle Class	FSS according to R107 becomes compulsory	Vehicle Types	Final Date
Class III	11 <sup>th</sup> of July 2018	New Vehicle Types	11 <sup>th</sup> of July 2019
Class I & II	1 <sup>st</sup> of September 2020	New Vehicle Types	1 <sup>st</sup> of September 2021



Come and visit us at Used Bus and Coach Live. 13<sup>th</sup> & 14<sup>th</sup> of March - Newark Showground

SUPPLIER SPOTLIGHT



PSV are distributors for Ashtree Vision and Safety and can supply all mirror equipment including Cycle Safe Twin Mirrors.

MIRROR NO	COLOR	TYPE	MIRROR SIZE	TO FIT
PSV/13/252	Black	Glass	384x184 mm	16 - 28mm Mirror Arms
PSV/13/252 (Yellow)	Yellow	Glass	384x184 mm	16 - 28mm Mirror Arms
PSV/13/273	Black	Unbreakable Lens	384x184 mm	16 - 28mm Mirror Arms
PSV/13/273 (Yellow)	Yellow	Unbreakable Lens	384x184 mm	16 - 28mm Mirror Arms

**PSV RAMPS**  
Part of PSV Transport Systems Ltd

The PSV UK and EU Compliant Manual Ramp was designed to combat the increasing need for a lightweight robust manual ramp from Bus Body Builders and Bus Operators. The reinforced bungee style handle ensures operators can deploy and store the ramp without placing stress on the lower back. It is not until the handle is fully extended that the operator takes the weight of the top board.

RAMP DEPLOYMENT

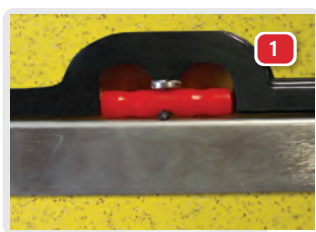

**1**  
PULL RAMP HANDLE

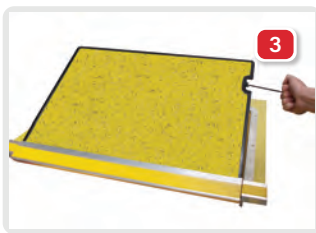
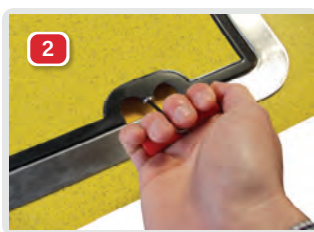

**3**  
RAISE RAMP & RELEASE HANDLE



P. +44 (0) 1992 479 950  
F. +44 (0) 1992 471 676

sales@psv-transport-systems.co.uk  
www.psv-transport-systems.co.uk

Unit 21 Impresa Park Pindar Road,  
Hoddesdon Hertfordshire EN11 0DL

