

Warnings

- Do not drop the InsuJet™ injector or the consumables.
- The InsuJet™ should only be used for the administration of U-100 insulins
- The InsuJet™ should only be used with InsuJet™ Nozzles and Adaptors.
- Check the expiration dates of your insulin. Do not use insulin past its expiration date.
- Check the expiration dates of the InsuJet™ consumables on the outer packaging. Do not use consumables past its expiration date.
- Check the integrity of the InsuJet™ consumables packaging. Do not use if the package is breached.
- Never use the same Nozzle for different types of insulin.
- Never use the same cartridge- or vial Adaptor for different insulin cartridges or vials. Discard the Adaptor with the empty insulin cartridge or vial.
- Be careful not to touch the needle inside the Adaptor.
- Never discharge the InsuJet™ without a Nozzle attached, or air inside the Nozzle. This is called DRY-FIRING and may damage the device beyond repair.
- Do not store insulin inside the Nozzle. The Nozzle is only intended to be filled immediately before injection.
- Replace the Nozzle whenever the InsuJet™ has not been used for more than 3 days.
- Never use the same Nozzle or cartridge or vial Adaptor for different patients. Using the same device for

multiple patients may result in the direct transfer of bacteria, viruses or other germs from one person to another.

- Adult supervision is highly recommended when a child uses the InsuJet™. Make sure that children are told that the InsuJet™ is not a toy.
- Keep all medications and injection devices out of the reach of children.
- Never use, or attempt to repair a damaged or broken InsuJet™ or consumable.
- In case provided hygiene practices and warnings are not followed, the consumables may be contaminated during use, possibly resulting in infections.
- In case a serious incident has occurred in relation to the device, this should be reported to EPG BV and the [applicable Competent Authority] in [applicable country]
- Temperature limits for use:

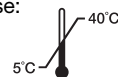

Good hygiene practices

- Wash your hands thoroughly before using the InsuJet™
- Clean the injection site as directed by your Diabetes Care Specialist.
- Avoid unnecessary contact with the Nozzle tip or the areas on the consumables that come into contact with the insulin. Always keep the nozzle cover and adaptor caps on between use. This will prevent possible contamination.

InsuJet™ Nozzle replacement and installation



Max **56 injections**, or **14 days** use. (whichever comes first)

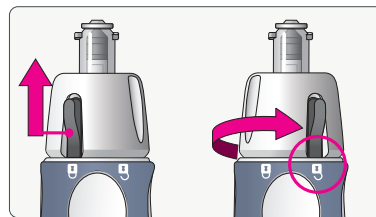

Push the Nozzle Lock Switch upward and Turn the Nozzle Lock until the Switch points to the 'unlocked' position.

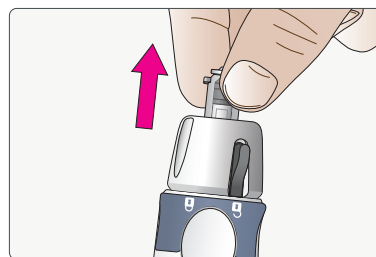

Pull the Nozzle out of the InsuJet™ with a firm straight pull.

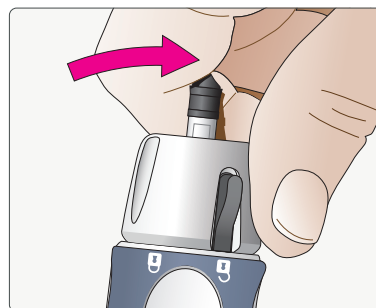

Loosen the internal part of the Nozzle by pushing it firmly to one side.



Remove the internal part of the Nozzle and discard it together with the nozzle.

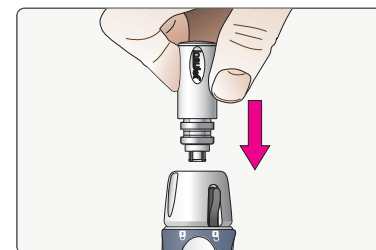

Firmly push the Nozzle into the Nozzle Lock.

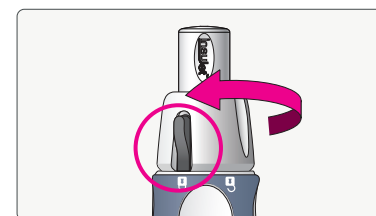

Once you have fully inserted the Nozzle, turn the Nozzle Lock until the Switch points to the 'locked' position.

Symbol Legend



CONSULT INSTRUCTIONS FOR USE



CAUTION



MANUFACTURER



BATCH CODE



USE-BY DATE



STERILIZED USING ETHYLENE OXIDE



TEMPERATURE LIMITS



DO NOT USE IF PACKAGE IS DAMAGED AND CONSULT INSTRUCTIONS FOR USE



DO NOT RESTERILIZE



NON-PYROGENIC



SINGLE PERSON-MULTIPLE USE



DO NOT RE-USE MORE THAN 56 TIMES



DO NOT RE-USE LONGER THAN 14 DAYS



MEDICAL DEVICE



SINGLE STERILE BARRIER SYSTEM



UNIQUE DEVICE IDENTIFIER



CALIBRATED FOR USE OF U-100 INSULIN



Euro Offices Building 3rd Floor
Beechavenue 127,
1119 RB Schiphol-Rijk, The Netherlands



017303-EN-8.0
3 Nov 2021

insuJet™
Insulin - Jet Administration System

Consumable information



- This packaging contains sterile consumables for use in combination with the InsuJet™ system.
- Please read the complete instructions for use booklet inside the InsuJet™ package before using the InsuJet™ system.
- Keep the original InsuJet™ instructions for use in safe custody.
- This package will only contain one type of consumable.



Identification

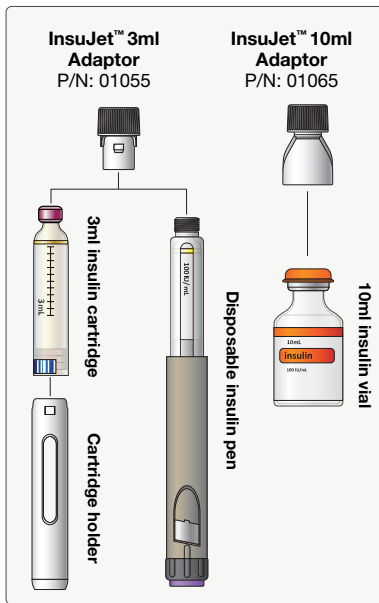
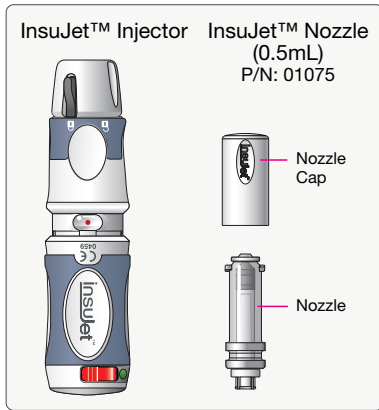

Example of the use of InsuJet adaptors for 3ml insulin cartridge, disposable penfil or 10ml insulin vials.

Preparing the consumables

Choose your InsuJet™ adaptor

There two types of Adaptors available for the InsuJet™.

These Adaptors are used to transport the insulin from an insulin cartridge or insulin vial into the Nozzle.

- Use a 3ml Adaptor if you want to use insulin from a 3ml insulin cartridge or from a disposable prefilled pen.
- If you want to use insulin from a 10ml vial, use the 10ml Vial Adaptor.

Removing the consumable from its sterile packaging

Once you confirm you have the correct consumable, confirm the packaging is intact and check the expiration date.

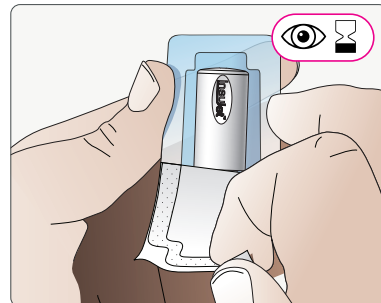

Break or tear a single blister from the strip. Check the expiration date. Open the blister seal by tearing the lid from one of the corners in one clean pull.

3ml Adaptor with disposable insulin pen

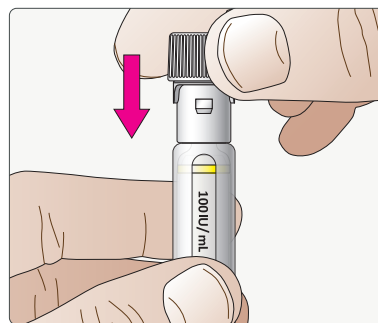

Take the 3ml Adaptor and place it on top of the disposable insulin pen. Push the Adaptor firmly onto the insulin pen until it is fixed.

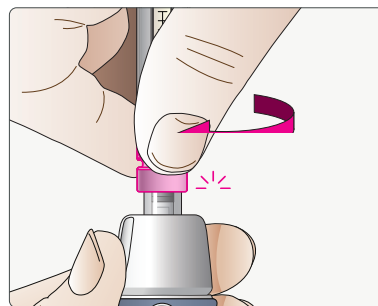

Align the Adaptor with the Nozzle and firmly rotate the Adaptor clockwise onto the Nozzle.

NOTICE:

When attaching the Adaptor with a disposable insulin pen on the Nozzle, make sure to hold the Adaptor when rotating it onto the Nozzle.

Installing a 3ml Adaptor with cartridge

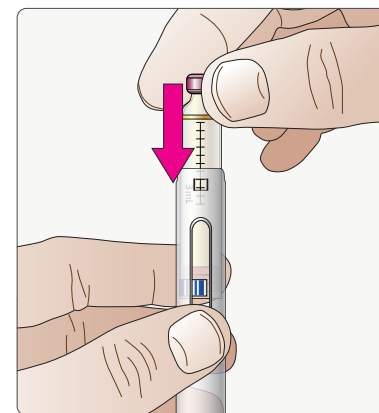

Slide the 3ml cartridge into the Holder, with the bottom of the cartridge downward.

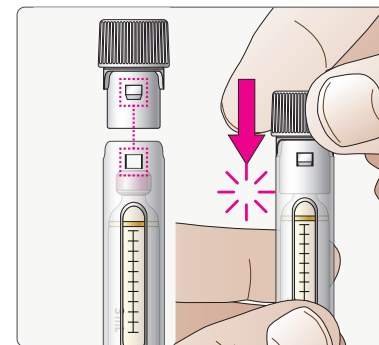

Take the Adaptor and align the protrusions with the corresponding holes in the Holder.

Push firmly until the Adaptor snaps in place. The Adaptor remains on the Holder.

Installing a 10mL Adaptor with vial

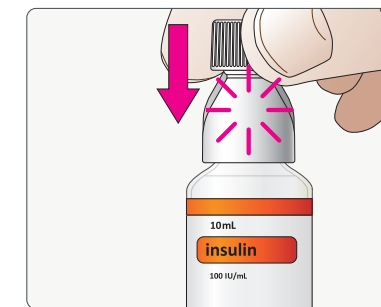

Remove the protective cap from the insulin vial.

Push the 10ml Adaptor firmly onto the vial, until the Adaptor snaps in place. The Adaptor remains on the vial.

Connecting the Adaptor to the Nozzle

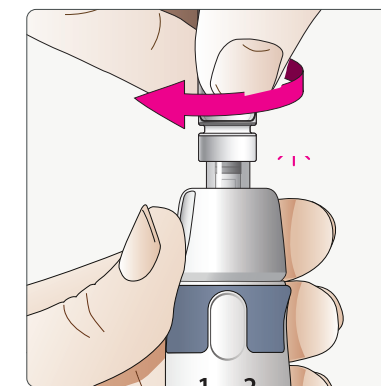

Align the Adaptor with the Nozzle and firmly rotate the Adaptor clockwise onto the Nozzle.

Storage and maintenance

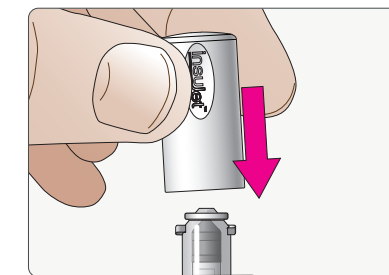

To keep the accessories clean between use, always put back the covers after use.

Remove the Comfort Ring and place the Nozzle Cover back on the Nozzle.

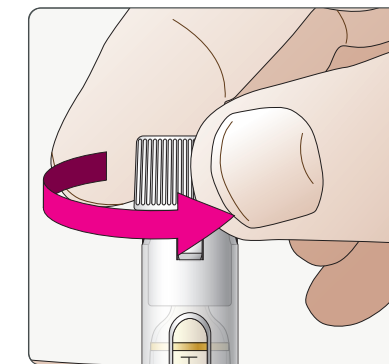

Place the Adaptor Cover back on the Adaptor.

Disposal

- All products can be discarded in regular household waste
- Discard the cartridge/vial Adaptor along with each empty insulin cartridge/vial.