



E3

Wireless
headphones



ACTIVE NOISE CANCELLATION

QUICK CHARGE

User's manual

Please read this manual
before using the product

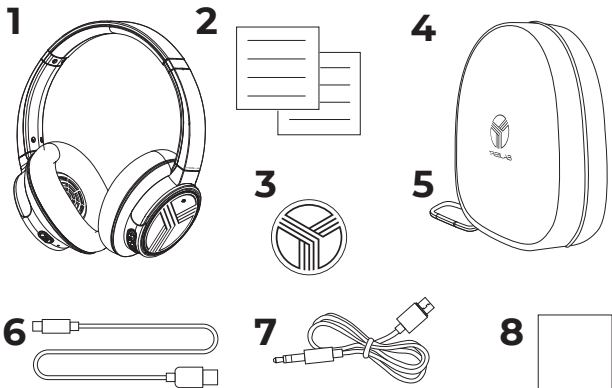
**E3**

1. **TREBLAB E3** headphones
2. User's manual
3. Round TREBLAB sticker
4. Carrying Case
5. Carabiner
6. Charging Type-C cable
7. 3.5 mm Audio cable
8. Insert card

Thank you for choosing TREBLAB E3!

The over-ear headphones with Feedforward Active Noise Cancellation technology provide superior sound quality and the convenience of hands-free operation.

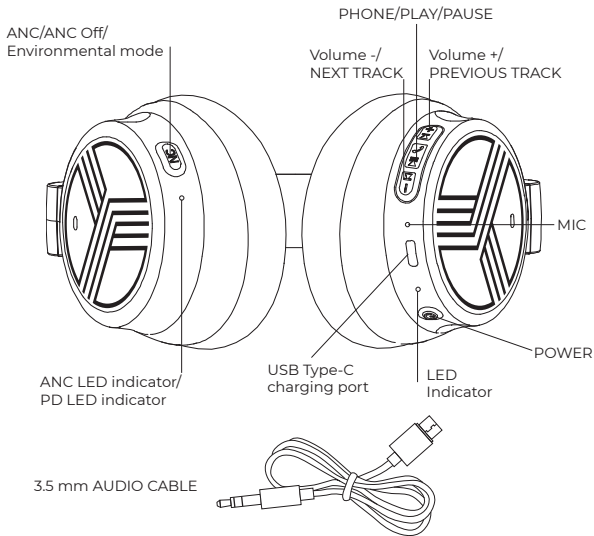

Function	Operation
Power ON	Press and hold the POWER button for 3 seconds.
Power OFF	Press and hold the POWER button for 5 seconds.
Battery level	Press shortly the POWER button while the headset is on.
Play/Pause	Press the PHONE button.
Volume +	Press shortly the Volume + button.
Volume -	Press shortly the Volume - button.
Next track	Press and hold the Volume - button for 1 second.
Previous track	Press and hold the Volume + button for 1 second.
Answer a phone call	Press shortly the PHONE button during the incoming call.
Reject a phone call	Press and hold the PHONE button during the incoming call for 1 second.
End a phone call (Hang up)	Press shortly the PHONE button during the conversation.
Redial	Press the PHONE button twice.
Voice assistant activation	Press and hold the POWER button for 3 seconds.
ANC MODE	Press and hold the ANC button.
Environmental mode/ ANC OFF	When the ANC MODE is active, press shortly the ANC button to switch to the Environmental mode and press it shortly again to turn ANC off.

SETTING UP YOUR TREBLAB E3

Turn ON

When using the headset for the first time, press the **POWER** button for 5 seconds until the red LED starts flashing. Then release the button. The device will get into pairing mode. For further use, press the **POWER** button for 3 seconds. You will hear the "Power ON" voice prompt, and the red LED light will start flashing.

Turn OFF

Press and hold the **POWER** button for 5 seconds. You will hear the "Power OFF" voice prompt, and the red LED will flash two times.

PAIRING

Make sure **TREBLAB E3** are charged and the 3.5 mm Audio cable is not plugged in.

1. Press and hold the **POWER** button for 3 seconds. You will hear the "Power ON" voice prompt. Do not release the button for a few additional seconds until you hear the "Pairing" voice prompt, and the LED will start flashing red indicating that the **E3** are in pairing mode.
2. Activate Bluetooth mode on your smart device and keep it within 3 feet / 1 m from the **TREBLAB E3** while pairing.
3. Scan/search for available devices in your smart device.
4. Select the **TREBLAB E3** from the list.
5. If prompted the password, enter "0000".
6. Once the **E3** are successfully paired and connected, you will hear the "Connected" voice prompt, and the LED will start flashing blue slowly.

NOTE: The **TREBLAB E3** headphones can be connected to only one device at a time.

To connect the **E3** to the second device:

1. Switch off Bluetooth mode on the first device the headphones are connected to.
2. Repeat pairing steps 1-6 and connect the other device.

When you turn the earbuds on, they will try to reconnect with recently connected device/devices. If the reconnection does not happen automatically, the earbuds will try to find the next device in the pairing list. The headphones can save up to 8 devices.

AUX-IN CONNECTION

You can connect the **TREBLAB E3** to compatible devices using the supplied 3.5 mm Audio cable.

Plug the USB Type-C end of the Audio cable into the **USB Type-C charging port / AUX Line-in** port on the right earcup and plug the other 3.5 mm end into the AUX jack on your device.

NOTE: The functions Next, Previous, Pause and Volume are not available when using the 3.5 mm Audio cable. You will need to make all the adjustments using your smart device.

Please keep the ANC function off while connected with a line-in audio cable.

AUDIO PLAYBACK

Bluetooth mode

To pause and resume the playback when connected wirelessly, press shortly the **PHONE** button.

To adjust the volume, press shortly the **Volume+** button to turn the volume up and **Volume-** button to turn the volume down.

To change tracks on the **E3**, press and hold the **Volume -** button for 1 second to play the next track and press and hold the **Volume +** button for 1 second to play the previous track.

ANC FUNCTION

The **TREBLAB E3** headphones feature the Feedforward Active Noise Cancellation (ANC) technology. This technology provides the ability to not only decrease the surrounding noise in ANC mode but also alternatively increase some frequencies of surround sound in Environmental sound mode to hear voices when using the **E3** headphones. These functions can be used with and without playing any music.

- To turn ON the ANC mode, press and hold the **ANC** button on the left earcup. The ANC LED indicator near the button will turn green.
- To turn ON the Environmental sound, press shortly the **ANC** button.
- To turn OFF the ANC functions, press shortly the **ANC** button again.

NOTE: Please keep the deduction microphone holes on both earcups not blocked when using the ANC/Environmental functions.

PHONE CALLS

The **TREBLAB E3** can be used to make and receive phone calls when connected wirelessly. The audio playback will be paused during the calls.

Function	Operation
To answer a call	Press shortly the PHONE button.
To reject a call	Press and hold the PHONE button for 3 seconds.
To end a call	Press shortly the PHONE button.
To redial	Press twice the PHONE button.
Multicals*	Press shortly the PHONE button to answer the first call. When the second one is incoming, press the PHONE button to pick it up. The first one will enter into the hold on status. Press the PHONE button again to end the second call and get back on the first one. Press the POWER button to end the current call.

*To be able to use this option, your device needs to support the multicalls management.

VOICE ASSISTANT ACTIVATION

The **TREBLAB E3** headphones support the voice assistant activation command. To use any of the voice assistants (depending on the assistant enabled on your connected smart device) while in Bluetooth mode, press and hold the **POWER** button for 3 seconds. After the sound notification, you can transmit your voice commands using an inbuilt mic.



Cortana®



Alexa®



Siri®



Google Voice Assistant®



Bixby®

TROUBLESHOOTING

Problem	Solution
Doesn't turn on	<p>Make sure the headphones are charged.</p> <p>Charge up to 1 hour until the battery is fully charged, if necessary.</p> <p>Press and hold the POWER button again for 1 second.</p>
Music is not playing	<p>Make sure the headphones are charged.</p> <p>Make sure the 3.5 mm Audio cable is correctly and firmly connected to the headphones if you are using the AUX Line-In mode.</p> <p>Make sure the 3.5 mm Audio cable has been removed from the headphones if you are trying to use the Bluetooth connection.</p> <p>Make sure the volume level is not set to a 0 level on both the headphones and the device.</p> <p>Make sure that the distance between your device and the headphones is less than 30 feet / 10 meters.</p> <p>Make sure your smart device's Bluetooth mode is on and not involved in any kind of wired connection.</p>

Headphones don't pair with my Bluetooth device

Make sure the 3.5 mm Audio cable is not plugged in.

Make sure the headphones are not paired with any other device, as it can only pair with one device at a time.

Make sure that the distance between your device and the headphones is less than 30 feet / 10 meters.

Make sure your smart device's Bluetooth mode is on and not involved in any kind of wired connection.

Headphones are visible on my device but do not connect

Make sure the headphones are not paired with any other device, as it can only pair with one device at a time.

Make sure that the distance between your device and the headphones is less than 30 feet / 10 meters.

Disconnect the device from your headphones and remove the **E3** from your device's pairing list. Turn the **E3** off. Try to pair again using steps 1-6 from the Pairing charter.

I cannot find Bluetooth on my laptop

Make sure your laptop supports the Bluetooth connection. If it doesn't, you will need an external wireless USB adapter compatible with your laptop. For further details, consult with your laptop manufacturer.

Frequent disconnection and noise

Make sure that the distance between your device and the headphones is less than 30 feet / 10 meters.

Make sure that nothing is blocking the signal between your device and the **E3**.

Check if the music is paused. Check if the volume level is set on both the source device and the headphones.

Check if the headphones are running out of power.

CHARGING AND BATTERY

TREBLAB E3 support PD quick charging protocol, so you can charge them with your USB Type-C charger or Power Bank with quick charge. When PD quick charge protocol is detected, you will see the ANC LED shining white.

Also, you can charge the headphones by plugging the supplied cable into the USB Type-C charging port on the right ear-cup and the other end of the charging cord into a standard USB port. The LED light will turn red. It takes up to 1 hour to charge the **E3** fully. The red light will turn off when the headphones are fully charged.

One full battery charge provides up to 2 days of playtime at medium volume w/o ANC and up to 27 hours at 100% volume with the ANC activated function.

The incredible quick charge function lets you use your headphones up to 7 hours at 100% volume w/o ANC after just 3min of charging by 5V / 2A standard charger and even much longer with 9V / 2A, 12V / 1.5A quick charge charger.

When the battery is running low, you will hear the "Battery Low" voice prompt.

Be sure to use no less than 5V DC, 2A adapter or charger. Using a power source with lower power will increase the overall charging time. Unplug the **E3** from the charging cable and the cable from the power source when not in use. If left unused, a fully charged battery will lose its charge over time.

We recommend charging the **TREBLAB E3** fully at least twice a month to maintain the sufficient battery life.

SAFETY RULES

- Don't disassemble or modify your headphones for any reason. Doing this may cause the headphones to malfunction or become combustible.
- The damage to your device can void your manufacturer's warranty.
- Do not let your device get wet – liquids can cause serious damage.
- Damage to your device caused by water can void your manufacturer's warranty.
- Make sure the headset is completely dry before charging.
- Avoid exposing the **TREBLAB E3** to extreme temperatures (below 37°F/3°C or above 112°F/45°C). Extreme temperatures can cause the deformation of the **E3** components, reduce the battery life and the lifespan of your new headset.
- Don't put the device's LED lights close to humans' or animals' eyes.
- Do not use your **E3** during a thunderstorm. Thunderstorms can cause serious malfunction and increase the risk of electric shock.

RECYCLING

The earphones can be recycled, and they should be in order to keep our planet clean. Where should you bring them?

In the **US**, there are a couple of options:

1) Best Buy has a recycling program.

Just take the broken earbuds with you next time you visit a Best Buy store.

This link will help you to find the best location:

<https://www.bestbuy.com/site/store-locator/>

2) Check for other possible locations next to you on these websites:

(just enter your ZIP to find a location):

<https://www.call2recycle.org>

<https://search.earth911.com>

<https://recyclenation.com/find>

<https://www.cta.tech/Consumer-Resources/Greener-Gadgets>

In **Canada**, please visit the links below:

<https://thinkreuse.net>

<https://www.call2recycle.ca>

In the **UK**, please visit the links below:

<https://www.recycle-more.co.uk/>

<https://www.recyclenow.com/local-recycling>

SPECIFICATIONS

Battery:	Up to 35 hours playtime (100% volume only) Over 48 hours playtime (medium volume only) Up to 27 hours playtime (100% volume and ANC) Up to 7 hours playtime from 3 minutes charge (100% volume only) Rechargeable Li-Ion 900mAh 3.7V, Input up to 18W-5V / 2A, 9V / 2A, 12V / 1.5A
Charging time:	Up to 1 hour with 5V / 2A standard charger
Voice assistant activation:	Supported by pressing and holding the POWER button for 3 seconds
Wireless version:	BT5.0, HFP v1.7, A2DP v1.3, AVRCPv1.5
Audio playback support:	AAC, SBC
Signal Range:	33 ft/10 m
Frequency response:	20 Hz–20 kHz
Charging port:	USB Type-C
Dimensions:	205x180x55 mm/8x7.08x2.16 in
Weight:	270 g/9.52 oz/0.59 lb

THANK YOU

We truly appreciate that you chose **TREBLAB** as your trusted brand of wireless ANC headphones. Our team sincerely hopes that you enjoy the great sound and seamless usability that the **TREBLAB E3** provide.

We love making our customers happy by providing true value with our products. If for any reason you are not completely satisfied with your purchase or have any questions, please let us know by contacting us at http://treblab.com/contact_us.

We care about our customers most of all and are always here to serve you!

1 YEAR WARRANTY
Parts and Labor Warranty

Please visit www.treblab.com
to register YOUR product.

Manufactured by Productech



EB

WIRELESS
HEADPHONES



Made in China

www.treblab.com
support@treblab.com

