

See Full Differential
Assembly on Page 11
of Our DC1 Manual

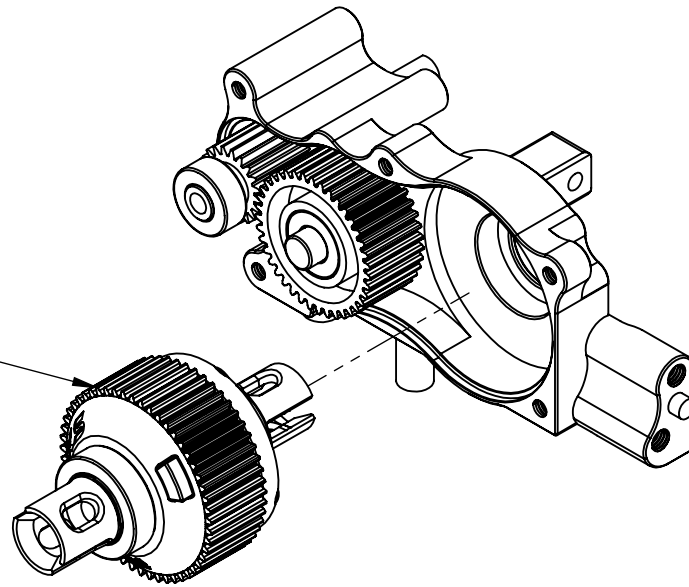

3x M3 x 14mm Buttonhead

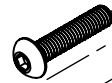

M3 x 3mm Buttonhead
(Oiling Fill Hole)



M3 x 8mm Buttonhead

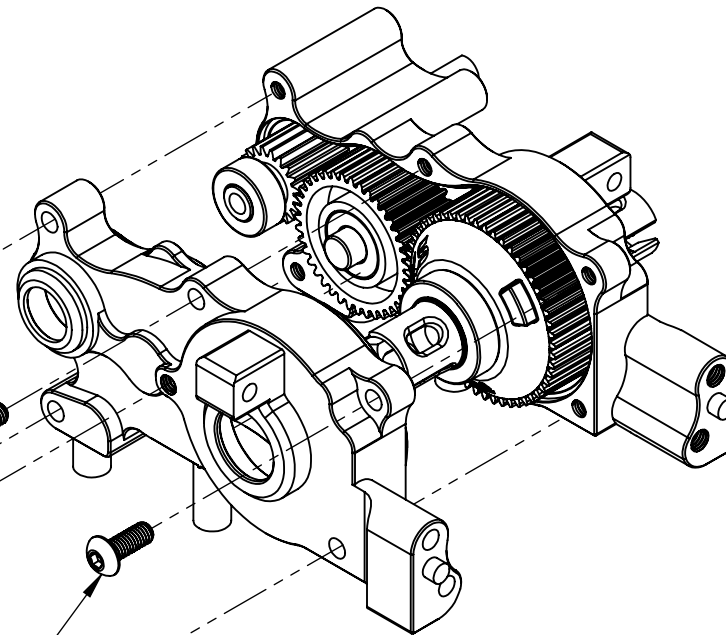
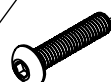

3x M3 x 8mm Countersink

All Screws go Thru Motor
Mount into Transmission

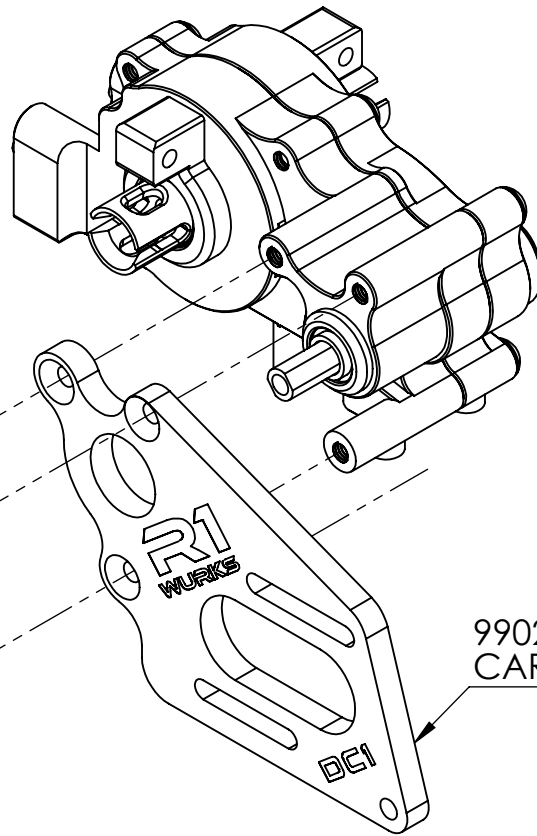

990254-CF
CARBON FIBER LOWERING MOTOR MOUNT

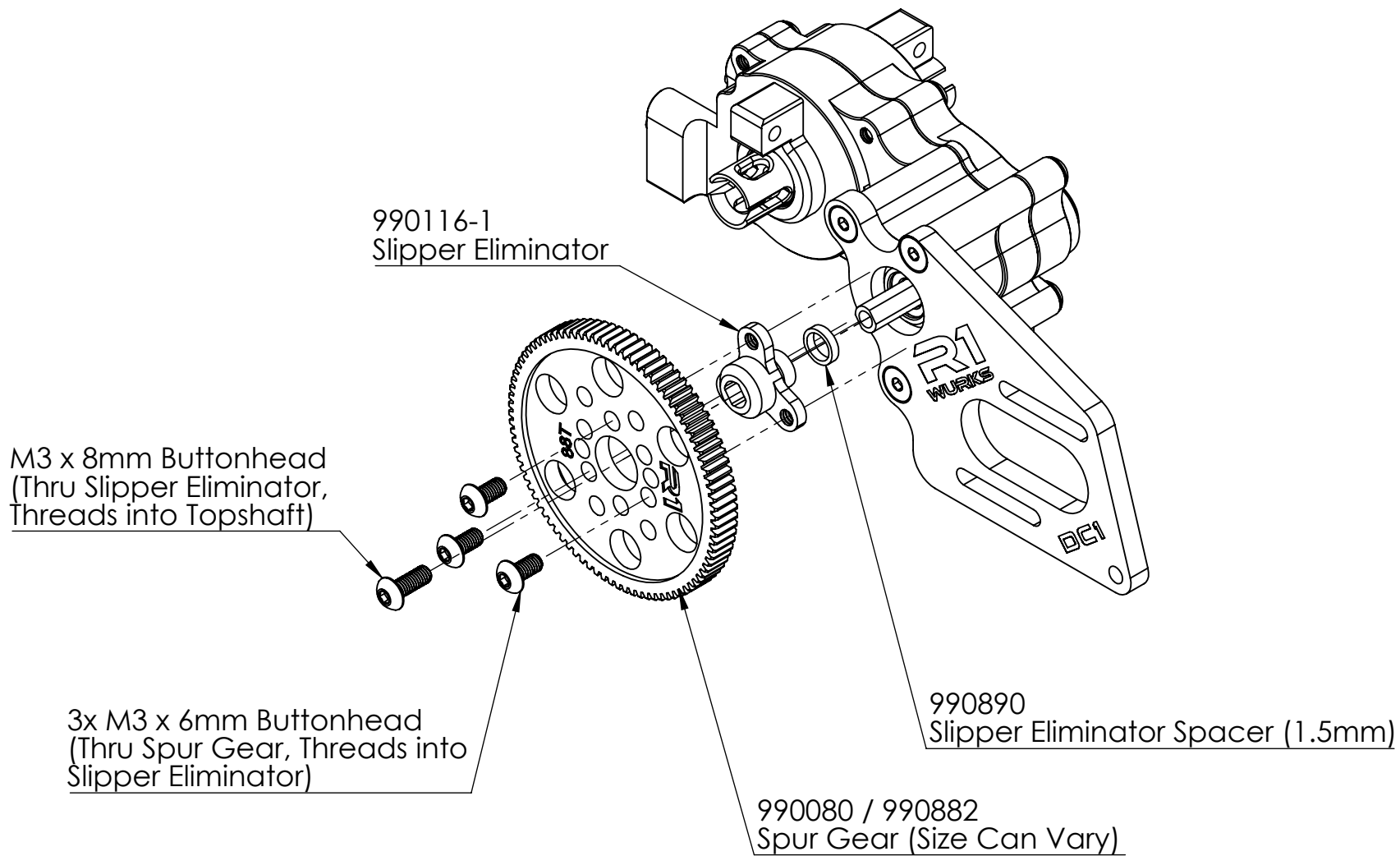

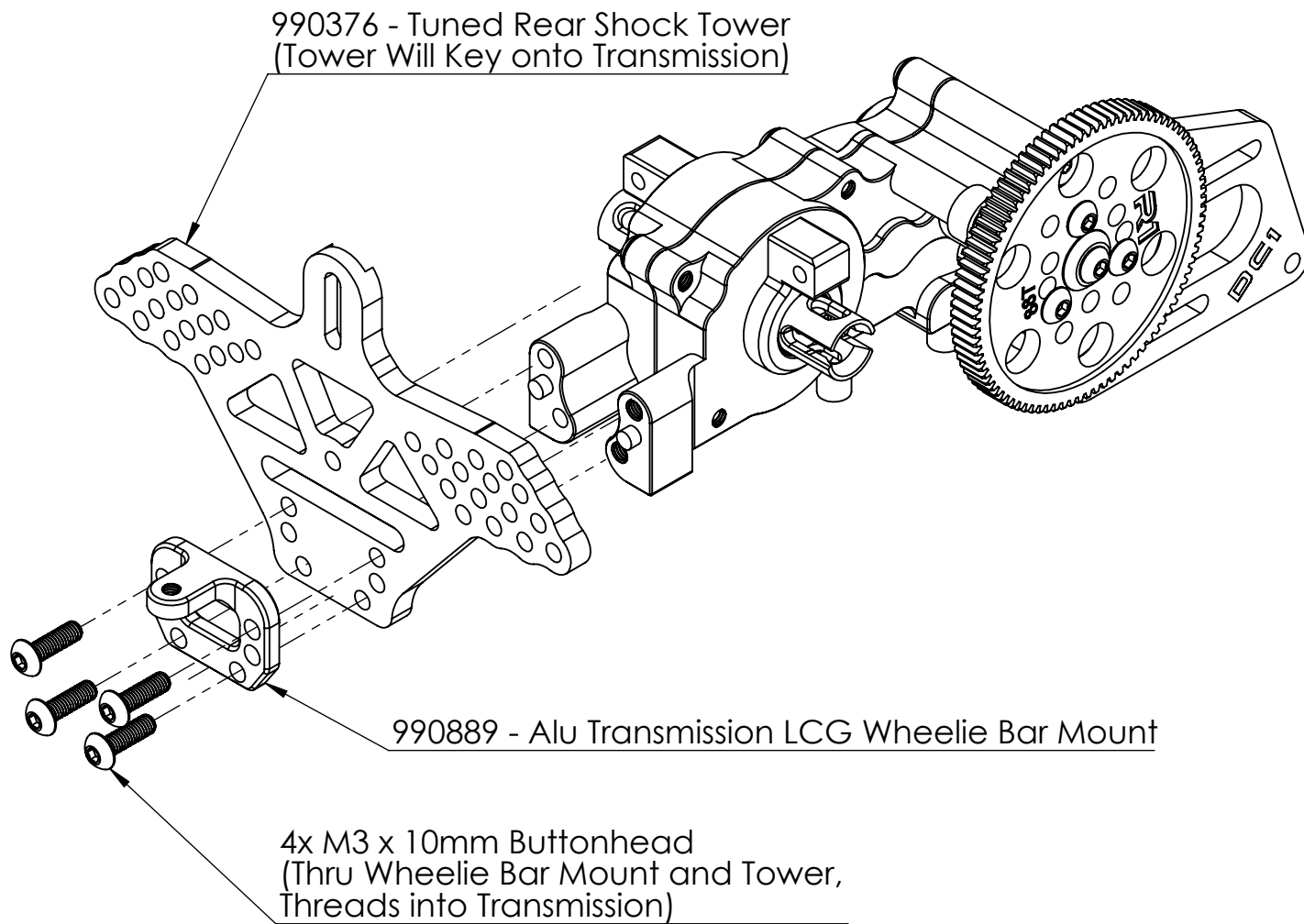

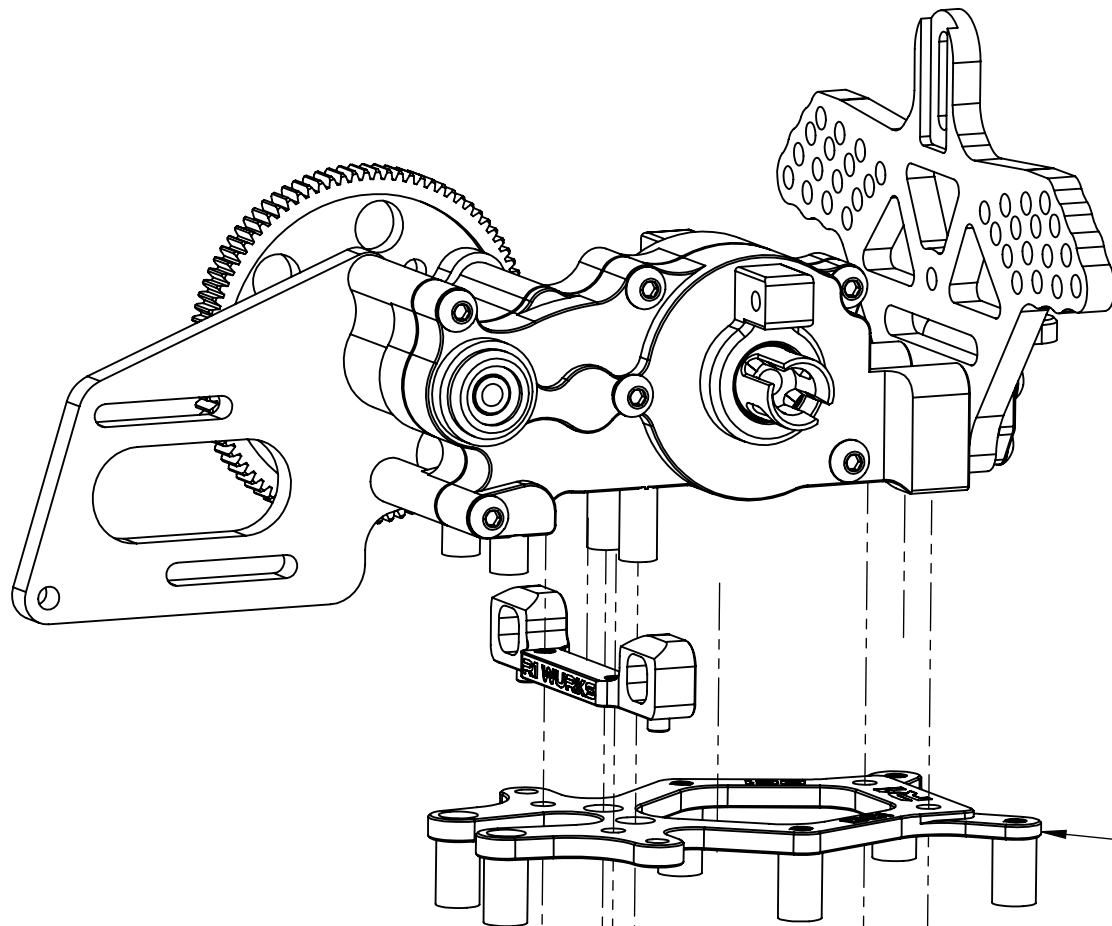

990277
Chassis Standoff for Laydown
Transmission

2x M3 x 8mm Countersink
(Thru Riser, Thread into C-Block)

2x M3 x 8mm Countersink
(Thru Riser, Thread into Transmission)

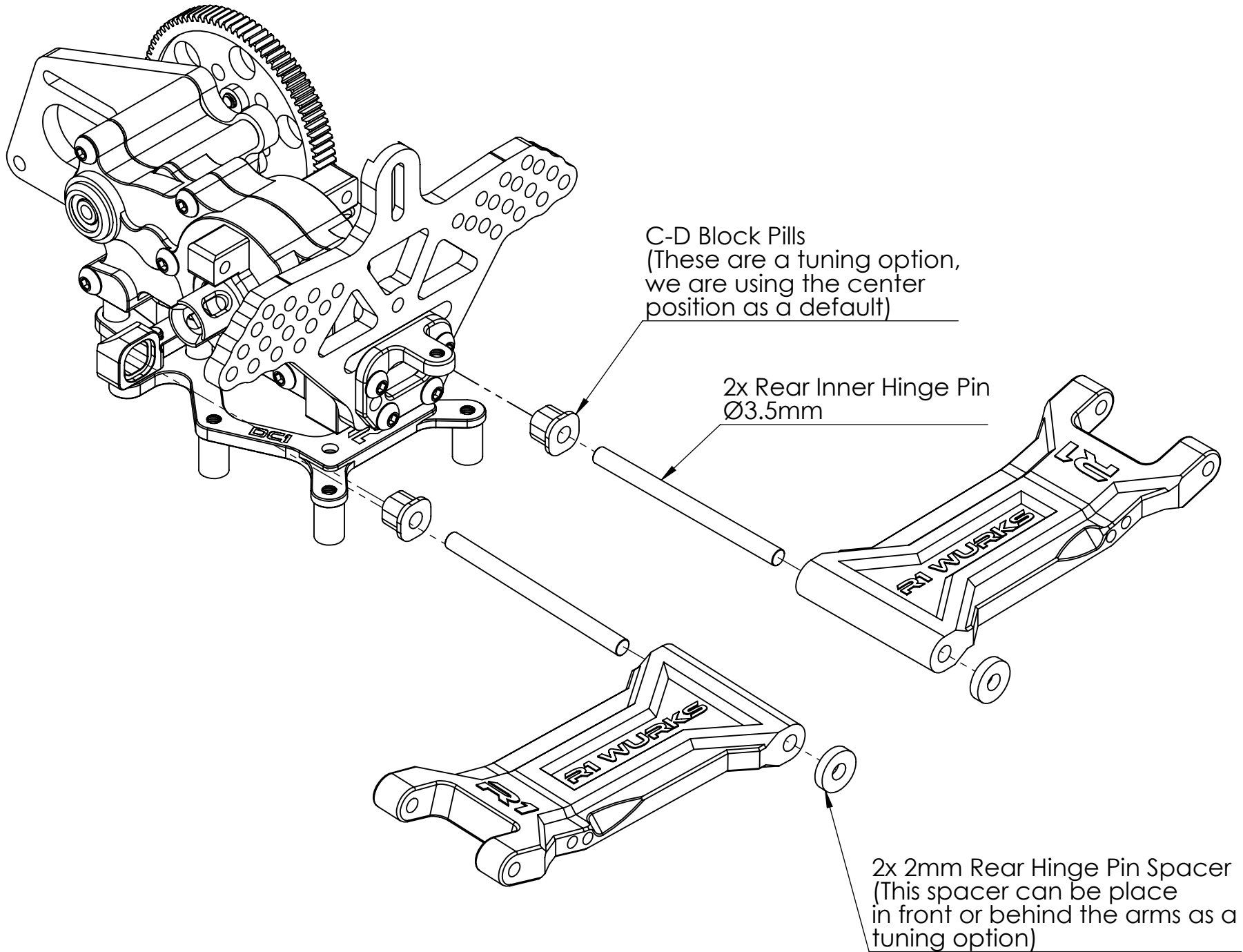

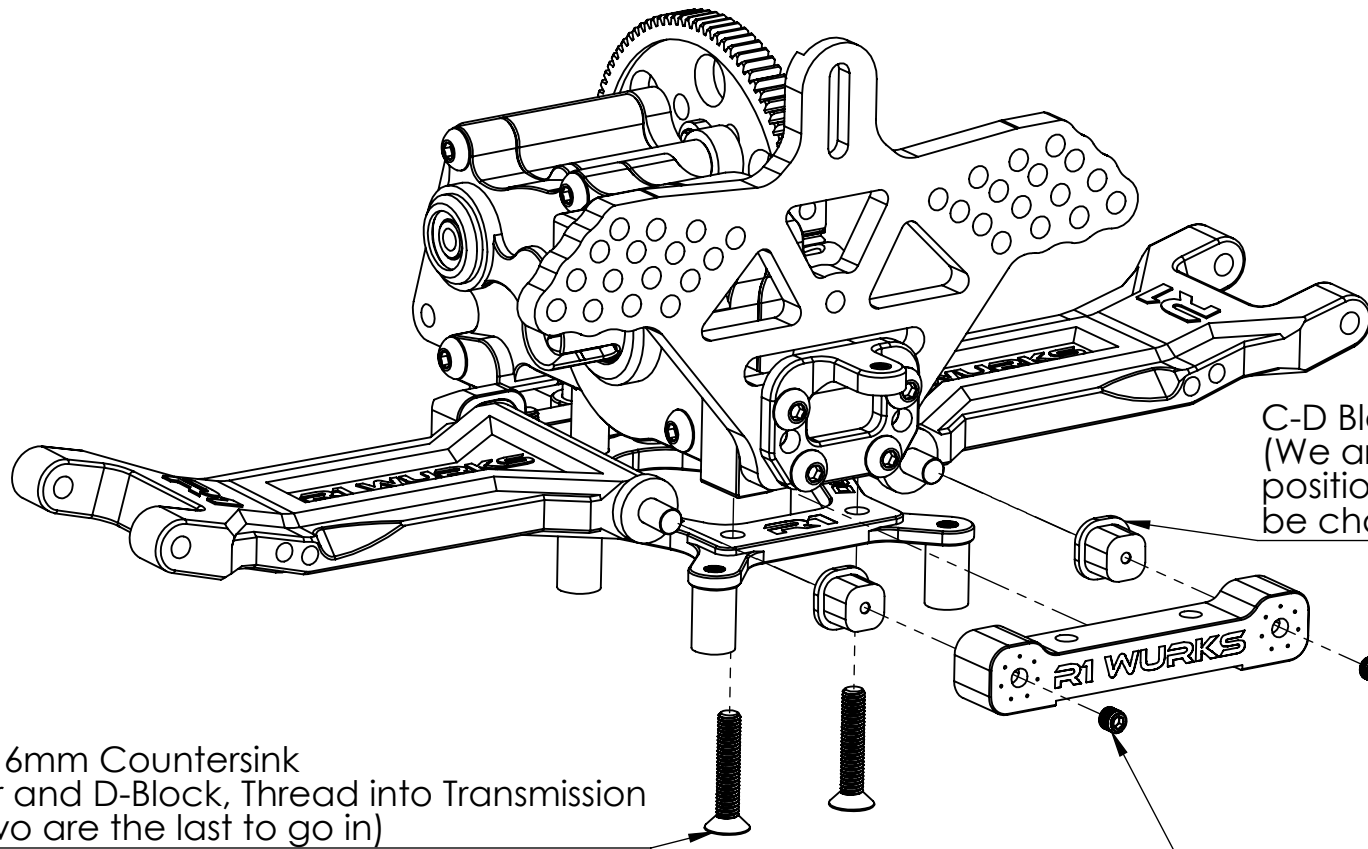

C-D Block Pills
(We are using the center
position as default, they can
be changed for tuning)

2x M3 x 16mm Countersink
Thru Riser and D-Block, Thread into Transmission
(These two are the last to go in)

2x M3 x 3mm Set Screw
(Used to take out any
play in the arms)

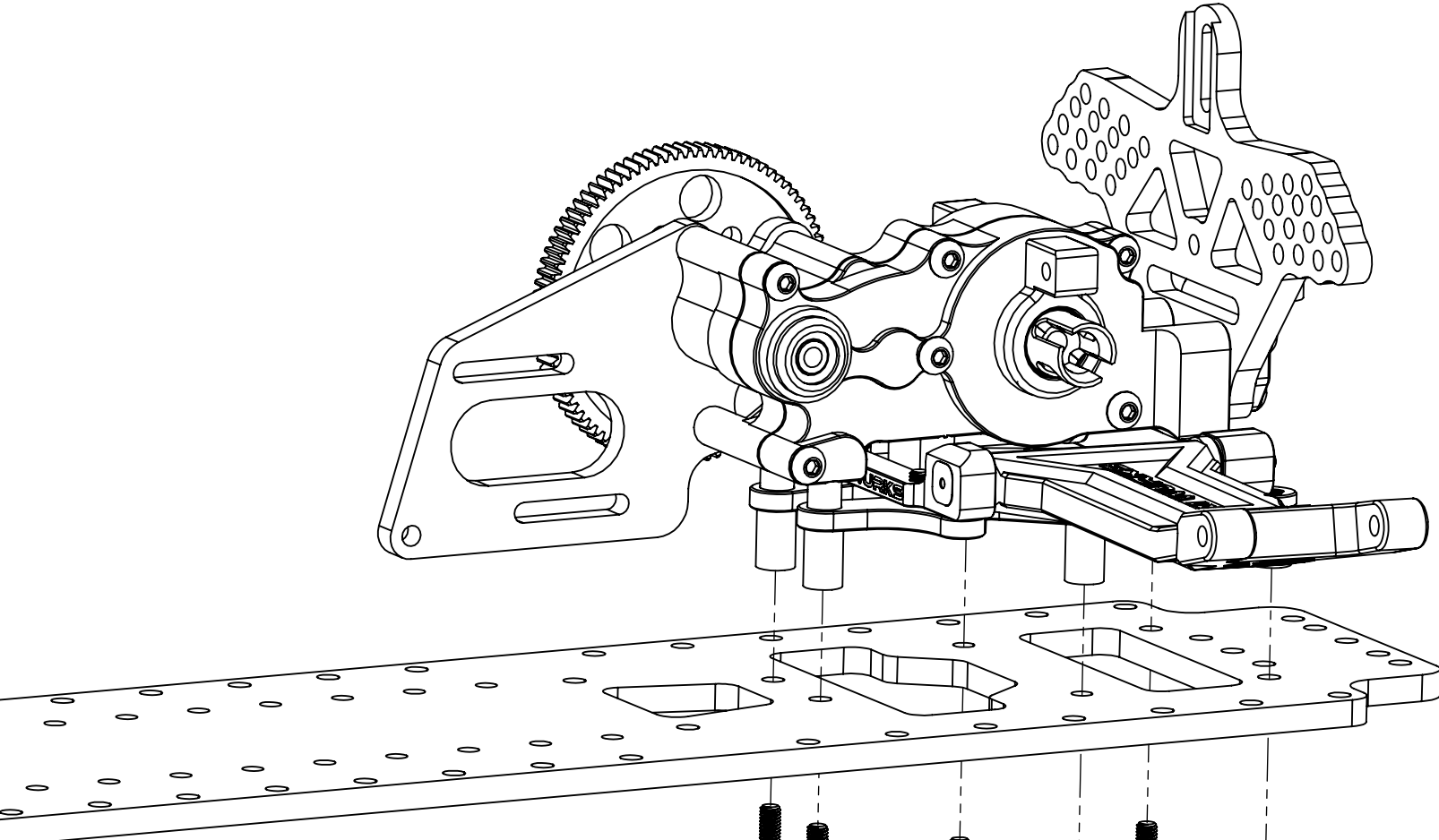

2x M3 x 18mm Countersink
(Thru Chassis and Riser
Thread into Transmission)

4x M3 x 8mm Countersink
(Thru Chassis, Thread into Riser)