

# DC1

PROTOTYPE  
DRAG RACING  
CONVERSION KIT



**DC1**  
WORKS

INSTRUCTION  
MANUAL

# INTRODUCTION

DC1

R1WURKS

**THIS IS OUR FLAGSHIP PRODUCT, THE DC1 DRAG CAR IS A TOP OF THE LINE RACE CAR! THIS KIT HAS BEEN TESTED AND PROVEN ON THE TRACK AND ITS WINNING REPUTATION SPEAKS FOR ITSELF.**

*Enjoy your build!*

# TOOLS NEEDED

**⚠ CAUTION: HANDLE TOOLS CAREFULLY!**

● NEEDLE NOSE PLIERS

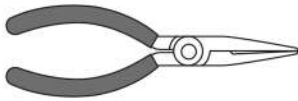

● AWL



● SCREW CEMENT



● CURVE SCISSORS AND SANDER

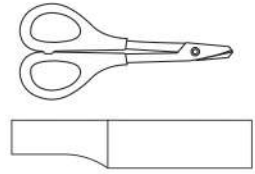

● SHARP HOBBY KNIFE

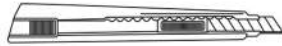

● HEX WRENCH

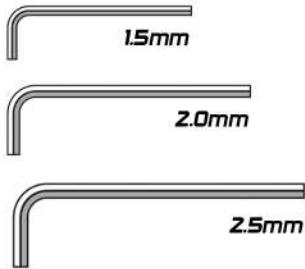

● GEAR DIFFERENTIAL GREASE



● GREASE

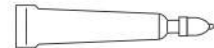

GEAR  
DIFF  
OIL  
#500,000

● CROSS WRENCH

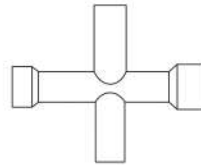

● CUTTER



SHOCK  
OIL  
#800

● REAMER

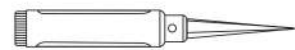

# RADIO PREPARATION

- A new battery must be charged before it is used. Refer to the charger instruction manual for charging.
- Set up the radio control system as indicated below.

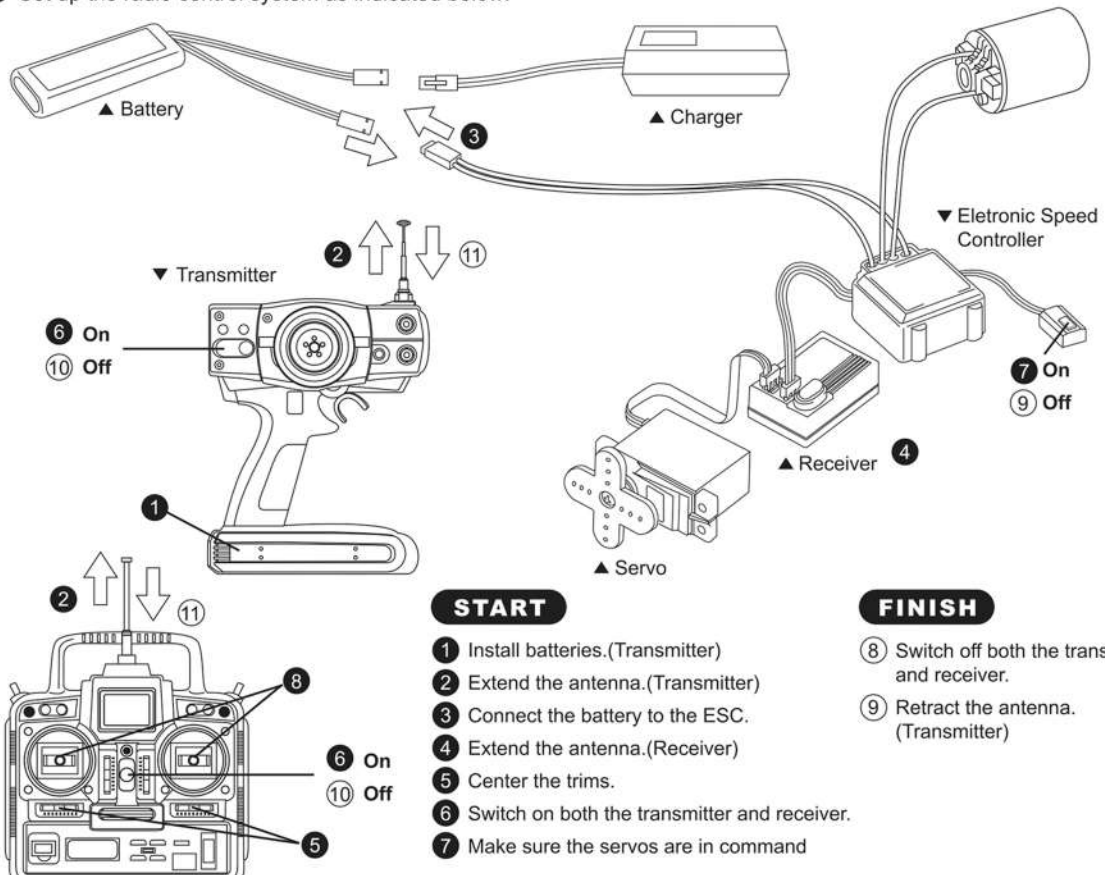

### START

- 1 Install batteries.(Transmitter)
- 2 Extend the antenna.(Transmitter)
- 3 Connect the battery to the ESC.
- 4 Extend the antenna.(Receiver)
- 5 Center the trims.
- 6 Switch on both the transmitter and receiver.
- 7 Make sure the servos are in command

### FINISH

- 8 Switch off both the transmitter and receiver.
- 9 Retract the antenna. (Transmitter)

# SHOCK ASSEMBLY PART 1

DC1  
R1WORKS

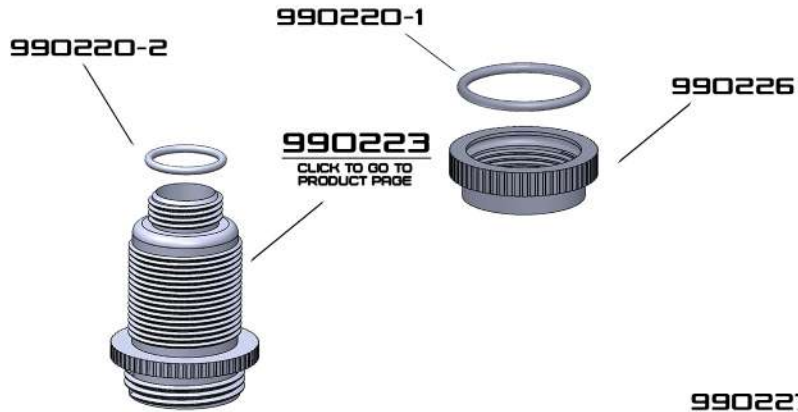

MAKE 4

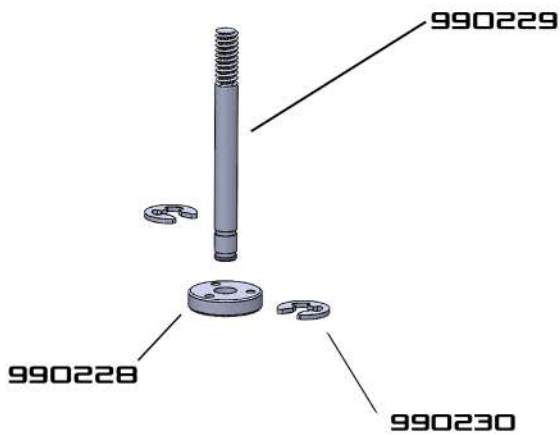
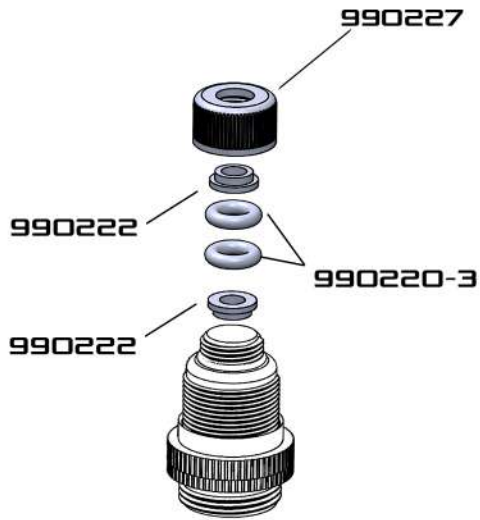

\*CLICK THE PART NUMBER TO OPEN  
THE PRODUCT PAGE

\*PRODUCT AND DESCRIPTION  
SUBJECT TO CHANGE  
WITHOUT NOTICE

"HOW TO  
BUILD"



CLICK HERE



# SHOCK ASSEMBLY PART 2

R1WORKS DC1

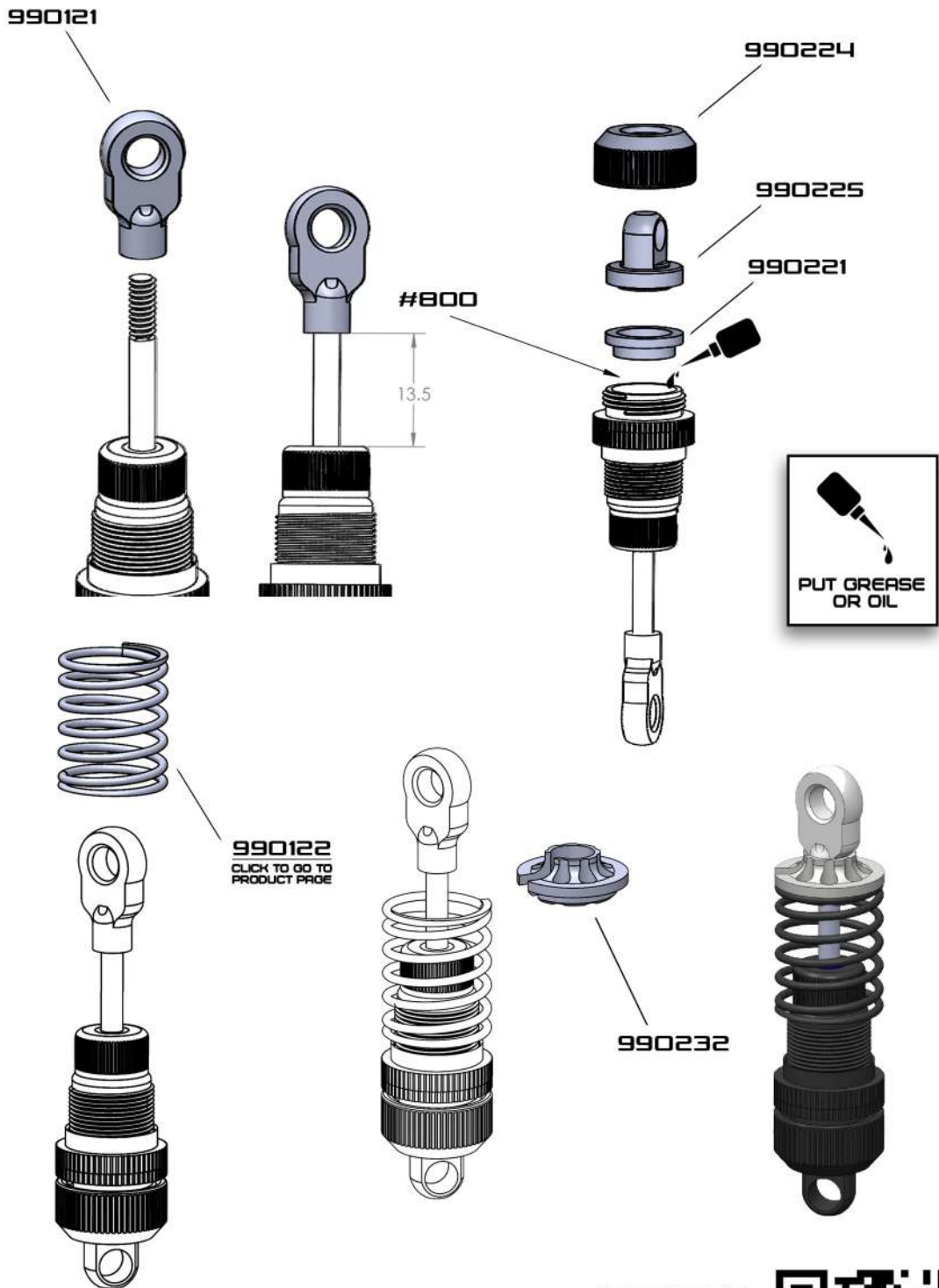

\*CLICK THE PART NUMBER TO OPEN  
THE PRODUCT PAGE

\*PRODUCT AND DESCRIPTION  
SUBJECT TO CHANGE  
WITHOUT NOTICE

"HOW TO  
BUILD"



CLICK HERE



FRONT BODY MOUNT SHORT TOWER  
STEP 1

990061	x2
990113	x2

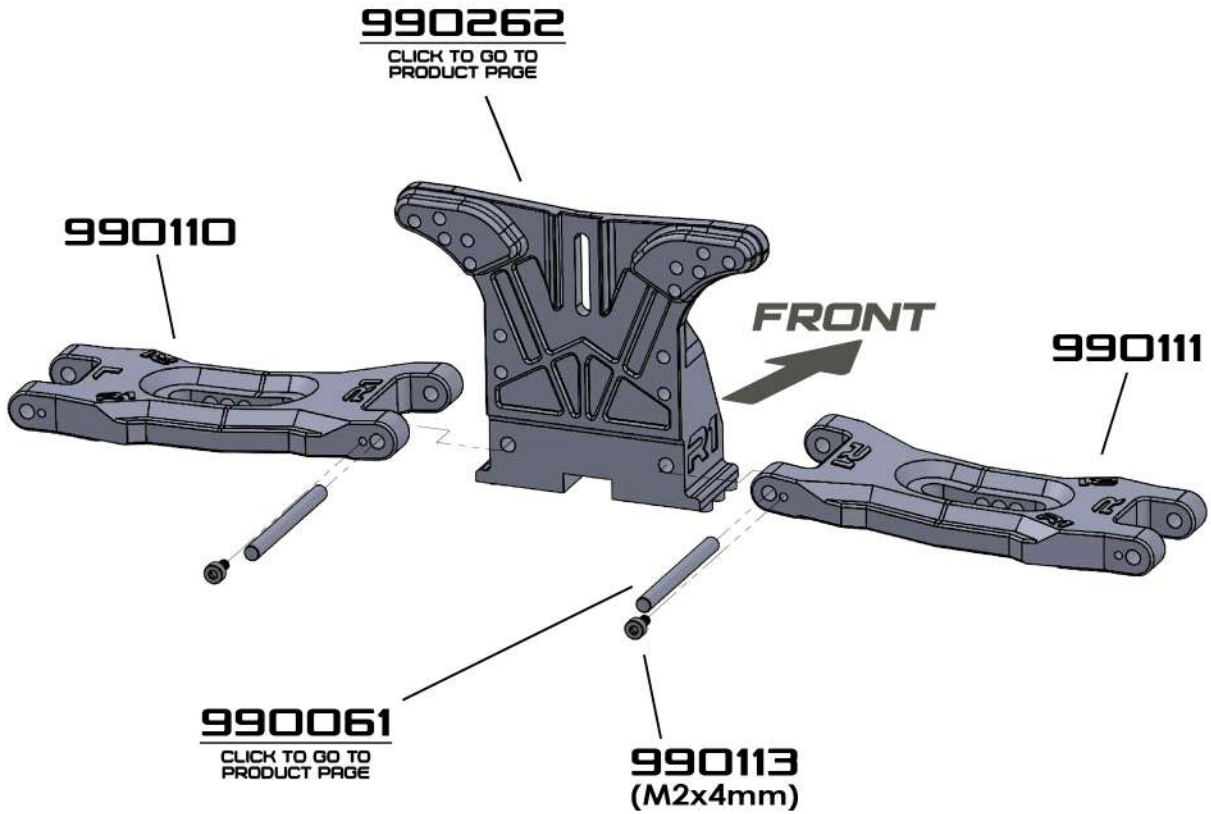

\*CLICK THE PART NUMBER TO OPEN  
THE PRODUCT PAGE

\*PRODUCT AND DESCRIPTION  
SUBJECT TO CHANGE  
WITHOUT NOTICE

"HOW TO  
BUILD"



CLICK HERE



FRONT BODY MOUNT SHORT TOWER  
STEP 2

990048-v1 x2  
990158-8 x2

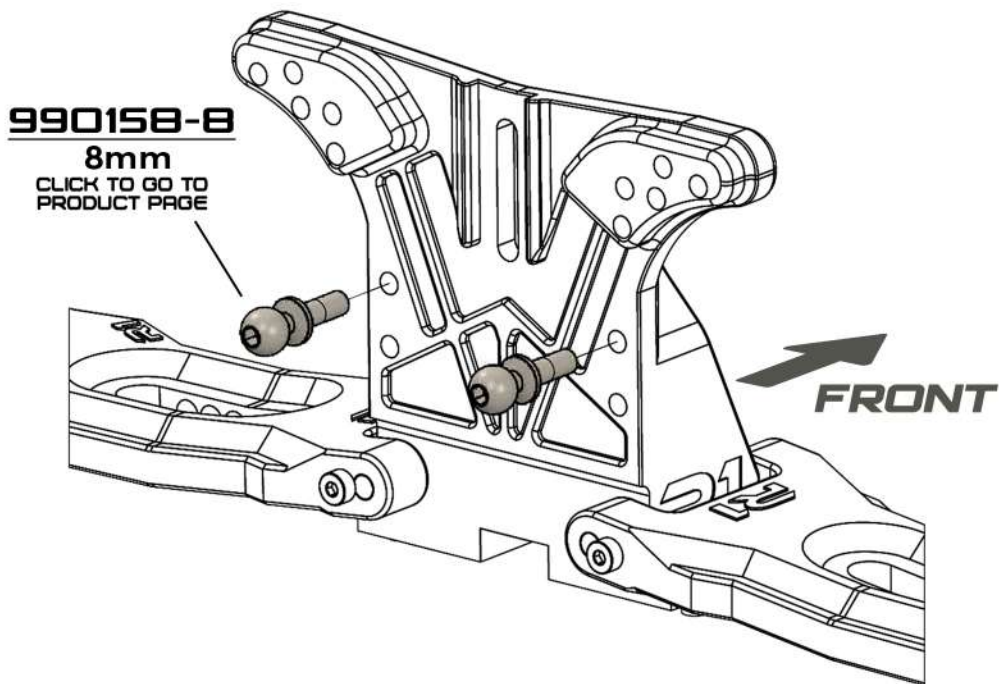

\*CLICK THE PART NUMBER TO OPEN  
THE PRODUCT PAGE

\*PRODUCT AND DESCRIPTION  
SUBJECT TO CHANGE  
WITHOUT NOTICE

"HOW TO  
BUILD"



CLICK HERE



# FRONT BODY MOUNT SHORT TOWER STEP 3

- |           |    |
|-----------|----|
| 990158-10 | x2 |
| 990059    | x2 |
| 990113    | x2 |
| 990120-2  | x2 |

**990158-10**  
(10mm)  
CLICK TO GO TO  
PRODUCT PAGE

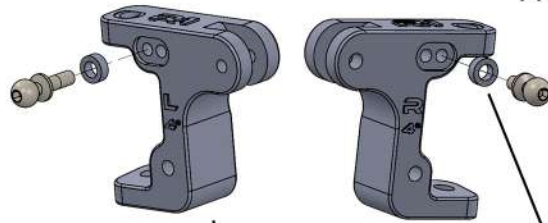

**990015-4**  
CLICK TO GO TO  
PRODUCT PAGE

**990120-2**  
(2mm)

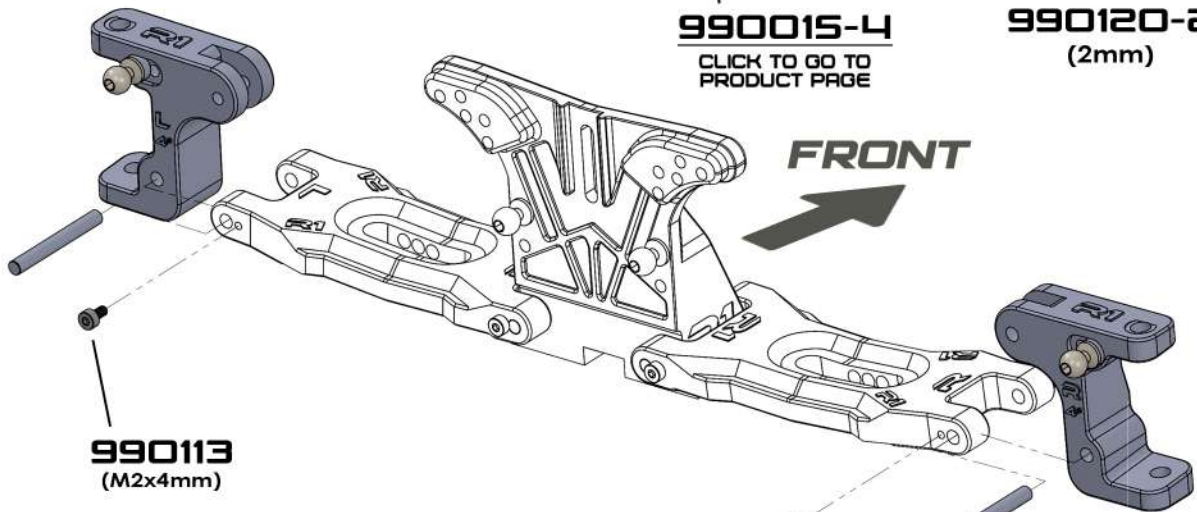

**990113**  
(M2x4mm)

**990059**  
CLICK TO GO TO  
PRODUCT PAGE

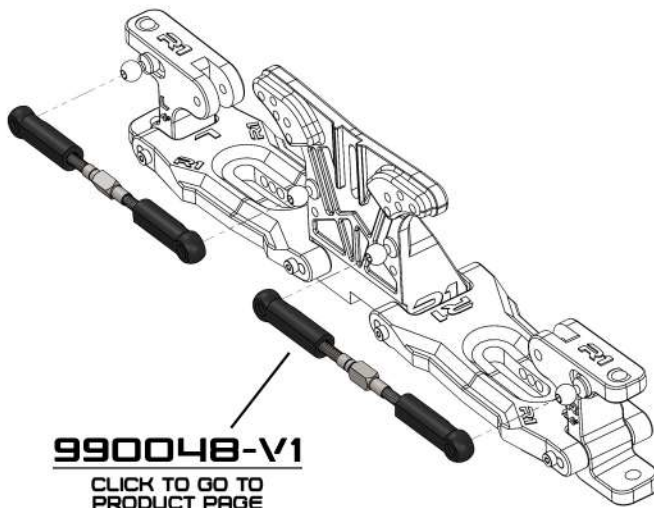

**990048-V1**  
CLICK TO GO TO  
PRODUCT PAGE

\*CLICK THE PART NUMBER TO OPEN  
THE PRODUCT PAGE

\*PRODUCT AND DESCRIPTION  
SUBJECT TO CHANGE  
WITHOUT NOTICE

"HOW TO  
BUILD"



CLICK HERE





# FRONT BODY MOUNT SHORT TOWER STEP 4

990234	x2
990158-10	x2
990166-6	x2
990166-12	x4
990166-18	x2
990166-20	x2

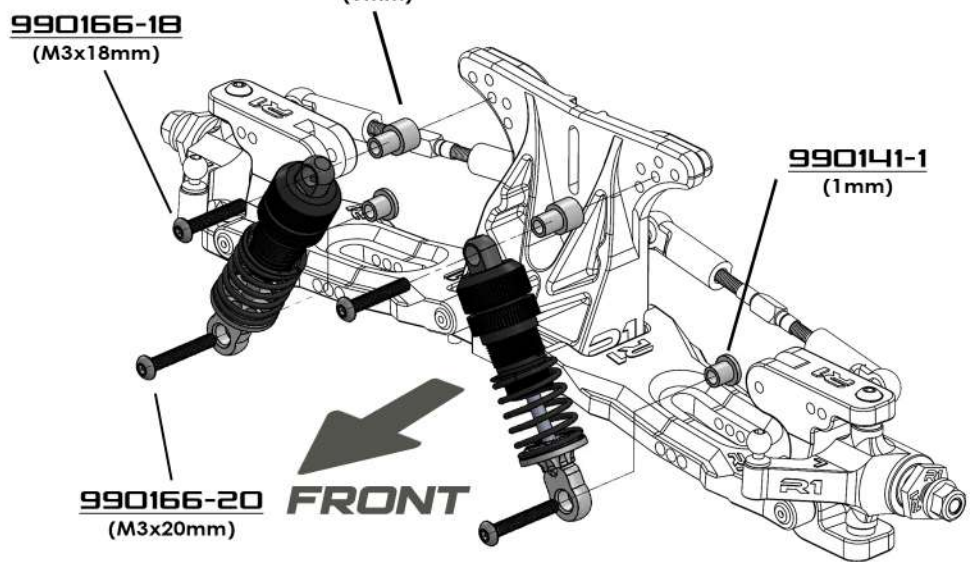
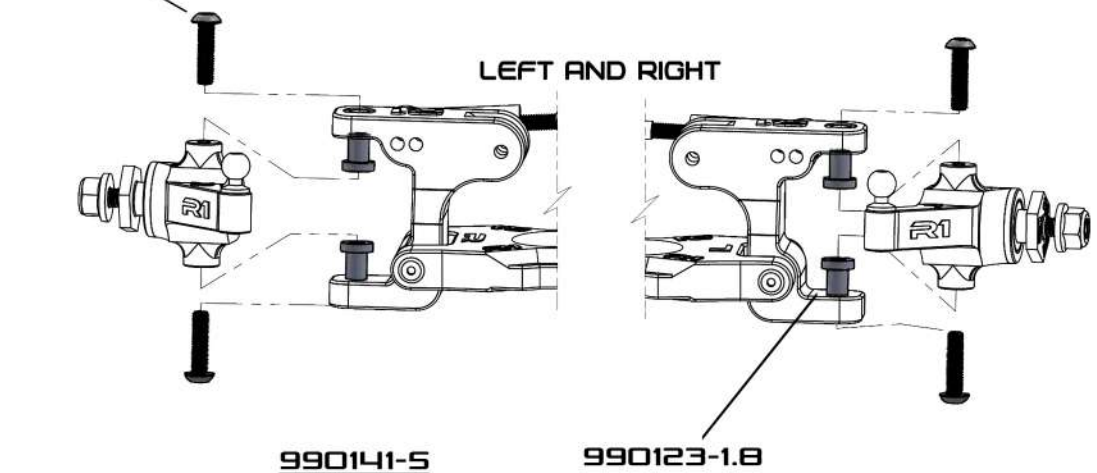
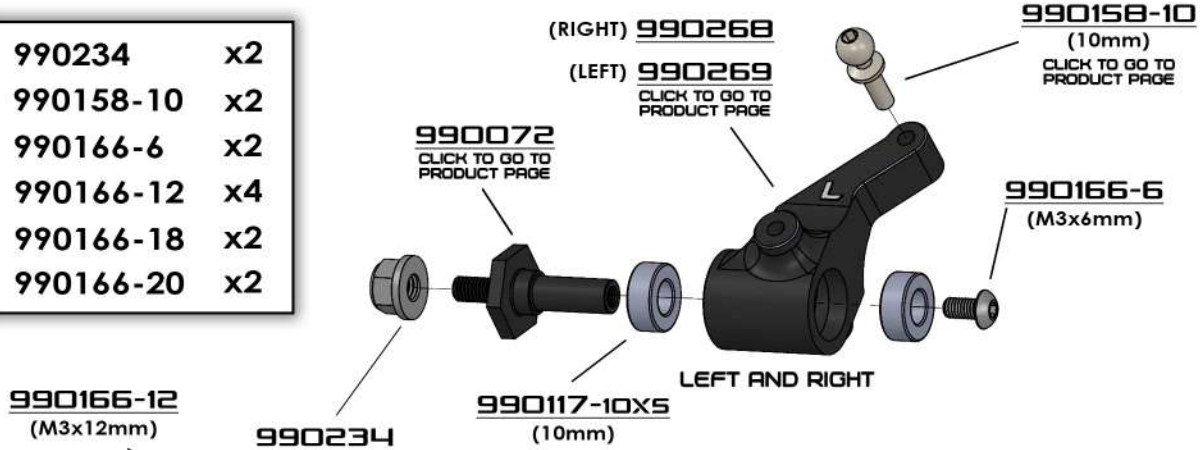

\*CLICK THE PART NUMBER TO OPEN THE PRODUCT PAGE

\*PRODUCT AND DESCRIPTION SUBJECT TO CHANGE WITHOUT NOTICE

"HOW TO BUILD"



CLICK HERE



R1WORKS DC1

# FRONT BODY MOUNT SHORT TOWER STEP 5

990166-8	x2
990163-8	x2
990136-12x8	x2
990129	x2

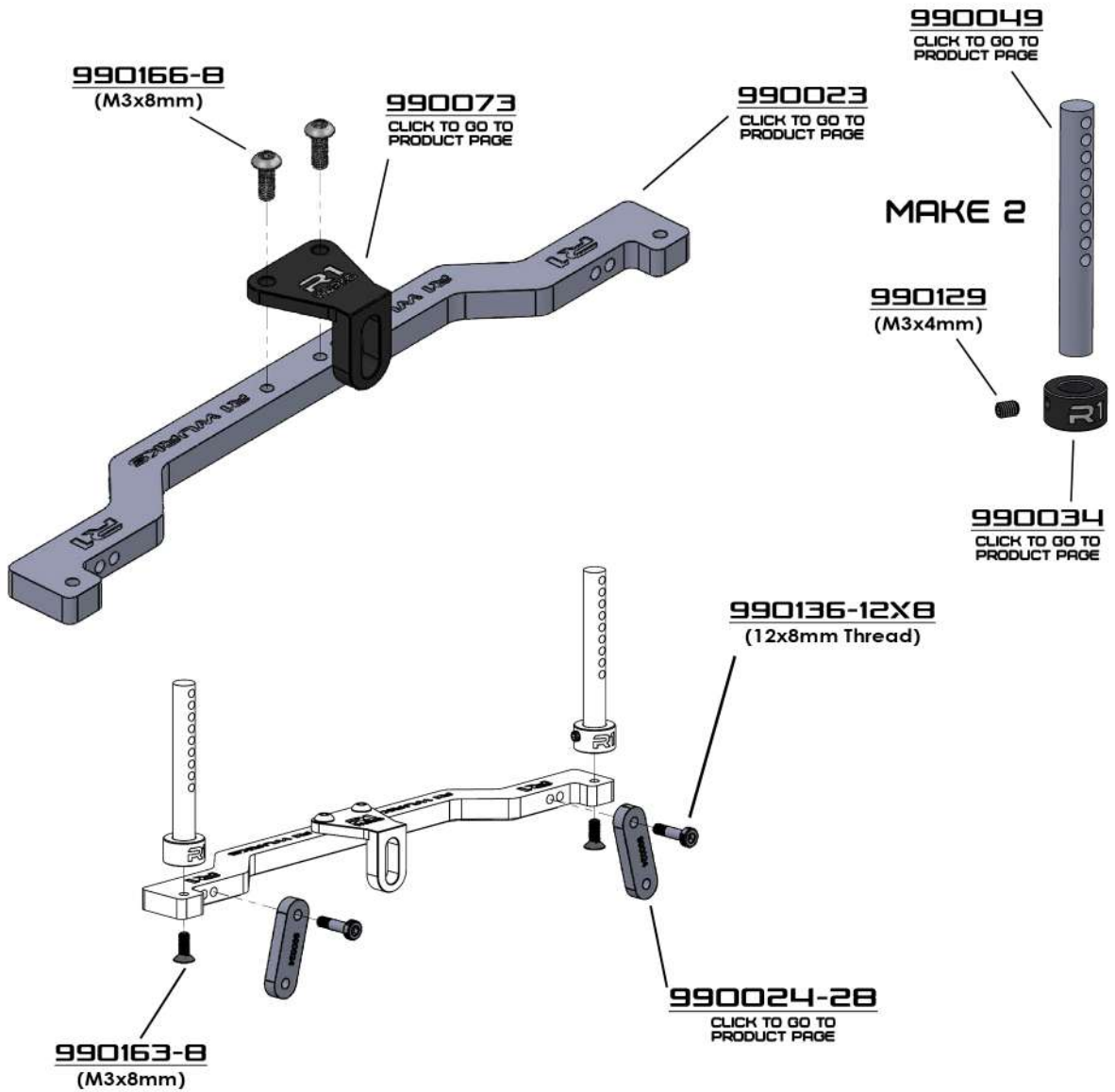

\*CLICK THE PART NUMBER TO OPEN  
THE PRODUCT PAGE

\*PRODUCT AND DESCRIPTION  
SUBJECT TO CHANGE  
WITHOUT NOTICE

"HOW TO  
BUILD"



CLICK HERE



# FRONT BODY MOUNT SHORT TOWER STEP 6

990136-12x4 x2

990126-ST  
CLICK TO GO TO  
PRODUCT PAGE

990127-ST  
CLICK TO GO TO  
PRODUCT PAGE

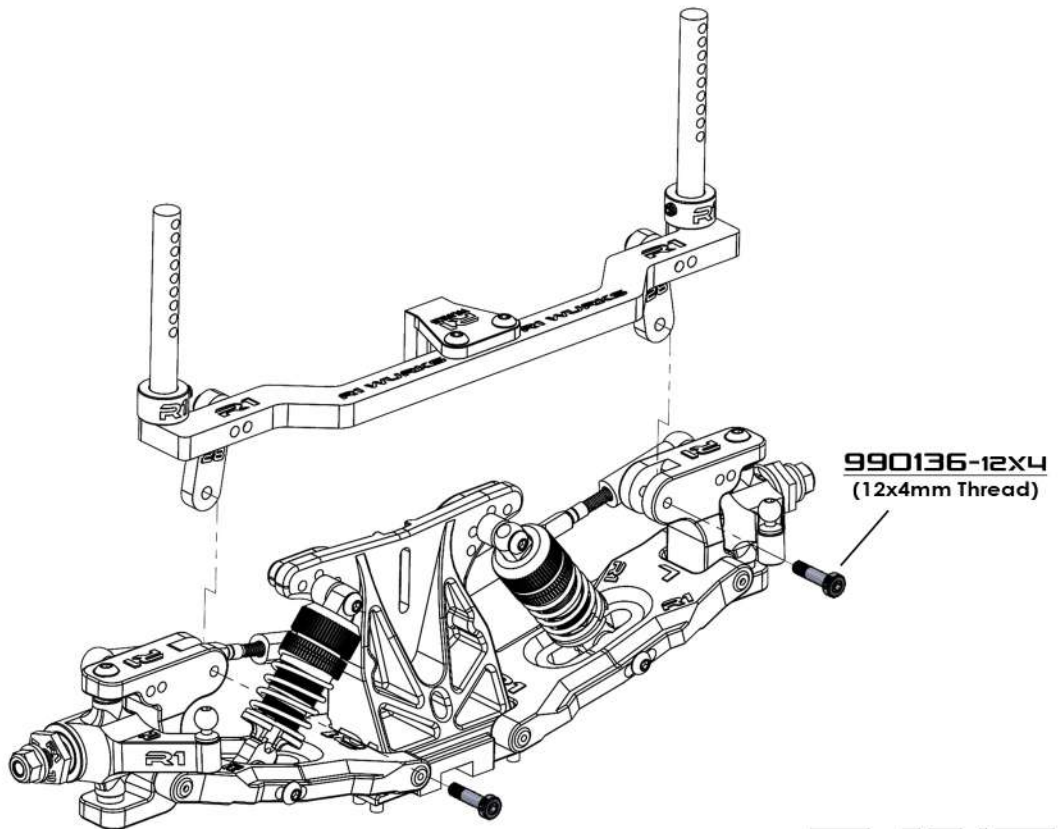
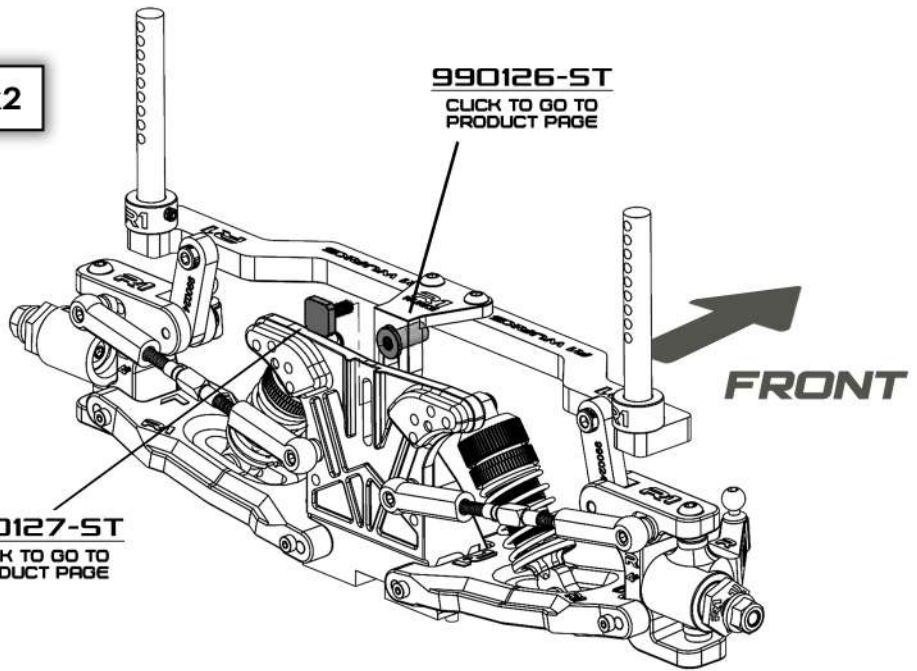

\*CLICK THE PART NUMBER TO OPEN  
THE PRODUCT PAGE

\*PRODUCT AND DESCRIPTION  
SUBJECT TO CHANGE  
WITHOUT NOTICE

"HOW TO  
BUILD"



CLICK HERE



# REAR HUB ASSEMBLY STEP 1

990120	x10
990116-25	x4
990158-6	x2
990118	x4

## MAKE 2

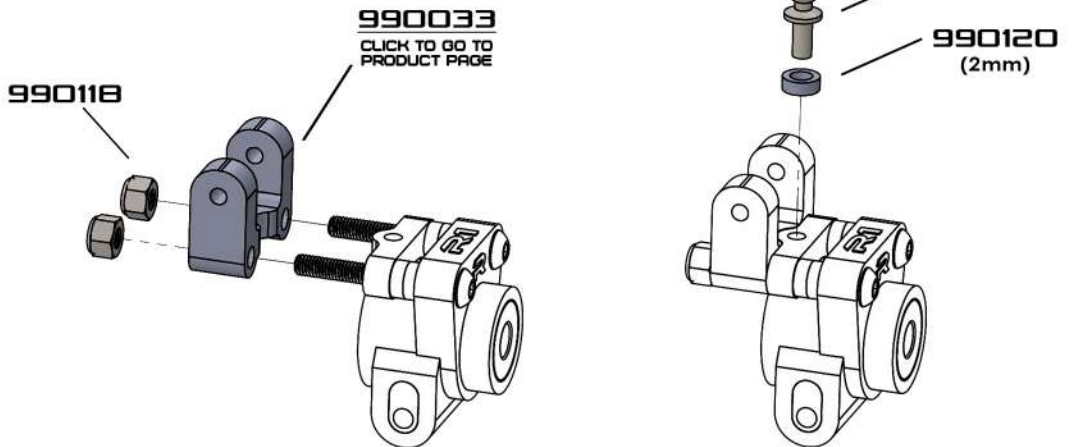
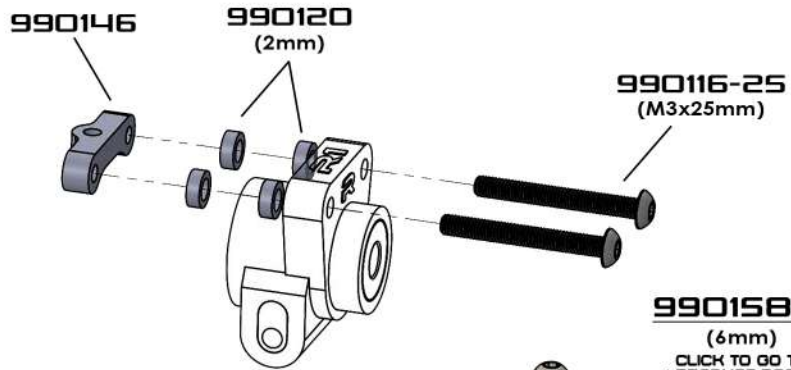
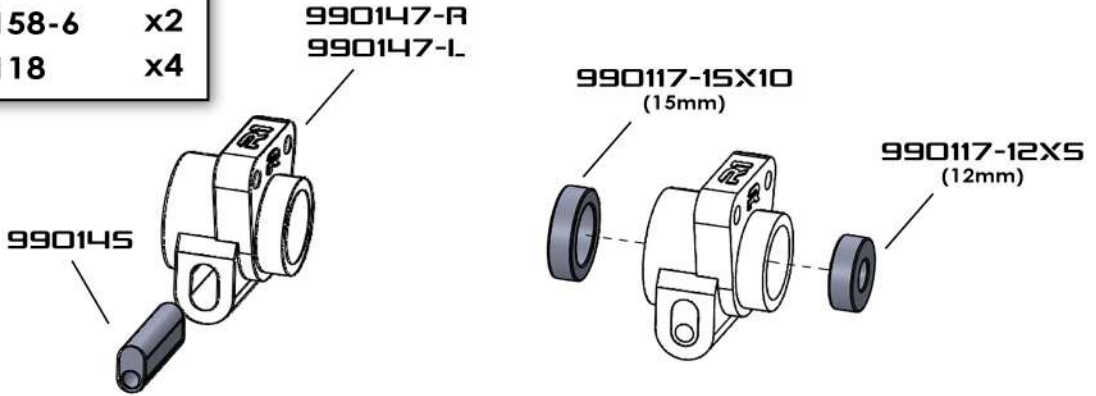

\*CLICK THE PART NUMBER TO OPEN  
THE PRODUCT PAGE

\*PRODUCT AND DESCRIPTION  
SUBJECT TO CHANGE  
WITHOUT NOTICE

"HOW TO  
BUILD"



CLICK HERE



# REAR HUB ASSEMBLY STEP 2

990152	x2
990150	x2
990234	x2

## MAKE 2

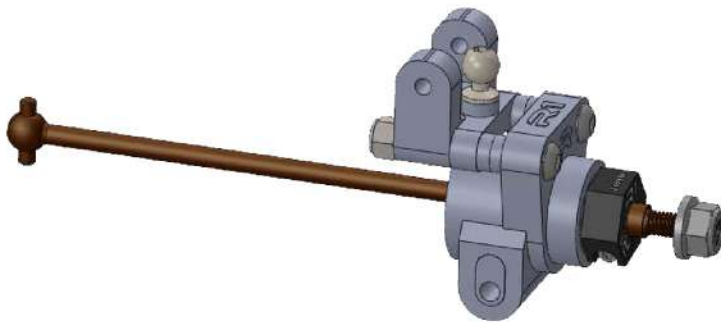
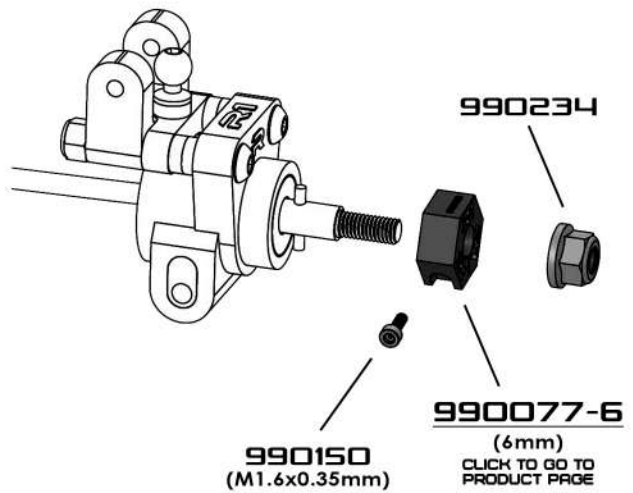
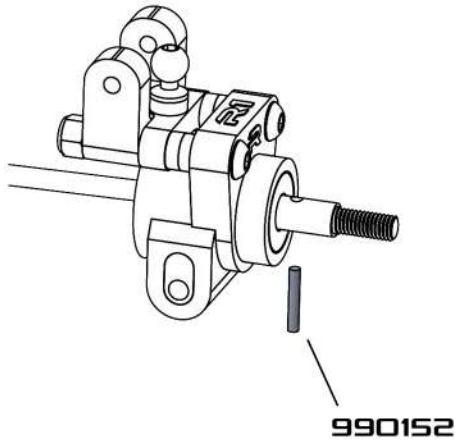

\*CLICK THE PART NUMBER TO OPEN  
THE PRODUCT PAGE

\*PRODUCT AND DESCRIPTION  
SUBJECT TO CHANGE  
WITHOUT NOTICE

"HOW TO  
BUILD"



CLICK HERE



# GEAR DIFFERENTIAL ASSEMBLY STEP 1

R1WORKS DC1

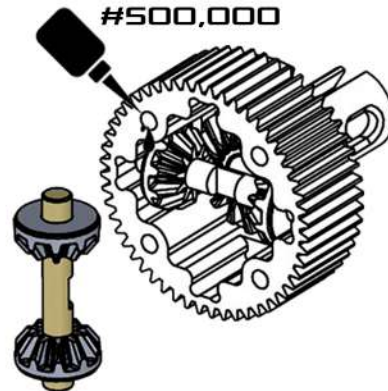
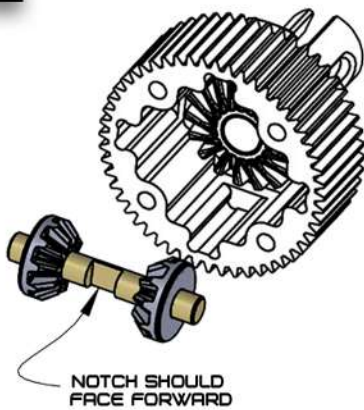
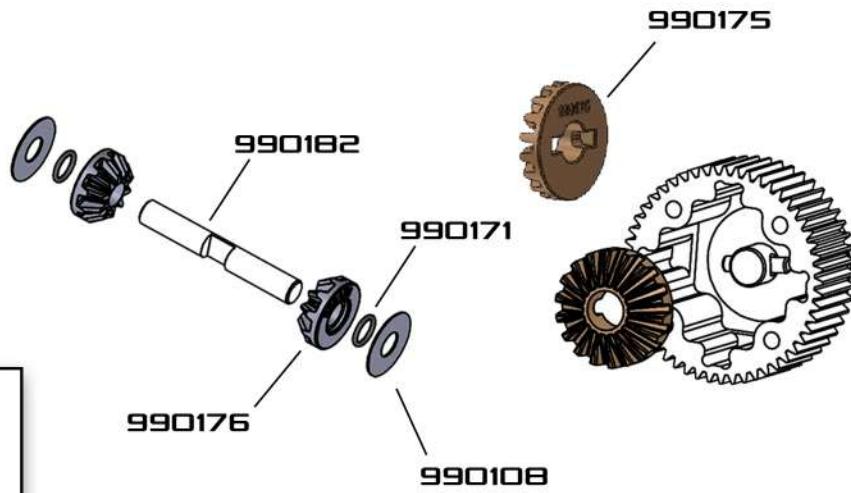
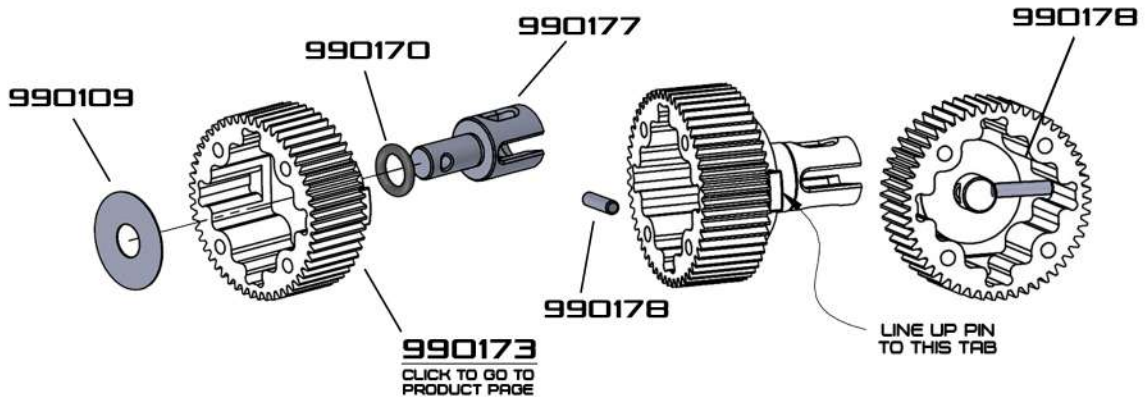

\*CLICK THE PART NUMBER TO OPEN  
THE PRODUCT PAGE

\*PRODUCT AND DESCRIPTION  
SUBJECT TO CHANGE  
WITHOUT NOTICE

"HOW TO  
BUILD"



CLICK HERE



# GEAR DIFFERENTIAL ASSEMBLY STEP 2

R1WORKS DC1

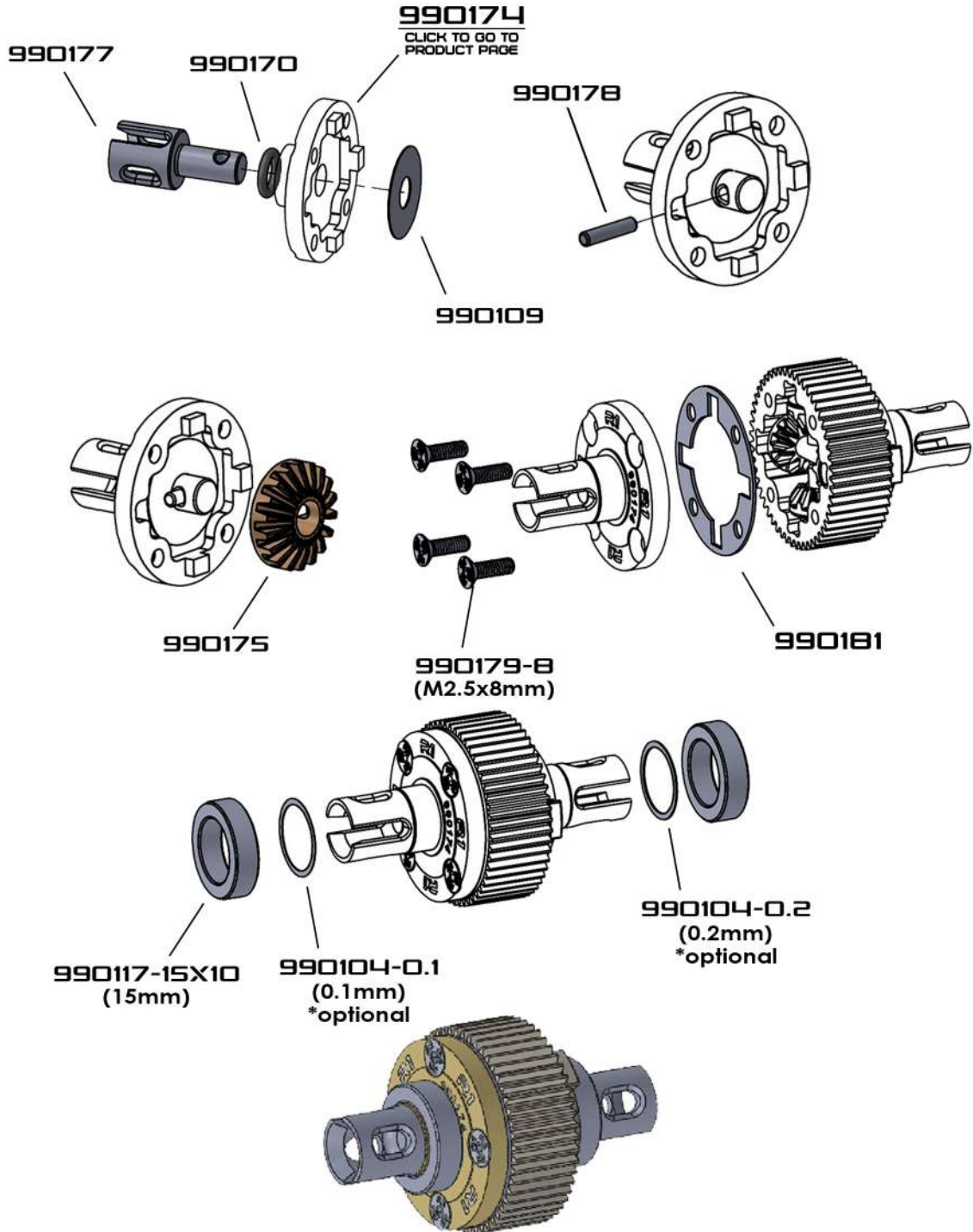

\*CLICK THE PART NUMBER TO OPEN  
THE PRODUCT PAGE

\*PRODUCT AND DESCRIPTION  
SUBJECT TO CHANGE  
WITHOUT NOTICE

"HOW TO  
BUILD"



CLICK HERE



# STAND-UP TRANSMISSION ASSEMBLY STEP 1

**990096 (LAYDOWN)**

**990097 (STANDUP)**

CLICK TO GO TO  
PRODUCT PAGE

**990117-10X5  
(10mm)**

**990117-10X5  
(10mm)**

**990095**

CLICK TO GO TO  
PRODUCT PAGE

**990098 (STANDUP)**

CLICK TO GO TO  
PRODUCT PAGE

**990214 (LAYDOWN)**

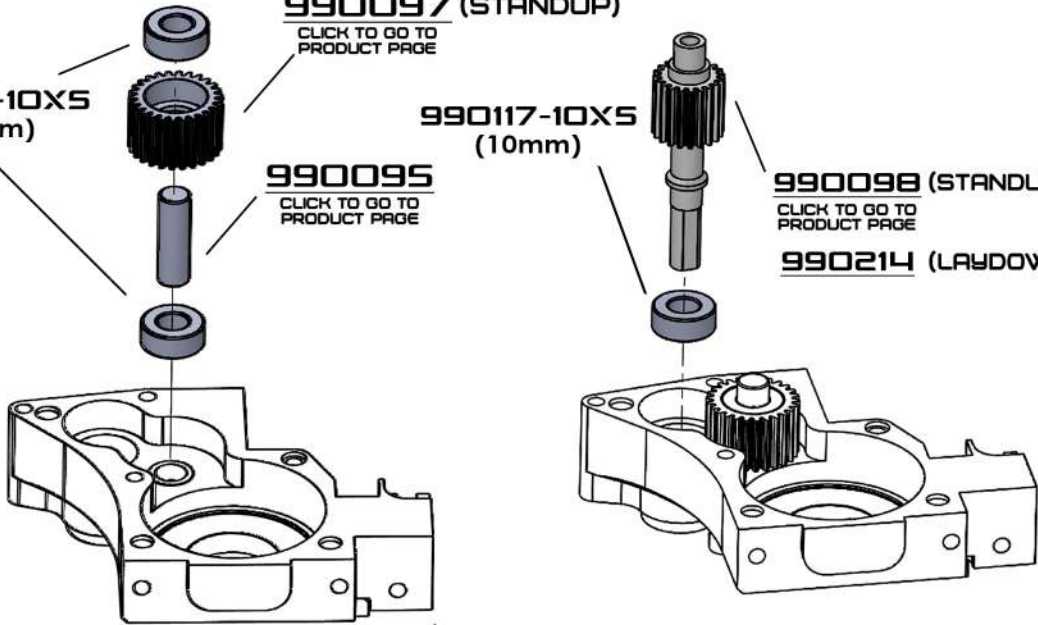

**990208**

CLICK TO GO TO  
PRODUCT PAGE

**990117-10X5  
(10mm)**

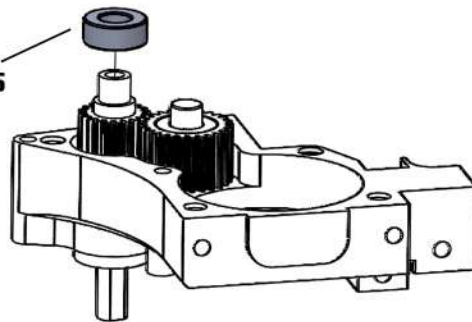

\*CLICK THE PART NUMBER TO OPEN  
THE PRODUCT PAGE

\*PRODUCT AND DESCRIPTION  
SUBJECT TO CHANGE  
WITHOUT NOTICE

**"HOW TO  
BUILD"**



**CLICK HERE**





# STAND-UP TRANSMISSION ASSEMBLY STEP 2

990166-18 x4  
990166-5 x3



990166-18 (M3x18mm) \*Use 3 pcs for laydown transmission

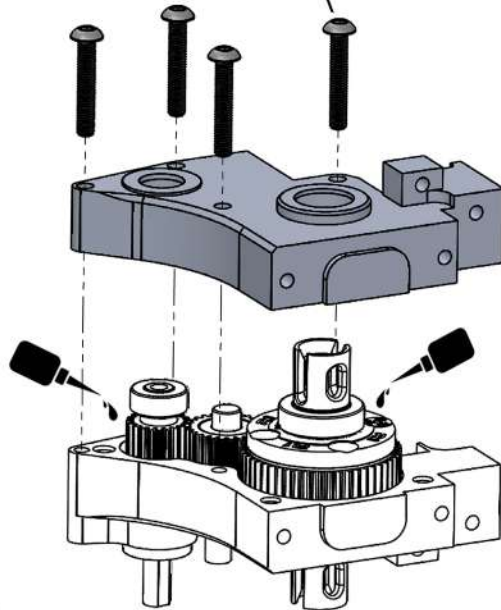
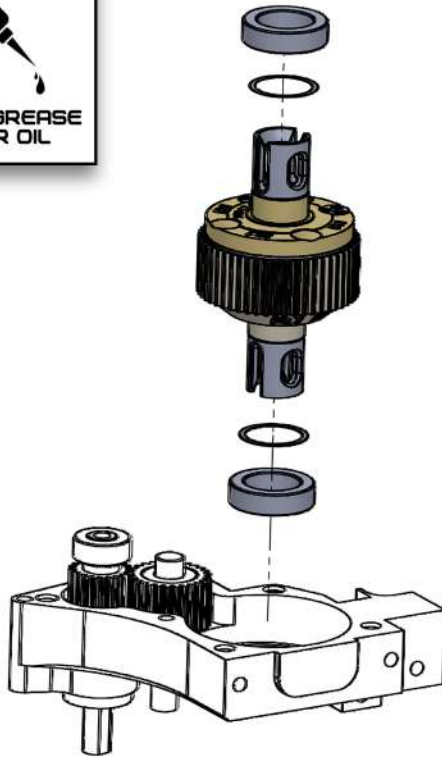

990209  
CLICK TO GO TO  
PRODUCT PAGE

990184  
CLICK TO GO TO  
PRODUCT PAGE

990116  
CLICK TO GO TO  
PRODUCT PAGE

990166-5 (M3x5mm)

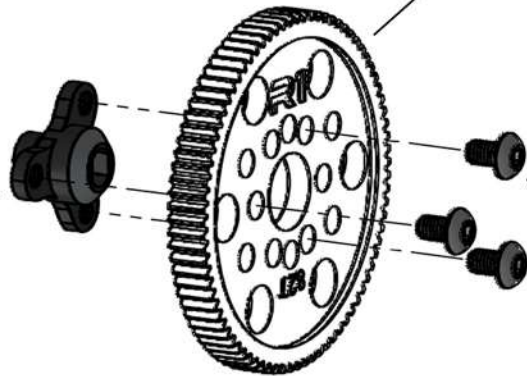

"HOW TO  
BUILD"



CLICK HERE



\*CLICK THE PART NUMBER TO OPEN  
THE PRODUCT PAGE

\*PRODUCT AND DESCRIPTION  
SUBJECT TO CHANGE  
WITHOUT NOTICE

# STAND-UP TRANSMISSION ASSEMBLY STEP 3

990163-8	x3
990213	x1
990166-14	x2
990118	x1

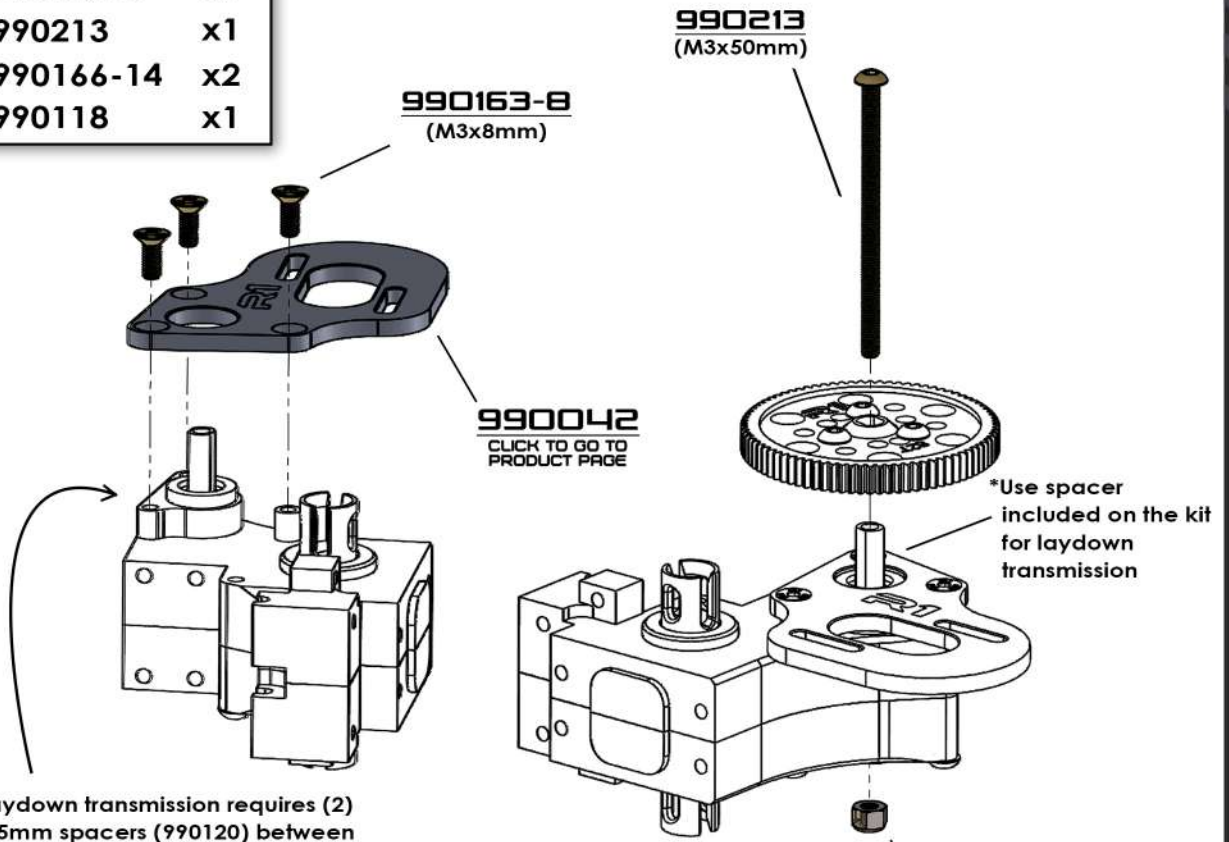

- \* Laydown transmission requires (2) 1.5mm spacers (990120) between plate and case
- \* Use (2) M3x10mm button head screws for the remaining threads on the laydown transmission case

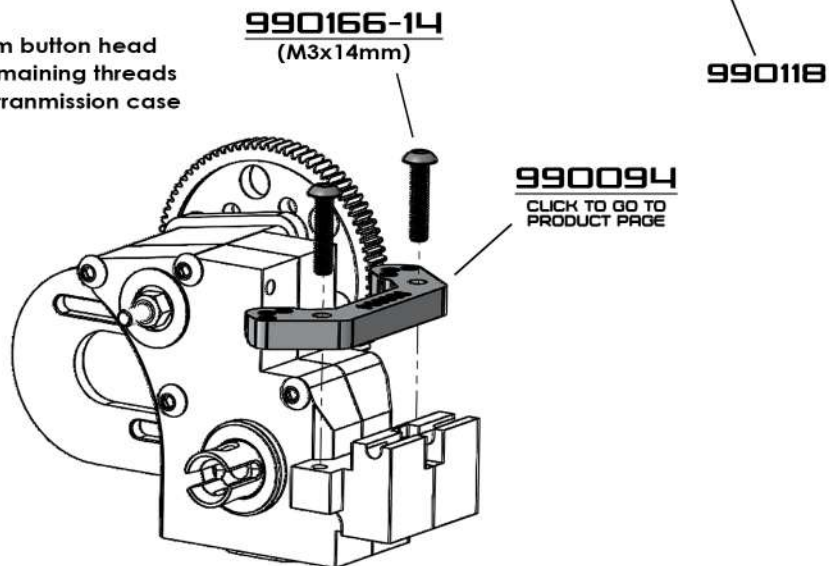

\*CLICK THE PART NUMBER TO OPEN  
THE PRODUCT PAGE

\*PRODUCT AND DESCRIPTION  
SUBJECT TO CHANGE  
WITHOUT NOTICE

"HOW TO  
BUILD"



CLICK HERE



# REAR BODY MOUNT SHORT TOWER STEP 1

990163-8 x8

990163-8  
(M3x8mm)

990006  
CLICK TO GO TO  
PRODUCT PAGE

990038  
CLICK TO GO TO  
PRODUCT PAGE

990037  
CLICK TO GO TO  
PRODUCT PAGE

990047-8  
CLICK TO GO TO  
PRODUCT PAGE

990130

990130

990163-8  
(m3x8mm)

FRONT

\*CLICK THE PART NUMBER TO OPEN  
THE PRODUCT PAGE

\*PRODUCT AND DESCRIPTION  
SUBJECT TO CHANGE  
WITHOUT NOTICE

"HOW TO  
BUILD"



CLICK HERE



REAR BODY MOUNT SHORT TOWER  
STEP 2

990136-14x4 X2

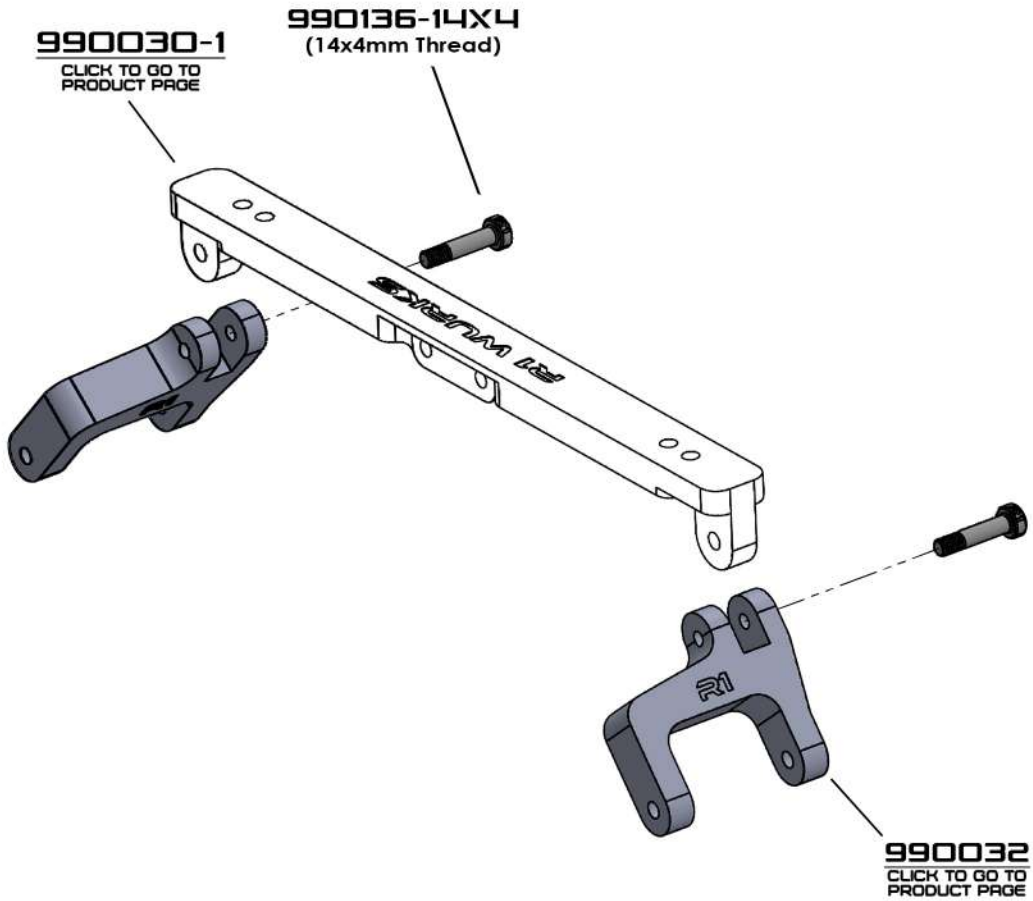

\*CLICK THE PART NUMBER TO OPEN  
THE PRODUCT PAGE

\*PRODUCT AND DESCRIPTION  
SUBJECT TO CHANGE  
WITHOUT NOTICE

"HOW TO  
BUILD"



CLICK HERE



# REAR BODY MOUNT SHORT TOWER STEP 3

- 990136-35x6 x4
- 990163-8 x4
- 990120-2 x4

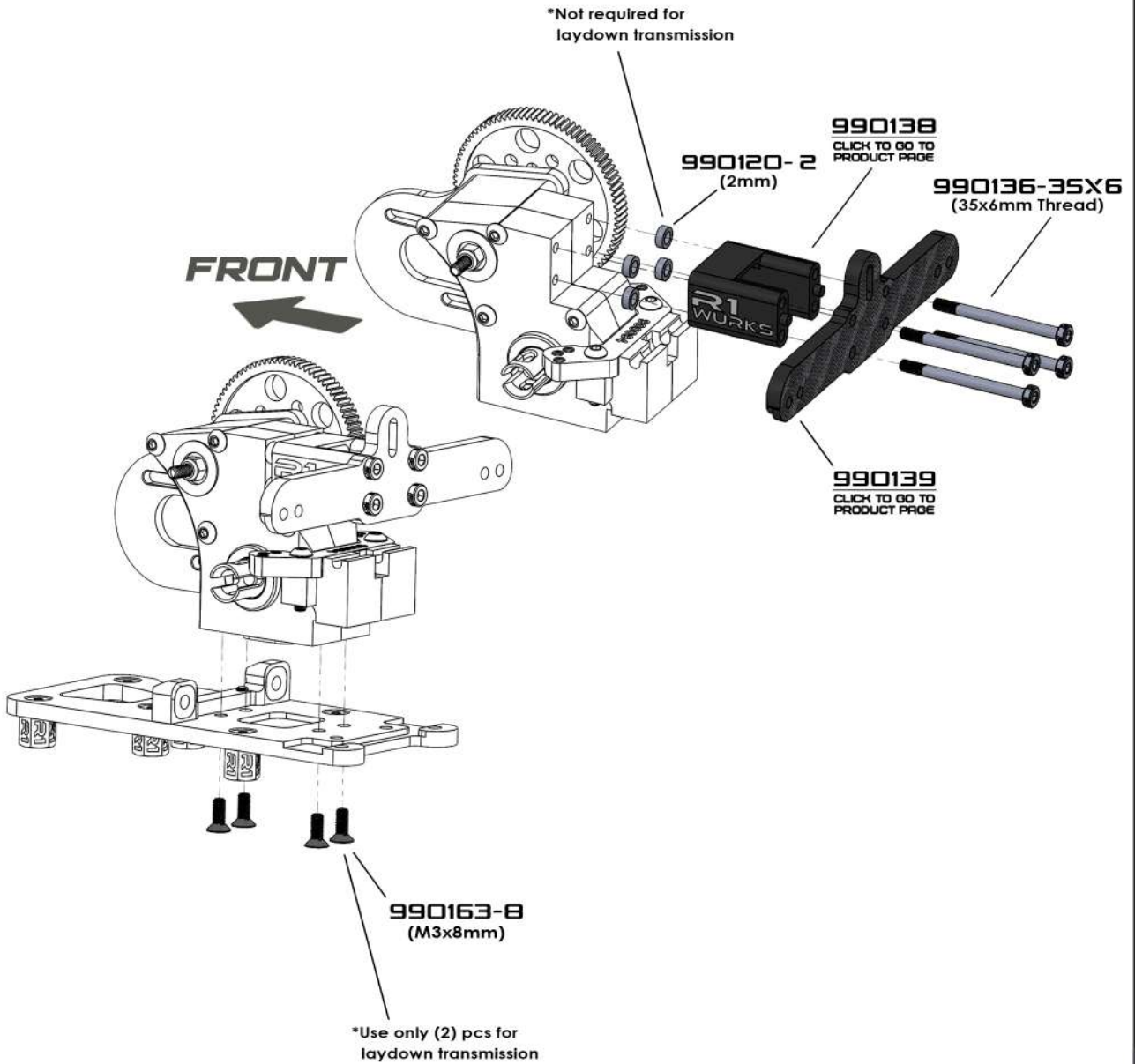

\*CLICK THE PART NUMBER TO OPEN THE PRODUCT PAGE

\*PRODUCT AND DESCRIPTION SUBJECT TO CHANGE WITHOUT NOTICE

"HOW TO BUILD"



CLICK HERE



# REAR BODY MOUNT SHORT TOWER STEP 4

R1WORKS DC1

990136-10x5	x4
990058	x2
990166-12	x4
990120-2	x4
990118	x2

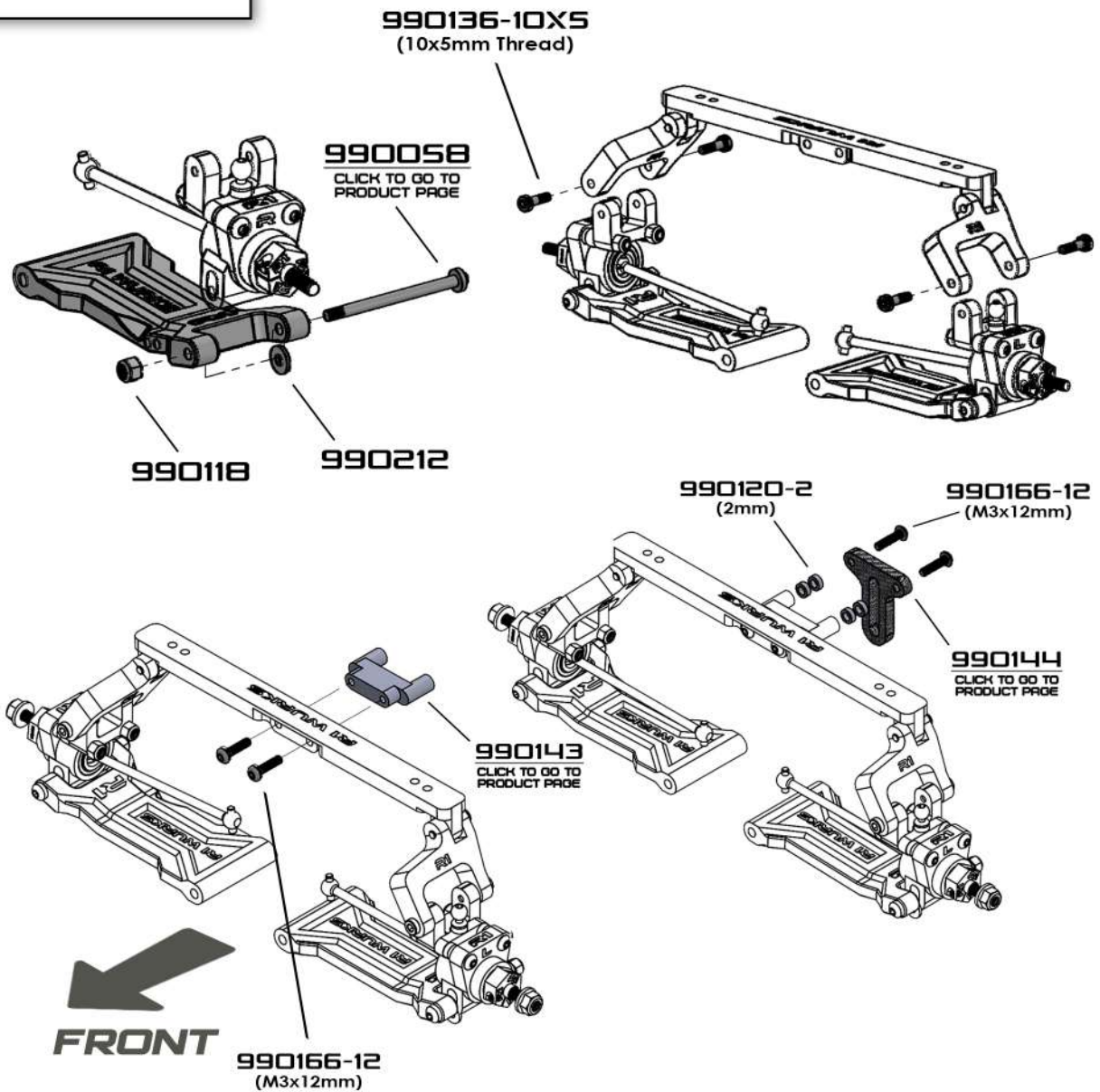

\*CLICK THE PART NUMBER TO OPEN THE PRODUCT PAGE

\*PRODUCT AND DESCRIPTION SUBJECT TO CHANGE WITHOUT NOTICE

"HOW TO BUILD"



CLICK HERE



# REAR BODY MOUNT SHORT TOWER STEP 5

990163-20 x2  
990216-2mm x2

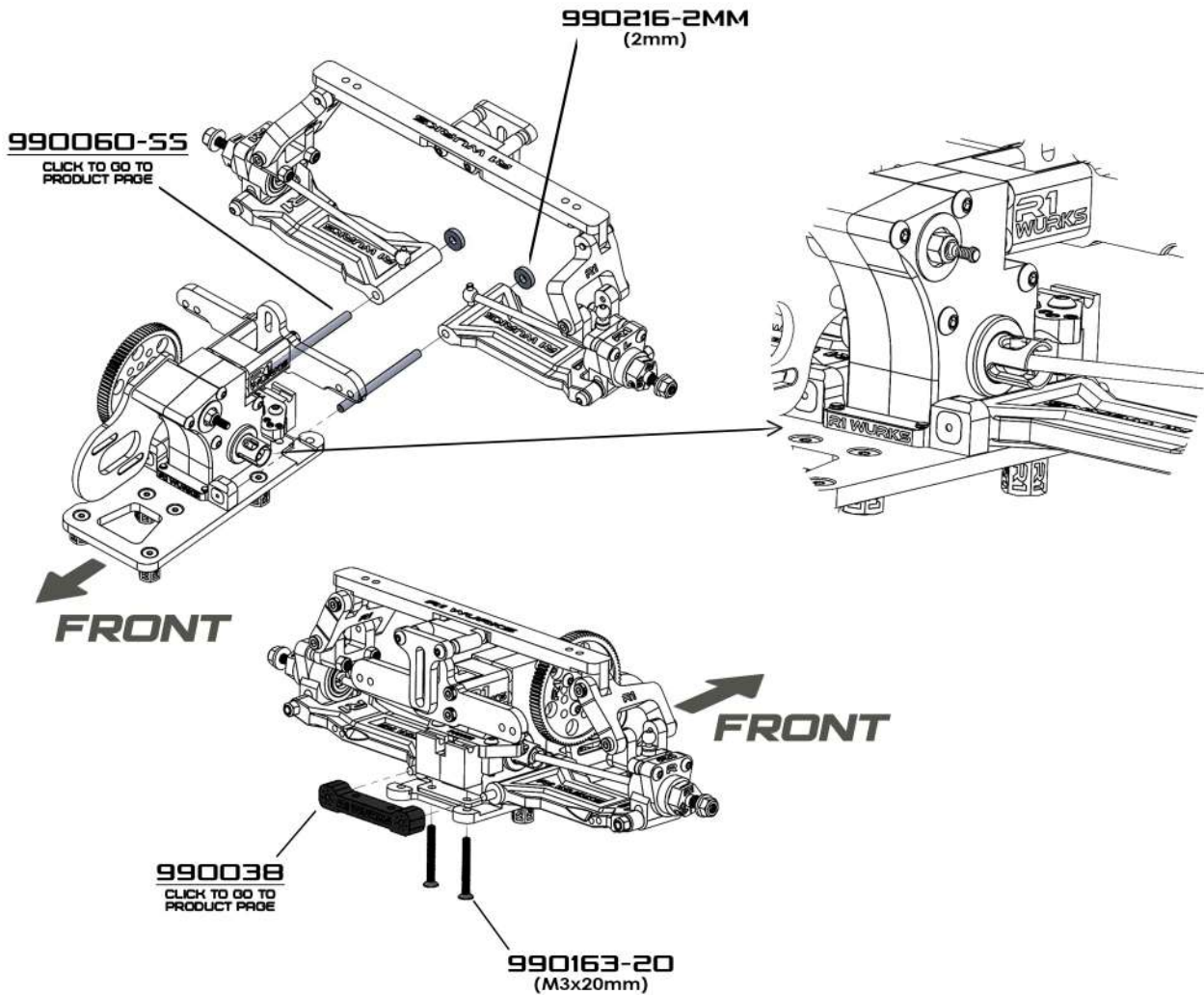

\*CLICK THE PART NUMBER TO OPEN  
THE PRODUCT PAGE

\*PRODUCT AND DESCRIPTION  
SUBJECT TO CHANGE  
WITHOUT NOTICE

"HOW TO  
BUILD"



CLICK HERE



# REAR BODY MOUNT SHORT TOWER STEP 6

- |          |    |
|----------|----|
| 990166-8 | x2 |
| 990120   | x2 |
| 990158-6 | x2 |

**990047-8**  
CLICK TO GO TO  
PRODUCT PAGE

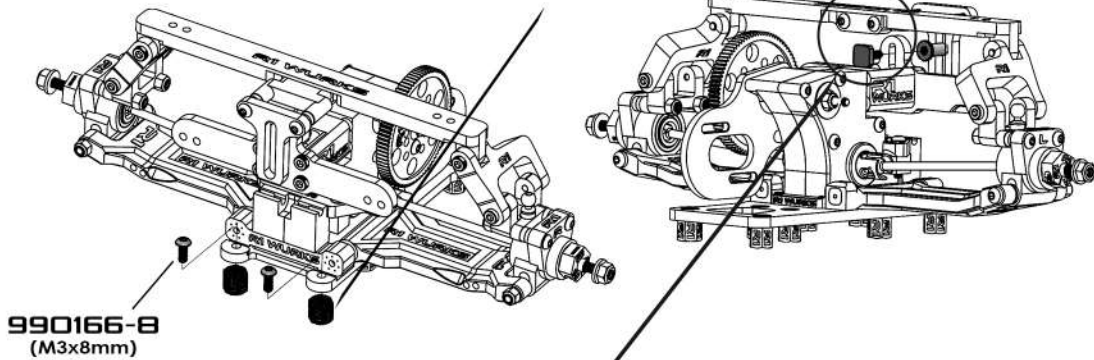

**990166-8**  
(M3x8mm)

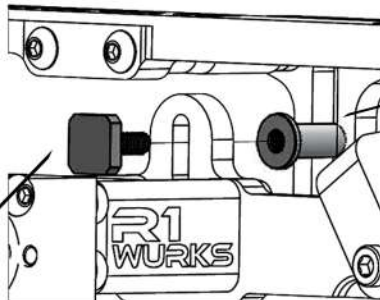
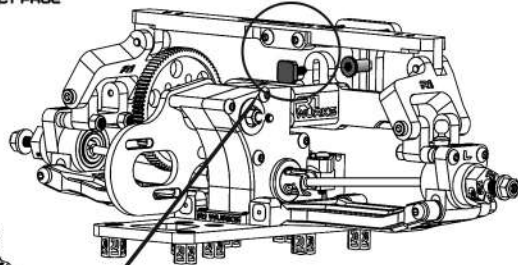

**990127-ST**

**990126-ST**

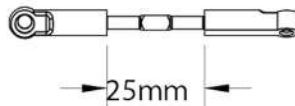

25mm

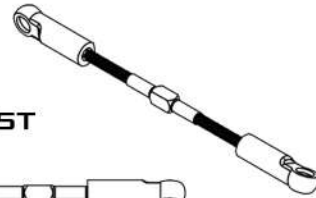

**990233-58-V1**  
CLICK TO GO TO  
PRODUCT PAGE

**990158-6**  
(6mm)  
CLICK TO GO TO  
PRODUCT PAGE

**990120**  
(2mm)

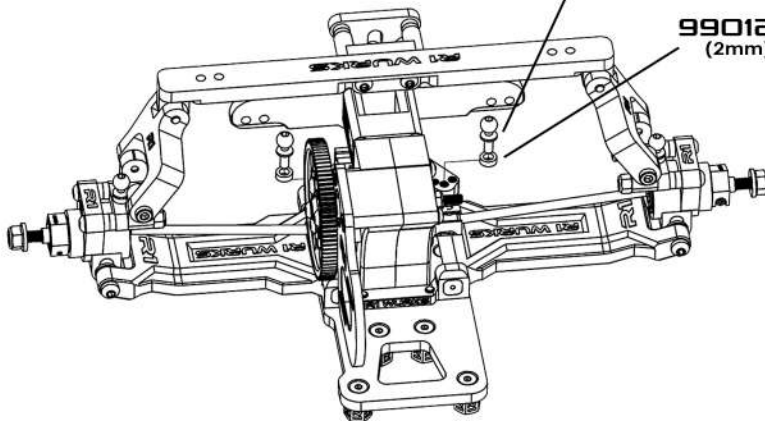

\*CLICK THE PART NUMBER TO OPEN  
THE PRODUCT PAGE

\*PRODUCT AND DESCRIPTION  
SUBJECT TO CHANGE  
WITHOUT NOTICE

"HOW TO  
BUILD"



CLICK HERE





# REAR BODY MOUNT SHORT TOWER STEP 7

- |           |    |
|-----------|----|
| 990166-18 | x2 |
| 990140    | x2 |
| 990134    | x2 |
| 990118    | x4 |

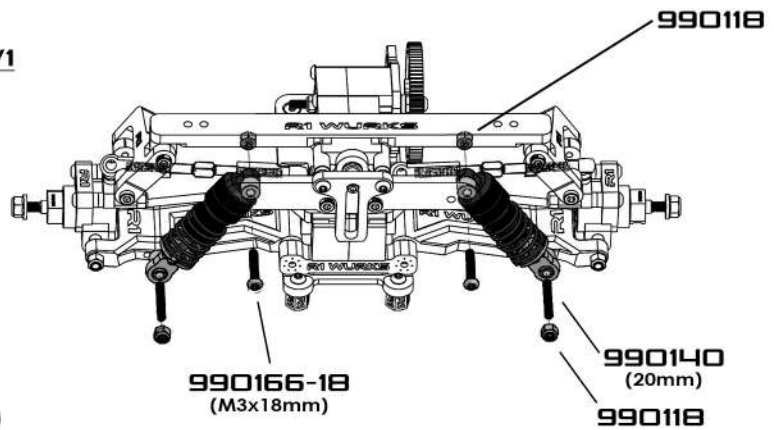
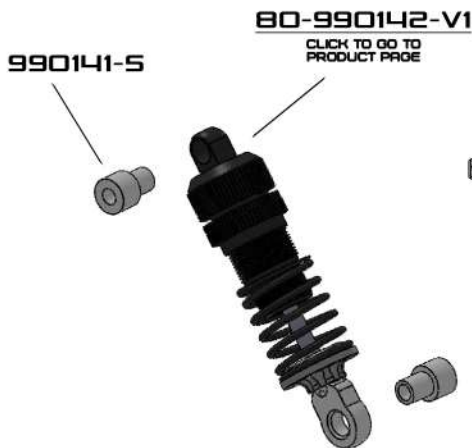
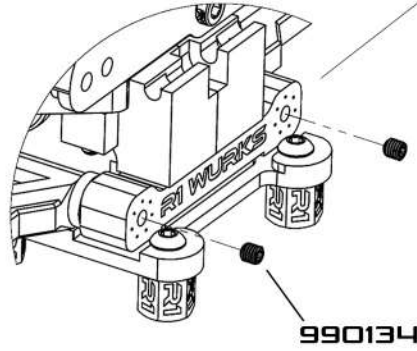
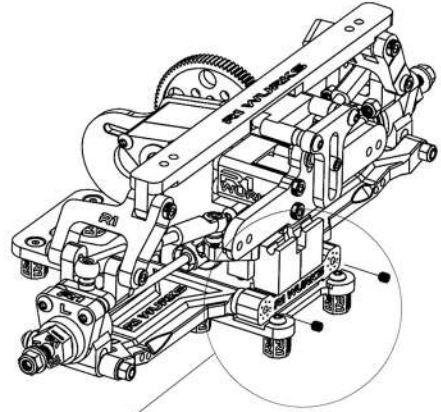
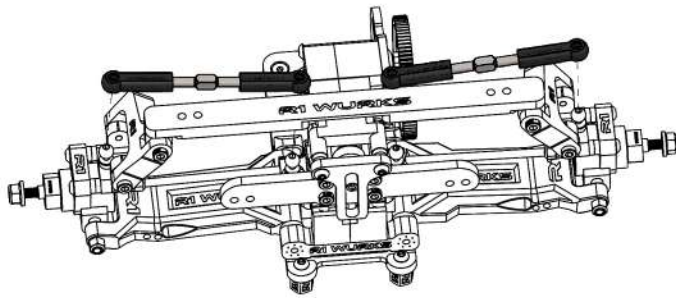

\*CLICK THE PART NUMBER TO OPEN  
THE PRODUCT PAGE

\*PRODUCT AND DESCRIPTION  
SUBJECT TO CHANGE  
WITHOUT NOTICE

"HOW TO  
BUILD"



CLICK HERE



# REAR BODY MOUNT SHORT TOWER STEP 8

990163-8	x2
990129	x2

990049  
CLICK TO GO TO  
PRODUCT PAGE

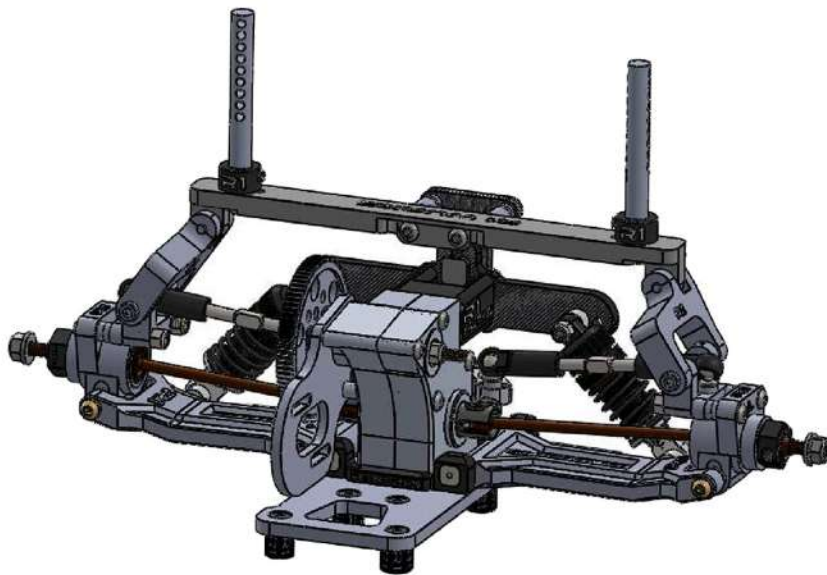
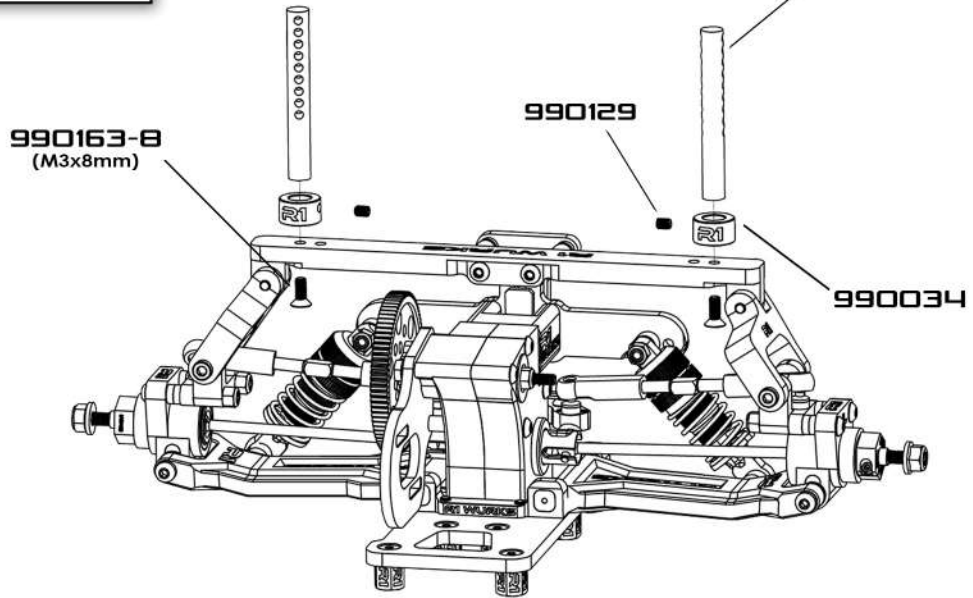

\*CLICK THE PART NUMBER TO OPEN  
THE PRODUCT PAGE

\*PRODUCT AND DESCRIPTION  
SUBJECT TO CHANGE  
WITHOUT NOTICE

"HOW TO  
BUILD"



CLICK HERE



# WHEELIE BAR ASSEMBLY

990163-8	x4
990217	x4
990165	x1

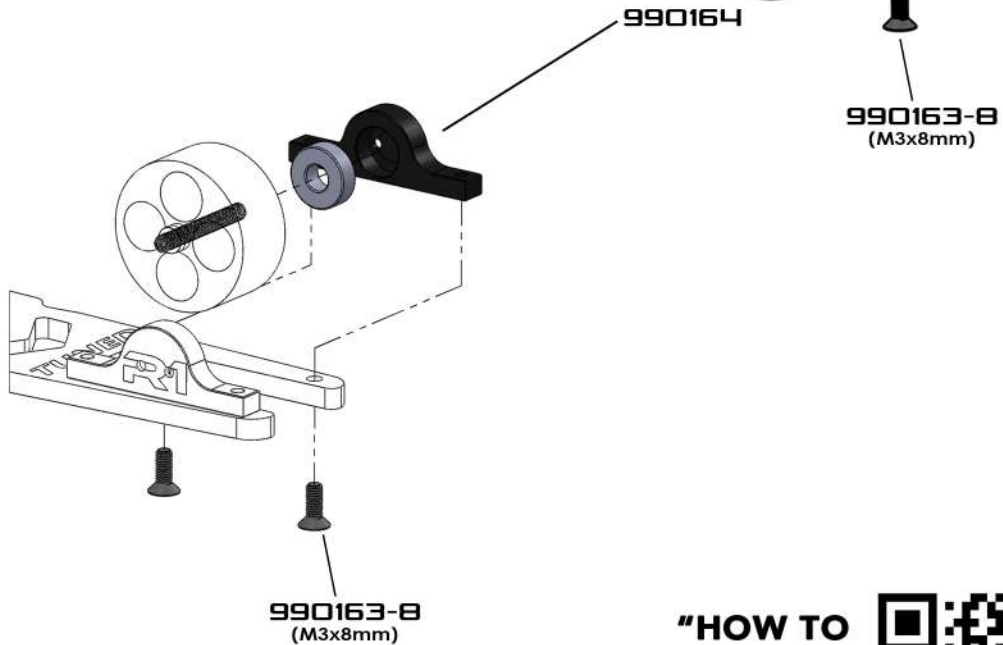
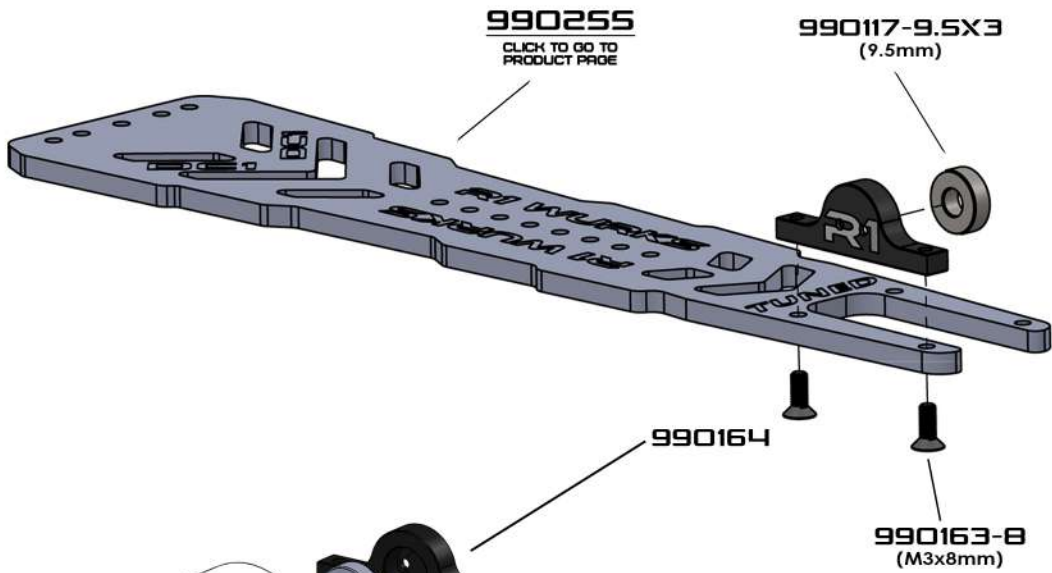
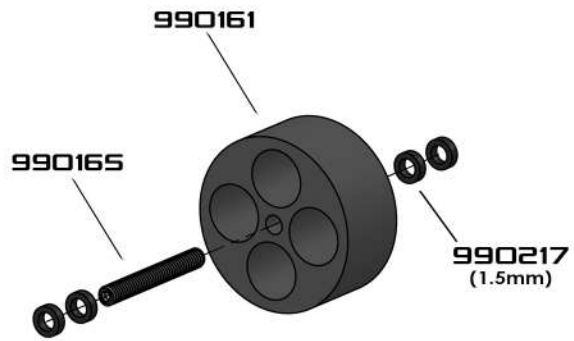

\*CLICK THE PART NUMBER TO OPEN  
THE PRODUCT PAGE

\*PRODUCT AND DESCRIPTION  
SUBJECT TO CHANGE  
WITHOUT NOTICE

"HOW TO  
BUILD"



CLICK HERE



# DC1 ASSEMBLY STEP 1

990163-10 x8

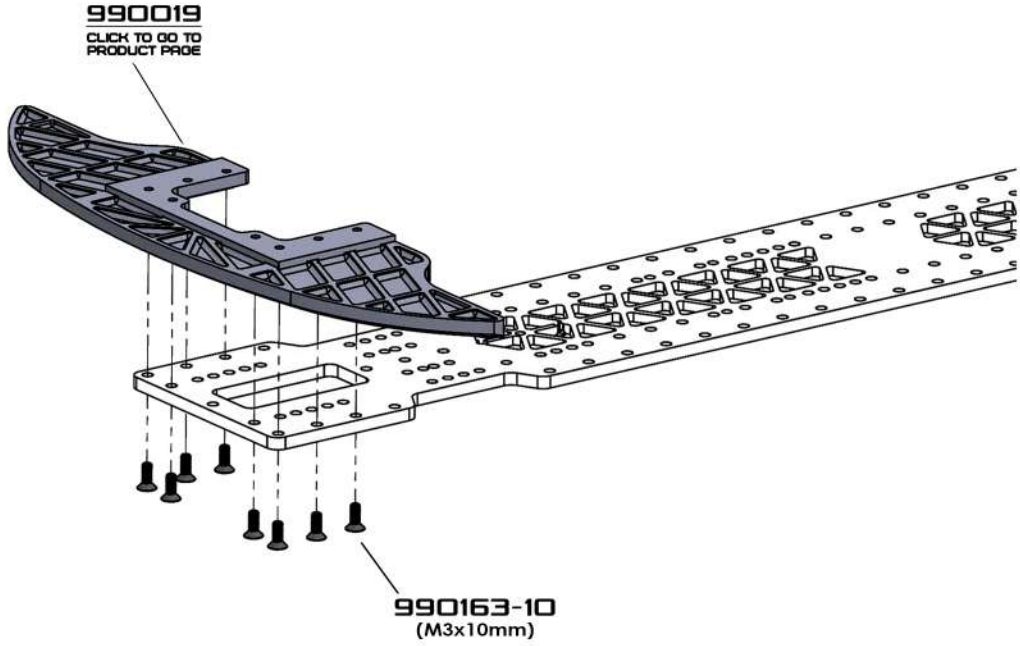

**990019**  
CLICK TO GO TO  
PRODUCT PAGE

**990163-10**  
(M3x10mm)

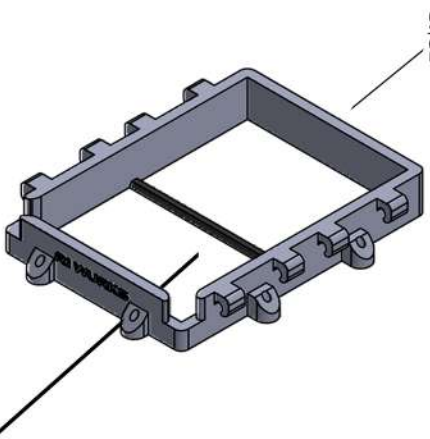

**990156**  
CLICK TO GO TO  
PRODUCT PAGE

'CUT AWAY

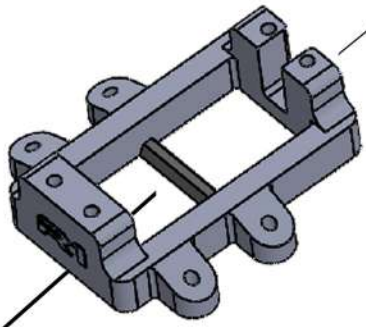

**990008**  
CLICK TO GO TO  
PRODUCT PAGE

'CUT AWAY

'CLICK THE PART NUMBER TO OPEN  
THE PRODUCT PAGE

'PRODUCT AND DESCRIPTION  
SUBJECT TO CHANGE  
WITHOUT NOTICE

"HOW TO  
BUILD"



CLICK HERE



# DC1 ASSEMBLY STEP 2

990163-10 x8  
990166-8 x4

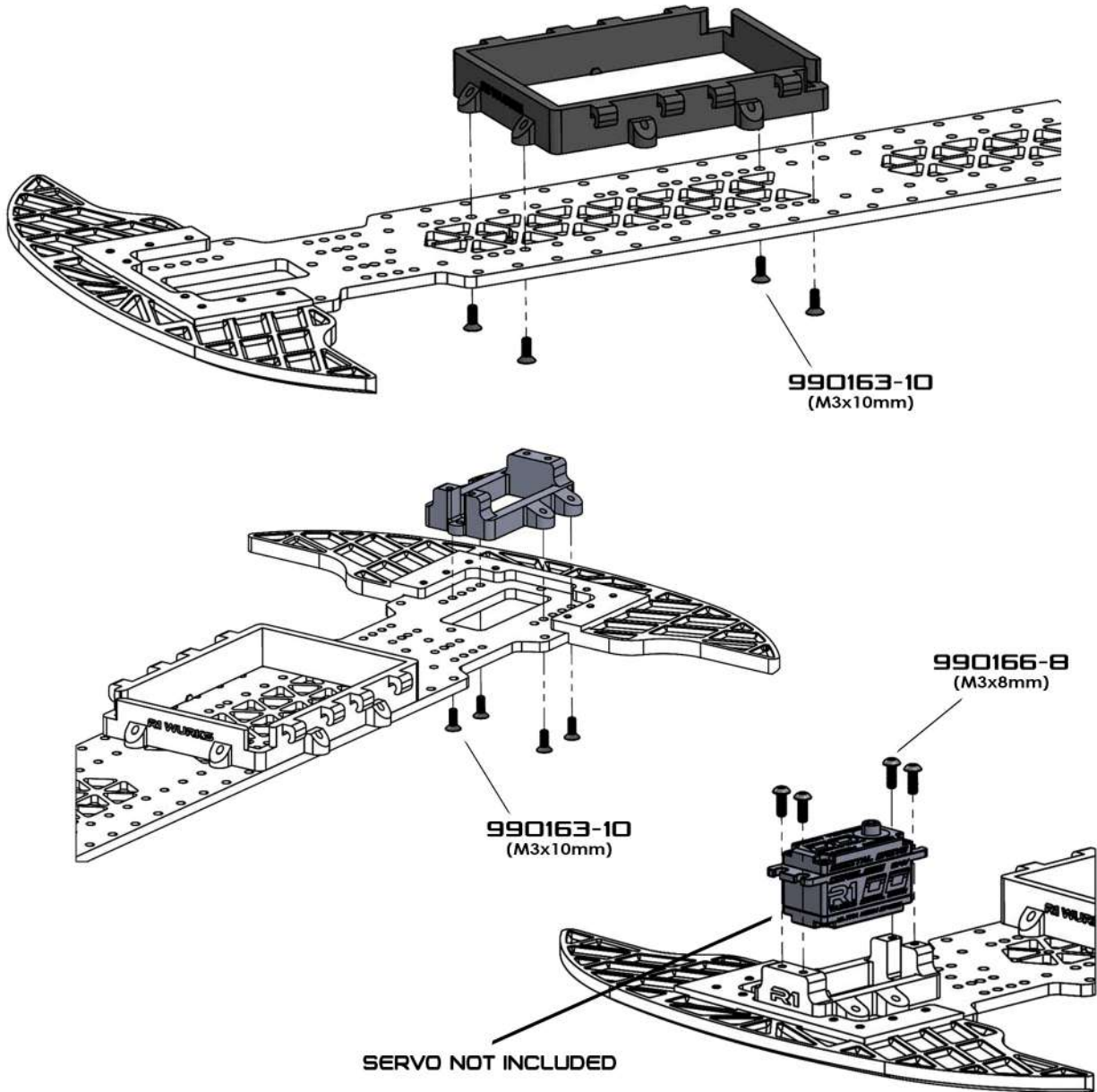

\*CLICK THE PART NUMBER TO OPEN  
THE PRODUCT PAGE

\*PRODUCT AND DESCRIPTION  
SUBJECT TO CHANGE  
WITHOUT NOTICE

"HOW TO  
BUILD"



CLICK HERE



# DC1 ASSEMBLY STEP 3

990163-8	x4
990166-5	x1
990158-4	x2

**990036**  
CLICK TO GO TO  
PRODUCT PAGE

**990048-V1**  
CLICK TO GO TO  
PRODUCT PAGE

**990158-4**  
(4mm)  
CLICK TO GO TO  
PRODUCT PAGE

**990166-5**  
(M3x5mm)

**990163-8**  
(M3x8mm)

38mm

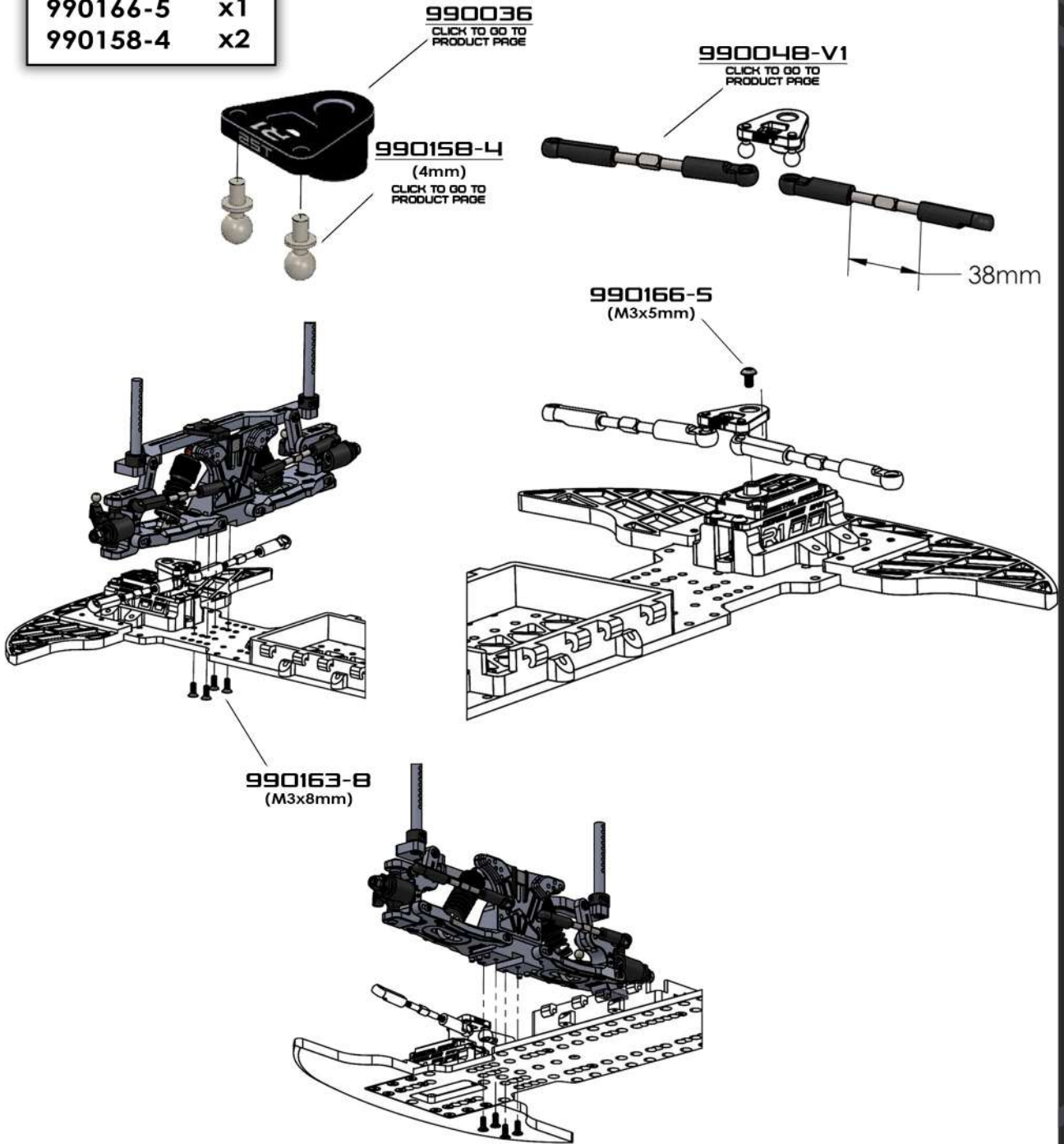

\*CLICK THE PART NUMBER TO OPEN  
THE PRODUCT PAGE

\*PRODUCT AND DESCRIPTION  
SUBJECT TO CHANGE  
WITHOUT NOTICE

"HOW TO  
BUILD"



CLICK HERE



R1WORKS DC1

DC1 ASSEMBLY  
STEP 4

R1 WURKS DC1

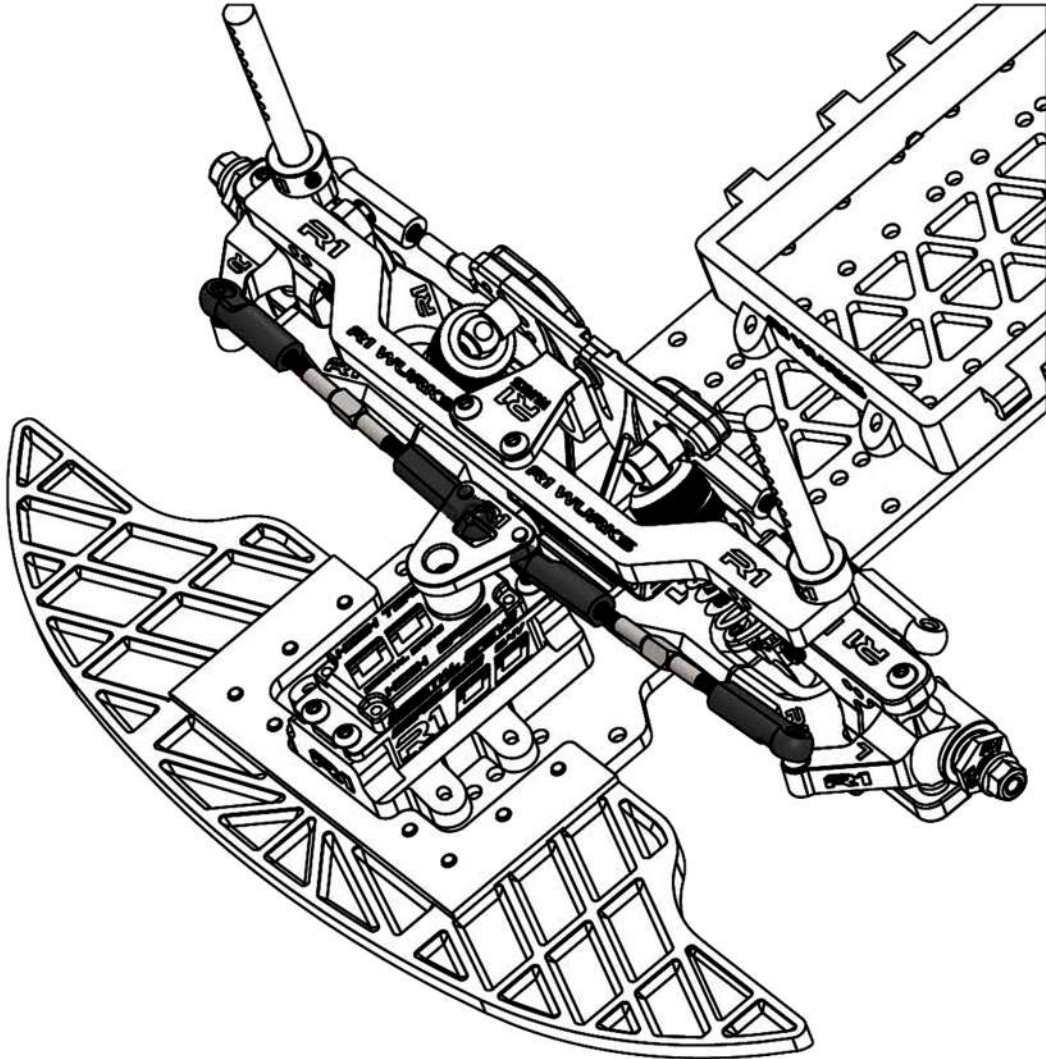

\*CLICK THE PART NUMBER TO OPEN  
THE PRODUCT PAGE

\*PRODUCT AND DESCRIPTION  
SUBJECT TO CHANGE  
WITHOUT NOTICE

"HOW TO  
BUILD"



CLICK HERE



# DC1 ASSEMBLY STEP 5

- |           |    |
|-----------|----|
| 990163-8  | x8 |
| 990163-14 | x5 |
| 990118    | x5 |

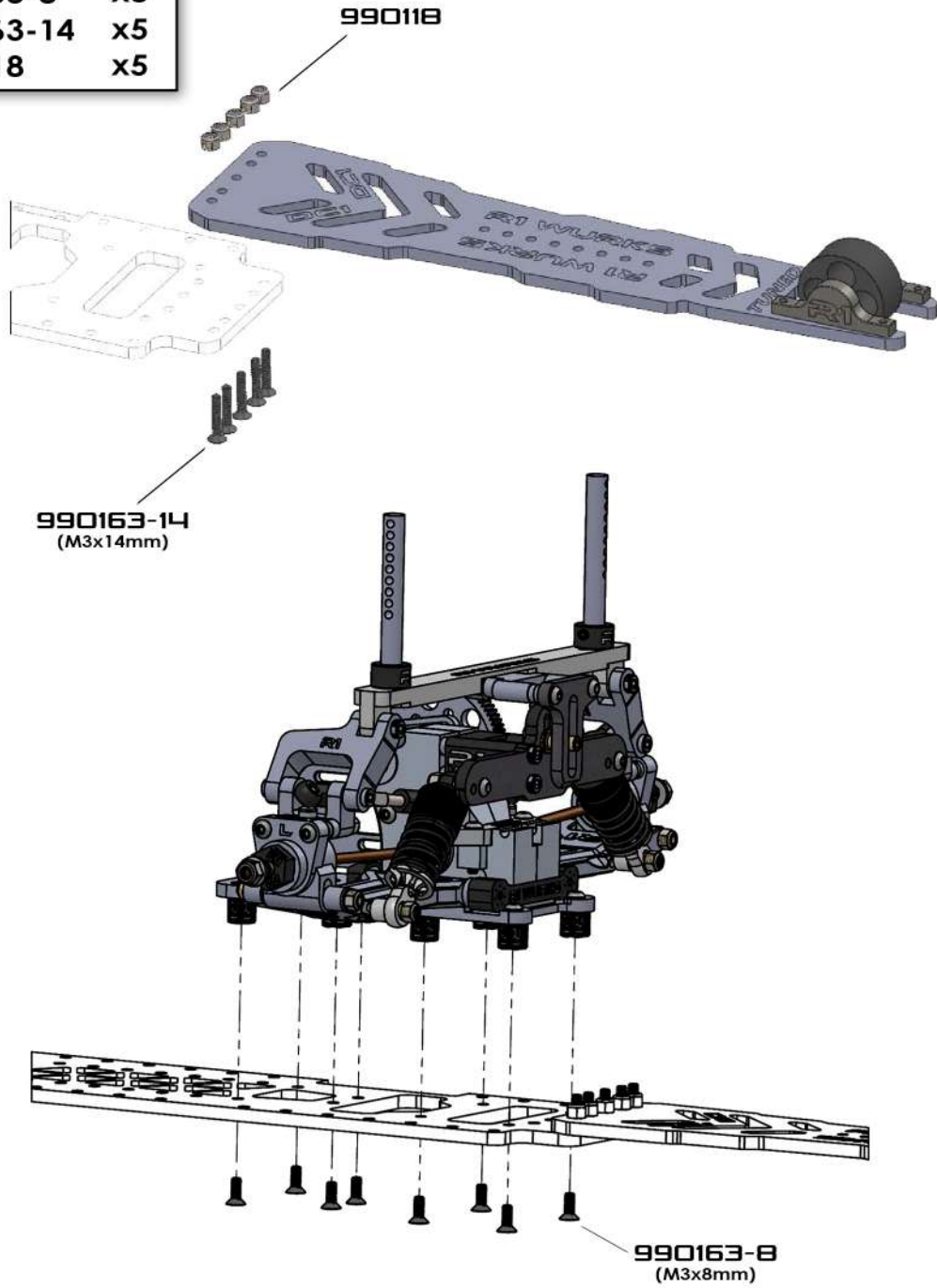

\*CLICK THE PART NUMBER TO OPEN  
THE PRODUCT PAGE

\*PRODUCT AND DESCRIPTION  
SUBJECT TO CHANGE  
WITHOUT NOTICE

"HOW TO  
BUILD"



CLICK HERE





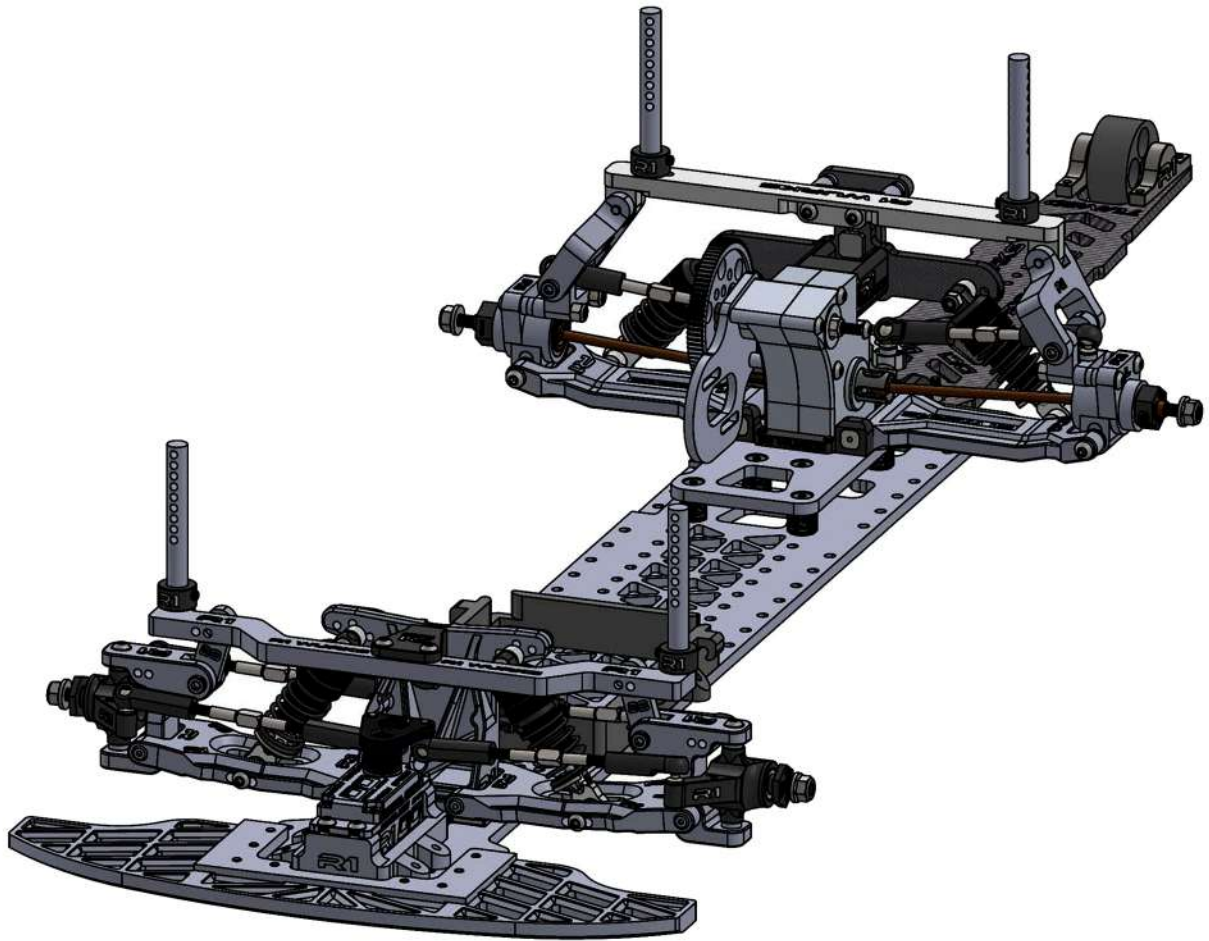

\*CLICK THE PART NUMBER TO OPEN  
THE PRODUCT PAGE

\*PRODUCT AND DESCRIPTION  
SUBJECT TO CHANGE  
WITHOUT NOTICE