



HOW TO HANG A HORIZONTAL MOUNT FOR A FLAT SCREEN TV

Note:

These instructions are for a horizontal flat screen TV mount



GETTING STARTED

- A. Follow the installation instructions and recommendations provided by the TV mount's manufacturer.
- B. With a pencil, mark on the wall where you want the top and center of the TV mount to be.
- C. Determine which holes on the TV mount you will be using to install the wall hardware.

STEP 1

- A. Place TV mount face down on a flat surface.
- B. Position the crossbar against the top of the TV mount and align arms with the holes to be used with the wall hardware.
- C. Align the center mark of the crossbar with the center of the TV mount.

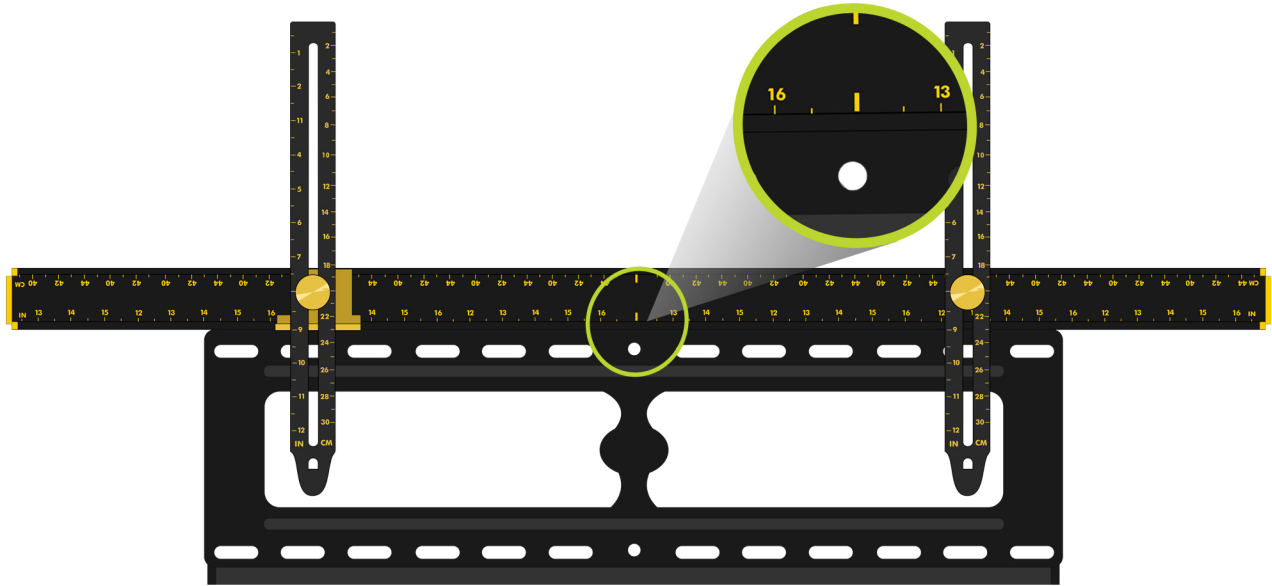

STEP 2

- A. Slide arms up till hook catches holes.
- B. Tighten knobs to secure arms in place.

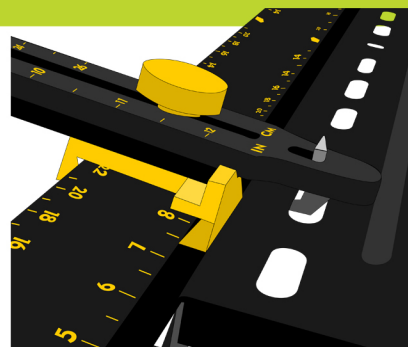

STEP 3

- A. Remove Hang It Perfect from frame.
- B. Place Hang It Perfect with knobs against the wall and level facing you.
- C. Align the center of the level with the top-center mark you made on the wall from step one.
- D. Use the level to make sure the crossbar is straight.
- E. Firmly press hooks to create dimple marks on wall.

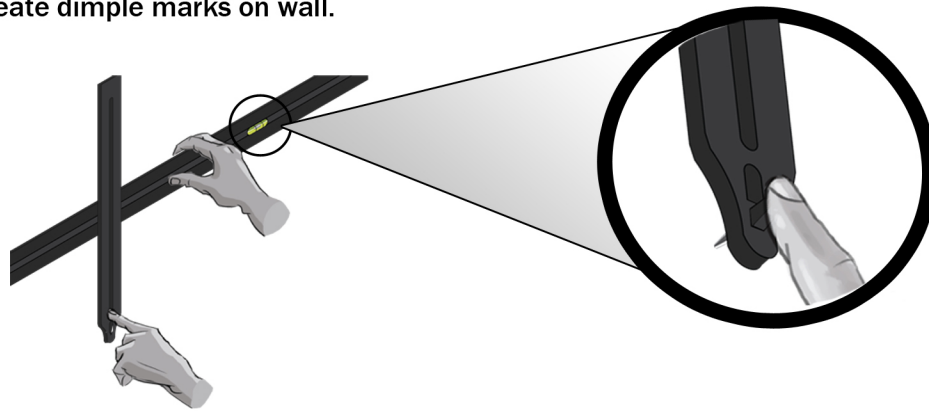

STEP 4

- A. Remove Hang It Perfect from wall.
- B. Place mount against wall. Align the holes of the TV mount to the dimple marks on wall.
- C. Install the TV mount to the wall using the wall hardware that is recommended by the TV mount manufacturer.
- D. The TV mount is now installed level to the wall! Complete the TV mounting process following the TV mount and/or TV manufacturer instructions.