

LED Canopy Light Installation Instruction

Cautions:

1. Can not use the electric generator to test the LED light.
2. Please abide by related country, regional and local law and regulations when install this fixture.
3. Please turn off the power before installation or maintenance.
4. Proper earth grounding is required to ensure safety.

Notice:

1. To avoid possibility of electrical shock or fire, the installation personnel must have professional electric knowledge.
2. Please wear gloves to avoid injury before installation.
3. If any smoke or spark of the wire happened, please turn off the power immediately and notify relevant personnel.

Attention:

1. Please check if there is any damage during shipping. If so, please contact manufacturer timely.
2. Please read the installation instruction carefully to check whether all the accessories are complete. After confirmation, then install the fixture according to installation steps.

Installation Steps:

1. Screw the aluminum pipe into the heatsink. (Figure 1)

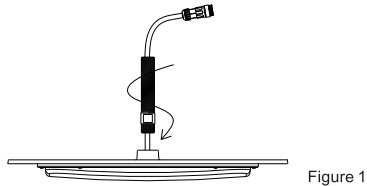

Figure 1

2. Screw the safety rope to heatsink by screwdriver. (Figure 2)

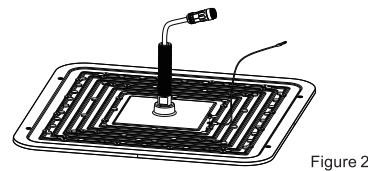

Figure 2

3. Drill the installation hole accordingly on the ceiling. (Figure 3)

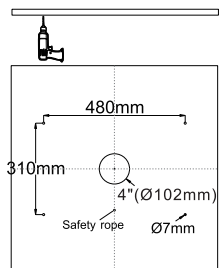

Figure 3

4. Lock the safety rope to the ceiling, assemble the installation plate to the aluminum pipe, then install led fixture. (Figure 4)

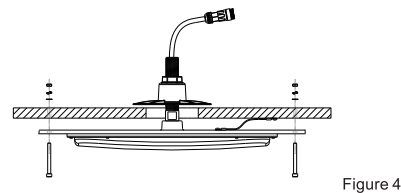

Figure 4

5. Take the driver box apart by screwdriver. (Figure 5)

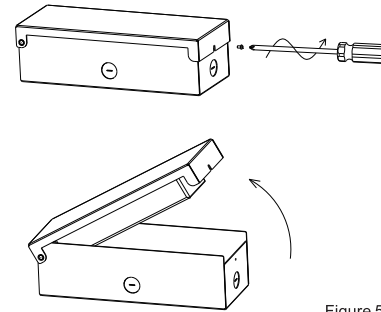

Figure 5

7. Connect the DC connector of led fixture with driver's DC connector. Remove the holes of the driver box if necessary. (Figure 7)

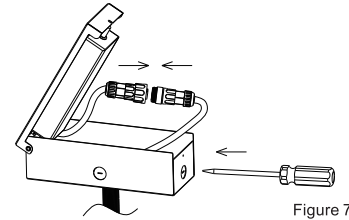

Figure 7

6. Assemble the 3/4 pipe nut to the aluminum pipe (fix the height and direction of driver box), across the DC connector through driver box, then screw the driver box onto the aluminum pipe. (Figure 6)

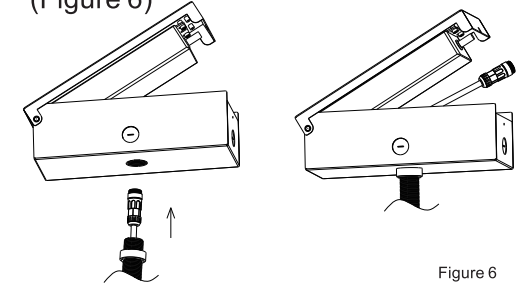

Figure 6

8. Connect the led fixture to local power with necessary connector protection measures. (Figure 8)

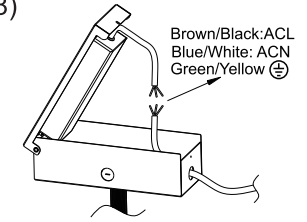

Figure 8

9. Finally, assemble the driver box. (Figure 9)(Figure 10)

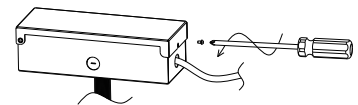

Figure 9

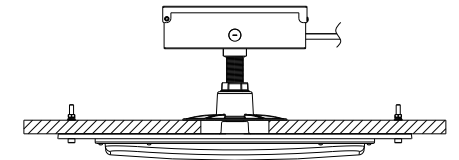

Figure 10