



crua
OUTDOORS®

COTTAGE

Instruction Manual

INCLUDES:

Outer Tents (x1)
Inner Tent Bedrooms (2)
Steel Tent Poles (x6)
Steel Porch Poles (x1)
Aluminum Porch (x1)
Tent Stakes Pack (x1)
Footprint (x1)
Insulated Carpet (x1)
Carry Bag (x3)

NOTE: TWO ADULTS WILL BE NEEDED TO SET-UP THIS TENT.

EVERYONE WHO USES THIS TENT SHOULD READ THIS MANUAL AND BECOME FAMILIAR WITH ALL SAFETY WARNINGS AND PRECAUTIONS FOR SAFE USE, ASSEMBLY, CARE, MAINTENANCE, AND STORAGE. KEEP THIS MANUAL SO YOU CAN REFER TO IT LATER

Failure to follow these directions can cause an unsafe situation leading to fire, burns, serious injury, permanent disability, or death to you or others.

FIRE, VENTILATION & GENERAL PRECAUTIONS FOR YOUR SAFETY

- Do not use gas or other combustion appliances anywhere in, or near your tent.
- Do not place hot appliances near the walls, roof or curtains.
- Always observe the safety instructions for these appliances.
- Never allow children to play near hot appliances.
- Make sure all ventilation openings on inner and outer tents as well as any Reflective Flysheets are open all the time to avoid possible suffocation.



DANGER

Indicates an imminently hazardous situation which, if not avoided, may result in death or serious injury.



WARNING

Indicates a potentially hazardous situation which, if not avoided, may result in death or serious injury.



CAUTION

Indicates a potentially hazardous situation which, if not avoided, could result in property damage or injury.



FLAMMABILITY

Keep all flame and heat sources away from this tent fabric. Any tent, even ones treated with flame-resistant chemicals, are not fireproof. The fabric will burn if left in continuous contact with any flame source and could result in serious injury, permanent disability, or death to you or to others.

THIS TENT IS NOT FIREPROOF, for these reasons:

- DO NOT spray the tent with insecticide.
- DO NOT use other than Crua Outdoors ® recommended water repellent compounds on your tent.
- DO NOT use matches, lighters, stoves, heaters, grills, lanterns, candles, cooking equipment or any other fuel-burning devices, in or near the tent.
- DO NOT build fires in or near a tent.
- DO NOT leave campfires unattended.



CARBON MONOXIDE GAS WILL KILL YOU

Stoves, heaters, grills, lanterns, candles, and any other fuel burning devices that burn propane, natural gas, charcoal, kerosene, coal, or other fuel, produce a toxic gas called Carbon Monoxide. Carbon Monoxide is an invisible, odorless and colorless gas. A dangerous level can accumulate in a tent that cannot be detected by sight, smell or taste. When breathed in, even in small quantities, Carbon Monoxide is absorbed into the bloodstream, replacing, and reducing the oxygen in the bloodstream and causing Carbon Monoxide poisoning and suffocation which will cause serious injury, permanent disability, or death to you or to others.

For these reasons:

- DO NOT use matches, lighters, stoves, heaters, grills, lanterns, candles, cooking equipment or any other fuel-burning devices, in or near the tent.
- DO NOT build fires in or near a tent.
- DO exercise care when using electricity and lighting in and near your tent.



SEVERE WEATHER

In some climatic conditions (for example, severe storms, high winds, heavy snow) stakes and guy lines may not be sufficient to anchor a tent securely, which could result in the tent being picked up or blown away, which could cause serious injury, permanent disability, or death to you or to others.

Under such conditions:

- DO use supplemental means to anchor the tent.
- DO seek appropriate shelter, for example, in a house, cabin building or a secure structure other than a tent.



SUFFOCATION HAZARD

Any tent must be properly ventilated in all weather conditions to allow sufficient airflow into and out of the tent. If airflow into and out of the tent is obstructed (for example, heavy snow or bedding/pillows covering vents) you and other persons will suffer from a lack of oxygen and suffocate resulting in serious injury, permanent disability, or death to you or to others.

For these reasons:

- DO clear snow or other materials away from any external vents frequently.
- DO ensure that bedding, pillows, backpacks, etc. are kept away from any internal vents.
- DO NOT use matches, lighters, stoves, heaters, grills, lanterns, candles, cooking equipment or any other fuel-burning devices, in or near the tent. (SEE CARBON MONOXIDE WARNING).



PROTECT YOUR CHILDREN

- DO NOT leave children unattended inside or around a tent.
- DO NOT allow children to set-up or take down a tent.
- DO NOT allow children to enter or exit a tent except through the door.
- DO NOT allow children to remain in a closed-up tent on hot days.
- DO NOT allow children to play with any plastic bags or other packaging material as there is a risk of suffocation. Your failure to follow this warning will cause death, serious injury or permanent disability to your children.



FOR YOUR SAFETY

Before using this product, read and fully understand:

- (1) Attached Warning Labels.
- (2) This instruction manual and all accompanying documentation.

KEEP ALL EXITS CLEAR



VENTILATION

Any tent must be properly ventilated in all weather conditions to allow sufficient airflow into and out of the tent. Please familiarize yourself with all vents and openings in your tent to ensure you can maintain adequate ventilation. There are three main reasons we promote ventilation within a tent, as in the same way we would in any dwelling like a house or apartment. These are Airflow, Air quality, and Condensation Reduction.

- **AIRFLOW:** Without airflow or fresh air into the tent, your environment will become stale and stuffy. It is important to promote good quality airflow throughout the tent.
- **AIR QUALITY:** A buildup of any harmful gasses (carbon dioxide, carbon monoxide, and others) is possible in an enclosed space. For this reason, you must always have adequate ventilation in your tent to ensure a good flow of air from outside.
- **CONDENSATION REDUCTION:** Leaving the vents open, supplemented by partially opening windows and doors at night to provide cross ventilation is a good way to reduce condensation.

Given the importance of proper ventilation, for airflow, air quality and condensation reduction, we use high and low venting in most of our tents. This allows cooler air in through the low vents and warmer, moist air up and out through the high vents. Opening both the high and low vents is important as this allows for this cross ventilation. If your tent has vents in the porch / vestibule, then it is important to also keep those vents open. Failure to vent your tent properly, may result in serious injury, permanent disability, or death to you or to others.



GENERAL PRECAUTIONS

- Make sure you know the fire precaution arrangements on the site.
- Consider the possibility of falling rocks or tree limbs, lightning, flash floods, avalanches, strong winds, and other potential hazards.
- Make sure you anchor your tent at all times.
- Please be mindful of guylines, bathtub floors, straps, and other parts of tents as they can be a potential trip hazard.

IMPORTANT

We make every effort to ensure the accuracy of our information. We do, however, have a policy of continuous improvement and we therefore reserve the right to change or amend designs and specifications without prior notice. Please refer to www.cruaoutdoors.com/pages/instructions for the most up-to-date safety setup and instructions.

SET-UP

IMPORTANT: WE ADVISE YOU TO ASSEMBLE THE TENT ONCE BEFORE GOING CAMPING TO BECOME FAMILIAR WITH THE ASSEMBLY OF THE TENT.

Set-up of your tent may take longer in windy conditions due to the extra caution needed.

1. Take out and organize all the contents from the carry bags.
2. Lay down the tent footprint and roll the outer tent out in its approximate final location and lightly peg the corners down to keep it in place. The tent is heavy once erected, so please make sure you have the tent where you want to pitch it before assembling.
3. The poles are color coded to assist you. There are 2 red poles for the center of the tent, 3 black poles in total (2 for the tent and 1 for the sunroom) 2 yellow poles for the tent.
4. There are also 2 black porch poles.
5. Place the poles together, but do not put the straight sides onto the curved pole just yet.



A. Outer Tent

- A1. Put the 2 curved red poles through the sleeves on the top center of the tent.
- A2. Next, put the straight red poles into the side sleeves. Connect the straight sides to the curved pole.
- A3. Once the side poles are connected to the curved top pole, you can start to raise the center by finding the corresponding pin at the bottom of the tent. Now insert the pin into the bottom of the pole.
Note: There are two pins because the red poles and black poles meet in the same spot.
- A4. Once that is completed, the center of the tent should be standing.
- A5. You can now follow the same process on the black poles.
- A6. After both black poles are secured, you can follow the same process for the two yellow poles.
- A7. Once all the poles on the main tent are secured, pull the tent taught and properly peg down the corners of the tent to secure it in place.
- A8. Now, you should be left with one remaining black pole and the 2 porch poles. Place the curved black pole, through the sleeve of the sunroom. Place the straight black poles through the side sleeves and attach to the curved pole. Find the corresponding pin at the bottom of the tent and put the pin in the bottom of the pole.



B. Sunroom

- B1.** Place the curved pole through the sleeve at the top.
- B2.** Slide the straight poles through the corresponding sleeves.
- B3.** Connect the side poles to the curved poles
- B4.** Need to have a step to find the corresponding pin and put it into the bottom of the straight pole - similar to section A.
- B5.** Fasten all clips to the poles
- B6.** Stake out the tent using the attached guy-lines.
- B7.** Stake out the lower section of the sunroom.

D. Porch (Without RV)

- D1.** Place the porch poles through the eyelets, guy down the porch and peg down the side slaps so it is secure.
- D2.** There is additional fabric on the porch for attaching to an RV.
- D3.** There is a drawstring to cinch up the additional fabric when the RV is not attached.



F. Ventilation

F1. Outer Braced Vents

Ensure that side vents (braced vents) are always open when the tent is erected.

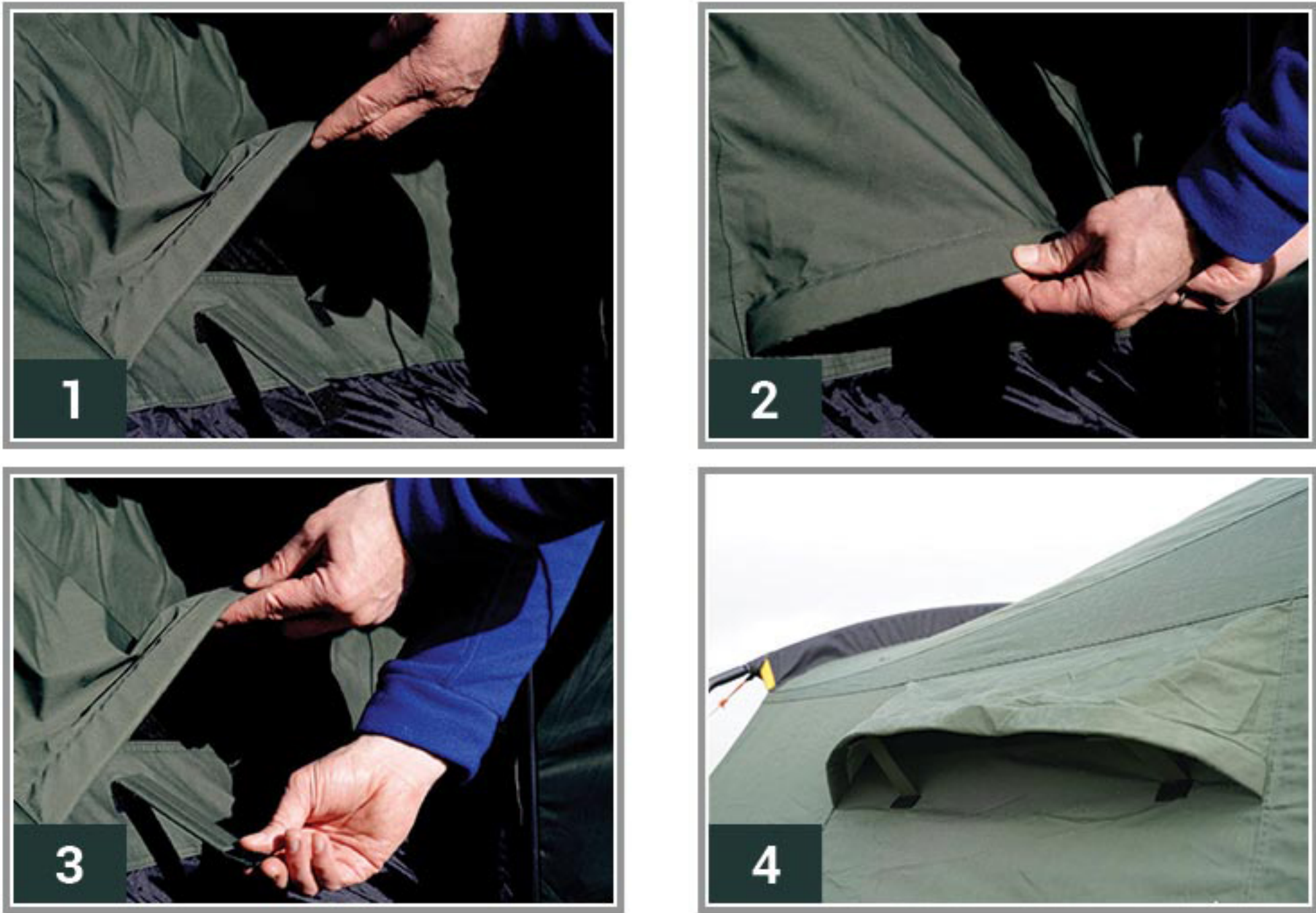

F3. Insulated Inner Tent / Culla (formerly "Cocoon")

The insulated inner tents have curtains that cover the vents and windows. At least two vents/windows, one high and one low, should be fully zipped open, rolled up, and secured in each bedroom. Ensure items such as bedding do not block any vents. **Note,** there are a few different ways to open the large window/vents on the back wall: 1) fully unzip the sides of the curtain and place the brace on the velcro patch at the bottom of the curtain to keep it open 2) there are velcro patches halfway up, so the curtain can be unzipped and folded back to the velcro patches 3) the curtain can be fully unzipped, rolled up and secured. For maximum airflow, all vents/windows can be fully rolled up and secured. The doors can also be rolled open to further supplement airflow.



G. Reflective Flysheet

When using the Cottage with its Reflective Flysheet, always:

- G1.** Make sure the flysheet is staked out at the bottom separately from the tent itself - at least 15-20cm further out all around. This is important to ensure that there is adequate airflow between the reflective flysheet and the tent body. (Fig G1)
NOTE: The back window vent should be zipped open and the guylines should be staked-out fully under the reflective flysheet. This ensures a good flow of air into the tent. (Fig G2)



- G2.** Make sure that the vents on the reflective fly line up with the vents on the tent body where applicable, and that the reflective flysheet in no way disrupts airflow into the tent vents.



- G3.** When using the reflective flysheet, always open and roll up fully and secure the back window on the Cottage's insulated inner tent / Culla (Cocoon) to maximize airflow. (Fig G3)



For further information, please refer to your Flysheet instruction manual included with your Flysheet purchase.

C. Bedrooms

- C1.** Your Cottage comes with an insulated carpet. The carpet is designed to fill the space under one bedroom and the center living space of the tent. If you choose to use both bedrooms, then the carpet will simply sit under one bedroom.
- C2.** If you are using one or both of the insulated bedrooms, then bring them into the tent and unroll them. There are buckles along the outside of the bedroom that connect to corresponding buckles inside the outer tent. The buckles have also been color coded to assist you in orienting the bedroom correctly.
- C3.** Once you have clipped the buckles, you can pull or loosen the webbing to ensure the bedroom is taught and secure.



E. Porch (With RV)

- E1.** Make sure the RV is positioned next to the tent so that the awning matches up with the porch.
- E2.** Lower the RV awning so that there is more than enough slack to attach the porch and the awning.
- E3.** Utilizing an RV Connector (not included) – slide the connector onto both the RV and the Porch securing the two together. You may need more than one connector based on the size of your awning.
- E4.** Raise the RV awning to the appropriate height, so that the porch is pulled taught.
Note: Do not pull the porch too tight or you can risk damaging the tent.
- E5.** Using the drawstring, cinch up any extra fabric on the flaps so they are secure.

F2. Outer Window Vents

On applicable tents, ensure that all outer window vents are open and guyed out. For maximum airflow, these window vents can be fully rolled up.

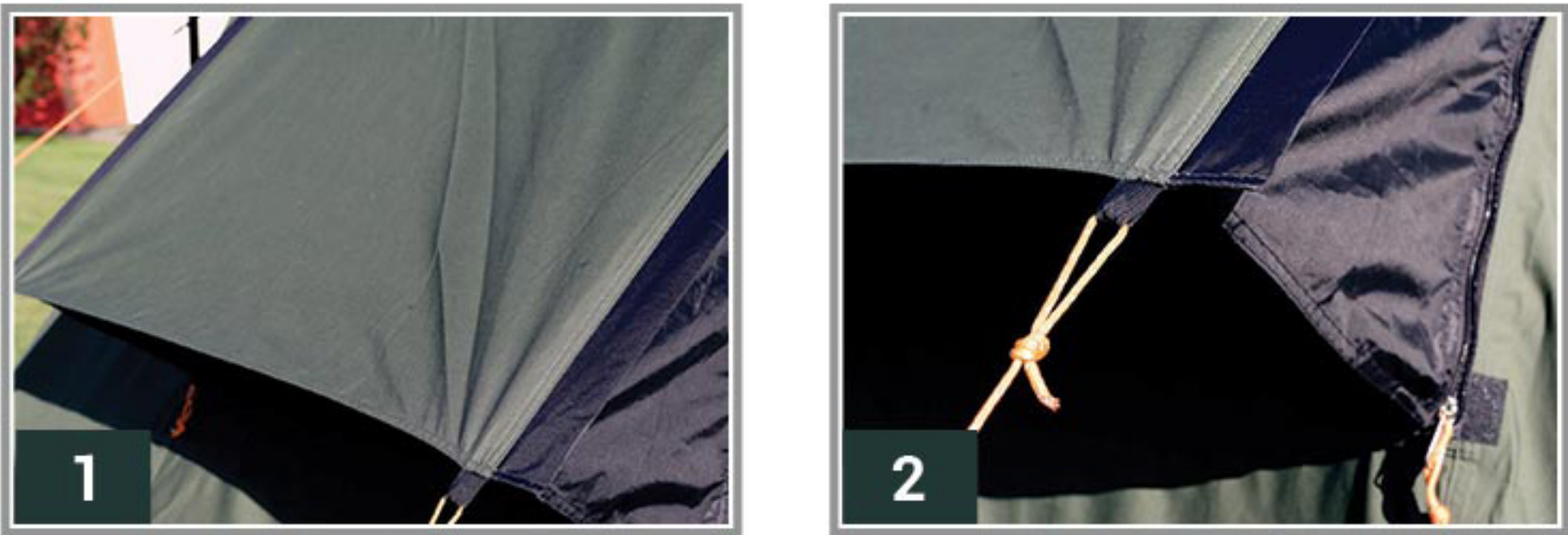

TAKE DOWN

A. Inner Tent

Close all windows of the Insulated Culla Tent. If the door of the Insulated Culla tent is rolled up, unroll the door, and close the door partially. Leave the horizontal section of the door open so that it allows for air to flow through when rolling up the Insulated Culla Tent. Leave the horizontal section of the door open so that it allows for air to flow through when rolling up the Insulated Culla Tent.

Remove the Insulated Culla Tent by unclipping the buckles.

Roll up the Insulated Culla Tent by laying it flat and folding it in third, lengthways. Roll the tent towards the door.

Apply the compression straps to the outside of the tent.

B. GuyLines

Remove the stakes from the ground.

Take the guy-lines off the stakes, tie them neatly, and place them back in the pockets provided. (You may need to keep a guy-line at the front and back in place to ensure the tent does not move with the weather).

C. Poles

Unclip the poles.

Take the poles of the pin.

Push the poles through the sleeve.

Fold away the poles neatly into their bag.

D. Rolling up

Close all outer vents to ensure that the vent braces do not get damaged when packing away and storing the tent.

Similar to the inner tent, fold the outer tent in thirds, lengthways.

Roll the tent towards the door.

Apply the compressing straps to the outside of the tent.

CARE INSTRUCTIONS

DO NOT LEAVE YOUR TENT SET UP IN DIRECT SUNLIGHT LONGER THAN NECESSARY. THE SUN’S ULTRAVIOLET (UV) LIGHT DEGRADES ALMOST EVERY FABRIC AND MATERIAL. IF LEFT IN SUNLIGHT FOR PROLONGED PERIODS OF TIME, FABRIC WILL FADE AND WEAKEN. DO NOT STORE TENT ON CONCRETE FLOOR. DO NOT SPRAY THE TENT WITH INSECTICIDE. EXERCISE CARE WHEN USING ELECTRIC DEVICES IN AND NEAR TENTS.

Although our tents are constructed to rigid specifications, periods of wind or rain soaking the ground may loosen the stakes and cause the uprights to sink into the ground. This will weaken the rigidity of the overall structure. Water pockets may also form in the roof if the unit is not assembled taut, possibly causing broken frames and torn fabric. Regularly check that your tent is anchored tautly and securely.

Ensure that the tent is fully dry when packing away. If this is not possible when leaving the campsite, take the tent out of its bag as soon as possible and allow it to dry. Never store a tent when wet, as this can seriously degrade the product.

WARRANTY INFORMATION

ALL CRUA OUTDOORS® PRODUCTS CARRY A LIMITED TWO-YEAR WARRANTY REFER TO OUR TERMS AND CONDITIONS AT WWW.CRUAOUTDOORS.COM.

EXCEPT FOR THE WARRANTY EXPRESSLY SET FORTH HEREIN, SELLER MAKES NO WARRANTY WHATSOEVER WITH RESPECT TO THE GOODS, INCLUDING ANY

(A) WARRANTY OF MERCHANTABILITY;

(B) WARRANTY OF FITNESS FOR A PARTICULAR PURPOSE;

(C) WARRANTY AGAINST INFRINGEMENT OF INTELLECTUAL PROPERTY RIGHTS OF A THIRD PARTY, WHETHER EXPRESS OR IMPLIED BY LAW, COURSE OF DEALING, COURSE OF PERFORMANCE, USAGE OF TRADE OR OTHERWISE.

For more information in English, go to www.cruaoutdoors.com

Pour consulter ces consignes et instructions de sécurité en français, veuillez visiter www.cruaoutdoors.com



Um diese Sicherheitsrichtlinien und Anweisungen in deutscher Sprache anzuzeigen, besuchen Sie bitte www.cruaoutdoors.com



Para ver estas pautas e instrucciones de seguridad en español, visite www.cruaoutdoors.com



OUR ALL LOCATIONS



www.cruaoutdoors.com

Crua Outdoors USA
40675 Country Road 21,
Ault, CO. USA 80610
1-518-354-3987