



hairmax®
TRANSFORMATIVE HAIR REGROWTH

USER MANUAL

LASER CAP **272**

Hair Growth **Laser Light Device** PowerFlex

Introduction to Hairmax

Your Hairmax laser device is a home-use laser device that utilizes clinically proven technology to treat male and female pattern hair loss, also known as hereditary hair loss in men and women. The Hairmax laser device is an over-the-counter (OTC) device that can be sold directly to the public.

Indications

Hairmax laser devices are indicated to treat Androgenetic Alopecia, and promote hair growth in females who have Ludwig (Savin) I-1 to II-2, or frontal patterns of hair loss and in males who have Norwood Hamilton Classifications of IIa to V and who both have Fitzpatrick Skin Types I to IV.

Your Hairmax laser device can be worn by itself, in your favorite cap, or in the sports cap provided.

How Hairmax works

Hairmax works by providing therapeutic laser energy to stimulate hair follicles. Hairmax should be used 3 times per week, spaced out every other day. For example, Monday, Wednesday, Friday. The Hairmax should not be used more than the recommended treatment time per day. Clinical studies demonstrate that most users see benefits in as little as 16 weeks.

Hairmax results

Hairmax laser therapy has been proven safe and effective in 7 clinical studies with over 460 men and women. In these clinical studies, over 90% of the participants experienced significant hair growth, on average, over 20 new hairs per square centimeter/129 per square inch.

It is important that you read and understand the content of this user manual before using your Hairmax laser device.

How do you know if the Hairmax is right for you?

Hairmax laser devices can be used by men and women with thinning hair (including color treated hair) or pattern baldness caused by a hereditary/hormonal condition. Doctors use a system known as the Norwood Hamilton Classification (men) and the Ludwig-Savin Classification (women) to describe the degree of hair loss. Use the scales below to determine if Hairmax laser devices are right for your hair loss. Hairmax has been clinically tested to treat hair loss as shown in the dark color areas below.

CLASSIFICATION FOR MEN AND WOMEN

Norwood Hamilton Classification - Males

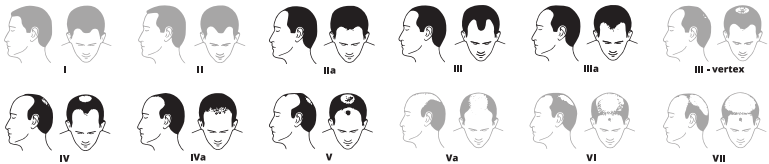

Ludwig-Savin Classification - Females



SYMBOLS

	European Conformity		Power On/Off		Serial Number
	WEEE		Refer to instruction manual		Degree of moisture resistance
	Warning		RF interference		Laser light indicator
	Caution		Type BF applied part		Underwriter Laboratories
	Laser		Laser aperture indication		Restriction of Hazardous Substances
	Laser Warning		Low-level ESD		Federal Communications Commission
	Manufacturer		Catalog #		Recycling
	Date of Manufacture		Keep dry		Laser warning label
	Humidity limitation		Temperature limit		

TESTING FOR SENSITIVITY

Prior to treatment, test your skin for sensitivity by shining the light on the inside of your forearm for 2 minutes. If you see any reaction, do not use your laser cap and contact customer service.

HOW TO MONITOR DEVICE ACTIVITY

Your device is manufactured in an ISO 13485 certified facility using the highest quality components. Your device should provide many years of trouble-free usage. When working properly, a therapeutic red laser light should shine out of the device. The laser light does not diminish over time.

PARTS



This is a harmless low-level ESD (Electrostatic Discharge) sensitive device. Please do not touch the charging contacts or USB-port. Touching the contacts or USB-port is not of the essential performance and will not cause a basic safety issue. If touching the contacts or USB-port causes the device to malfunction, reset your device by powering off and back on.

WHAT IS INCLUDED

- | | | |
|----------------------------|-------------------------|---------------|
| 1. Hairmax Laser Cap 272 | 4. Quick start guide | 7. Sports cap |
| 2. Power supply with cord | 5. Storage/travel case | |
| 3. Controller/battery pack | 6. Size adjustment ring | |

Notice: Entire Hairmax assembly is considered as a Type BF applied part.

GETTING STARTED

Read this manual completely before you start to use your Hairmax. The instructions in this user manual are intended for individuals with a minimum of an eighth grade education. Hairmax is safe for home use. The consumer is the intended operator of this equipment.

When you receive your device, take all the parts out of the case. Make sure your device is clean and dry before beginning the treatment.



Controller/battery pack

Your Hairmax laser device comes with a rechargeable controller/battery pack.

You must charge the controller/battery pack for 4-6 hours before every use

ATTENTION

The Hairmax laser device must be plugged into the controller/battery pack in order to operate.

ONLY UTILIZE THE PROVIDED CONTROLLER/BATTERY PACK WITH YOUR HAIRMAX LASER DEVICE. PLUGGING INTO ANY OTHER POWER SOURCE MAY DAMAGE THE DEVICE AND VOID YOUR WARRANTY.

CHARGING

Charge your laser cap by plugging the small (USB Type-C) end of the power cord into the small socket on the side of the controller/battery pack (Figure A).

Plug the other end of the power cord into the large (USB-A) socket of the power supply (Figure B). Plug the power supply into an electrical wall outlet.

The battery indicator will flash on the display of the controller/battery pack during the charging process. Four full bars will indicate a full charge (Figure C).

The battery will indicate the level of charge remaining on the battery.

4 bars = 100%

3 bars = 75%

2 bars = 50% (time to recharge)

1 bar = 25%

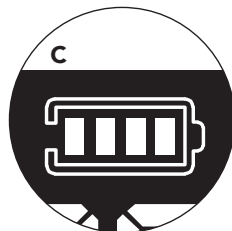
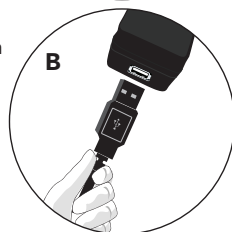
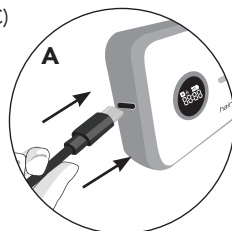

When charging is complete, disconnect the power cord from the controller/battery pack and store it for future charging (Figure D).

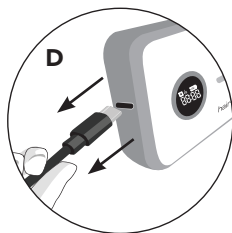

Before Starting Your Treatment:

1. Make sure the battery is FULLY CHARGED.
2. Test your Hairmax laser device for sensitivity.

TREATMENT METHOD

Connect the controller (cable coming out of the back of the laser cap) to the large USB-A socket on the side of the controller/battery pack (Figure E).

Place your laser cap on your head in a comfortable relaxed position (Figure F).

Your device can be worn by itself or inserted into your favorite sports cap (sports cap is provided).

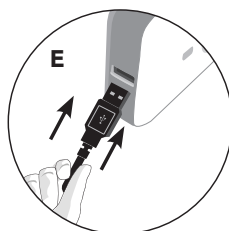

Press the on/off button once (Figure G). You will hear a beep and the timer will illuminate. The counter will start at 7:00 minutes and countdown to 00:00.

When your Hairmax laser device is turned on, the logo, battery level, timer and laser indicator light will illuminate. The timer will keep track of how long you have used the device.

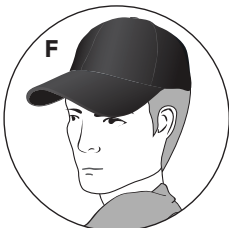

The laser indicator light on the controller/battery pack will flash to indicate the lasers are on and functioning properly (Figure H).

As you are near the end of your treatment, the timer will flash 00:00 for 10 seconds, you will hear a double beep and the lasers will turn off.

If you choose to power off your device before the treatment is complete, press and hold the on/off button for 3 seconds, you will hear the double beep and your device will power down.

Once you are done with the treatment, disconnect the controller cable from the controller battery pack. Check the level of charge remaining on the battery. If it needs recharging, charge the controller/battery pack as described in the CHARGING section so it will be ready for your next treatment.

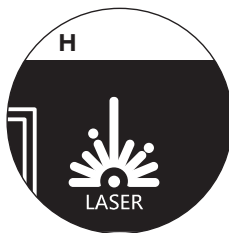
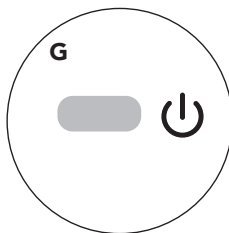

NOTE – Your Hairmax laser device cannot be used while charging.

PROPER USE

Your Hairmax should be used for 7 minutes, three times per week. The treatments should be spaced out every other day. For example; Monday, Wednesday, Friday.



3 times
per week

Make sure your battery is charged properly. You should have a minimum of two bars on the battery indicator display before starting your treatment.

TROUBLESHOOTING

ANY ATTEMPT TO SELF-SERVICE YOUR DEVICE, UNLESS INSTRUCTED BY CUSTOMER SERVICE, WILL VOID YOUR WARRANTY.

Hairmax has advanced electronics to ensure that the device is working like it is supposed to and that the proper amount of laser energy is being delivered. If for some reason you are experiencing difficulties with your device, please try one of the tips below:

Your laser device will not turn on

- Make sure the device is fully charged
- Make sure the device and the controller/battery pack are properly connected

Your laser device turns off during use

- Make sure the device is fully charged
- Make sure the device and the controller/battery pack are properly connected

Your laser device is not lighting up, but the controller/battery pack is fully charged

- Make sure the device and the controller/battery pack are properly connected

LASER PARAMETERS

Wavelength: 655nm +/- 5nm visible red light

Laser Power for classification: <5mW CW

Divergence: 57 mrad

Number of lasers: 272

MTBF Lasers (mean time between failures): 10,000 hours at 25°C/77°C

This Laser Product is designated as Class 3R during all procedures of operation.

Note: Hairmax laser devices have no user-serviceable parts.

USE CONDITIONS

Operating temperature/altitude/atmospheric pressure/humidity: 5°C/41°F

to 35°C/95°F/0 to 2,000 m/80kPa to 106kPa/0% to 90%, relative humidity

Storage & transportation temperature/humidity/atmospheric pressure:

-20°C/ -4°F to 60°C/140°F/0% to 90%, relative humidity/50kPa to 106kPa

Ingress of water or particulate matter: IP22

Battery charging cycles: 300 cycles

RoHS (restriction of hazardous substances): 2011/65/EU

Device size and weight: 22 x 18 x 9 cm/ 8.5 x 7 x 3.5 in / 862 grams / 1.9 lb

Product warranty: 1 year

Age of use: Adult

SOFTWARE VERSION

Software Version: SFM-272A_V1.2

LABELS

Warning label

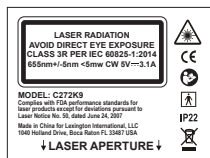

Serial number label



Controller/battery pack label



POWER SUPPLY SPECIFICATIONS

Output = 5.0 VDC / 1.0A

The power supply for your Hairmax can be used in the United States and Internationally. This power supply will adapt to all power supplies from 100 volt/60 Hz (US) to 240 volt/50 Hz. If outlets in your country have different plugs than the power supply that comes with this laser device, use an international plug adapter (not supplied). Only use the power supply and power cord provided by the manufacturer, any other power supply or power cord may damage your device.

WARNINGS

- ▲ Do not stare directly at the red laser light or its reflection in a mirror because it can temporarily irritate your eyes. If you stare at the light for too long, it could harm your eyes. Also, never use a magnifying glass when using Hairmax because it can cause temporary irritation to your eyes.
- ▲ Keep the Hairmax out of the reach of children, pets and pests.
- ▲ Do not drop your Hairmax in water because you may get an electrical shock. If your Hairmax gets damaged by water, contact customer service.
- ▲ If the cord is damaged on your Hairmax do not use the device because you could get an electrical shock. If the cord gets damaged, contact customer service.
- ▲ Do not use your Hairmax near any heated surfaces because this could cause the device not to work properly and may cause an electrical shock, contact customer service.
- ▲ Laser light - avoid direct eye exposure.
- ▲ This is a harmless low-level ESD (Electrostatic Discharge) sensitive device. Please do not touch the charging contacts or USB-port. Touching the contacts or USB-port is not of the essential performance and will not cause a basic safety issue. If touching the contacts or USB-port causes the device to malfunction, reset your device by powering off and back on.
- ▲ No modification of this equipment is allowed.
- ▲ This equipment has no user-serviceable parts. Do not attempt to modify or repair this equipment.
- ▲ Do not attempt to modify or service while the equipment is in use.
- ▲ If this equipment is modified, appropriate inspection and testing must be conducted to ensure continued safe use. Contact Hairmax customer service.
- ▲ In case of a serious incident, seek medical attention immediately.
- ▲ If you are experiencing any allergic reaction from handling or using the device, stop using it immediately.
- ▲ Only use the power supply and power cord provided by the manufacturer, any other power supply or power cord may damage your device.

CAUTIONS

- △ If you are taking any medications or products that make you sensitive to light, test the device to make sure you do not have a reaction. Some of the things that can cause increased sensitivity to your Hairmax could be medicines for colds, allergies, pain medicine and drugs to treat infections. To test your Hairmax for sensitivity, turn the device on, hold the device on one spot, shining the light on your forearm. After two minutes, turn the device off and set aside. Look at the spot where you held the laser light over the next five minutes. If you see any reaction such as redness or rash, do not use your Hairmax and contact customer service for information on how to return your product and get a refund.
- △ Only use your Hairmax as directed. Do not try to change the way your Hairmax operates. Altering controls, adjustments, performance or procedures other than those specified herein may result in hazardous radiation (laser) exposure. Contact customer service.
- △ Never use acetone or other solvents on any part of your Hairmax. Use of solvents on the window can block the laser light from coming through.
- △ It is suggested to charge the device every 3 months even if it is not used.
- △ For assistance setting up, using or maintaining the device, or to report unexpected operations or events, contact the manufacturer.
- △ Do not place the power adapter where it is difficult to disconnect and where the cable may be stepped on.

RISKS

Hairmax has been clinically tested on both men and women. In the clinical study for men, 5% of the men said they had itching or tingling from using the Hairmax. None of the women in the clinical study reported any of these side effects. If you have itching, tingling or any other side effect that bothers you, stop using the device and contact customer service.

MAINTENANCE

Hairmax is designed to last for many years. It does not require any maintenance other than periodic cleaning.

CLEANING THE DEVICE

- Make sure your device is turned off.
- Disconnect the power cord from the controller/battery pack.
- Clean your device with a soft, slightly moistened cloth before and after each treatment. Never use acetone or other solvents on any part of your device.

DISPOSAL INSTRUCTIONS



This symbol on the product or on its packaging indicates that this product must not be disposed of with your other household waste. Instead, it is your responsibility to dispose of your waste equipment by handing it over to a designated collection point for the recycling of waste electrical and electronic equipment.

The separate collection and recycling of your waste equipment at the time of disposal will help to conserve natural resources and ensure that it is recycled in a manner that protects human

health and the environment. For more information about where you can drop off your waste equipment for recycling, please contact your local city office or your household waste disposal service.

ELECTRICAL SAFETY

Basic safety precautions should be observed when using this, or any other electrical device, especially when children are present.

- ▲ **WARNING:** Keep away from water. Contact with water may result in an electrical shock.

To reduce the risk of hazard by electric shock:

- ▲ Do not use while bathing.
- ▲ Do not place or store your Hairmax where it can fall or be pulled into a tub or sink.
- ▲ Do not expose your Hairmax to running water, or drop into water or any other liquid. If your Hairmax falls into water, unplug it immediately from the power outlet.
- ▲ If using your Hairmax near water, the use of an electrical outlet protected by a Ground Fault Circuit Interrupter is recommended.
- ▲ Do not dispose of your Hairmax in a fire or store in high temperatures greater than 140°F (60°C).
- ▲ Do not turn on or use your Hairmax while it is charging.
- ▲ Power supply cannot be separated during use. Do not position the equipment in a manner that will make it difficult to plug in or remove the power cord.
- ▲ If you have any problems with this device, such as setting up, maintaining or using, please contact customer service.
- ▲ Please report to customer service if any unexpected operation or events occur.
- ▲ After drop/shock, that may cause changes in the performance, please contact customer service.
- ▲ Be careful, do not put the power cord around your neck, it may cause strangulation.
- ▲ Keep the device out of the reach of children/pets to avoid inhalation or swallowing of small parts.
- ▲ Do not use the device if it is damaged in any way. The continuous use of a damaged unit may cause injury, improper results, or serious danger.
- ▲ The device should be used only with the accessories recommended for use by the manufacturer.
- ▲ When not in use, store the device with the adapter in a dry room and protect it against extreme moisture, heat, lint, dust and direct sunlight.
- ▲ Never place any heavy objects on the storage case.

ELECTROMAGNETIC EMISSIONS GUIDANCE**Guidance and manufacturer's declaration – electromagnetic emissions**

The Hairmax Laser Device is intended for use in the electromagnetic environment specified below. The customer or the user of the Hairmax Laser Device should assure that it is used in such an environment.

Emission test	Compliance	Electromagnetic environment-guidance
RF emissions CISPR 11	Group 1	The Hairmax Laser Device uses RF energy only for its internal function. Therefore, its RF emissions are very low and are not likely to cause any interference in nearby electronic equipment.
RF emissions CISPR 11	Class B	The Hairmax Laser Device is suitable for use in all establishments, including domestic establishments and those directly connected to the public low-voltage power supply network that supplies buildings used for domestic purposes.
Harmonic emissions IEC 61000-3-2	Class A	
Voltage fluctuations/flicker emissions IEC 61000-3-3	Compliance	

ELECTROMAGNETIC IMMUNITY GUIDANCE**Manufacturer's declaration – electromagnetic immunity**

The Hairmax Laser Device is intended for use in the electromagnetic environment specified below. The customer or the user of Hairmax Laser Device should assure that it is used in such an environment.

Immunity test	IEC 60601 test level	Compliance level	Electromagnetic environment-guidance
Electrostatic discharge (ESD) IEC 61000-4-2	Contact: ± 8 kV Air: ± 15 kV ± 2 kV, ± 4 kV, ± 8 kV,	Contact: ± 8 kV Air: ± 15 kV ± 2 kV, ± 4 kV, ± 8 kV,	Floors should be wood, concrete or ceramic tile. If floors are covered with synthetic material, the relative humidity should be at least 30%.
Electrical fast transient/burst IEC 61000-4-4	± 2 kV for power supply lines ± 1 kV for input/output lines	± 2 kV for power supply lines Non applicable	Mains power quality should be that of a typical commercial or hospital environment.
Surge IEC 61000-4-5	± 1 kV differential mode ± 2 kV common mode	± 1 kV differential mode ± 2 kV common mode	Mains power quality should be that of a typical commercial or hospital environment.
Voltage dips, short interruptions and voltage variations on power supply input lines IEC 61000-4-11	Voltage dips: 0% UT; 0,5 cycle g) At 0°, 45°, 90°, 135°, 180°, 225°, 270°, and 315° 0% UT; 1 cycle and 70% UT; 25/30 cycles Single phase: at 0° 0% UT; 250/300 cycle	Voltage dips: 0% UT; 0,5 cycle g) At 0°, 45°, 90°, 135°, 180°, 225°, 270°, and 315° 0% UT; 1 cycle and 70% UT; 25/30 cycles Single phase: at 0° 0% UT; 250/300 cycle	Mains power quality should be that of a typical commercial or hospital environment. If the user of the Hairmax Laser Device requires continued operation during power mains interruptions, it is recommended that the Hairmax Laser Device be powered from an uninterruptible power supply or a battery.
Power frequency (50Hz/60Hz) magnetic field IEC 61000-4-8	30 A/m 50 Hz or 60 Hz	30 A/m 50 Hz	The Hairmax Laser Device Power frequency magnetic fields should be at levels characteristic of a typical location in a typical home healthcare environment.
NOTE UT is the a.c. mains voltage prior to application of the test level.			

ELECTROMAGNETIC IMMUNITY GUIDANCE**Manufacturer's declaration – electromagnetic immunity**

The Hairmax Laser Device is intended for use in the electromagnetic environment specified below. The customer or the user of the Hairmax Laser Device should assure that it is used in such an environment.

Immunity test	IEC 60601 test level	Compliance level	Electromagnetic environment-guidance
Conducted RF IEC 61000-4-6	3 Vrms 150 KHz to 80 MHz	3 V 6 V	Portable and mobile RF communications equipments should be used no closer to any part of the Hairmax Laser Device including cables, than the recommended separation distance calculated from the equation applicable to the frequency of the transmitter. Recommended separation distance: $d = \left[\frac{3.5}{V_i} \right] \sqrt{P}$ $d = \left[\frac{12}{V_i} \right] \sqrt{P}$ $d = \left[\frac{3.5}{E_i} \right] \sqrt{P} \quad 80 \text{ MHz to } 800 \text{ MHz}$ $d = \left[\frac{7}{E_i} \right] \sqrt{P} \quad 80 \text{ MHz to } 2.7 \text{ GHz}$ Where P is the maximum output power rating of the transmitter in watts (W) according to the transmitter manufacturer and d is the recommended separation distance in metres (m). ^b Field strengths from fixed RF transmitters, as determined by an electromagnetic site survey, ^a should be less than the compliance level in each frequency range. ^b Interference may occur in the vicinity of equipment marked with the following symbol: 
Radiated RF IEC 61000-4-3	6 V in ISM and amateur radio bands between 0,15 MHz and 80 MHz 10 V/m 80 MHz to 2.7 GHz	10 V/m	

NOTE1 At 80 MHz and 800 MHz, the higher frequency range applies.

NOTE2 These guidelines may not apply in all situations. Electromagnetic propagation is affected by absorption and reflection from structures, objects and people.

- a The ISM (industrial, scientific and medical) bands between 150 kHz and 80 MHz are 6,765 MHz to 6,765 MHz to 6,795 MHz, 13,553 MHz to 13,567MHz; 26.957 MHz to 27,283 MHz; and 40,70 Hz. The amateur radio bands between 0,15 Hz and 80 MHz are 1,8 Hz to 2,0 Hz, 3,5 MHz to 4,0 MHz, 5,3 MHz to 5,4 MHz, 7 MHz to 7,3MHz, 10,1 MHz to 10,15 MHz, 14 MHz to 14,2 Hz, 18,07 MHz to 18,17 MHz, 21,0 MHz to 21,0 MHz to 21,4 MHz. 24,89 MHz to 24,99 MHz, 28,0 MHz to 29,7 MHz and 50,0 MHz to 54,0 MHz.
- b Field strength from fixed transmitters, such as base stations for radio (cellular/cordless) telephone and land mobile radios, amateur radio, AM and FM radio broadcast and TV broadcast cannot be predicted theoretically with accuracy. To assess the electromagnetic environment due to fixed RF transmitters, an electromagnetic site survey should be considered. If the measured field strength in the location in which the Hairmax Laser Device is used exceeds the applicable RF compliance level above, the Hairmax Laser Device Laser 272 should be observed to verify normal operation. If abnormal performance is observed, additional measures may be necessary, such as reorienting or relocating the Hairmax Laser Device.
- c Over the frequency range 150 kHz to 80 MHz, field strengths should be less than 3V/m.

ELECTROMAGNETIC DISTANCE RECOMMENDATIONS

Recommended separation distances between portable and mobile RF communications equipment and the EQUIPMENT or SYSTEM for EQUIPMENT and SYSTEMS that are not LIFE-SUPPORTING

The Hairmax Laser Device is intended for use in an electromagnetic environment in which radiated RF disturbances are controlled. The customer or the user of the Hairmax Laser Device can help prevent electromagnetic interference by maintaining a minimum distance between portable and mobile RF communications equipment (transmitters) and the Hairmax Laser Device as recommended below, according to the maximum output power of the communications equipment.

Rated maximum output power of transmitter (W)	Separation distance according to frequency of transmitter (m)			
	150 kHz to 80 MHz outside ISM and amateur radio bands $d = \left[\frac{3.5}{V_1} \right] \sqrt{P}$	150 kHz to 80 MHz outside ISM and amateur radio bands $d = \left[\frac{12}{V_2} \right] \sqrt{P}$	80 MHz to 800 MHz $d = \left[\frac{3.5}{E_1} \right] \sqrt{P}$	800 MHz to 2.7 GHz $d = \left[\frac{7}{E_1} \right] \sqrt{P}$
0.01	0.12	0.20	0.035	0.07
0.1	0.38	0.63	0.11	0.22
1	1.2	2.0	0.35	0.70
10	3.8	6.32	1.10	2.21
100	12	20.00	35	70

For transmitters rated at a maximum output power not listed above, the recommended separation distance d in metres (m) can be estimated using the equation applicable to the frequency of the transmitter, where P is the maximum output power rating of the transmitter in watts (W) according to the transmitter manufacturer.

NOTE1 At 80 MHz and 800 MHz, the separation distance for the higher frequency range applies.

NOTE2 These guidelines may not apply in all situations. Electromagnetic propagation is affected by absorption and reflection from structures, objects and people.

WARRANTY

ANY ATTEMPT TO SELF-SERVICE YOUR DEVICE, UNLESS INSTRUCTED BY LEXINGTON INTERNATIONAL CUSTOMER SERVICE, WILL VOID YOUR WARRANTY

To validate your warranty, please register online at: www.hairmax.com/warranty

THE DEVICE IS WARRANTED BY LEXINGTON INTERNATIONAL, LLC ("LEXINGTON") AGAINST DEFECTS IN MATERIALS OR WORKMANSHIP FOR 12 MONTHS FROM DATE OF PURCHASE. IF THIS PRODUCT IS DETERMINED TO BE DEFECTIVE, LEXINGTON WILL REPAIR OR REPLACE IT, AT ITS OPTION, AT NO CHARGE DURING THE WARRANTY PERIOD. THE WARRANTY PERIOD IS NOT EXTENDED IF LEXINGTON REPAIRS OR REPLACES THE PRODUCT. AFTER THE WARRANTY PERIOD, THE USER MUST PAY FOR ALL PARTS AND LABOR CHARGES. IF THE PRODUCT IS REPAIRED OR REPLACED, EITHER WITHIN OR OUTSIDE THE WARRANTY PERIOD, LEXINGTON RESERVES THE RIGHT TO PROVIDE EQUIVALENT PARTS IN DIFFERENT COLORS TO YOUR ORIGINAL PRODUCT.

THIS WARRANTY DOES NOT COVER DAMAGES CAUSED BY ACTS OF GOD, MISUSE, NEGLIGENCE, ACCIDENT, MODIFICATION OF OR TO ANY PART OF THE PRODUCT. THIS WARRANTY DOES NOT COVER DAMAGE DUE TO IMPROPER OPERATION OR MAINTENANCE, CONNECTION TO IMPROPER VOLTAGE SUPPLY, OR ATTEMPTED REPAIR BY ANYONE OTHER THAN LEXINGTON. THIS WARRANTY IS VOID IF PRODUCT IS TAMPERED WITH.

TO OBTAIN WARRANTY SERVICE, YOU MUST CALL LEXINGTON INTERNATIONAL CUSTOMER SERVICE TO REQUEST AN AUTHORIZATION NUMBER. YOU MUST DELIVER THE PRODUCT FREIGHT PREPAID, IN EITHER ITS ORIGINAL PACKAGING OR PACKAGING AFFORDING AN EQUAL DEGREE OF PROTECTION, TOGETHER WITH YOUR NAME, ADDRESS AND AUTHORIZATION NUMBER, TO:

Lexington International, LLC, 1040 Holland Drive, Boca Raton, FL 33487, USA

LEXINGTON INTERNATIONAL, LLC SHALL NOT BE LIABLE FOR ANY SPECIAL, PUNITIVE, INCIDENTAL OR CONSEQUENTIAL DAMAGES THAT ARE DIRECTLY OR INDIRECTLY RELATED TO THE USE OF, OR THE INABILITY TO USE, THE PRODUCT, EVEN IF LEXINGTON INTERNATIONAL, LLC HAS BEEN ADVISED OF THE POSSIBILITY OF SUCH DAMAGES WHETHER IN AN ACTION OF CONTRACT, NEGLIGENCE OR OTHER TORTUOUS ACTION. SOME STATES DO NOT ALLOW THE EXCLUSION OR LIMITATION OF SPECIAL, PUNITIVE, INCIDENTAL OR CONSEQUENTIAL DAMAGES, SO THE ABOVE LIMITATION OR EXCLUSION MAY NOT APPLY TO YOU. THIS WARRANTY IS THE ONLY WRITTEN OR EXPRESS WARRANTY GIVEN BY LEXINGTON INTERNATIONAL, LLC. ALL IMPLIED WARRANTIES FOR THE PRODUCT, INCLUDING BUT NOT LIMITED TO ANY IMPLIED WARRANTIES OF MERCHANTABILITY AND FITNESS FOR A PARTICULAR PURPOSE, ARE LIMITED IN TIME TO THE TERM OF THIS WARRANTY. SOME STATES DO NOT ALLOW LIMITATIONS ON HOW LONG AN IMPLIED WARRANTY LASTS, SO THE ABOVE LIMITATION MAY NOT APPLY TO YOU.

GOVERNING LAW; JURISDICTION AND VENUE: THIS WARRANTY, AND THE TERMS OF SALE OF THE PRODUCT, SHALL BE GOVERNED BY AND CONSTRUED IN ACCORDANCE WITH THE LAWS OF THE STATE OF FLORIDA WITHOUT REGARD TO PRINCIPLES OF CONFLICTS OF LAWS. THE PARTIES IRREVOCABLY SUBMIT AND CONSENT TO THE SOLE AND EXCLUSIVE JURISDICTION AND VENUE OF THE FLORIDA STATE COURTS IN AND FOR PALM BEACH COUNTY, FLORIDA, U.S.A. AND THE FEDERAL COURTS IN AND FOR THE SOUTHERN DISTRICT OF FLORIDA, U.S.A. THE PARTIES AGREE NOT TO RAISE THE DEFENSE OF FORUM NON CONVENIENS.

WARRANTY OUTSIDE THE U.S.A.

THE WARRANTY ON THIS PRODUCT SHALL COMPLY WITH APPLICABLE LAW WHEN SOLD BY AN AUTHORIZED DEALER TO A CONSUMER OUTSIDE OF THE UNITED STATES, INCLUDING EXTENDED WARRANTY COVERAGE PERIODS AS MAY BE LEGALLY REQUIRED IN SUCH JURISDICTIONS.

AUTHORIZED REPRESENTATIVE IN EUROPE (REGULATORY AFFAIRS ONLY):

EC	REP	Westervoortsedijk 60 6827 AT Arnhem The Netherlands
-----------	------------	---

TEL: +31 (0) 70 345-8570 FAX: +31 70-346-7299

CUSTOMER SERVICE TOLL-FREE NUMBERS

United States and Canada 1-866-527-3726

United Kingdom 0808-134-9868

Australia 61 7 3198 2484

France 805-081-824

Spain 900-838-164

Mexico 01 800 953 0209

Italy 800 694 205

Germany 800 001 0163

**Authorized Representative in Europe
(Regulatory Affairs Only):**



Westervoortsedijk 60
6827 AT Arnhem
The Netherlands

Tel: +31 (0) 70 345-8570 Fax: +31 70 346-7299

Australian Sponsor:

Emergo Australia

Level 20, Tower II Darling Park,
201 Sussex Street Sydney,
NSW 2000 Australia

hairmax[®]
TRANSFORMATIVE HAIR REGROWTH



LEXINGTON INTERNATIONAL, LLC

1040 Holland Drive | Boca Raton, Florida | 33487 | USA

www.hairmax.com