

# FEND

# OWNER'S MANUAL

**Model: FEND One**

Complies with US **CPSC** Safety Standard for Bicycle Helmets for persons age 5 and older. This helmet is designed to protect impact caused by collision of head with an obstacle while cycling or roller skating, it has passed **EN1078:2012+A1:2012** to show conformity to the **EHSR of Regulation (EU) 2016/425**.

# OWNER'S MANUAL

This helmet is designed only for pedal cycles, skateboards, and roller skates; and is not intended for motorcycles or motorsports. The helmet must not be used by children under 5 years of age in any activity including, climbing where there is risk of strangulation by being suspended from the helmet.

## WARNING

The helmet must be fit and attached correctly to the user's head in order to be effective. It will only be protective when it is the correct size and properly adjusted. It is recommended to try different sizes to ensure the best fit.

No helmet will provide protection against all injury. Even low-speed accidents can cause serious injuries or death. Please ride with care and caution and comply with all traffic regulations.

Once a helmet has received an impact, it may no longer be adequate to protect the head against further impacts and should be discarded and replaced even if damages are not visible. FEND generally recommends replacing a helmet every three years.

## HOW TO USE

To **UNFOLD** helmet, rotate both sides out until they “**click**” into place as shown in **Figure A**. To ensure the helmet is fully unfolded and the lock is engaged, push on both sides. If the sides are able to move, the lock is not engaged, and the side must be rotated out further until the “click” occurs. Note, make sure strap is taut and does not block side from fully unfolding.

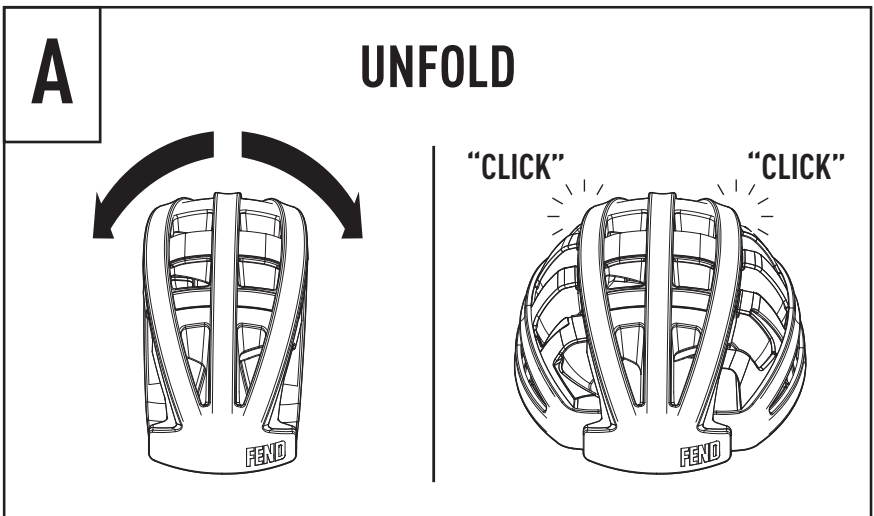

# OWNER'S MANUAL

To **FOLD** helmet, lift arrow on lock tab (  ) up **AND** rotate side inward, as shown in **Figure B**. Repeat on opposite side.

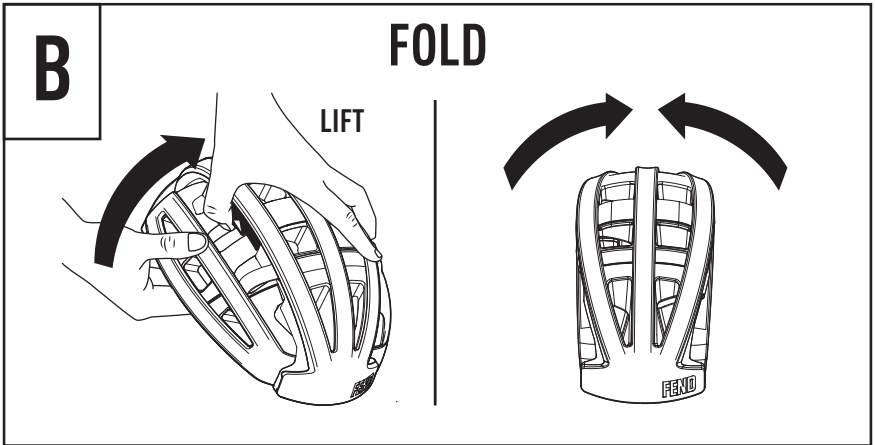

## FIT GUIDE

To ensure the helmet will provide the maximum protection, make sure it fits correctly and is worn properly. Once helmet is fully open, place onto head with rear fit adjuster in the back. Make sure the helmet is low and straight in the front to protect your forehead, as shown in **Figure C**. Never wear the helmet tilted forward or backward. Note all adjustments must be made when the helmet is perfectly horizontal across the forehead. Failure to do so may result in an improper fit with risk of the helmet not being secured properly and may come off in an accident.

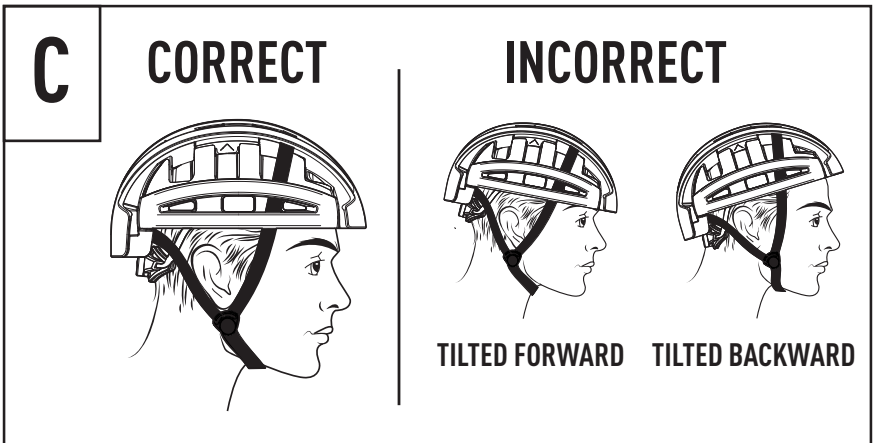

# OWNER'S MANUAL

## STRAP FIT

Fasten buckle securely under chin, as shown in **Figure D**. Pull strap tight for a customized fit. Make sure straps do not cover the ears, as shown in **Figure E**. Check all adjustments each time before use.

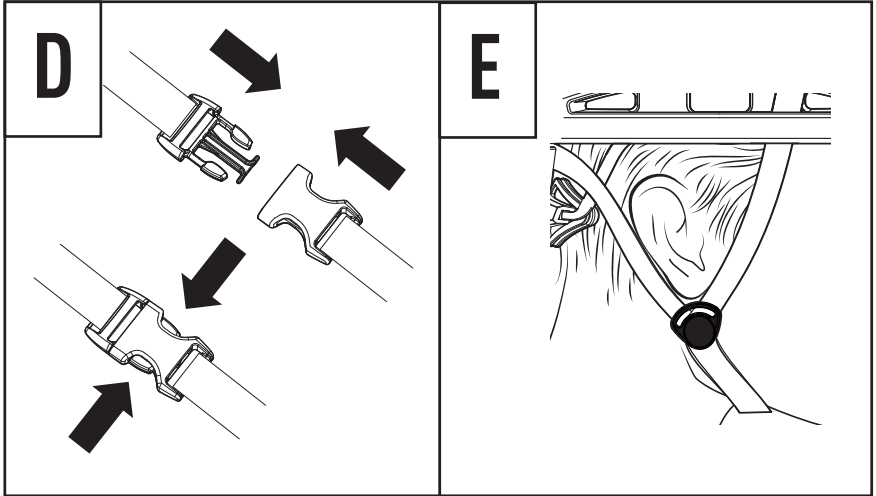

## REAR FIT ADJUSTER

Rotate rear dial clockwise to tighten and counterclockwise to loosen as shown in **Figure F**. Note the fit should be adjusted for your comfort and should not be uncomfortably tight.

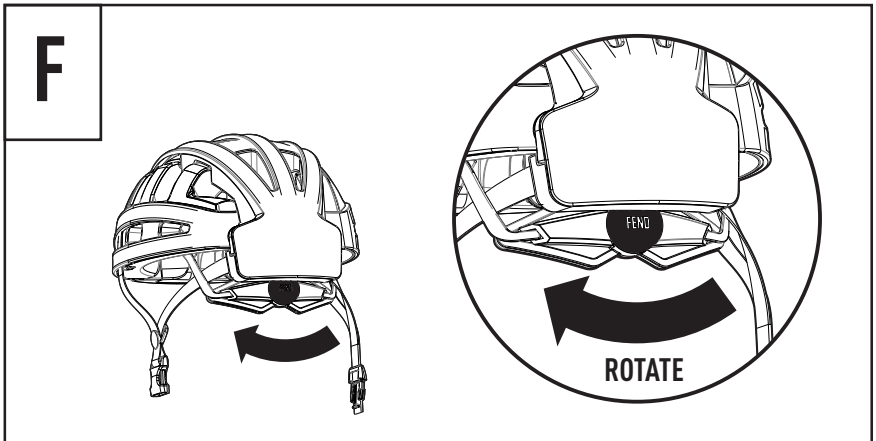

# OWNER'S MANUAL

## **FIT CHECK**

Once all adjustments are made, it is very important to check the fit. Stand in front of a mirror and grab the helmet with both hands. Twist left and right. Your forehead skin should move along with the helmet. Next, try to roll the helmet forward and backward. If it is able to be rolled off the head completely in either direction, it is not fit properly and needs to be readjusted. **WARNING:** If you cannot adjust the helmet to fit properly, it must not be used. Please consult with your dealer or contact FEND for further assistance.

## **CARE**

**WARNING:** Helmets can be damaged by certain cleaning solvents, including ammonia or bleach. The damage may not be visible to the user. Clean the helmet with a soft cloth using only warm water and mild soap. Note, the inner foam lining may be removed and washed separately. Do not dismantle or modify any part of the helmet, which will result in seriously jeopardizing its protective function.

## **STORAGE**

Store helmet in a cool, dry place. Excessive heat can damage the helmet. Direct sunlight and storing inside a car can cause heat damage. Heat damaged helmets should not be used.

## **1 YEAR LIMITED WARRANTY**

FEND guarantees to the original purchaser that this product is free of manufacturing defects for a period of one year from the original date of purchase. This guarantee does not apply to defects of physical damage resulting from abuse, neglect, improper repair, improper fit, alterations, or use not intended by the manufacturer.

If your FEND helmet is found to be defective in materials or production within one year from the original date of purchase, contact your dealer or FEND, who will at their discretion either repair or replace the helmet. FEND does not guarantee any helmet that is damaged due to heat or contact with solvents. This guarantee does not affect your statutory rights. This guarantee is in lieu of all other agreements and warranties, general or special, express or implied and no representative or person is authorized to assume liability on behalf of FEND in connection with the sale or use of this product.

**EU Type examination conducted by:** SGS United Kingdom Ltd,  
Weston-super-Mare, BS22 6WA, UK. Notified Body No: 0120

## **MANUFACTURED BY FEND CORP**

175 North 8th Street Suite 3R, Brooklyn, NY 11211

+1 646 647 0460

[www.fend.io](http://www.fend.io) - [help@fend.io](mailto:help@fend.io)

Declaration of conformity internet address is: [www.fend.io](http://www.fend.io)

**FEND**<sup>®</sup>

[www.fend.io](http://www.fend.io)