

FUTURA HOME

2000W Infrared Heater FUTIH2000W



REGISTER YOUR GUARANTEE

www.futura-direct.co.uk/guarantee

User Manual— Please read and retain for future reference

Thank you for choosing our Futura Infrared Heater. Please be sure to read this users' manual carefully before using the unit. If you should encounter any problems, please contact a qualified service technician for help.

Contents

Parts List

Technical Information

Safety Instructions

Using your unit

Maintenance

Warranty

Parts List

No.	Description	No.	Description
1	Small Cover	12	Back Board
2	Mesh	13	Connector
3	Decorated Board	14	Bigger Bracket
4	Transparent Window	15	Folded Board
5	Switch	16	Nut
6	Side Board	17	Bolt
7	Rubber Washer	18	Small Bracket
8	Wire Box	19	Side Board
9	Side Board	20	Side Board
10	Ceramics Column	21	Heating Element
11	Fixed Board	22	PCB

Exploded Assembly Diagram

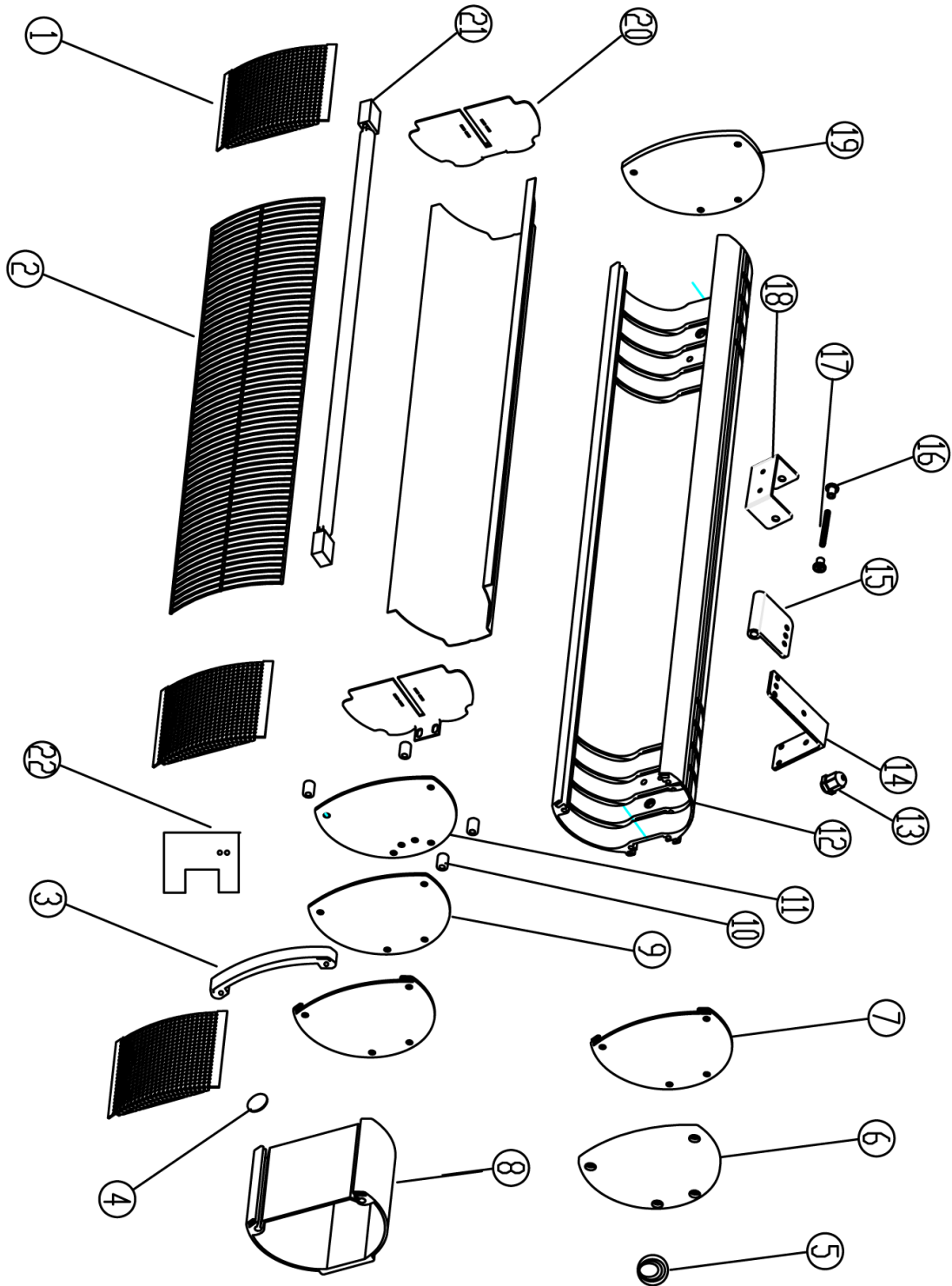

NOTICE: Actual product may vary from pictures shown.

Technical Information

2000W Infrared Heater

Model: FUTIH2000W

Voltage: 220 - 240V~ 50Hz

Rated Power: 2000 W

Heating Setting: 750W/ 1500W/ 2000W

Protection against electric shock: Class I

Protection against harmful ingress of water: IP65

IMPORTANT

Read these instructions fully before using the heater. Retain these instructions for future reference.

Safety Instructions

1. Please follow all the safety precautions listed below for safety and to reduce the risk of injury or electrical shock.
2. Read this Instruction Manual carefully to maximize this appliance's performance and keep for future reference.
3. If the mains cable is damaged it must be replaced by the manufacturer, its service agent, or similarly qualified persons in order to avoid a hazard.
4. The heater must not be located immediately below a mains socket.
5. Don't wrap the power cable around the unit.
6. Disconnect the appliance from the power socket when not in use or cleaning.
7. Damaged heater glass must be exchanged.
8. If has to be notified that the mounting in the bath must be so that the persons in the bath can not reach the controls.
9. Do not operate the appliance in direct sunlight, near heat sources, humid environments or in places near water or other liquids such as bathrooms, shower or swimming pool.

Warning!

The appliance must only be operated in a horizontal position with max±15° slope. In case of operations in angels larger than 5° in horizontal position or of vertical operations, the heating loop wire may fall into disuse shortly.

1. Do not use the appliance in areas where petrol, paints or other flammable substances are used or stored.
The minimum distance of your appliance from the ground is 1.8 m (6 feet).
2. The minimum distance of your appliance from the ceiling is 0.7 m (2.5 feet).
3. The minimum distance of your appliance from the animals is 1 m (3.5 feet).
4. The minimum distance of heating area of your appliance from the materials such as wood, carton, cloth etc., is 1 m (3.5 feet).
5. **WARNING:** In order to avoid overheating, do not cover the appliance.
6. Do not insert any object into the protective grid.
7. Do not make use of your heater to light up cigarette or similar materials.
8. This appliance can be used by children aged from 8 years and above and persons with reduced physical, sensory or mental capabilities or lack of experience and knowledge if they have been given supervision or instruction concerning use of the appliance in a safe way and understand the hazards involved. Children shall not play with the appliance. Cleaning and user maintenance shall not be made by children without supervision.

Special Instruction for Infrared Heater!

Do not place any objects such as furniture, papers, cloths, and curtains at least 0.9m (3 feet) from the front of the heater and away from the sides and rear when the heater is plugged in.

1. Do not place the heater near a bed because objects such as pillows or blankets can fall off the bed and be ignited by the heater.
2. Always unplug the heater if it is not being used.
3. Avoid the use of an extension cord because the extension cable may overheat and cause a risk of fire. However, if you have to use an extension cord, the cord shall be 14 AWG minimum size and rated not less than 2000 watts.
4. Do not operate within 7.6 m (25 feet) of flammable material.
5. Never block the front grill of the heater.
6. The heater is not suitable for hazardous locations.
7. Never attempt to service the heater without disconnecting its power source.
8. Take out the front grid to clean the reflector (reflecting mirror) and the filament and apply the related instructions.

Attention! Only technical services and persons authorized by SUN may serve, repair and replace the parts of this heater.

Using your Units

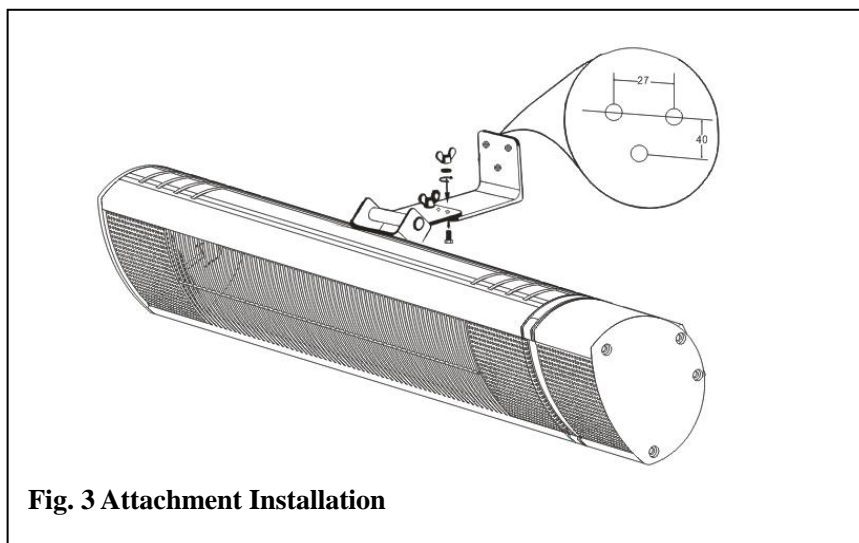
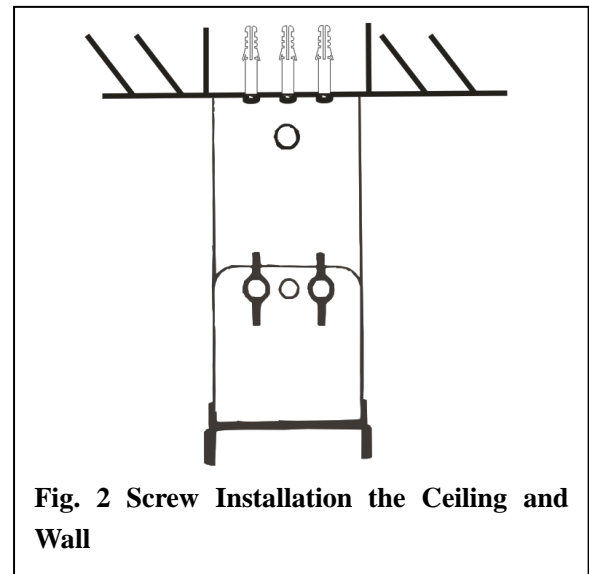
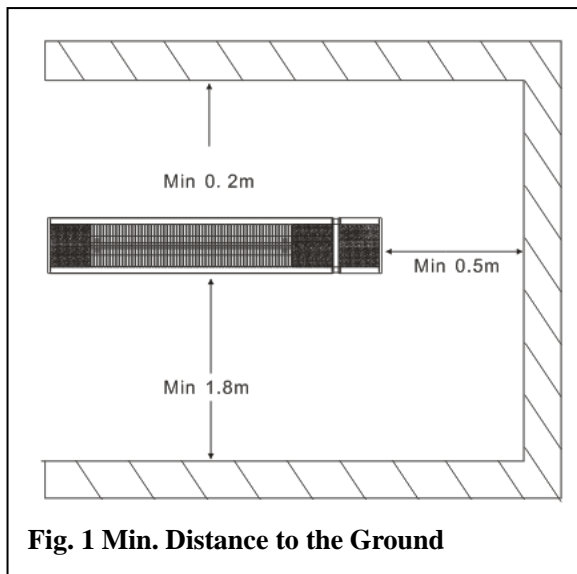

Before Installation

a. Before the installation, these matters need to attention:

1. Products should be put down gently
2. Acid and alkali environment installation is not recommended.
3. The product must be grounding.
4. The products are required to check the product brand mark on the voltage and the local voltage whether conform.
5. Ensure the power rating should have sufficient current carrying capacity.

b. Ensure the production's installation site

For the safe use of the product, the product installation position

should guarantee the bottom minimum height of 1.8 m from the ground, ceiling, roof, or other coverings minimum distance is 0.2 m, the minimum distance with both sides wall is 0.5 m (as shown in fig. 1).

c. Install set screw

According to the product installation location, three position with percussion drill diameter of 8 mm round hole (as shown in fig. 2), and then insert the expansion screws, respectively. Install the bracket in the wall and make sure the installation point security firm (as shown in fig. 3).

Installation the Infrared Heater

1. Attention before installation

- a) The product is fragile and should be taken gently.
- b) The installation is not recommended under some acid or alkali environment.
- c) Product must be reliable ground connection.
- d) Check the product rating label marking if it is consistent with local voltage.
- e) Ensure the power level have adequate current-carrying capacity.

2. Installation locations

In order to use the appliance safely, the distance of appliance from the ground should be a minimum 1.8m, the distance of appliance from the ceiling, roof or other coverings should be a minimum 0.2m, and the distance of appliance from the both sides of walls should be a minimum 0.5m (Fig. 1)

3. Install the fixed screw on wall

According to the appliance installation location, using percussion drilling to make three circle holes which diameter is 10-11 mm (Fig. 2), and insert the expansion screws respectively. Install the bracket on the wall and make sure it is safety and strong enough (Fig. 3).

4. Fix the product

Removing all the packages on the appliance (especially shake proof foam in the heating tube), fix the activity plate and bracket by butterfly screws and adjust the angle of the appliance.

Turn power on, observe 5 to 8 minutes, to make sure the functions are normal.

Operation: (Fig. 4 and 5)

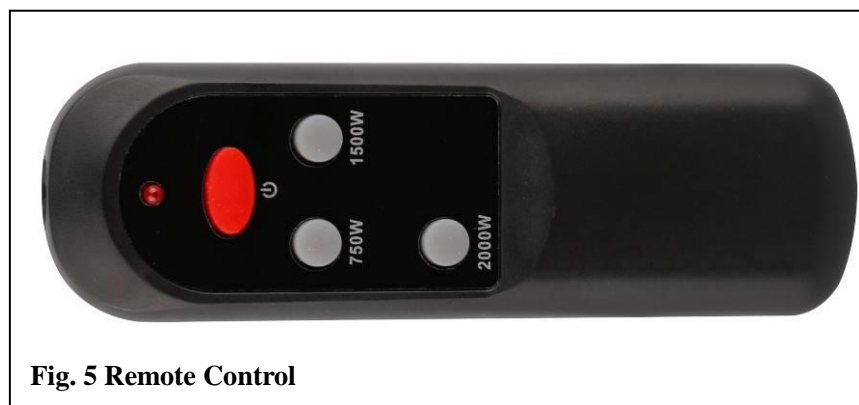
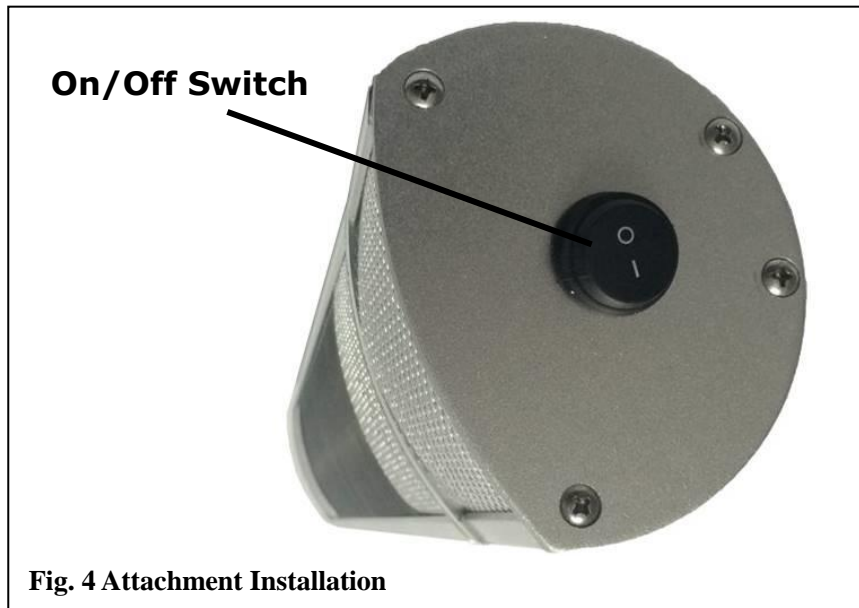

1. The heater must be supplied with proper voltage and frequency (AC220-240V, 50Hz), and connected to an individual, properly grounded branch circuit, protected by a circuit breaker which in accordance with wiring rules.
2. Only operate the heater after it is fixed. Our Electric Heater is equipped with remote controller.
3. To operate the heater, please firstly turn on the On/Off Switch. Then switch on the heater head is used the remote controller (5). There are 3 heating settings on remote controller 750W/ 1500W/ 2000W.

Maintenance:

Attention!

Careful and regular maintenance of Infrared Heater is required to attain a long and efficient operation of your appliance.

1. Check the cleanliness of the Reflector and IR-Filament at least once a month. If necessary, apply cleaning and maintenance instructions.
2. The number of checks may be increased considering the amount of the dust in the environment.
3. Check the deformation of the Reflector, Wire and Frame visually while cleaning the appliance. In case of any deformation, consult a qualified technician.
4. Check the power cable and plug visually while cleaning the appliance. In case of any deformation, consult a qualified technician.
5. It is recommended to change the reflector every 2 years for more efficient operation.

Cleaning

Attention!

Regular and careful cleaning helps your heater operate for longer years and more efficiently.

1. Unplug your power cable for your safety before cleaning your appliance.
2. Take out the front grid wire through the inlets on the frame using a slotted screwdriver.
3. Make sure that the power is off for your safety. Power cable plug must be unplugged.
4. The reflector and filament must be cleaned with a soft cloth, a smooth brush or cool or dry air. The cloth may be damp but never too wet and the cleaner should not include any chemical.
5. Refrain from using cleaning material likely to damage the reflector (cleanser etc.).
6. Insert the wire grid using a slotted screwdriver.

Disposal



Household Appliances, accessories and packaging should be sorted for environmentally-friendly recycling.

Only for EC countries:

Do not dispose of appliances into household waste!

According to the European Directive 2002/96/EC on waste electrical and electronic equipment and its incorporation into national right, products that are no longer suitable for use must be separately

collected and sent for recovery in an environmentally-friendly manner.

Declaration of Conformity

The declaration is to certify that it conforms to CE, EMC, LVD and RoHS directives:

EN55014-1:2006 + A1 + A2

EN55014-2: 1997 + A1 + A2

EN55015: 2013

EN61547: 2009

EN61000-3-2: 2006 + A1 + A2

EN61000-3-3: 2013

All provisions of Annex 1 of Council Directive 2004/108/EC – EMC directive

EN60335-1: 2012 + A11

EN60335-2-30: 2009 + A11

EN62233: 2008

EN60598-1: 2008 + A11

EN60598-2-1: 1989

EN62471: 2008

All provisions of Annex 1 of Council Directive 2006/95/EC – the Low Voltage Directive
RoHs 2011/65/EU



A handwritten signature in black ink, appearing to be 'Alan Garnett'.

Mr. Alan Garnett, UK QA Manager

Please read the following carefully

ACL Group (Intl) Ltd. and/or its distributor have provided the parts list and assembly diagram as a reference tool only. Neither ACL Group (Intl). Ltd. or its distributor makes any representation or warranty of any kind to the buyer that he or she is qualified to do any repairs or replace any parts of this product. ACL Group (Intl) Ltd. and its distributor expressly state that all repairs or parts replacement should be done by certified or licensed technicians. The buyer assumes all risk and liability arising out of his or her repairs or parts replacement to the original product.

12 Months Limited Warranty

If within 12 months from the date of purchase you experience any problems with your product, please return the product to its distributor/dealer for repair or replacement. This warranty DOES NOT COVER normal wear, or any damage as a result of accidents, misuse, abuse or negligence.

REGISTER YOUR GUARANTEE

www.futura-direct.co.uk/guarantee

Contact us at www.futuradirect.co.uk/contact

Register at www.futura direct.co.uk/guarantee

We ACL Group (Intl.) Ltd, England DN6 8LZ declare that the Heater is exclusively manufactured for Futura Direct Ltd and has been manufactured according to our full quality assurance procedures.