

BULKHEAD WEATHERSTRIP

2019-UP FORD RANGER

BH-6

10 MINUTES
 NORMAL INSTALL TIME

KEEP AN EYE OUT FOR THESE ICONS:

IMPORTANT!
 INSTALLATION INFO

HELPFUL TIPS
 TO ASSIST INSTALLATION

PARTS INCLUDED

 61" X5272 EPDM
 Weatherstrip

TOOLS REQUIRED



 Rubbing Alcohol
 or Glass Cleaner

 Clean, Lint-
 Free Cloth

 Sharp Razor
 or Small knife

Silicone

INSTRUCTIONS

 To ensure the weatherstrip sticks, make sure the surface temperature of the bulkhead is at least **50°F** and will remain so for at least a day.

1. Clean the top of the bulkhead thoroughly with a clean, lint-free cloth and rubbing alcohol or glass cleaner. Allow to dry.



 The top of the bulkhead should be both **dry** and absolutely **free of dirt**, oil, or any other contaminants prior to affixing the weatherstrip.

2. Peel the first few inches of adhesive backing from one end of the weatherstrip.

 *The adhesive is very sticky. Be careful to avoid sticking it to anything yet.*

3. At the bulkhead, put the peeled length of weatherstrip under the driver-side bed rail so that:

- its end touches the cargo bed wall *and*
- it lines up with the bulkhead.

 *The weatherstrip will be strongly pinched by the bed rail cap. That's OK.*

4. Starting on the driver side, slowly remove the remaining adhesive backing and affix the weatherstrip to the top of the bulkhead, pressing down firmly with your thumb as you go.

 *If there's a bed liner on the bulkhead, go ahead and affix the weatherstrip to it, but make sure to align the weatherstrip to the actual, painted metal bulkhead underneath.*

 **Never stretch** the weatherstrip when applying. If you do, its adhesive will **fail**.

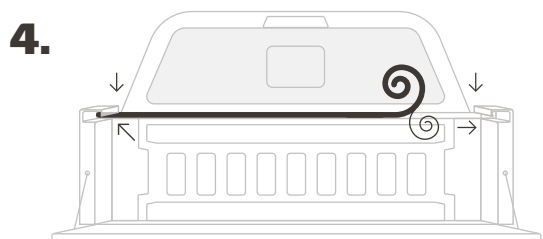
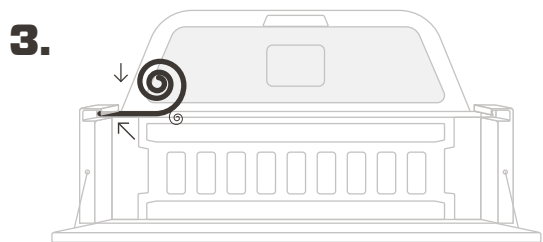
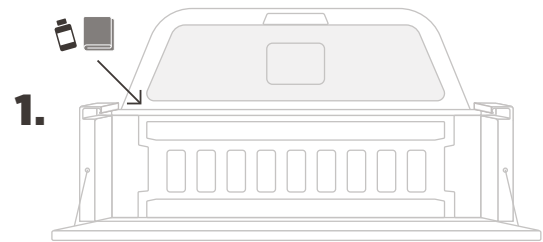

INSTRUCTIONS CONT'D

5. Put the passenger-side end of the weatherstrip under the bed rail.

☆ *The weatherstrip will be strongly pinched by the bed rail cap. That's OK.*

6. Use a sharp blade to score the weatherstrip where it meets the passenger-side bed rail cap so that the adhesive side is all that connects the segment under the bed rail to the segment on the bulkhead.

7. Repeat step 6 on the driver side.

8. Silicone each joint where the weatherstrip meets the bed rail caps.

9. After you have installed the cover, close the panels, get in the cargo bed, and look at the bulkhead for areas where daylight shines through. Silicone those areas.

10. After you have installed the cover, leave the cab panel(s) closed and locked for 24 hours to allow the weatherstrip adhesive, which is pressure-activated, to fully cure.

⚠ To ensure the weatherstrip sticks, make sure the surface temperature of the bulkhead is at least **50°F** and will remain so for at least a day.



5.

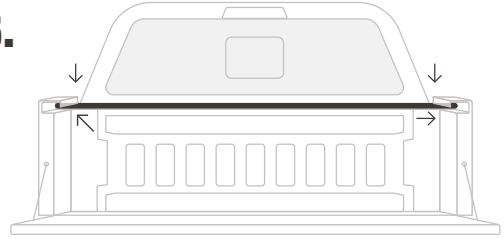

6-7.

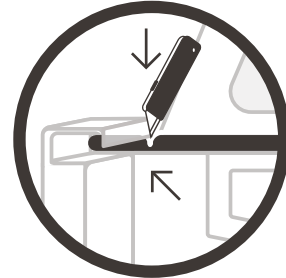

8.

