



DIAMONDBACK

DiamondBackCovers.com / 800 935 4002

DIAMONDBACK TOOLBAR

INSTALLATION GUIDE

DP-1

 **15 minutes**
Normal install time

Keep an eye out for these icons:

 **IMPORTANT!**
Important installation information

 **Helpful Hints**
Tips to assist installation

PARTS INCLUDED:

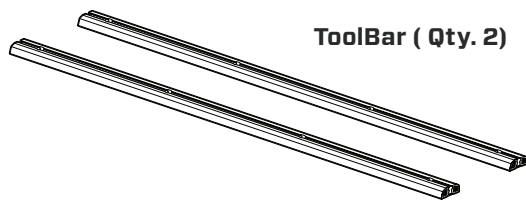

ToolBar (Qty. 2)

Installation Hardware



10-32x3/4"
Button Head
Screws (8)



10-32 Rubber
Well Nuts (8)

Tool Mounting Hardware

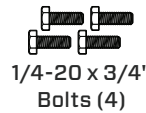

1/4-20 x 3/4"
Bolts (4)

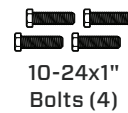

10-24x1"
Bolts (4)



10-24x1" Flat
Head Screws (4)



1/4-20 Mounting Nuts (6)



10-24 Mounting Nuts (6)

TOOLS REQUIRED:



Drill



3/8" Bit



1/8" Hex Key
(One came with your cover)



Marking Utensil
(A Silver/Black marker
is our favorite)



Tape Measure
(optional)

INSTRUCTIONS

1 Determine where you would like to mount the ToolBar. One of our favorite locations is centered on the structural studs of the DiamondBack Cover.

2 Open the desired panel and pull the gas spring off the access panel ball stud by flipping the quick-release tab outward to the open position. If necessary, disengage the safety catch.

 If you disengage the safety catch, be sure to reattach properly.

3 Fold this panel all the way over and rest on the opposite panel. This allows for a nice flat workspace.

 If you have a top-mounted accessory that prevents the panel from being folded completely over, this process can be completed with the cover closed or in the open position.

4 Place the ToolBar in the desired location and mark the 4 mounting holes.

5 Place the ToolBar off to the side and drill each of these marks with the 3/8" drill bit.

6 Once the holes are drilled, locate 4 of the rubber well nuts. Place one of these in each of the drilled holes.

 Well nuts have a grip range of 0.015" - 0.188". Do not mount ToolBar using the well nuts on material outside of this thickness.

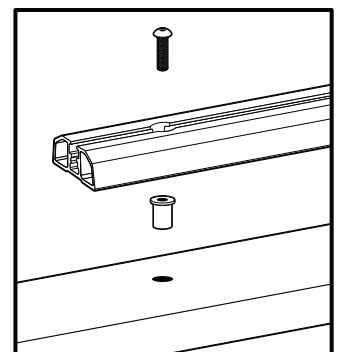

CONTINUED ON REVERSE >

INSTRUCTIONS (CONTINUED)

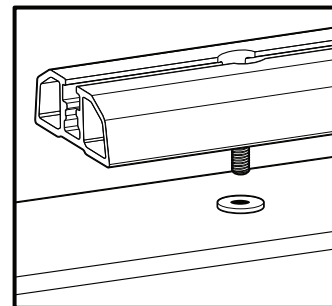
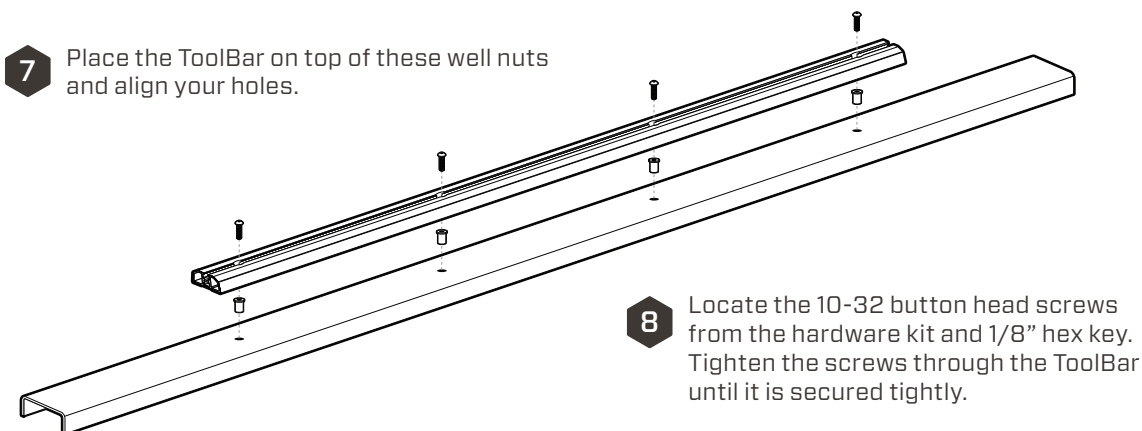

TOOL MOUNTING HARDWARE



QUICK FIST CLAMPS

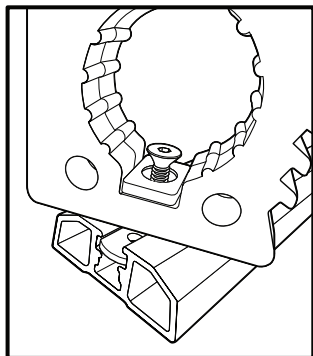

The ToolBar is compatible with Quick Fist clamps. To install, locate the included #10-24 flat head screw and #10-24 mounting nut from the hardware kit. Insert screw into the plastic washer (included in Quick Fist packaging) and Quick Fist clamp. Partially thread the mounting nut onto the screw. Slide the mounting nut into the end of the ToolBar and tighten the screw at the desired location.