

12" ANSI RFF Carbon Steel MAG meter Specifications

Specifications.

- Electrode Material: Titanium
- Wetted Materials Teflon, Titanium
- Flow Body Material Carbon Steel
- Flow Velocity .01 - 15 m/s Nominal 0 - 3 m/s
- Water flow scaleable range 1,200 to 16,500 GPM
- Accuracy: +/- 0.5% of reading in water.
- Repeatability of +/- 0.15% of reading
- 12" 150# ANSI Flange Connections.
- LCD Display
- Temperature:
 - Gas: 14°F (-10°C) to 350°F (180°C)
 - Ambient: 14°F (-10°C) to 140°F (60°C)
- Power Requirement: 24 VDC 20 Watts maximum;
- Output signals: Modbus RTU, 4–20 mA; transmit up to 3000 feet
- HART as an option
- 0-10 KHz for flow rate indication
- Digital communications: Modbus RTU
- Proof Pressure 1.6 MPa, 230 PSIG.
- Display: Flow rate, Flow Rate 0-100%, and Total flow
- Wiring connection to enclosure size: M20 x 1.5
- Factory Final QC Test Certificate
- Integral Electronics installation
- Electronics Enclosure: IP65
- Meter weight approx 180 pounds
- Shipping weight, approx 220pounds



Stainless steel electrodes in Teflon



12" ANSI RFF Carbon Steel MAG meter Dimensions

ANSI Size	DN Size	L		b		N-Dia		N	H		D		WFB Diam		WD Diam		WB Width	
		inches	mm	inches	mm	inches	mm		inches	mm	inches	mm	inches	mm	inches	mm	inches	mm
8"	200	13.386	340	1.142	29	11.752	298.5	8@0.866	21.654	550	13.583	345	8.661	220	11.811	300	7.087	180
10"	250	17.323	440	1.181	30	14.252	362	12@1.024	23.622	600	15.945	405	10.827	275	14.764	375	9.843	250
12"	300	19.291	490	1.260	32	17.008	432	12@1.024	26.772	680	17.008	432	12.835	326	16.850	428	11.811	300

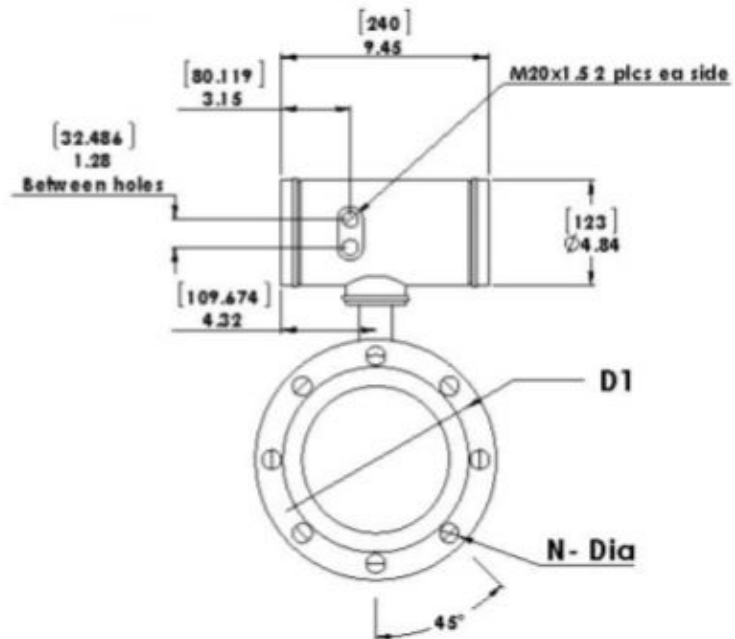
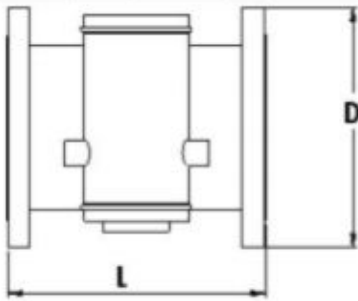

Contact Info:

Tactical Flow Meter
 22642 Indian Springs Road
 Salinas, CA 93908
 email: Dave.Korpi@TacticalFlowMeter.com
 Phone: (831) 455-0418
 Web: <https://www.tacticalflowmeter.com>