

**Kodak**

# Video Monitor

CFH-V10



Quick Start Guide

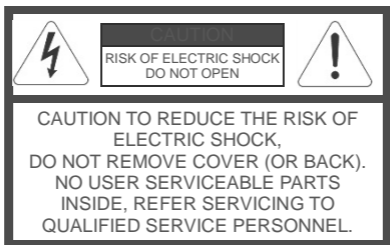

This symbol is intended to alert the user to the presence of uninsulated "dangerous voltage" within the product's enclosure that may be of sufficient magnitude to constitute a risk of electric shock to persons.



The exclamation point within an equilateral triangle is intended to alert the user to the presence of important operating and maintenance (servicing) instructions in the literature accompanying the product.

## Warning

To prevent fire or shock hazards, do not expose this product to rain or moisture.

Do not expose the product to dripping or splashing and never place anything containing water or liquid, such as a vase, on the product.

To avoid electrical shock, do not open the cabinet. Refer servicing to qualified personnel only.

## **Regulatory Notices for USA**

This equipment has been tested and found to comply with the limits for a digital device, pursuant to Part 15 of the FCC Rules. These limits are designed to provide reasonable protection against harmful interference in a residential installation. This equipment generates, uses, and can radiate radio frequency energy and, if not installed and used in accordance with the instructions, may cause harmful interference to radio communications. However, there is no guarantee that interference will not occur in a particular installation. If this equipment does cause harmful interference to radio or television reception, which can be determined by turning the equipment off and on, the user is encouraged to try to correct the interference by one or more of the following measures:

- Reorient or relocate the receiving antenna.
- Increase the separation between the equipment and receiver.
- Connect the equipment into an outlet on a circuit different from that to which the receiver is connected.
- Consult the dealer or an experienced radio/TV technician for help.

You are cautioned that any changes or modifications not expressly approved in this manual could void your authority to operate this equipment.

The shielded interface cable recommended in this manual must be used with this equipment in order to comply with the limits for a digital device pursuant to Subpart B of Part 15 of FCC Rules.

## Camera Mounting

To mount the KODAK Video Monitor CFH-V10 to a wall, unscrew the base of the camera and remove the metal plate.

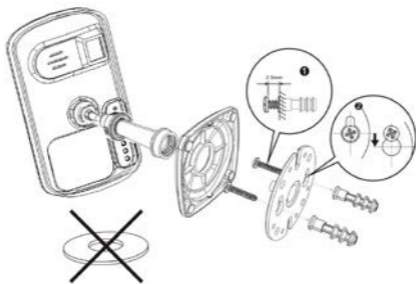

With the included screws and anchors, fasten the mounting bracket onto the wall. Then, reattach the base cover and screw the stand back onto the mounting bracket.

## 1. iSecurity+ App



To get started, download the iSecurity+ app from Apple's App store or the Google Play Store.

## 2. Connect to Power



Connect the KODAK Video Monitor CFH-V10 to the AC power adapter, then plug the power cord into the electrical outlet.

### 3a. Wi-Fi Setup Mode



Please make sure the “Wi-Fi Setup” switch on the back of the camera is set to ON.

The “Wi-Fi Setup” indicator will glow green when the KODAK Video Monitor CFH-V10 is ready for setup. (This may take up to 2 minutes when the camera is first powered on.)

## 3b. Connect to KODAK Video Monitor CFH-V10

iPhone

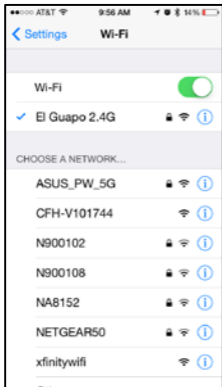

Android



Go to Settings -> (Wireless & Networks for Android) Wi-Fi on your device and connect to the KODAK Video Monitor CFH-V10 network (denoted by "CFH-V10" plus the last 4 digits of its CAM ID, which can be found on the back of the camera).

## 4a. Launch iSecurity+ App

Once your device establishes its connection to the KODAK Video Monitor CFH-V10, (usually takes around 30 seconds) launch the iSecurity app. The iSecurity+ app will automatically detect your camera. When prompted, click 'Yes' to setup your camera.





## 4b. Setup Wizard

Follow the instructions in the Camera Setup Wizard to complete installation.



## 4c. Camera initialization

Once you see the page below, follow the directions to initialize your camera.



## 4d. Setup Complete

Once you see the page below, the setup process has been completed. Restart iSecurity+ and please log in again.



You can use your iOS/ Android devices to access the camera anywhere in the world. Make sure your phone has access to the internet via 3G, 4G or Wi-Fi for internet connection.

## 5. Using iSecurity+

Please enter your user name and password, created during the setup process, in the login window to access your KODAK Video Monitor CFH-V10.



## 6a. iSecurity+ Features – Main Window

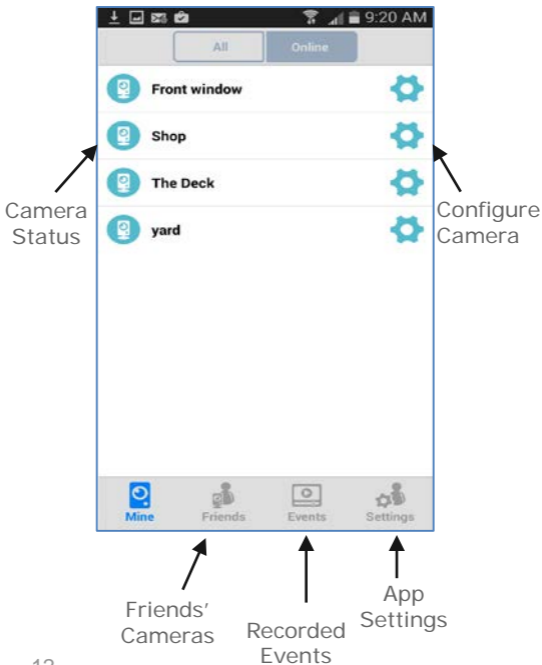

## 6b. iSecurity+ Features – Camera Viewer

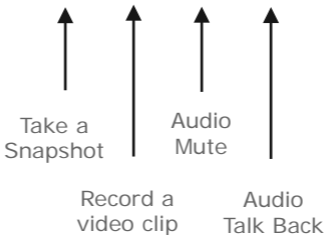
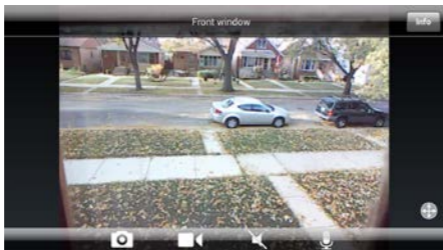

## 7. Electronic PTZ Function

In order to use the Electronic Pan/Tilt/Zoom function on the camera, you will need to zoom in on the live video stream first.

### Zooming In -

Touch the screen with two fingers together and slide outward at an angle and the image will zoom in.

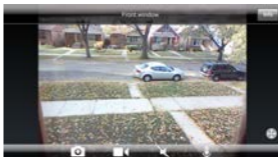

### Zooming Out -

Touch the screen with two fingers apart and slide inwards at an angle and it will zoom out.



### Pan/Tilt-

Swipe directional controls to change the camera pan & tilt view.

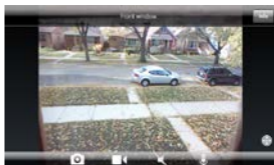

## 8. Audio Talkback

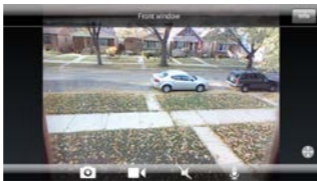

1. To use Audio Talkback, first press the Audio button to initiate sound to listen in.
2. Then press and hold down the Audio Talkback button and speak into your device, then let go for the audio to transfer to the camera's speaker.

## **Safety Information**

Do not point the camera directly at the sun, or else it will damage the image sensor.

Keep the camera away from heat to avoid electric shock.

Keep the camera away from rain and moisture.

Do not attempt to open, dismantle, repair, or service the camera. Doing so may cause electric shock and other hazards.

Any evidence of misuse, abuse, or tampering will void the Limited Warranty.

To maintain compliance with FCC's RF exposure guidelines, this equipment should be installed and operated with minimum distance of 20 cm between the radiator and your body. Use only the supplied antenna.



## Troubleshooting



LED Status Indicators



### Wi-Fi Setup

- Green: Setup mode on
- Orange: Setup mode initializing
- Light Off: Setup mode off



### Network

- Green: Connected to iSecurity+
- Flashing Green: Connected to the Internet
- Orange: Connected to local network
- Flashing Orange: Not connected to any network



### Power

- Green: Power On

## **For More Information**

For support or to learn more about KODAK Connected Family Home products, please visit:

**[www.connectedfamilyhome.com](http://www.connectedfamilyhome.com)**

To get the latest software updates or to learn more about iSecurity+, please visit:

**[www.isecurityplus.com](http://www.isecurityplus.com)**

### **Limited One Year Manufacturer Warranty**

Seedonk Inc. will repair or replace (at our discretion) your camera unit free of charge (except shipping) for 12 months from the date of purchase, if unit is defective. The customer should return the defective unit to the original place of purchase first, based on its return or refund policy. In case the original vendor's return/refund policy has expired and this unit is still within the limited manufacturer's warranty, customer can call 1-800-329-0223 or email us at [support@seedonk.com](mailto:support@seedonk.com) to get RMA ID and shipping instructions. Camera must be shipped with proof of purchase. Customer will need to pay freight for shipping the defective camera. Seedonk will be responsible for freight of defective camera. In the absence of a purchase receipt, the warranty period shall be 12 months from the date of manufacture of the camera itself.

In no event, shall Seedonk be liable for any special, incidental, or consequential damages for breach of this or any other warranty, express or implied, whatsoever.

The detailed terms and conditions are on SEEDONK website.

# Kodak

## Video Monitor

CFH-V10



The Kodak trademark and trade dress are used under license from Kodak

For more information visit:  
[www.connectedfamilyhome.com](http://www.connectedfamilyhome.com)

Apple, iPad, and iPhone are trademarks of Apple Inc.  
Android is the trademark of Google Inc.

© 2014 Seedonk, Inc. All rights reserved

Made in China