

# i3 PRO

COFFEE GRINDER

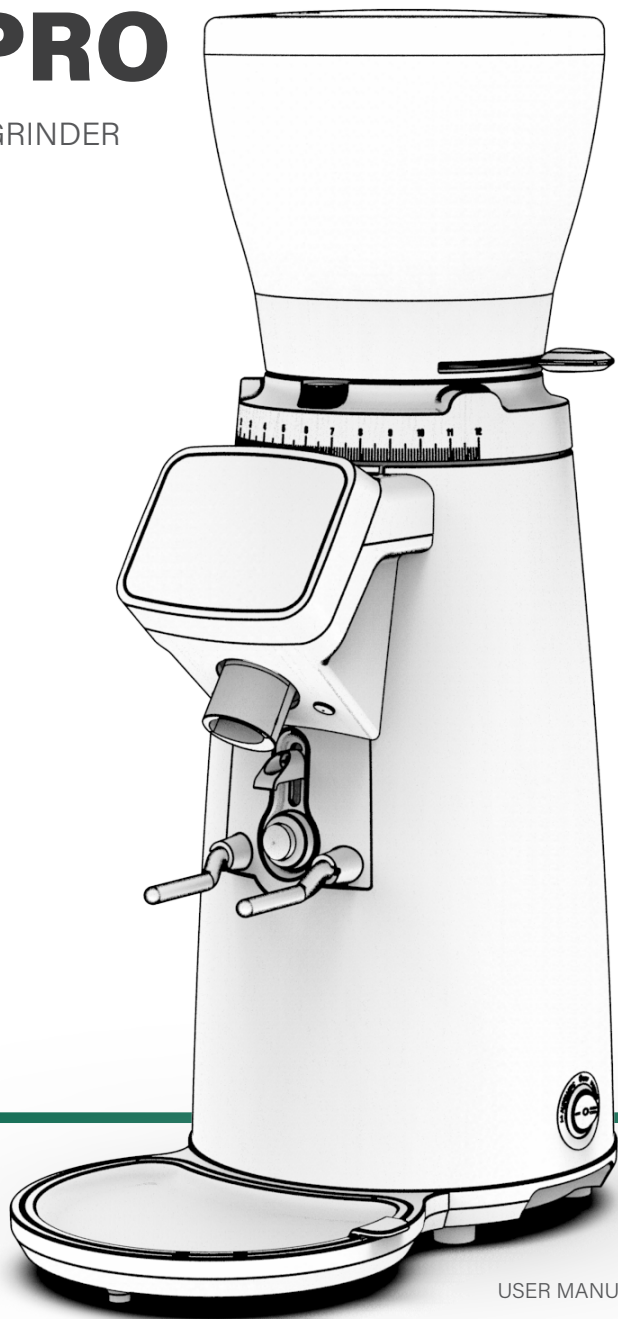

USER MANUAL

**COMPAK**



# i3 PRO

## COFFEE GRINDER

1. SAFETY	4
2. DESCRIPTION	6
3. INSTRUCTIONS	6
4. IDENTIFICATION	7
5. TECHNICAL CHARACTERISTICS	7
6. EXTERNAL COMPONENTS	8
7. INSTALLATION	9
8. ADJUSTMENT	10
9. OPERATION	13
10. SETTINGS	13
11. CLEANING	14
12. MAINTENANCE	15
13. DECLARATION OF CONFORMITY	18

---

# 1. SAFETY

---

## ADDITIONAL SAFETY MEASURES BUILT-IN TO OUR GRINDERS:

---

- **Special screw to keep the hopper fixed.**



This coffee grinder should only be used for the function for which it was designed: **grinding coffee beans.**



**Do not use the grinder to grind other types of foods** such as nuts or to grind finer granulated foods such as sugar and others.



This device **may be used by children aged 8 years and over, by people with reduced physical, sensory or mental capacities and by people without prior experience/knowledge,** provided they have received supervision or instructions on the safe use of the device and understand the associated risks.



**Children should not play with the device.**



Cleaning and maintenance of the device should not be carried out by children without supervision.



**Do not allowing liquids to come into contact with internal or external** surfaces

while the appliance is on or off, except for those parts expressly mentioned in the "CLEANING" section. If, for any reason, this happens, disconnect the power supply immediately and dry all surfaces carefully.

---

## 1. SAFETY

---

**USERS SHOULD PAY SPECIAL ATTENTION TO, AND SCRUPULOUSLY OBEY THE FOLLOWING SAFETY INSTRUCTIONS**



If it is necessary to access the interior, where the electrical components are located, **go to the nearest technical service**



**In the event of any component breaking, or for any intervention we recommend contacting a technical services centre**, who will carry out the repair or replacement, guaranteeing that safety standards are adhered to.



**If the supplied cord is damaged**, it must be replaced by the manufacturer, its service agent or similarly qualified persons in order to avoid a hazard.



**Any other use will be considered improper and dangerous.**



**NOTE: The manufacturer will not be liable for damage caused either by the improper use of the device or by not following the stated safety measures.**

## 2. DESCRIPTION

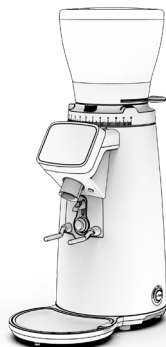

Your new grinder has been designed using the most sophisticated technologies in existence. **The result is a product of high quality that offers the assurance of the best results possible.** Our products are manufactured by hand, one by one, following the strictest quality requirements. In the manufacturing process, we use only the highest quality materials (aluminum, stainless steel, etc.) especially designated for being in contact with food stuff.

For the optimal functionality of the grinder model described in this user manual, the maximum work cycles are as follows:

Model	Work cycle	
	ON	OFF
i3 PRO	7 sec	60 sec

### SOUND LEVEL

The level of sound emitted is:

Sound level	With coffee
i3 PRO	78,5 dB

## 3. INSTRUCTIONS



**3.1.** This manual is designed to provide the necessary information to correctly install, use and maintain the grinder, as well as to highlight precautions for users to keep in mind.

To ensure the best operation of the coffee grinder, please follow the instructions as outlined in this manual.



This manual should be saved for the life of the grinder, and should always be at the disposal of the operator.

**3.2.** This manual uses some special terms, such as:

- **Text in bold** to highlight the importance of some terms.
- **Numbers in parentheses after a word, which match the numbering of the items** in the image to the side or in the image of the external components.

Example: (1) - 1 Hopper Lid.

Icons:

Information	Warning
	

## 4. IDENTIFICATION



The technical characteristics plate is indelibly marked with the following information:

**COMPAK** **CE**

Made in Spain

<b>MODEL</b>		<b>SERIAL NUMBER</b>
	<b>DATE</b>	<b>ORDER</b>
<b>ELECTRICAL DATA</b>		
<b>OPTIONS</b>	<b>OBSERVATIONS</b>	

COMPAK Coffee Grinders s.a. Moli Barri, B. P.I. Can Barri 08-415 Bigues, Barcelona, Spain.  
IPX1 COFFEE GRINDER

**i** **NOTE:** The manufacturer reserves the right to change the machine components, according to the requirements of each market, and also for technological advances.

## 5. TECH. CHARACTERISTICS

### 5.1. SCOPE

The coffee grinders are intended for commercial applications where ground coffee must be used, or in small shops selling coffee, but not for continuous mass production of food.



**This grinder should only be used to grind coffee beans.**

**Any other use is considered improper and dangerous.**

**i** **NOTE:** The manufacturer is not liable for damage to persons, goods or the machine itself, if the safety regulations given in this manual are not followed, or the machine is used incorrectly.

### 5.2. TECHNICAL DATA

	100 V 50 Hz	100 V 60 Hz	110 V 60 Hz	220 V 60 Hz	230 V 50 Hz	240 V 50 Hz	
<b>Electrical Power</b>	540	650	715	530	500	520	W
<b>Spin Speed</b>	1320	1620	1640	1700	1380	1400	rpm

<b>Ø Flat Burrs</b>		<b>Production 50 Hz*</b>	<b>Production 60 Hz*</b>	<b>Time for one dose (7g) 50Hz</b>
58	2,3	2,5	3,1	2,7
<b>mm</b>	<b>in</b>	<b>g/s</b>	<b>g/s</b>	<b>s</b>

<b>Time for one dose (7 gr) 60Hz</b>	<b>Hopper capacity</b>		<b>Net weight</b>		<b>Height Width Depth</b>	
2,4	0,7	1,54	8,07	17,79	515 190 315	20,3 7,5 12,4
<b>s</b>	<b>Kg</b>	<b>lb</b>	<b>Kg</b>	<b>lb</b>	<b>mm</b>	<b>in</b>

\* Production based on a medium roast coffee and Espresso grinding point.

## 6. EXTERNAL COMPONENTS

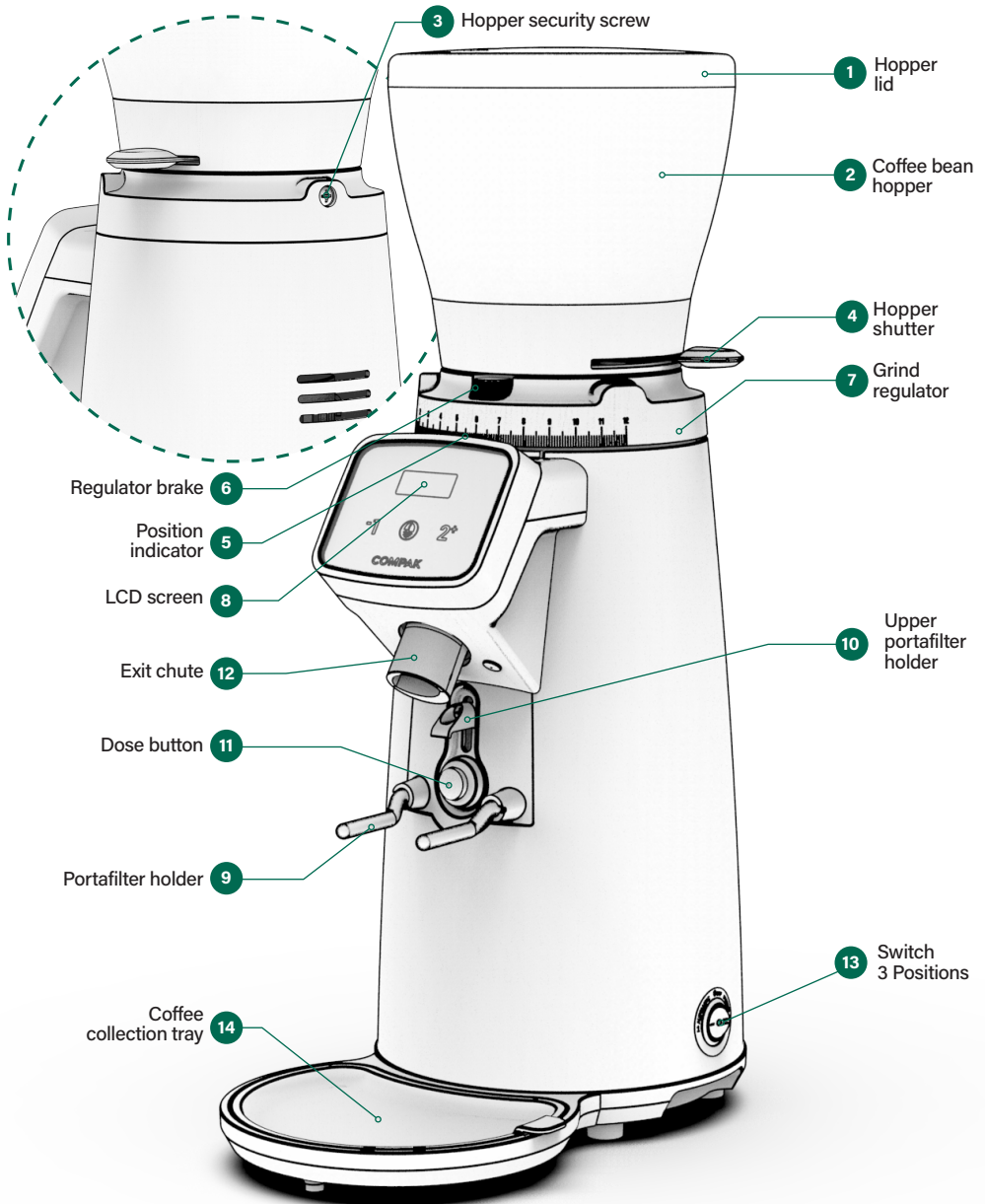



## 7. INSTALLATION

### 7.1. LEGAL NOTICES

 The installer must read this instruction manual carefully before installing the machine.



The installation of the device must be carried out by qualified and authorised personnel, obeying all the current safety and hygiene regulations.

### 7.2. IMPORTANT WARNINGS

 The operator must be a responsible adult. Never a child nor someone without the ability to accept that responsibility.

**When handling the grinder, the following precautions should be obeyed:**

- When removing the grinder from the packaging, always pull it by the handles of the bag.
- Feet must not be bare.
- Hands and feet must be dry.
- Do not get the machine wet.
- Do not expose the machine to direct sunlight or other atmospheric agents.
- Never insert any object into the coffee inlet or outlet while the appliance is running. (Please remember that when the grinder stops, the burrs will keep turning for a short while).
- When unplugging the grinder, always pull on the plug and never the power cable to avoid a possible short circuit.
- Care is needed when handling cutting burrs during cleaning.

 **NOTE:** This coffee grinder should not be installed in places (SUCH AS INDUSTRIAL KITCHENS) where are expected to be cleaned using water jets or a steam cleaner.

### 7.3. WHERE TO USE IT

 The appliance must be installed on a solid and flat surface.



The minimum size for the working space, to ensure you get the best performance from the machine, must be the following:

Model	i3 PRO	
Height	535 21	mm in
Width	210 8,3	mm in
Depth	360 14,2	mm in

- Install the grinders on tables that are completely level and in areas free from external vibrations
- Install the grinders in areas where there are installations with a ground connection.
- Avoid places where abrupt changes in temperature, humidity or airflow may occur.

### 7.4. INSTALLING THE COFFEE GRINDER

Before connecting the coffee grinder, check the following:

- The characteristics on the data plate must match those of the electrical mains network.
- The electrical connection plug matches the socket into which it is to be plugged.
- Ensure that the electrical power of the facility is adequate for the power consumed by the appliance.
- The point of connection to the electrical mains network must be protected with the appropriate electrical protection device.
- The equipment must be correctly connected to a ground connection according to the current safety regulations.

## 8. ADJUSTMENT

### 8.1. GRINDER SET UP

Place the hopper (2) on the grind regulator (7) and make sure the bean trap (4) is in the closed position (Fig. 1).

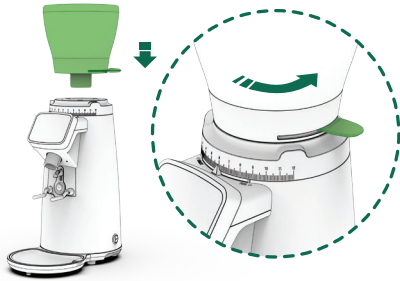

Fig. 1

Lock the hopper (2) in place using a phillips head screw driver to gently tighten the hopper security screw (3) (Fig. 2).



Fig. 2

Remove the hopper lid (1), fill the hopper with coffee (2), and replace the lid on the hopper (4) (Fig. 3).



Fig. 3

Plug in the grinder, and place the main power switch (13) **I - 1 AUTOMATIC / 0 - 0 OFF / II - 2 MANUAL** to position **I - 1 AUTOMATIC**, and open the bean trap (4) to allow coffee to pass into the grind chamber.

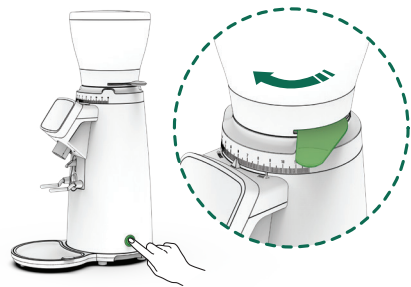

Fig. 4

## 8. ADJUSTMENT

### 8.2. ADJUSTING THE TOP PORTAFILTER SUPPORT

In order to ensure the proper distribution of ground coffee in the portafilter, while supporting the portafilter in a hands-free position during dosing, it is possible to adjust the height of the upper portafilter support (10).

To do this adjustment operation:

1. Loosen the screw on the upper support (10) by using a #2 Philips screw driver.
2. Adjust the support to the desired height using the portafilter as the point of reference.
3. Tighten the screw with the #2 Philips screw driver (Fig. 4).

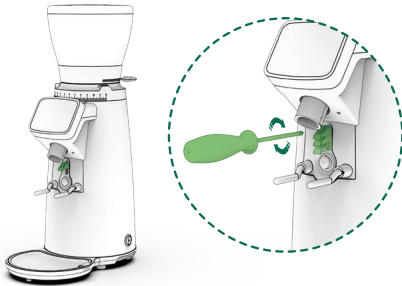

Fig. 4

### 8.3. ADJUSTMENT OF THE ALUMINUM PORTAFILTER HOLDER (OPTIONAL)

In some grinders, it is possible that the portafilter holder is made of aluminum. If this is the case, it is possible to adjust the height of the lower portafilter holder and also adjust the position of the portafilter forward and backward in relation to the coffee outlet.

To perform this adjustment:

1. Loosen the screw on the lower holder using the hexagonal Allen wrench No. 3 included with your grinder.
2. Adjust the holder to the desired height, using the portafilter as a reference point.
3. Tighten the screw using the provided hexagonal Allen wrench No.3 (Fig. 6).

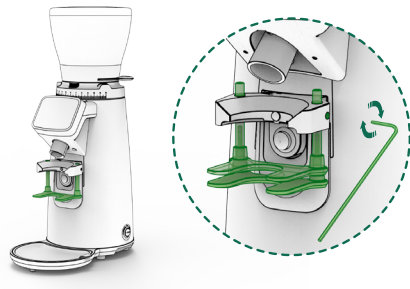

Fig. 6

## 8. ADJUSTMENT

4. With the provided hexagonal Allen key number 3, tighten or loosen the screw located on the front of the portafilter to find the correct position as seen in (Fig. 7 y Fig. 8).

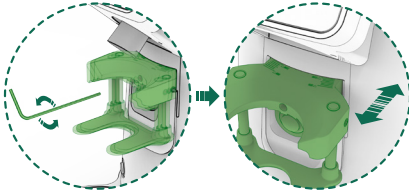

Fig. 7

Fig. 8

Once you reach the desired grinding point, you can lock the grinding regulator using the regulator brake. (6) (Fig. 6).

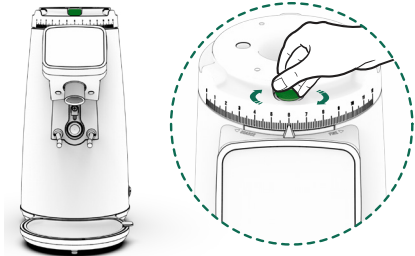

Fig. 6

### 8.4. GRIND ADJUSTMENT SYSTEM

Rotate the grind regulator (7) until reaching the grind level desired.

Rotating the grind regulator clockwise will result in a courser grind; turning the regulator counter clockwise will result in a finer grinder (Fig. 5).

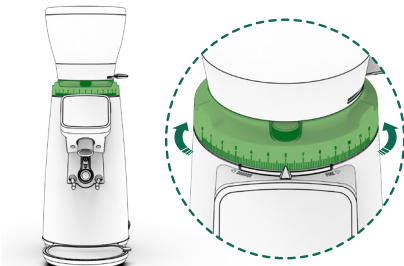

Fig. 5

**!** NOTE: It is recommended that this operation be performed, when changing to a finer grinding, with the motor running, to prevent coffee from building up between the burrs and blocking the grinder.

**!** NOTE: If the coffee throughput is very low, this is because the coffee is being ground very fine. If the throughput is very high, this is because the coffee is being ground very coarse. A perfect Espresso is produced when the grinding gives an infusion of 25 ml of coffee in 25 seconds using about 7 g of ground coffee.

## 9. OPERATION

### 9.1. MAIN SWITCH

The main switch (13) has the following positions:

**I / 0 / II (Fig. 7)**

	i3 PRO
The equipment's electronic functions are activated	I
Equipment off	0
Equipment in manual mode. Backup system that allows the equipment to be used in the event of a fault in the power board or keypad. When in manual mode, the equipment starts grinding until the switch is set to OFF.	II



Fig. 7

## 10. SETTINGS

### 10.1. DISPLAY ICON GUIDE

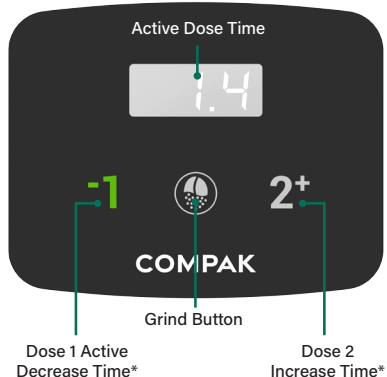

\* Once the time configuration mode is on.

### 10.2. UTILIZATION

A pre-programmed single or double can be set by simple pressing the corresponding icon on the LCD screen.

The preselection of a single or double dose will remain active until it is changed by pressing one of the two numbered preselect icons. This preselection is reflected on the LCD screen with the icon of the active selection in the secondary color, and the rest of the icons in the principle color.

Dispensing the preselected dose by pressing the lower pulse button (11) one time. When the grinding cycle begins, a timer countdown will begin on the LCD screen, which will count down the timed dose cycle to zero.

### 10.3. GRIND TIME CONFIGURATIONS

To set up dose time, simultaneously press the number of the desired dose to be configured and the Grind button 2 seconds until it blinks.

Pressing to decrease or to increase the time until get the desired, to confirm press the Grind Button.

---

# 11. CLEANING

---

## 11.1. GENERAL CLEANING

**11.1.1** To ensure that the grinder functions properly, and produces the highest quality grind possible, the parts that come into contact with coffee should be cleaned periodically.

General Cleaning guidelines as follows:

- Always turn the main power switch to the off position (13).
- Unplug the machine from the power source.
- Do not submerge the grinder in water or use power washing devices.
- The appliance is not to be cleaned with a water jet.

## 11.2. BEAN HOPPER CLEANING

**11.2.1** In order to properly clean the bean hopper (2), first empty out all remaining beans and fragments.

To remove the hopper, first close the bean trap (4), and then loosen the hopper lock screw (3) and lift the hopper straight up.

Clean the hopper (2) with a moist soft cloth or with a small amount of water and neutral soap to eliminate any oily residue from the beans.

Replace the bean hopper (2) following the same steps as the removal process, but in reverse.

## 11.3. CLEANING THE GRIND CHAMBER

**11.3.1** It is recommended that the grind chamber be cleaned monthly with a cleaner. This process will eliminate smelly residues from the coffee remains, which can negatively affect the quality of the brewed coffee.

Care is needed when handling cutting burrs during cleaning.

The steps to follow are:

In order to properly clean the bean hopper (2), first empty out all remaining beans and fragments.

- Close the bean trap on the hopper (4) and grind out the remaining coffee in the grind chamber.
- Pour the recommended grinder cleaning product into the bean hopper (2) and open the bean trap (4), allowing the cleaning product to pass into the grind chamber.
- Grind the cleaning product at a medium coarse grind setting until the recommended amount is passed through the system and nothing remains in the grind chamber.
- Clean the hopper (2) and refill with coffee beans.
- Discard the first 2-3 doses of coffee to assure that the residual cleaning product is removed from the grind chamber and set the grind regulator to the desired setting (7).
- Following these steps will ensure that the grinder is clean and ready for use.
- We do not recommend the taking apart of the grind assembly unless changing burrs, or removing a blockage/obstruction in the grind chamber. Removal of the grind assembly should be performed by a qualified service technician.

---

## 11. CLEANING

---

### 11.4. CLEANING THE OUTSIDE OF THE GRINDER

**11.4.1** To clean the exterior of the grinder, first wipe with a dry soft cloth, and then gently wipe with a damp cloth and neutral soap.

### 11.5. CLEANING THE TOUCH SCREEN

**11.5.1** Proper cleaning should be done with a soft, damp microfiber towel. Preferably distilled water or other cleaning product specifically designed for touch screen cleaning.

Turn off the grinder and gently wipe off the screen using a circular motion.

---

## 12. MAINTENANCE

---

### 12.1. GENERAL WARNING

**12.1.1** Before performing any type of maintenance you should:

- Always turn **OFF** the main power switch to the off position (13).
- If the grinder is jammed, unplug it from the power source and contact an authorized service technician.

In case of breakdown or malfunction, turn off the appliance, we should never try to repair it, it is essential to call the nearest technical service.

 **NOTE: Not following these warnings can compromise the safety of the grinder as well as the user.**

### 12.2. GENERAL MAINTENANCE OF THE GRIND CHAMBER

**12.2.1** To guarantee the efficiency and correct operation of the grinder, it is essential to follow manufacturer instructions and ensure that all maintenance work is carried out by qualified staff.

Dull burrs will result in; a lower quality grind, greater heat generation in the coffee and grinder, increased electrical consumption, and finally it puts additional stress on the grinder motor.

 **Not following the recommended burr life guidelines can compromise the safety of the grinder.**

**These operations should be done by a qualified service technician.**

## 12. MAINTENANCE

### 12.3. GRINDING GROUP MAINTENANCE

To perform grind chamber maintenance please observe the following steps:

**12.3.1** Turn off the grinder by making sure the main power switch (13) is on the **OFF** position. Disconnect the plug from the power source. Loosen the hopper security screw (3) using a Phillips head screw driver as seen in (Fig.1).



Fig. 1

**12.3.2** Check that the shutter is in the closed position before removing the hopper from the grind regulator (7). (Fig. 2).

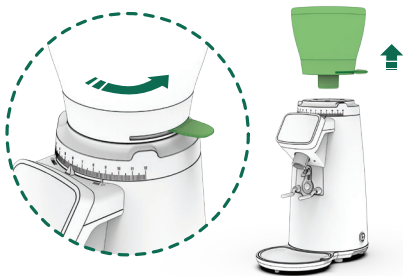

Fig. 2

**12.3.3** To avoid losing the position of the regulator scale with respect to the current grinding point, it is essential to tighten the setting of the grinding regulator using the adjusting brake (6) by turning it clockwise (Fig. 3).

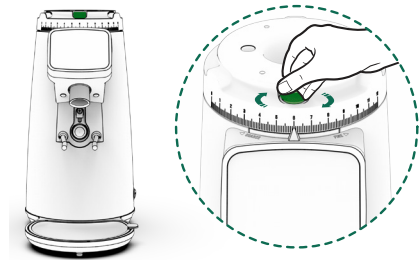

Fig. 3

**12.3.4** Loosen the grinding regulator screws using an Hex Allen screwdriver #3, according to (Fig.4). Remove the regulator by pulling up. (Fig.5).

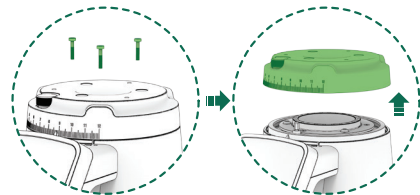

Fig. 4

Fig. 5

**12.3.5** Loosen the upper burrs support screws using a #3 Hex Allen key, according to (Fig.6). Remove the upper holder by pulling upwards to access the grinding cavity, clean the interior with the help of a brush or vacuum cleaner and remove any coffee residue from the grinding cavity (Fig.7).



## 12. MAINTENANCE

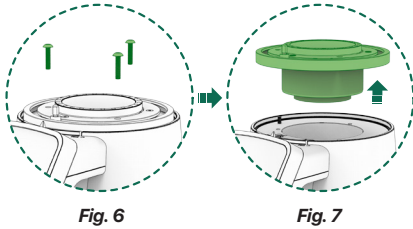

### 12.4. REPLACING THE METAL GRID

The metal grid ensures consistency in the dosage and minimizes static electricity

**12.4.1** Located between the coffee exit chute and the grinder's body, can be replaced after removing the regulator from the grinder, following the instructions up to step **12.3.3**. To remove it, use a Hex Allen key #3 to loosen the two top screws (**Fig. 8**). And the screw located beneath the coffee exit chute (**Fig. 9**).

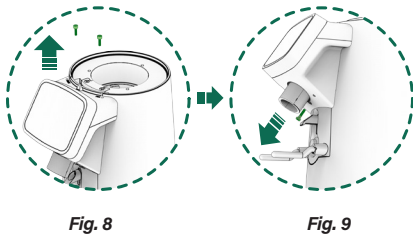

**12.4.2** Partially move the display plastic cover forward (**Fig. 10**). And then downward along the coffee exit chute until it can be completely freed (**Fig. 11**).

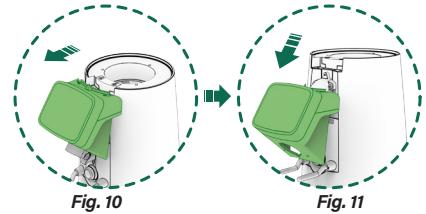

**12.4.3.** Using a Hex Allen key #3, loosen the two screws of the coffee exit chute and remove it from the grinder body to gain access to the metal grid (**Fig. 12**).



---

## 13. DECLARATION OF CONFORMITY

---

In accordance with European community directives, quality certificates have been applied. All materials have been adapted and technical reports are available at our offices.

**2014/30/UE** on the approximation of the laws of the Member States relating to electromagnetic compatibility.

**06/42/EC** amending Directive 95/16/EC on the approximation of the laws of the Member States relating to machinery

**REG. 1935/2004** amending Directive 89/109/EC on the approximation of the laws of the Member States relating to material and objects destined to make contact with nutritional products.

**03/108/EC** amending Directive 2002/96/EC on waste electrical and electronic equipment (WEEE).

**2014/34/UE** on the harmonization of the laws of Member States relating to electrical equipment designed for use within certain voltage limits.

**2012/19/UE of 04/07/2012** on the approximation of the laws of the Member States on waste electrical and electronic equipment (WEEE).

**11/65/EU** related to the restriction on the usage of certain dangerous substances with electrical equipment and electronics.

### Environment

Do not throw the appliance away with the normal household waste; hand it in at an official recycling collection point. By doing this, you will help to preserve the environment.

The Legal Representative

**Jesús Ascaso**



### Compak Coffee Grinders, s.a.

Molí Barri, Parcela B - Pol. Ind. Can Barri - 08415 Bigues i Riells - Barcelona - Spain  
Ph. 34 93 703 13 00 - [www.compak.es](http://www.compak.es) - [info@compak.es](mailto:info@compak.es)





## USER MANUAL

K09639H01 | PROC-CAL/002/03 | v. 27/09/2023