

SILLY POOPY'S HIDE & SEEK



INSTRUCTIONS

Be the first to find SILLY POOPY!

AGES: 3+

PLAYERS: 2+

INCLUDES

- The fabulously friendly **SILLY POOPY!**
- 2 AA batteries

GETTING STARTED

- Flip the switch on the back of **SILLY POOPY** to the ON position.
- Players select who is going to hide **SILLY POOPY** first. Let's call that person the "Hider".

HOW TO PLAY!

HIDING SILLY POOPY

- The Hider hides **SILLY POOPY** and presses the "**SILLY POOPY**" button.
- The Hider lets all of the other players know that they can start looking for **SILLY POOPY**.
NOTE: We really suggest that the Hider move far away from the hiding spot before telling the other players to start looking for **SILLY POOPY!**

FINDING SILLY POOPY

- All players (except the Hider) begin looking for **SILLY POOPY**.
- **SILLY POOPY** will say quick random phrases and make funny noises to give clues to help find him.
- The first player to find **SILLY POOPY** is the winner! Press **SILLY POOPY'S** button to hear the "Yippee, Yoopee" reward song!
NOTE: Have fun dancing and singing along! It's really a catchy tune!
- The player who found **SILLY POOPY** is now the Hider for the next round!
- When play is finished, we suggest flipping the switch to the OFF position.

Battery Replacement:

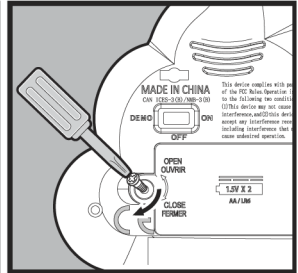
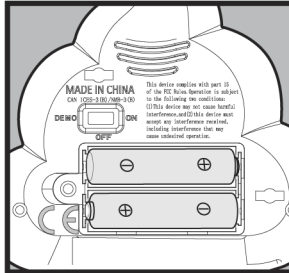
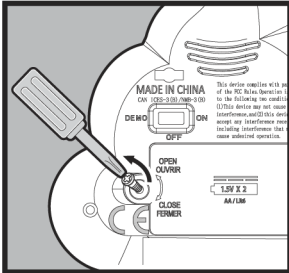

- THIS ITEM IS SUPPLIED WITH BATTERIES FOR "TRY ME" FUNCTION, 2 LR6 (INCLUDED AND REPLACEABLE) (DETAILS IN THE INSTRUCTION DRAWING).
- NON-RECHARGEABLE BATTERIES ARE NOT TO BE RECHARGED.
- DO NOT MIX OLD AND NEW BATTERIES.
- BATTERIES ARE TO BE INSERTED WITH THE CORRECT POLARITY.
- EXHAUSTED BATTERIES ARE TO BE REMOVED FROM THE TOY.
- THE SUPPLY TERMINALS ARE NOT TO BE SHORT-CIRCUITED.
- DO NOT MIX ALKALINE, STANDARD (CARBON-ZINC), OR RECHARGEABLE (NICKEL-CADMIUM) BATTERIES.
- DO NOT USE RECHARGEABLE BATTERIES.



ADVICE FOR MAINTENANCE AND USE OF A BATTERY TOY:

- FOR OPTIMAL PERFORMANCE, USE ONLY ALKALINE BATTERIES.
- THE REPLACEMENT OF THE BATTERIES TO BE MADE BY AN ADULT FOLLOWING THE INSTRUCTIONS.
- THE SUPPLIED BATTERIES ARE FOR DEMONSTRATION ONLY AND SHOULD NOT BE INCLUDED AS AN INTEGRAL PART OF THE PURCHASE PRICE OF THE TOY. IT IS POSSIBLE THAT THE BATTERIES ARE WEAK OR DISCHARGED PRIOR TO PURCHASE. REMOVE THE BATTERIES AT THE TIME OF PURCHASE AND REPLACE THEM WITH THE CORRECT TYPE OF BATTERIES ACCORDING TO THE INSTRUCTION / DIAGRAM ATTACHED.
- PACKAGING MATERIAL IS NOT A TOY. REMOVE ALL PACKAGING MATERIALS BEFORE GIVING THIS TOY TO A CHILD.
- PRODUCT, COLORS, DECORATIONS OR DETAILS MAY VARY FROM THOSE SHOWN ON PACKAGING.
- PLEASE READ INSTRUCTIONS BEFORE USE. KEEP THE PACKAGING, SINCE IT CONTAINS IMPORTANT INFORMATION.

WARNING: CHANGES OR MODIFICATIONS TO THIS UNIT NOT EXPRESSLY APPROVED BY THE PARTY RESPONSIBLE FOR COMPLIANCE COULD VOID THE USER'S AUTHORITY TO OPERATE THE EQUIPMENT.

NOTE: THIS EQUIPMENT HAS BEEN TESTED AND FOUND TO COMPLY WITH THE LIMITS FOR A CLASS B DIGITAL DEVICE, PURSUANT TO PART 15 OF THE FCC RULES. THESE LIMITS ARE DESIGNED TO PROVIDE REASONABLE PROTECTION AGAINST HARMFUL INTERFERENCE IN A RESIDENTIAL INSTALLATION. THIS EQUIPMENT GENERATES, USES AND CAN RADIATE RADIO FREQUENCY ENERGY AND, IF NOT INSTALLED AND USED IN ACCORDANCE WITH THE INSTRUCTIONS, MAY CAUSE HARMFUL INTERFERENCE TO RADIO COMMUNICATIONS. HOWEVER, THERE IS NO GUARANTEE THAT INTERFERENCE WILL NOT OCCUR IN A PARTICULAR INSTALLATION. IF THIS EQUIPMENT DOES CAUSE HARMFUL INTERFERENCE TO RADIO OR TELEVISION RECEPTION, WHICH CAN BE DETERMINED BY TURNING THE EQUIPMENT OFF AND ON, THE USER IS ENCOURAGED TO TRY TO CORRECT THE INTERFERENCE BY ONE OR MORE OF THE FOLLOWING MEASURES:

- REORIENT OR RELOCATE THE RECEIVING ANTENNA.
- INCREASE THE SEPARATION BETWEEN THE EQUIPMENT AND RECEIVER.
- CONNECT THE EQUIPMENT INTO AN OUTLET ON A CIRCUIT DIFFERENT FROM THAT TO WHICH THE RECEIVER IS CONNECTED.

– CONSULT THE DEALER OR AN EXPERIENCED RADIO/ TV TECHNICIAN FOR HELP.

THIS DEVICE COMPLIES WITH PART 15 OF THE FCC RULES. OPERATION IS SUBJECT TO THE FOLLOWING TWO CONDITIONS: (1) THIS DEVICE MAY NOT CAUSE HARMFUL INTERFERENCE, AND (2) THIS DEVICE MUST ACCEPT ANY INTERFERENCE RECEIVED, INCLUDING INTERFERENCE THAT MAY CAUSE UNDESIRED OPERATION.

Questions or comments? info@whatdoyoumeme.com