





|                      |   |   |  |  |
|----------------------|---|---|--|--|
| AVCS-DELETE-1        | 1   | 9   | 1  | 2  |
| AVCS-DELETE-2        | 1   | 17  | 1  | 4  |
| <b>KIT INCLUDES:</b> | <br>Loctite Threadlocker Red 0.5ml | <br>Stainless Steel Set Screws, 10-32 x 1/4" | <br>10-32 tap | <br>Subaru OE cam seals 806732160 |

**USER ASSUMES ALL RISKS AND LIABILITY ACCOMPANIED WITH INSTALLATION. WHEN IN DOUBT, WE RECOMMEND A TRAINED PROFESSIONAL PERFORM THE INSTALLATION.**

### INSTALLATION OF AVCS DELETE KIT

#### TOOLS NEEDED (NOT INCLUDED):

- Cutting Oil (or spare engine oil will suffice)
- 3/32" Hex wrench
- Tap Handle
- Hook tool for removing old camshaft seal
- Mallet and seal seating tool for new camshaft seal

#### PARTS NEEDED (NOT INCLUDED):

- Non AVCS cam sprocket(s)
- Cam sprocket bolt(s) 13199AA010 (reuse the ones removed)

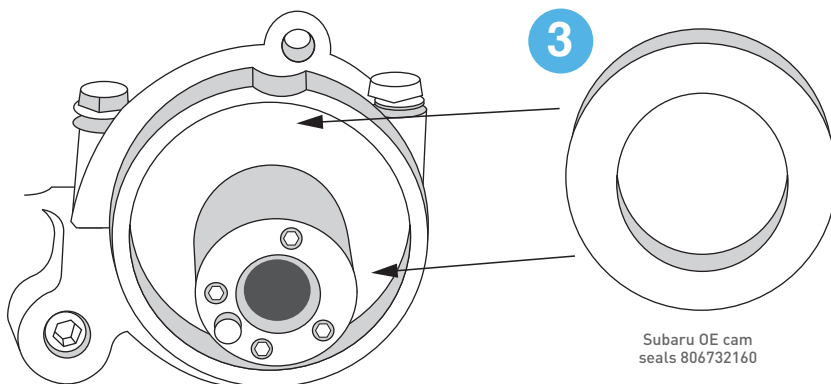
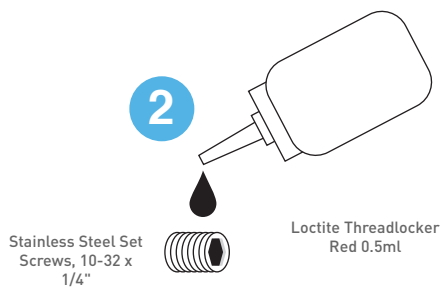
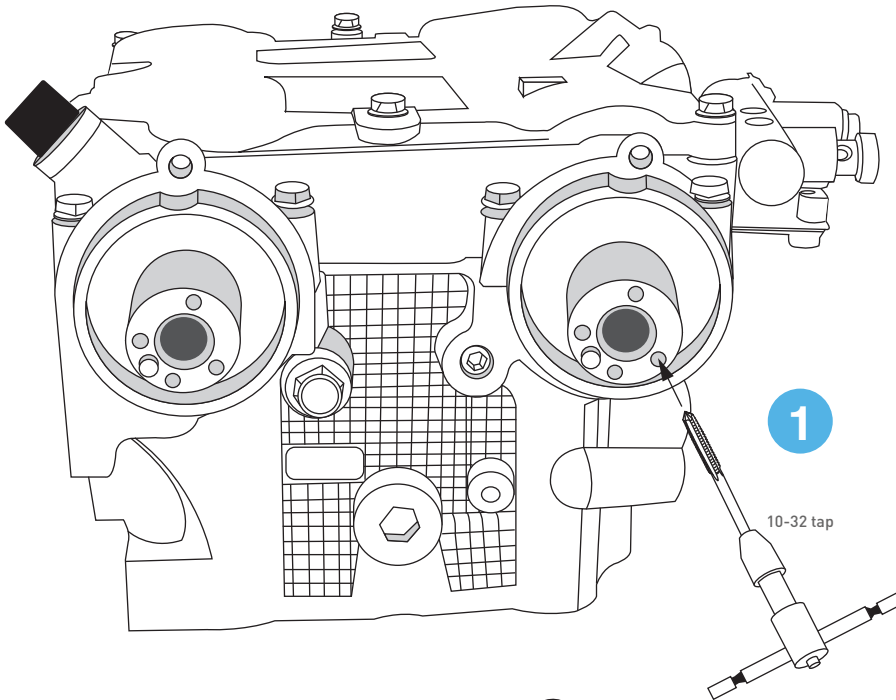

Prior to step 1 it is necessary to remove the desired camshaft sprocket(s) and associated hardware (timing belt, ETC). If the engine is still in the vehicle then removal of the radiator may be necessary to obtain sufficient working space.

- 1** Using the supplied 10-32 tap, thread the (4) holes per camshaft. A drop of cutting oil, or used motor oil will aid this step.
- 2** Apply red Loctite to each set screw's threads, then install the set screws with a 3/32" Hex wrench. The set screws should sit just below the surface so as to maintain a flat surface for the sprocket to fit.
- 3** If you have not already done so, remove the original camshaft seal with a hook tool. Prior to installing the new seal, apply a light film of oil around the circular perimeters. This will help it ease the seal into place with a mallet and properly sized adapter. No adapter? No worry, a large socket or properly sized plumbing pipe can work as an adapter. Refer to the service manual when in doubt.

The AVCS Deletion is now complete. The engine is ready for reassembly of the timing assembly and previously removed parts. The timing belt marks will align as per the service manual with the following setups:  
 AVCS only on the intake camshafts = 2008-2014 WRX  
 AVCS deleted entirely from the engine = 2002-2005 WRX