

### Tools Required

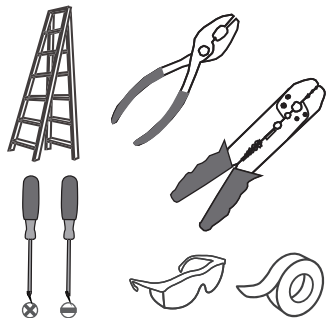

### Light Source

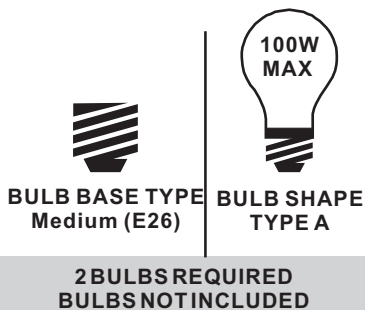

### Warnings and Cautions

Turn off the electricity at the circuit breaker before installation. Consult a licensed electrician if in doubt about installation.

Turn off power to the fixture and allow the bulbs to cool before replacing.

### Package Contents

**Preparation:** Identify and inspect all parts before beginning the installation.

Missing or damaged parts? Contact your original place of purchase.

#### PARTS BAG

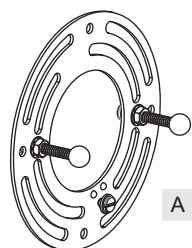

**A** Crossbar Assembly x 1



**B** Alternate Mounting Screw x 2



**C** Outlet Box Screw x 2



**D** Wire Connector x 3

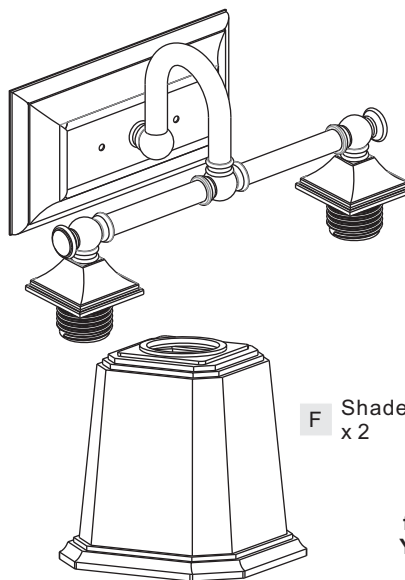



**E** Fixture Body x 1

**F** Shade x 2

**G** Socket Collar x 2

**Note:** Socket collar shape is for illustration purpose only. Your socket collar shape may vary from illustration.

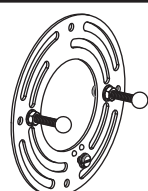
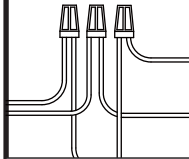
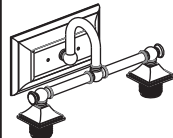
### Table of Contents

Alternate Mounting Screw	Crossbar Assembly	Wiring	Fixture Body	Shade & Bulb
				
<b>STEP 1</b>	<b>STEP 2</b>	<b>STEP 3</b>	<b>STEP 4</b>	<b>STEP 5</b>

# STEP 1

OPTION 1

**Standard Mounting Screw**  
Included (Pre-assembled)

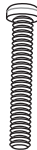

OPTION 2

**Alternate Mounting Screw**  
Included



skip to next page

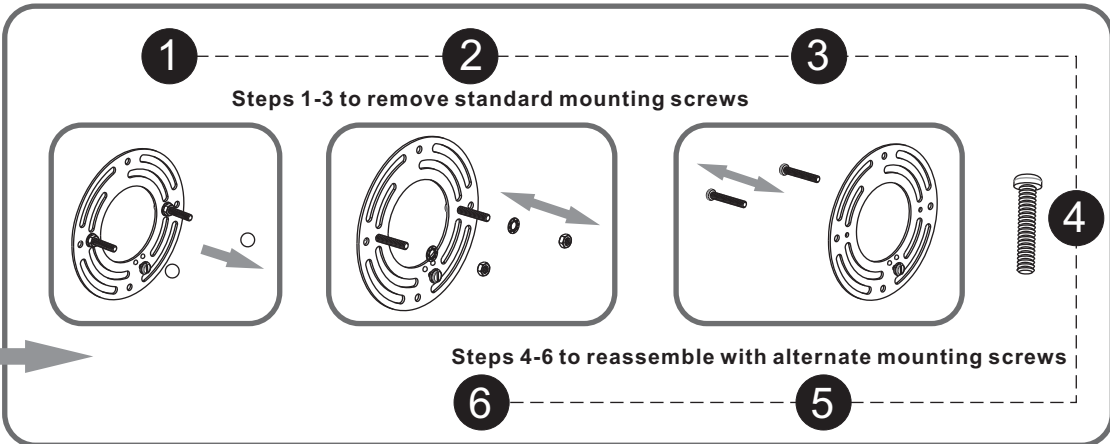

# STEP 2

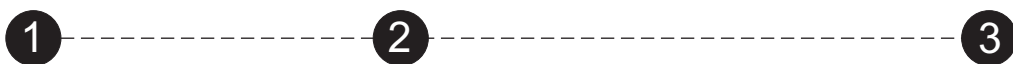

**Step 1**  
Install crossbar assembly

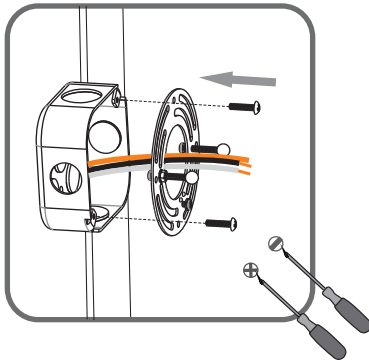

**Step 2 - 3**  
Test fitting backplate to mounting screws

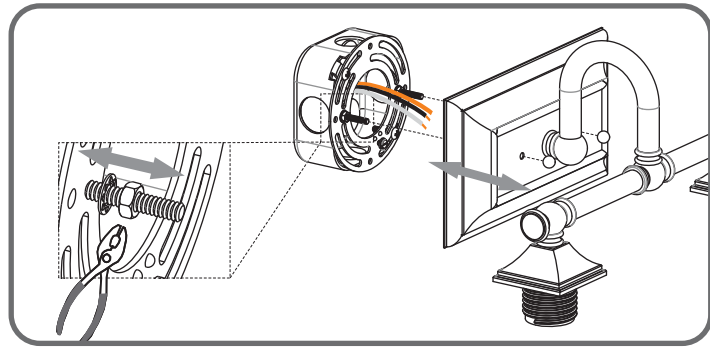
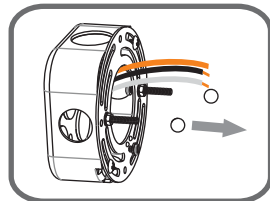

# STEP 3

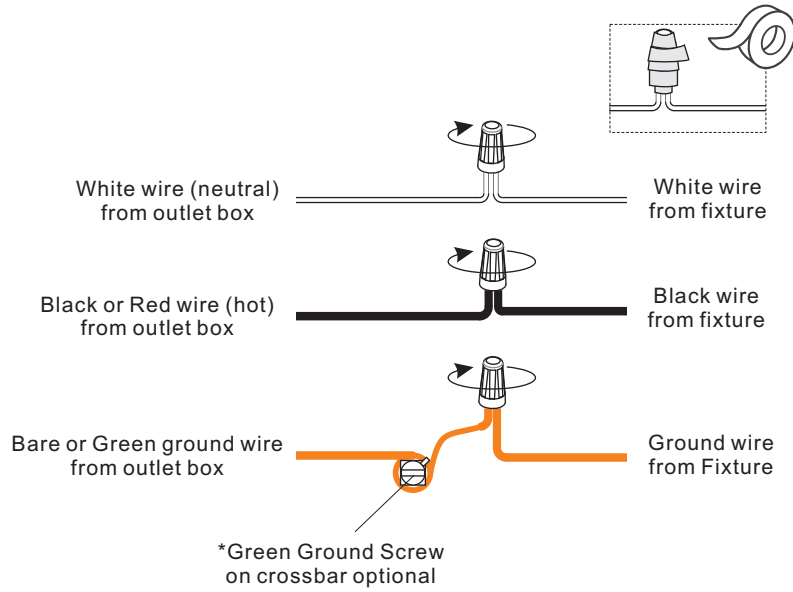

## STEP 4

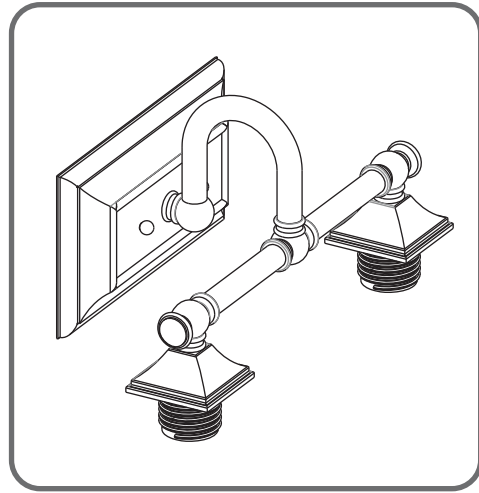
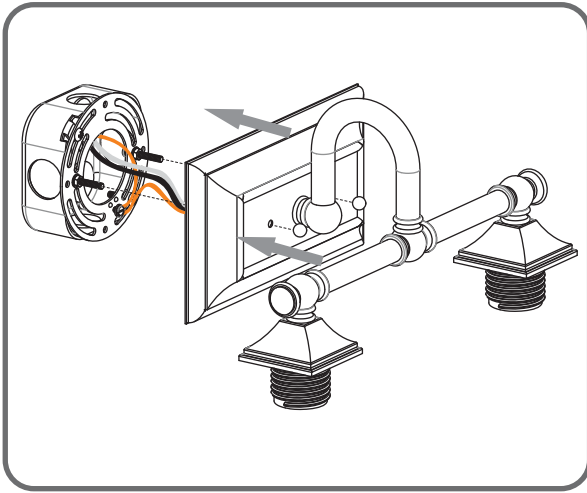

## STEP 5

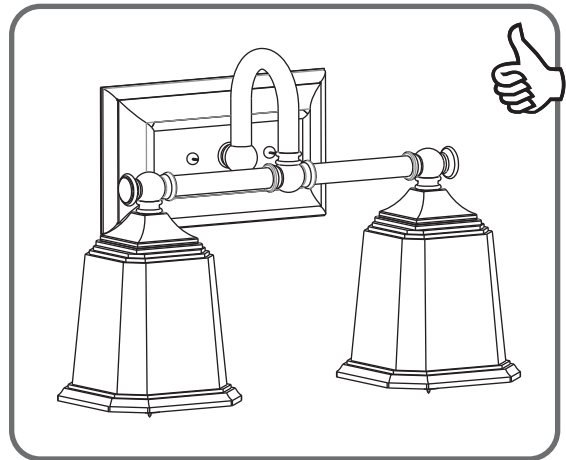
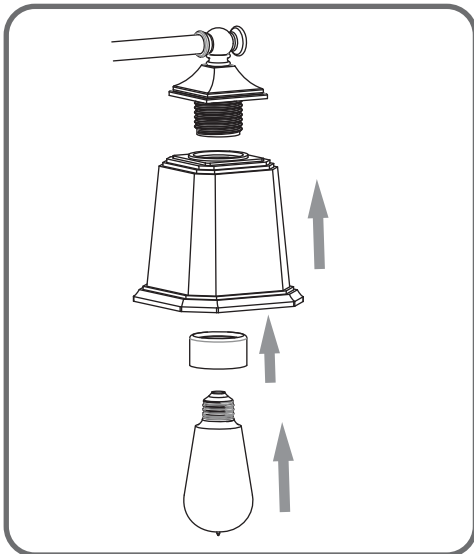

**Note:** Socket collar shape is for illustration purpose only. Your socket collar shape may vary from illustration.