

Tools Required

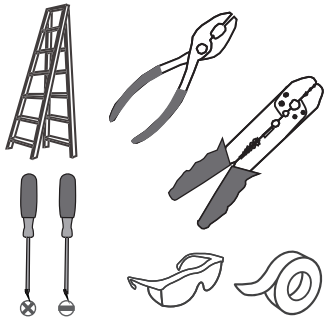

Light Source

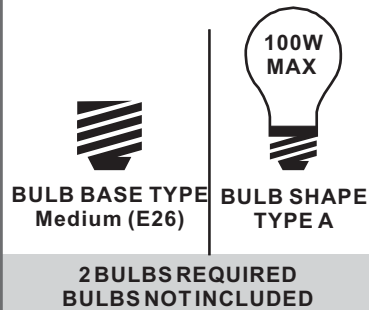

Warnings and Cautions

Turn off the electricity at the circuit breaker before installation. Consult a licensed electrician if in doubt about installation.

Turn off power to the fixture and allow the bulbs to cool before replacing.

Package Contents

Preparation: Identify and inspect all parts before beginning the installation.

Missing or damaged parts? Contact your original place of purchase.

PARTS BAG

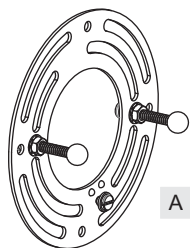

A Crossbar Assembly x 1



B Alternate Mounting Screw x 2



C Outlet Box Screw x 2



D Wire Connector x 3

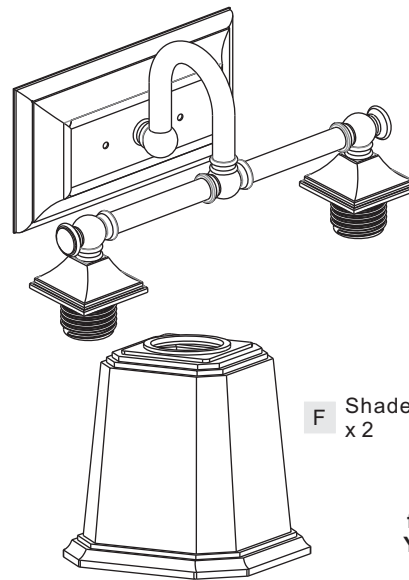



E Fixture Body x 1

F Shade x 2

G Socket Collar x 2

Note: Socket collar shape is for illustration purpose only. Your socket collar shape may vary from illustration.

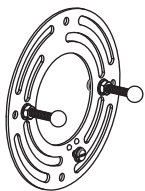
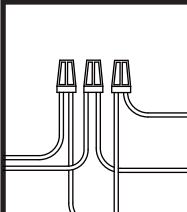
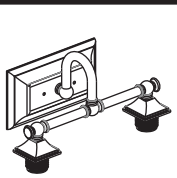
Table of Contents

| Alternate Mounting Screw | Crossbar Assembly | Wiring | Fixture Body | Shade & Bulb |
|---|---|--|---|---|
|  |  |  |  |  |
| STEP 1 | STEP 2 | STEP 3 | STEP 4 | STEP 5 |

STEP 1

OPTION 1

Standard Mounting Screw
Included (Pre-assembled)

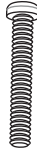

OPTION 2

Alternate Mounting Screw
Included



skip to next page

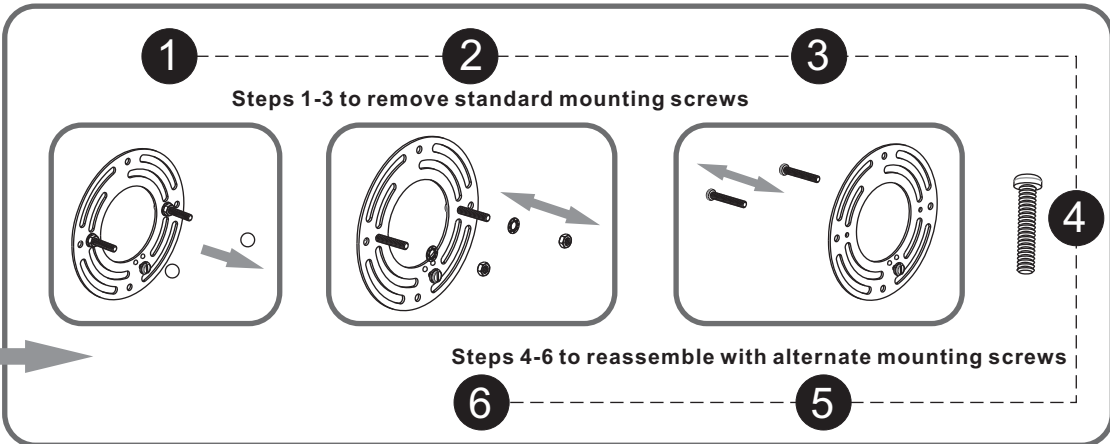

STEP 2

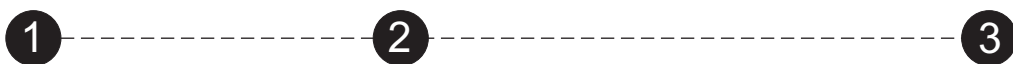

Step 1
Install crossbar assembly

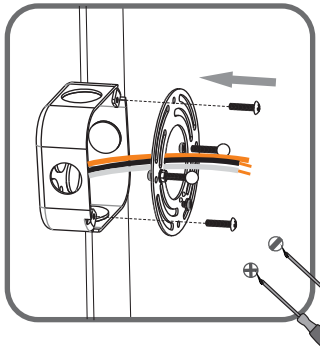

Step 2 - 3
Test fitting backplate to mounting screws

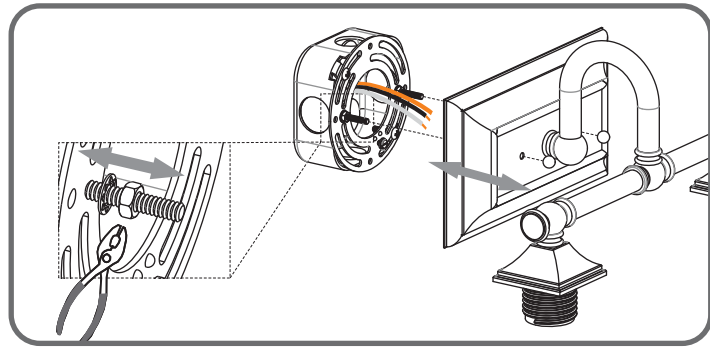
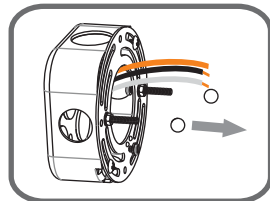

STEP 3

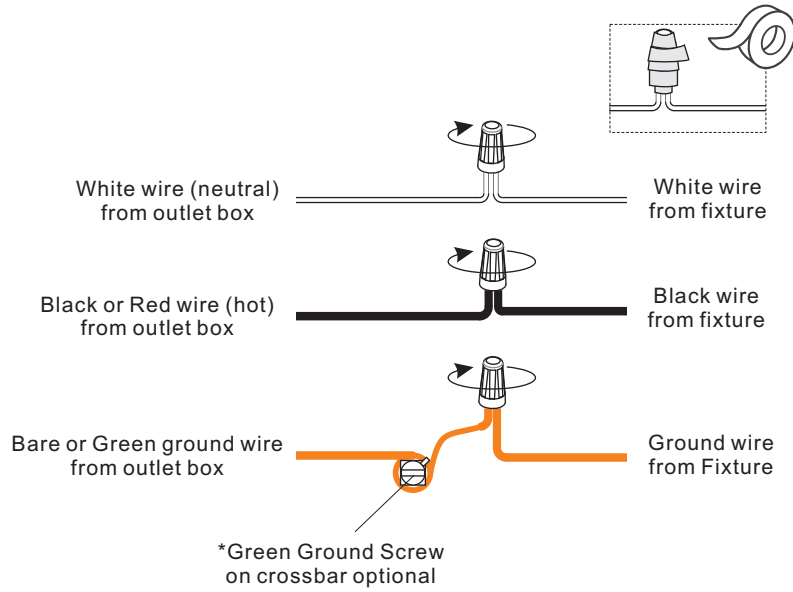

STEP 4

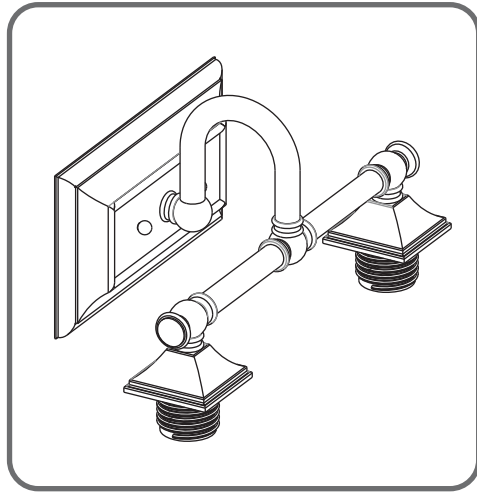
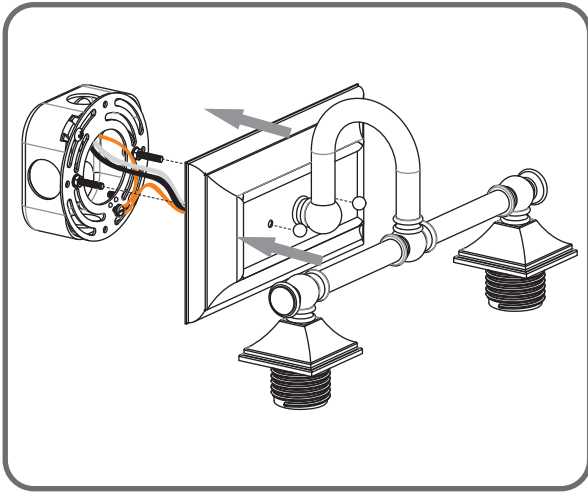

STEP 5

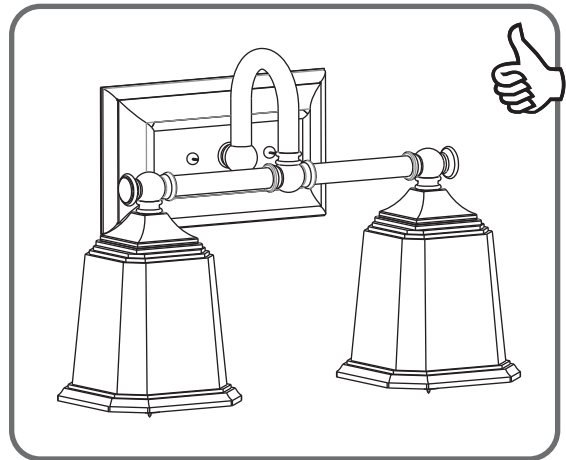
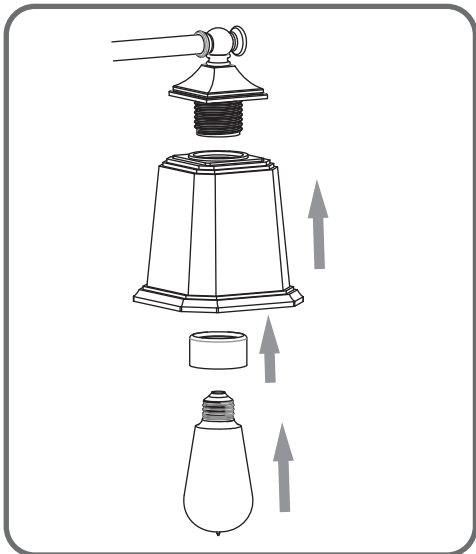

Note: Socket collar shape is for illustration purpose only. Your socket collar shape may vary from illustration.