

Tools Required

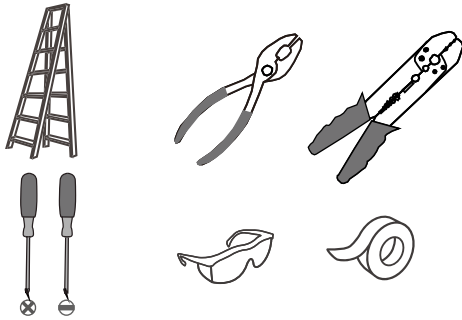

Light Source

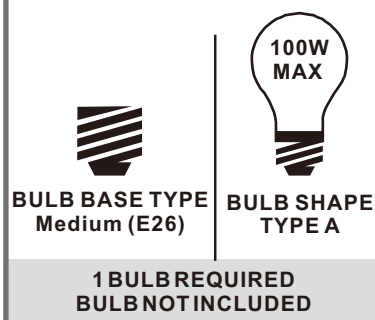

Fixture Height Adjustable 10.5" to 46.5"

⚠ Warnings and Cautions

Turn off the electricity at the circuit breaker before installation. Consult a licensed electrician if in doubt about installation.

Turn off power to the fixture and allow the bulbs to cool before replacing.

Package Contents

Preparation: Identify and inspect all parts before beginning the installation.

Missing or damaged parts? Contact your original place of purchase.

PARTS BAG

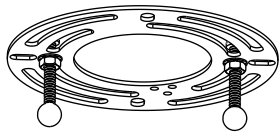

A Crossbar Assembly
x 1



B Outlet Box Screw
x 2



C Wire Connector
x 3

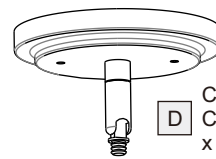

D Ceiling
Canopy
x 1

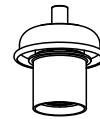

G Fixture
Body
x 1



E 6" L Rod
x 2

F 12" L Rod
x 2

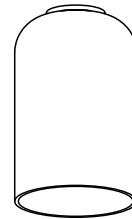

H Shade
x 1

Table of Contents

Crossbar Assembly

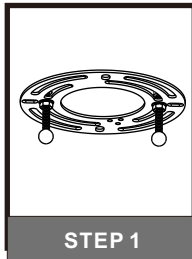

STEP 1

Downrod

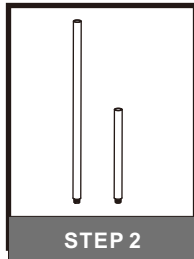

STEP 2

Wiring

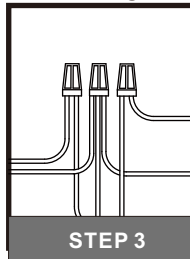

STEP 3

Ceiling Canopy

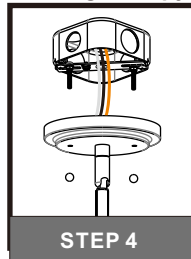

STEP 4

Shade & Bulb

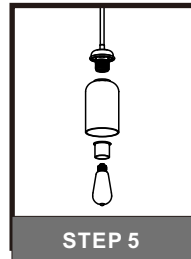

STEP 5

STEP 1

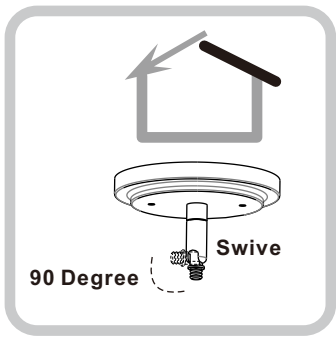

For angled ceilings,
Swivel opening towards wall.



1
Step 1
Install crossbar assembly

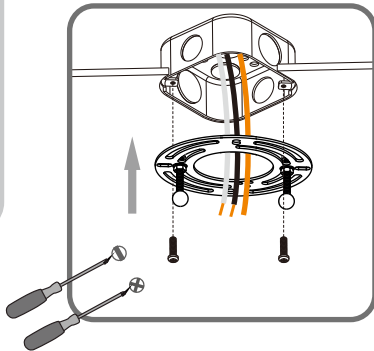

2
Step 2 - 3
Test fitting ceiling canopy to
mounting screws

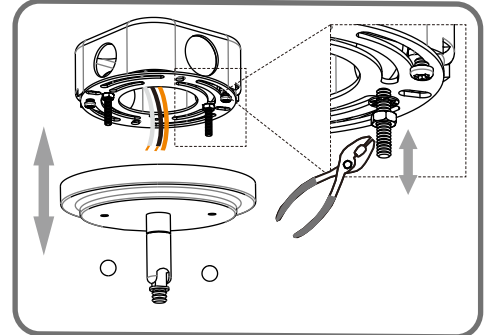
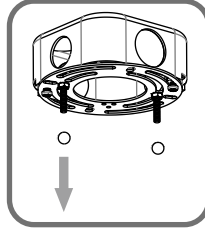

STEP 2

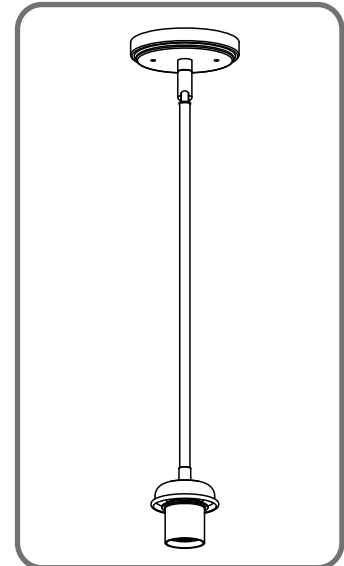
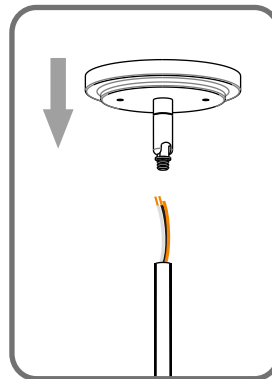
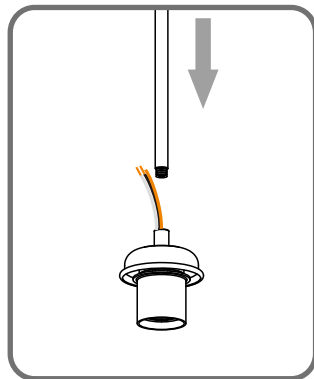
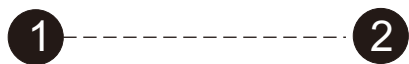
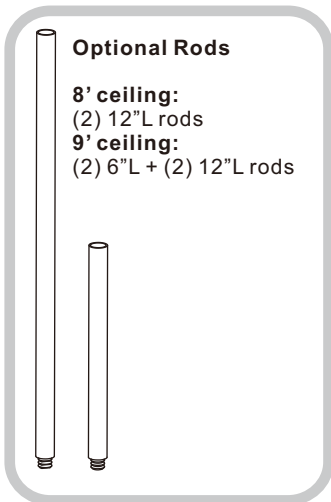

STEP 3

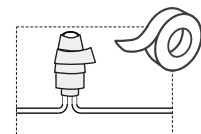
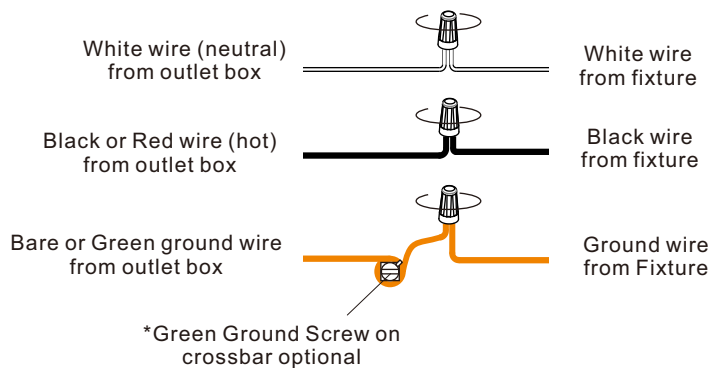

STEP 4

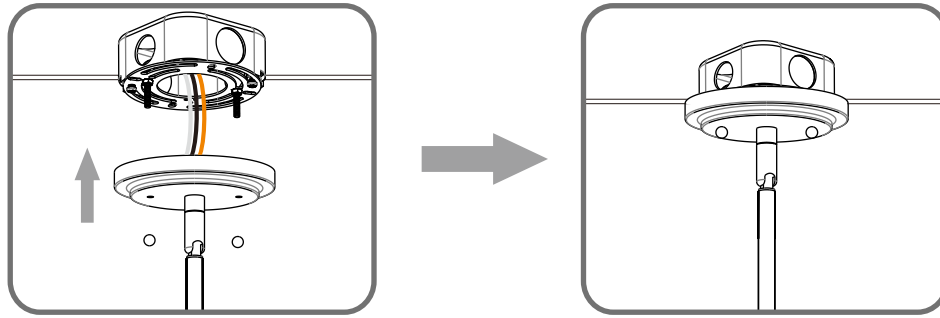

STEP 5

