

### Tools Required

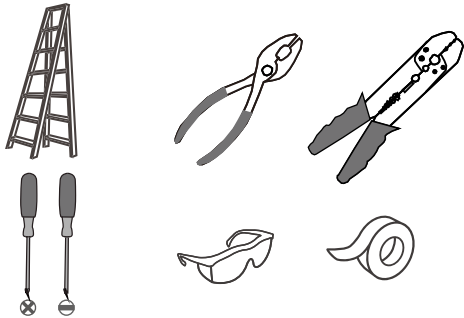

### Light Source

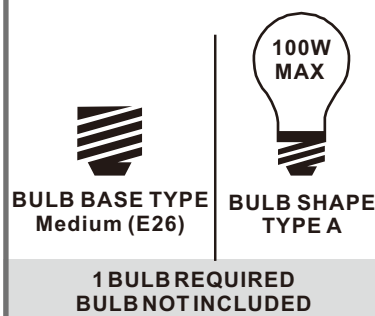

### Fixture Height Adjustable 10.5" to 48.5"

#### ⚠ Warnings and Cautions

Turn off the electricity at the circuit breaker before installation. Consult a licensed electrician if in doubt about installation.

Turn off power to the fixture and allow the bulbs to cool before replacing.

### Package Contents

**Preparation:** Identify and inspect all parts before beginning the installation.

Missing or damaged parts? Contact your original place of purchase.

#### PARTS BAG

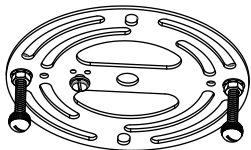

**A** Crossbar Assembly  
x 1



**B** Outlet Box Screw  
x 2



**C** Wire Connector  
x 3

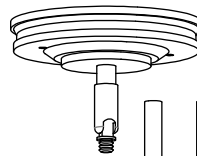

**D** Ceiling Canopy Assembly  
x 1



**E** 6" L Rod  
x 2



**F** 12" L Rod  
x 2

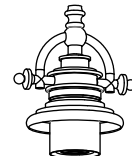

**G** Fixture Body  
x 1



**H** Ring  
x 1

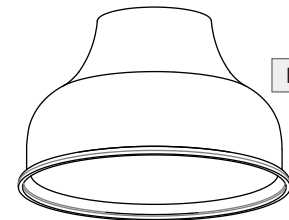

**I** Shade  
x 1

### Table of Contents

Crossbar Assembly	Ceiling Canopy Assembly & Downrod	Wiring	Ceiling Canopy	Ring & shade	Bulb
STEP 1	STEP 2	STEP 3	STEP 4	STEP 5	STEP 6

## STEP 1

**1**  
Step 1  
Install crossbar assembly

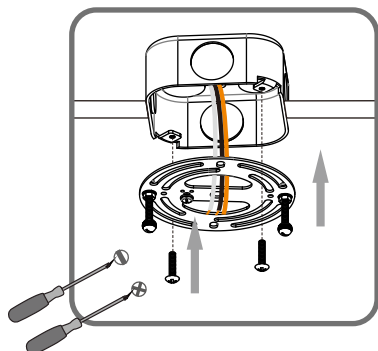

**2**  
Step 2 - 3  
Test fitting ceiling canopy to mounting screws

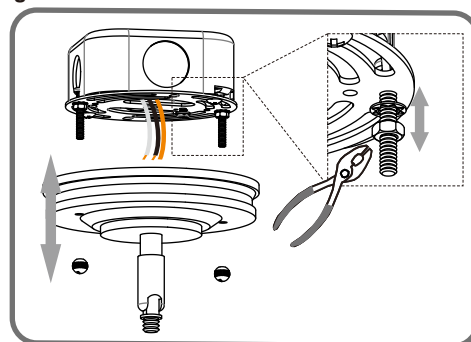
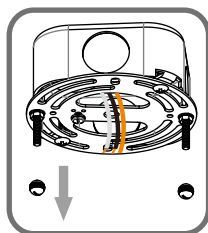

## STEP 2

### OPTION 1

Pendant — UQL3660

#### Optional Rods

8' ceiling:  
(2) 12"L rods  
9' ceiling:  
(2) 6"L + (2) 12"L rods



**1**  
Install rods

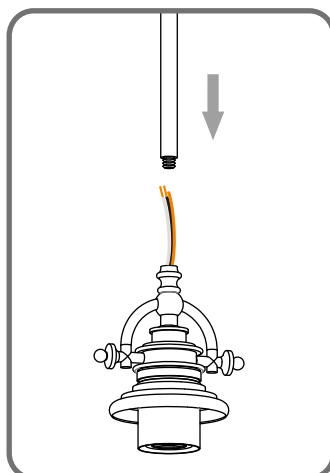

**2**  
Tighten hex nut inside of the ceiling canopy

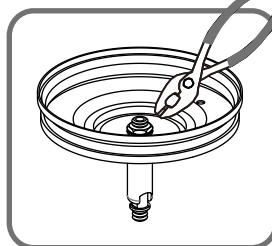

**3**  
Install Ceiling Canopy

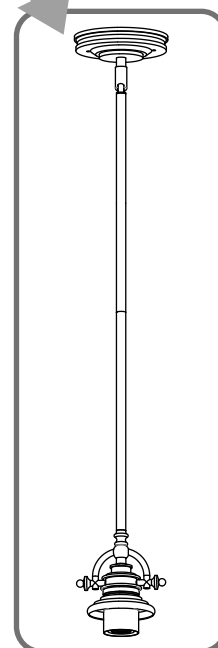
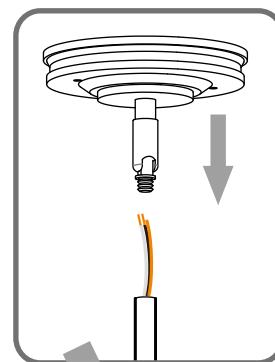

### OPTION 2

Semi-flush — UQL3662

**1**  
Remove swivel

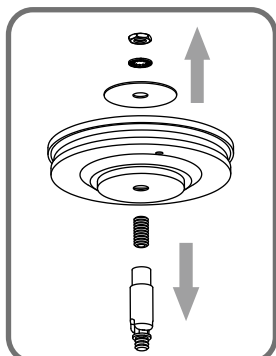

**2**  
Install ceiling canopy

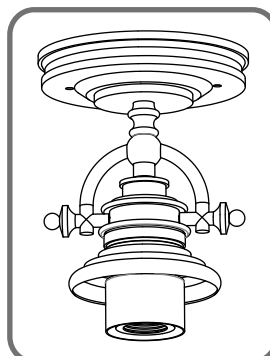
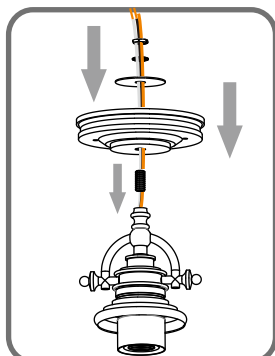

### STEP 3

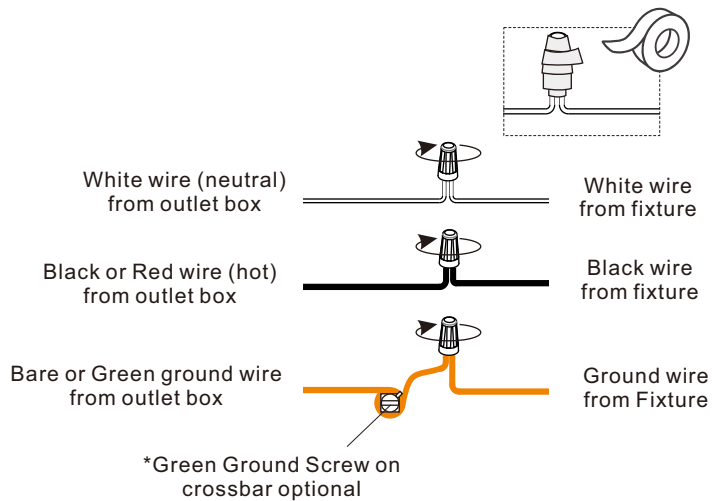

### STEP 4

#### OPTION 1

#### OPTION 2

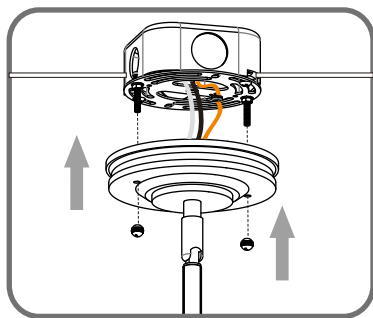

UQL3660

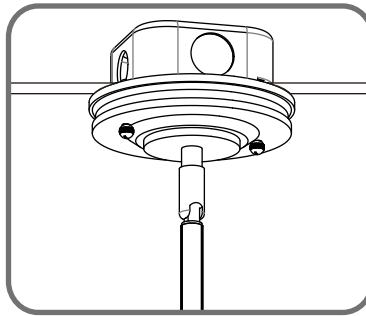

UQL3662

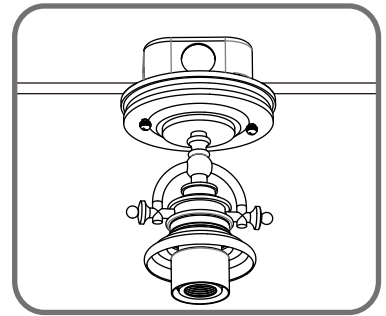

### STEP 5

1

Remove socket collar

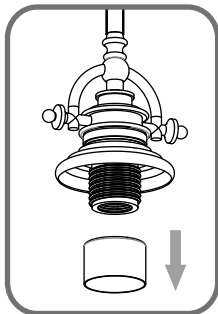

2

Place the ring

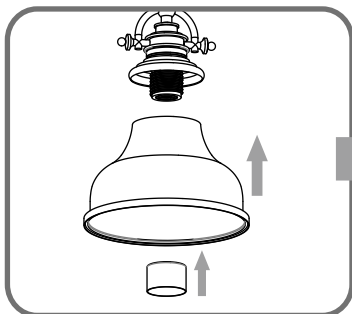
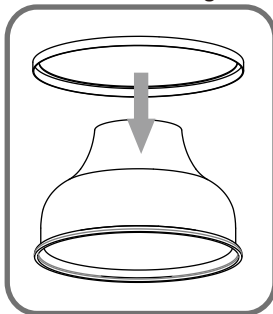

Install shade with ring

3

#### OPTION 1

UQL3660

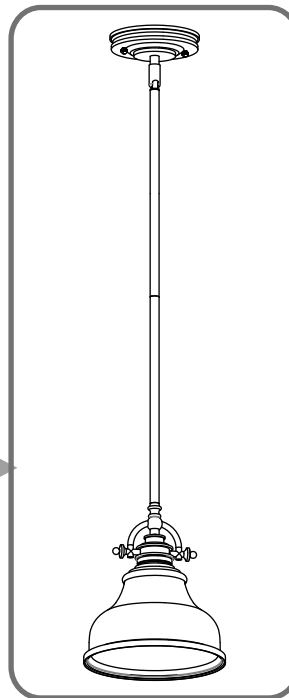

#### OPTION 2

UQL3662



**STEP 6**

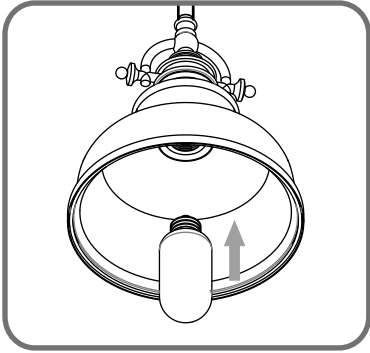

**OPTION 1**

UQL3660

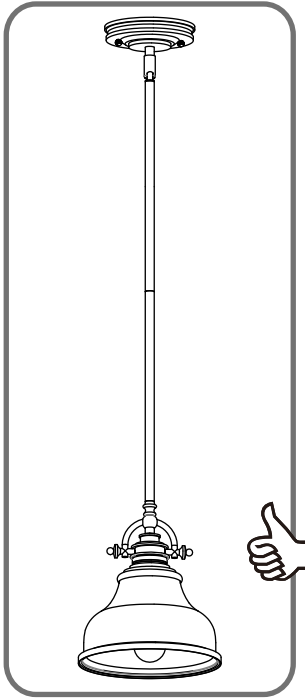

**OPTION 2**

UQL3662

