

Tools Required

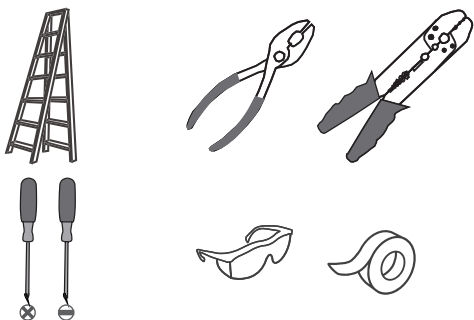

Light Source

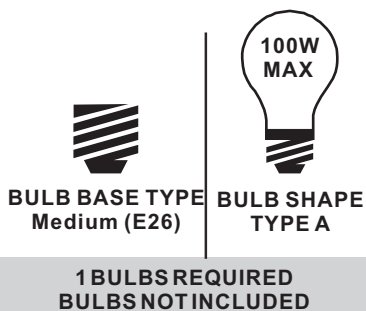

Fixture Height Adjustable 22.25" to 58.25"

⚠ Warnings and Cautions

Turn off the electricity at the circuit breaker before installation. Consult a licensed electrician if in doubt about installation.

Turn off power to the fixture and allow the bulbs to cool before replacing.

Package Contents

Preparation: Identify and inspect all parts before beginning the installation.

Missing or damaged parts? Contact your original place of purchase.

PARTS BAG

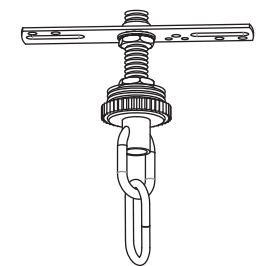

A Crossbar Assembly x 1

B Outlet Box Screw x 2

C Wire Connector x 3

D Quick Link x 1

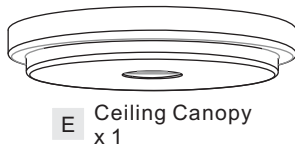

E Ceiling Canopy x 1

F Small Loop x 1

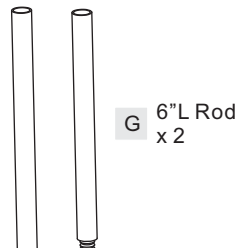

G 6" L Rod x 2

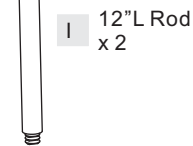

I 12" L Rod x 2

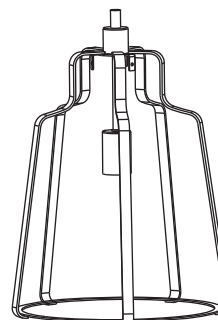

H Fixture Body x 1

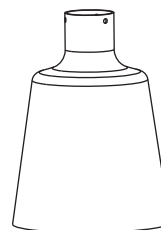

J Shade x 1

K Stem x 3

Table of Contents

Fixture Body

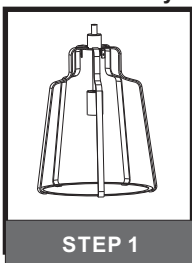

STEP 1

Rods & Small Loop

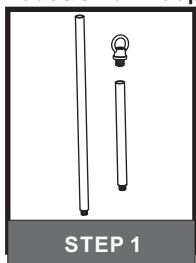

STEP 1

Crossbar Assembly

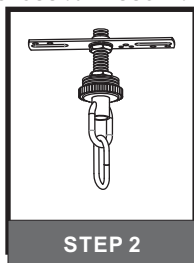

STEP 2

Quick Link

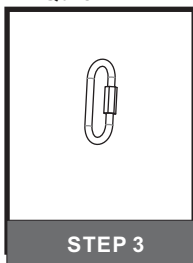

STEP 3

Wiring

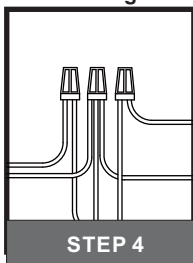

STEP 4

Ceiling Canopy

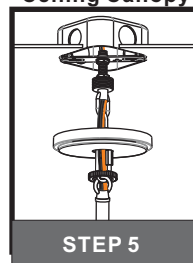

STEP 5

Bulb

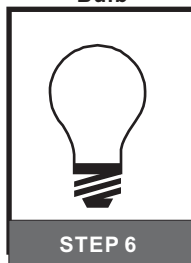

STEP 6

STEP 1

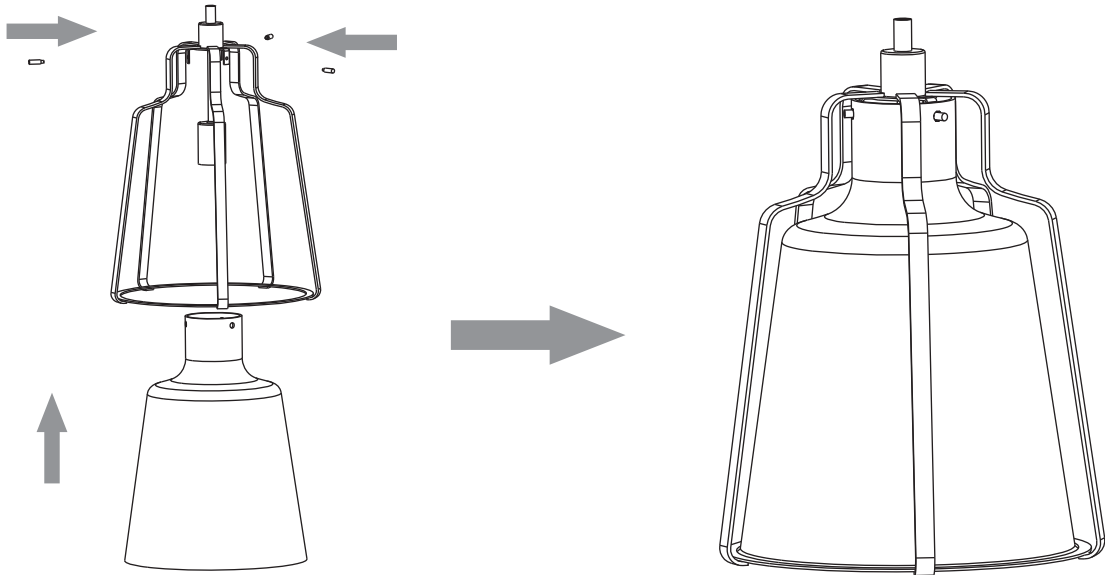

STEP 2

Optional Rods

8' ceiling:
(1) 6"L rods

9' ceiling:
(1) 6"L + (1) 12"L rods

10' ceiling:
(1) 6"L + (2) 12"L rods

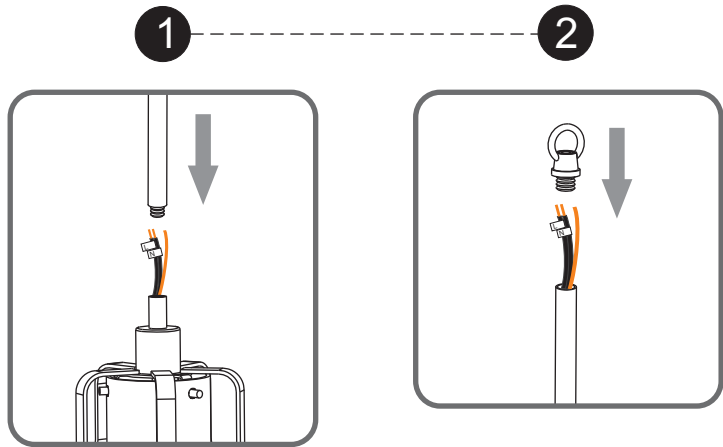

STEP 3

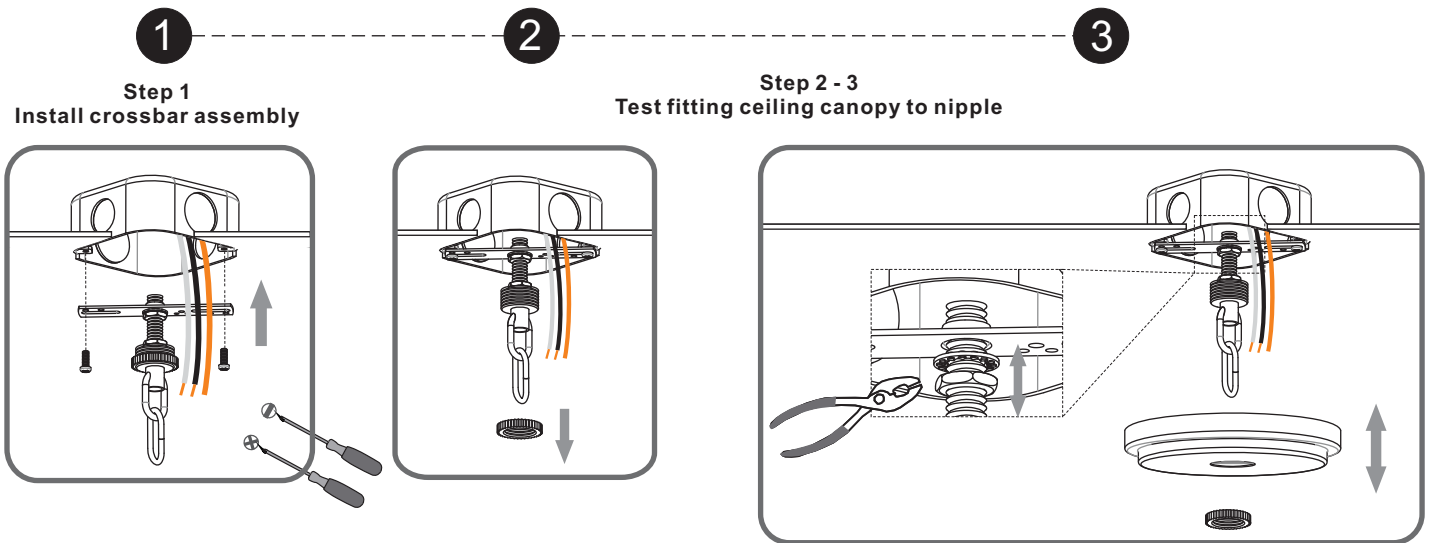

STEP 4

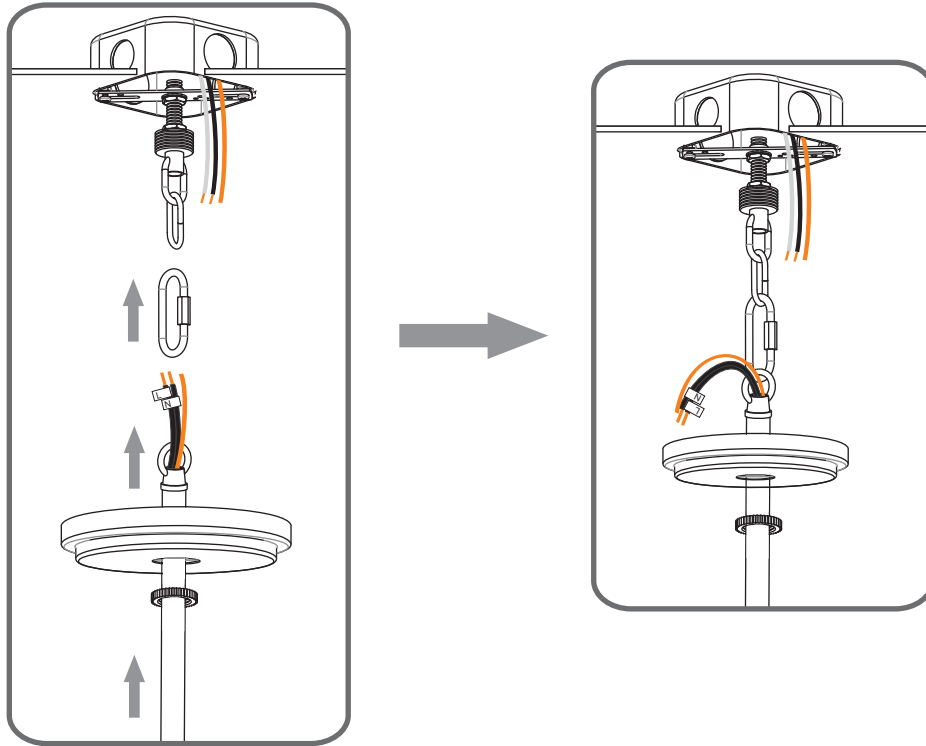

STEP 5

1

Step 1
Feed the fixture wires
through the loop

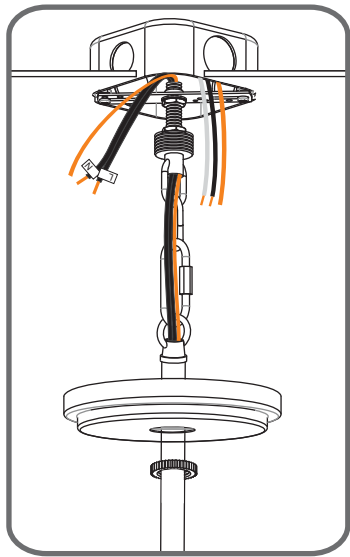

2

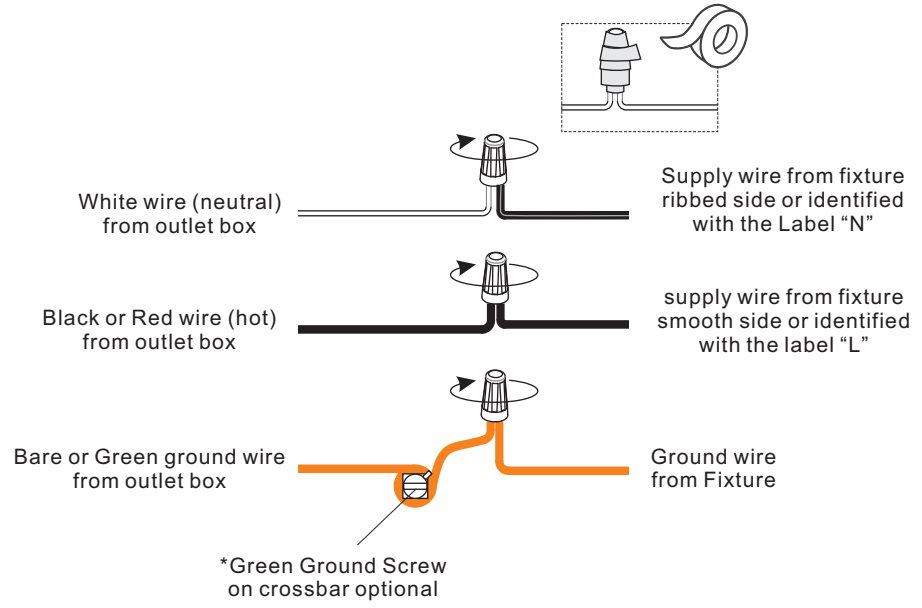

STEP 6

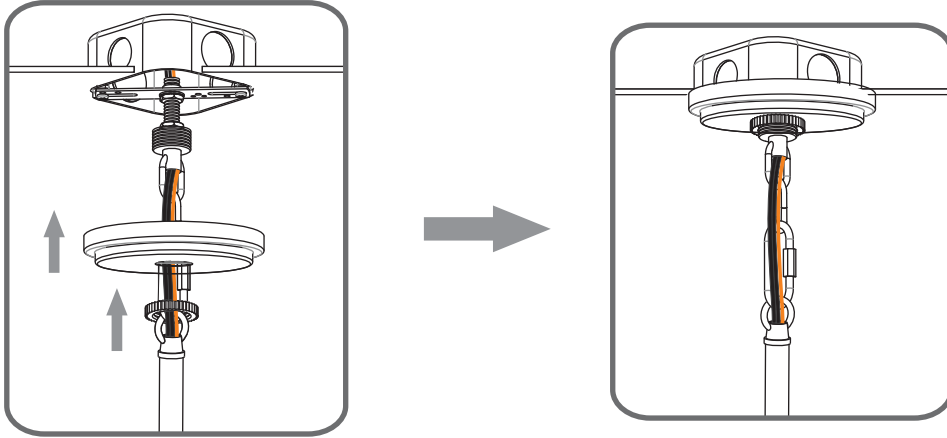

STEP 7

