

1. Open Ultimate Guitar and arrive at the home screen, then select “Accounts & Settings”

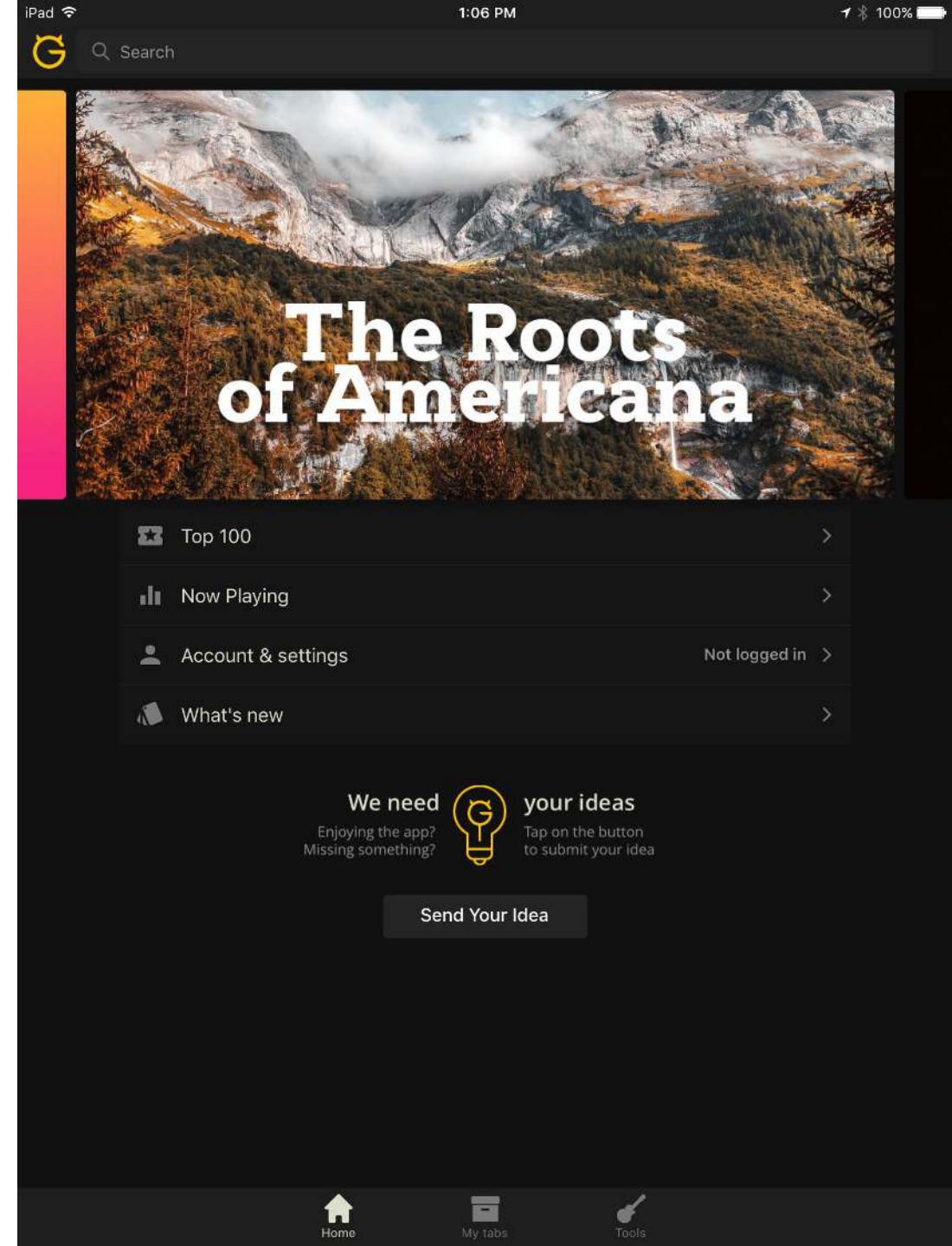

## 2. Select Pedal Interface

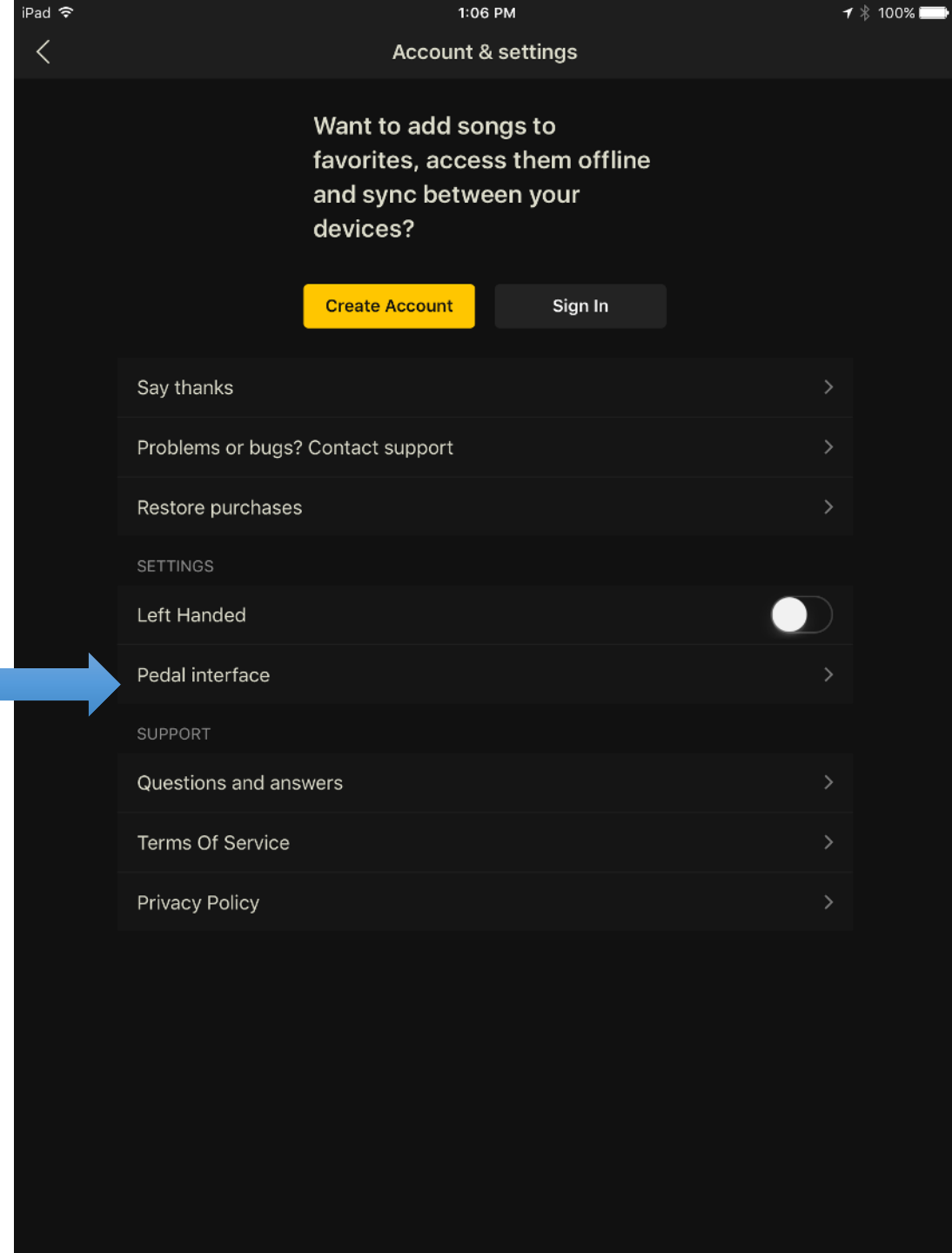

### 3. Select Air Turn Settings

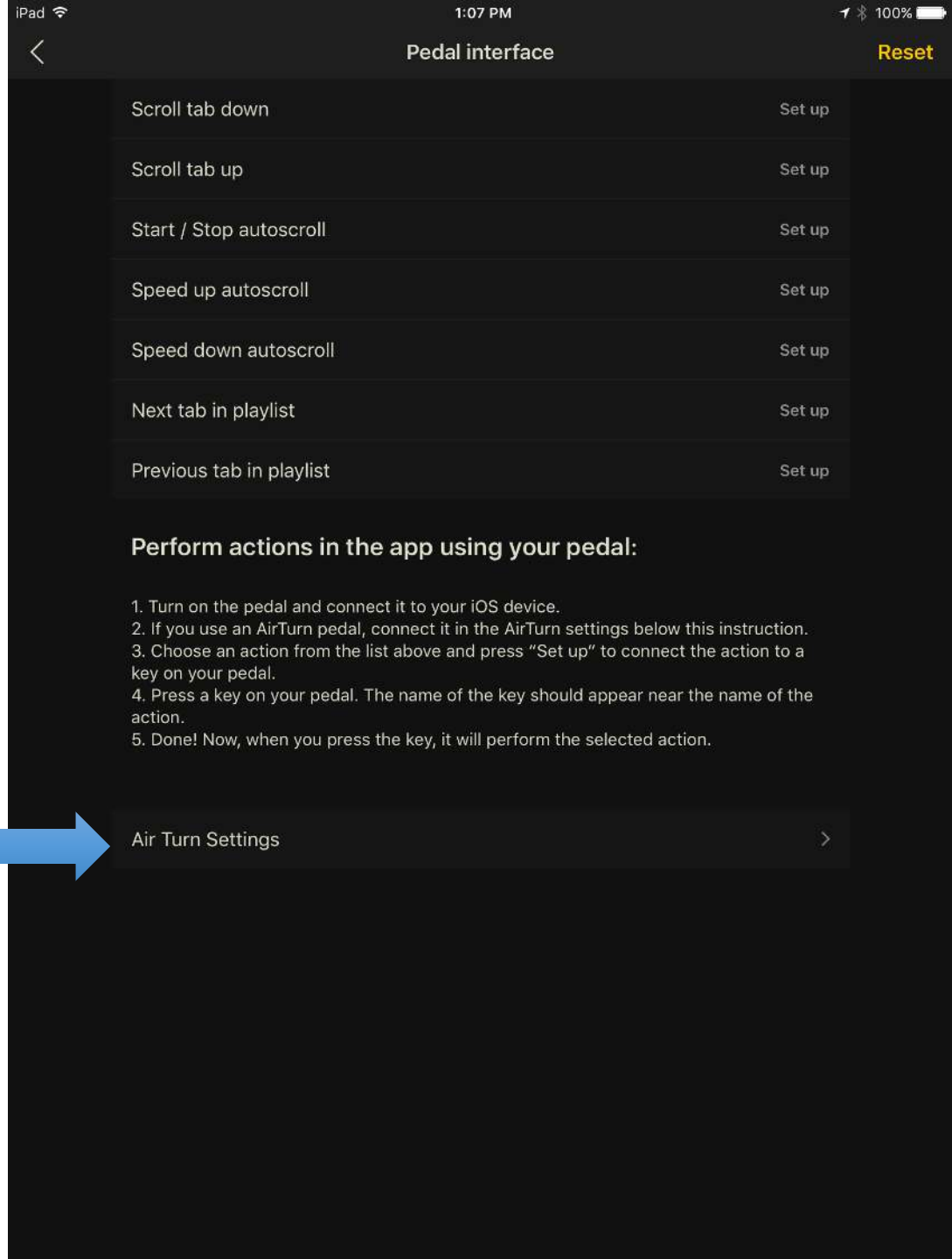

## 4. Turn on AirTurn Support

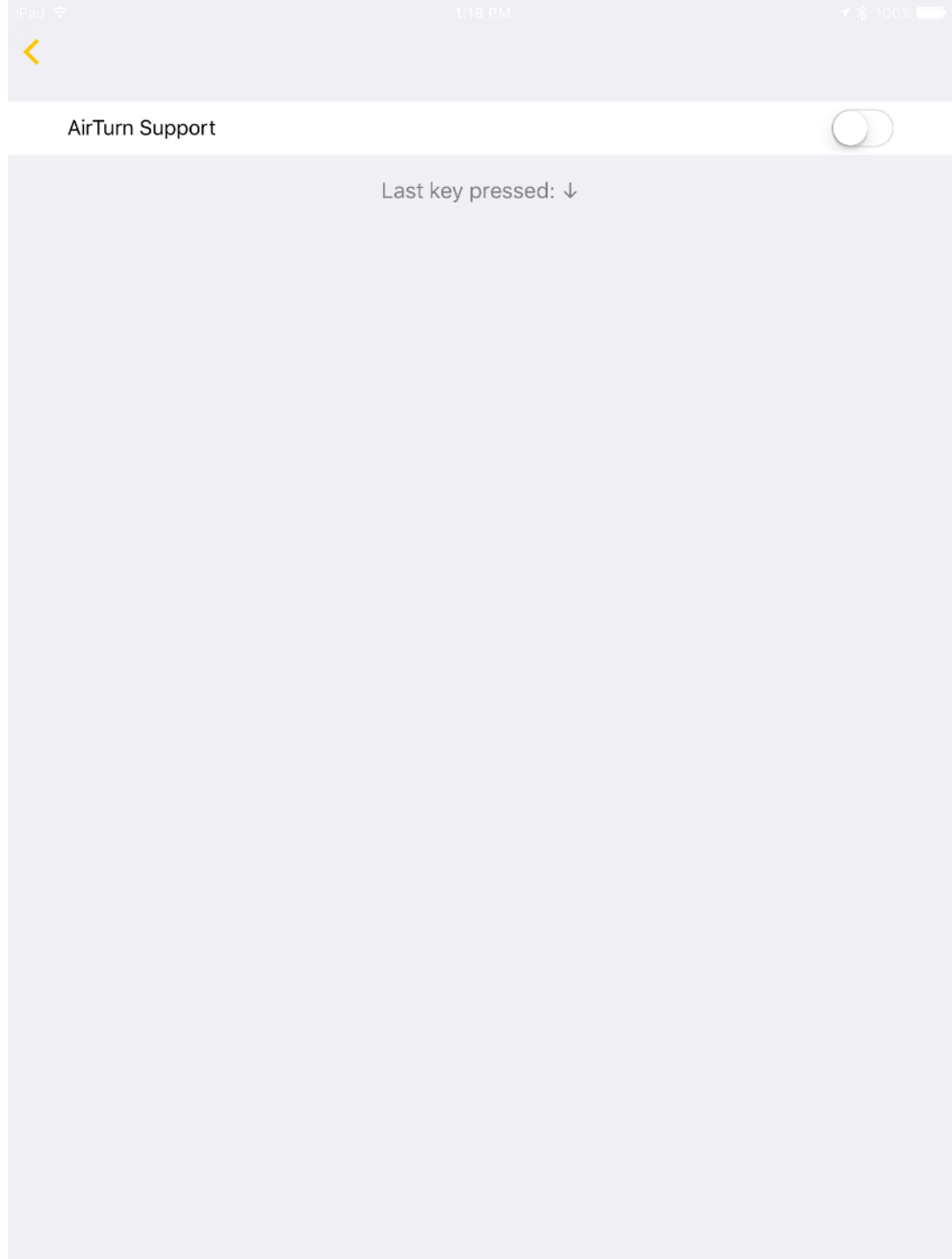

5. Select “Keyboard”

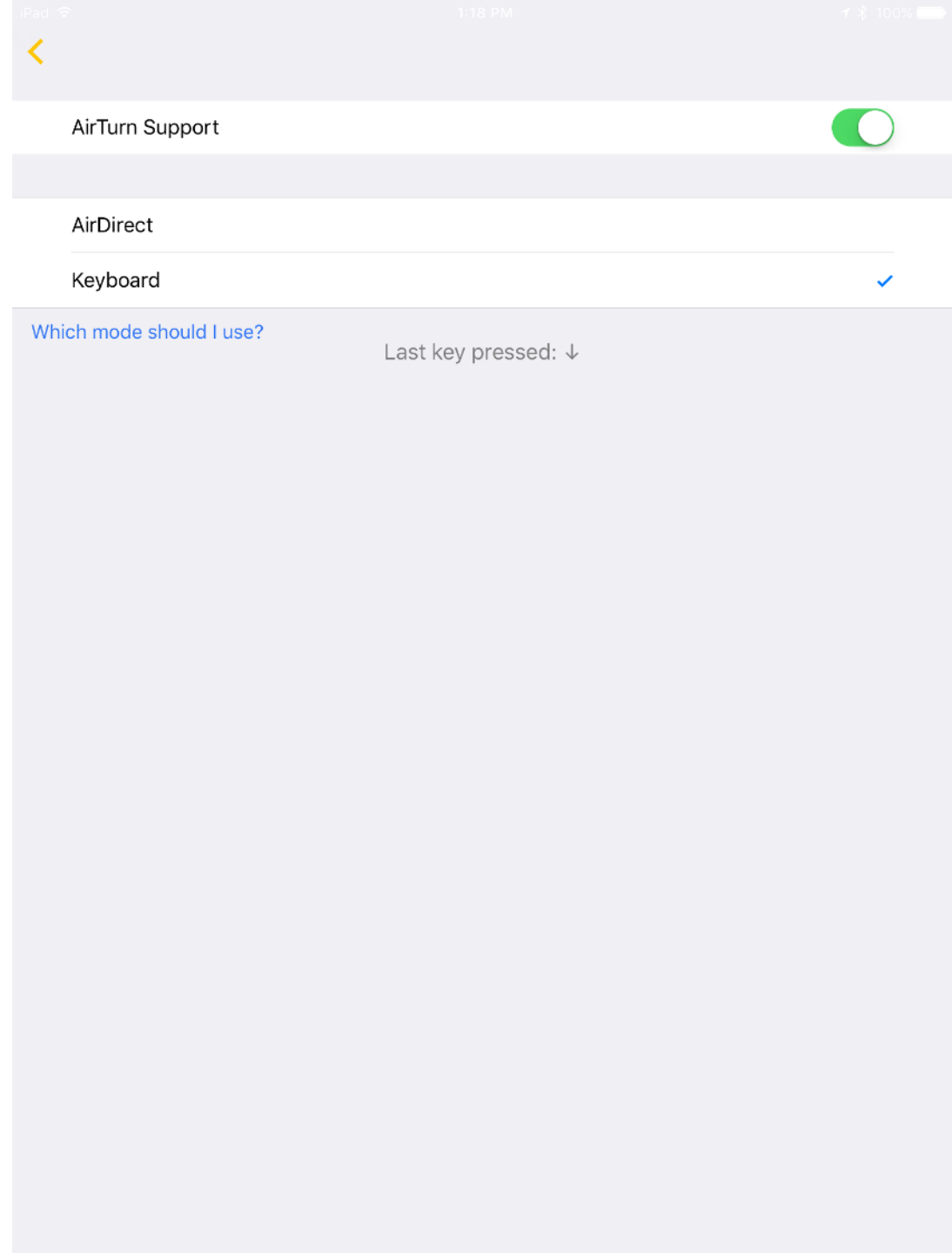

6. With your pedal paired and powered on, click on the “Pedal Interface” options and press the corresponding switch on your pedal. We recommend the following show in this screen shot.

