

User Manual

Combined W-Fi Control and Extension Lead

Specification

Voltage	230-250v
Switching current	Rated at 32A, SPST contact. For use up to 13A
Working current	For EV charging, ensure charger is set to 10A max
IP rating	Wi-Fi unit enclosure IP55 (when front cover is closed) Outdoor socket IP66
Accuracy	≤ 1 sec/day at 25°C
Back up	Settings stored when not connected to a power source. Once set, timing schedules run even when not connected to Wi-Fi
Minimum interval between on/off times	1 min
RCD (where fitted)	30mA RCBO, type A

Timer Operating Instructions

1. Install the Smart Life app, which is available for Android and iOS. Create a user account and log in.

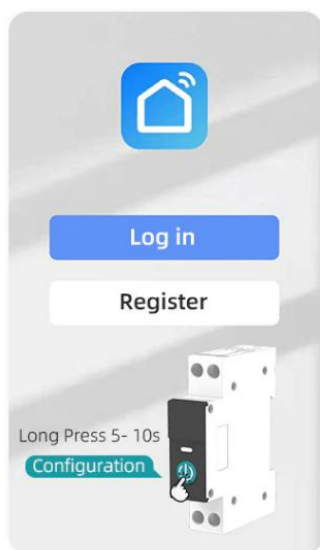

2. Turn on the Bluetooth and WiFi of the mobile phone, open the APP, and then long press the "power" button, wait for about 5-10 seconds, the LED indicator will flash blue light slowly.

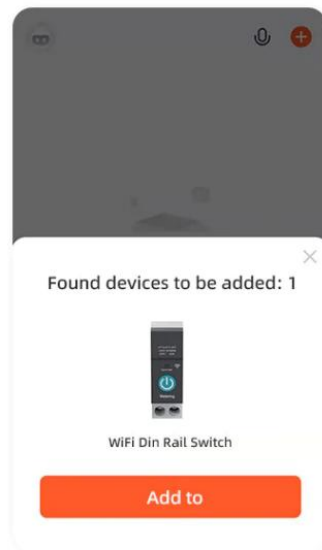

3. Waiting for a while after graphics is displayed the APP, or click the "+" in the upper right corner, then choose the "Add Device" button to wait discovering devices, then click "Add" button.

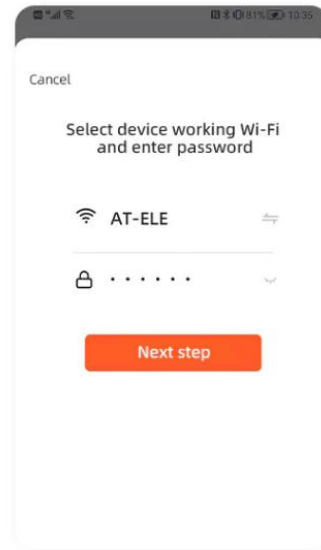

4. Enter the wifi account password and click next step, wait for the switch to connect the network.



5.The switch is connected to the network.

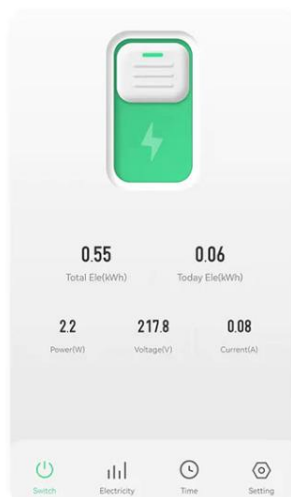

6.After the successful connection, the LED indicator will be changed from red slow flashing to red steady light.

8. You can rename the module by clicking on the pen icon in the top right corner.
9. Slide the switch up/down to control the module.
- 10.If required, use the timer, countdown and scene options to create custom routines.
- 11.For further help:
 - Go to the home page
 - Click on the 'Me' icon at the bottom right
 - Click on 'FAQ and Feedback'.
 - There is a search bar for questions at the top of the page.

RCD Operating Instructions

Section applies to units fitted with optional RCD

Function	<p>An Residual Current Device (RCD) is a life-saving device which is designed to prevent a fatal electric shock if a person comes into contact with a live wire e.g. a cable is damaged.</p> <p>An RCD constantly monitors the electric current flowing through the live and neutral wire. If a fault occurs and the live and neutral current become unbalanced (e.g. someone has come into contact with a live wire), the current will flow to earth and the RCD will detect this fault and cut the power immediately.</p>
Power switch	<p>To turn on, push lever switch upwards, with 'ON' then showing on the switch.</p> <p>To turn off, push lever switch downwards with 'OFF' then showing.</p>
RCD function	In the case of a fault, the RCD will trip, with the lever switch moving to the downward 'OFF' position. Push the switch upwards to reset.
Test function	Press the small push button marked 'T' to test the operation of the RCD.