

Quick Start Guide



Thank you for purchasing Swift Hitch SH04 WiFi Camera. This camera can be viewed by any type of smart phone using Android / iOS system. Please read this Quick Start Guide carefully before using the camera

Start Here

Step1: Download Free APP: Swift Wifi Cam

You can search Swift WiFi Cam in APP Store for iPhone or Google Play for Android phone (Or Scan the QR code below with APP such as Quick Scan to download the APP)



Step2: Power on camera

Press power button to turn on the camera, Power LED on the back will be green on. After 30 seconds, the front Status LED starts to blink slowly, then the camera is ready to be linked. (Having camera charged 5~6 hours before use is recommended).

01

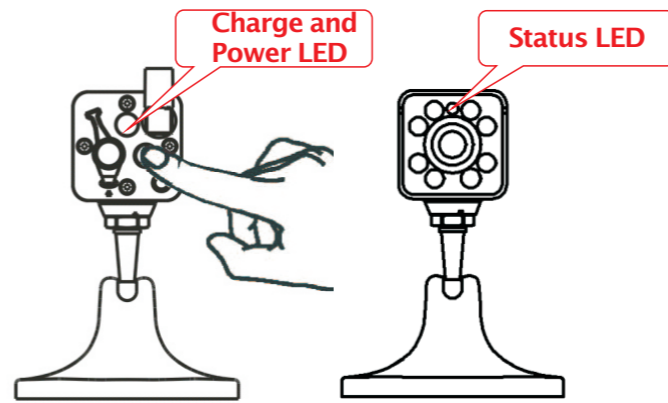

Step3: Link camera to smart phone

Turn on the wifi option on cell phone first and select camera's wifi ID:SWIFTCAM_XXXXXX. After selection, leave the password space blank. There is no password needed.

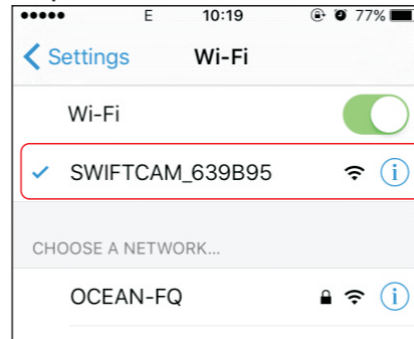

02

Step4: View the camera on smart phone

Run downloaded APP: "Swift Wifi Cam" on your smart phone. Tap "Add a new camera" and then tap "Search in LAN"

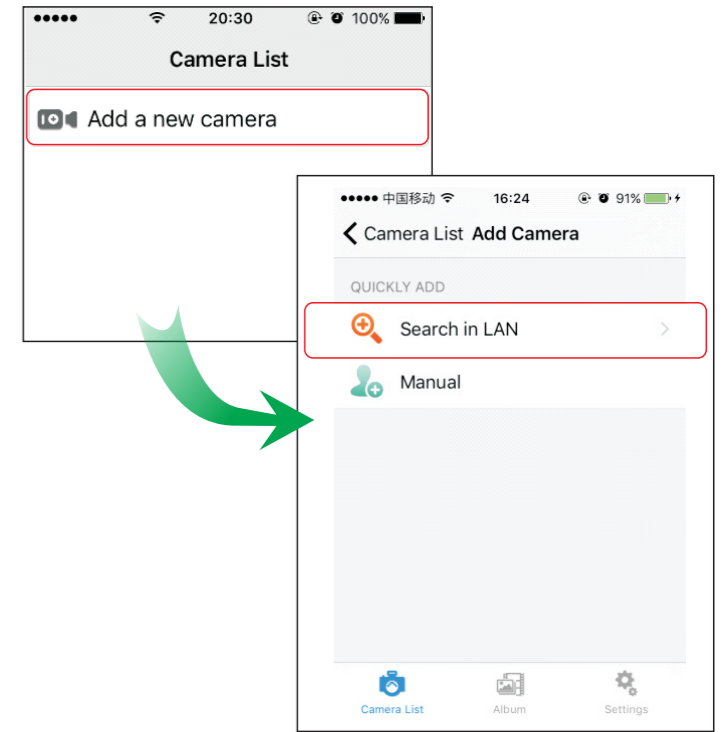

03

Front Status LED Behavior

LED Behavior	Meaning
Green LED on	Camera power is on and is in normal booting process. After booting process complete, previous saved AP mode or STA mode will be restored. The factory default setting is AP mode.
Green LED off	Camera is in STA mode and has successfully connected to a previously linked router.
Green LED blinking every half second	Camera is in STA mode and failed to connect to previously linked router. (It might be caused by router's password change, router's power off or too far away from router)
Green LED blinking every second	Camera is working in AP mode and can be linked to smart phone / tablet directly

The linked camera will be listed out on the page, tap on the camera and enter its "Save camera" page. Tap "Save" (You do not need fill in password field)

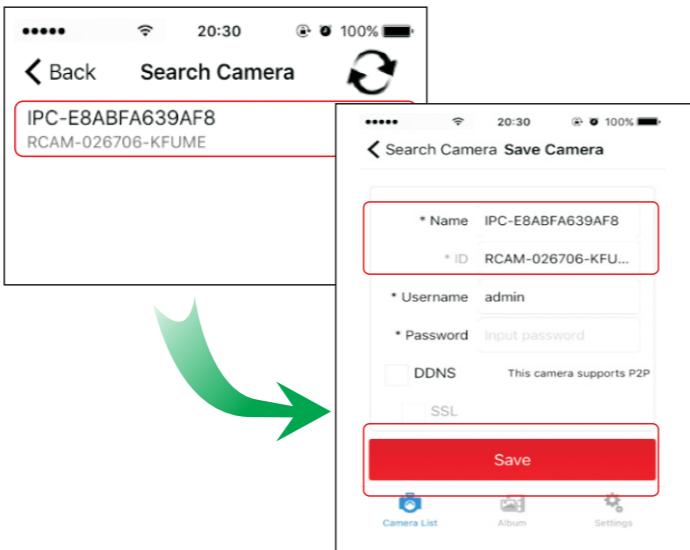

04

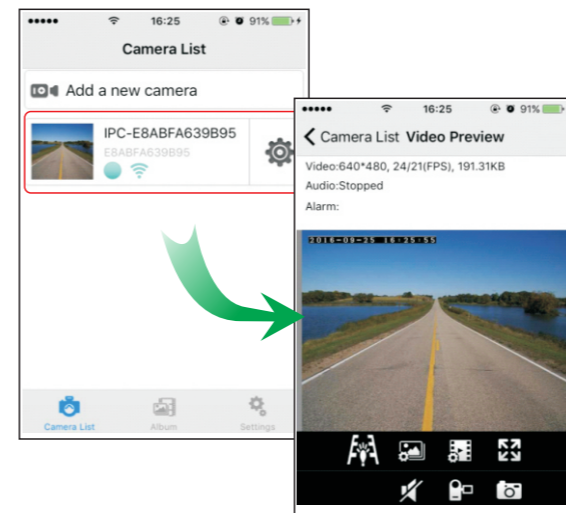

TIPS:

This camera can be operated in two modes. One is STA mode, another one is AP mode. Changing between two modes need to be manually operated.

STA mode: Camera can connect to Internet via router.

AP mode: Camera allow smart phone to be linked DIRECTLY.

Camera factory default setting is AP mode. Front status LED behavior will give you information about what mode camera is in after power on.

05

How to change camera from AP mode to STA mode

Step 1. Open APP "Swift Wifi Cam" and come to "Camera List" page.
Step 2. Tap setting icon beside the camera you want to connect to router

Step 3. Tap router option on the pop up window and then select the SSID of your router and input password to link to your router. The camera now is in STA mode.

Detail information please refer user manual on page 10.

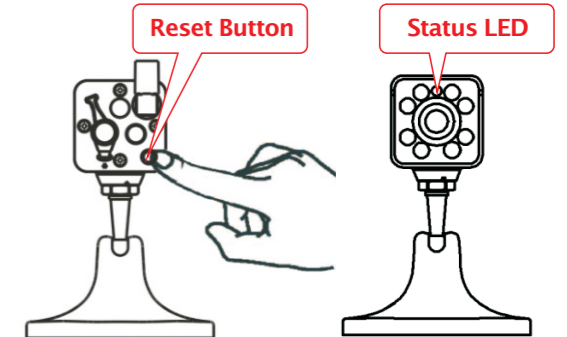

How to change camera from STA mode to AP mode.

Step 1. Power on camera and waits 30 seconds to allow camera to finish booting process.

Step 2. Press reset button and hold for 5 seconds.

Step 3. Release reset button and continue to wait about 20 seconds until status LED blinks every 1 second. The Camera is in AP mode now.

06

www.swifhitch.com

2017 Suntronics Technologies Inc. All Rights Reserved. Swift Hitch® is a registered trademark of Suntronics Technologies Inc. Tel: 617-600-8282 Email: swifhitch@sun-tronics.com Address: 200 Centreport Drive, Suite 365, Greensboro, NC 27409 USA

