

JAS
JONATHAN AMAR STUDIO



THE CAELI

A contemporary handcrafted made-to-measure pendant light fixture composed of an expertly handcrafted brass structure and a meticulously handwoven rattan shade.

A beautiful statement piece for living areas or as kitchen island lights.

Specifications

Standard shade size is 60cm (23.6in) x 60cm (23.6in)

Drop height is custom

We also tailor the size to your requirements

Available finishes:

- light or dark rattan tint
- lacquered steel
- aged or polished brass

LED bulb 12W dimmable, 3 x E27 (fits E26)

Production lead time: 6-7 weeks

The Caeli-S1
fabric, polished brass
60cm x 60cm



The Caeli-S
rattan, polished brass
60cm x 60cm



The Caeli-S2
rattan, aged brass
40cm x 40cm
35cm drop



The Caeli-W
rattan, white lacquered steel
made to measure





The Caeli-W

rattan, white lacquered steel



Made to measure Caeli

rattan, aged brass



Made to measure Caeli

tinted rattan, aged brass



XL Made to measure Caeli

rattan, aged brass

STANDARD
CANOPY US

130

25

14

Tube
diameter
14mm
Ep/1mm

410 ADJUSTABLE

BRASS

400

20

20

1010

NATUREL
RATTAN/
TEINTE
RATTAN

4

600

600

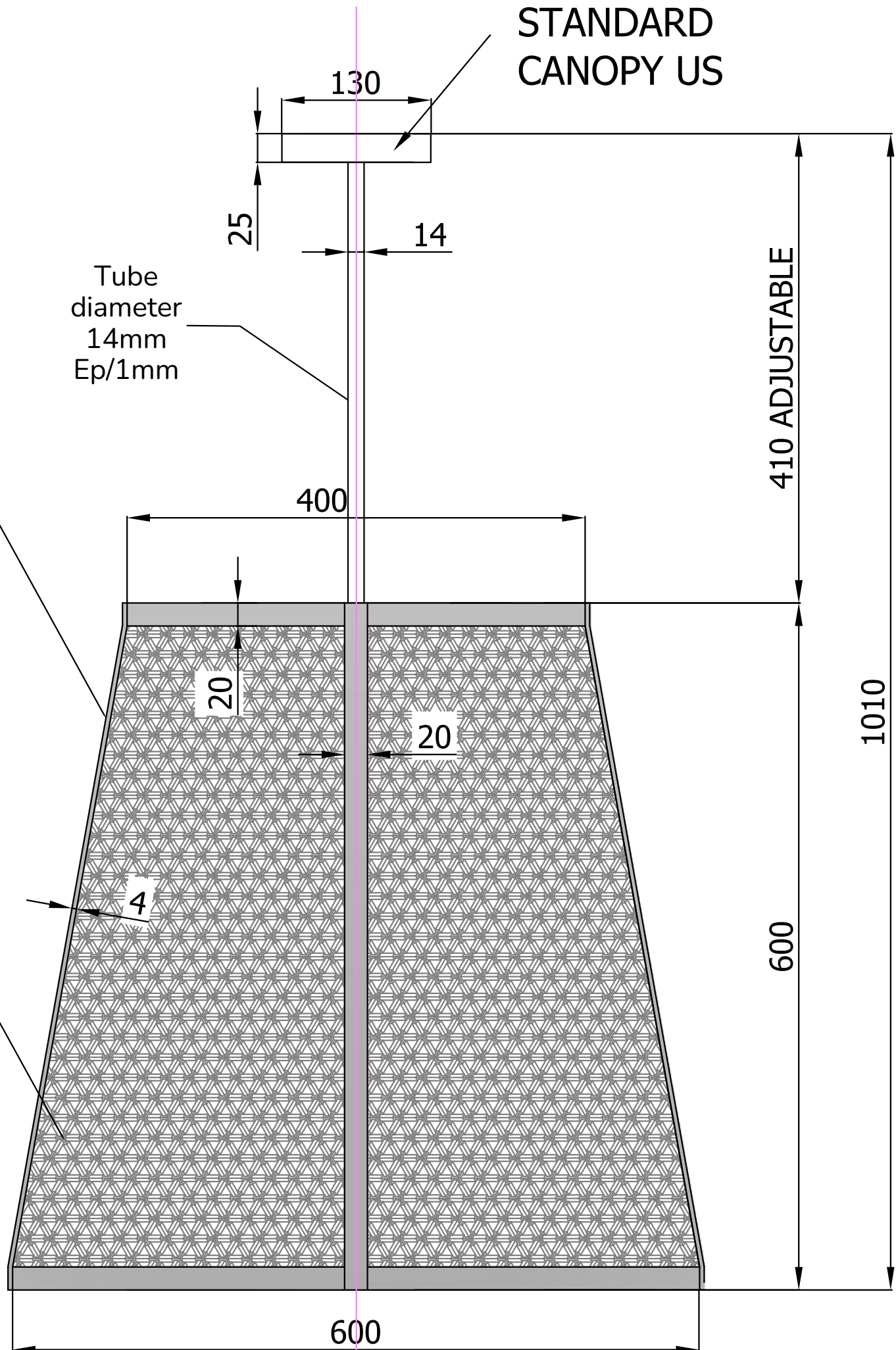

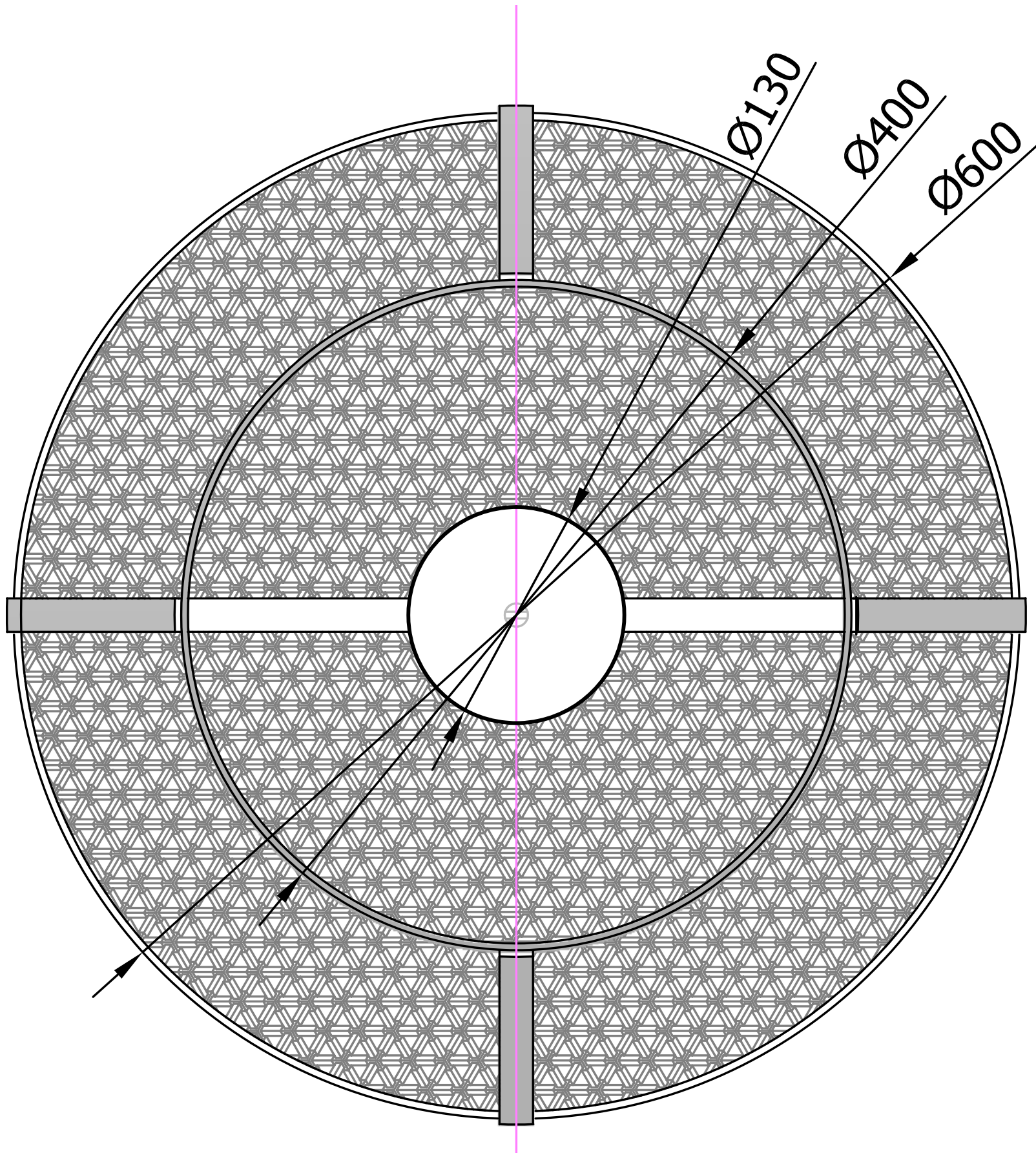

Tinted

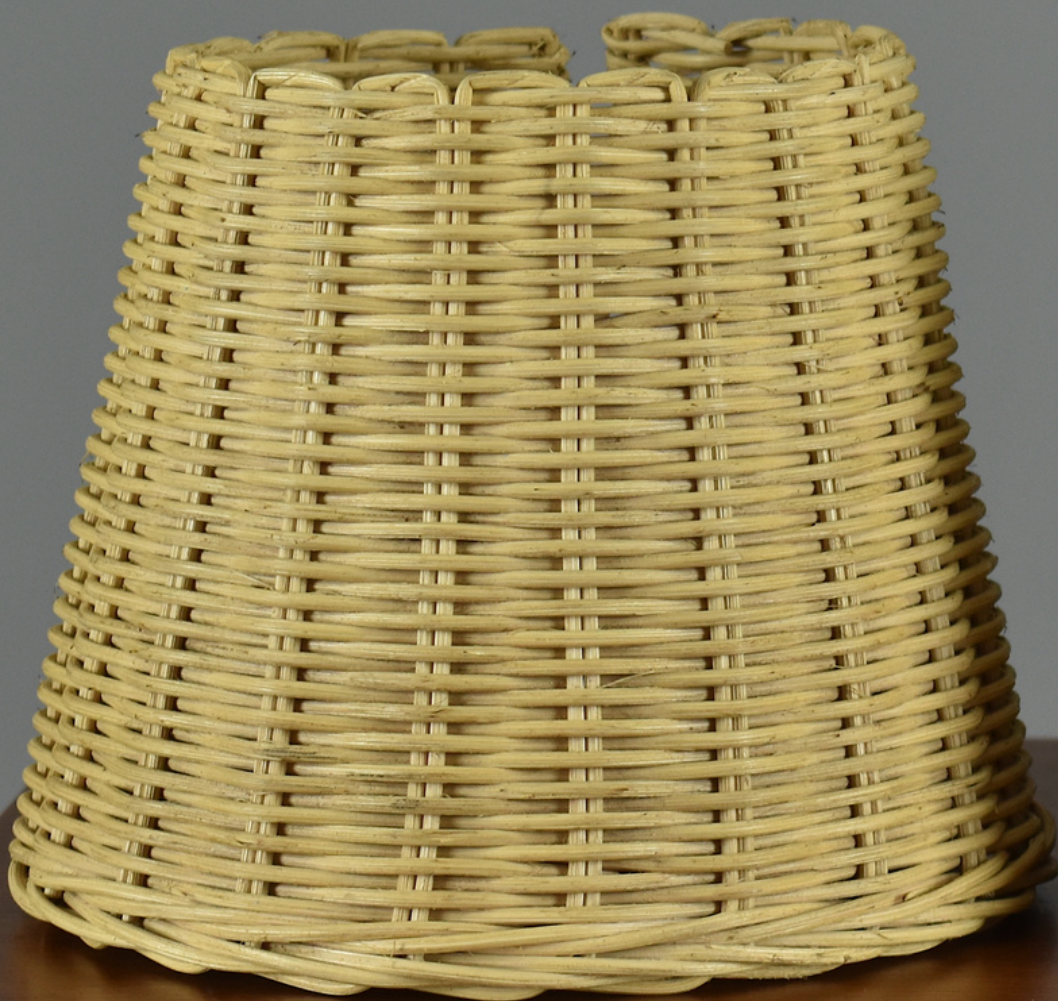

Natural

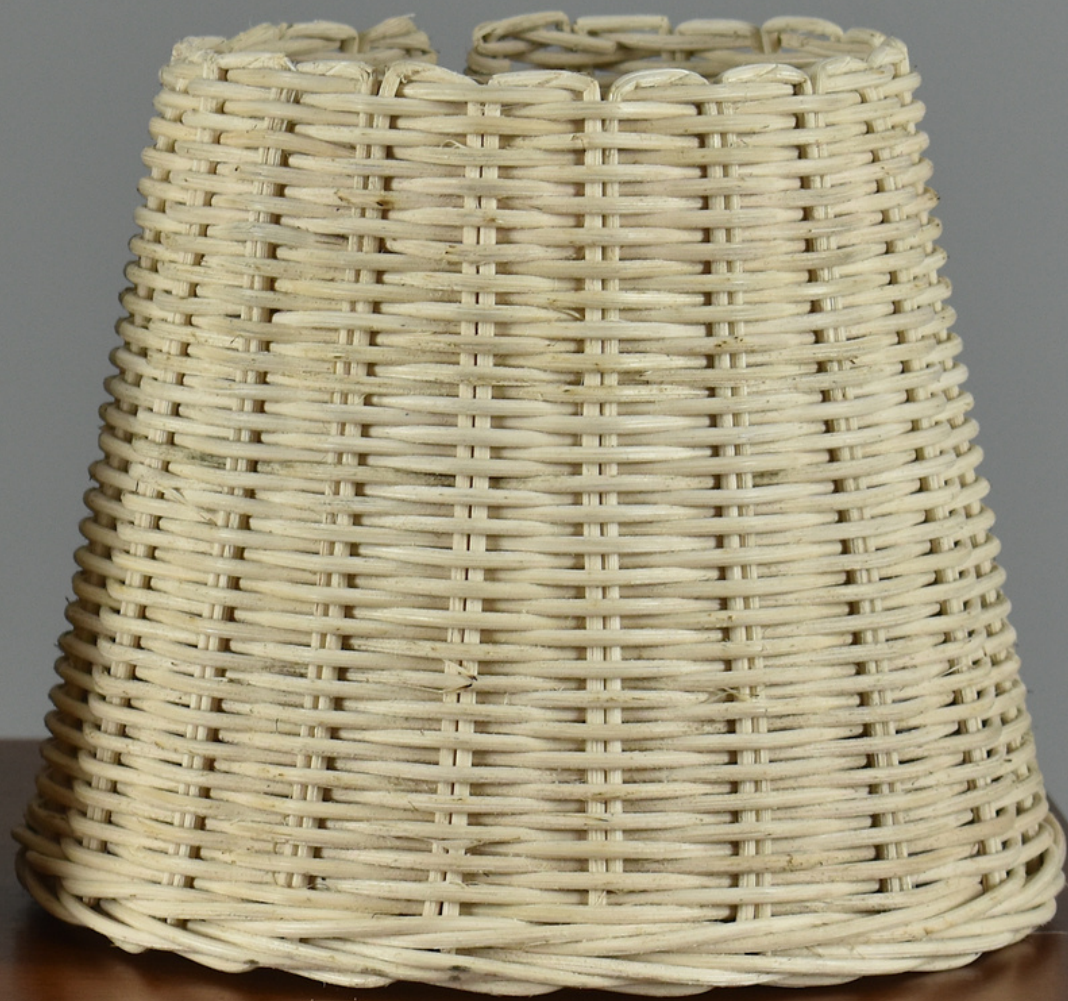



Polished brass



Aged brass



White lacquer, steel

CAELI
INSTRUCTION MANUAL

Socket: E26 socket base, MAX. 15W each

Voltage: 120V



ATTENTION

Always shut off power
before installing and doing
any cleaning or
maintenance.



All products are manufactured to
meet or exceed North American
standards C22.2-250, UL 1598,
C22.2-12, C22.2.9, UL 153.

All preparation for installation of
fixture is to be provided by the
end user.

The description and measurements
on this drawing are for information
purposes only.

JONATHAN AMAR STUDIO, 2024
All rights reserved.

1 Screw backplate to ceiling and J-box.

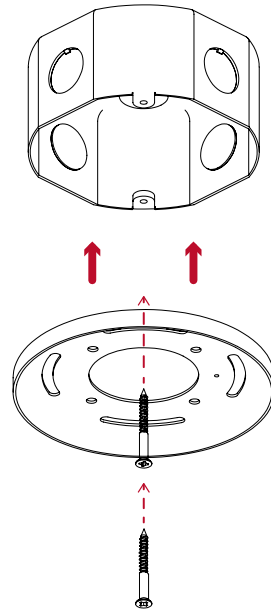

2 Make the electrical connections, inside canopy

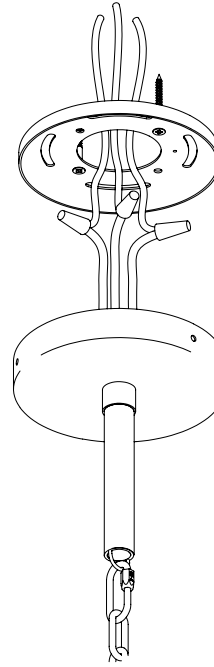

3 Hide electrical components/connections inside J-box.

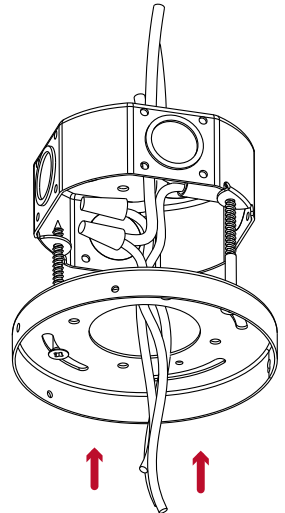

4 Fix canopy to backplate

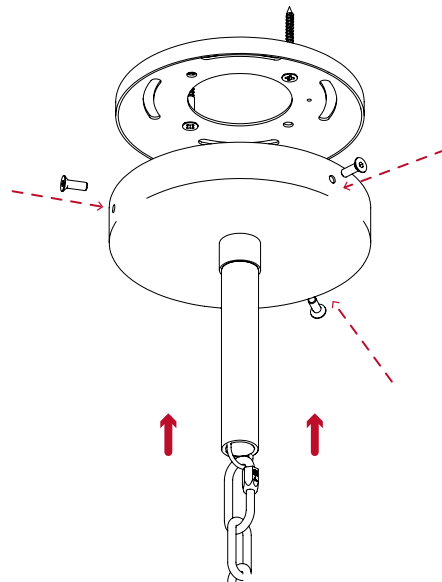

5

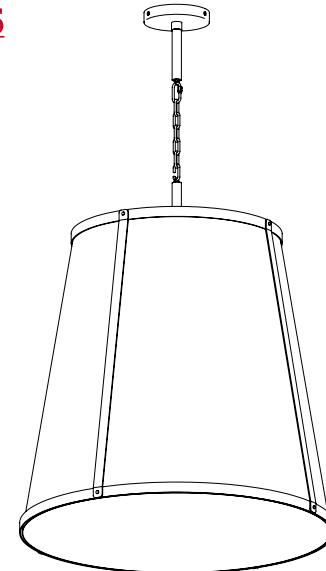



ABOUT Since 1989 Jonathan Amar works on prestigious projects internationally for both private and commercial spaces. His activities are split into three domains: - Design studio - Lighting manufacture - Interior design.

Our studio handcrafts bespoke brass lighting, tables and ceramics. Our pieces are modular designs that embrace a contemporary outlook on traditional Moroccan craftsmanship and high-quality Portuguese glass. Our know-how stems from combining traditional materials such as wicker, rattan and leather and meticulous workmanship.

. Brass and Portuguese glass are the central components of the collection and available in an array of finishes. Since these work well with a multitude of materials, our studio associates it with a unique palette of colors and textures. Expertly hand-woven rattan and wicker are used to design lampshades; original Zellige mosaic designs form tabletops; lamp stems are sheathed in various hand-stitched leather colors by artisan saddlers. Hand-engravings and brass openwork, core know-hows of the studio, bring forth a new perspective on each design.

Flow is a customizable collection that adapts to all types of clients and professionals for small and big scale projects. This collection embraces a contemporary outlook on our rich Moroccan heritage.

Craftsmanship

Handcrafted in Portugal, France and Morocco with French and Italian materials, Flow honors the relationship between meticulous workmanship and quality materials through the thickness, finishes and fixtures of each creation. Due to the handmade nature, each piece is unique and might vary slightly in finish.

To name a few interior design projects: Royal Mansour, Les Bains Douches, Comptoir Marrakech, Renaissance hotel, Castel, Nobu, numerous Costes restaurants and bars in Paris, Momo's and Sketch in London, Aroma Café in Bahrein, Club Med suites, Saint James hotel, consultancy for Ping Pong London.

Jonathan Amar also intervenes as a consultant for international design firms with luxury projects in Morocco where his studio oversees artisanal production units.

Contact us at info@spiritgallery.fr or +212661414500

www.spiritgallery.fr

www.jonathanamar.net