

THE WATERCOLOR BOARD™

SUCCESSFUL STRETCHING WITH YOUR NEW WATERCOLORBOARD™

The most important part of a successful stretch is getting the paper much wetter than your wettest washes. The Watercolorboard adds additional tension all around the edges of the paper so that even during the wettest of washes the paper stays flat and even.

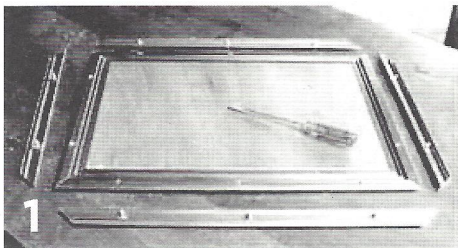

1. Since the screws are attached to the aluminum, they should be removed somewhat evenly. **Go around and loosen each screw one or two turns until they are all loose**, then lift off the top rails.

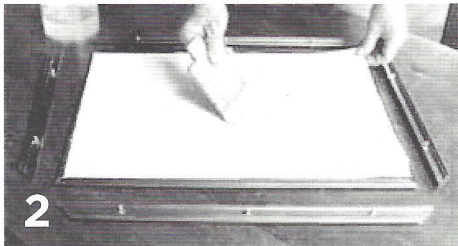

2. Lay your paper on the board, and with clean water and a wide brush, **thoroughly wet both sides** of the paper. Roll the paper up while applying more water. This stretches the paper fibers out and lets them absorb more water. Now roll the paper up from different directions, turning it over and rolling from the other side while applying more water. Let it sit for 5 or 10 minutes to further absorb the water. The paper should feel very pliable, almost like a fabric. If you work very wet or are using 300 lb. paper, roll and wet it again to make sure it is soaked. If the paper buckles during a very wet wash, then it wasn't wet enough, so next stretch, wet and roll it more. After a few stretches you will get the feel of how wet to get the paper for your style of painting.

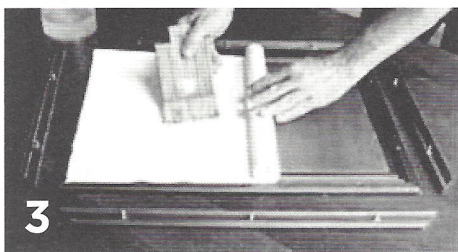

3. Lay the paper on the board lining it up with the edges. Smooth out any wrinkles by picking up each corner, one at a time, and pulling outward from the corner. Place the top rails back on pushing the screws into their holes. Starting from the center, start turning each screw one or two turns at a time, clock-wise, until they are all snug. Further tighten the screws until the sides are flat and the corners look even. **There is no need to over-tighten.**

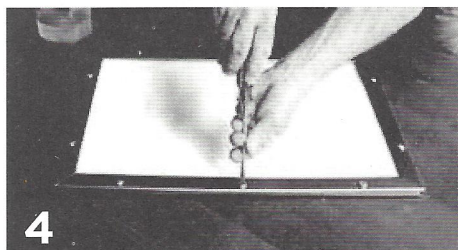

4. When stretched, blot dry with a blotter or paper towels and place in the sun or in front of a fan to speed up drying. When finished with the painting, let it dry completely before you remove it from the frame. This will keep it completely flat for framing. If it is not completely dry, buckles will form as it dries.

TROUBLESHOOTING

If your paper buckles after a very wet wash, it could be one of three things:

1. The paper did not get wet enough. Next stretch, soak and roll it more, and let it sit a little longer while absorbing more water.
2. The paper was not tightened enough, next time go around and tighten it more.
3. The paper was not completely dry when you began your wash. The part of the paper that is hidden under the extrusions dries slower, but this is the part that really holds the stretch.

If you are doing a really wet first wash on a large piece of paper give it a few hours with a fan to make sure that it is really dry. You may draw in the evening, stretch it, then let it dry all night. This tends to produce the best stretches.

For more information about this and other Guerrilla Painter products for artists:
www.guerrillapainter.com
866.493.0217