

## Making Life Easier And Safer

Staying in touch when using your microTALK® radio.

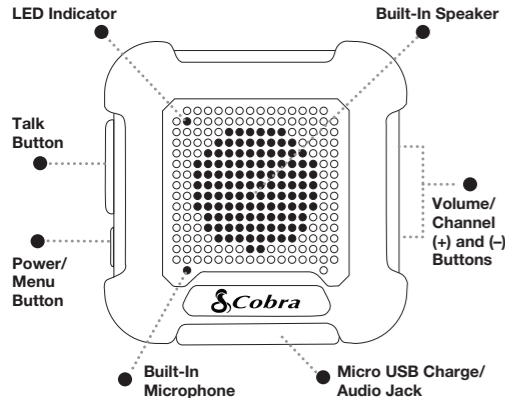

**TWO-WAY RADIO MODEL**  
**AU220**

KEM-ML41401



## Operational Cautions

Exposure to high volume sound levels may cause temporary or permanent damage to your hearing. Although there is no single volume setting that is appropriate for everyone, you should always use your radio with the volume set at low level and avoid prolonged exposure to high volume sound levels.

1. Set the volume control in a low position and use as low a volume as possible.
2. Avoid turning up the volume to block out noisy surroundings. Whenever possible, use your radio in a quiet environment with low background noise.
3. Limit the amount of time you use headsets or earpiece at high volume levels.
4. When using the radio without a headset or earpiece, do not place the radio's speaker directly against your ear.
5. Observe all signs and instructions that require an electrical device or RF radio product to be switched off in designated areas, such as gas/refueling stations, hospitals, blasting areas, potentially explosive atmospheres, or aircraft.
6. If you experience a skin irritation after using this product, discontinue use and seek medical attention.
7. If the product or charger: overheats; has a damaged cord or plug; has been dropped or damaged; has been dropped into water, disconnect any charger from its power supply, discontinue use of the product.

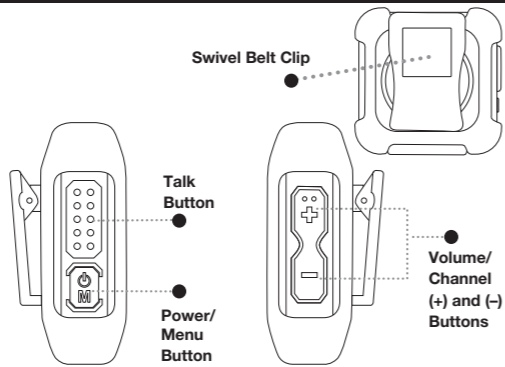

**Note:** Only Channels 1 to 8 are available by default. Channels 9 to 16 need to be activated by user before they can be selected. Channels 9 to 16 should only be used in countries where these frequencies are allowed by government authorities.

**Maximum/Minimum Operating Range:**  
-20C to +45C.  
**Maximum SAR values:**  
0.108W/kg for FM 12.5KHz  
**Frequency Band:** 446MHz.  
**Average and maximum radio-frequency power:**  
25mW.



## Using Your Radio

### Power Button

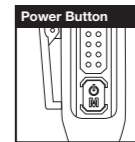

Press and hold **Power** button for 4 seconds to turn the radio on or off. Once the unit is on, Green LED flashes every 5 seconds.

### Talk Button

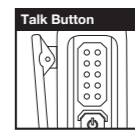

- Press and hold the **Talk** button to communicate with others.
- The microphone should be about 15 cm from your mouth.
- When talking, speak in normal voice.
- Release the **Talk** button when you are finished talking and listen for a response from the other person.
- You cannot receive at the same time while pressing the **Talk** button.



**NOTE:** Both radios must be on the same channel to communicate.

### Electromagnetic Interference

Nearly every electronic device is susceptible to electromagnetic interference (EMI) if inadequately shielded, designed, or otherwise configured for electromagnetic compatibility. Turn off your radio in any facility where posted notices instruct you to do so. These facilities may include hospitals or health care facilities that may be using equipment that is sensitive to external RF energy.

- When instructed to do so, turn off your radios when on board an aircraft. Any use of a RF device must be in accordance with applicable laws, regulations and airline crew instructions.
- Some radios may interfere with some hearing aids. In the event of such interference, you may want to consult your hearing aid manufacturer or physician to discuss alternatives.
- If you use any other personal medical device, consult the manufacturer of your device to determine if it is adequately shielded from RF energy. Your doctor or physician may be able to assist you in obtaining this information.



**WARNING - CHOKING HAZARD - SMALL PARTS**  
Not for children under 3 years. This product is not intended to be used as a toy or plaything.



## Using Your Radio

### Volume/Channel (+) and (-) Buttons

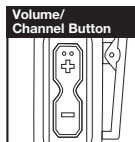

Press the + or - button to increase or decrease the volume. There are 12 different volume levels.

### Select a Channel

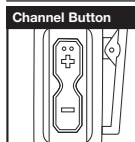

To change the channel, press **Power/Menu** button once, the current channel number prompted. Then, press the + or - buttons to select your channel, and you can:

1. fast press to skip voice prompting of every channel number
2. press and hold for fast skipping

It will exit the channel selection mode if there is no + or - button pressing for 5 sec. Or simply press **Power/Menu** button or **Talk** button once to return to standby mode immediately.



Note: Your radio has 8 channels by default. In countries where 16 channels are allowed, you can activate Channel 9 to 16 with the following steps:  
 Press and hold **Talk** button and then, turn on the radio by press and hold the **Power/Menu** button for 4 seconds simultaneously.  
 "8 channel" or "16 channel" will be indicated alternately for the mode entered.  
 Repeats steps above to toggle between the 8 channels or 16 channels mode.

### Micro-USB Charge Jack



Plug the USB cable into USB-compatible power port, then, insert the Micro-USB's connector directly into the charging port located bottom side of the unit.

- It will take around 5 hours for a full charge.
- Recommend to power off the device during charging.

### Battery Information

The battery is not charged before delivery, so please charge the battery for your first use. If the battery is not used for a long time or the battery is used up, please charge it before use. Charge / discharge for twice or three times alternately to achieve its optimal performance.

Note:

- Do not cause any short circuit on the battery or throw the battery into fire.
- When charging, please make sure the radio is powered off to guarantee it can be fully charged.
- Do not leave the radio or battery on the charger after it is fully charged. Unnecessary constant charging will shorten the battery life.
- Do not put the fully-charged battery to re-charge, or it may shorten the battery life.

- Please try to keep the battery in an indoor environment at around 25°C. The battery may get easily spoiled after being kept in the environment below -10°C for a long time.
- In temperatures higher than 35°C or below -10°C, the dischargeable power of the battery may decrease due to the physical property of lithium battery.

### LED indicator

When you press and hold <b>Talk</b> button	Green LED on
Standby Mode	Green LED flashes every 5 seconds
Battery Low	Red LED flashes every 5 seconds
Power Off the Device during charging	
Under Charging	solid Red (No flash)
Fully Charge	solid Green (No flash)

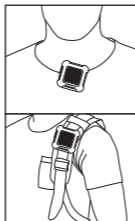

### Secure your microTALK® radio

Carrying your microTALK® radio with you is easy when using the 360° Swivel belt clip, which easily attaches to your sweater, belt or backpack.



## Declaration of Conformity (DoC)

We, the company

Altis Zenus BV in the Netherlands  
Wassenaarseweg 57,  
2596CL The Hague  
Niederlande/ Netherlands

declare under our sole responsibility that the following product

Type of product: Walkie Talkie  
 Trademark: Cobra  
 Model: AU220  
 Further details: battery operated, 446MHz

meets the essential requirements of the following EU-Directives:  
 2014/53/EU Directive on the making available of radio equipment on the market  
 2011/65/EU Annex II amending Annex (EU)2017/2102  
 Directive on the restriction of the use of certain hazardous substances  
 in electrical and electronic equipment

applied standards and regulations:

EN 60950-1:2006+AC:2011+A11:2009+A1:2010+A12:2011+A2:2013  
 EN 50566:2017  
 EN 303 405 V1.1.1 EN 300 296 V2.1.1  
 EN 301 489-1 V2.1.1 EN 301 489-5 V2.1.1  
 IEC 62321-3-1:2013 IEC 62321-4:2017  
 IEC 62321-5:2013 IEC 62321-6:2015  
 IEC 62321-7-1:2015 IEC 62321-7-2:2015  
 IEC 62321-8:2017

Authorized person for technical documentation:  
 Name, Position: Jaap Derk Buma, Director



The Hague, 30-10-2018  
 .....  
 Date

Signature



## Warranty & Customer Service

### Trademark

CEEL™ is a registered trademark of Cobra Electronics Europe, Ltd.

Snake design and microTALK® are registered trademarks of Cobra Electronics Corporation, USA.

### Warranty & Customer Service

For warranty and customer service information, please contact your dealer.

For use in EU countries, subject to local laws and regulations.

©2018 Altis Zenus BV in the Netherlands  
 Wassenaarseweg 57,  
 2596CL The Hague  
 Niederlande/ Netherlands

