

installation instructions

1. U - tube A
2. adjustable tube
3. T-tube
4. foot tube
5. connected pipe
6. U - tube B
7. C clip

Bedside Grab Rail

SKU: BE433

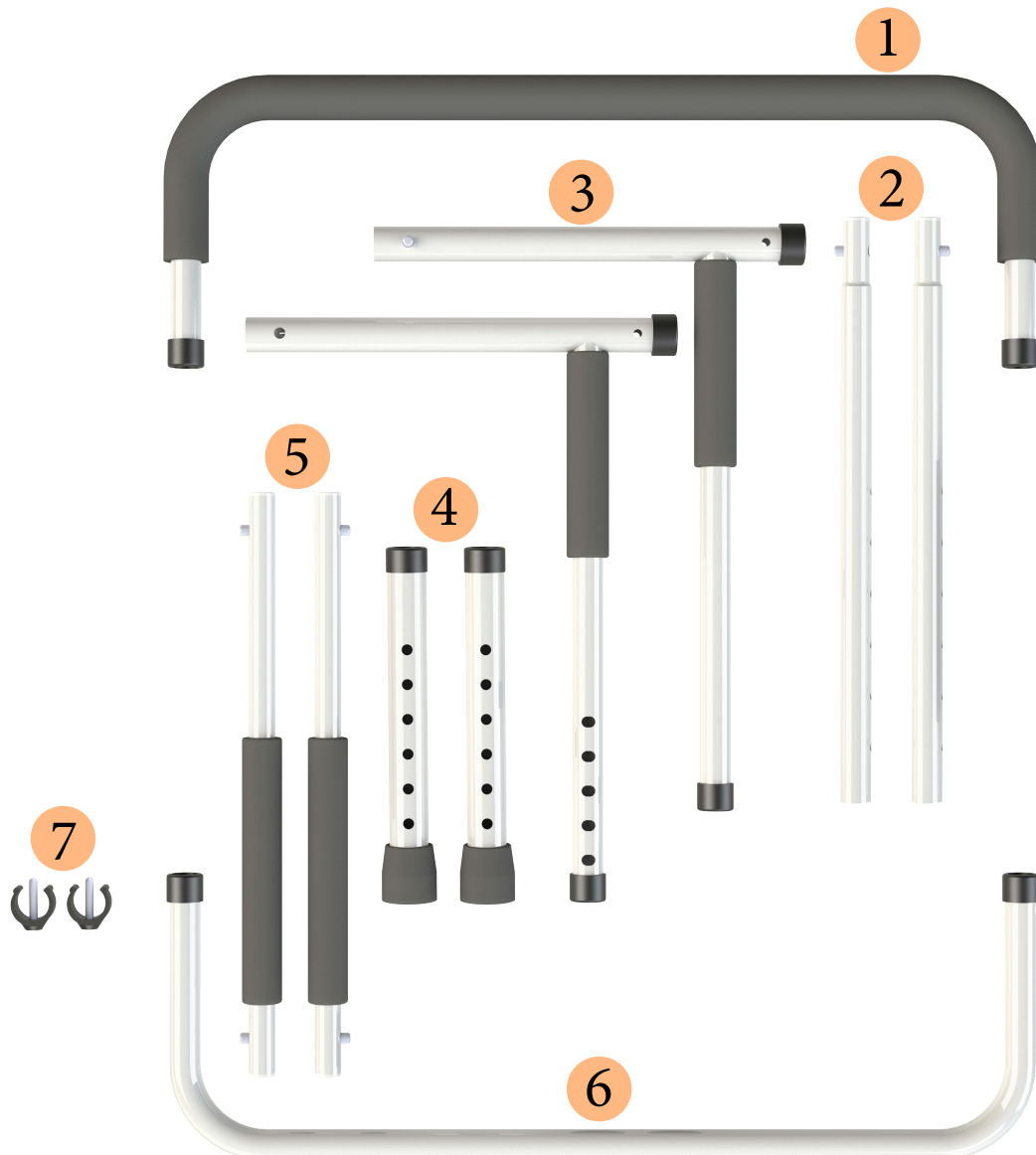

Bedside Grab Rail

SKU: BE433

installation instructions

Install the grab rail as shown in the below picture, adjust to the proper holes when installing no.2 and no.3, and insert the C clip to secure it.

