

# Gas Filler air (Zero) calibration

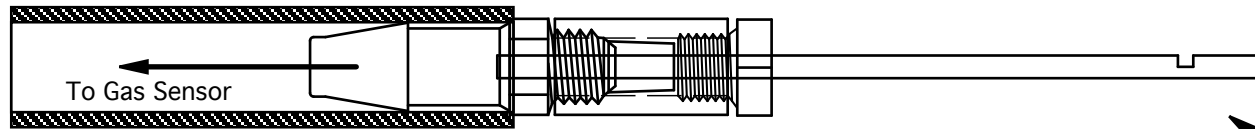

Sensor hose (sniffler)

Sniffer is pointed away from the filling lance pulling normal air across the sensor.

## Step 1

Press and hold cycle start button  
(or flip Sensor O-ride to up position)

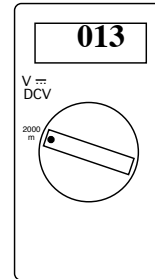
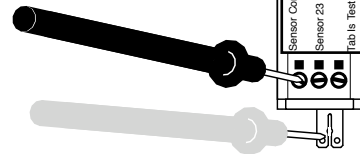
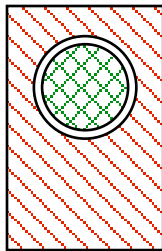

With lance hanging free in the air  
adjust Zero pot to  
13 mv (0.013 vdc)

Output hose is pointed away from the sniffer to keep argon out of the sensors during air calibration.



Output hose (filling lance removed)

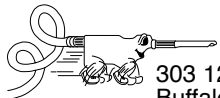

**FDR Design, Inc.**

303 12th Ave. South phone 763-682-6096  
Buffalo, MN 55313 fax 763-682-6197

1.5mm slow sniffer  
complete  
Calibration • Step 1

Created:

2/9/93

DAN

Last Modified:

8/7/03

CG

Scale:

2/1

Sheet 1 of 2

Drawing Number:

**10375-A**

# Gas Filler argon (Gain) calibration

The filling lance has been carefully removed, and the sniffer lance is set inside the Output hose. It is important to leave room around the end of the sniffer for excess gas to escape.

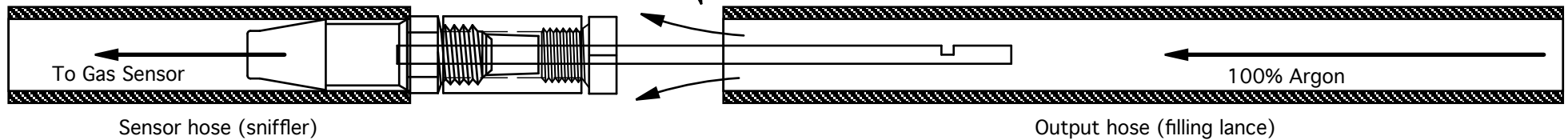

## Step 2

Press and hold cycle start button (or flip Sensor O-ride to up position)

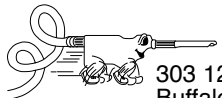
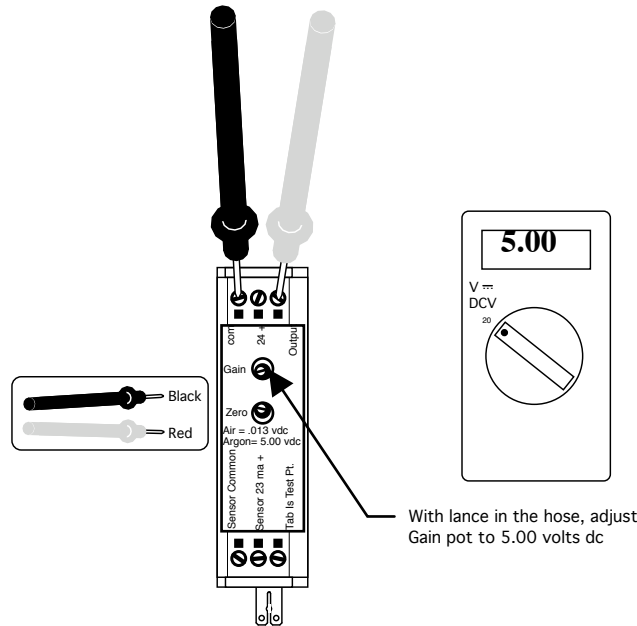
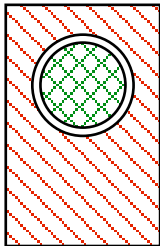

**FDR Design, Inc.**

303 12th Ave. South phone 763-682-6096  
Buffalo, MN 55313 fax 763-682-6197

1.5mm slow sniffer  
complete  
Calibration • Step 2

Created:

2/9/93

DAN

Last Modified:

8/7/03

CG

Scale:

2/1

Sheet 2 of 2

Drawing Number:

**10375-A**