

Jam

Composed of just
three different elements



normann
COPENHAGEN

Clever design

Composed of just three different elements, the Jam bookcase is a cleverly and elegantly executed design. The defining element is a wedge, which allows the bookcase to be assembled without the use of screws or tools. The shelves are quite simply jammed onto the wedges and then gravity and friction take care of the rest. The shelves' softly rounded corners give the unit an inviting and friendly visual expression. With its versatile design, the bookcase works just as well in small apartments as it does in large offices, where its purity and materiality craft a calming and pleasant presence.



normann

C O P E N H A G E N

Collection Overview

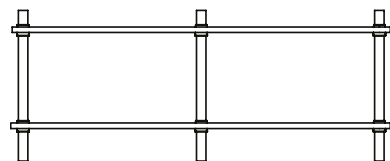

Jam Bookcase 6 poles
H: 55 x L: 138 x D: 38 cm

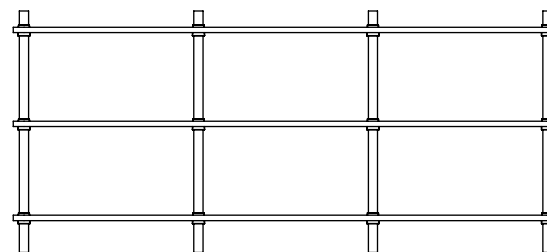

Jam Bookcase 8 poles
H: 90 x L: 203 x D: 38 cm



Product Facts

Description

The Jam bookcase has a clever design composed of just three different elements. Using the friction of a specially designed wedge, the bookcase can be assembled without the use of screws or tools. Softly rounded corners unify the visual expression and give the bookcase a friendly appearance.

Designer / Year Of Design

Rudolph Schelling Webermann / 2018

Material

Poles: Solid lacquered oak
Shelves: MDF with oak veneer
Wedges: Polypropylene

Construction

Jam bookcase consists of poles in solid oak, shelves in chipboard with oak veneer and wedges in polypropylene. Jam bookcase is delivered with grey wedges and comes flat-packed. Assembly manual included.

Maintenance

Clean with a damp cloth.
Please be aware that sharp objects can leave marks.

normann

C O P E N H A G E N

Material options

Poles and shelves

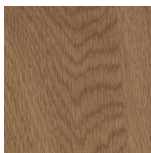

Oak

Wedges



Grey



normann
COPENHAGEN

Contact

Normann Copenhagen

Niels Hemmingsens Gade 12, 1153 Copenhagen, Denmark
normann@normann-copenhagen.com
+45 35 55 44 59

normann
C O P E N H A G E N