

RIDEFAST

SPM™ Boost Rear Mountain Hub Assembly

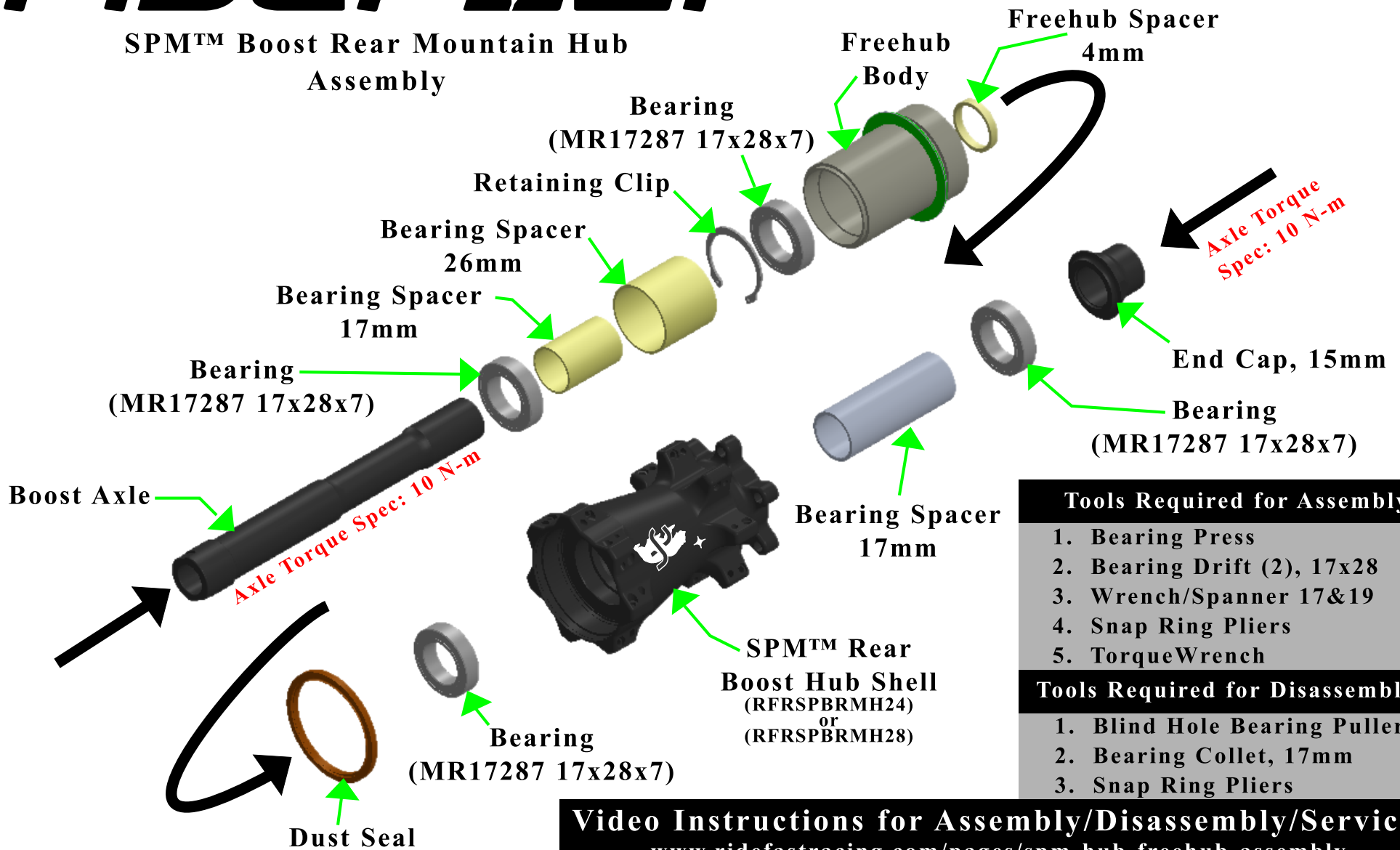

Tools Required for Assembly:

1. Bearing Press
2. Bearing Drift (2), 17x28
3. Wrench/Spanner 17&19
4. Snap Ring Pliers
5. TorqueWrench

Tools Required for Disassembly:

1. Blind Hole Bearing Puller
2. Bearing Collet, 17mm
3. Snap Ring Pliers

Video Instructions for Assembly/Disassembly/Service:
www.ridefastracing.com/pages/spm-hub-freehub-assembly