

Milk Frother

Usage Guidelines



Read the usage guidelines carefully before appliance usage.

The Appliance



Model No.: MF-001

220-240V~ 50/60 Hz, 450-550 W

Preparing the Appliance for Use

Do's and Dont's

- Check all the parts of the appliance before the first operation. Do not operate damaged products.
- Do not immerse any parts of the appliance in water.
- Place the appliance on flat surfaces only. Avoid placing the appliance on wooden surface.
- Operate the appliance through correct voltage sockets and with proper earthing facilities. Avoid using the appliance through extension cables. Avoid any wires hanging from the edge of the table while the appliance is in use.
- Unplug the appliance when not in use or while changing/cleaning the parts of the appliance. Let it cool before touching the parts. Touch only the knobs and handles. Avoid any contact with the hot surfaces.
- Do not operate the appliance on or near a hot gas/ electric burner or any heated surface.
- To avoid burning/scalding do not touch the appliance while in use.
- Keep away from children.

- The appliance is designed for home use only. It should be used indoors only.
- Before operating the appliance please ensure that it has adequate amount of milk in the jug. Excessive amount of milk can cause the froth to overflow.
- Appliance to be used only in conjunction with the basic unit provided.
- This appliance has a polarized plug (one blade is wider than the other). To reduce the risk of electric shock, this plug is intended to fit into a polarized outlet only one way. If the plug does not fit fully into the outlet, reverse the plug. If it still does not fit, contact a qualified electrician. Do not attempt to modify the plug in any way.
- Do not use appliance for other than intended use.
- Prior to every use, clean the jug and accessories to remove dust or production residues. Refer further information in the 'Clean your Appliance' section.

Appliance knowledge and usage

Know the appliance

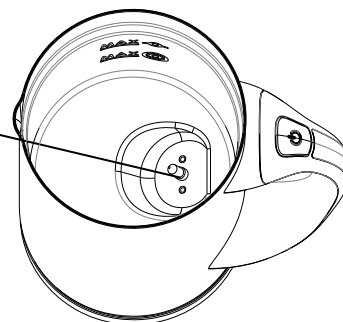
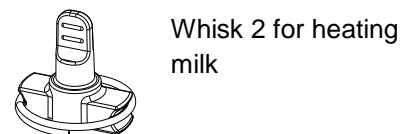
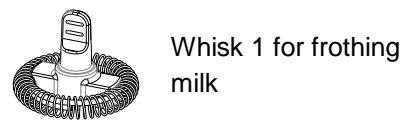
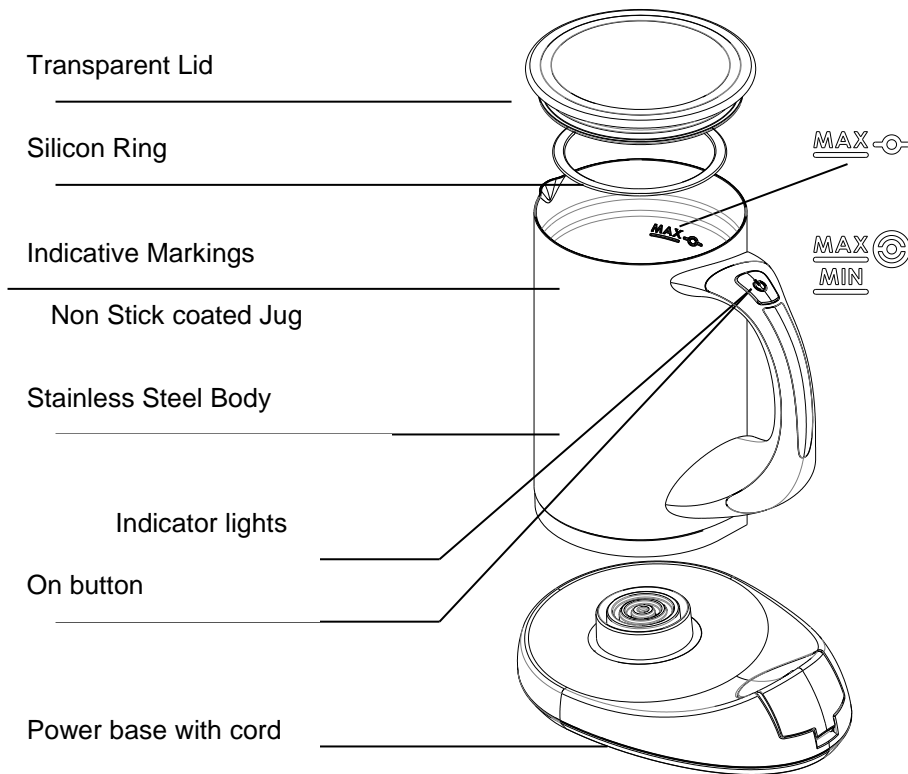

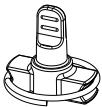
Whisks	Functions	Maximum capacity	Completion Time
	Frothing cold milk	125ml	120seconds
	Frothing & Heating	125ml	140-160seconds
	Heating (with a small amount of froth)	250ml	200-220seconds

Appliance Usage

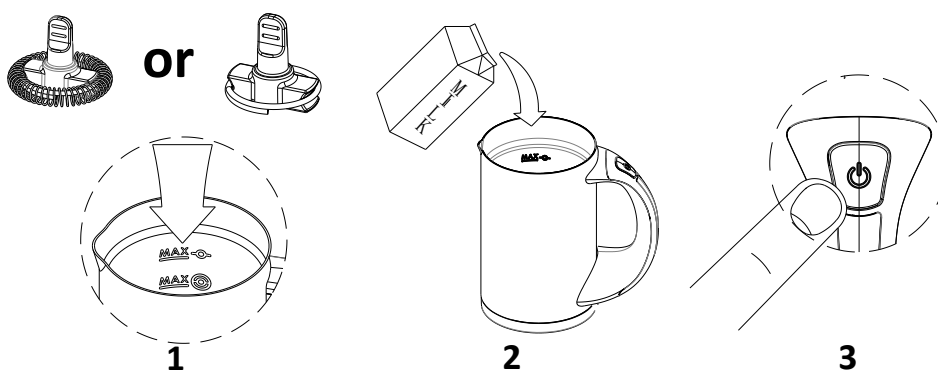

1. Choose the appropriate whisk and set it inside the jug. (Refer the above mentioned guidelines)
2. Pour the milk into the jug below the mark. (Refer the measurement chart shown above)
3. Indicative usage:
 - 1) Heating milk: Push the start button to start heating the milk. Once the indicator light switches off automatically the desired process is complete.
 - 2) Frothing cold milk: Pour the cold milk into the jug and push the start button to start frothing the milk. Once the indicator light switches off automatically the desired process is complete.

Hints for better results from the appliance

- Use whole fat milk (fat content > 3%) for best results.
- After heating/ frothing milk consume immediately. To avoid getting burnt/ hurt, always check the temperature of hot milk before consumption.
- After heating/ frothing milk ensure a gap of 2 minutes before starting the next process. Here are some handy hints to help you get the best out of your Milk Frother.
- Clean the appliance immediately after use.
- For heating/ frothing always use adequate amount of milk specified in the manual.

Clean your Appliance

- Remove the jug from the power base before cleaning.
- Separate the lid and the silicon ring from the jug. Wash them directly under running water.
- Clean the Jug immediately after each use. Flush and clean the inner walls with using warm soapy water and a non-abrasive cloth. Then wipe dry with a soft cloth.
- Clean the body of the Milk Frother with a soft cloth. To avoid scratches on the stainless steel body do not use sharp cleaning agents, hard nylon brush or metal brush stainless steel surface.
- Remove the whisks from the jug and wash them with warm water. Dry and store in a safe place. Do not use the dishwasher.

Common FAQs

Q. The jug is not working as it is not showing the indicator light. Please help.

A. There could be a few simple reasons for the same. Let us recheck a few pointers:

1. The plug is not inserted properly. Remove the plug and reinsert. Restart appliance.
2. The Jug and powerbase have lost contact. Remove jug and replace again. Restart appliance.
3. No power in the jack. Recheck the electric circuit and restart power. Restart appliance.
4. Damaged/ broken components. Get the parts repaired/ exchanged through the service provider.

Q. The jug is not starting frothing/ heating. What should I do?

1. The temperature of the jug could be higher than required. Rinse the jug with cold water to reduce the temperature. Place the jug again and restart the appliance.
2. The jug has been damaged due to water immersion. Please contact your service provider for repairing/changing the same.

Q. The motor is not starting. What am I doing wrong?

1. The jug was not cleaned immediately after previous use. Milk deposits could have blocked the mechanism. Try to move the shaft sleeve softly by hand to loosen it and clean it thoroughly. Restart appliance.
2. The motor has been damaged. Please contact your service provider for repairing/changing the same.

Q. The milk in the jug got charred instead of being frothed. Why did this happen?

1. The dosage of milk is not adequate. It is either too little or is too much. Refer the usage manual for the correct quantity. Restart appliance.

Terms and Conditions

- All disputes are subject to Ahmedabad jurisdiction.
- The product doesn't have any warranty but in case of damaged products the company may offer replacement for product purchase date is within two weeks. Refer to the company's return policies and get in touch with marketing@thekettlery.com for any product related questions or concerns.