

MAGNETIC WIRELESS CAR CHARGER

- 1** Snap in the mount piece to the backside of the charger.

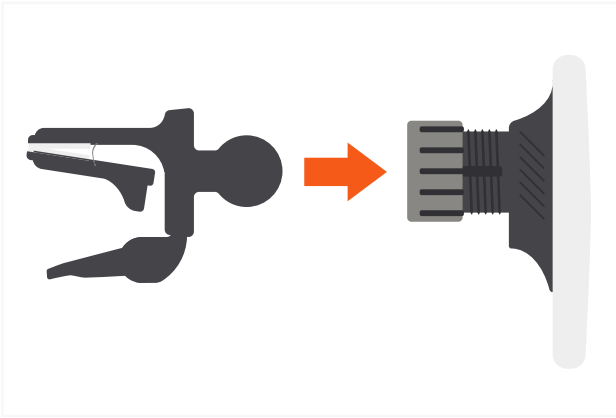

- 2** Twist the knob to tighten and secure the two pieces together.

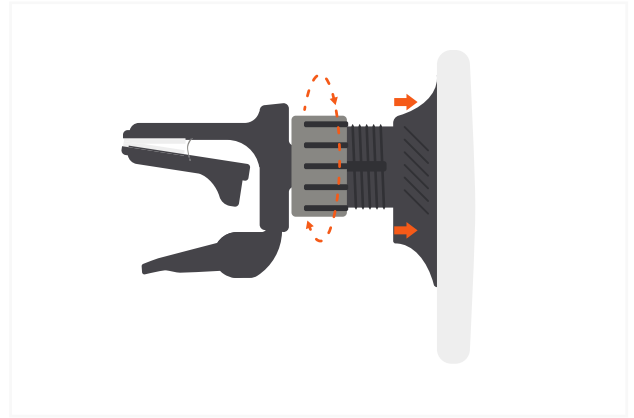

- 3** Push the bottom lever to open the clamp and attach onto car's air vents.
Fits most standard car air vents.
Does not work with circular or vertical air vents.

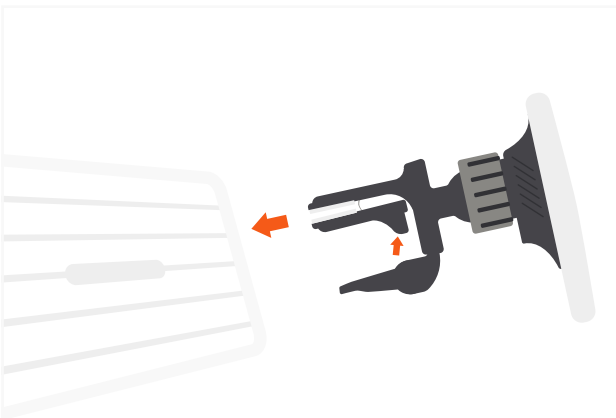

- 4** Use the included USB-C cable to connect to your car's charging port.
Requires 18W or higher car auxiliary power adapter (sold separately).

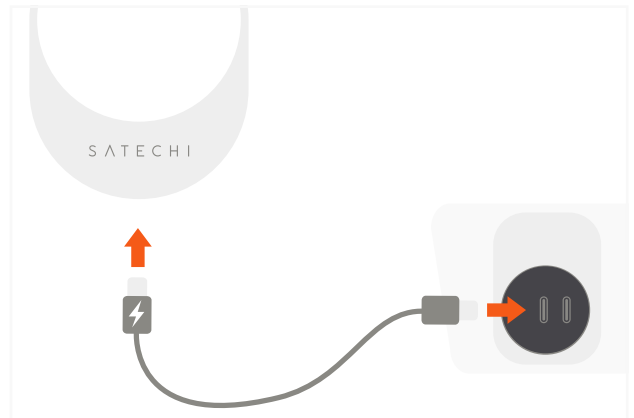

- 5** Place your iPhone with MagSafe onto the magnetic pad to begin charging.
White LED light will blink when charging.

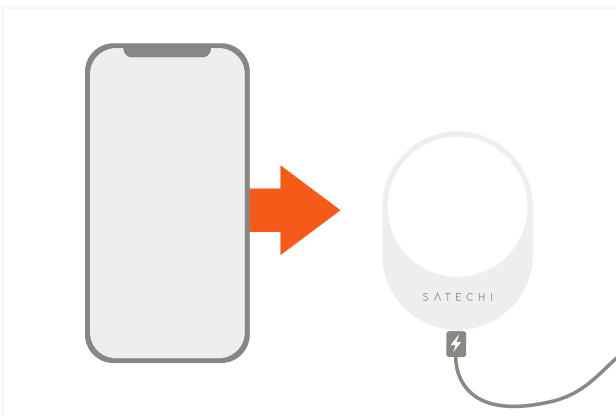

- !** **Important:** All iPhone 11 models and iPhone 12/13 cases without MagSafe require our Magnetic Sticker (sold separately).

