

AVENTON FENDER INSTALLATION INSTRUCTIONS

Our fenders are a perfect fit for your Aventon ebike.

Each Aventon ebike model has a matching fender designed specifically for it. Use only the fenders designed for your model. Additionally, the fenders for some models are offered in S, M, and L sizes to match our S, M, and L ebikes. If the fenders for your bike have size options, use the size fender that matches your bike.

Before riding, check to ensure that the wheels rotate smoothly and the tires do not touch the fender or fender mounting hardware.

TOOLS NEEDED:

- Metric hex keys
- Phillips screwdriver
- Adjustable (crescent) wrench or metric box/combination wrench

Pace 500 / 500 Limited Edition / 500 Step-through / 350 / 350 Step-through models:

1. Check to ensure you have the correct fender and correct size that matches your Aventon ebike.
2. Unpack the fenders and mounting hardware.
3. Apply a dab of thread adhesive (i.e. blue loctite) to each fixing bolt as well as a light grease, like white lithium grease.
4. Each fender is specific to the front or rear of the bike. The longer length fender is for the rear of the bike, and the shorter of the two is for the front.
5. The front fender attaches to the bike's fork in two spots - first, at the fork crown, and second, at the mounting point at the middle of the fork blades on either side. Use the long mounting bolt, washer, and nut to attach the fender to the fork crown. Remove the fixing bolts from the mounting points at the middle of the fork blades, attach the fender struts, then re-attach the fixing bolts.
6. Once installed, fine adjustments can be made to the front fender by loosening the strut attachment with a Phillips screwdriver, sliding the fender left/right along the struts, then re-tightening.
7. Remove the rear wheel from the bike so you can access the mounting points.
8. The rear fender attaches at three spots - first, at the mounting plate near the kickstand, second, at the mounting points near the rear dropout, and third, at the seatstay bridge. As before, mount the fender at each mounting point, then make fine adjustments if needed using the Phillips screw.
9. After installation, check for proper installation and operation.

Reference photo of small parts included with the Pace fender set:

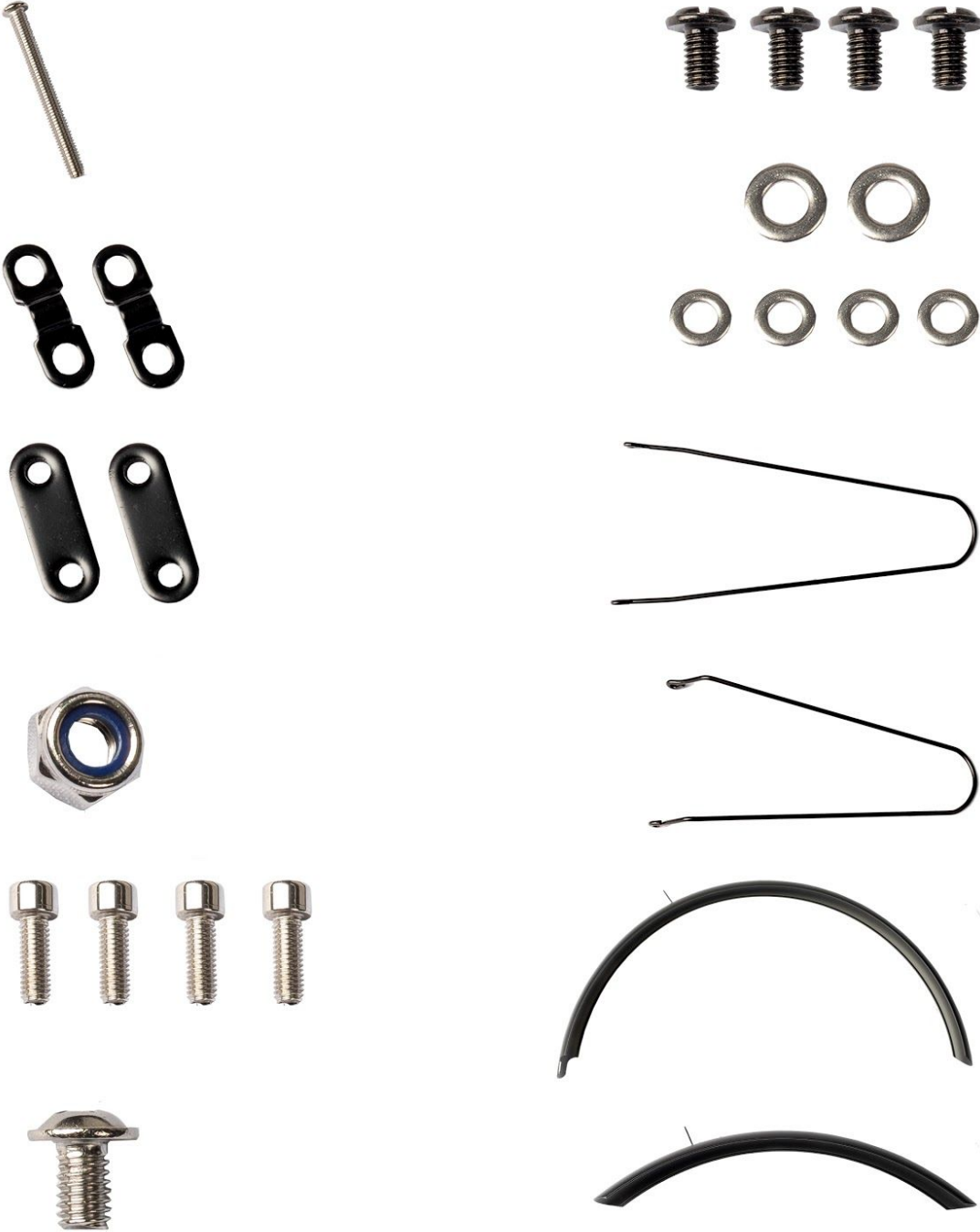

AVENTON

Sinch model

1. The Sinch fenders only come in one size.
2. Unpack the fenders and mounting hardware.
3. Apply a dab of thread adhesive (i.e. blue loctite) to each fixing bolt as well as a light grease, like white lithium grease.
4. Each fender is specific to the front or rear of the bike. The shorter of the two is for the front of the bike.
5. Start by securing the front fender to the suspension fork using the bolt and washer. The bolt threads into the back of the arch on the suspension fork.
6. Next attach the L-brackets to the two mounting points on the fork's lower casting, shown here.
7. Then bolt the fender strut to the newly-installed L-bracket on either side.
8. Now that the front fender is attached, the fit of the fender can be adjusted in several spots if needed. First, the length of each fender strut can be changed. Turn this knurled nut to loosen, slide the strut fore or aft, then re-tighten the knurled nut to lock the strut in place. Second, the height of the fender can be changed by sliding the fender up or down on the slot behind the fork arch. Finally, the fender can be moved left/right on the mounting struts with two Phillips screws. Loosen the Phillips screws, slide the fender left/right as needed, then re-tighten.
9. Let's move on to the rear fender. It attaches to the bike in 3 places, first, to the mounting points at the rear dropout, second, at the plate behind the bottom bracket, and third, at the seatstay bridge.
10. Remove the rear wheel from the bike so you can access the mounting points.
11. Attach the rear fender to the mounting plate behind the bottom bracket using the Phillips screw.
12. Attach the rear fender to the threaded hole in the seatstay bridge using the hex bolt.
13. Attach the rear fender struts to each side of the dropout using a hex bolt on each side.
14. After installation, check for proper installation and operation. Cycle the suspension fork to ensure that the fender doesn't rub at any point during the travel of the suspension fork.

Level model

1. Note: the Level model includes fenders with the original bicycle purchase. Purchase of additional fenders is not needed, unless you have damaged or lost the original fenders.
2. Check to ensure you have the correct fender and correct size that matches your Aventon ebike.
3. Unpack the fenders and mounting hardware.
4. Apply a dab of thread adhesive (i.e. blue loctite) to each fixing bolt as well as a light grease, like white lithium grease.
5. Each fender is specific to the front or rear of the bike. The longer length fender is for the rear of the bike, and the shorter of the two is for the front.
6. Start by securing the front fender to the suspension fork using the bolt and washer. The bolt threads into the back of the arch on the suspension fork.
7. Next attach the L-brackets to the two mounting points on the fork's lower casting, shown here.
8. Then bolt the fender strut to the newly-installed L-bracket on either side.
9. Now that the front fender is attached, the fit of the fender can be adjusted in several spots if needed. First, the length of each fender strut can be changed. Turn this knurled nut to loosen, slide the strut fore or aft, then re-tighten the knurled nut to lock the strut in place. Second, the height of the fender can be changed by sliding the fender up or down on the slot behind the fork arch. Finally, the fender can be moved left/right on the mounting struts with two Phillips screws. Loosen the Phillips screws, slide the fender left/right as needed, then re-tighten.
10. Let's move on to the rear fender. It attaches to the bike in 3 places, first, to the mounting points at the rear dropout, second, at the plate behind the bottom bracket, and third, at the seatstay bridge.
11. Remove the rear wheel from the bike so you can access the mounting points.
12. Attach the rear fender to the mounting plate behind the bottom bracket using the Phillips screw.
13. Attach the rear fender to the threaded hole in the seatstay bridge using the hex bolt.
14. Attach the rear fender struts to each side of the dropout using a hex bolt on each side.
15. After installation, check for proper installation and operation. Cycle the suspension fork to ensure that the fender doesn't rub at any point during the travel of the suspension fork.