



STEALTHPIVOT
By PortaPivot

SLIDEWAYS 5730
CEILING MOUNT INSTALLATION
+ FIXED PARTITION



SLIDEWAYS DOOR SETBOX

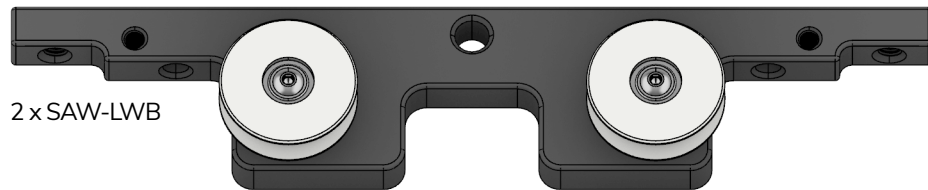
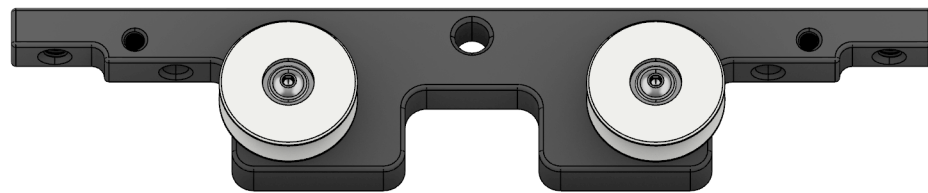

2 x SAW-LWB

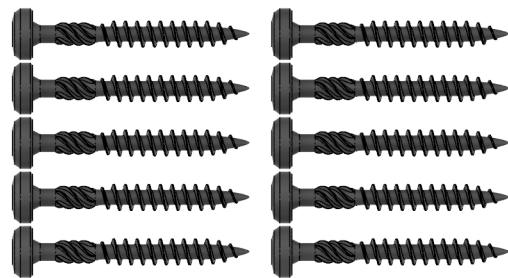

10 x Maxxfast CK 6x50 - black



1 x Maxxfast CST 4,5x50 - black

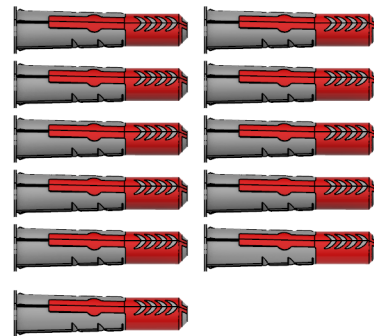

11 x Fisher Duopower 8x40

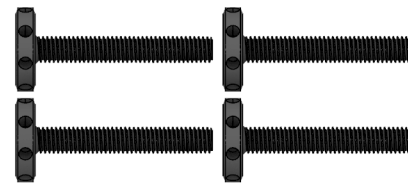

4 x SAW-SCR41

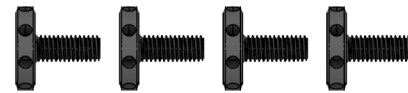

4 x SAW-SCR15



2 x DIN 427 - setscrew with shaft



4 x DIN 916 - M5x10 setscrew



2 x DIN 916 - M5x6 setscrew

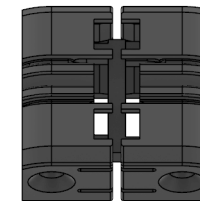

1 x SAW-SCLH-SET

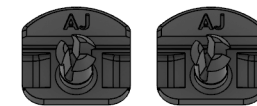

2 x SAW-AJ

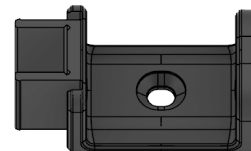

1 x SAW-VLGL30

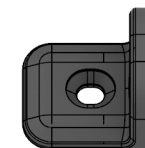

1 x SAW-VLGLENDA



2 x VILT Ø18 mm

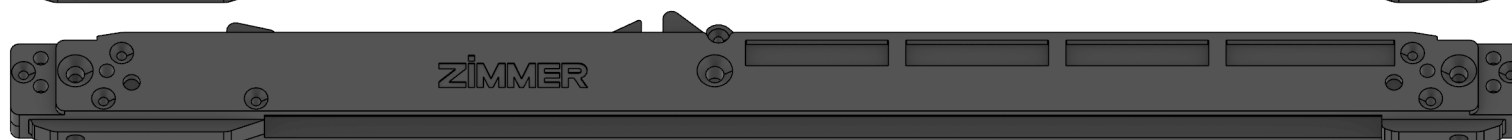
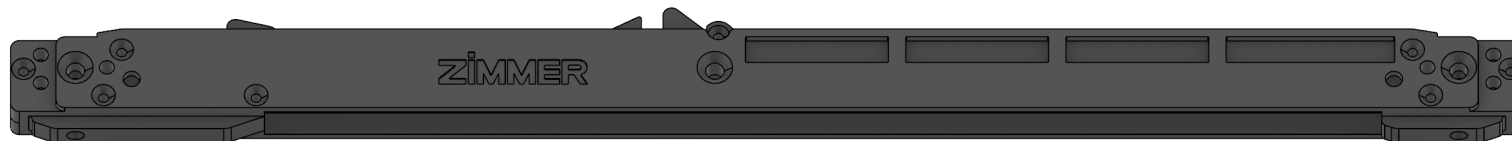

2 x E100-08-151 smooth comfort

SLIDEWAYS RAIL SETBOX

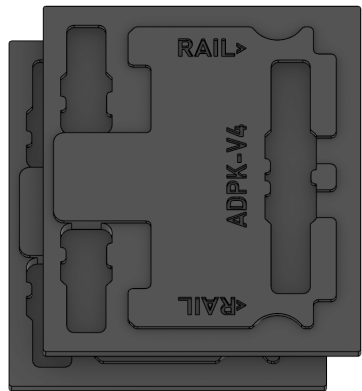

2 x SAW-ADPK

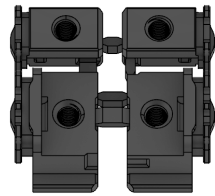

1 x SAW-ADPCONN-SET

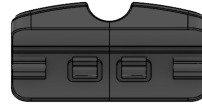

1 x SAW-BOOR



4 x DIN 916 - M5x10 setscrew

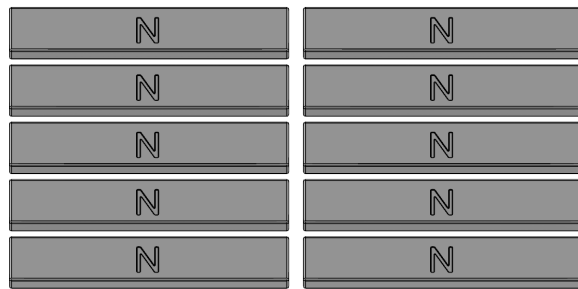

10 x MAGNET

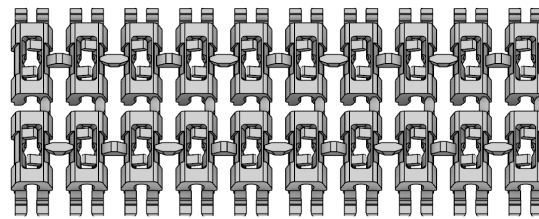

1 x MAGKL-SET

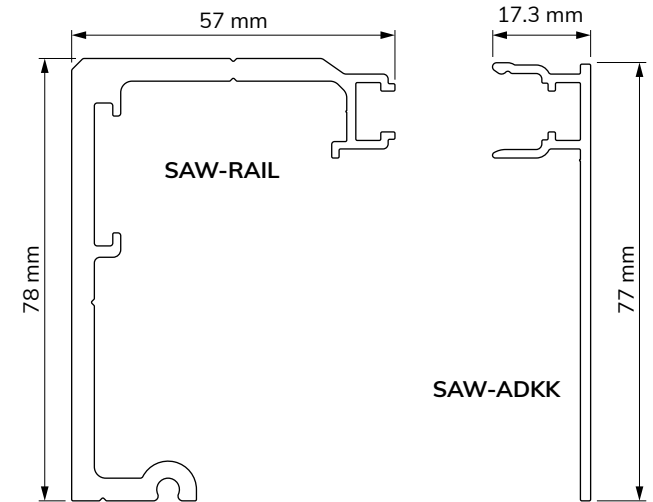

BLACK

SILVER

BRONZE

GOLD

BLACK

SILVER

BRONZE

GOLD

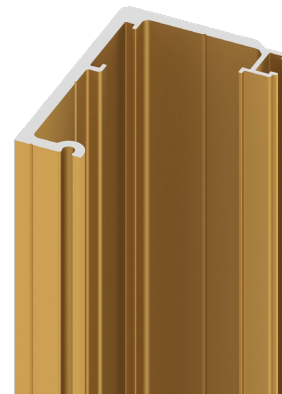
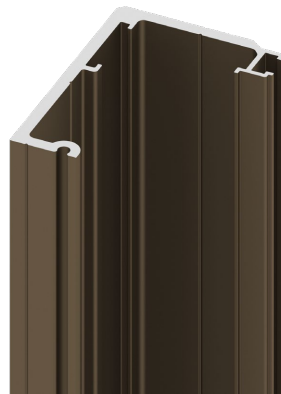
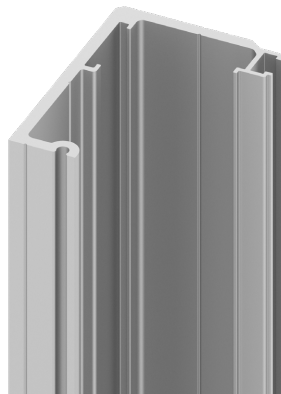

CEILING MOUNT POSSIBILITIES

+ FIXED PARTITION 3530

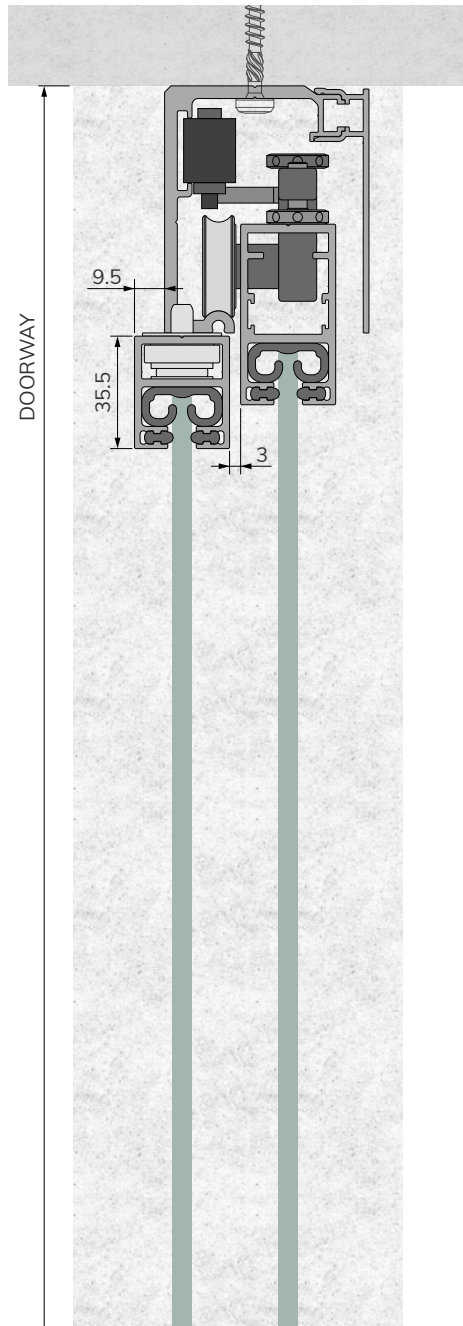

+ FIXED PARTITION 5730

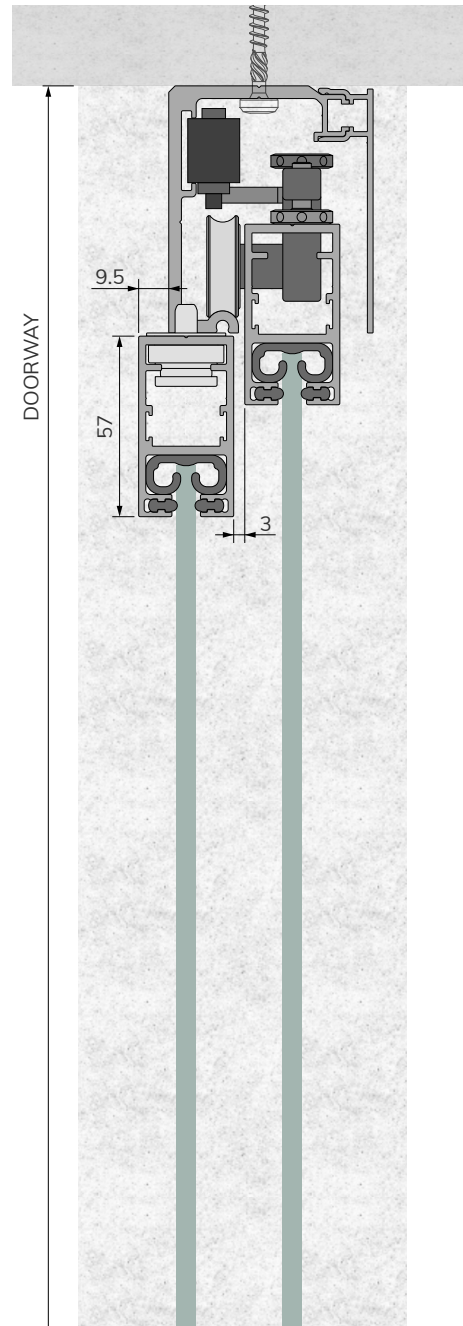

RECESSED

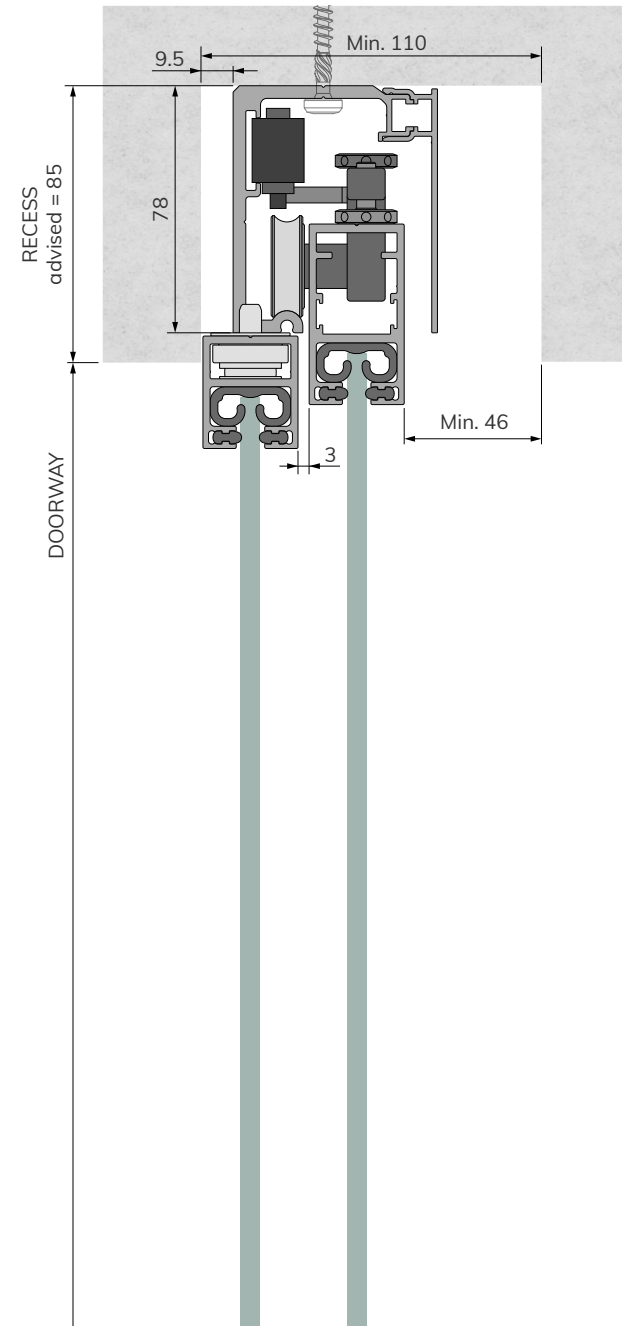

SLIDEWAYS DIMENSIONS

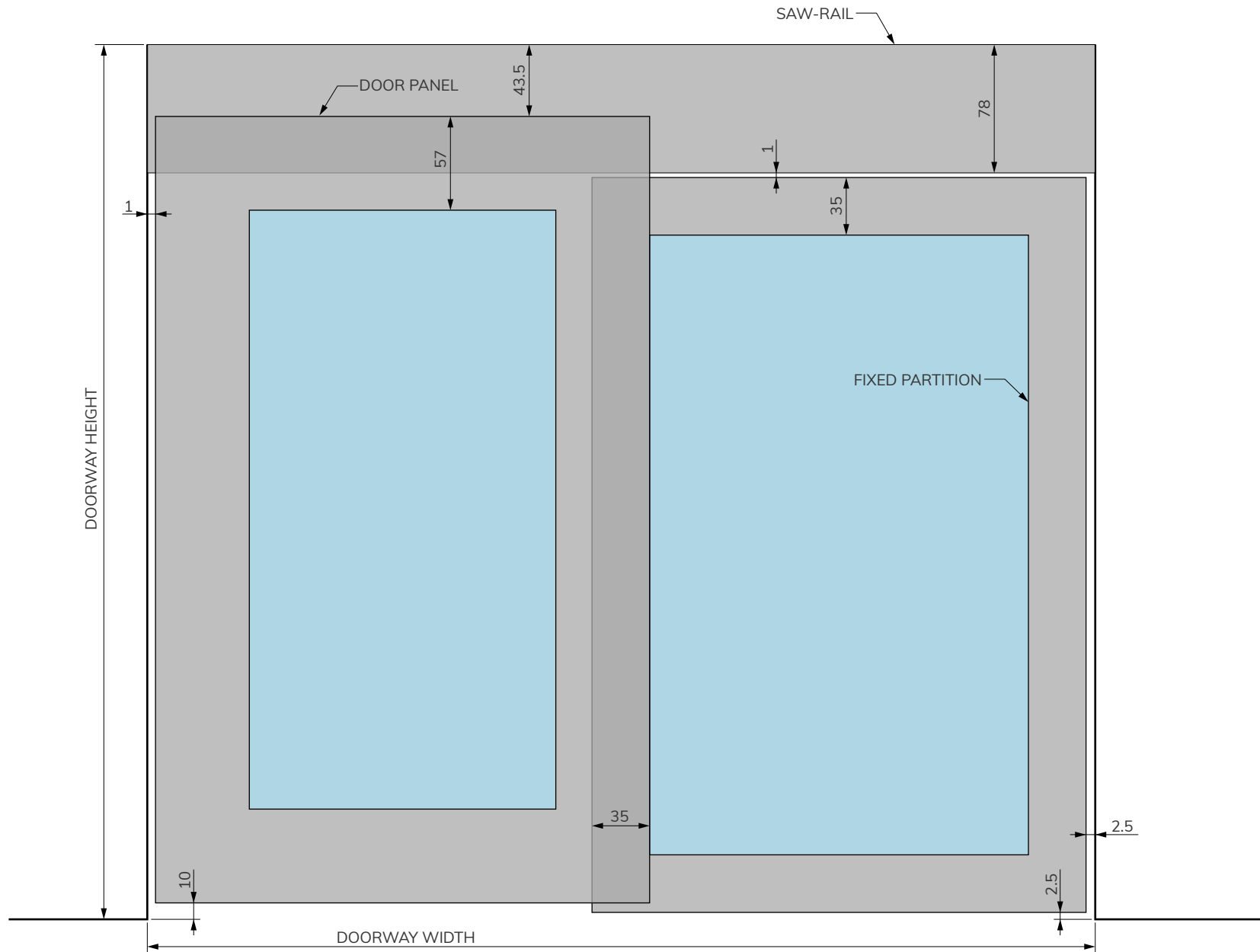
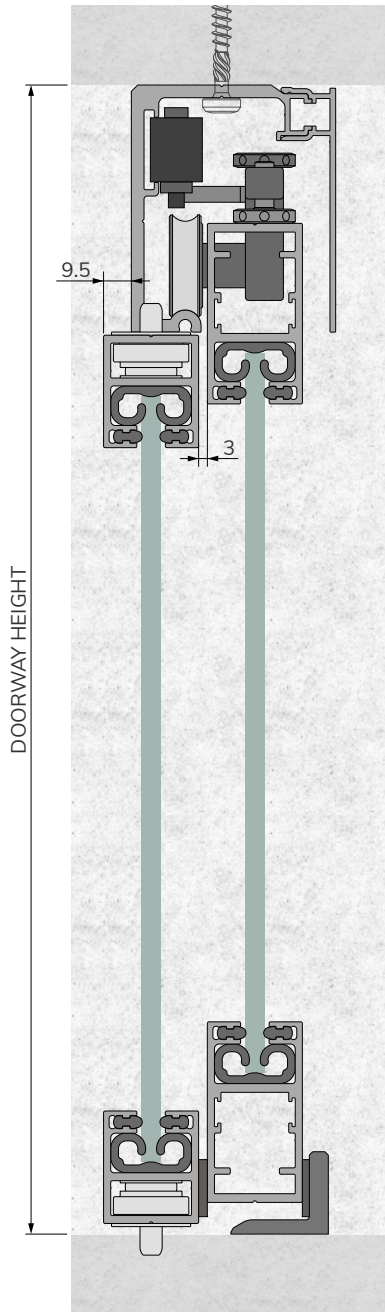

PREPARE 3D PARTS

Disconnect all 3D printed parts and assemble them as shown.

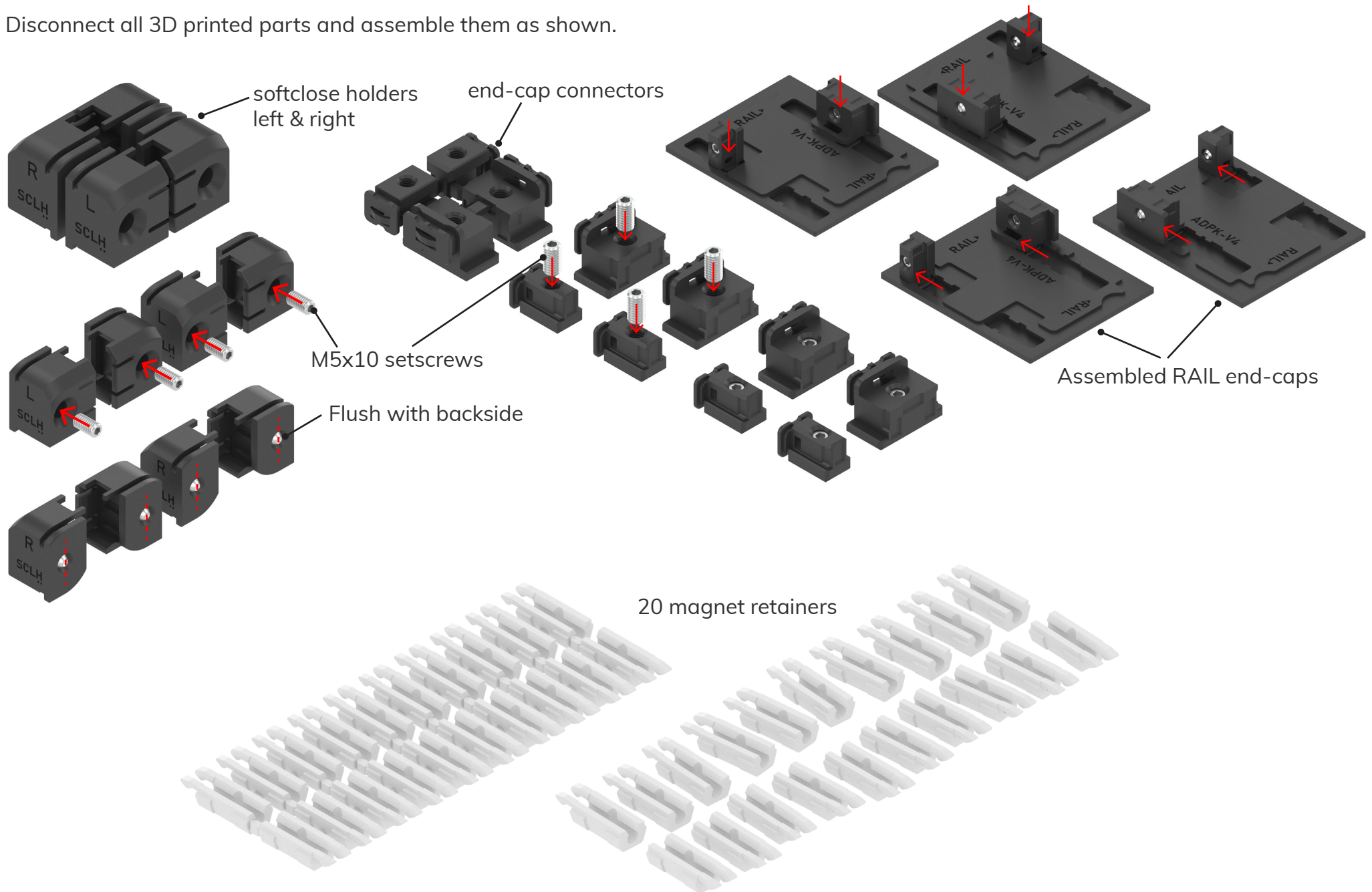

INSERT RAIL MAGNETS

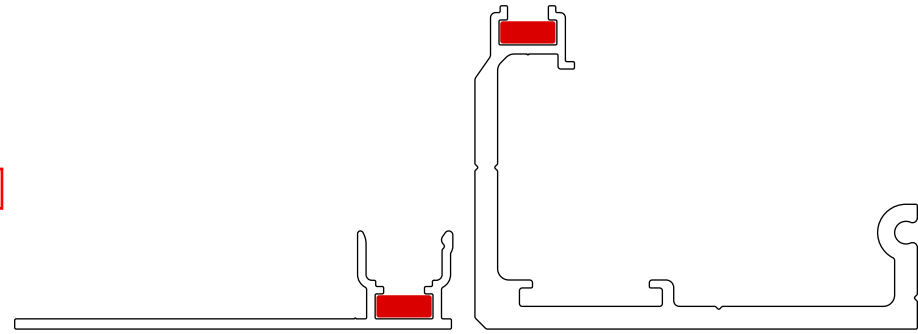
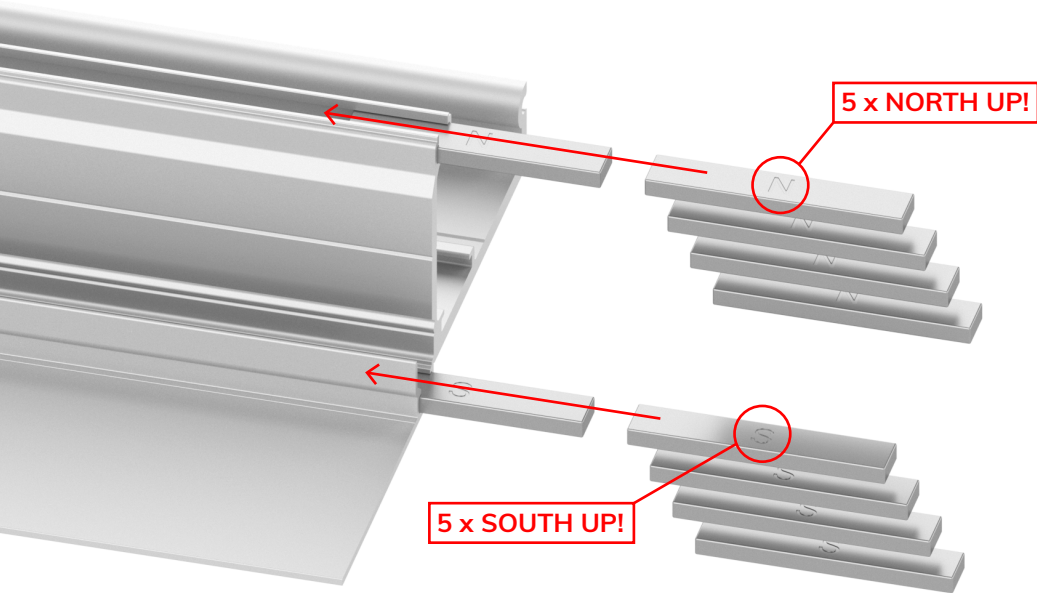

Position the SAW-RAIL and SAW-ADKK profiles next to each other and slide 5 magnets into each profile.

Place the magnets as shown below, and align them in both profiles.

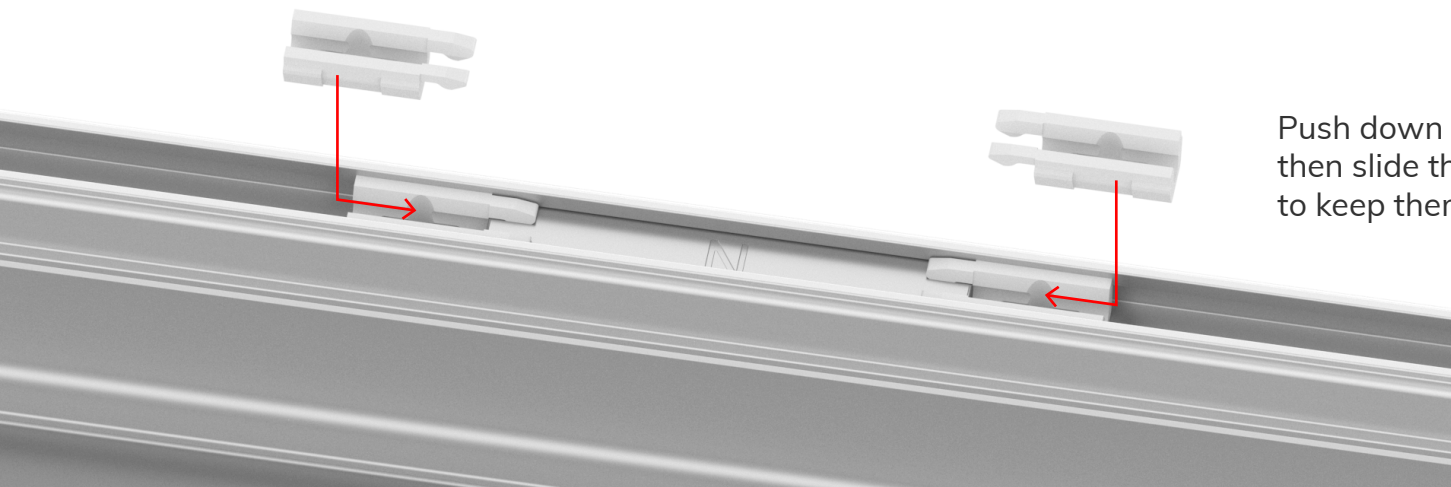
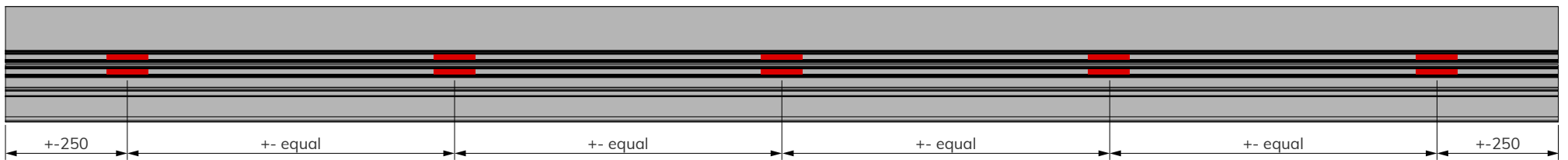

Push down the magnet retainers in the profile, then slide them towards and over the magnets to keep them in place.

POSITION RAIL

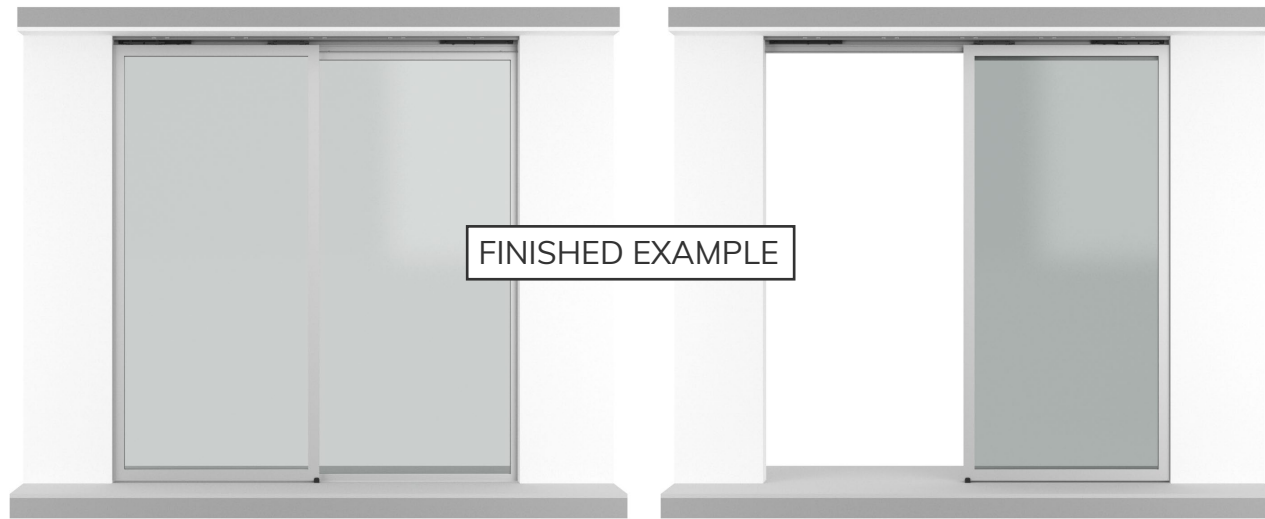

Position the SAW-RAIL exactly level in the desired position in the doorway.

This depends on the doorway measurements, desired wall overlap (open & closed position), sliding direction, door handle type, etc... Double check your doorway measurement data!

For more information, please refer to the "HOW TO MEASURE & ORDER ONLINE" manual.

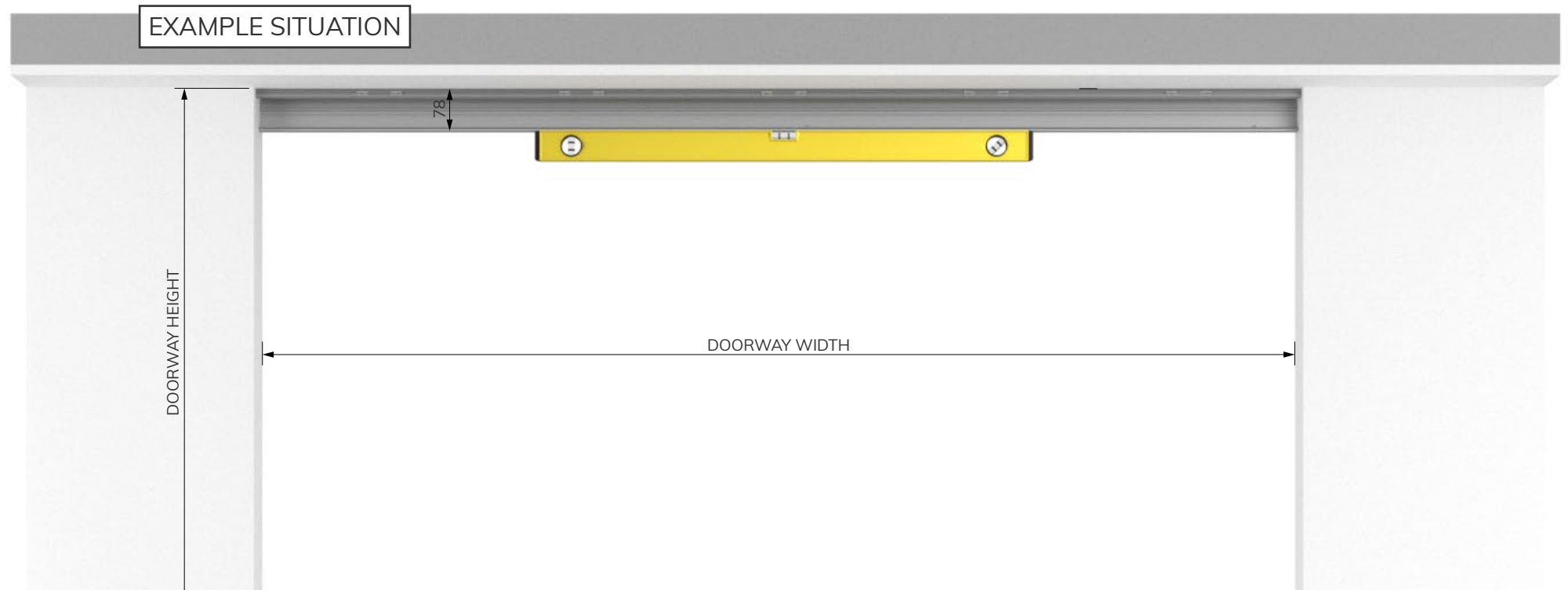

MARK & DRILL RAIL HOLES

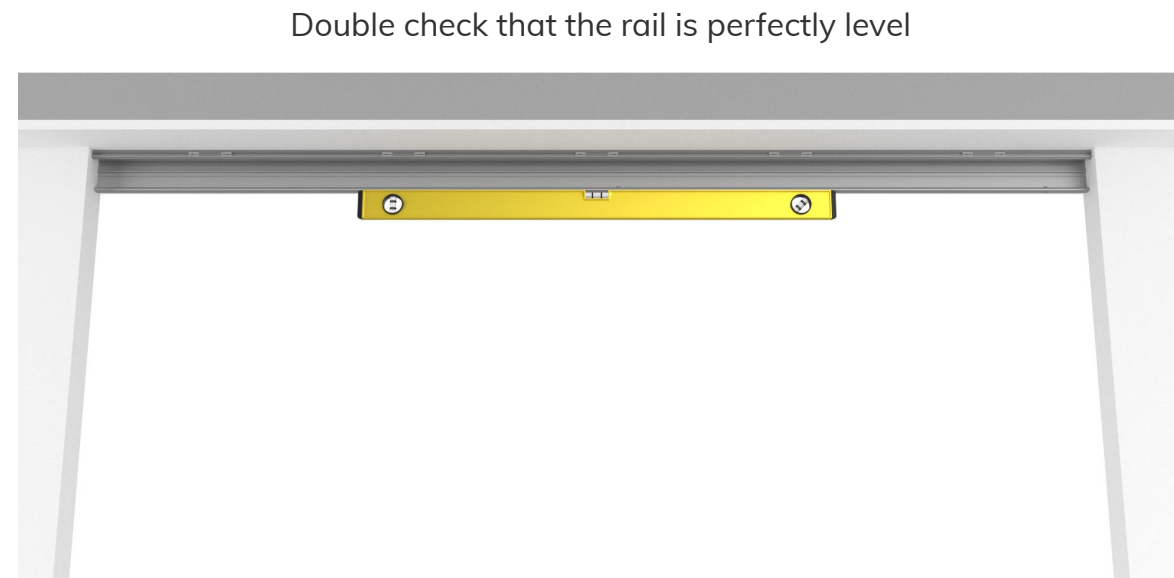
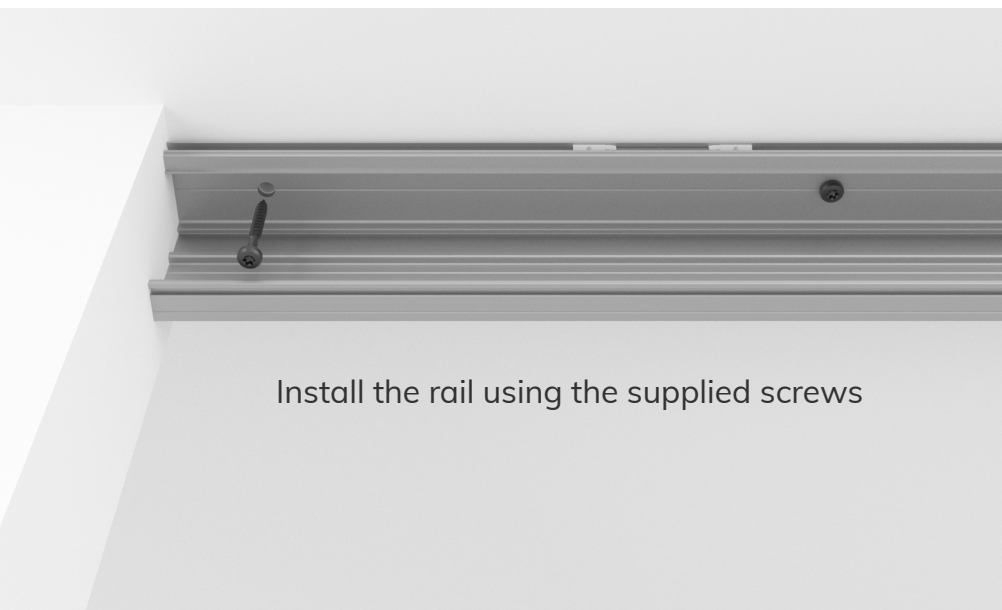
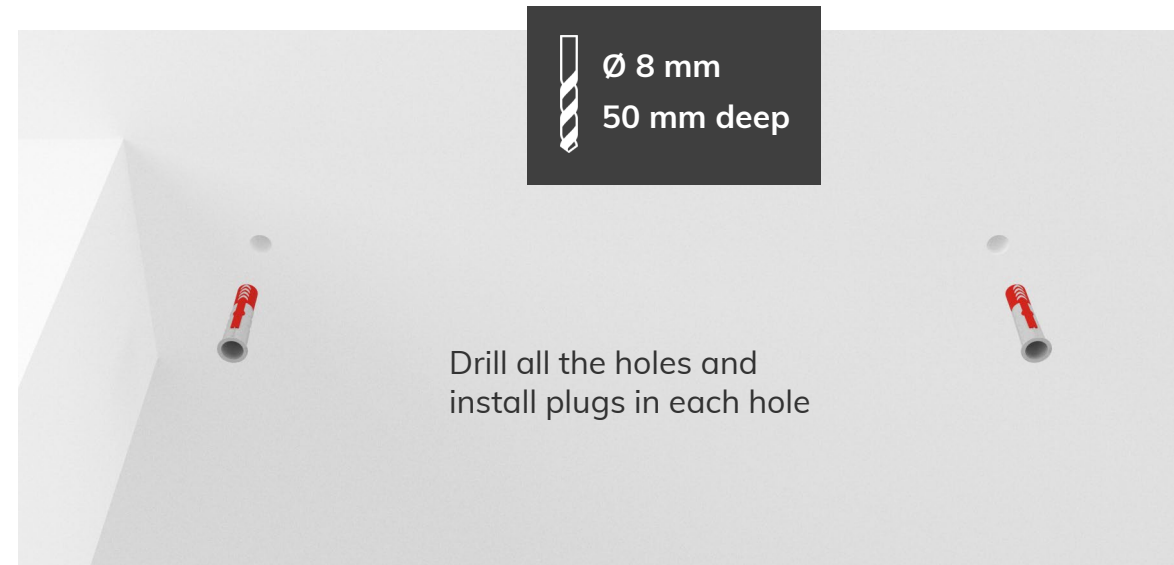
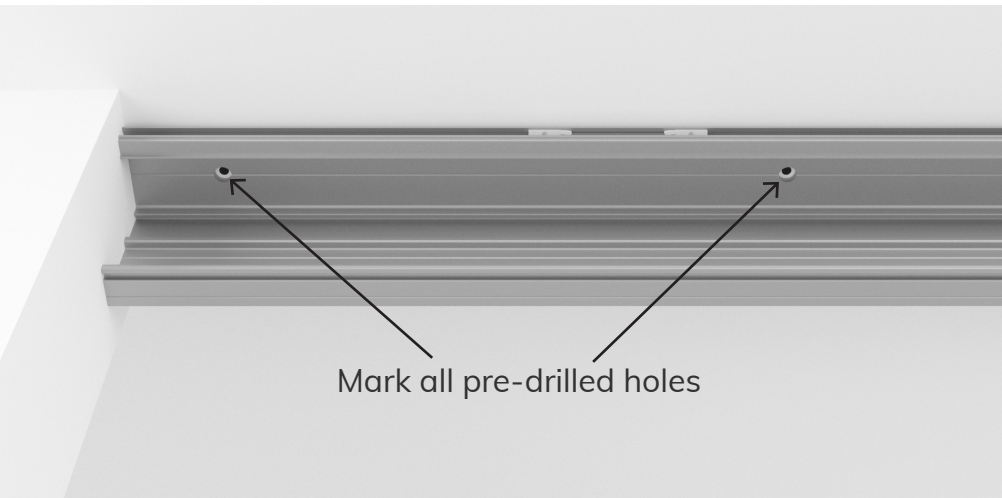

OPTIONAL FIXED PANEL UNDER RAIL

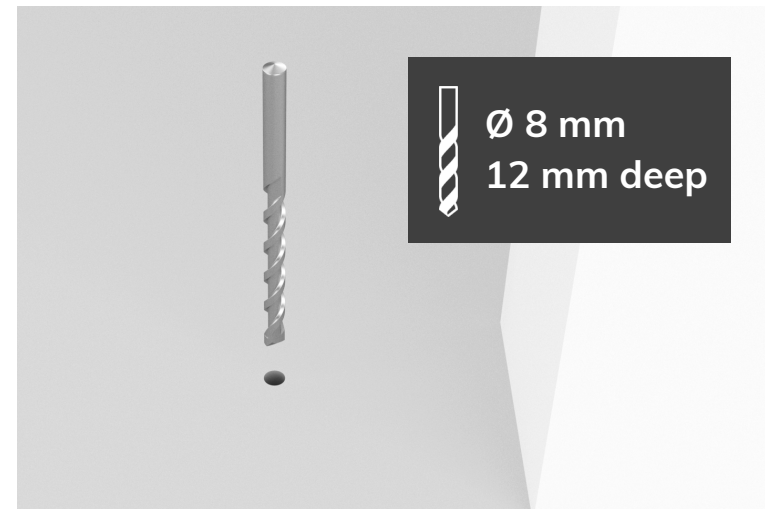
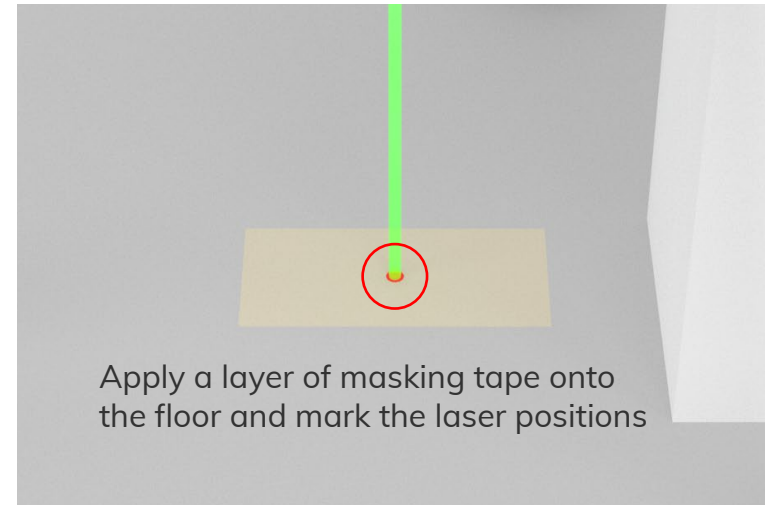
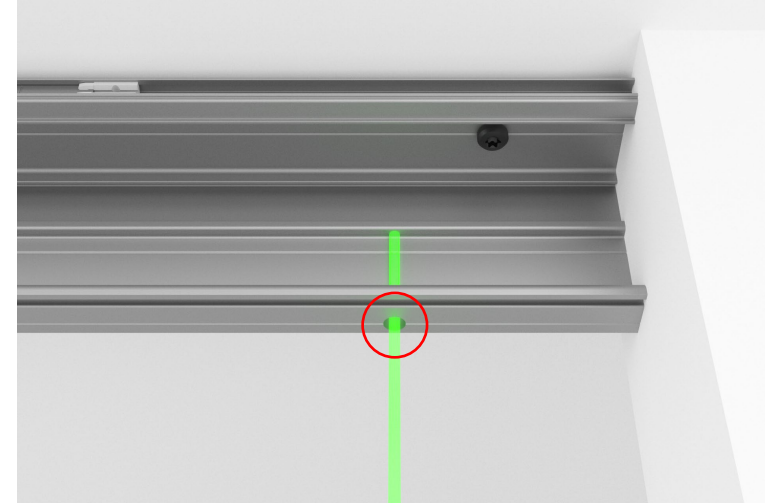
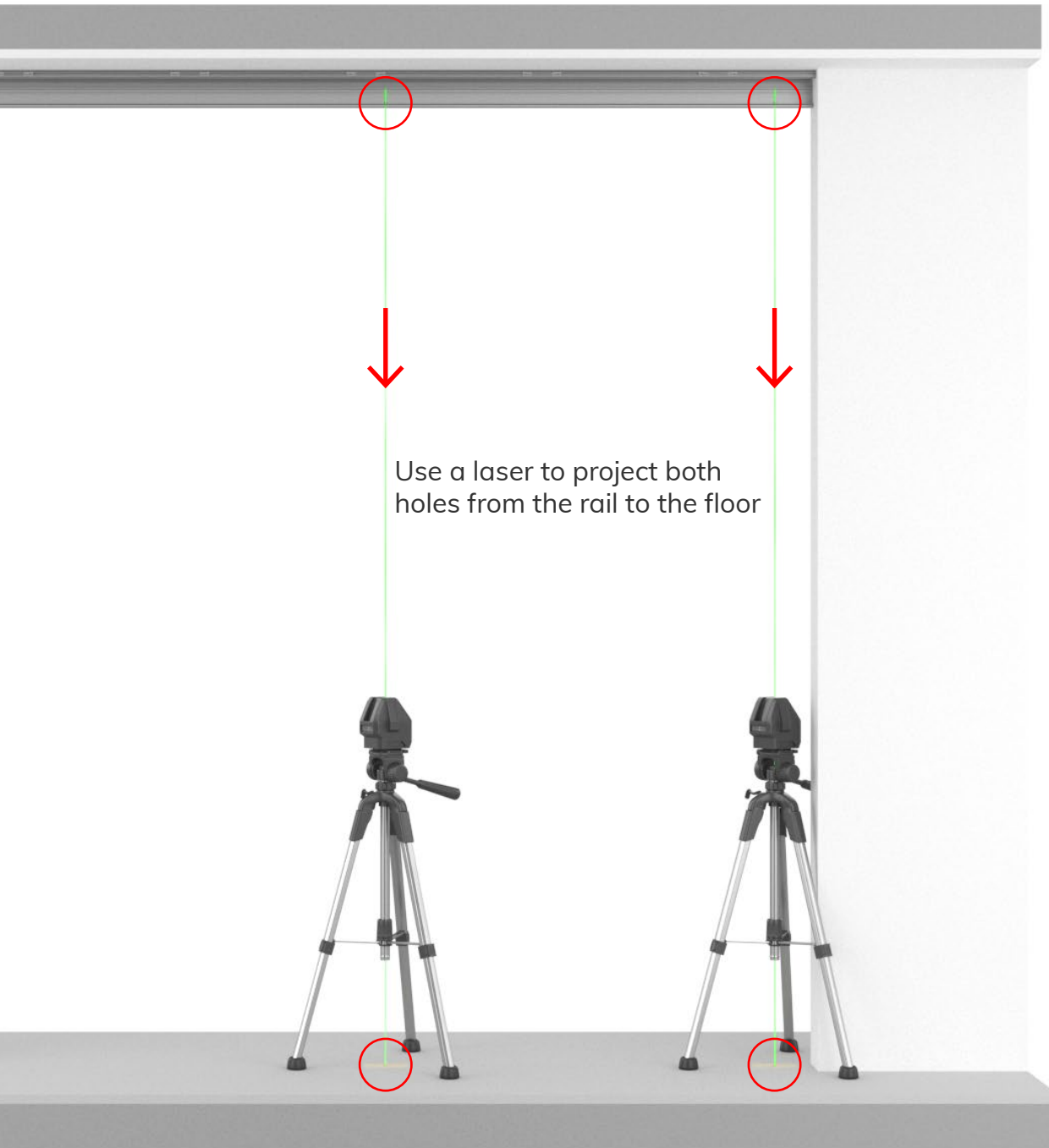

INSTALL FIXED PANEL

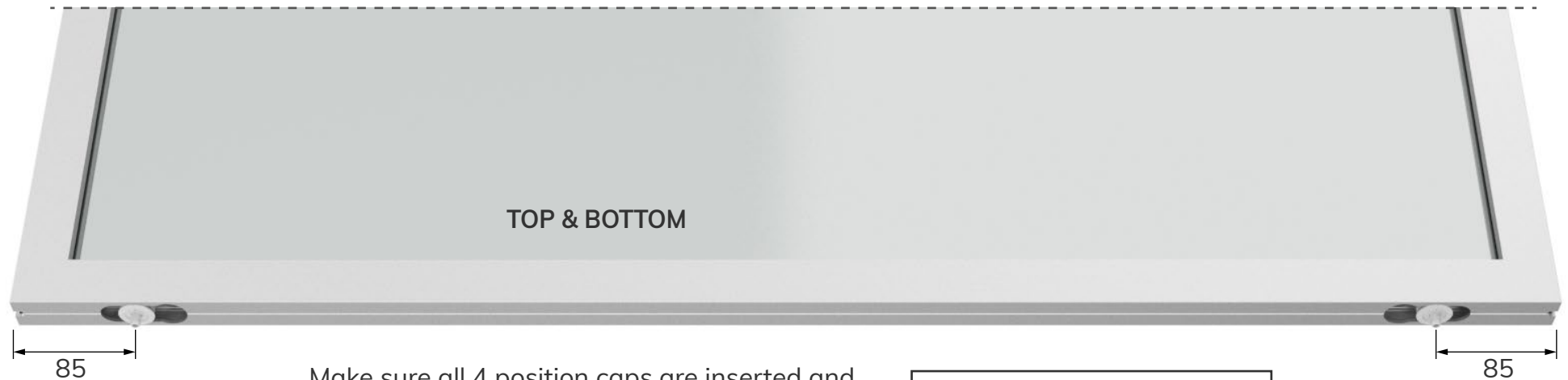

Make sure all 4 position caps are inserted and placed at 85 mm from the panels edge. You can lock them in place by rotating +/-90 degrees.

See fixed partition assembly manual for more info

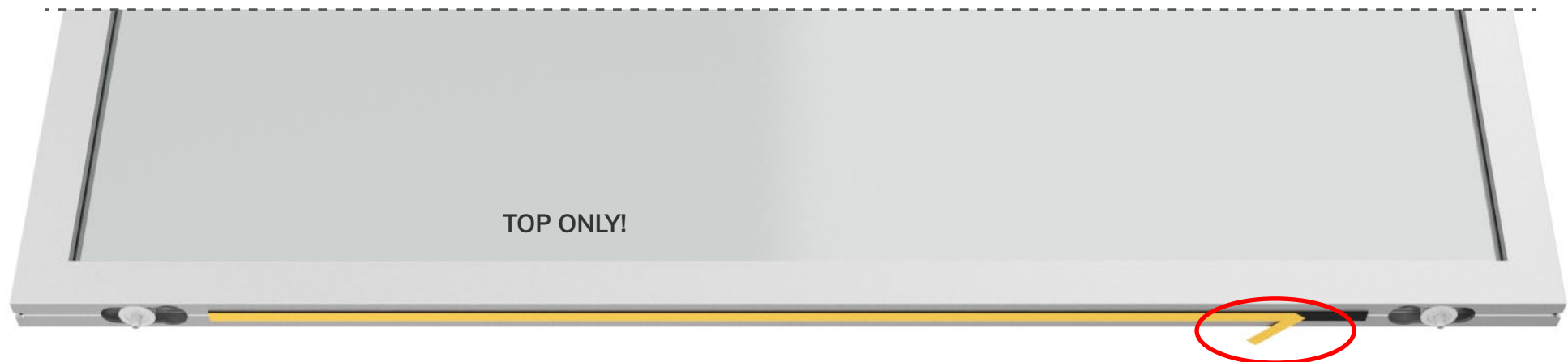

Apply a layer of double sided tape to the **TOP** side of the panel.

The tape should be at least **1.25 mm thick!**

On one side, pull a little bit of the backing strip so it's easier to remove it later on.



Position the fixed panel on the floor, aligning the positioning caps with the drilled holes in the floor.

Rotate the fixed panel more upright, and make sure the bottom positioning caps are inserted in the floor holes.

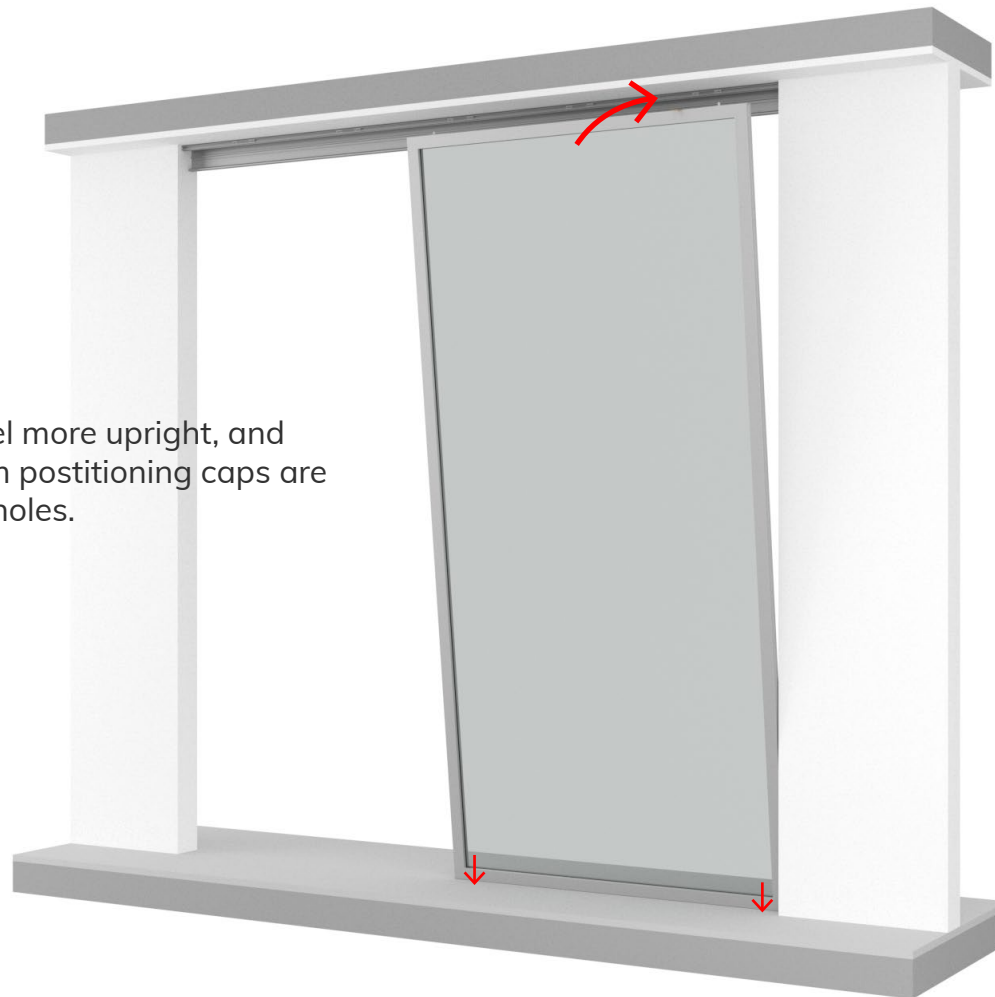

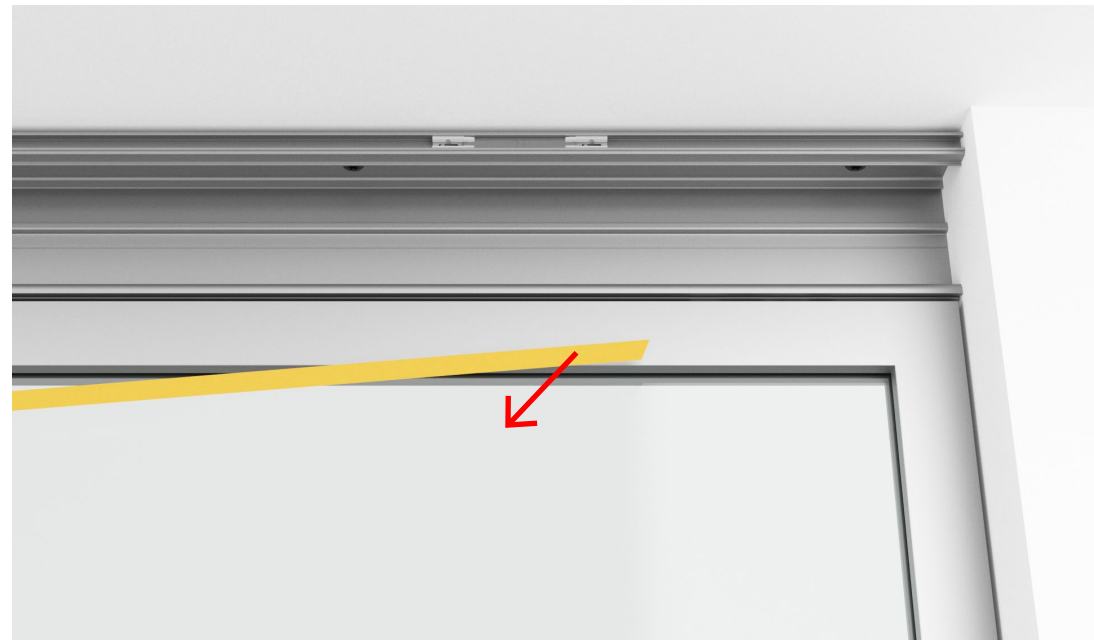
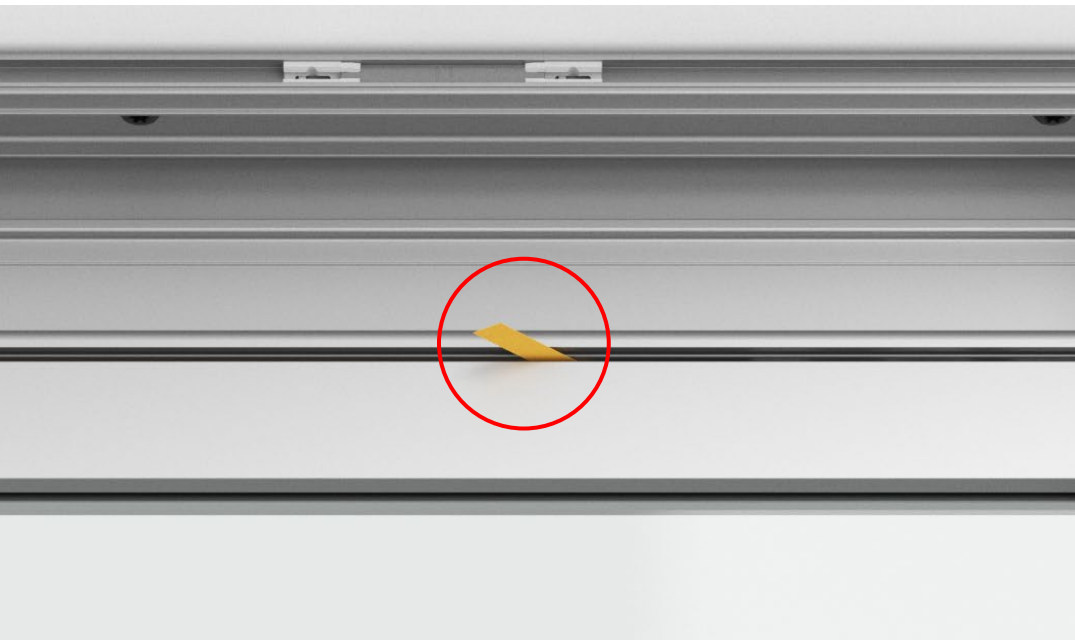

Pull the backing strip of the double sided tape, and remove it completely.

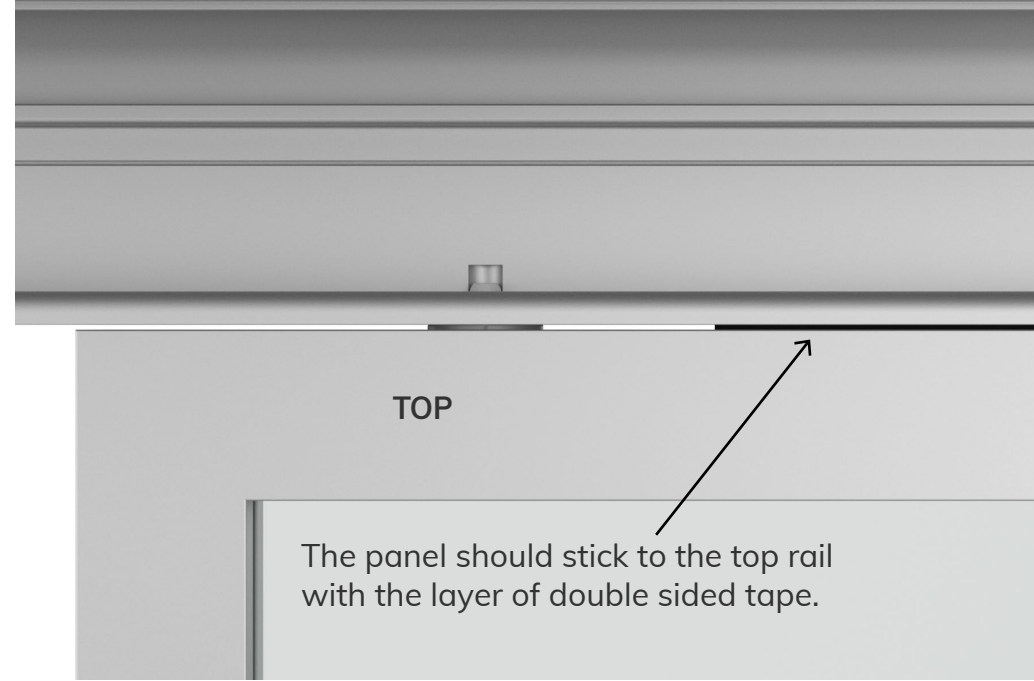
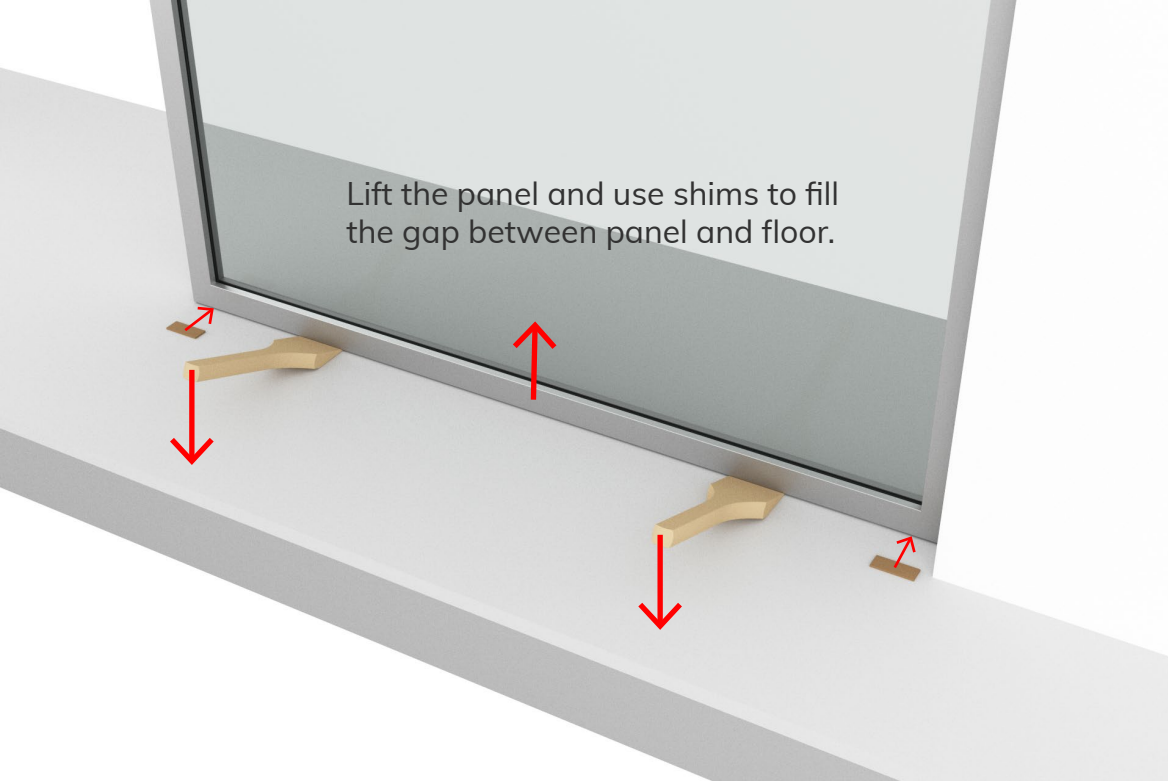

SHIMS NOT SUPPLIED, CAN BE FOUND IN ANY HARDWARE STORE

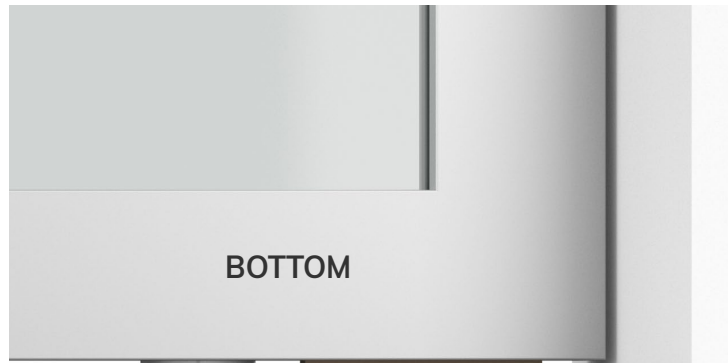
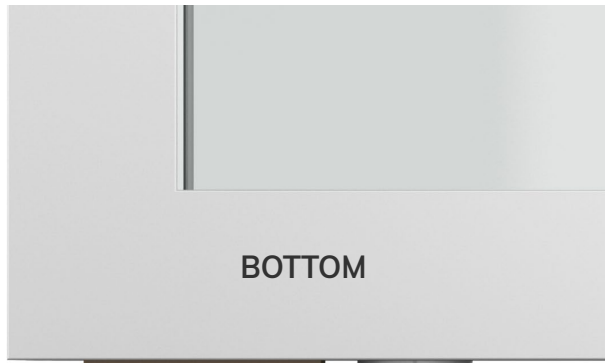

Use shims to fill the gap between panel and floor.

Use shims to fill the gap between panel and floor.

FINISH JOINTS

① Finish the joints with a paintable sealing product.



② Moisturize sealing product and framework with water and soap.



③ Finish the sealing joint under a straight angle with a rectangle tool.

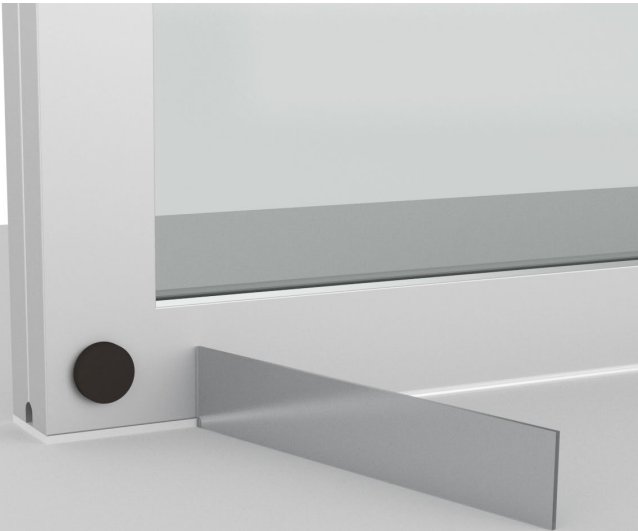

④ Sealing joint can be painted in the desired color afterwards.



Stick the round self-adhesive felt onto the corner of the fixed panel



FIXED PANEL INSTALLED



INSTALL DOOR LEAF

Clean the rail extremely well before installing the door leaf!

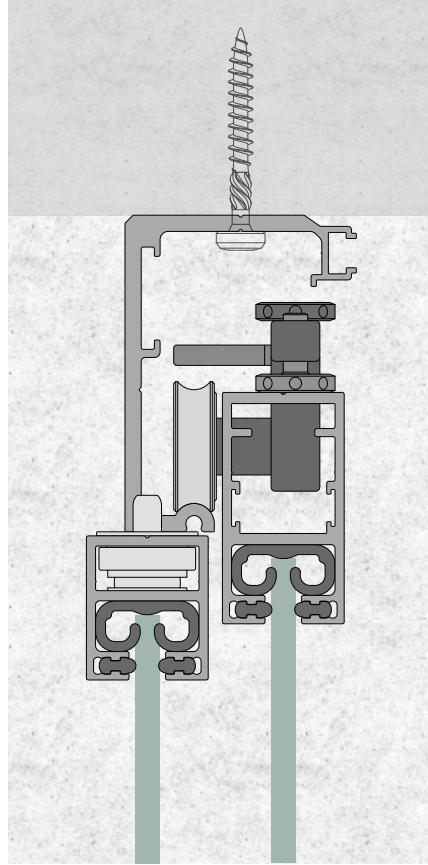
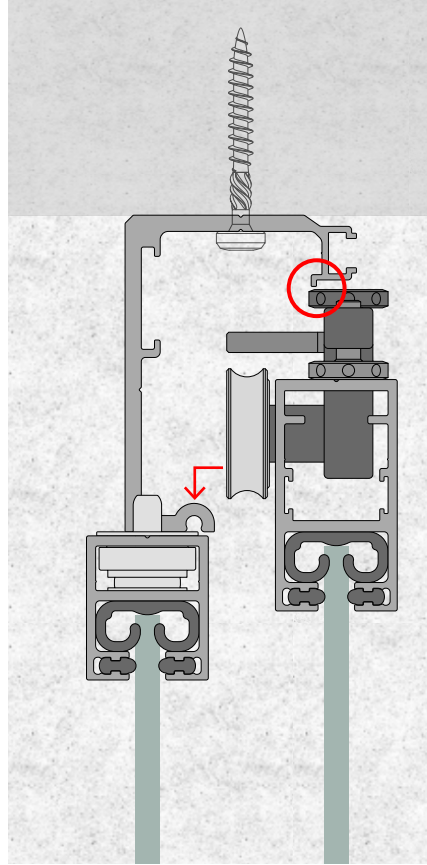

Install the door leaf onto the rail. Try to lift the door as upright as possible as space is limited.

Move the door to its closed position. Be careful as there is no soft close installed yet!

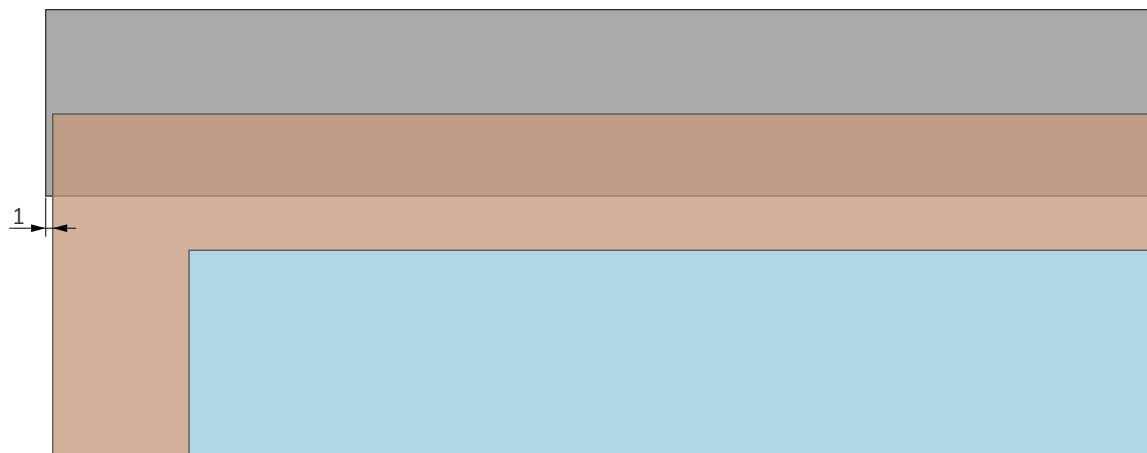

INSTALL FLOOR GUIDE

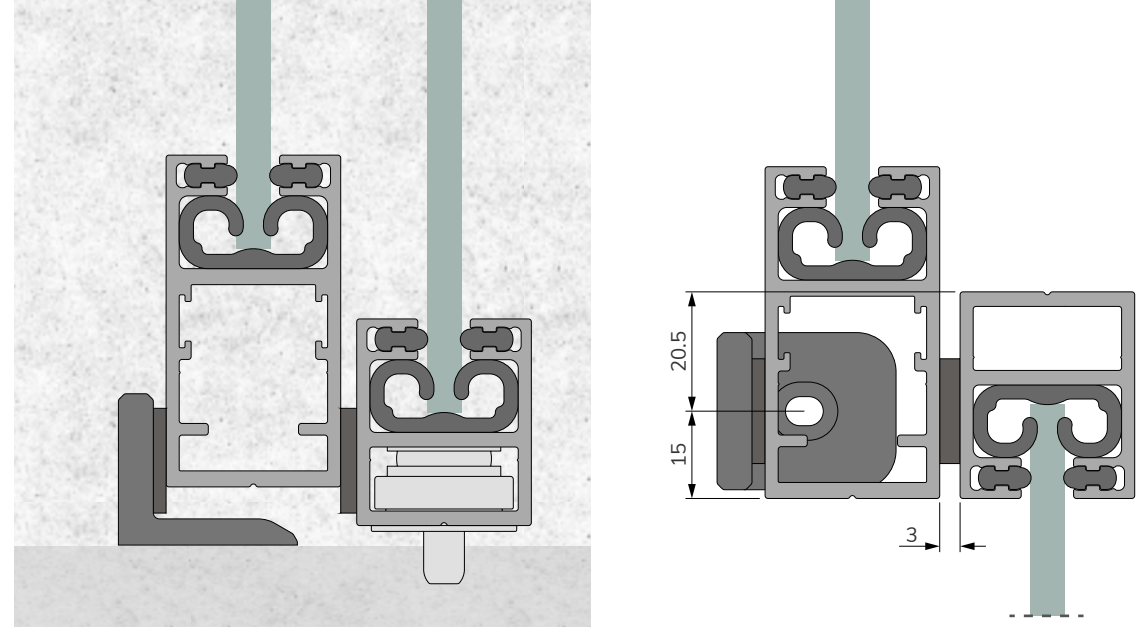
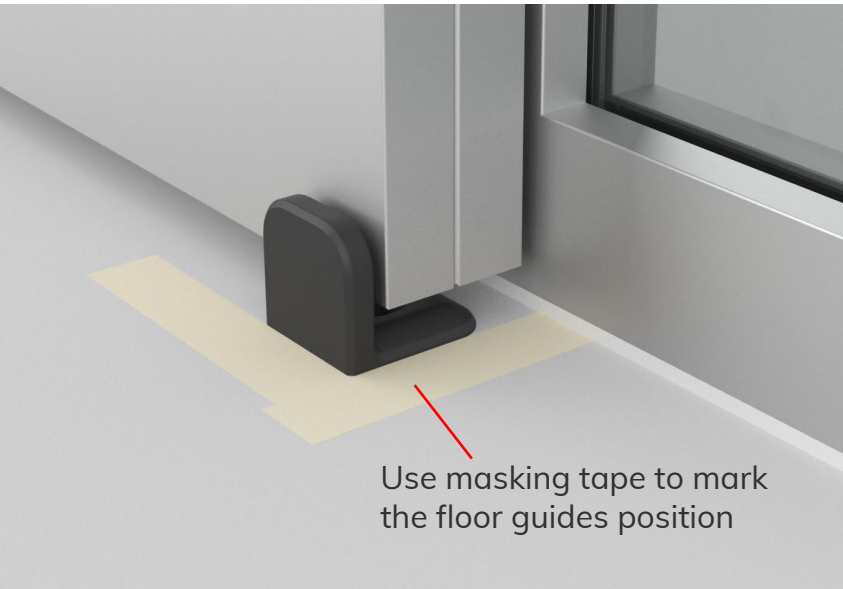

- ① Position the floor guide as shown. Different setups may require different positions!

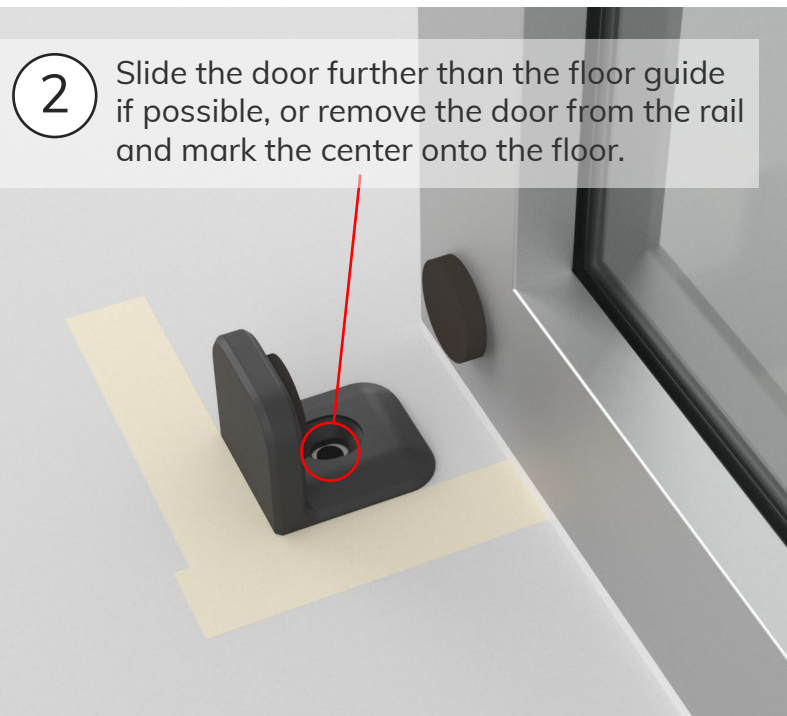

- ③ Drill the hole, secure with supplied screw and remove masking tape.



INSTALL SOFTCLOSE



Push the softclose trigger to its 'receiving' position

Push both softclose holders in the rail and rotate 90°

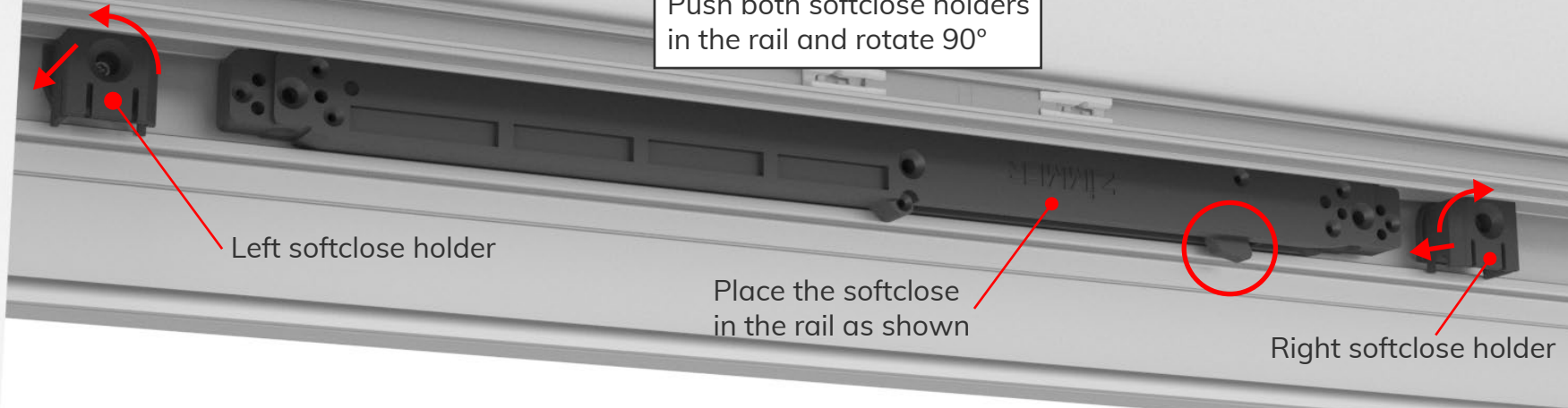

Left softclose holder

Place the softclose in the rail as shown

Right softclose holder

Slide softclose holders over the softclose ends, and slide the assembly to +/-25 mm from the rail edge.



+/-25 mm

Lock the softclose holders with a 2.5 mm allen key. Don't over tighten the setscrews!



Place the door leaf back in the middle of the rail if you removed it in the previous steps.



Repeat for the second softclose!

Make sure both softclose triggers are in their 'receiving' position, and facing each other.

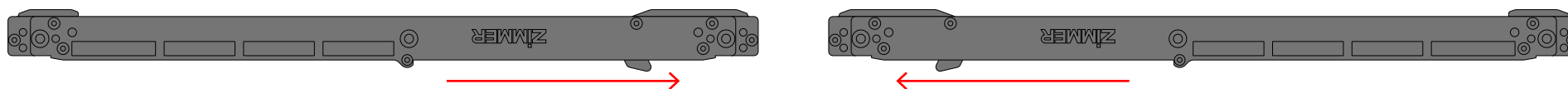

This softclose location depends on how far the door should open (preference, door handle type,...). This can be adjusted easily later on.



ADJUST SOFTCLOSE POSITIONS

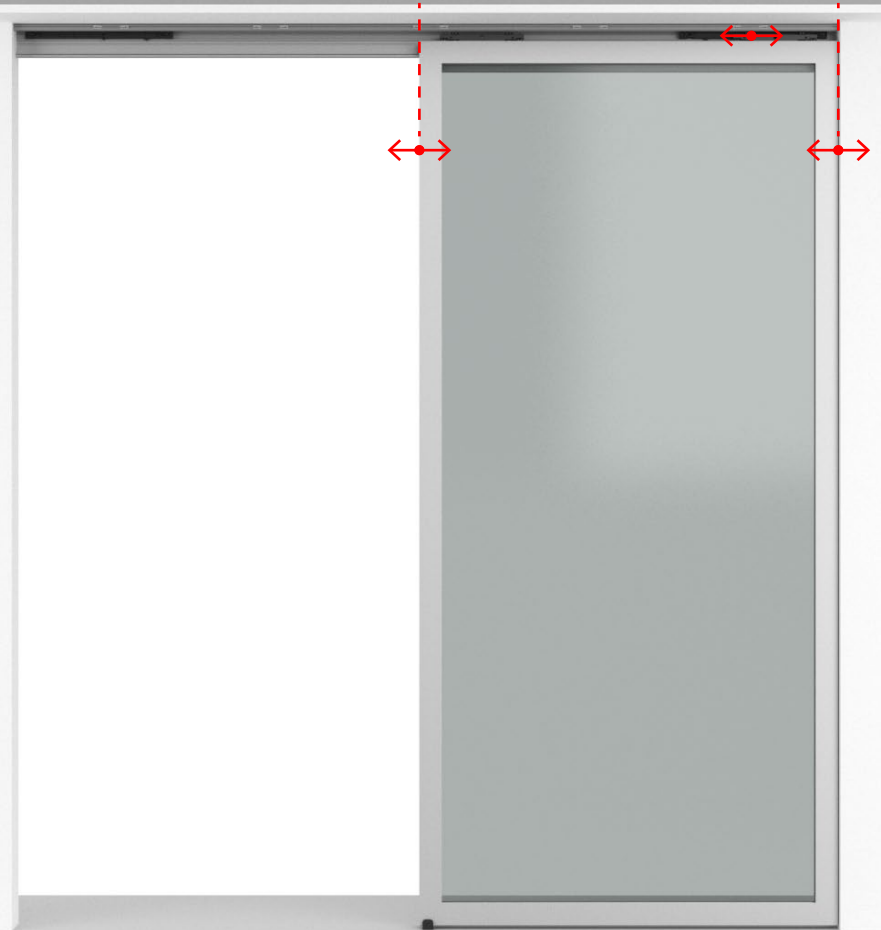
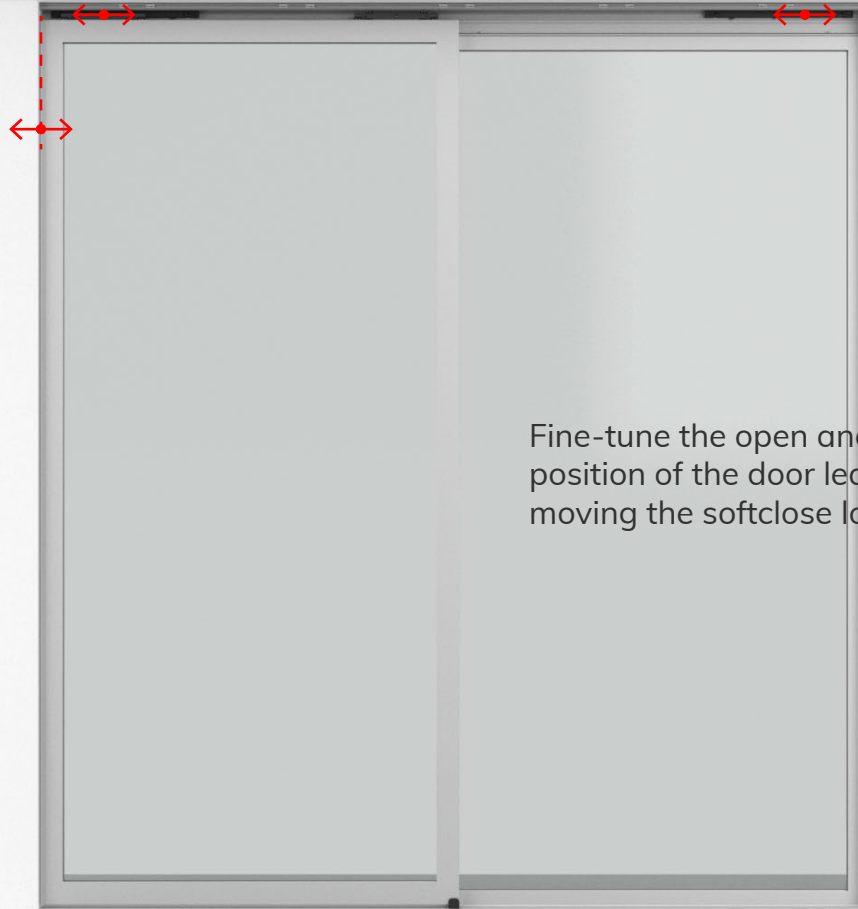
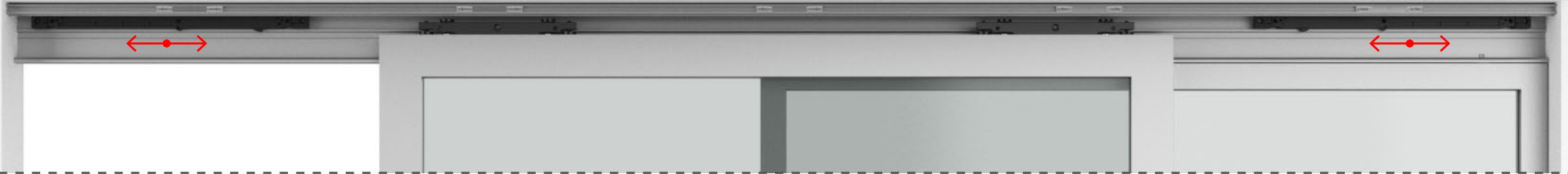

Fine-tune the open and closed position of the door leaf by moving the softclose locations.

ADJUST DOOR LEAF DOWN

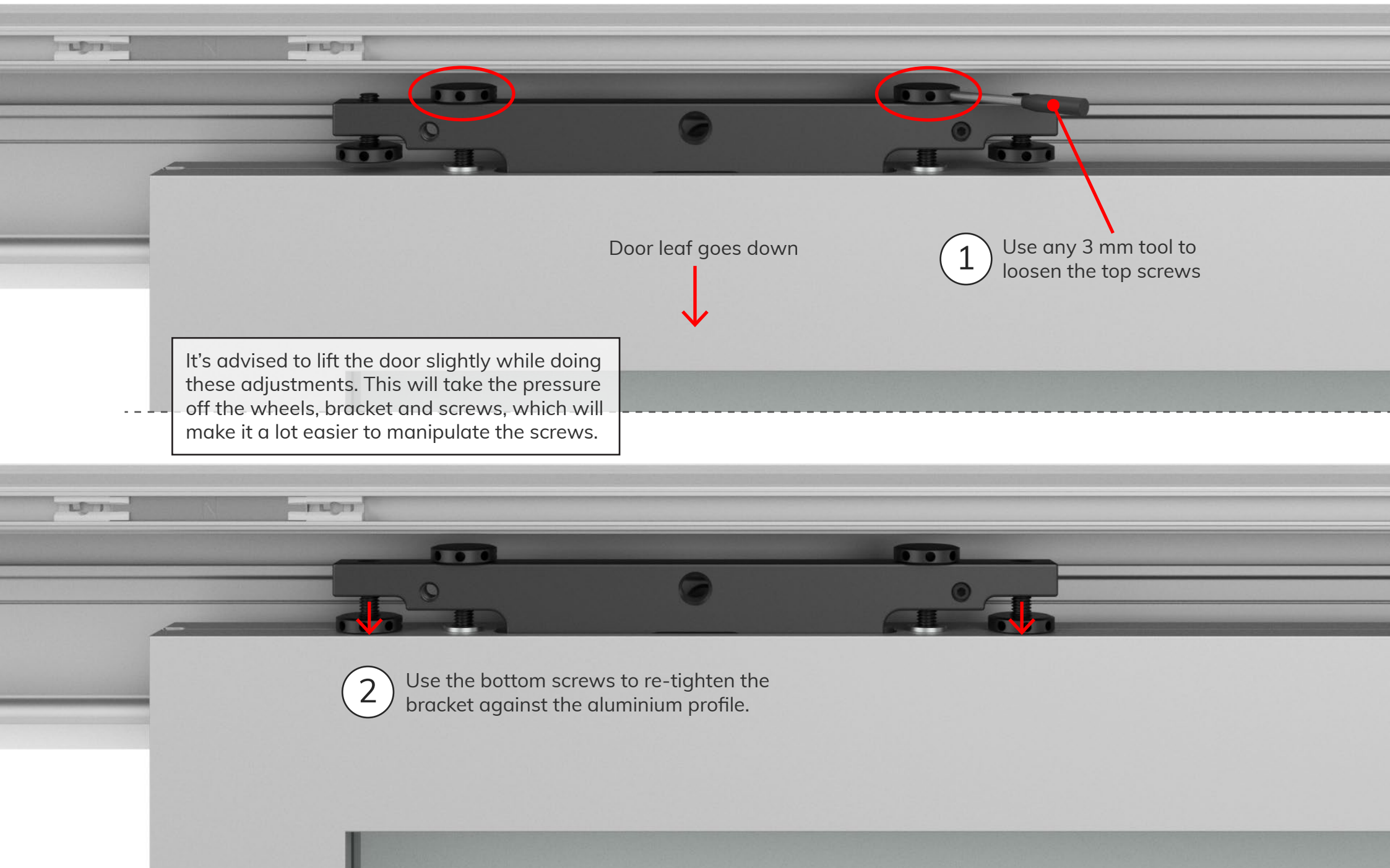

Door leaf goes down



1

Use any 3 mm tool to loosen the top screws

It's advised to lift the door slightly while doing these adjustments. This will take the pressure off the wheels, bracket and screws, which will make it a lot easier to manipulate the screws.

2

Use the bottom screws to re-tighten the bracket against the aluminium profile.

ADJUST DOOR LEAF UP

It's advised to lift the door slightly while doing these adjustments. This will take the pressure off the wheels, bracket and screws, which will make it a lot easier to manipulate the screws.

1 Use any 3 mm tool to screw in the bottom screws

2 Screw in the top screws to increase the door leaf height

3 Use the bottom screws to re-tighten the bracket against the aluminium profile.

Door leaf goes up

LEVEL/ALIGN THE DOOR LEAF

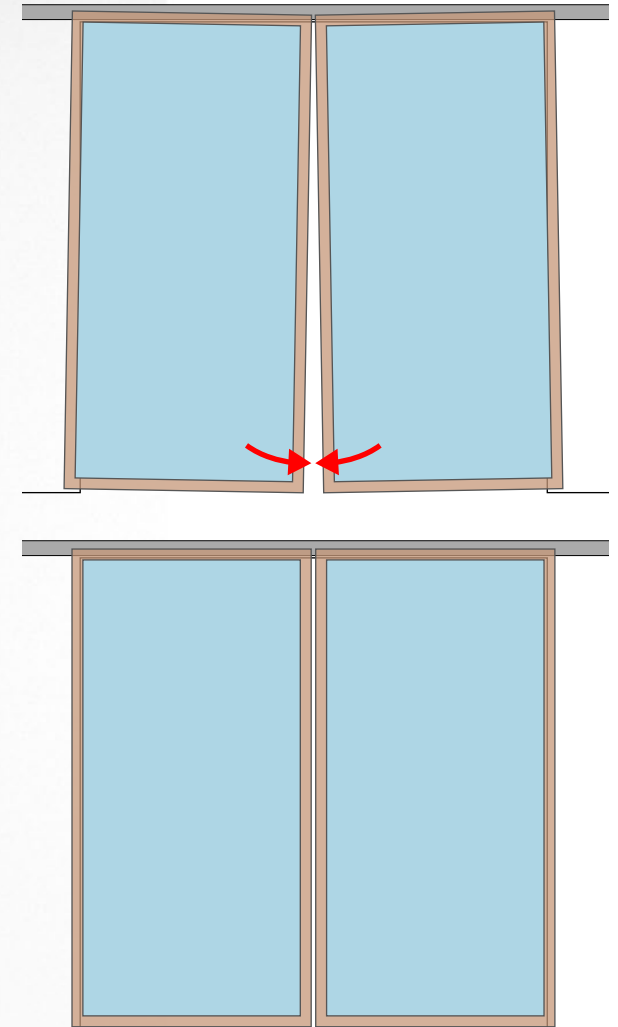
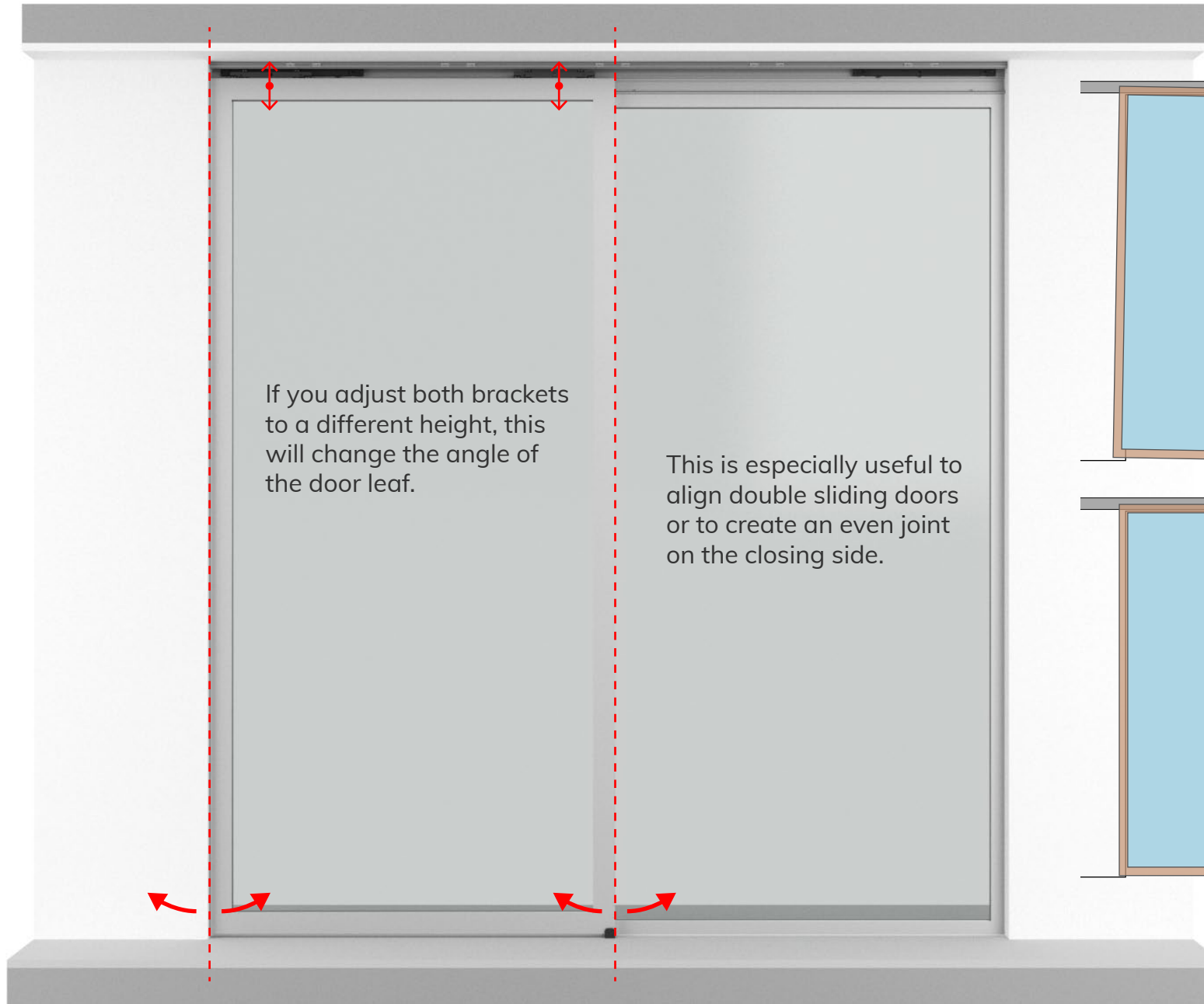

ANTI JUMP PROTECTION

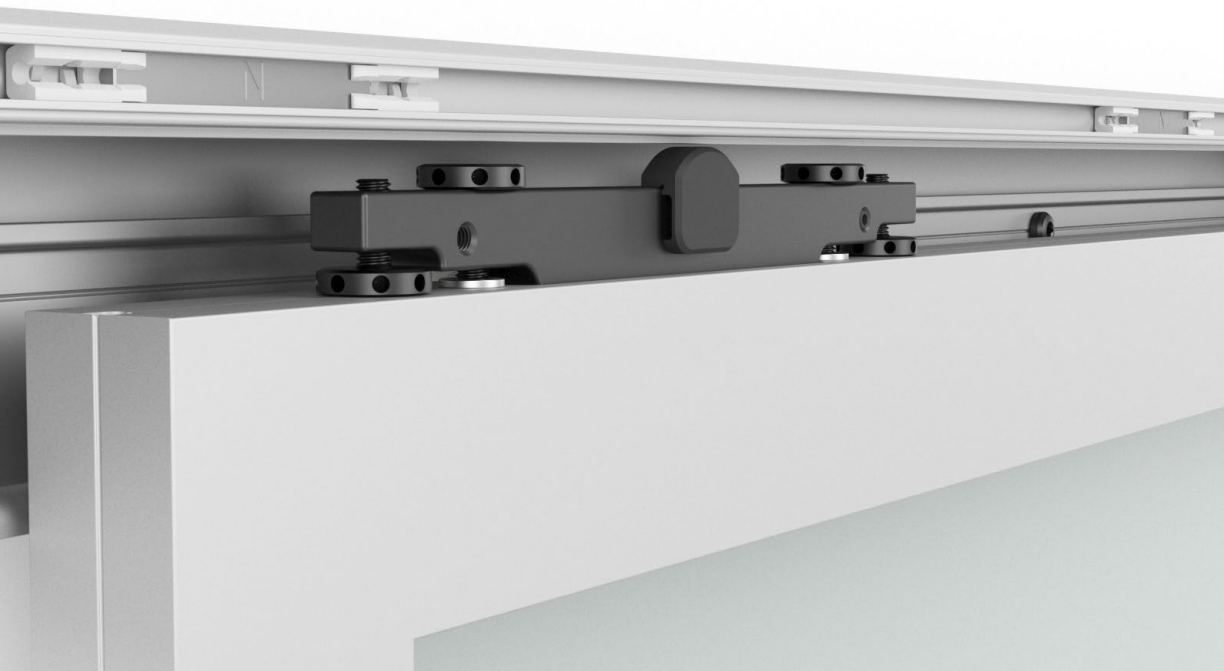
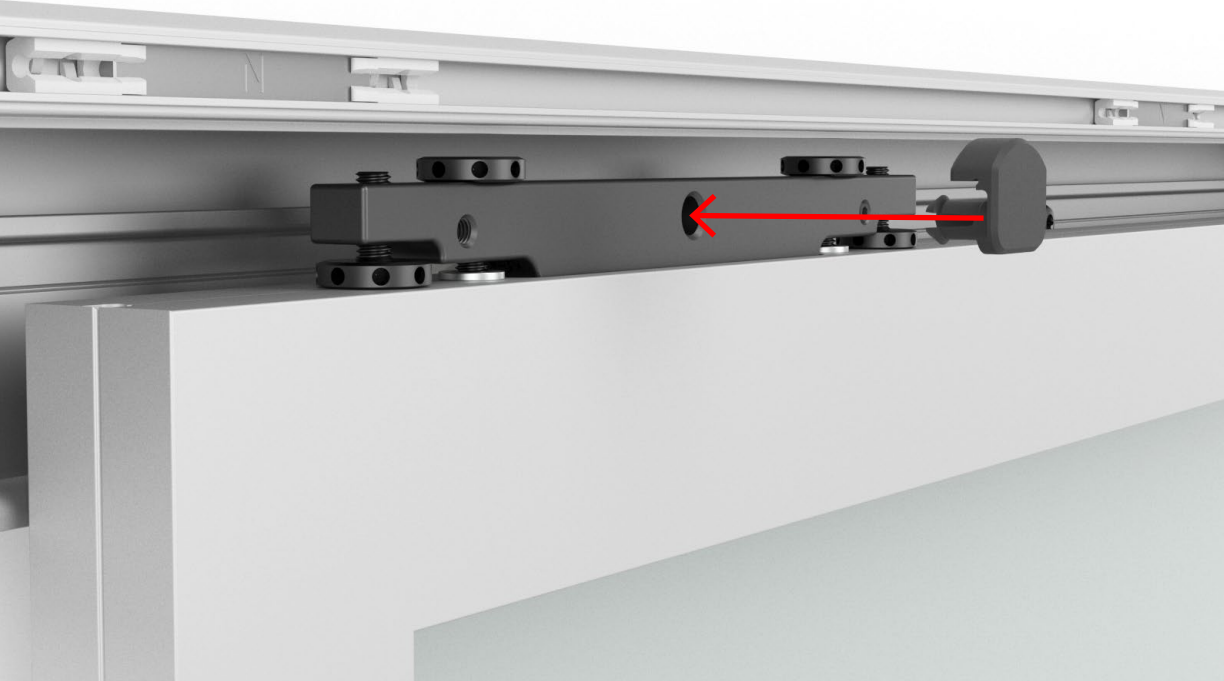

To prevent the door from accidentally jumping off the rail, mount an anti jump part in each steel bracket.

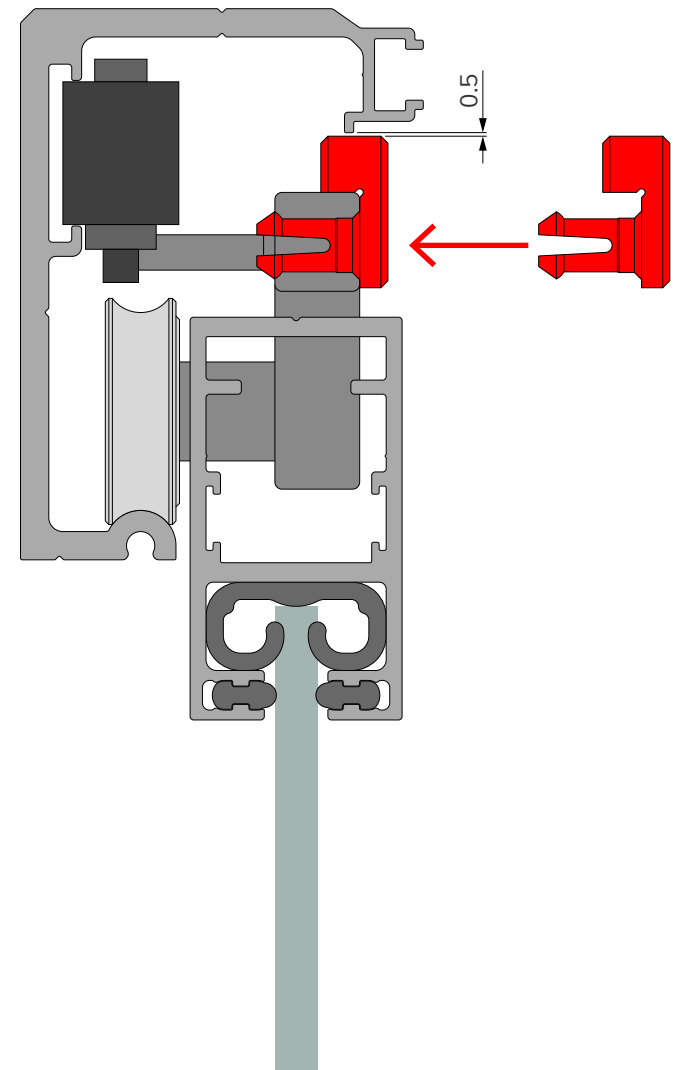

RAIL COVER

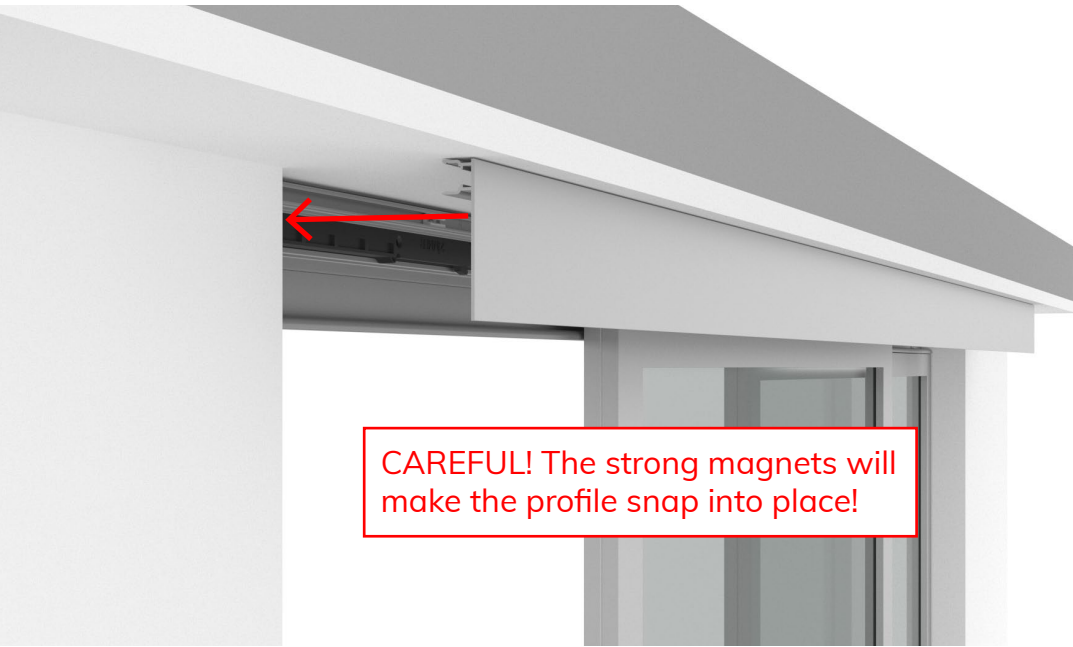

CAREFUL! The strong magnets will make the profile snap into place!

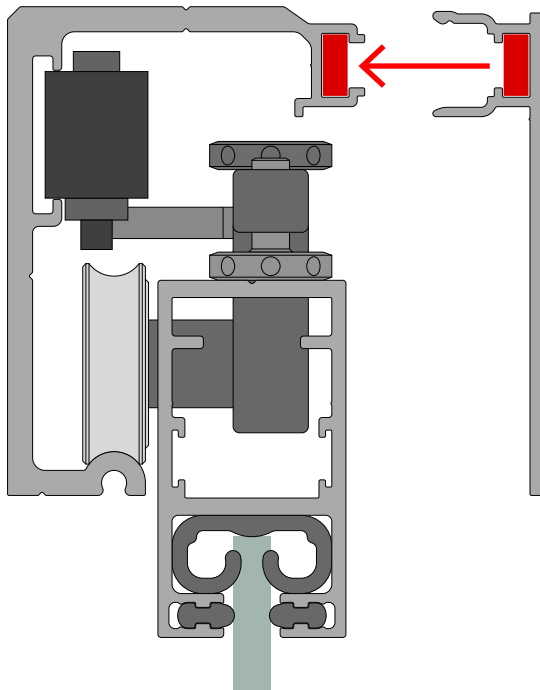
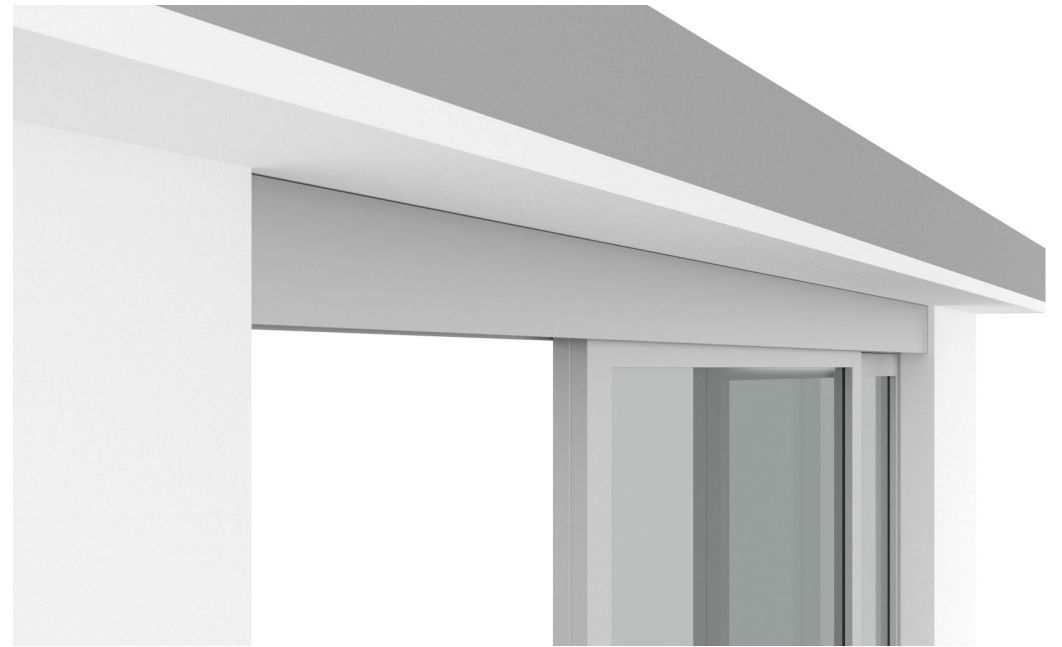

Install the rail cover profile over the rail.

 = MAGNETS

FINISHED PRODUCT

