



STEALTHPIVOT

By PortaPivot

SLIDEWAYS 5730
ASSEMBLY MANUAL

SLIDEWAYS DOOR SETBOX

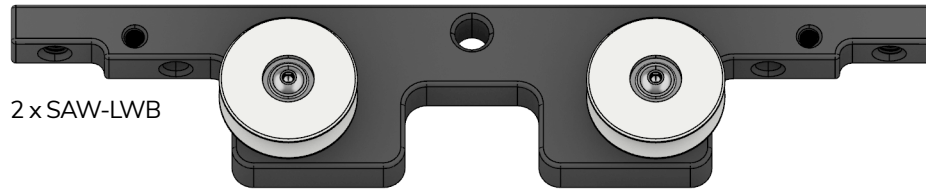
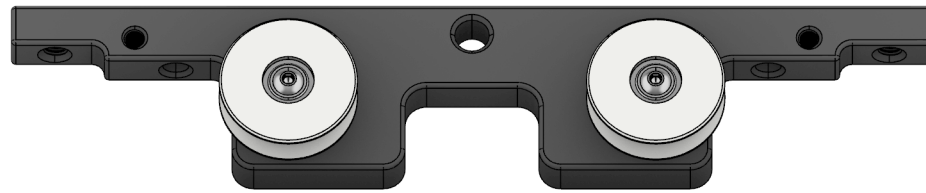

2 x SAW-LWB

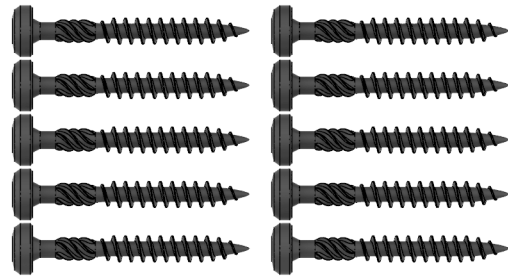

10 x Maxxfast CK 6x50 - black



1 x Maxxfast CST 4,5x50 - black

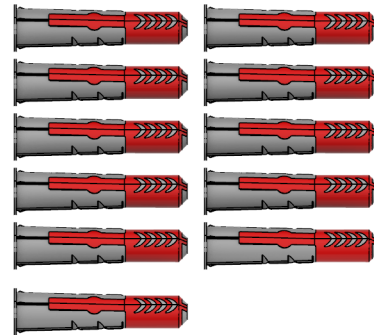

11 x Fisher Duopower 8x40

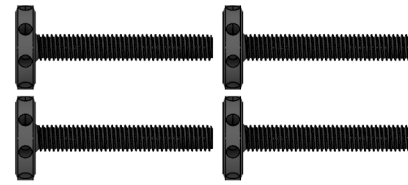

4 x SAW-SCR41

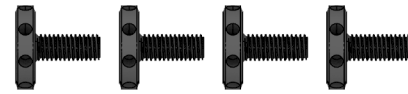

4 x SAW-SCR15



2 x DIN 427 - stelschroef met schacht



4 x DIN 916 - M5x10 setscrew 2 x DIN 916 - M5x6 setscrew

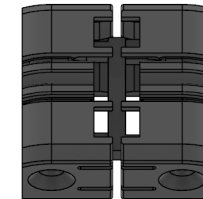

1 x SAW-SCLH-SET

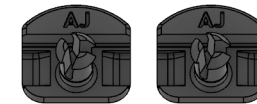

2 x SAW-AJ

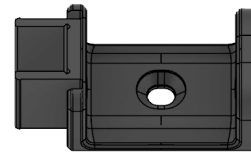

1 x SAW-VLGL30

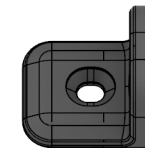

1 x SAW-VLGLENDA



2 x VILT Ø18 mm

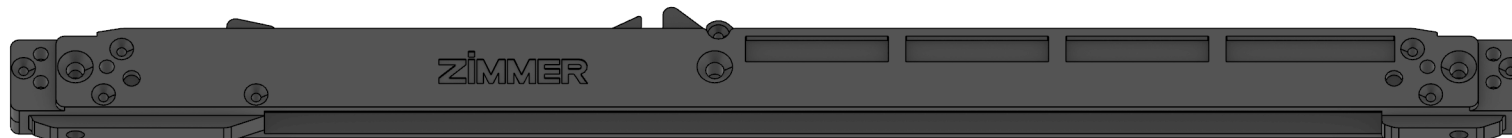
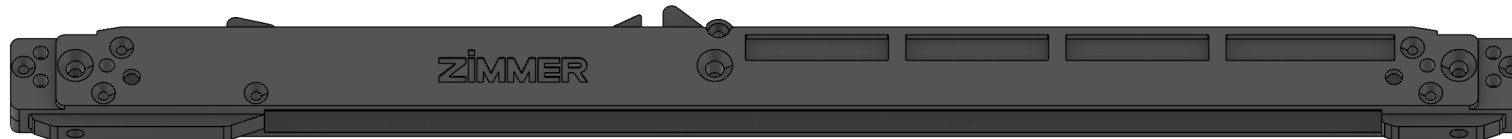

2 x E100-08-151 smooth comfort

SLIDEWAYS RAIL SETBOX

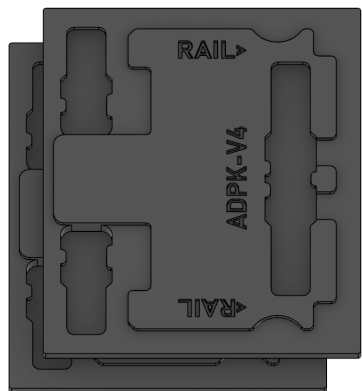

2 x SAW-ADPK

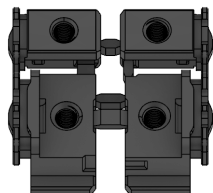

1 x SAW-ADPCONN-SET



1 x SAW-BOOR



4 x DIN 916 - M5x10 setscrew

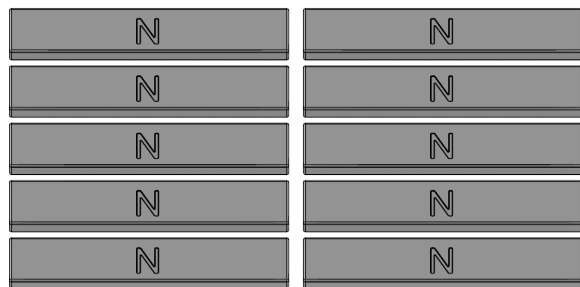

10 x MAGNET

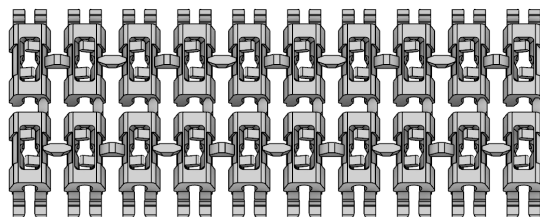

1 x MAGKL-SET

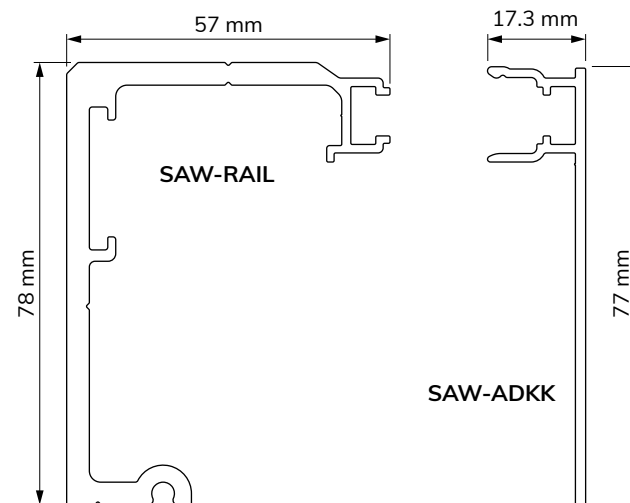

BLACK

SILVER

BRONZE

GOLD

BLACK

SILVER

BRONZE

GOLD

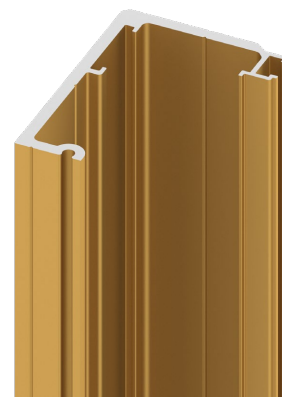
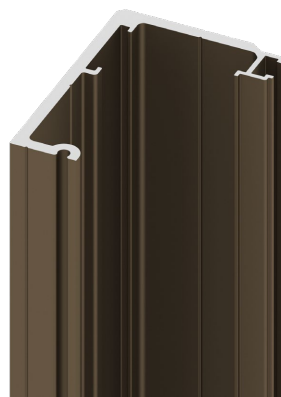
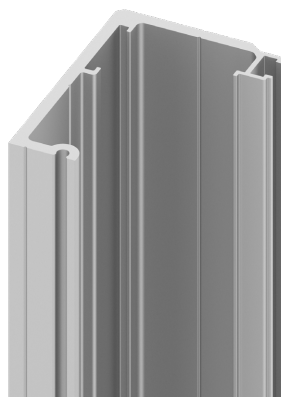

SLIDEWAYS 5730 PARTS

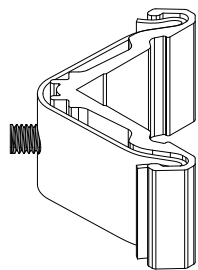

PAP-MCDBLK25x11x24,5

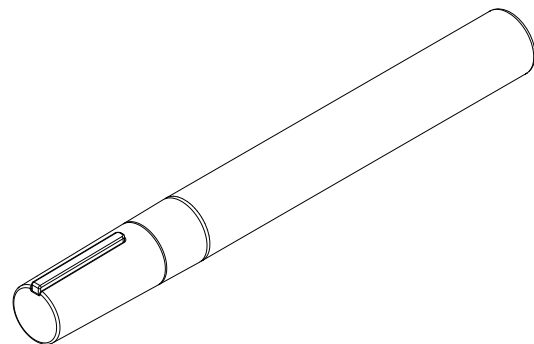

SAW CUT MARKER

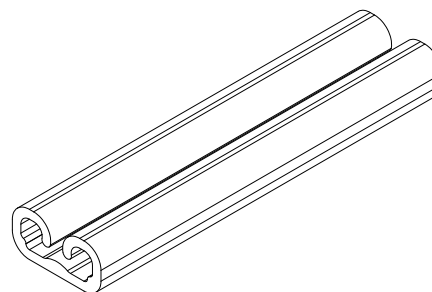

PAP-GLBR6-8

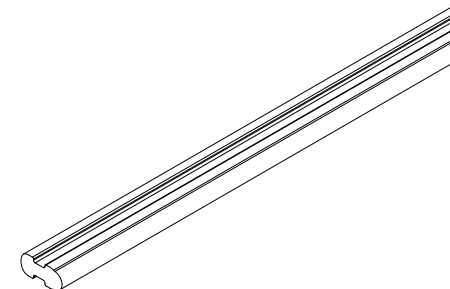

GLR68

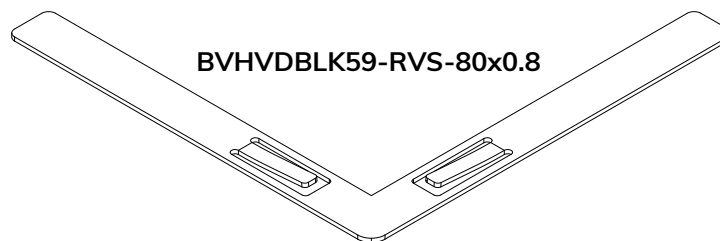

BVHVDBLK59-RVS-80x0.8

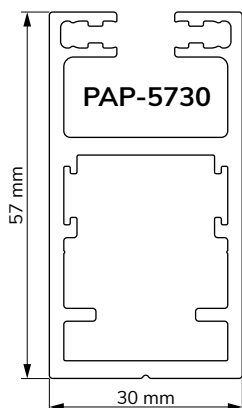

PAP-5730

BLACK



SILVER

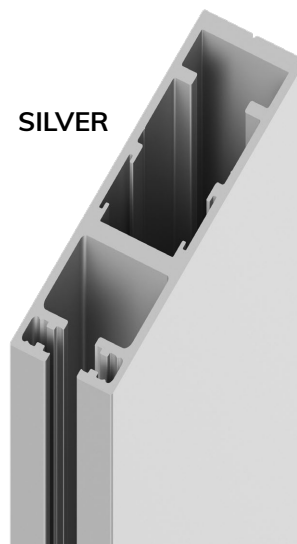

BRONZE



GOLD

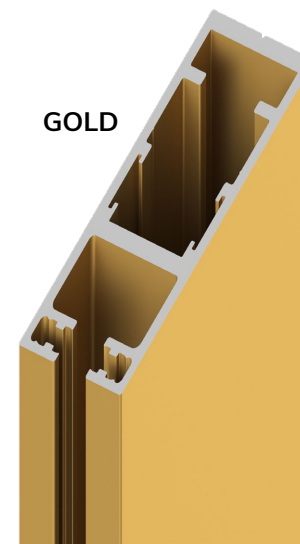

SLIDEWAYS 5730 EXAMPLE KIT OVERVIEW

The aluminium profiles are delivered in a firm cardboard tube which protects the profiles during transport and remains stackable. All assembly accessories & hardware are delivered in a separate cardboard box.

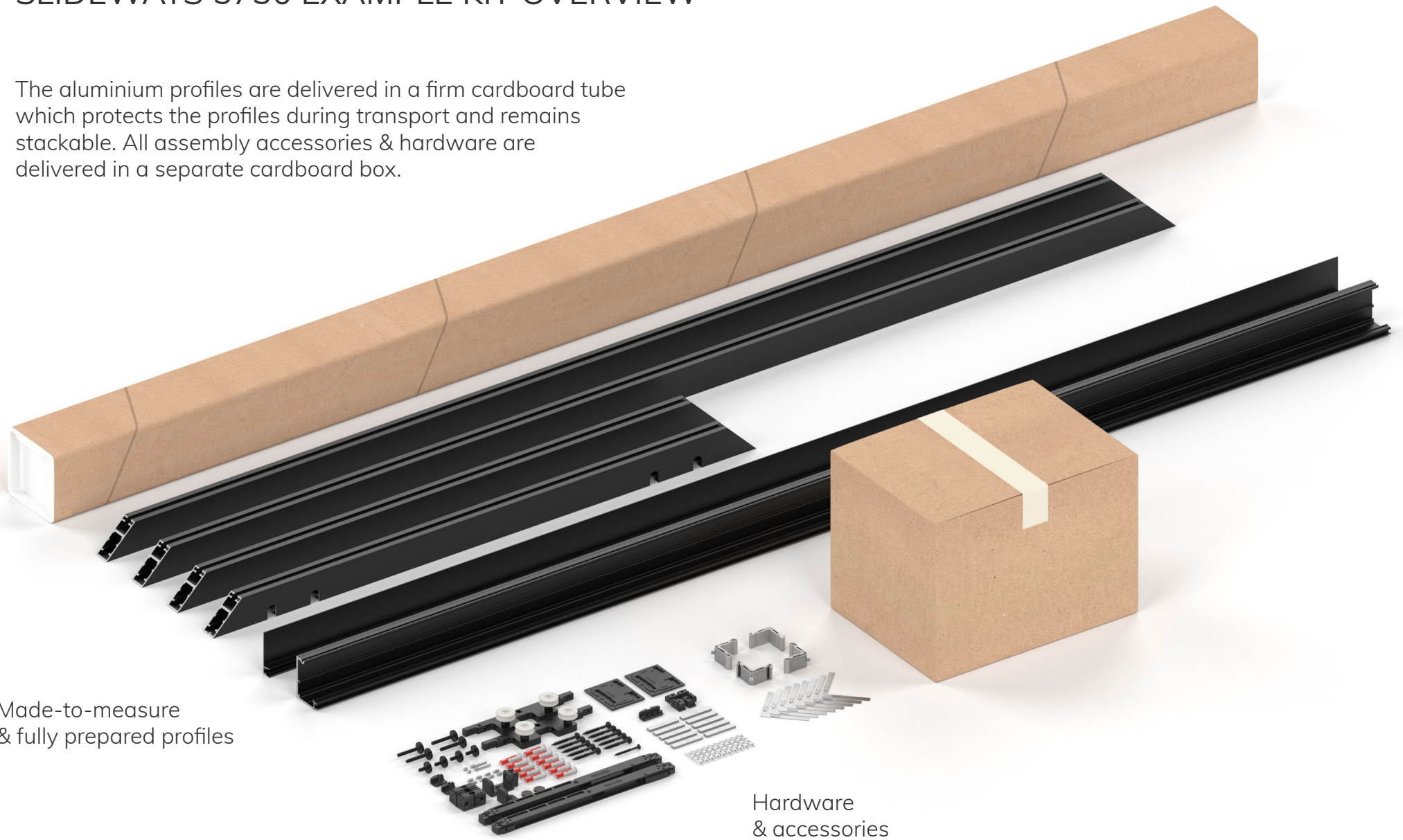

Made-to-measure
& fully prepared profiles

Hardware
& accessories

LOCALLY SOURCED MATERIALS

- ▶ Glass* (6 or 8 mm tempered glass)
- ▶ Silicone spray
- ▶ Isopropyl alcohol (cleaning alcohol)
- ▶ Acetone

* Portapivot recommends using 6 mm thick tempered glass for weight advantages during manipulation and installation on site

RECOMMENDED TOOLS

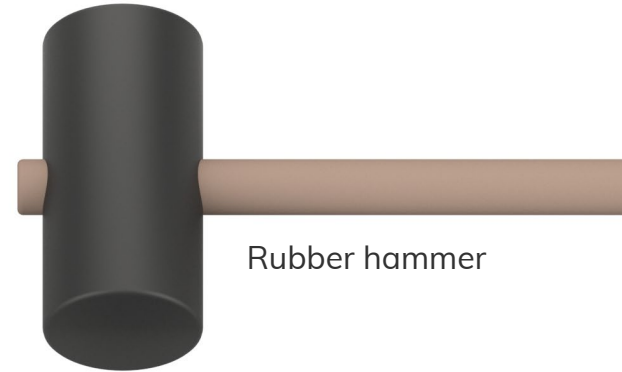

Rubber hammer



Bit screwdriver

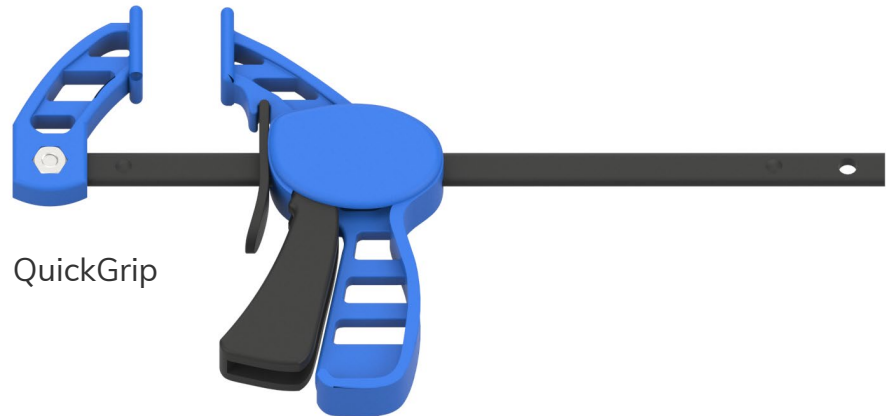

QuickGrip

COLOR SAW CUTS

Degrease* the saw cuts and use the supplied marker to paint the cuts.

*Isopropyl alcohol

Remove excessive paint from
visual sides with acetone or alike

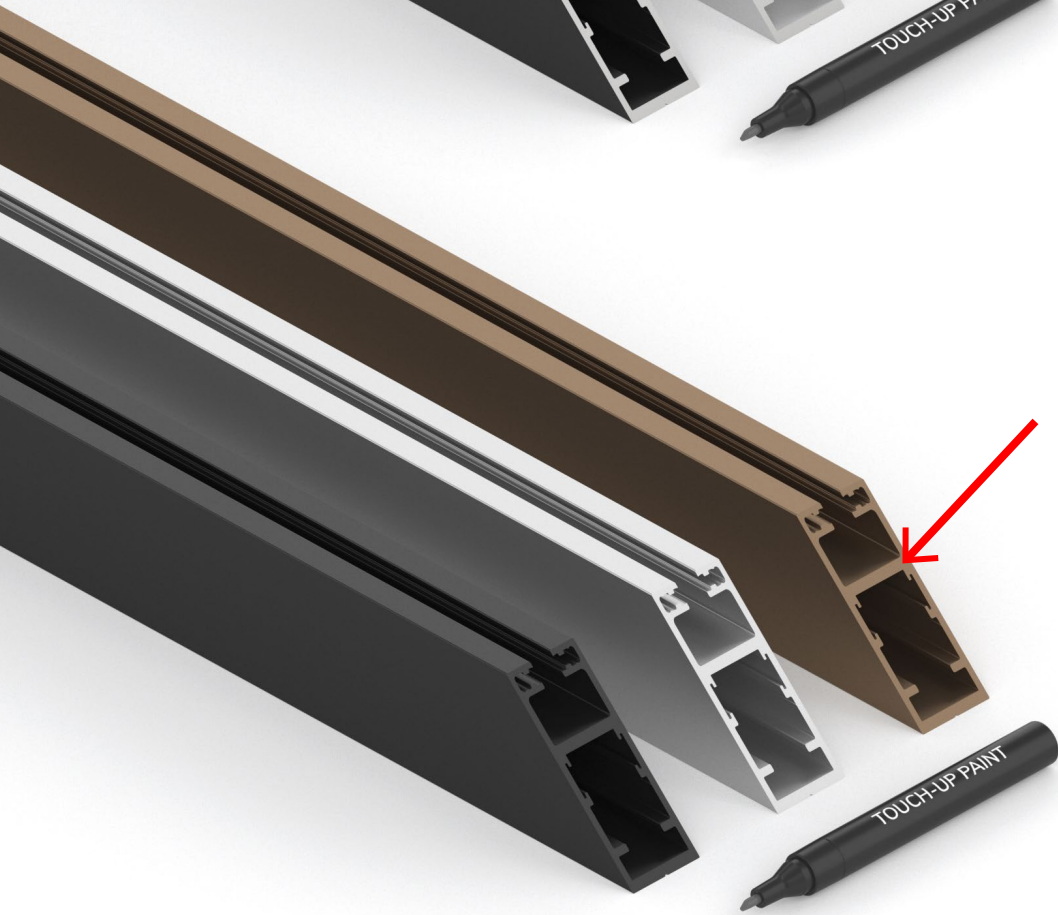
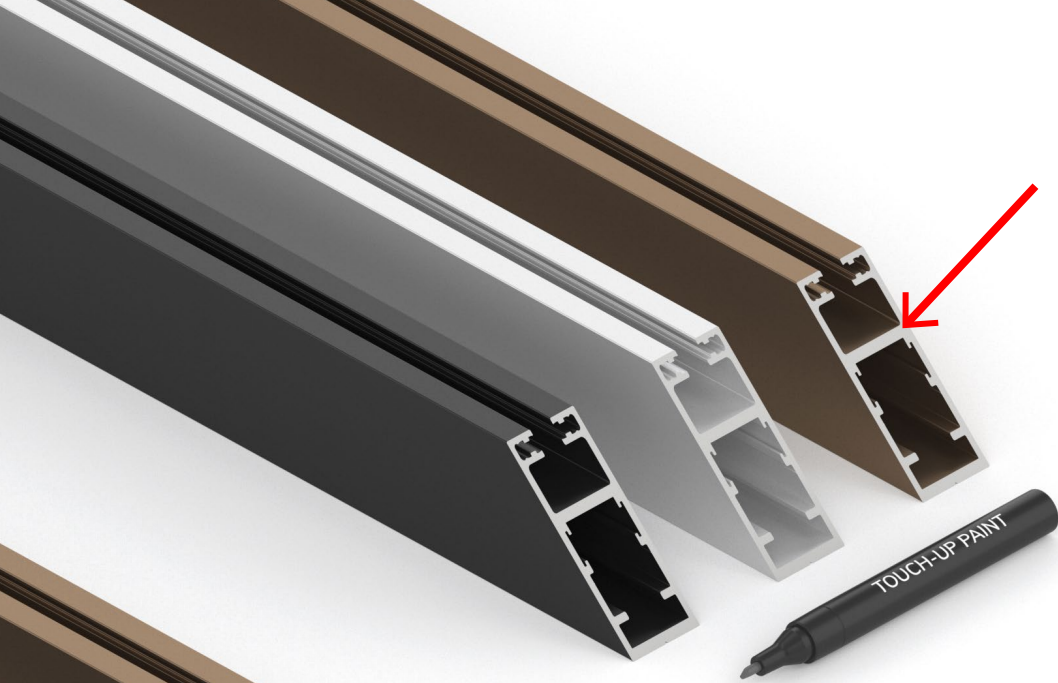

INSERT EPDM INSERTS

Slide in 5 EPDM inserts (GLBR6-8) into every profile, and distribute them evenly.

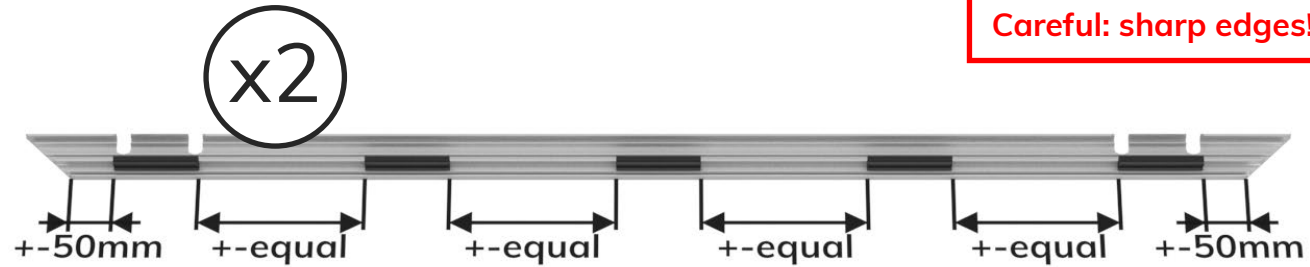
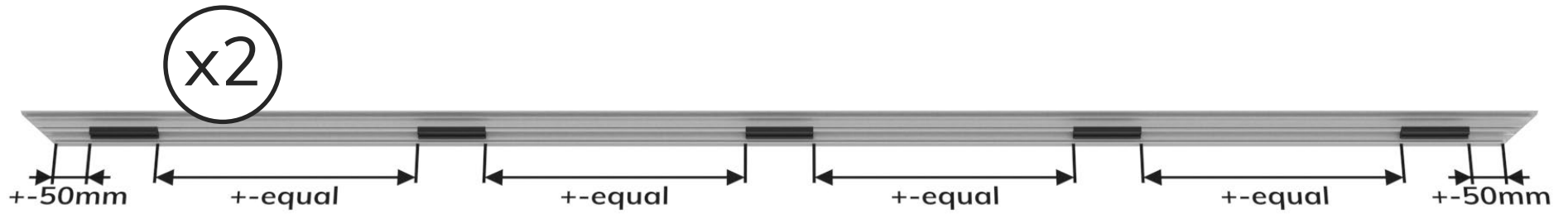
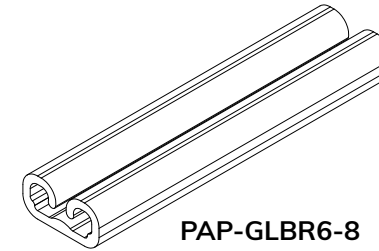

Careful: sharp edges!

INSERT GLR68 RUBBER EXTRUSIONS

The GLR68 rubber can be used for 6 or 8 mm glass because of its excentric profile shape. See visual for correct mounting positions.

GLR68 profile shape:

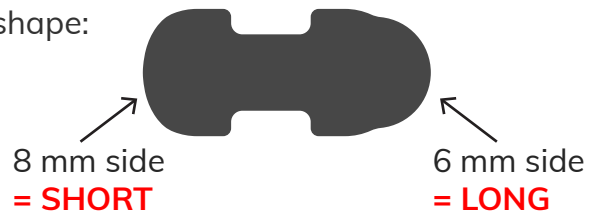

Rubber GLR68 patent pending

- 1 Cut off* a strip from the start of the GLR68.
 - For 6 mm glass, cut off the **SHORT** side.
 - For 8 mm glass, cut off the **LONG** side.

*To facilitate installing GLR68 in the alu profiles.

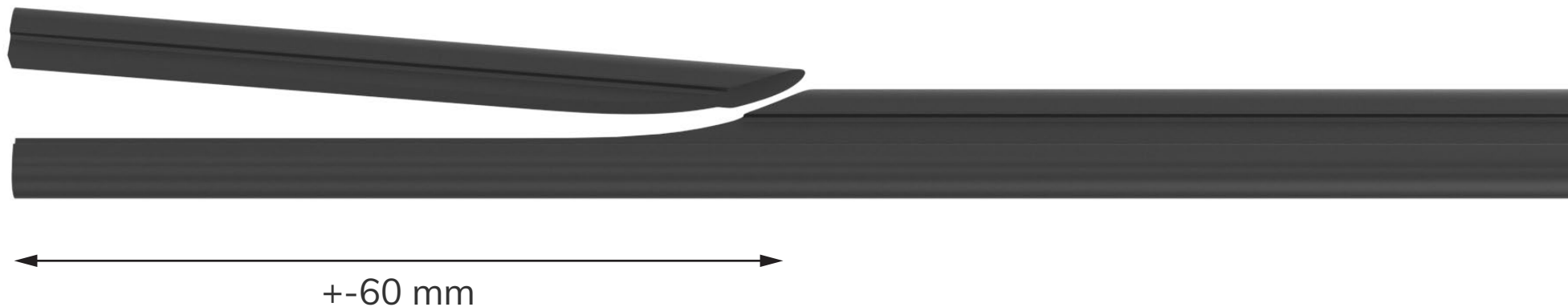
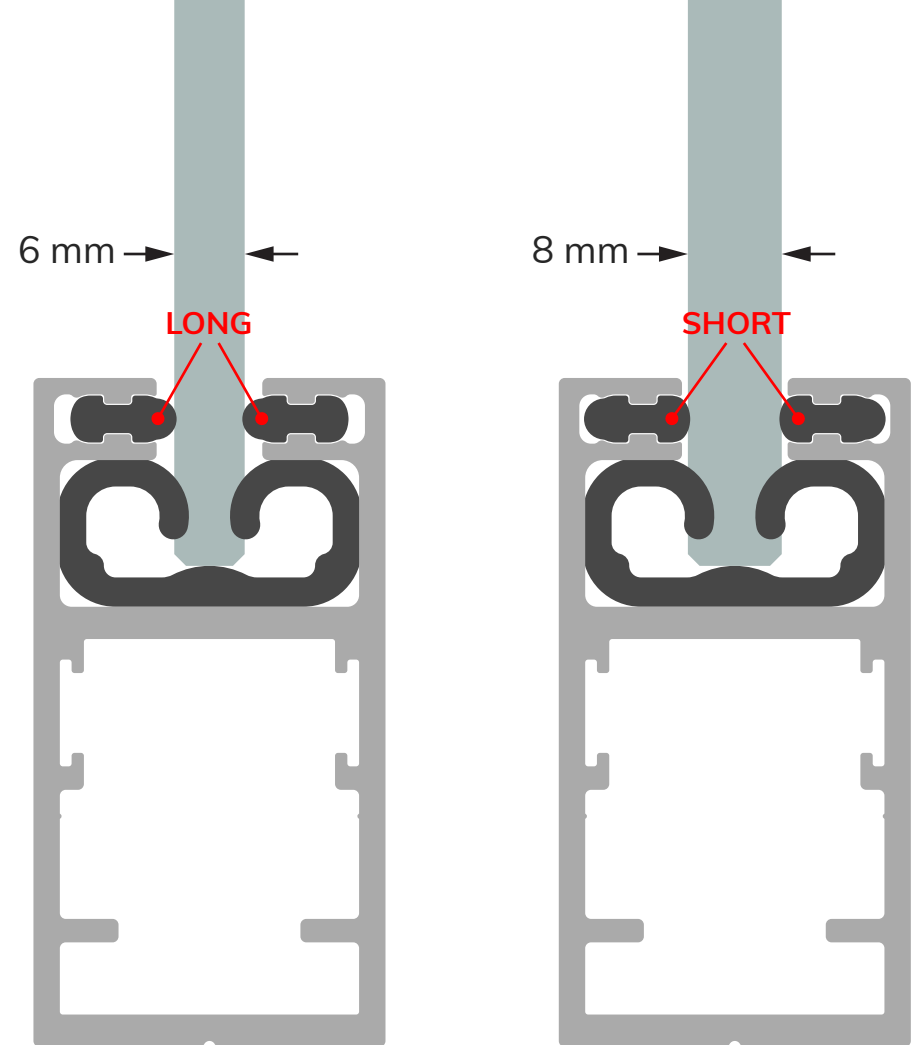

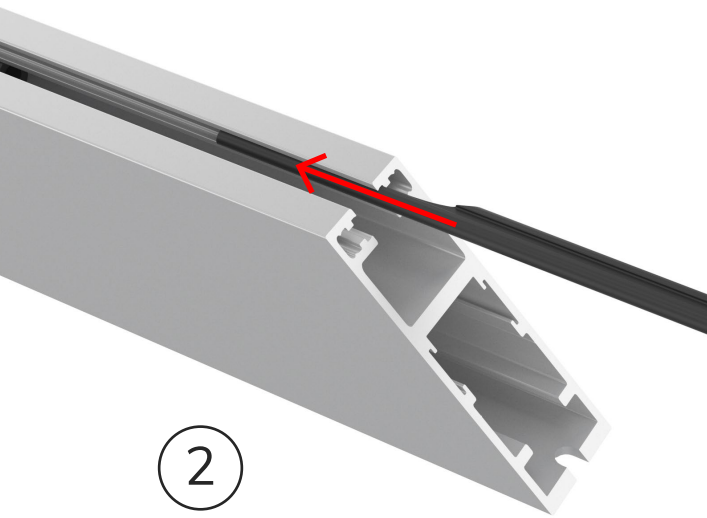

2

Guide the GLR68 through the canal, with the thin side towards the center of the profile.

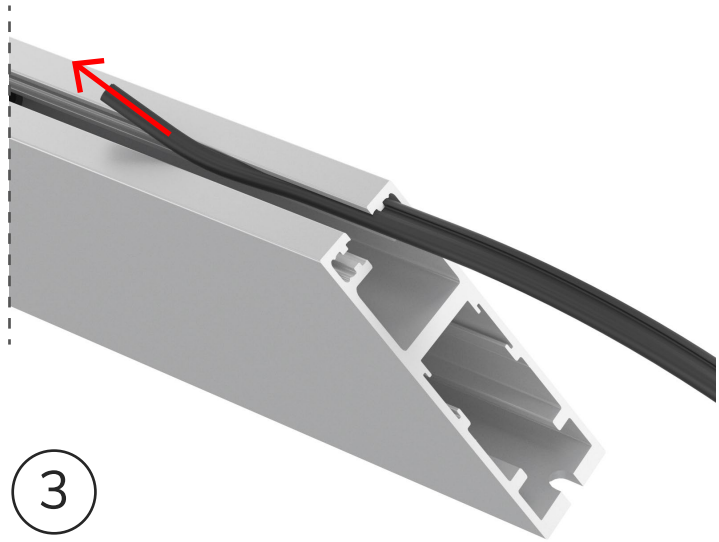

3

Pull the thin side out, and use this to pull the GLR68 through the aluminium profile.

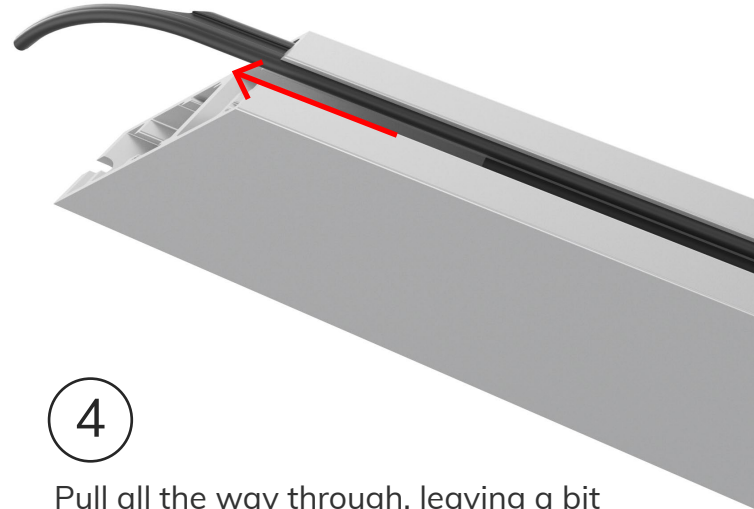

4

Pull all the way through, leaving a bit extra hanging out.

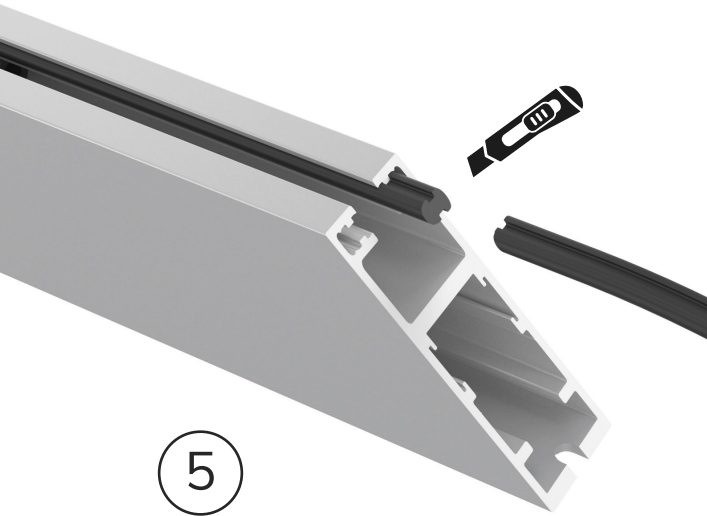

5

Cut this end at a 45° angle.

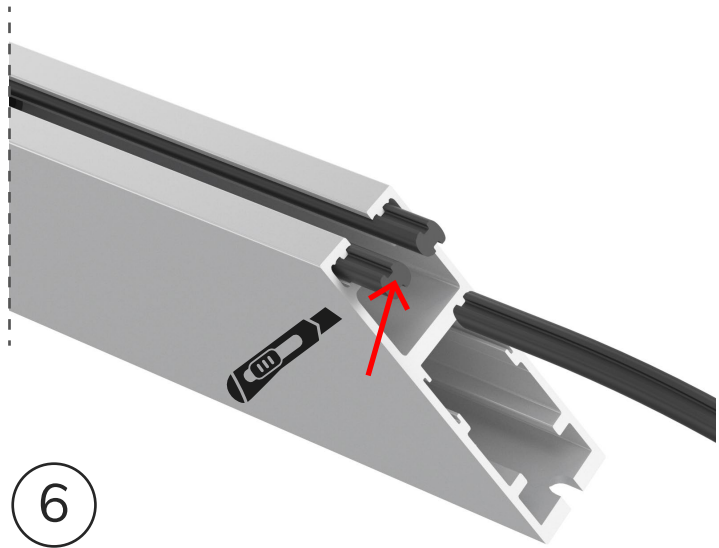

6

Repeat steps 1-5 for the second GLR68

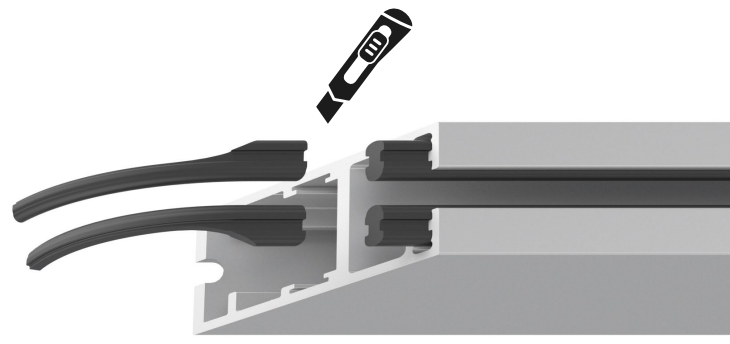

7

Cut off both remaining ends at the other side.

Apply steps 1-7 to each profile

PREPARE TOP AND BOTTOM PROFILES

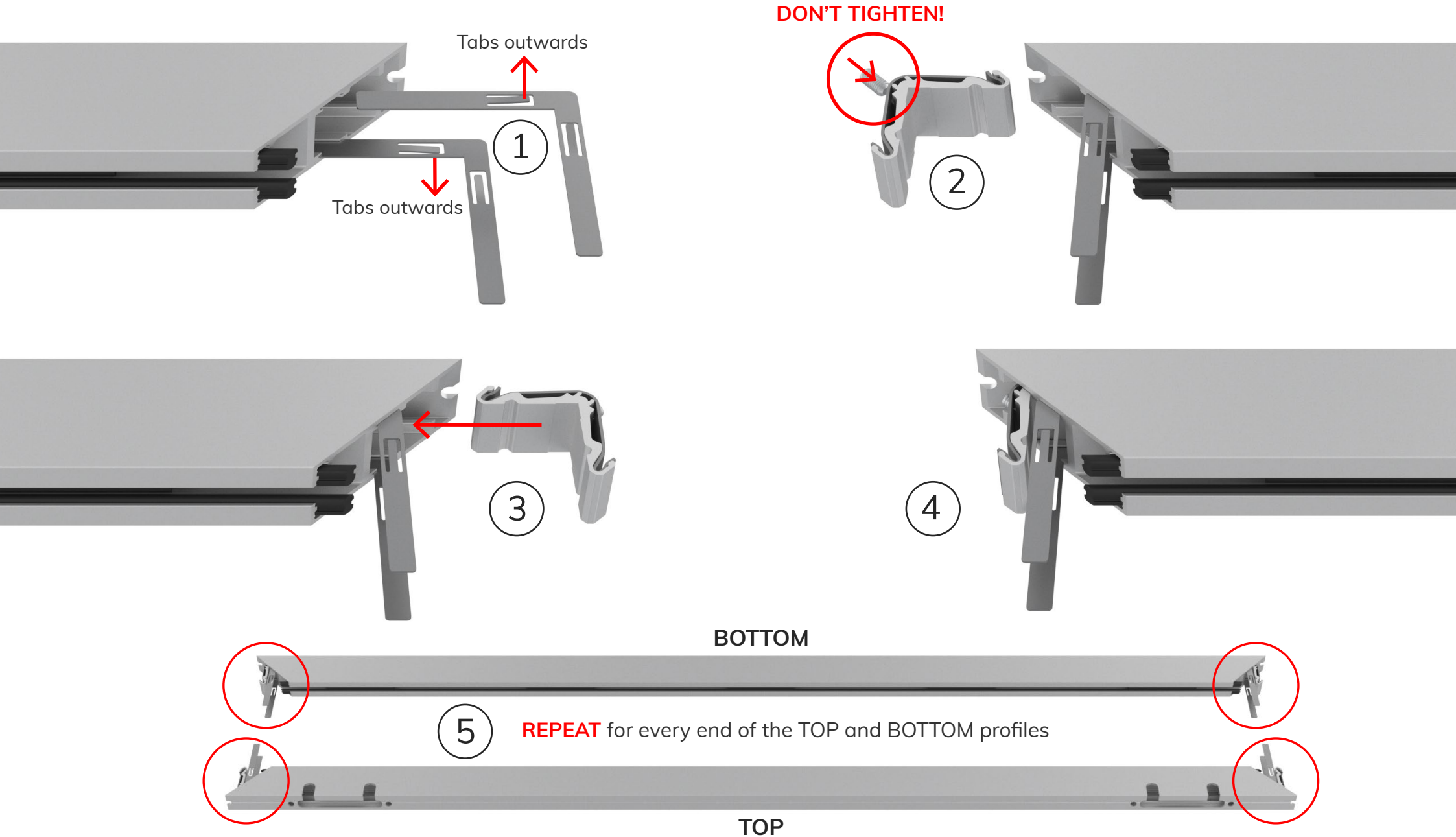

PLACE GLASS PANEL

Use 2 wooden spacers (+-15 mm thick) on an assembly table and place the locally purchased panel on top.

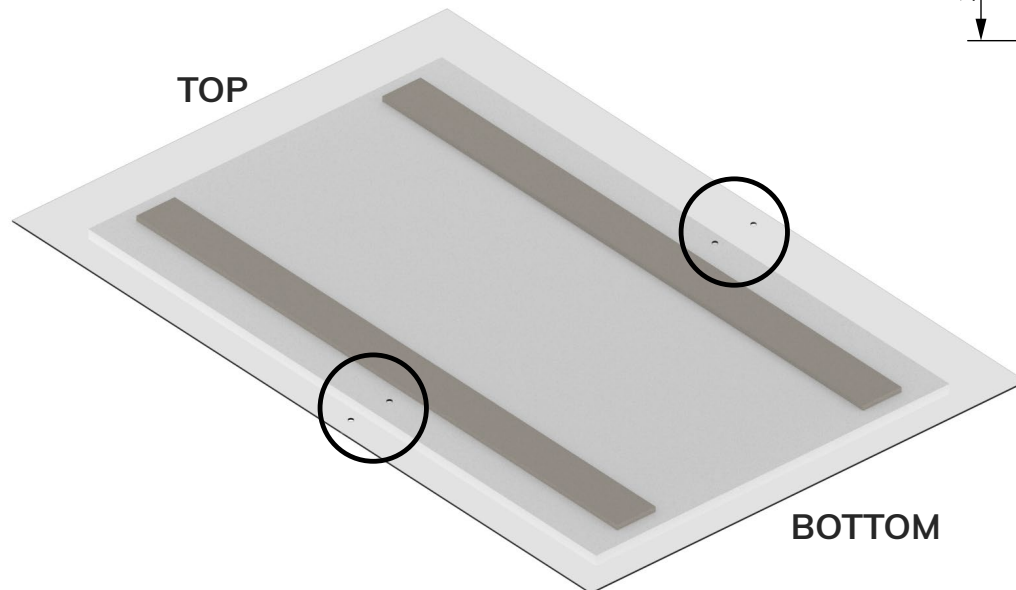
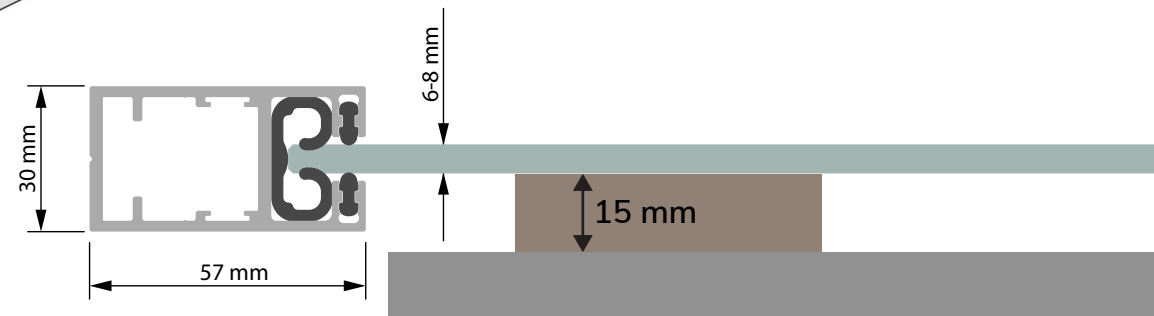
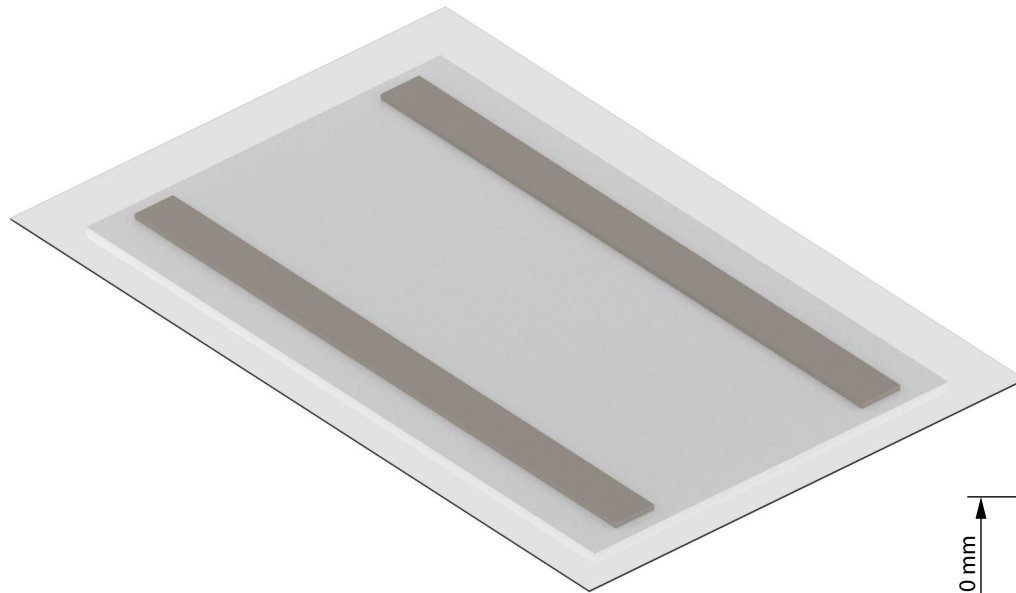

If your panel has pre-drilled holes, check that it has a top/bottom and left/right side!

MOUNT PROFILES ON GLASS

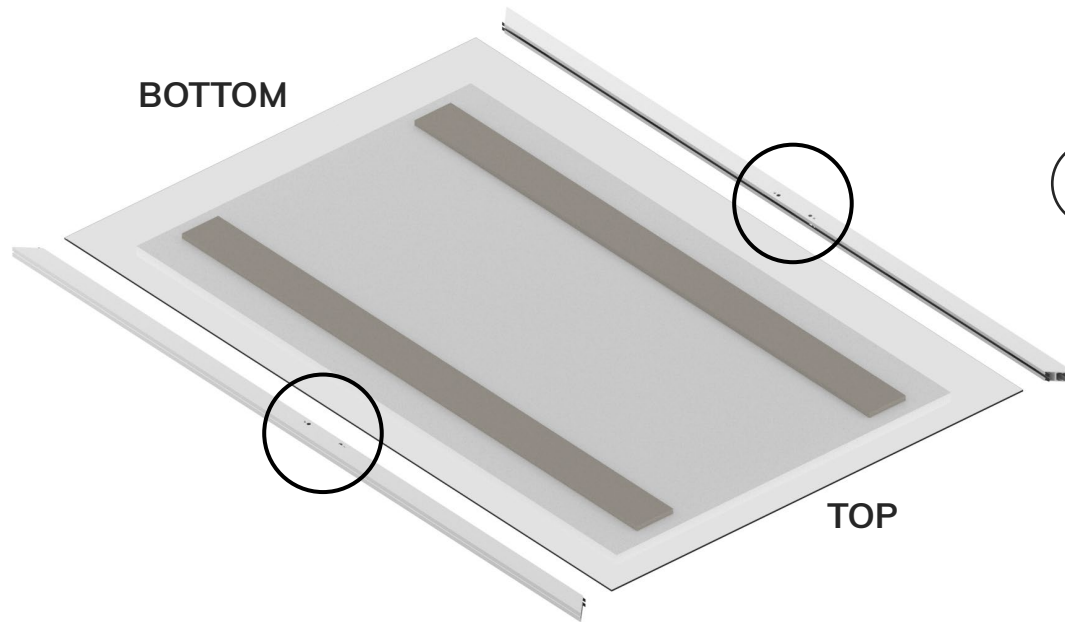

- 1 If there are holes for doorgrrips in the profiles, their top/bottom and left/right orientation might be important!

Careful: don't drop profiles!

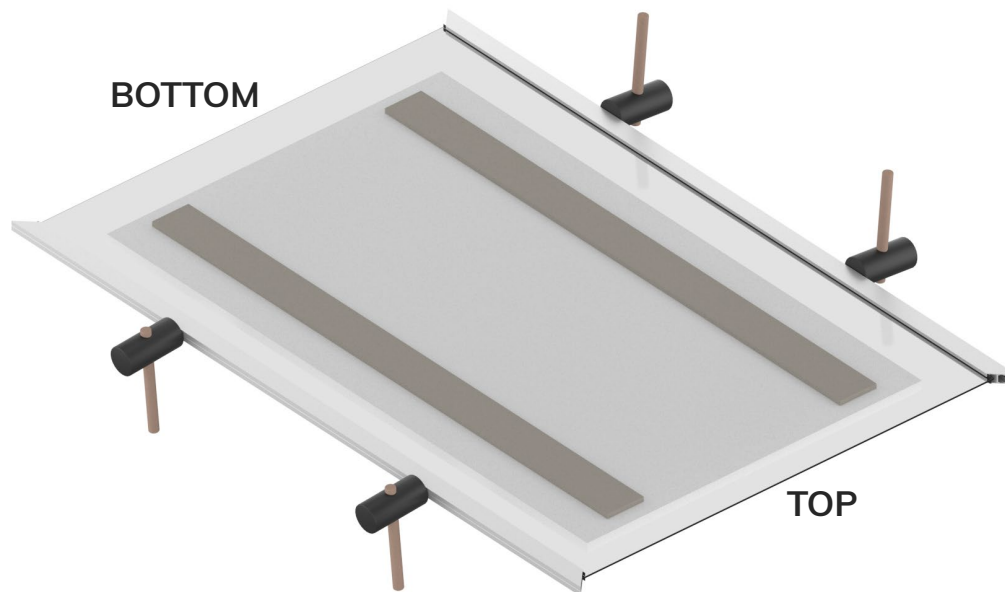

- 2 Push the left and right profiles with their EPDM inserts and GLR68 over the panel, matching the center of the profiles with the center of the glass.

Use a rubber hammer to facilitate positioning.

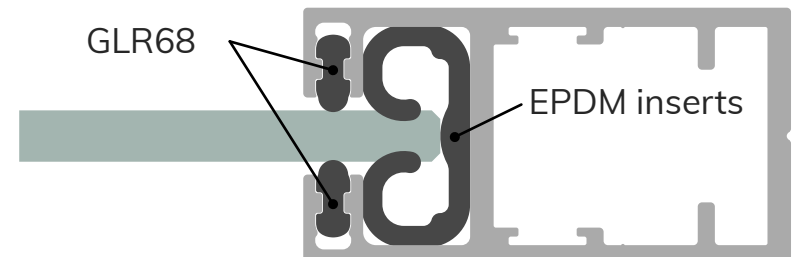

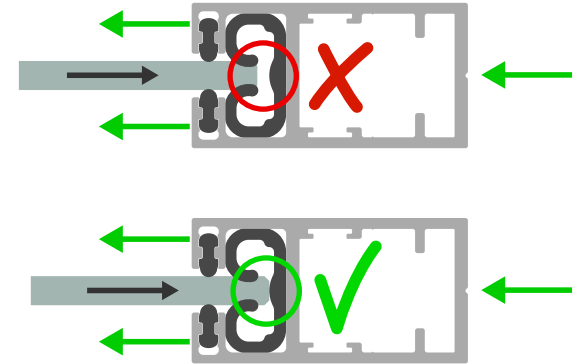
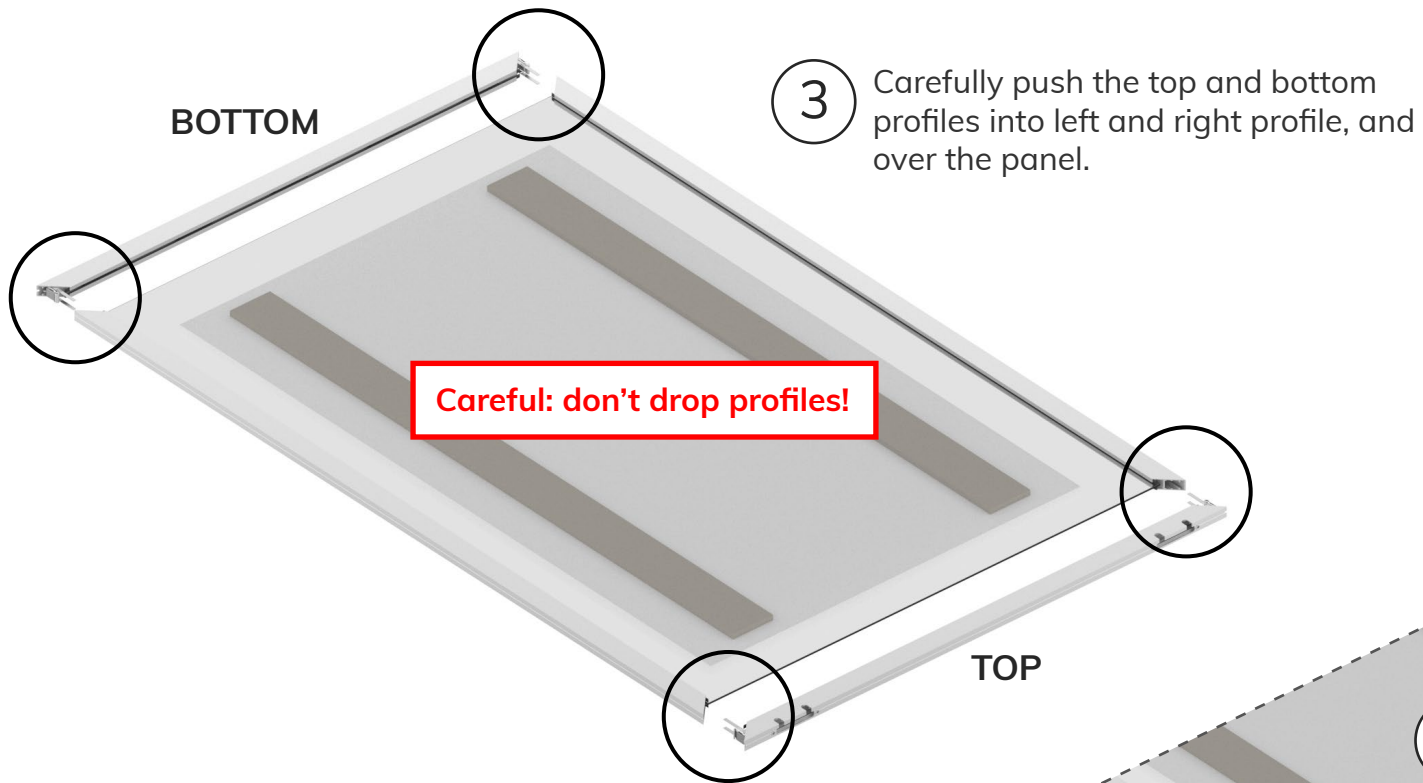

4 Push in the excess GLR68 into the profiles during mounting.

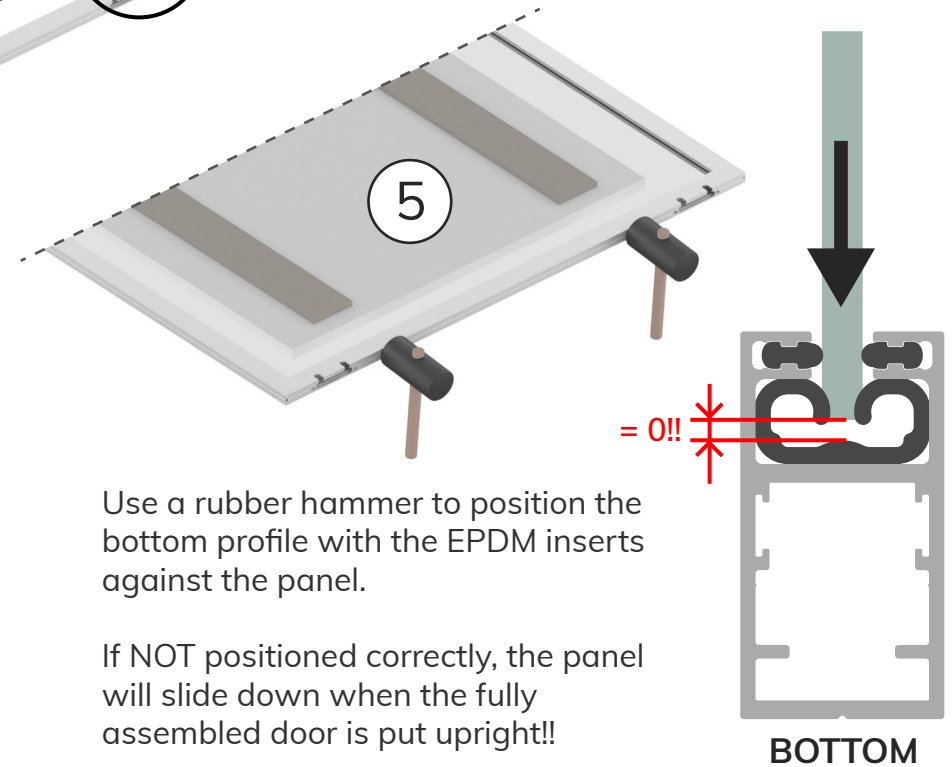
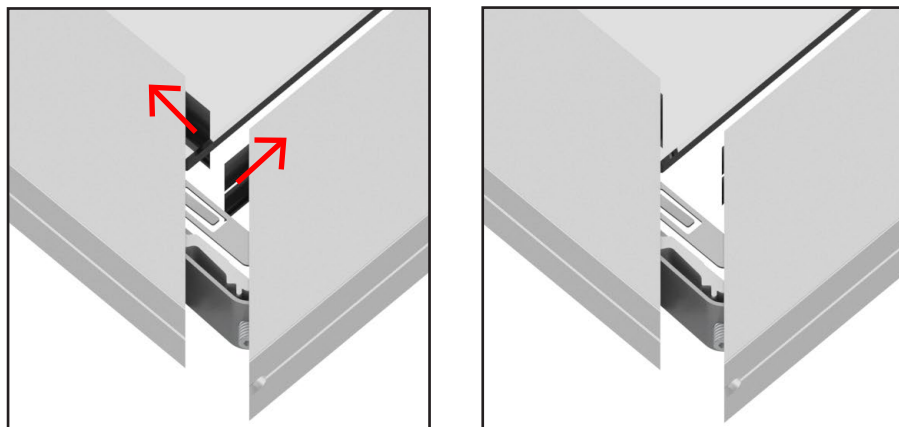

SECURE CORNER JOINTS

Align the profiles as best as possible, and carefully tighten the inbus screw **BY HAND!** **Over-tightening will damage the corner joint!**

During tightening, the space between the profiles will disappear.

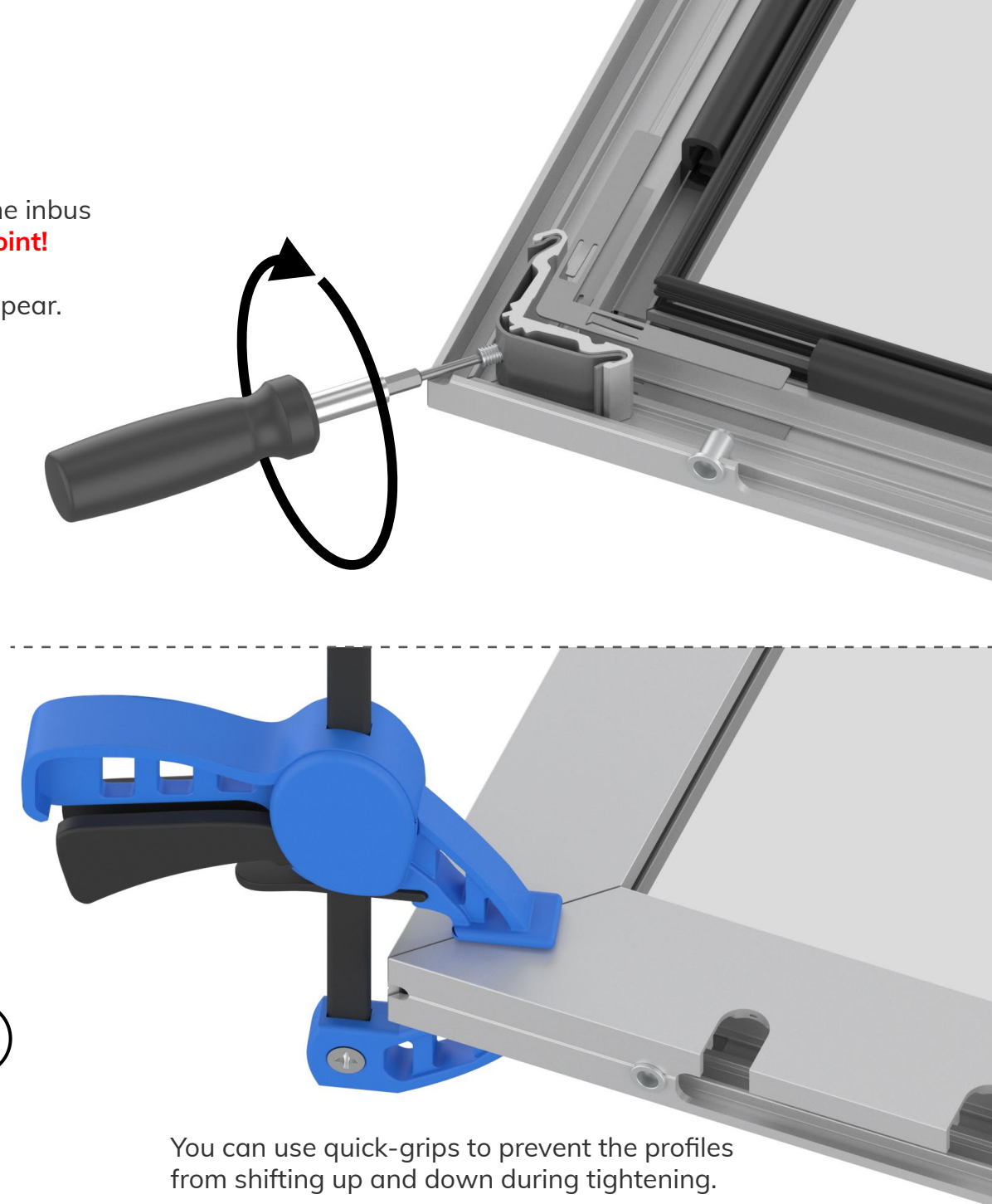
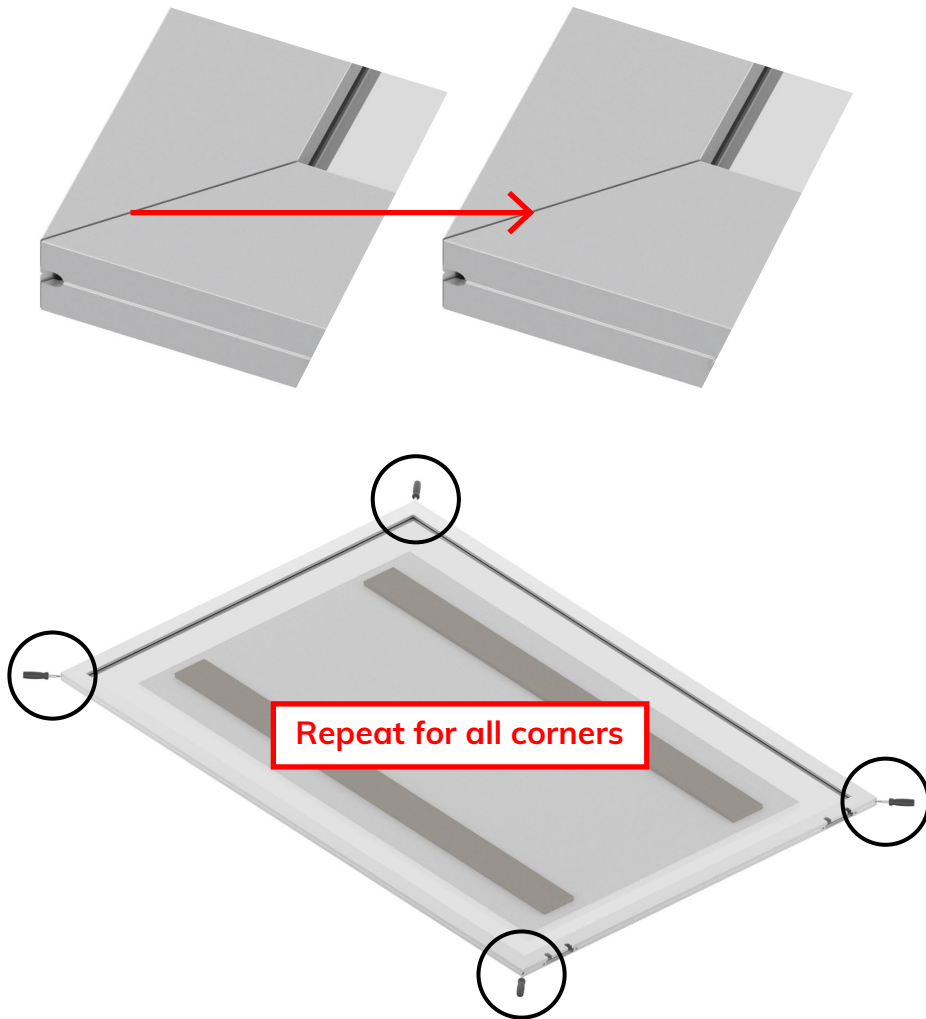

You can use quick-grips to prevent the profiles from shifting up and down during tightening.

INSTALL SAW-UMB

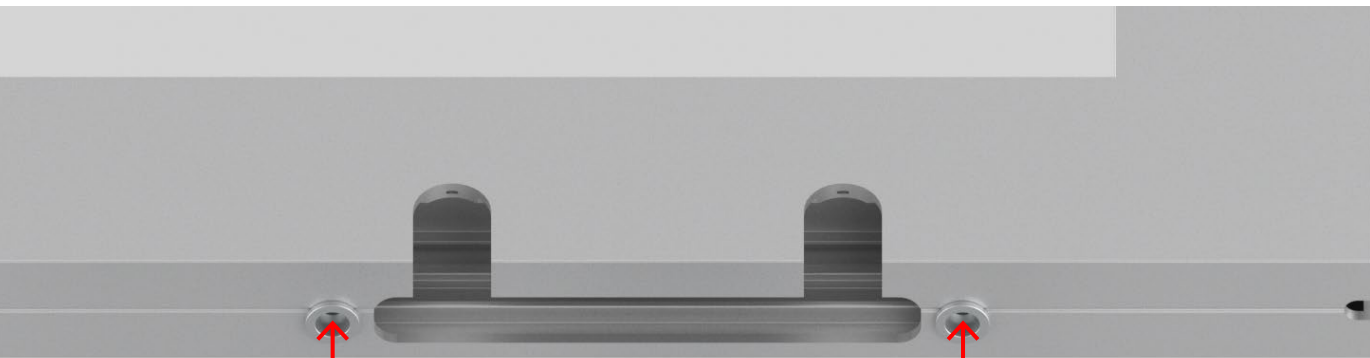
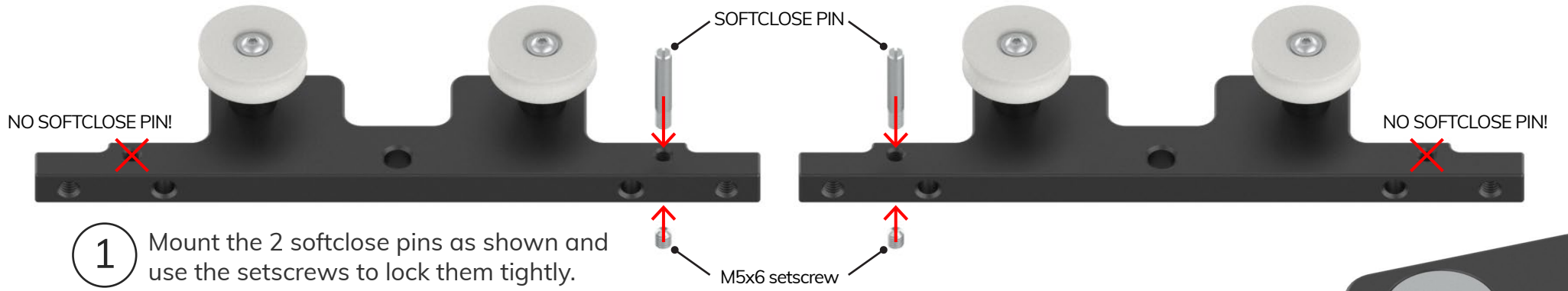

Setscrew should be flush with steel bracket!



4 Use any tool that fits in the 3 mm holes to tighten the screws

HEIGHT ADJUSTMENT

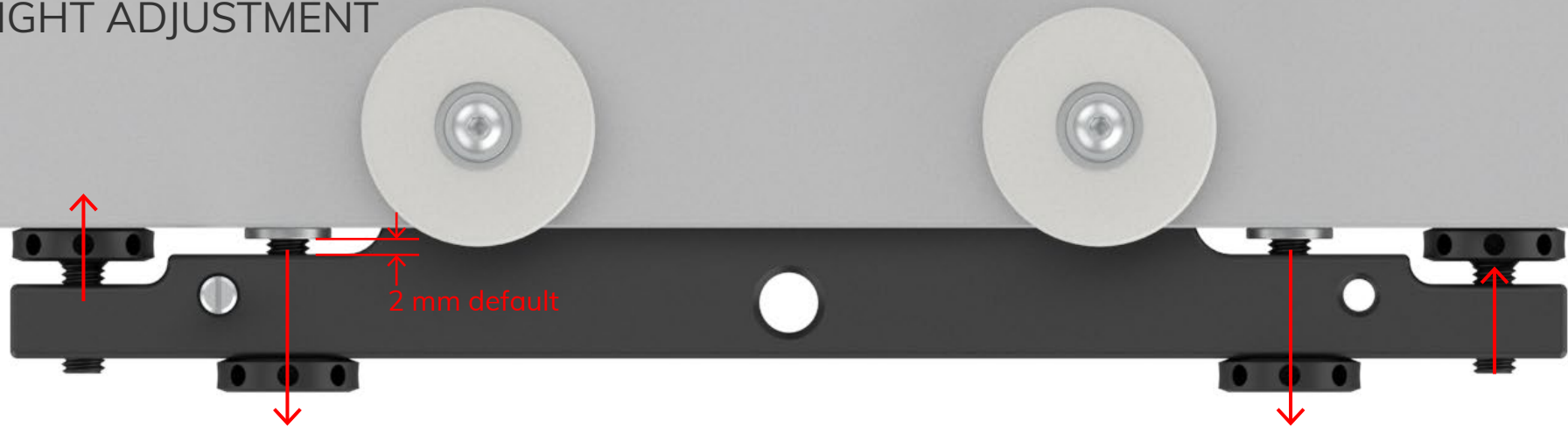

You can adjust the height of the panel in relation to the rail by using the 4 screws:

- Screw out the long screws: panel goes down
- Screw in the long & short screws: panel goes up
- Use the short screws to re-tighten the bracket against the aluminium profile.

We advise to initially install the bracket **2 mm out**. This allows for adjustments both up (2 mm) and down (3 mm) after installing the panel onto the rail.

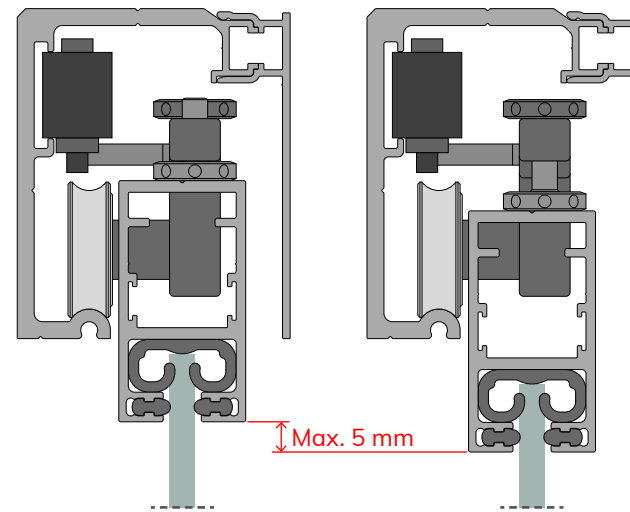

Make sure both brackets are adjusted equally.
Both soft close pins should face each other.

For further instructions on how to install the fully assembled sliding door, please refer to:

- slideways installation wall mount manual
- slideways installation ceiling mount manual