



STEALTHPIVOT

By PortaPivot

ASSEMBLY MANUAL 2038



STEALTHPIVOT NL SET

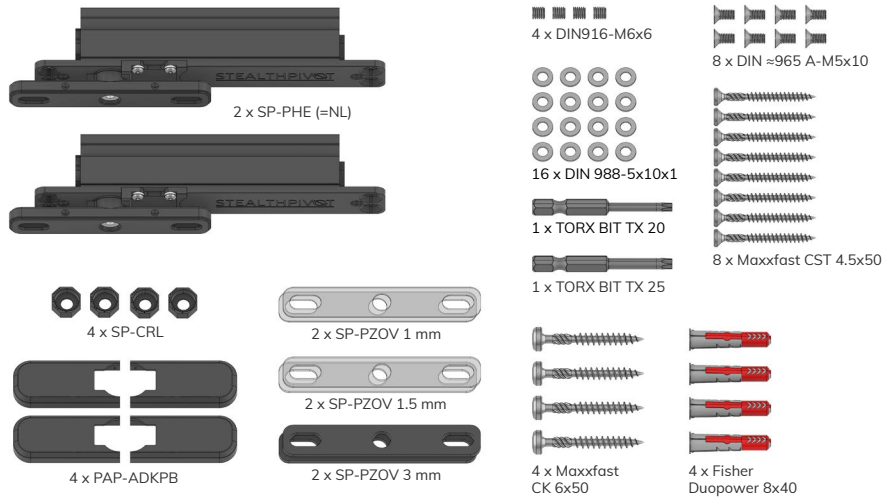

STEALTHPIVOT XL SET

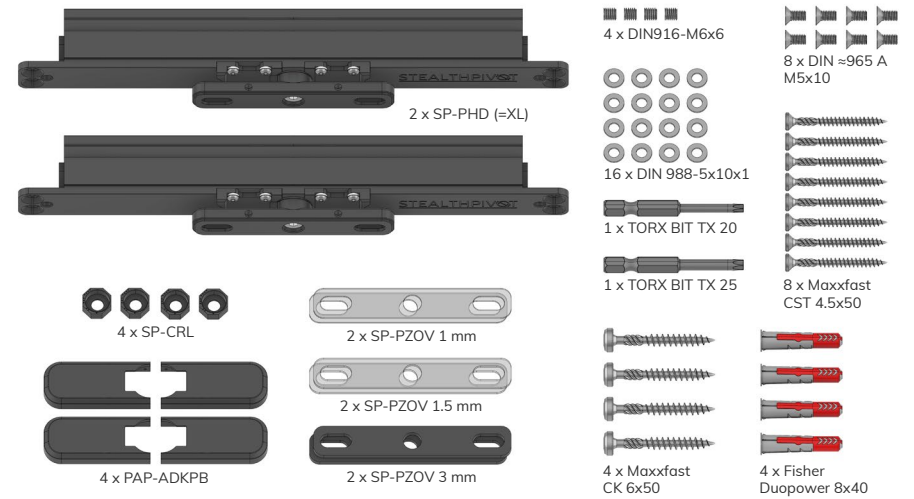

OPTIONAL STEALTHPIVOT NL ACCESSORY SET

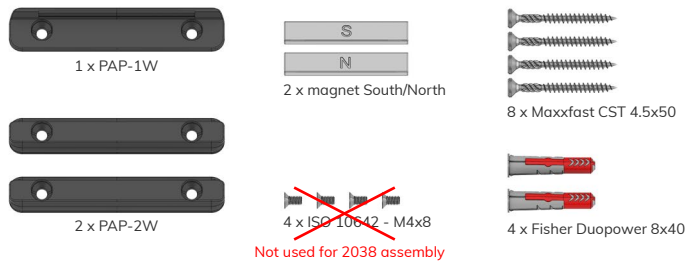

OPTIONAL STEALTHPIVOT XL ACCESSORY SET

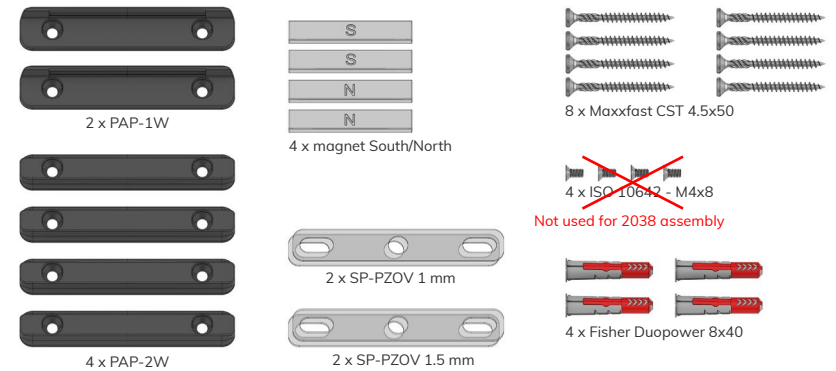

OPTIONAL STEALTHPIVOT INSTALLATION TOOL

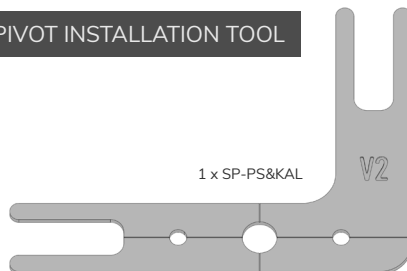

PORTAPIVOT 2038 PARTS

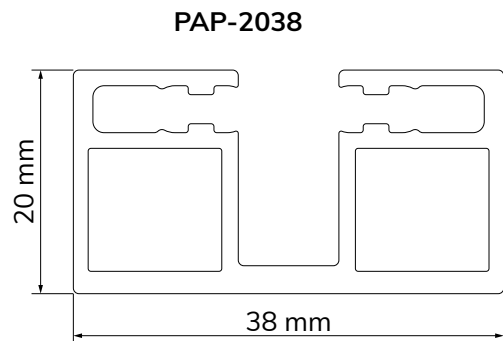

SAW CUT MARKER

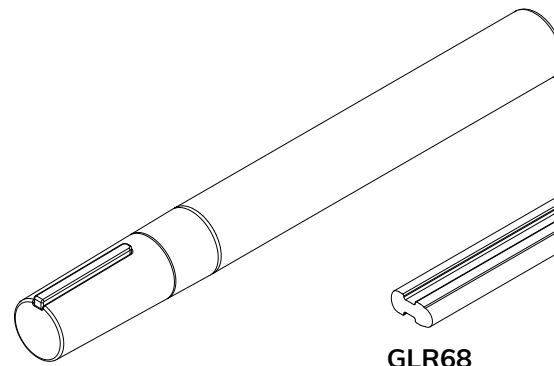

GLR68

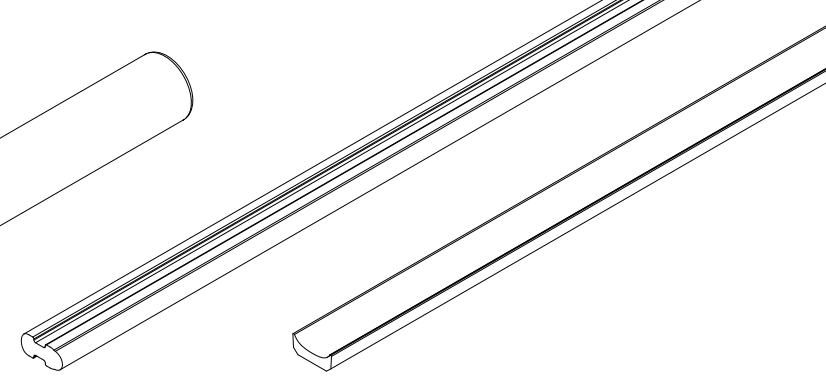

AWD-GLRMIMA

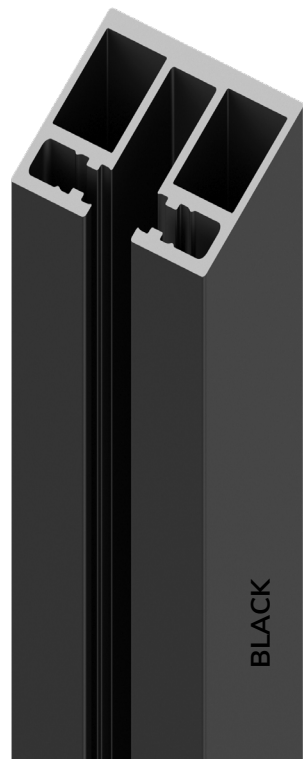

BLACK

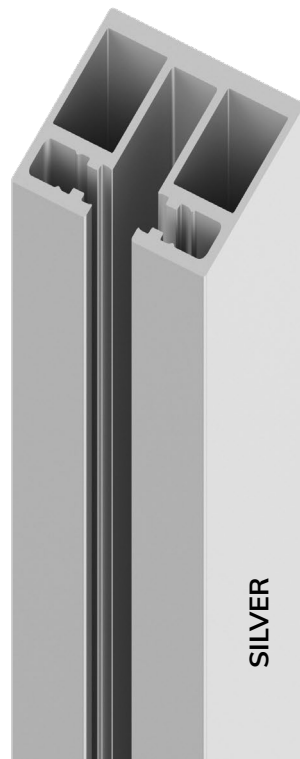

SILVER

PAP-KHP-15x9

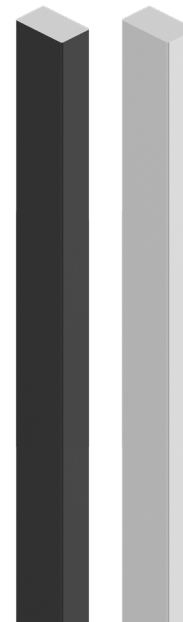

PAP-KHP-30x9

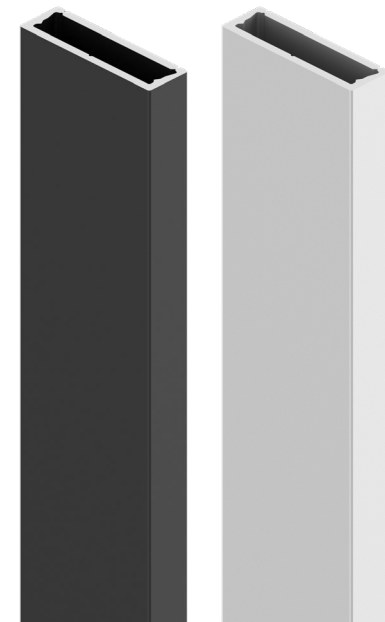

PORTAPIVOT 2038 NL PARTS

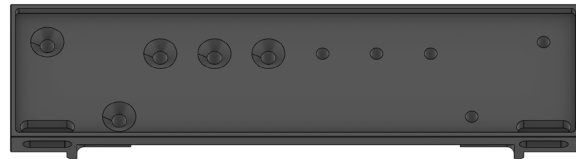
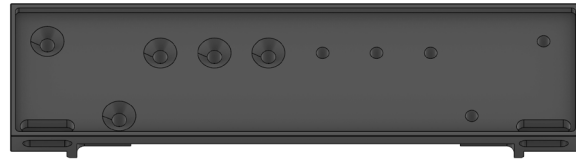
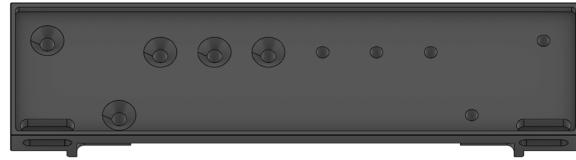
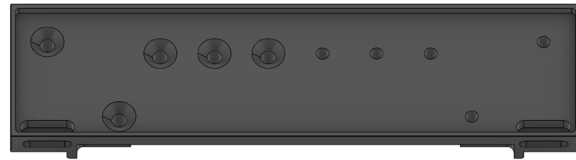

4 x GMHSE



4 x GMHSEAP



PAP-MMVS



4 x ISO 10642 - M4x6

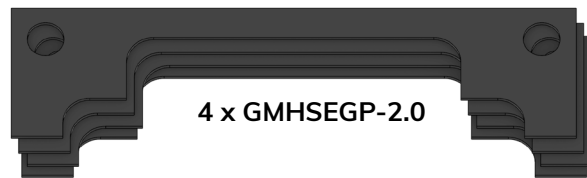

4 x GMHSEGP-2.0

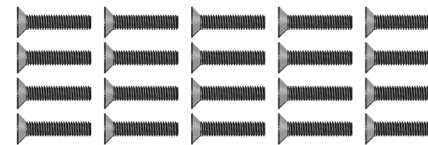

20 x DIN7991-M6x30



8 x DIN ≈965 A-M5x10

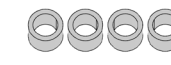

4 x PAP-GLBUS



8 x EASYCLICK



1 x PAP-MMTOOL

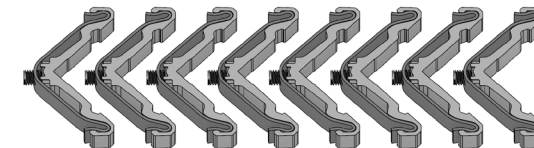

PAP-MCDS48-11,7x11x11,5



2 x PAP-GLIP

PORTAPIVOT 2038 XL PARTS

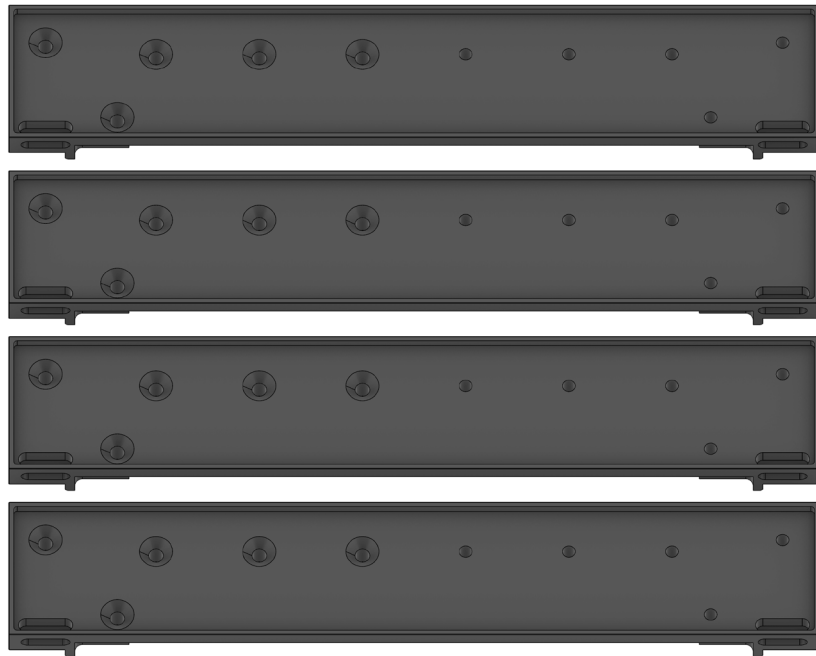

4 x GMHSD



4 x GMHSDGP-2.0

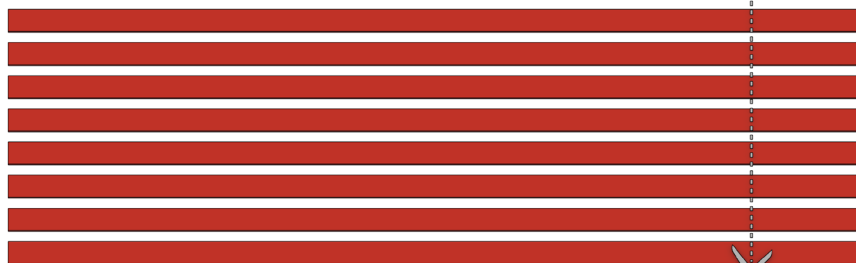

8 x EASYCLICK

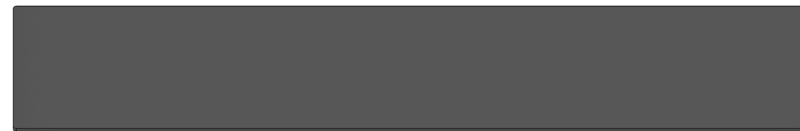
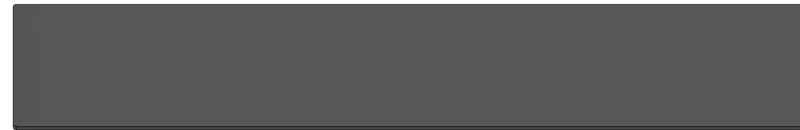

4 x GMHSDAP

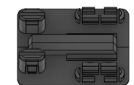
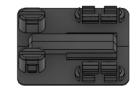
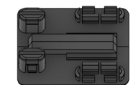
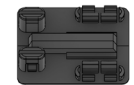

PAP-MMVS

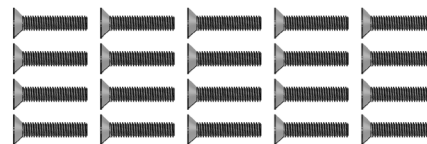

20 x DIN7991-M6x30



8 x DIN ≈965 A-M5x10



4 x PAP-GLBUS



4 x ISO 10642 - M4x6



1 x PAP-MMTOOL

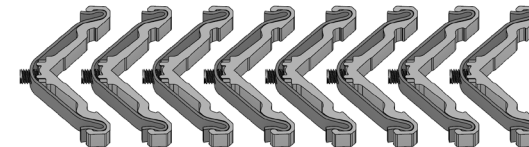

2 x PAP-GLIP

PORTAPIVOT 2038 XL EXAMPLE KIT OVERVIEW

The aluminium profiles are delivered in a firm cardboard tube which protects the profiles during transport and remains stackable. All assembly accessories, pivot hinges and door grips are delivered in a separate cardboard box.

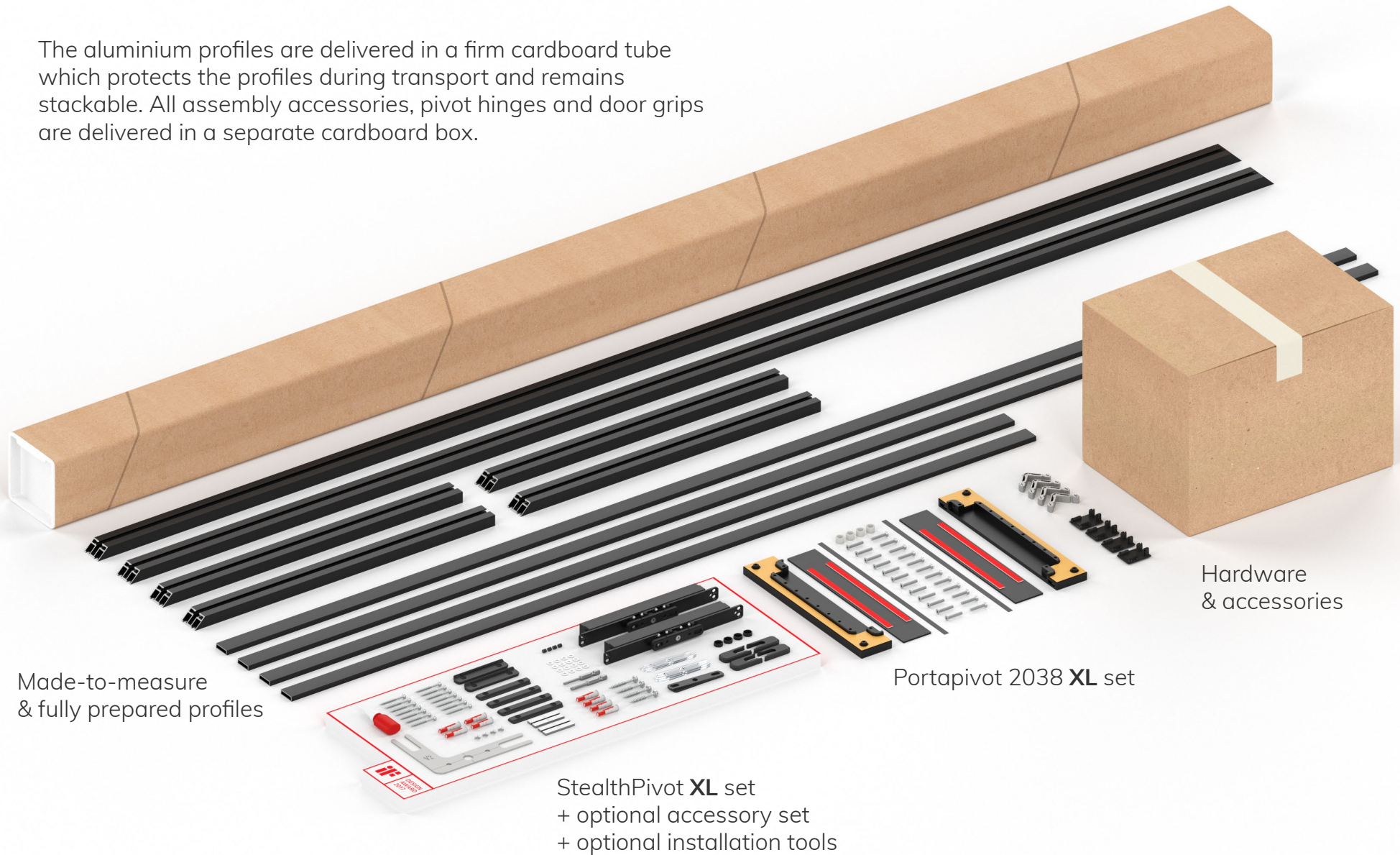

Made-to-measure
& fully prepared profiles

StealthPivot **XL** set
+ optional accessory set
+ optional installation tools

Portapivot 2038 **XL** set

Hardware
& accessories

LOCALLY SOURCED MATERIALS

- ▶ 8 mm tempered glass
- ▶ Isopropyl alcohol (cleaning alcohol)
- ▶ Silicone spray
- ▶ Isopropyl alcohol (cleaning alcohol)
- ▶ Acetone
- ▶ Loctite

RECOMMENDED TOOLS

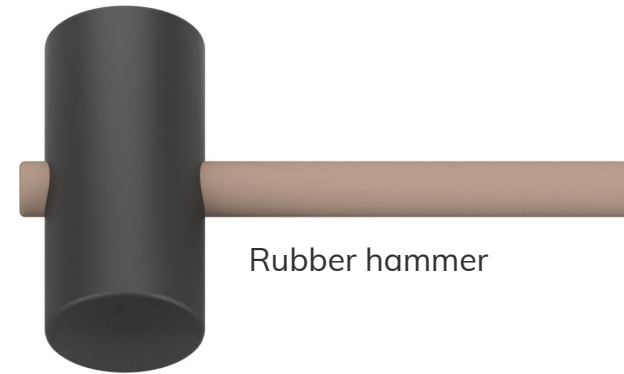

Rubber hammer



Bit screwdriver



QuickGrip

PORTAPIVOT 2038 **NL** PANEL DIMENSIONS (MM)

Door width < 1250 mm

Glass thickness = 8 mm

Top & bottom cavities are identical

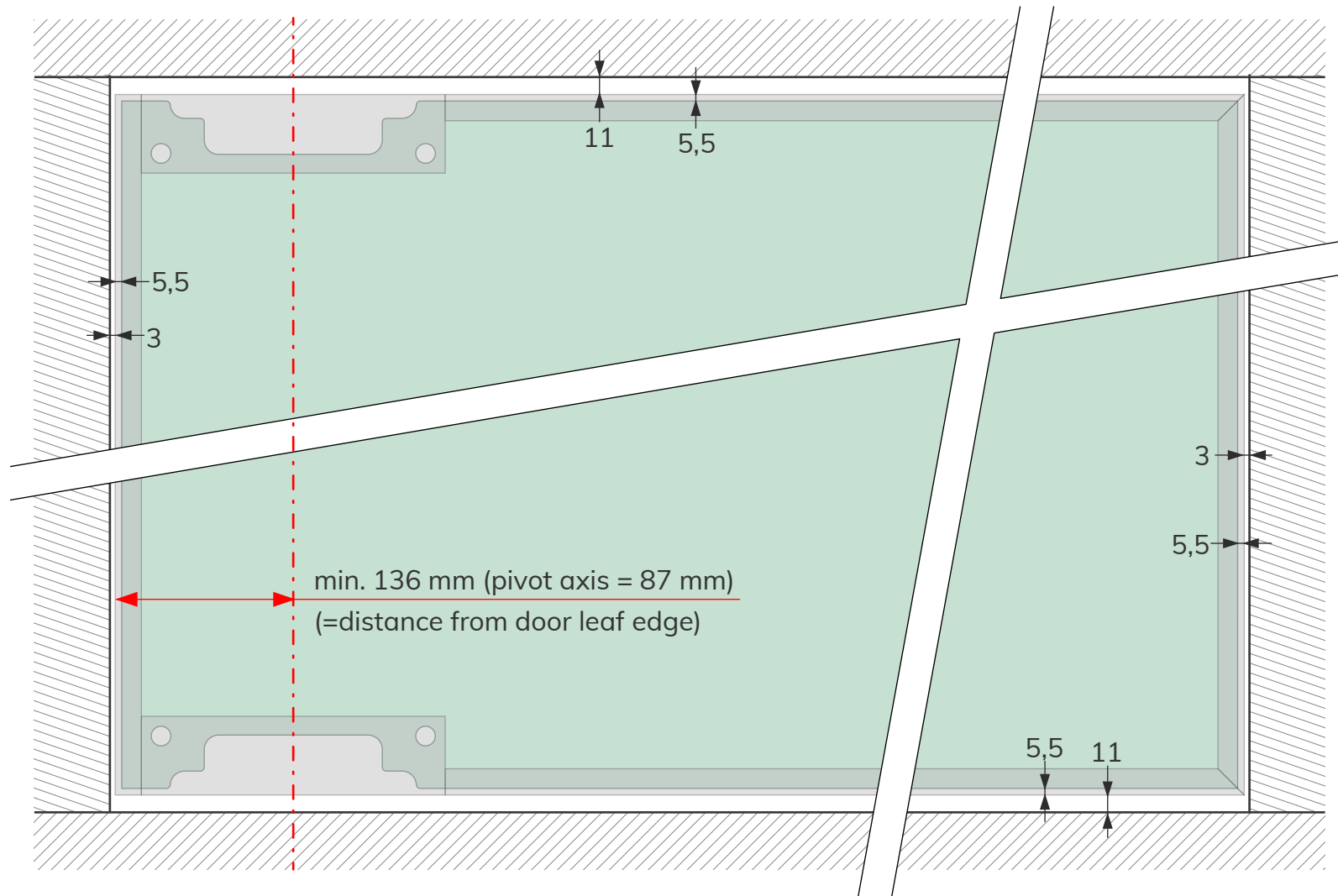

PORTAPIVOT 2038 **NL** CAVITY DIMENSIONS (MM)

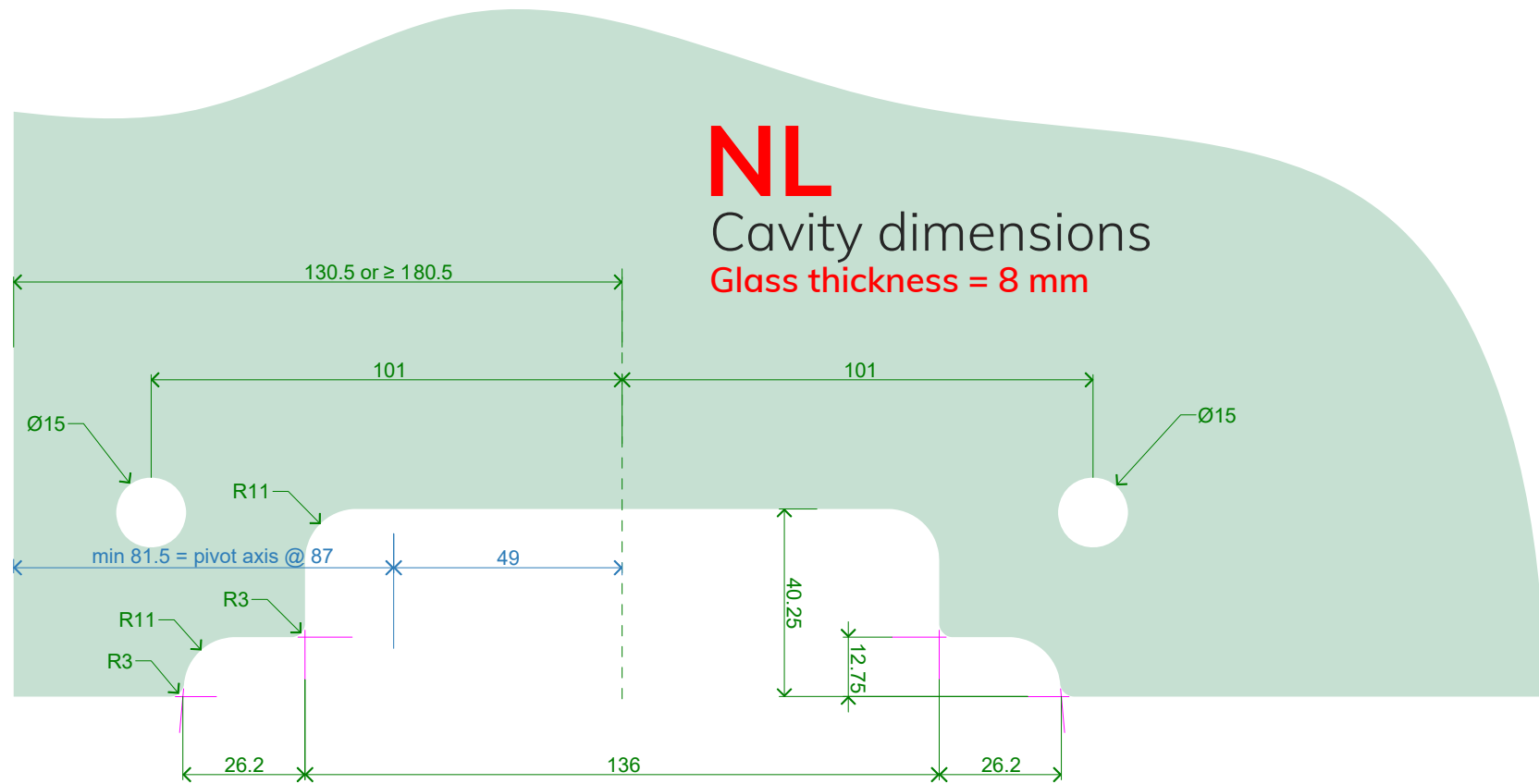

PORTAPIVOT 2038 XL PANEL DIMENSIONS (MM)

Door width > 1250 mm

Glass thickness = 8 mm

Top & bottom cavities are identical

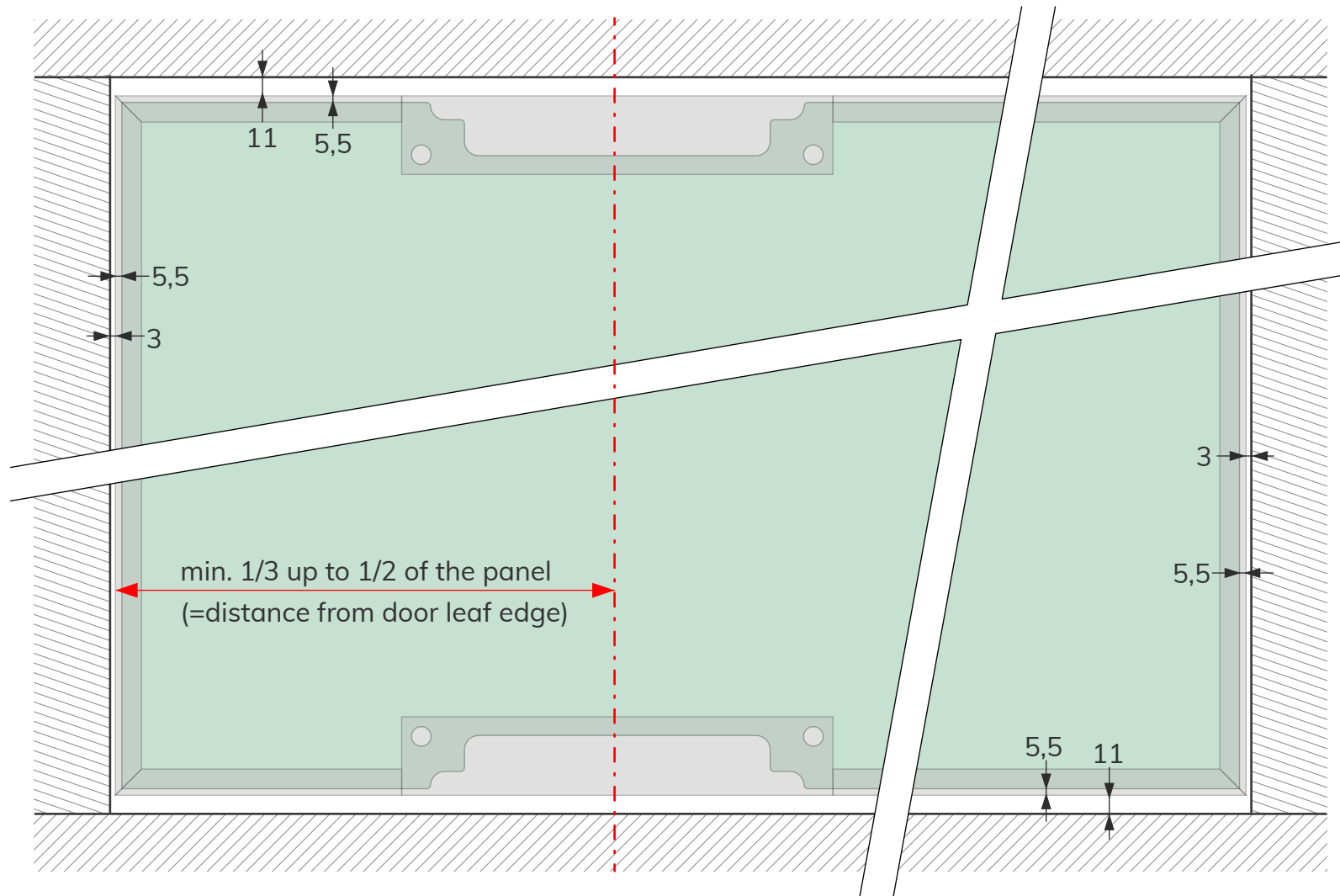

PORTAPIVOT 2038 XL CAVITY DIMENSIONS (MM)



XL
Cavity dimensions
Glass thickness = 8 mm

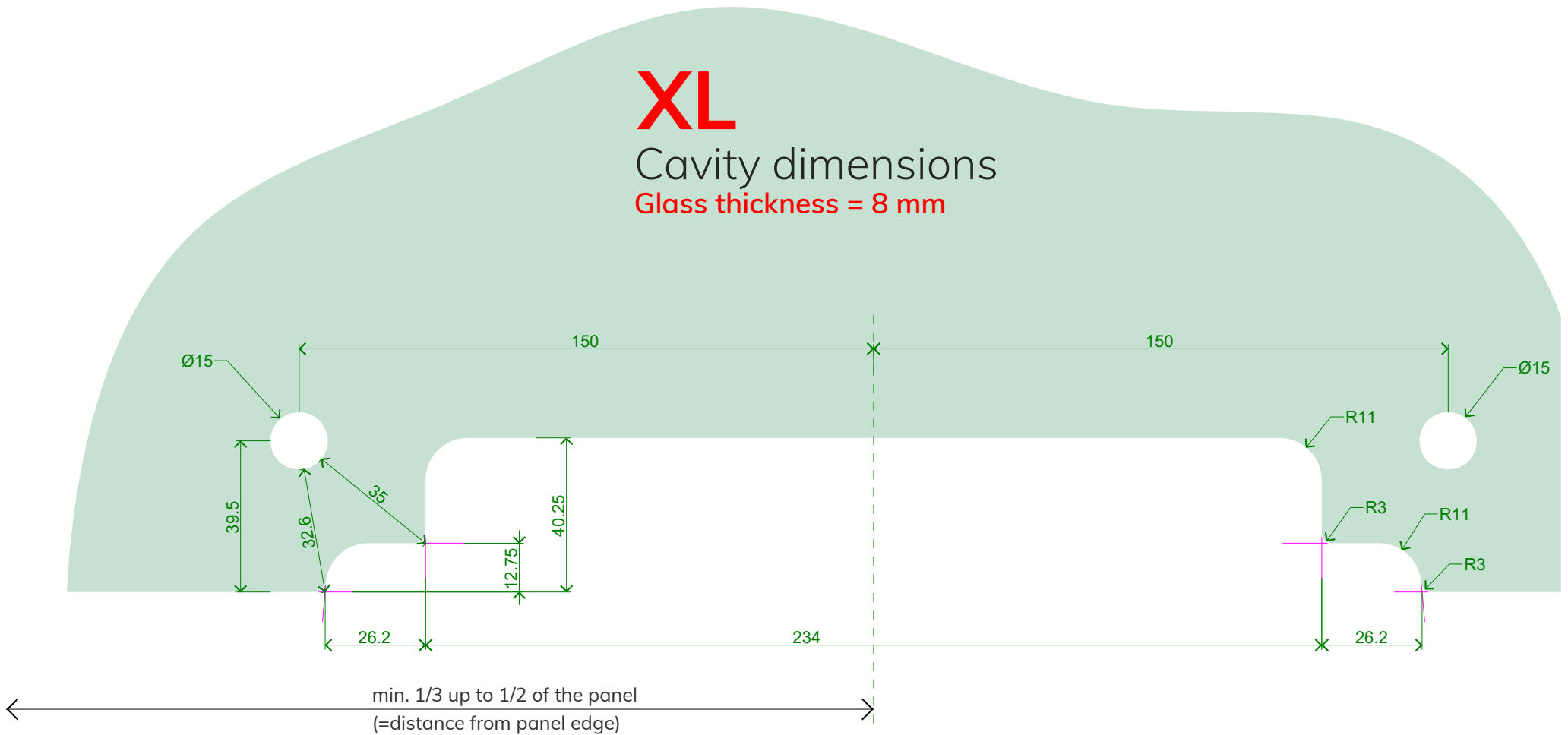

INSTALL ALUMINIUM CLAMPS

① Degrease the application zone first with isopropyl alcohol.

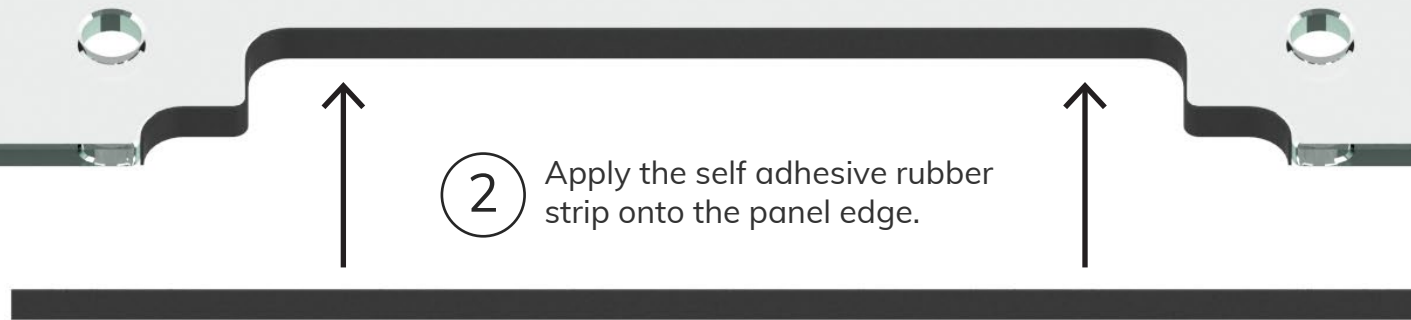

③ Remove the backing strip from the first aluminium glass clamp.



- 4 Carefully bring the clamp in place and press it against the glass.



- 5 Make sure everything is perfectly aligned.

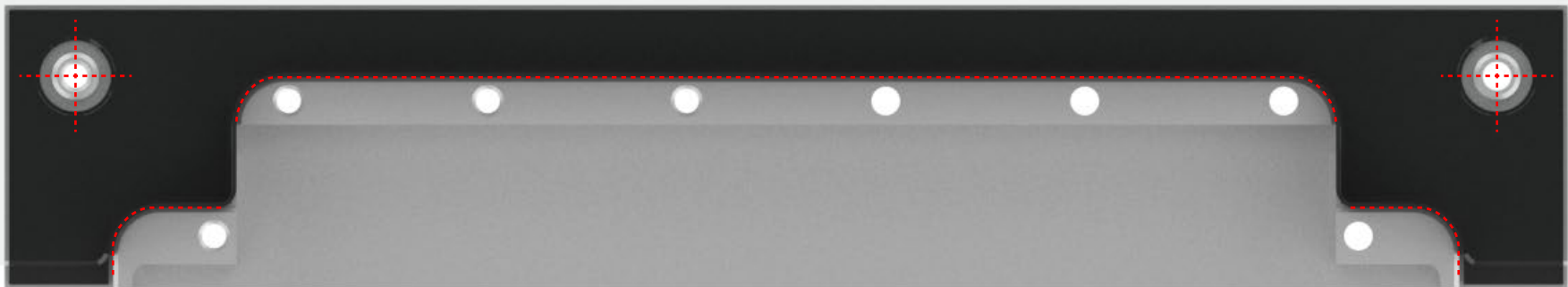

6 Insert the nylon distance spacers (PAP-GLBUS).



7 Carefully place the second clamp on top.



7 Insert and tighten all screws in a left to right alternating pattern.

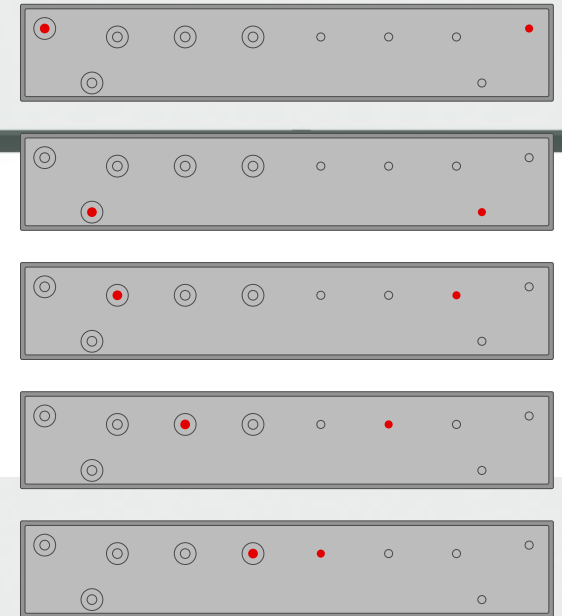
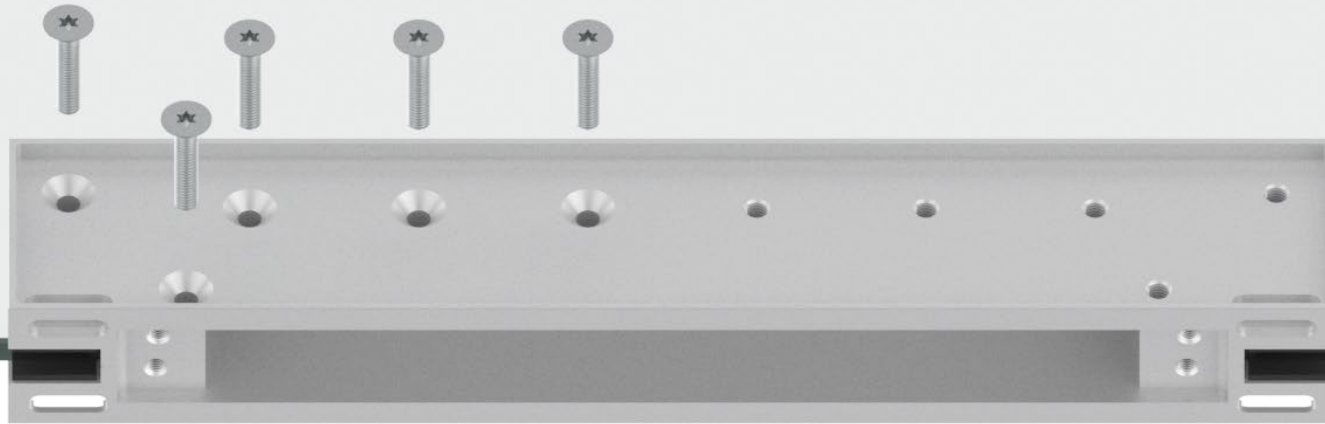

MOUNT HINGE

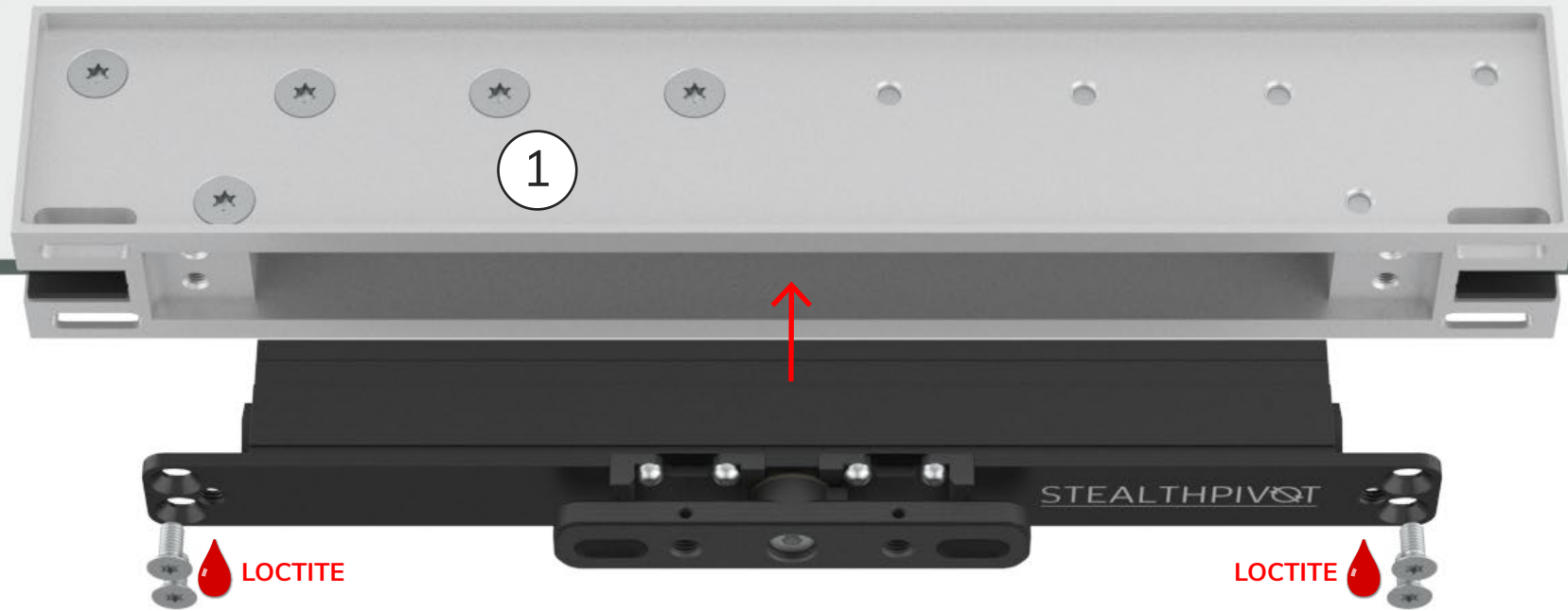

SYNCHRONIZE PIVOT AXIS HEIGHT IN DOORWAY

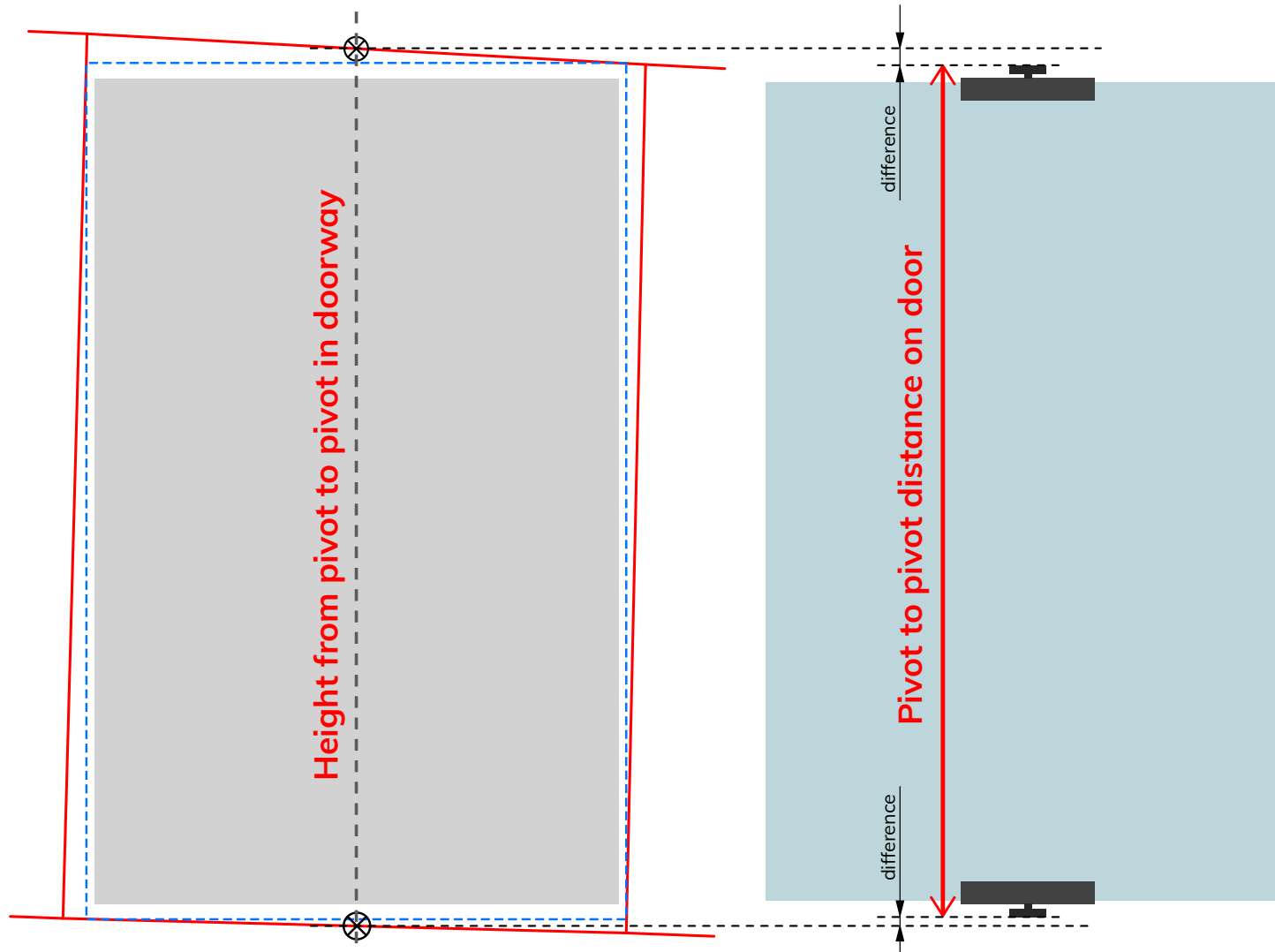

Compare the pivot to pivot distance of the door with the measured doorway height at the axis point.

Synchronize them if necessary, using a method described on the next page.

ADJUST HINGE HEIGHT / JOINT DIMENSIONS

To increase the joint dimensions, there are 3 methods:



1. Use supplied shims between hinge and door leaf. This is the preferred method for the bottom hinge.

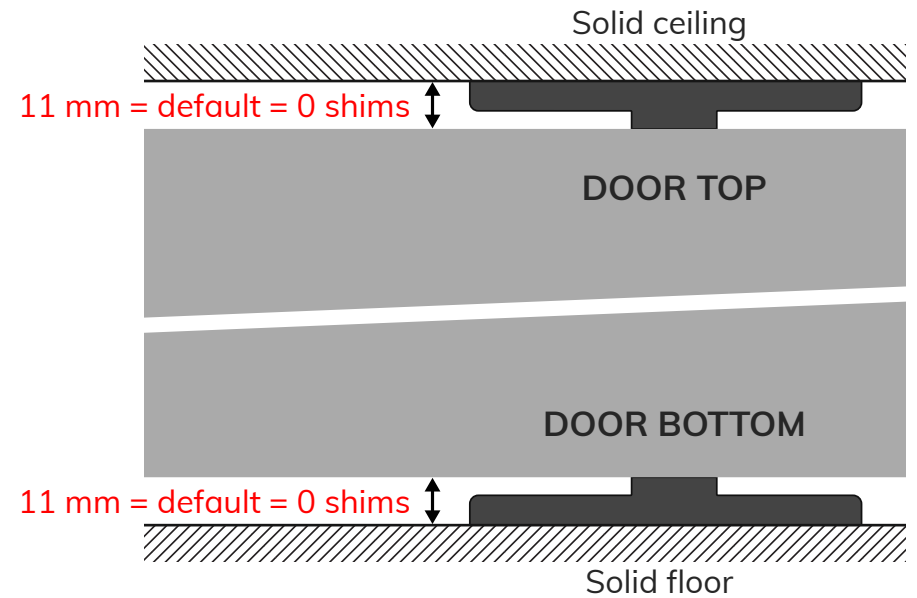

2. Use supplied shims between hinge and floor/ceiling (= less stable).



3. Adjust the inbus screws to move the hinge further away from the door leaf (loosen 4 hinge screws first).

CHECK PIVOT TO PIVOT DISTANCE

Double check the pivot to pivot distance of the door with the measured doorway height at the axis point.

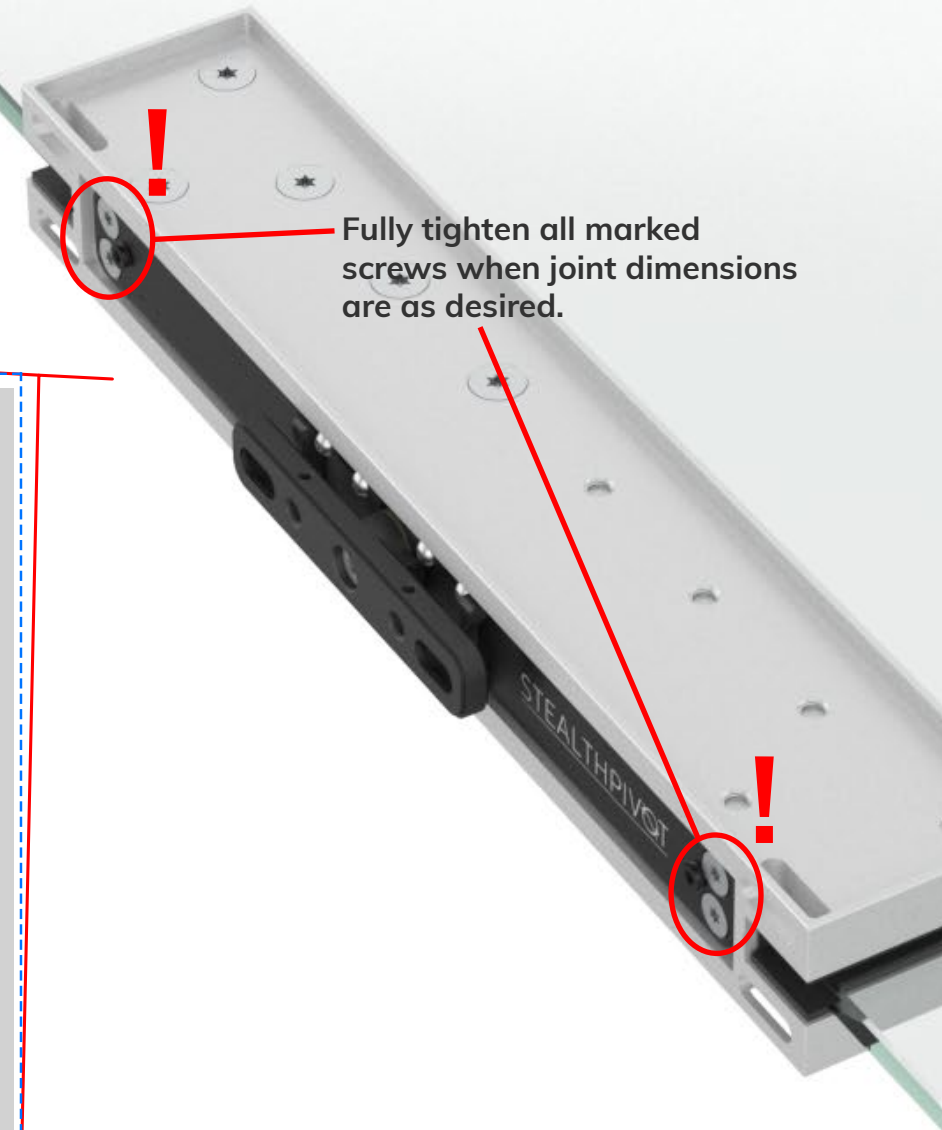
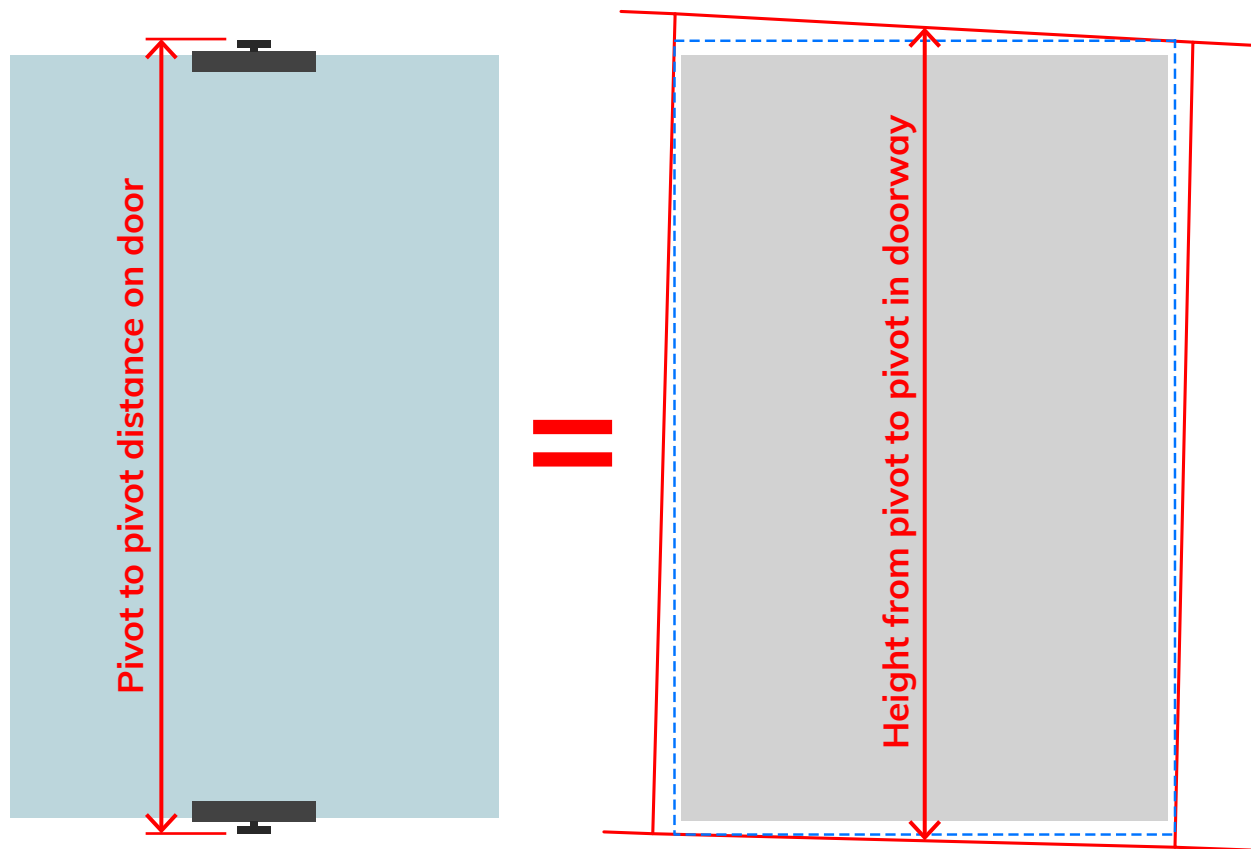



Remove the backing from the Easyclick strips and press the cover plates in place.



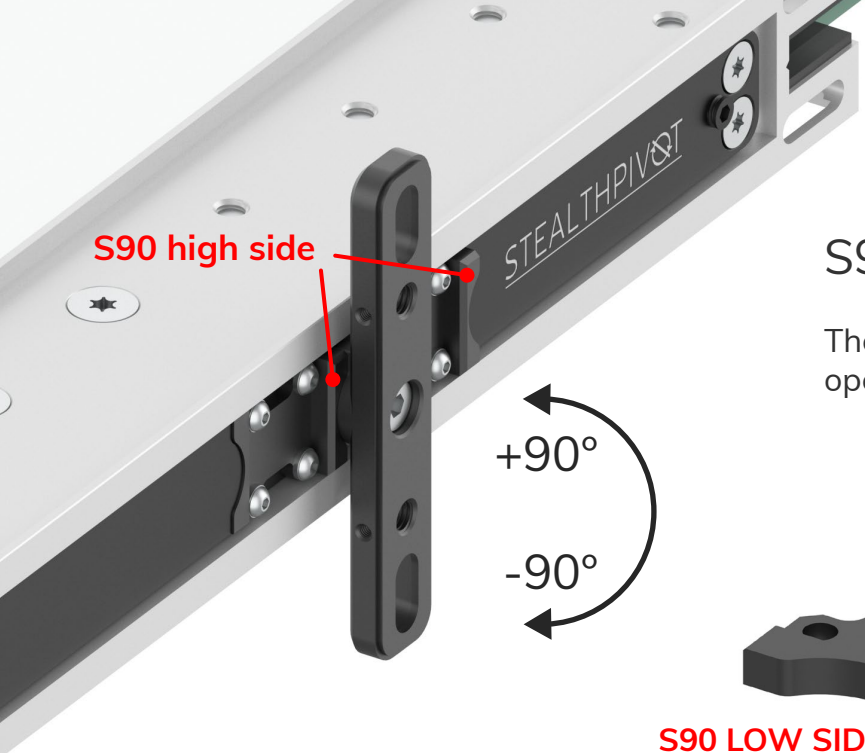

S90 - 90° LOCK

The S90* will stop the door in open position at +/-90°.

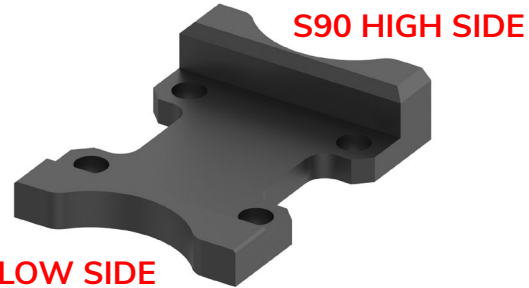
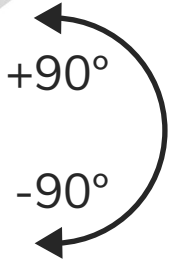

Make sure the S90* high sides are positioned identical for top and bottom hinges!

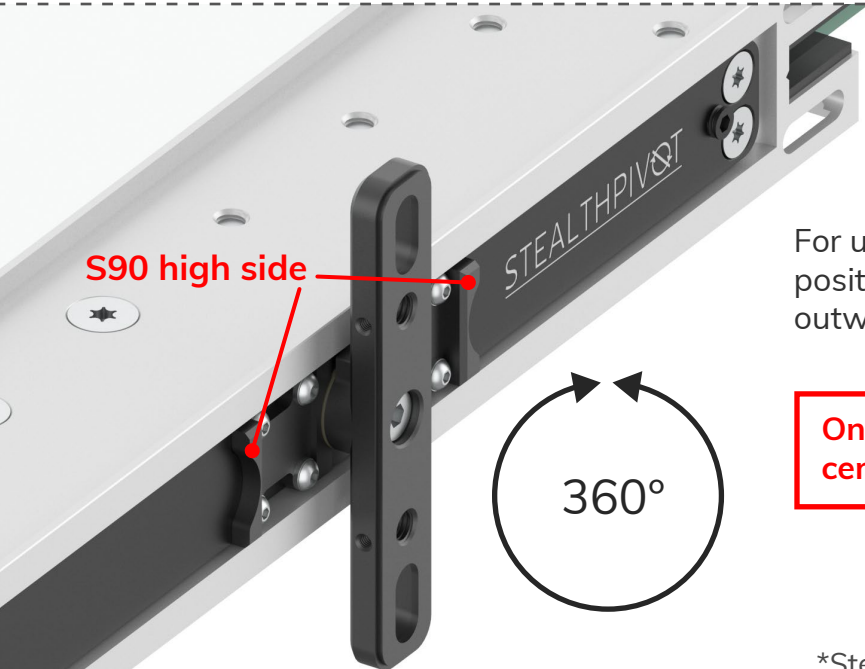
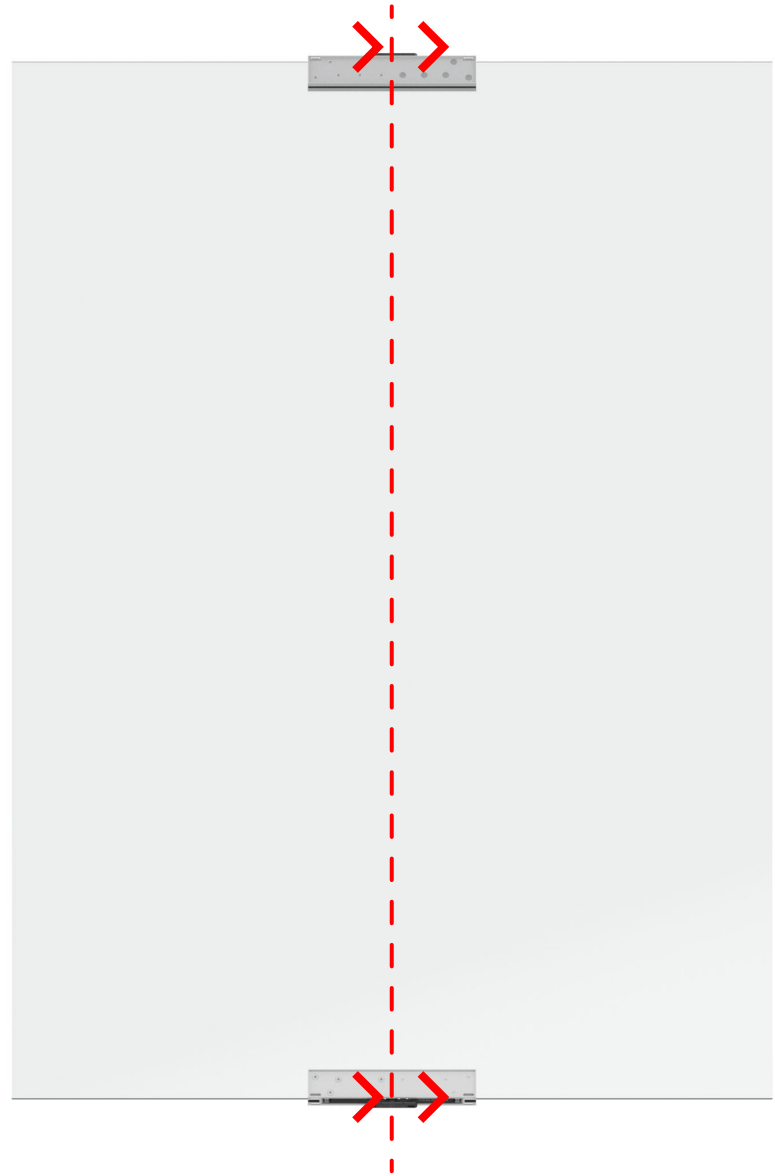

For unlimited 360° rotation, position all the S90* high sides outwards.



Only advised for central pivot axis

*StealthPivot NL has only one S90 per hinge

COLOR SAW CUTS

Degrease* the saw cuts and use the supplied marker to paint the cuts.

*Isopropyl alcohol

Remove excessive paint from
visual sides with acetone or alike

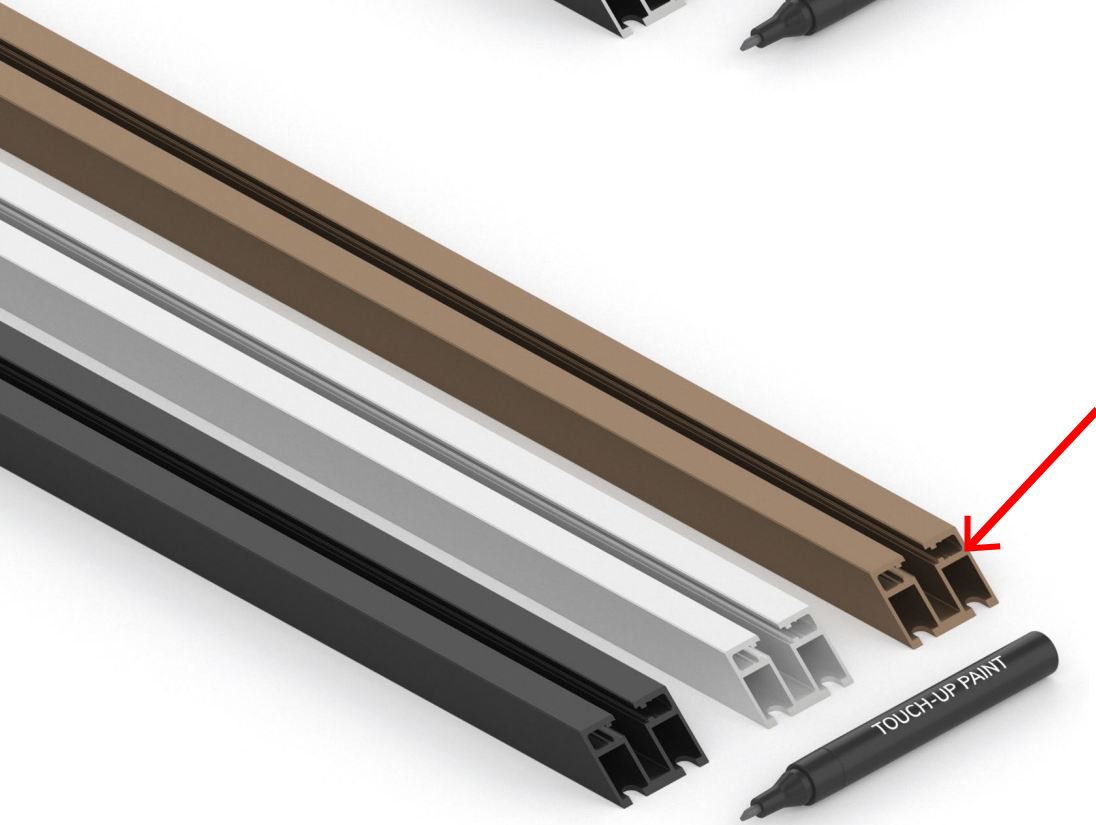

INSERT EPDM GLRMIMA

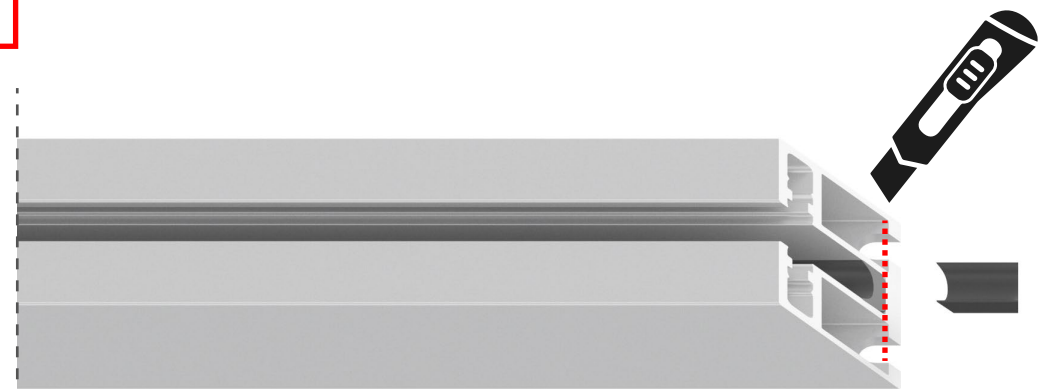
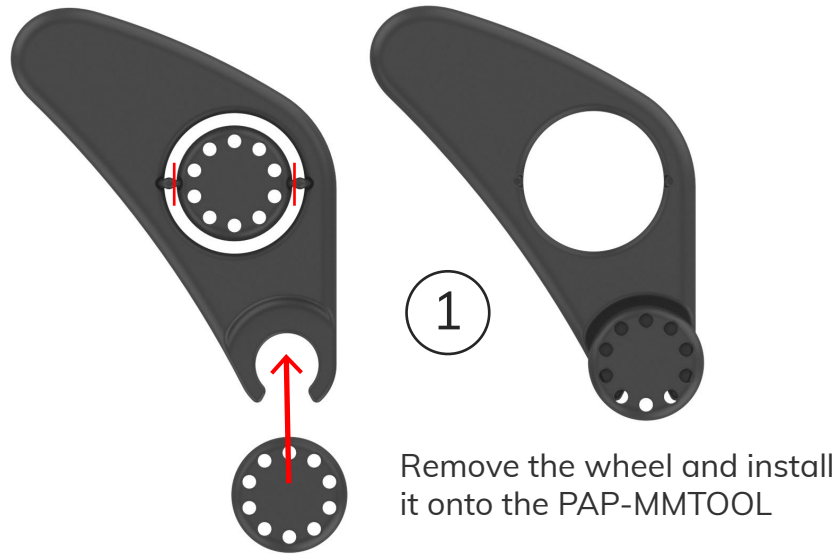

INSERT GLR68 RUBBER EXTRUSIONS

The GLR68 rubber can be used for 6 or 8 mm glass because of its excentric profile shape. However the minimax door always uses 8 mm tempered glass, so you must insert the GLR68 as shown.

GLR68 profile shape:

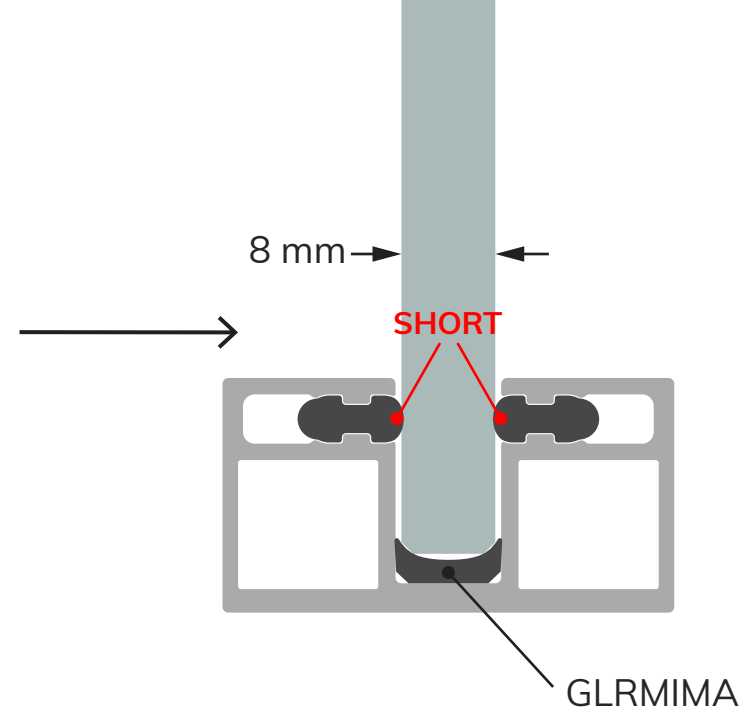
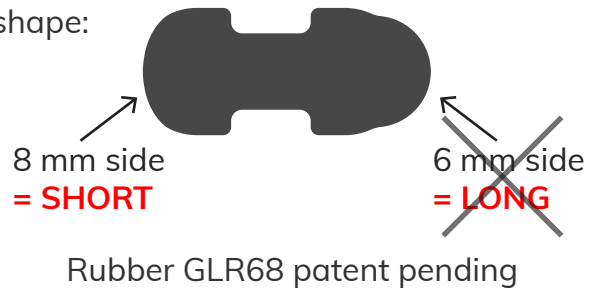

- 1 Cut off a strip from the start of the GLR68. For 8 mm glass, cut off the **LONG** side.

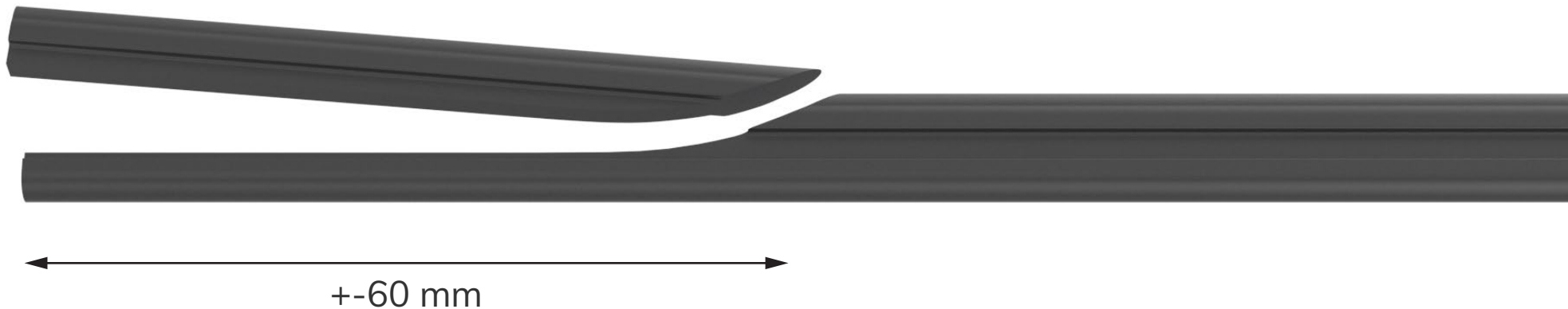

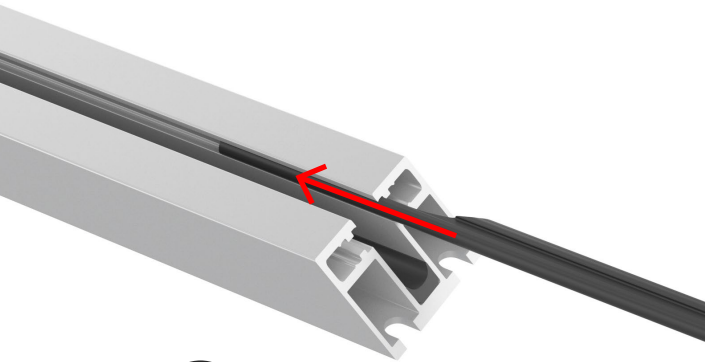

2

Guide the GLR68 through the canal, with the thin side towards the center of the profile.

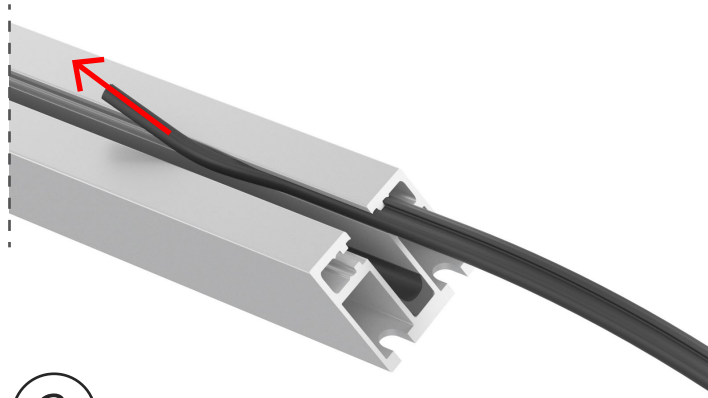

3

Pull the thin side out, and use this to pull the GLR68 through the aluminium profile.

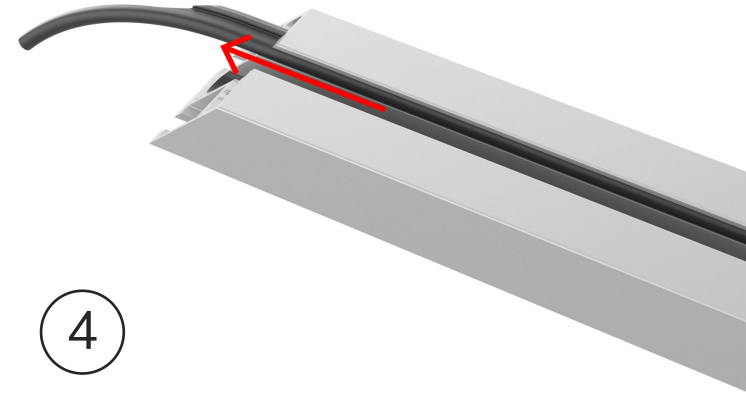

4

Pull all the way through, leaving a bit extra hanging out.

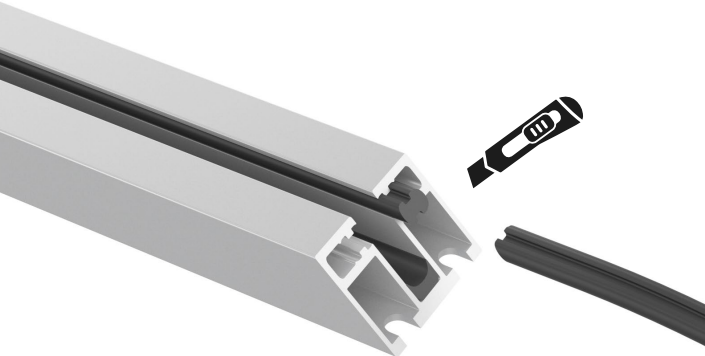

5

Cut this end at a 45° angle.

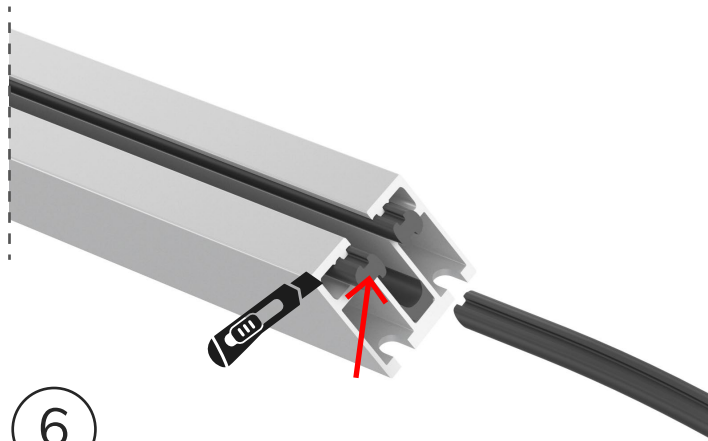

6

Repeat steps 1-5 for the second GLR68

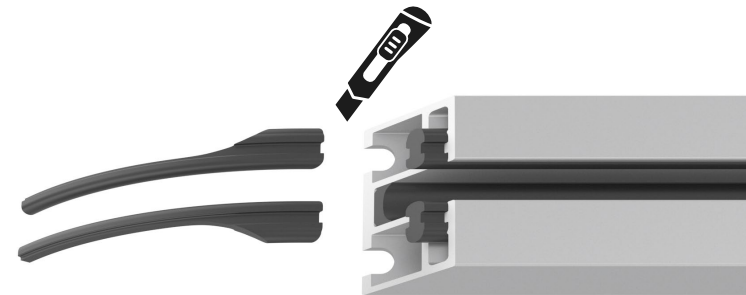

7

Cut off both remaining ends at the other side.

Apply steps 1-7 to each profile

INSERT CORNER JOINTS

Depending on the door configuration (see visuals below), 2 or 4 corners need to be prepared with corner joints.

Insert the corner joints in the vertical profiles colored red in visual.

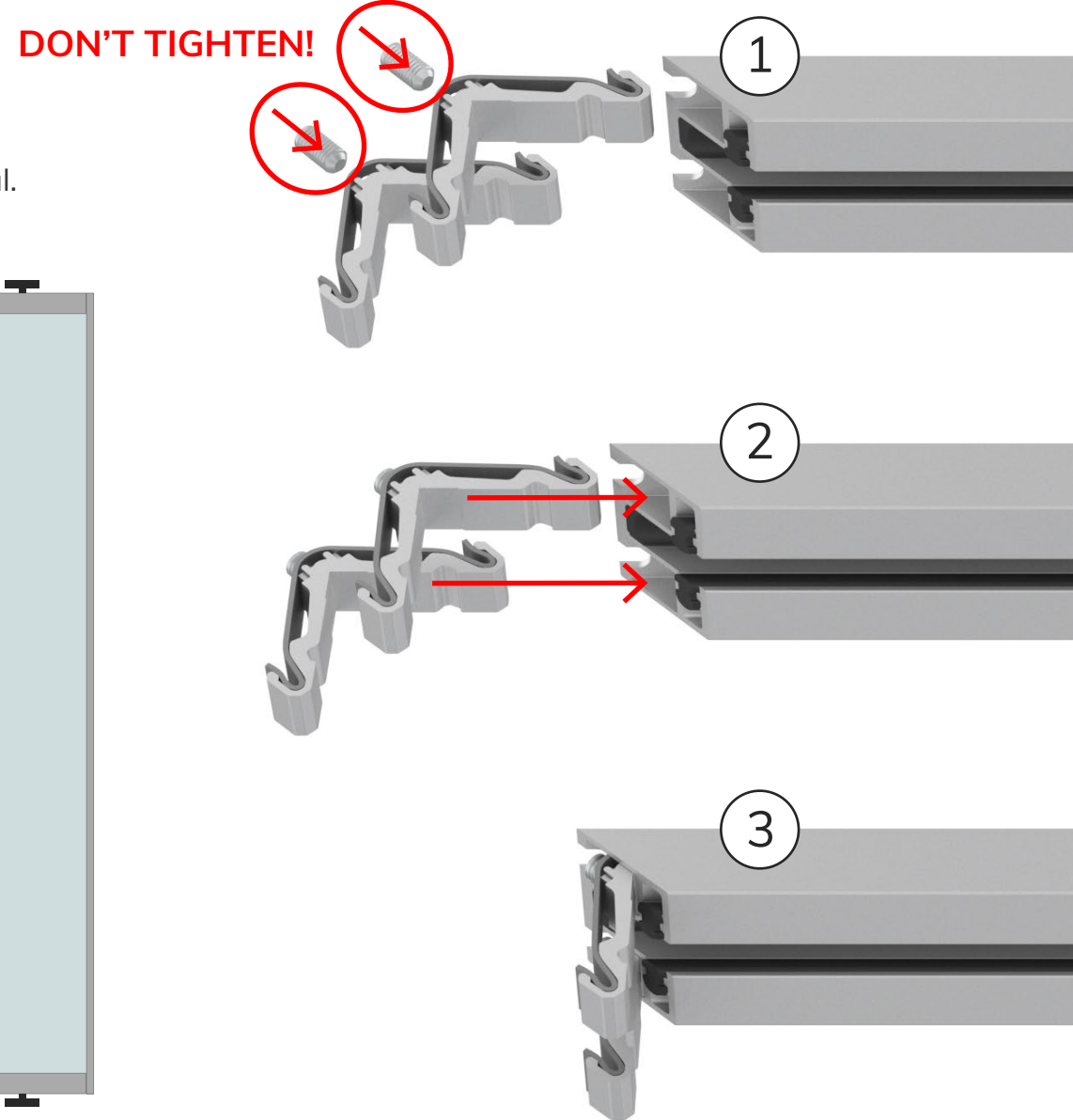
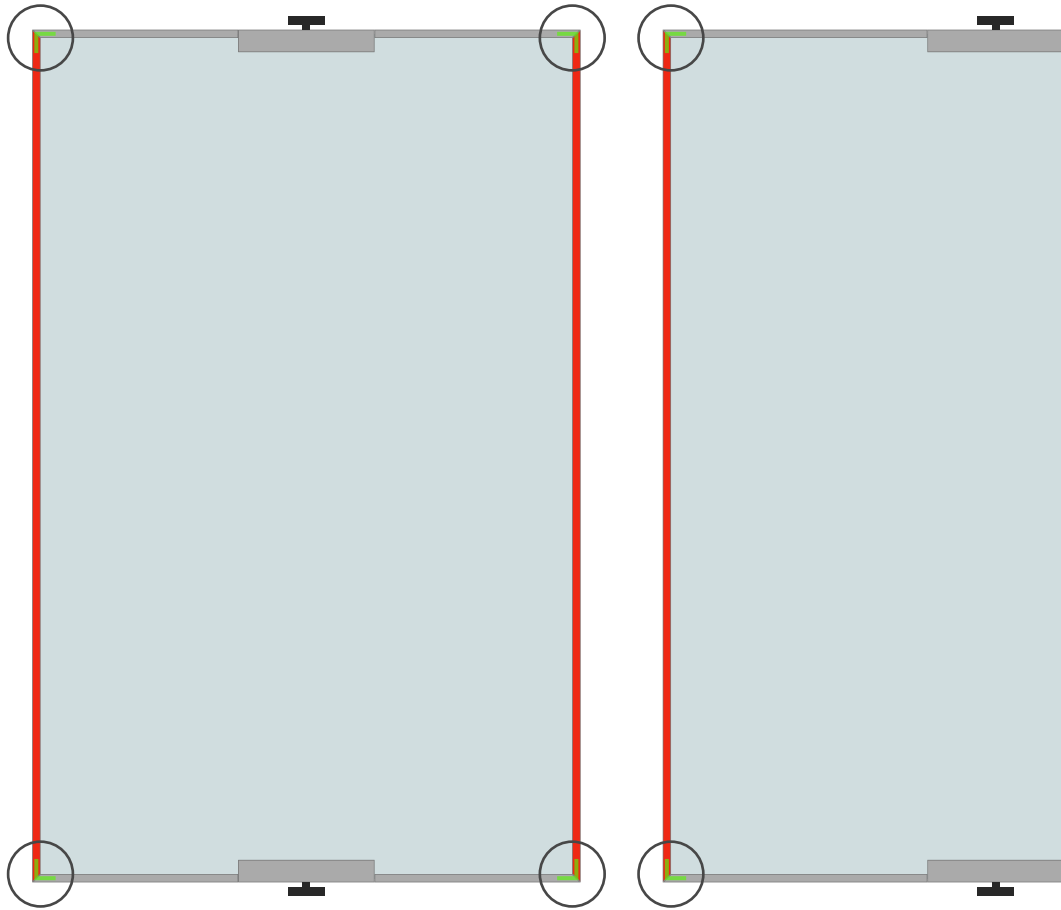

MOUNT PROFILES ON GLASS

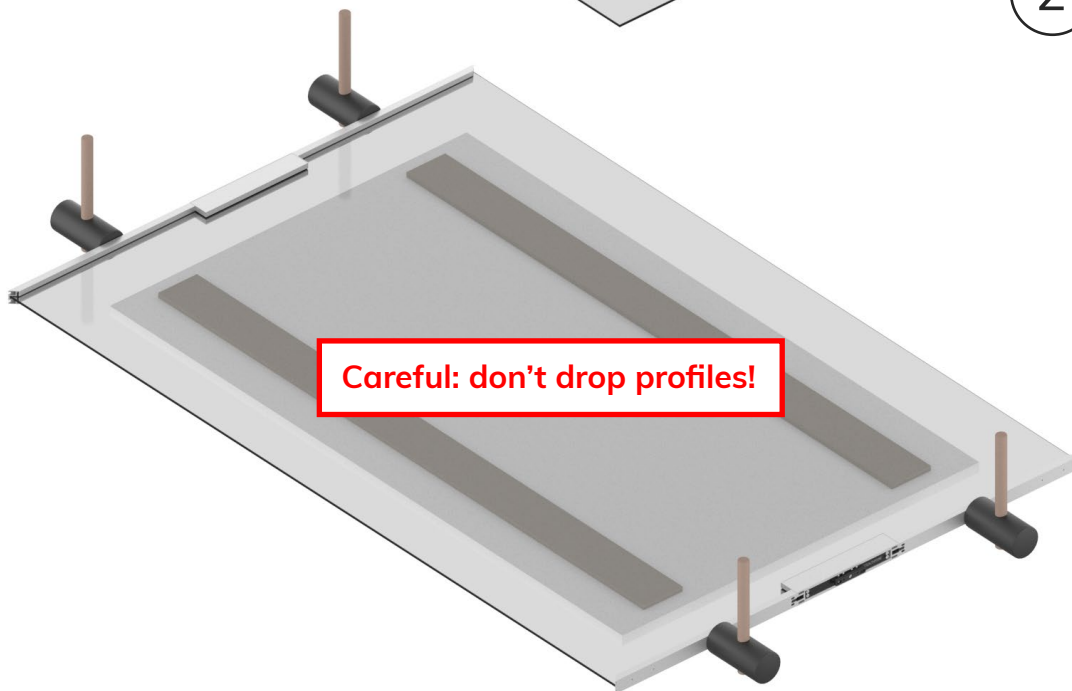
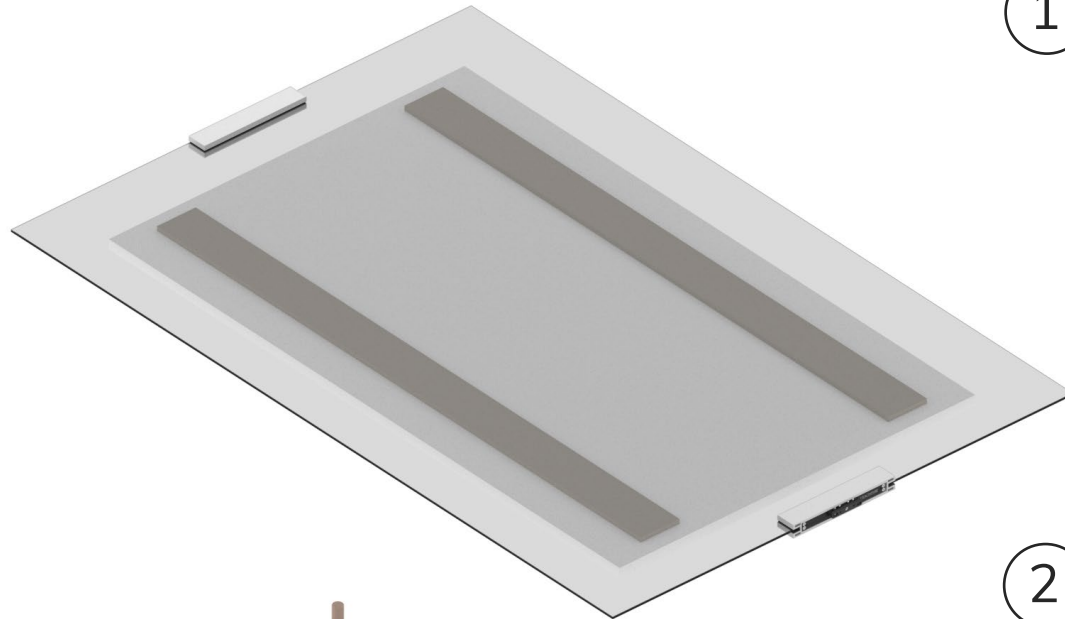

- 1 Use 2 wooden spacers (+-15 mm thick) on an assembly table and place the locally purchased panel on top.

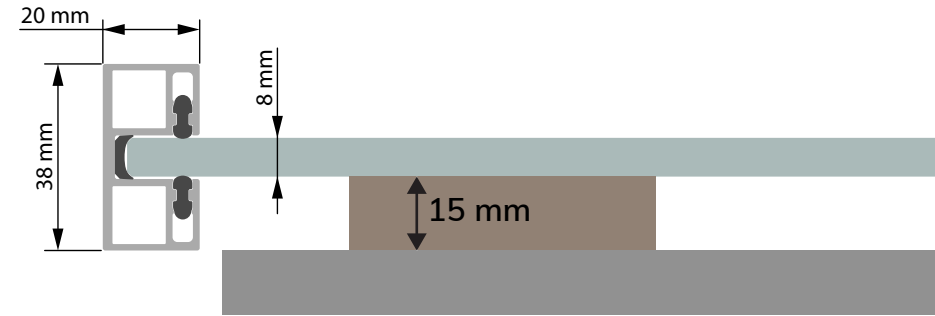

- 2 Push the top and bottom profiles with GLR68 and GLRMIMA over the panel.

Use a rubber hammer to facilitate positioning.

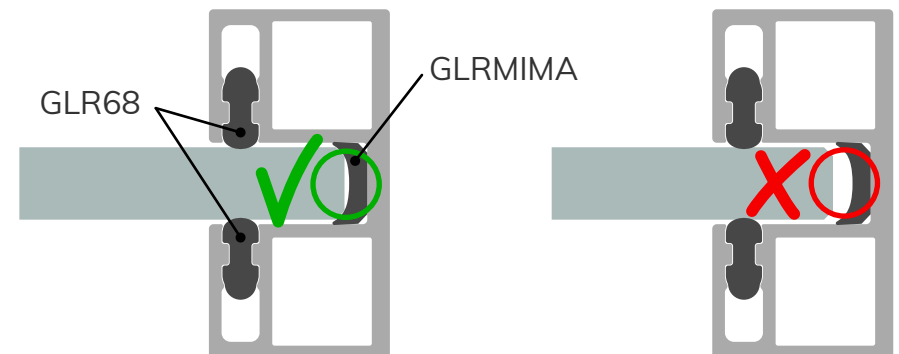

- 3 Attach each profile to the alu GMHD with the PAP-MMVS connectors as shown.

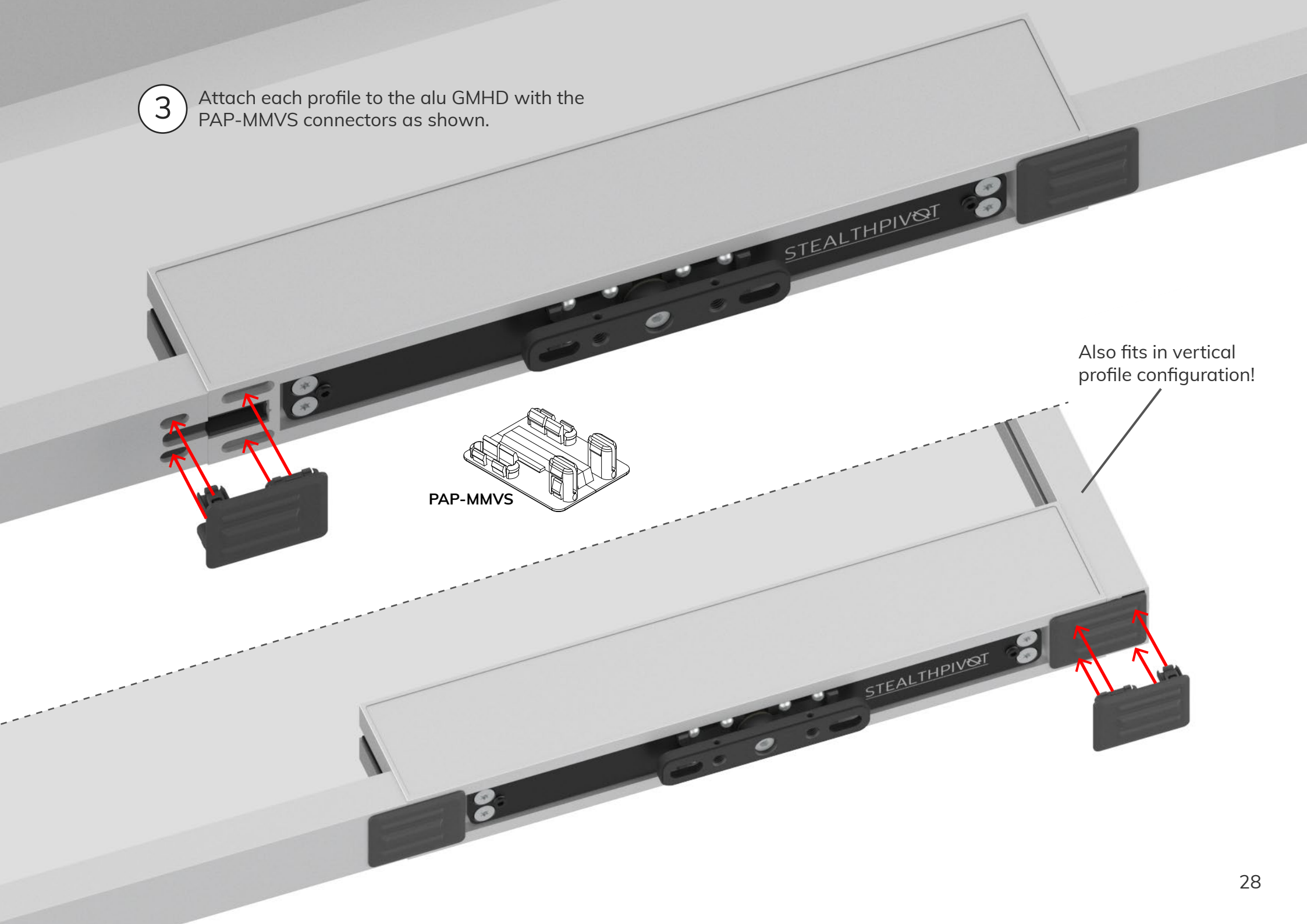

4 Carefully push the left and right profiles with their corner joints into the top and bottom profiles, and over the panel.

Careful: don't drop profiles!

5

Push in the excess GLR68 into the profiles during mounting.

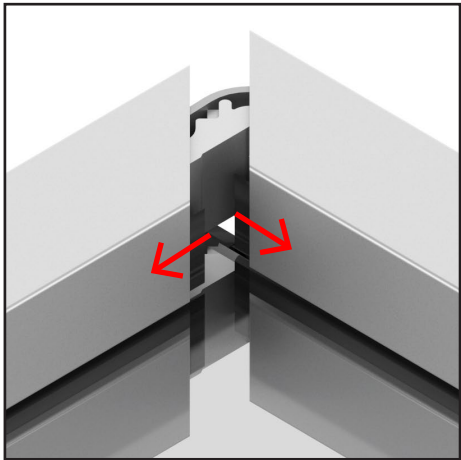

6 Use a rubber hammer to facilitate positioning.

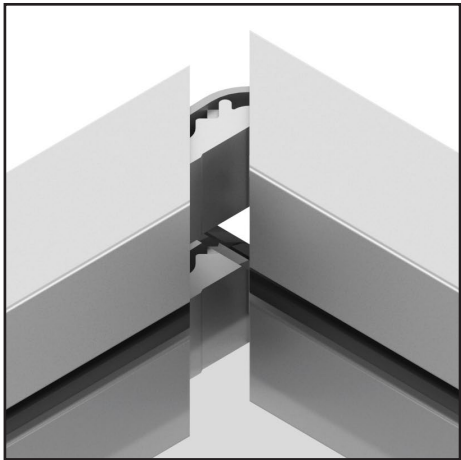

SECURE CORNER JOINTS

Align the profiles as best as possible, and carefully tighten the inbus screws **BY HAND!** Over-tightening will damage the corner joint!

During tightening, the space between the profiles will disappear.

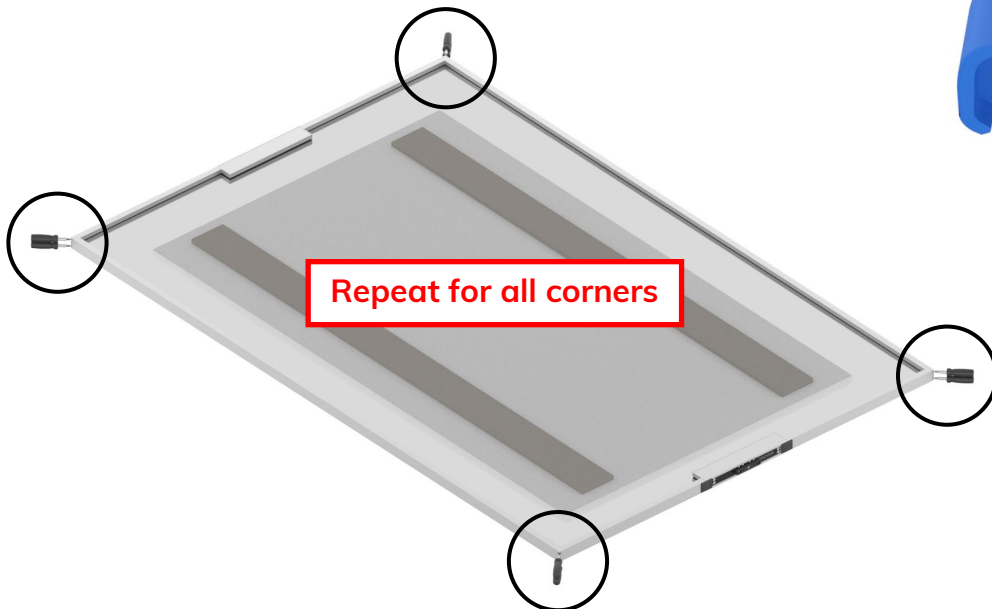
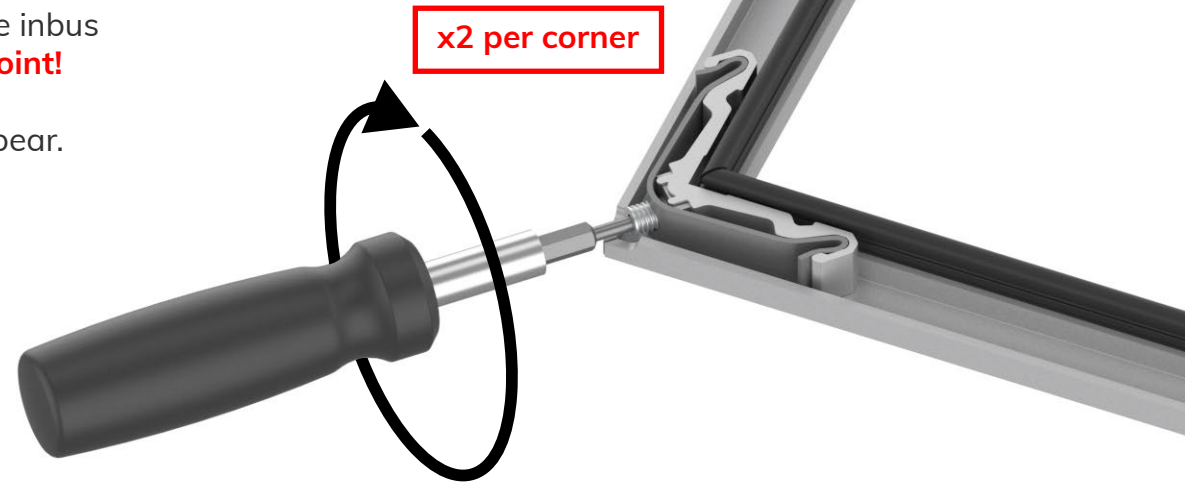
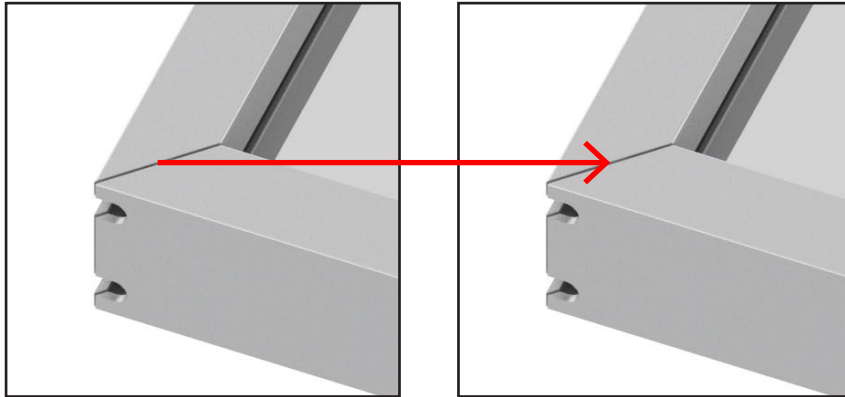

You can use quick-grips to prevent the profiles from shifting up and down during tightening.

FRAME-A-WAY POSITIONING MAGNETS

We advise to install the optional 2-way positioning magnet(s) onto the doorframe.

For counter magnets on the ceiling and/or 1-way operation, see 'Door installation manual'

For magnets on doors with doorjambs, see next page.

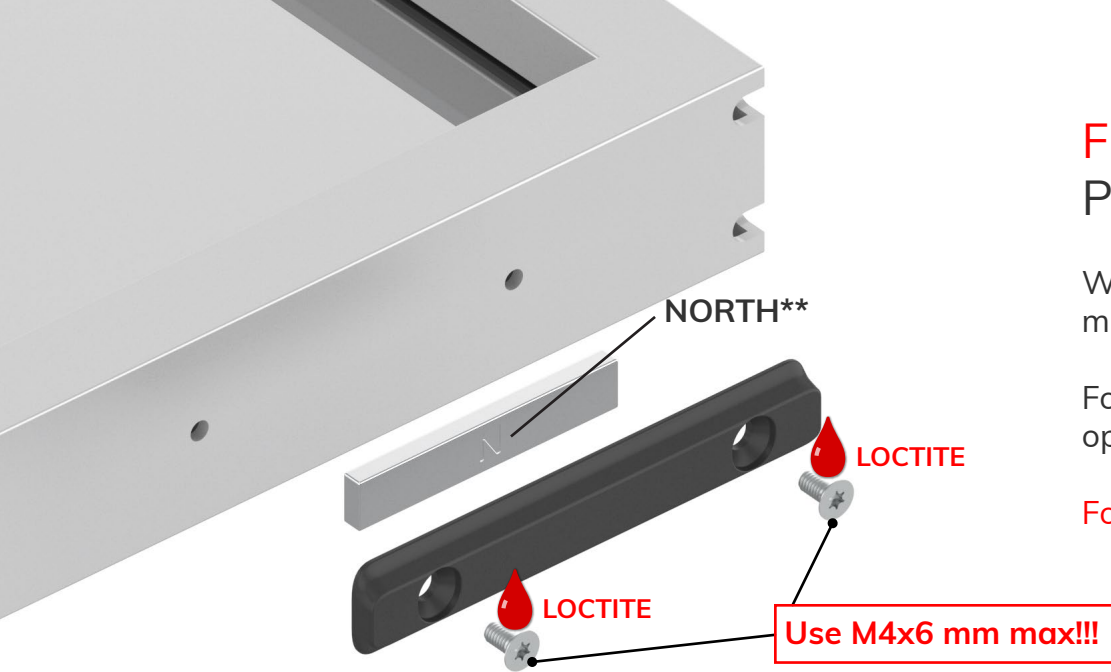

*Always face NORTH side UP on doors, so you can always face SOUTH side down for counter magnets on ceiling.

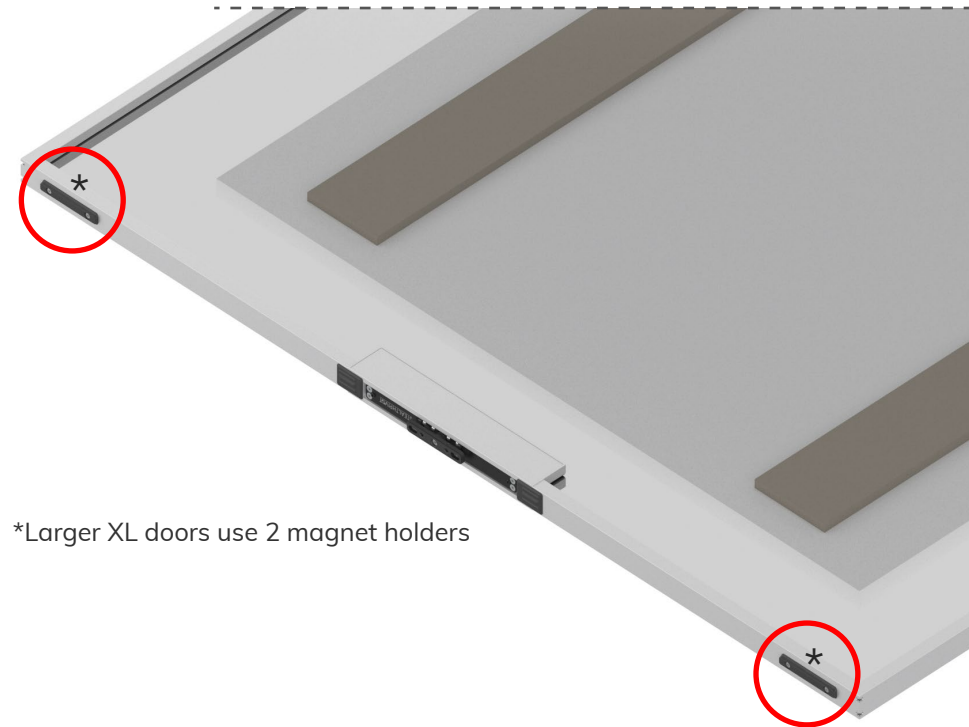
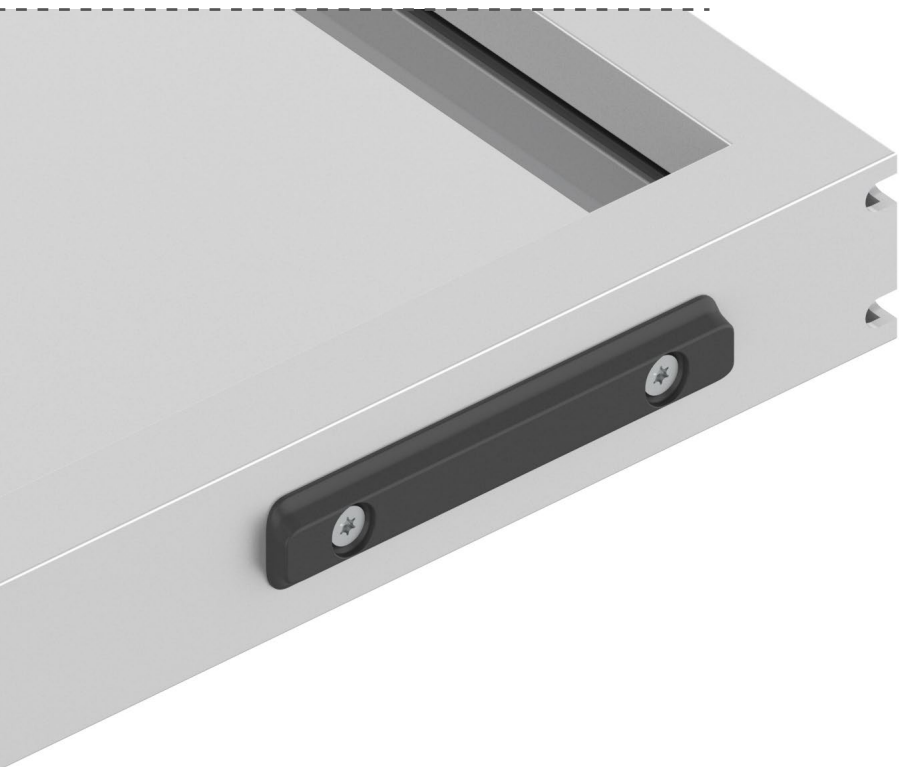

*Larger XL doors use 2 magnet holders

DOORJAMB POSITIONING MAGNETS

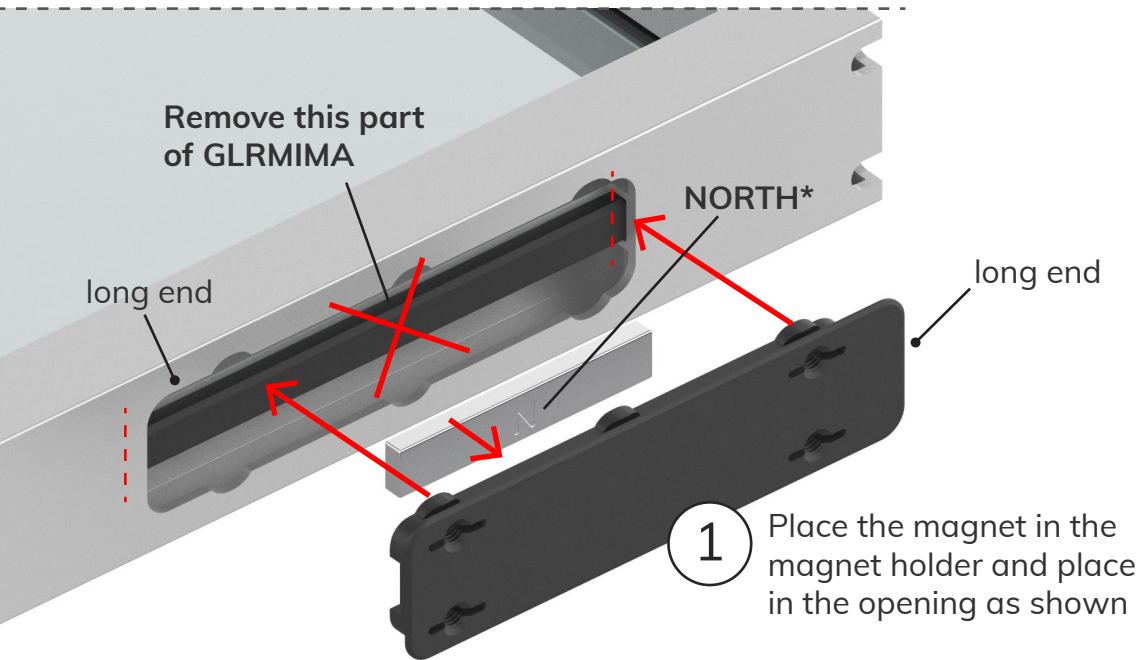

*Always face NORTH side UP on doors, so you can always face SOUTH side down for counter magnets in the doorjamb.

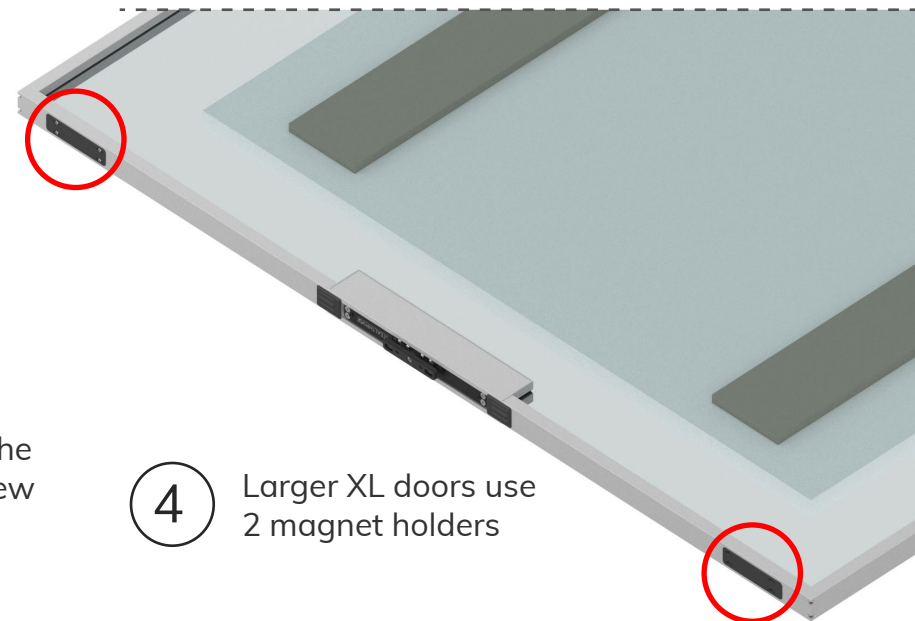
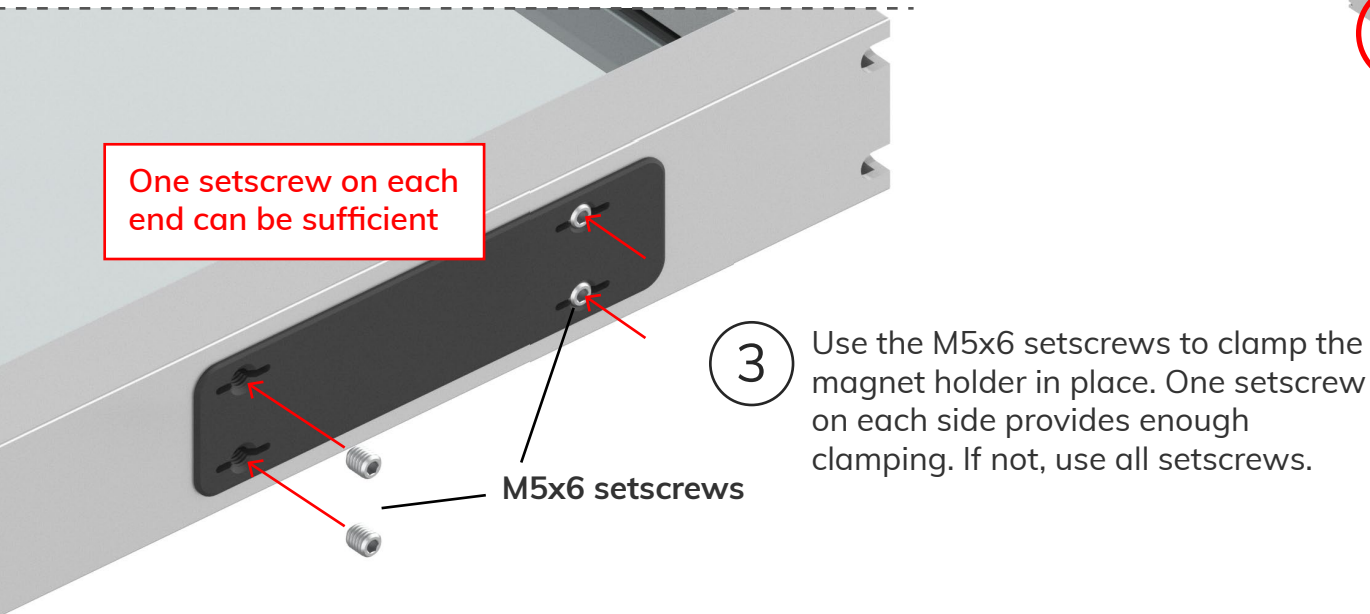
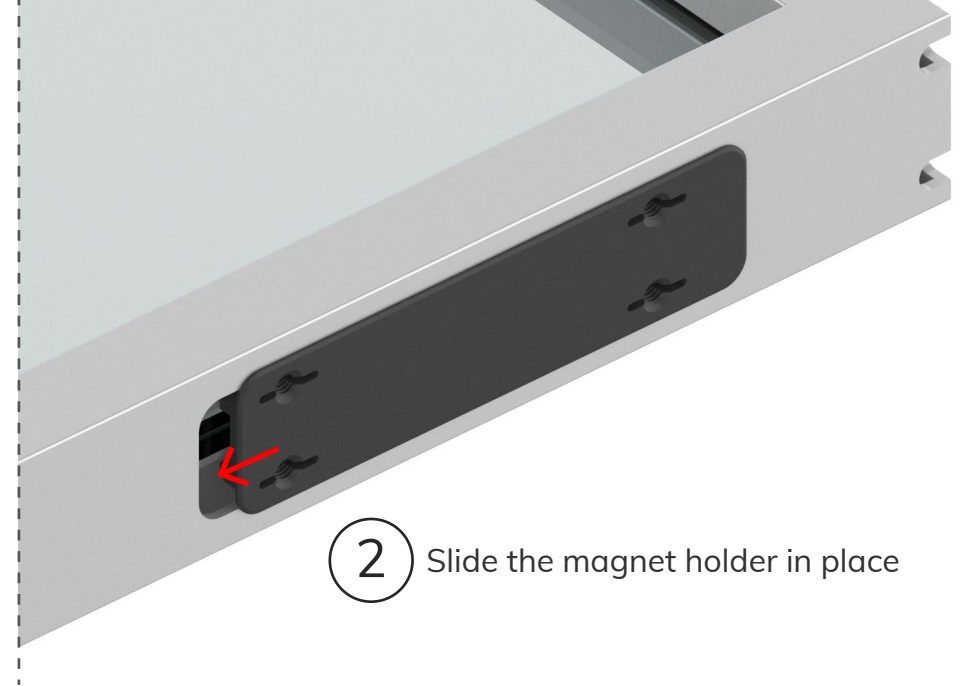

For further instructions on how to install
the fully assembled door in your doorway,
please refer to the DOOR INSTALLATION MANUAL