

ARMABOT

Low Profile Drive Installation Instructions

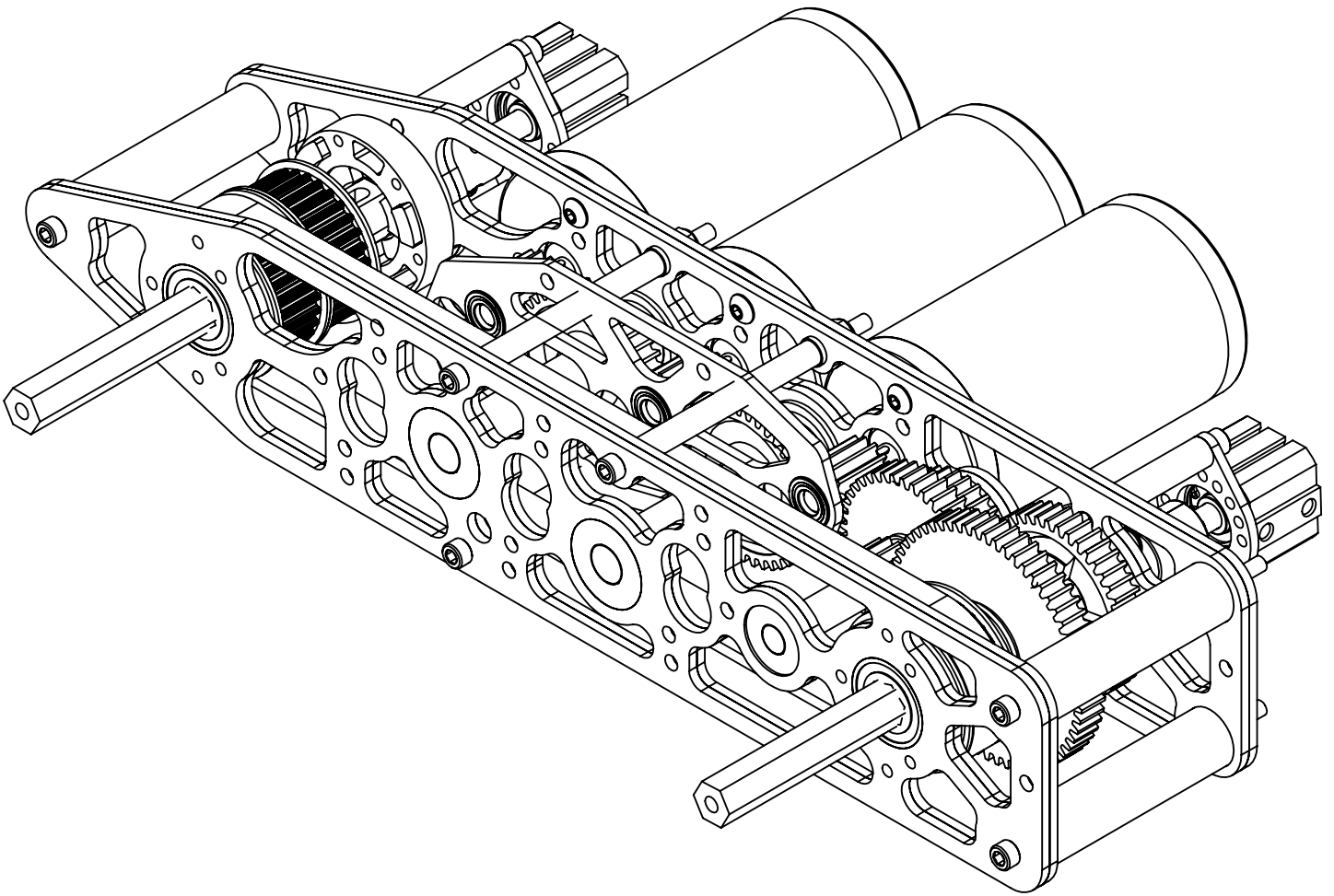

1. Assemble plates and bearings.

Observe plate differences: Front half of back plate as pictured has large holes at corners. Back half has tapped holes around bearing.

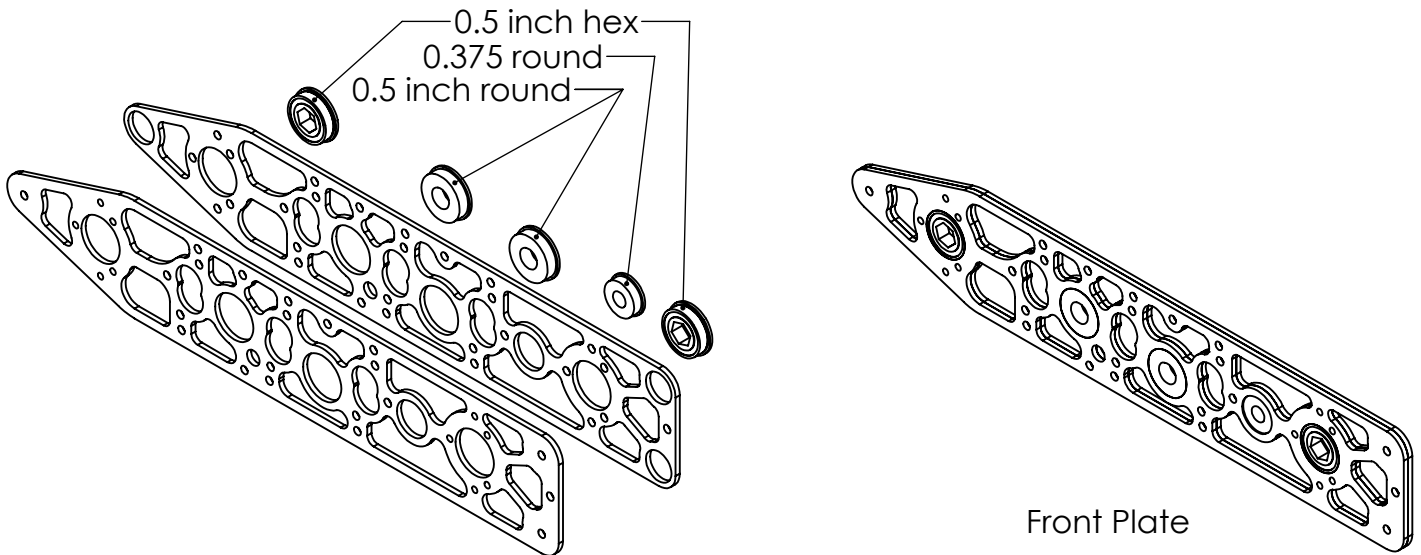
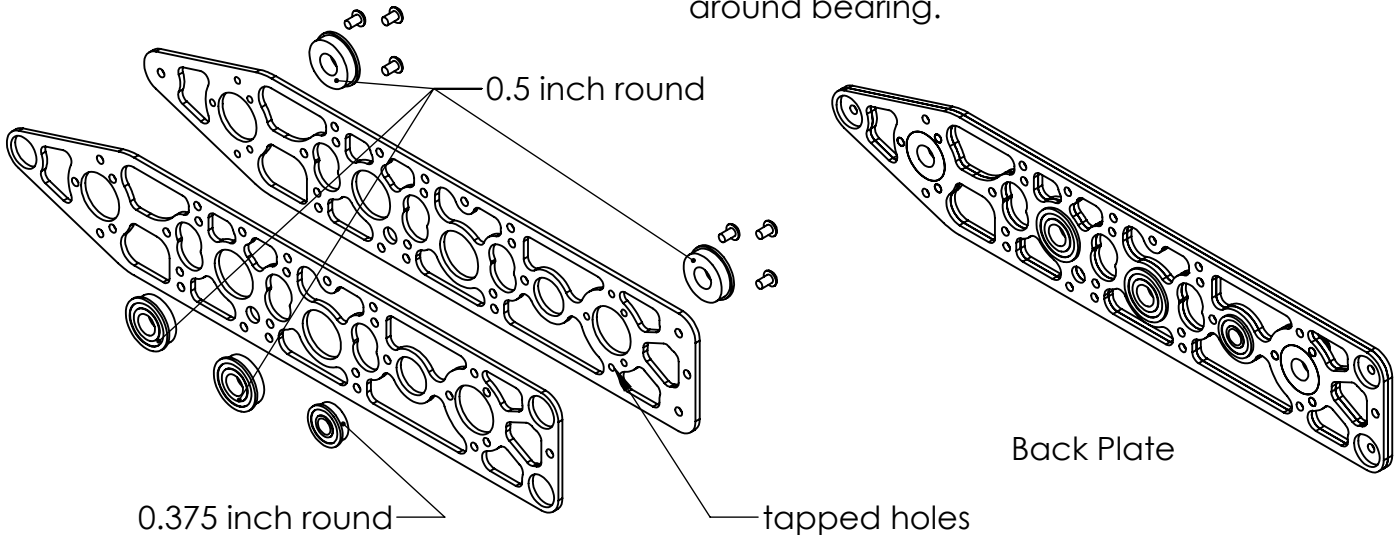

Observe plate differences: back half of front plate as pictured has large holes at corners.

2. Assemble Shafts.

High speed dog gear

Low speed dog gear

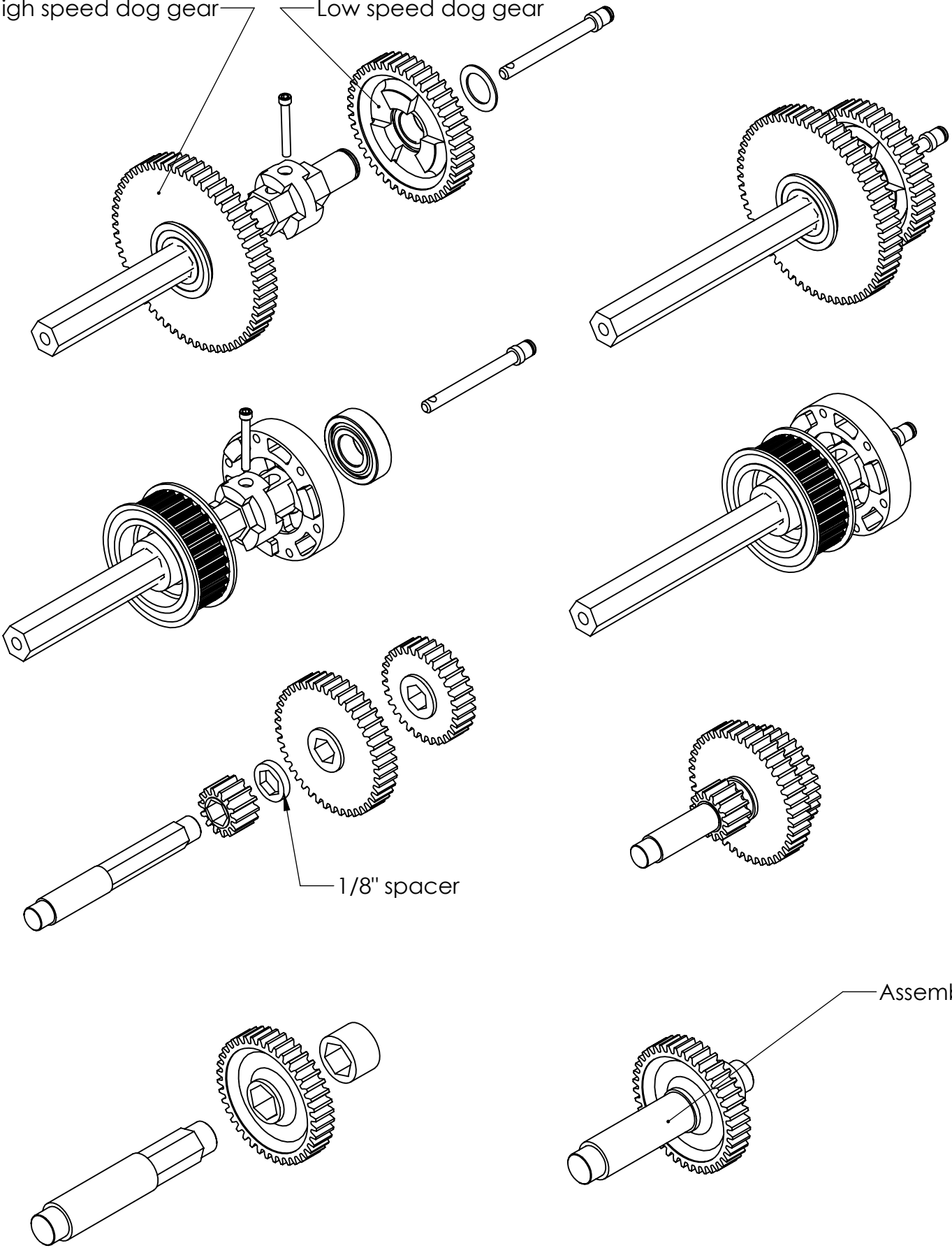

Assemble 2X

3. Attach motors to back plate

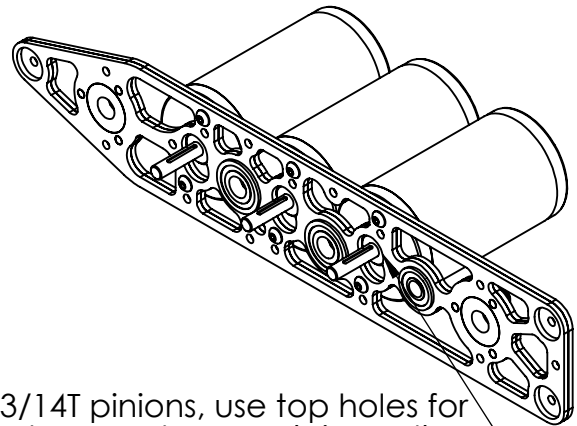
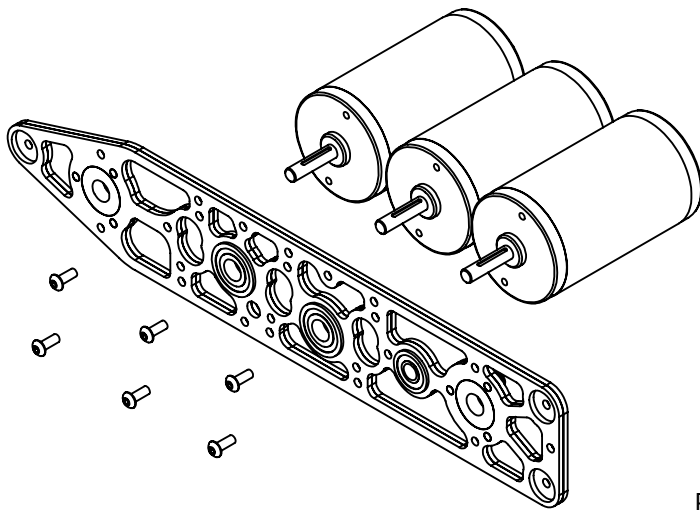

For 13/14T pinions, use top holes for motor boss and screws (pictured).
Use bottom holes for 11/12T pinions

4. Place pinions on motor shafts

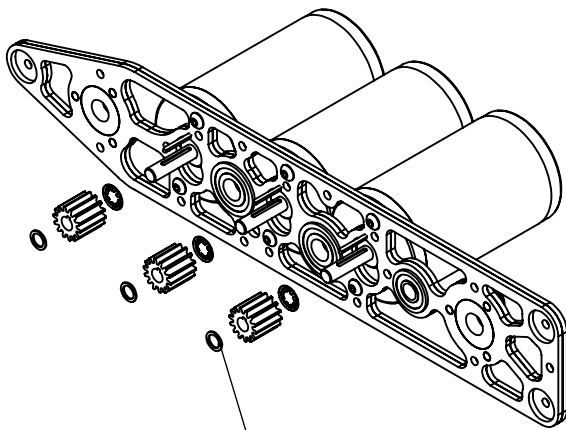

8mm washer

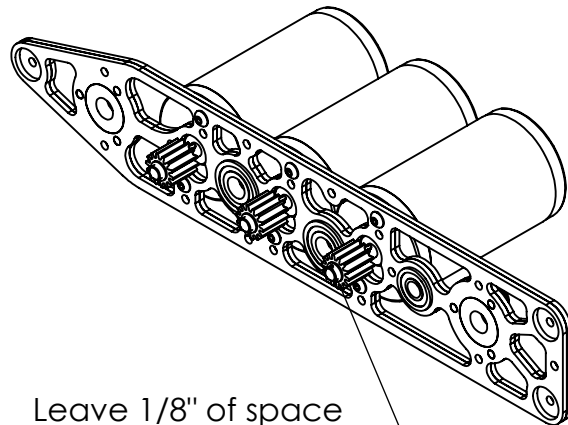

Leave 1/8" of space from washer to end of shaft when pinion is pushed all the way into retaining ring

5. Place shafts in back plate

Retain shifter shafts with snap ring.

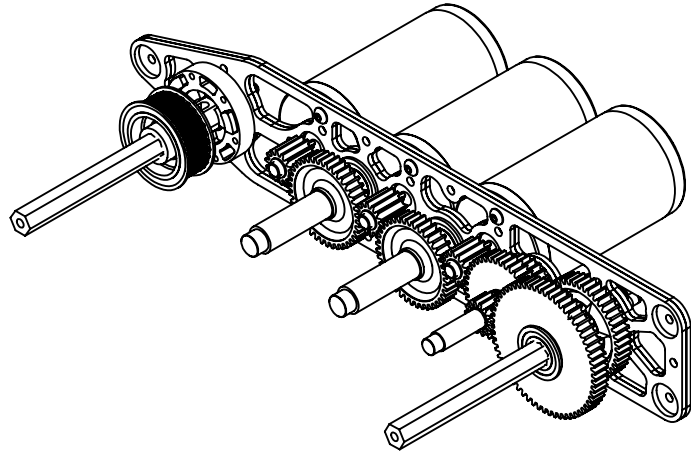
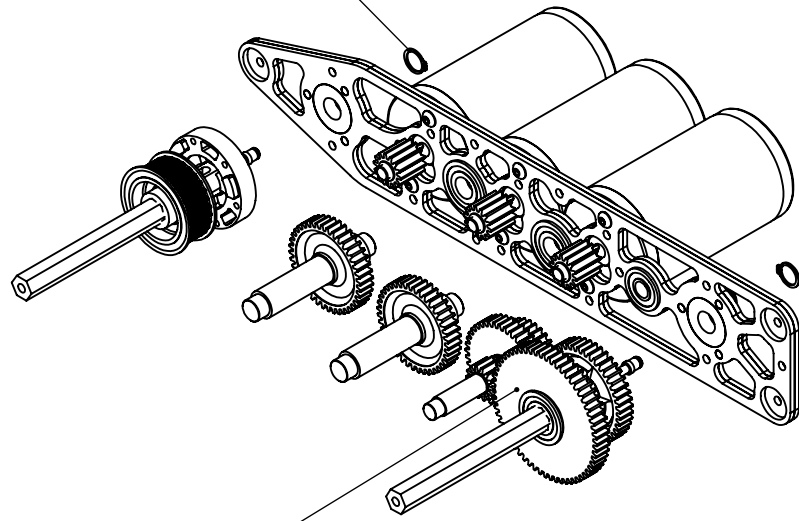

Assembling this group may be easier if shafts are temporarily disassembled to let gears slide past each other.

6. Attach shifter cylinders

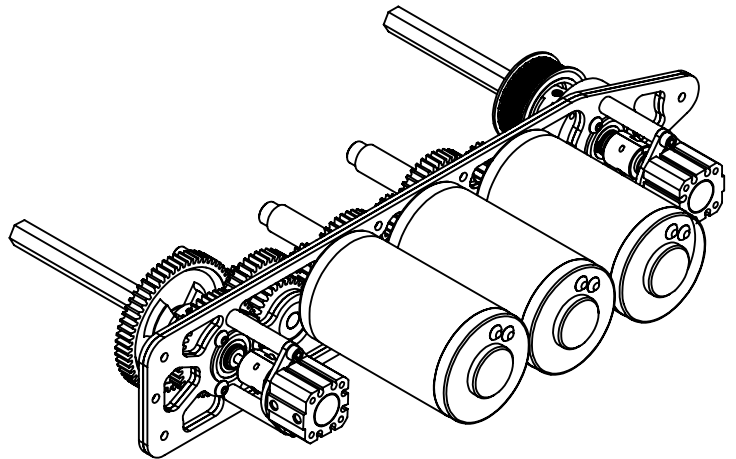
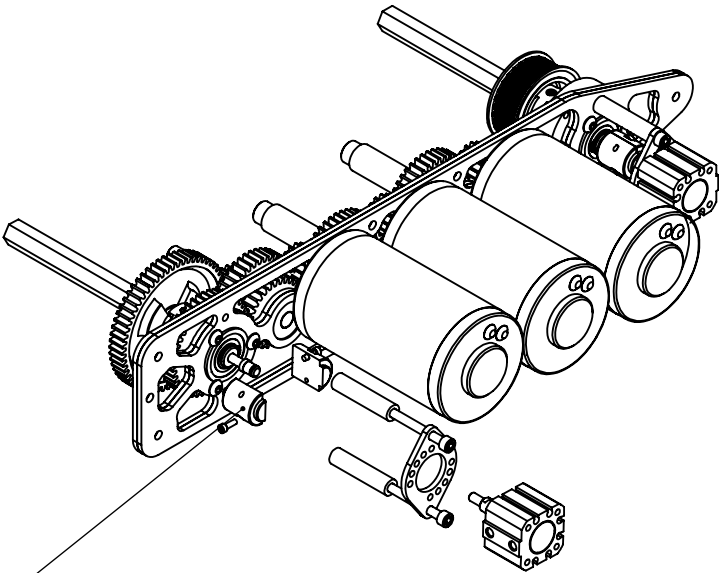

See VEX/WCP instructions for details of shifter assembly. Not all components pictured.

7. Place motor shaft support plate

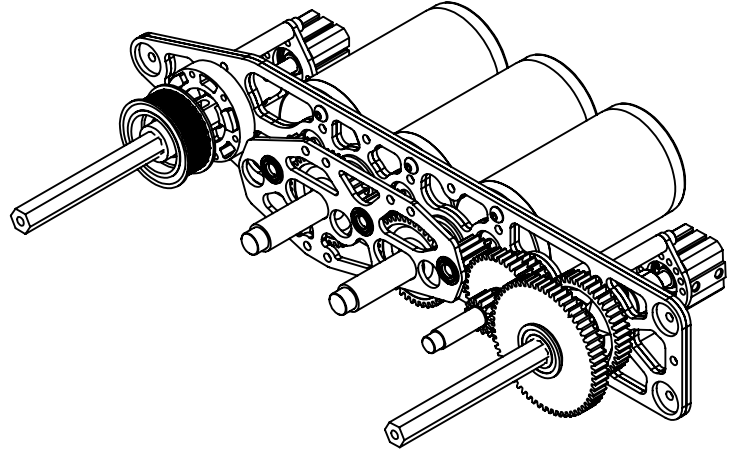
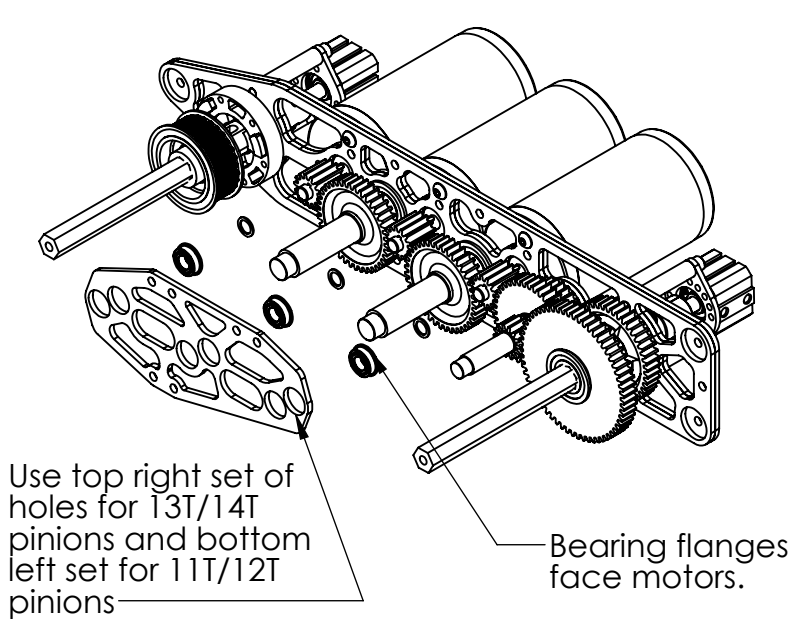

8. Place drive belt and pulleys

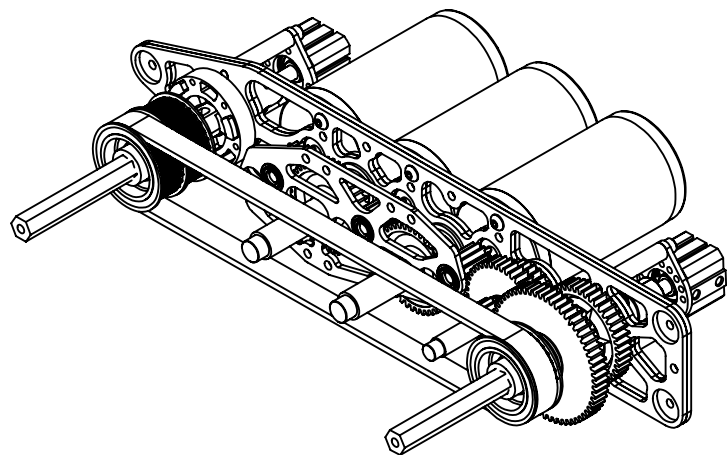
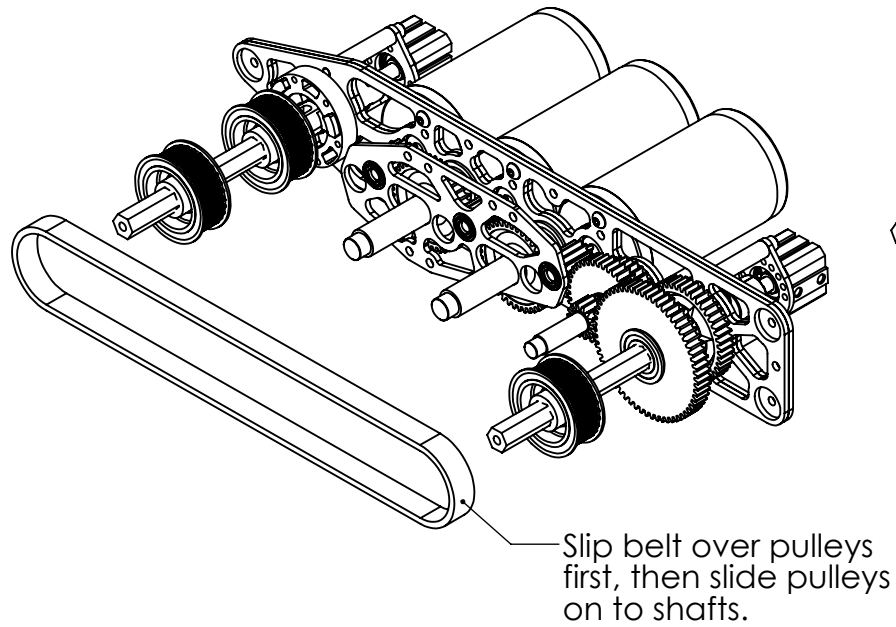

9. Place spacers and front plate, bolt together

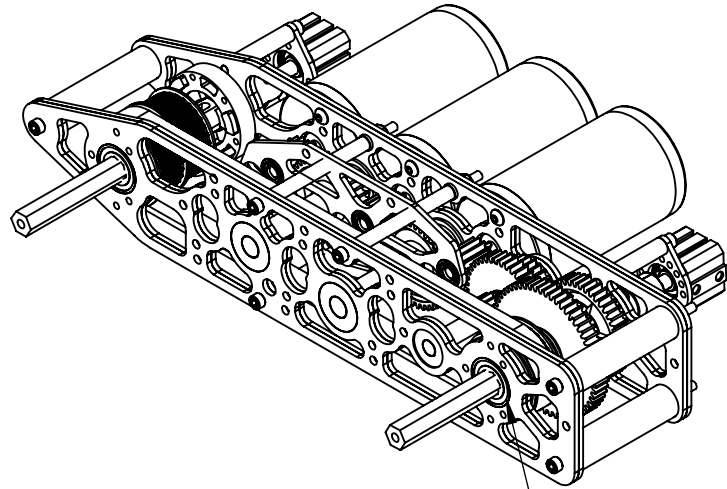
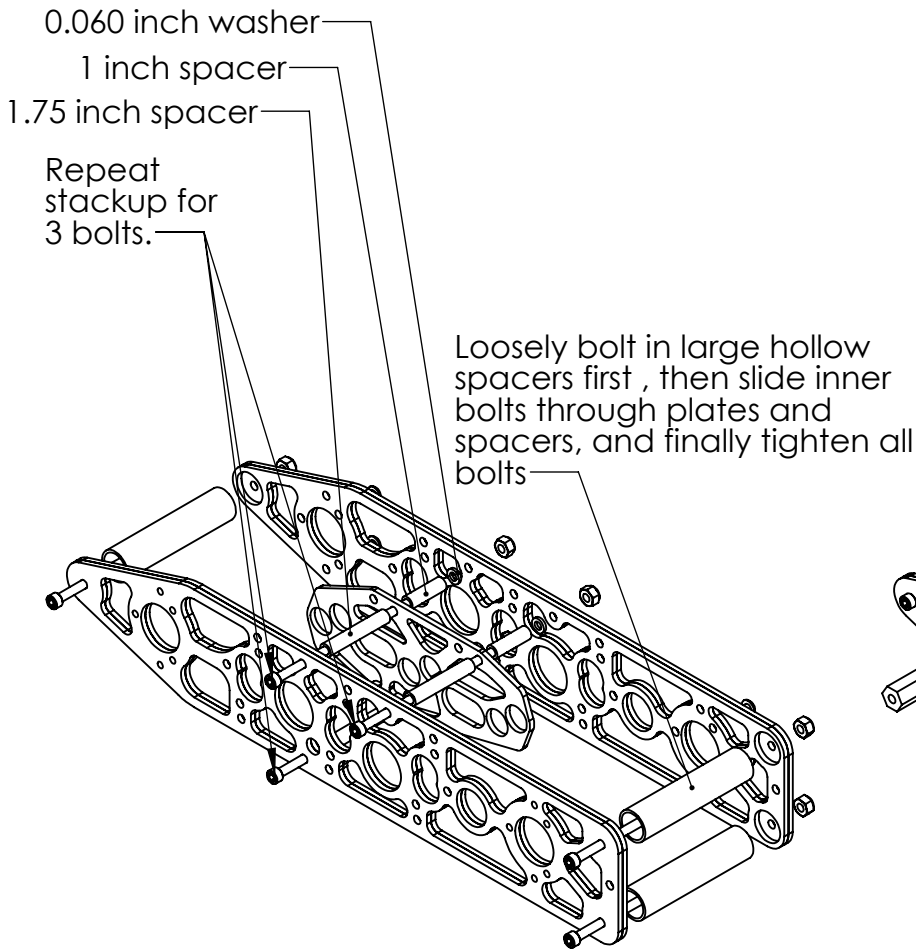

Components hidden for clarity. Make sure bearing flanges face inside of gearbox.

Assembly bolts can also be used to mount gearbox.

