

Bar & Line

Jeroen van de Gruiter



## Bar

A polyester bar that can be used as a towel rail or handle, it is available in a range of different colours and transparencies.

ø33 x 520 mm  
polyester  
matte or polished finishes



pink version

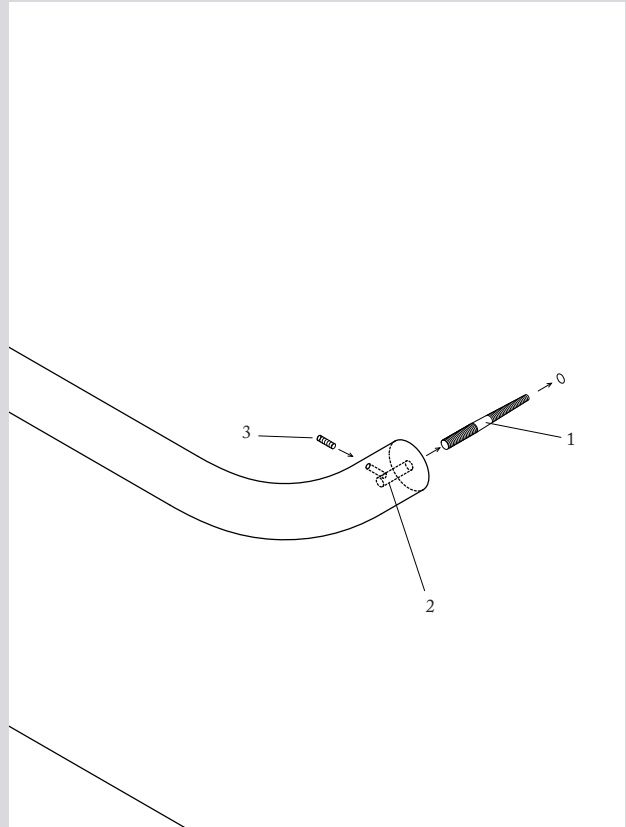

steps for installation

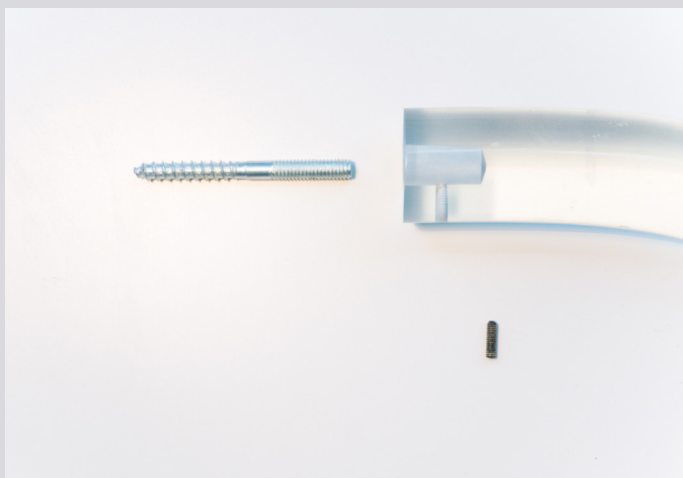

Depending on the chosen transparency the mount will be more or less visible.



## Line

The brass line doorhandle is created by the idea of a pulse, a short moment of movement in an otherwise linear shape.

ø10 x 720 mm

brass

brushed or polished finishes

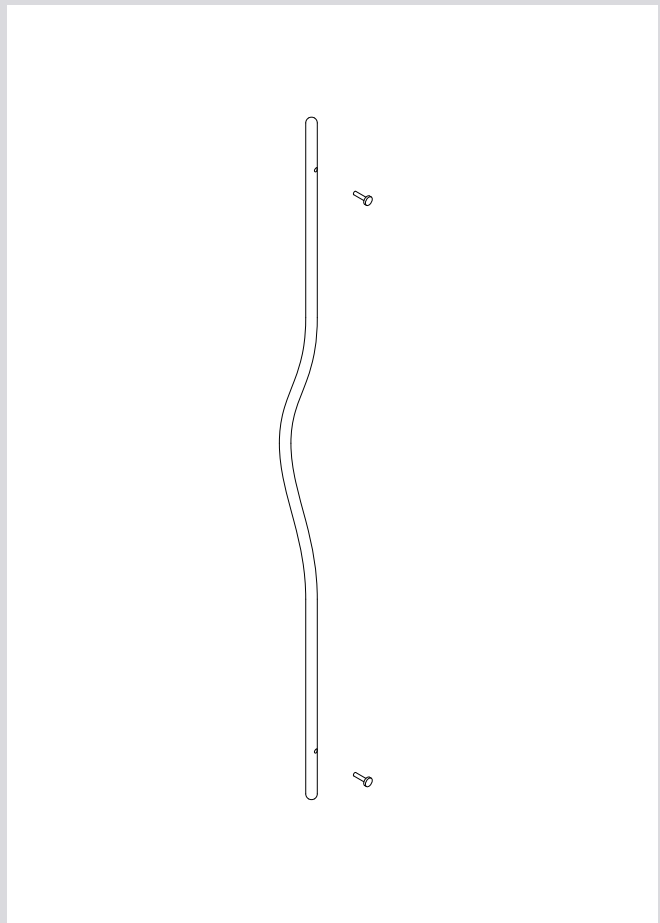
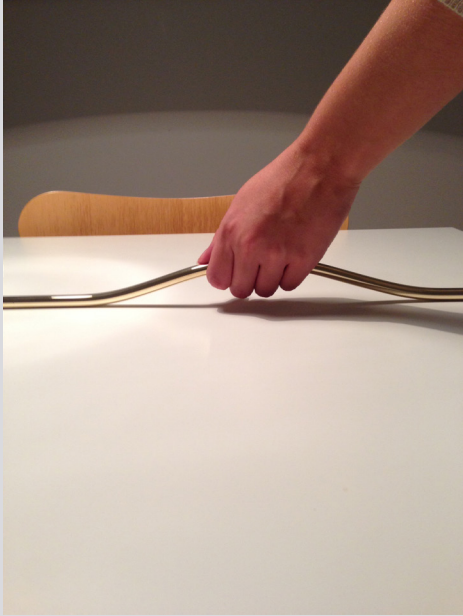

Two points from which the handle can be fastened,  
spacers in between the handle and screws can be made as well.

Jeroen van de Gruiter

[info@jeroenvandegruiter.nl](mailto:info@jeroenvandegruiter.nl)  
[www.jeroenvandegruiter.nl](http://www.jeroenvandegruiter.nl)