

Fat flush pull handle, oval

Tom Dixon Collection

d line

PRODUCT DATA SHEET

ITEM NUMBER 15.9010.01.100
SURFACE Polished brass

PRODUCT
Fat flush pull handle, oval, 70x140mm, brass.

PICTURE



TENDER TEXT

Fat flush pull handle, oval, 70x140mm, brass. The FAT collection is a series of architectural hardware pieces designed by English industrial designer Tom Dixon. Angular and bulbous, the pieces are a testament to form following function, whilst maintaining a humorous silhouette and a reductionist aesthetic. FAT is part of a fuller series by Tom Dixon including dining chairs, bar stools and lounge chairs. Material: polished brass, round. Radius: Ø70. W:70 mm x H:140 mm x D:19 mm.

PRODUCT SPECIFICATION

Dimensions: W:70 mm x H:140 mm x D:19 mm.

Radius: Ø70

Material: polished brass

Surface finish: polished, crafted by hand

Warranty for brass parts - 20 years

DRAWING

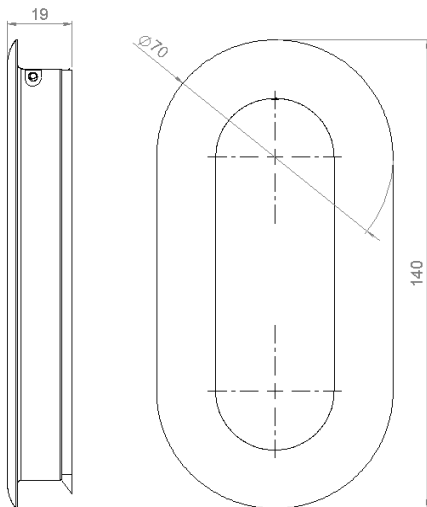

SPARE PARTS / ACCESSORIES:

14970102016	-	Grub screw M5 x 6,8 mm
14970102019	-	Grub screw M5 x 8,3 mm

MOUNTING:

See instruction supplied with product.

PACKING:

9 pcs in a bag

ISO-DRAWING

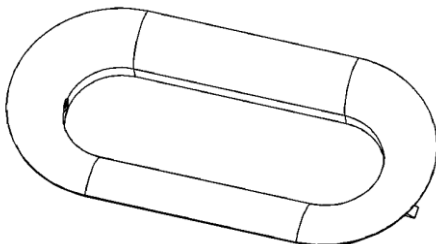

PRODUCT CARE

d line products are produced from brass. To sustain the unique d line finish appearance please follow the below instructions

- Wash down the surfaces using soapy water or mild detergent
- Always thoroughly rinse off with clean water
- To complete the cleaning procedure dry/polish the surfaces with a soft dry cloth

Please do not use scouring powder, steel wool, chloride based detergents or other aggressive cleaning products as these may damage the surface.