

***Lever KK shape round knob***

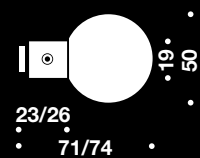

## Lever KK shape round knob

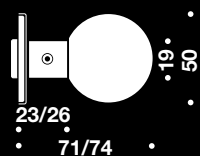
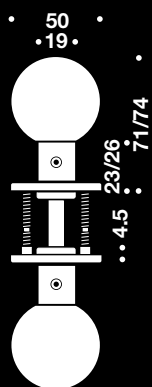

Description	Item number
Pair 7x7mm, w/snap on cover rose cc30/38mm, 33-49mm	14.3156.02.010
Pair 7x7mm, w/snap on cover rose cc30/38mm, 49-65mm	14.3156.02.020
Pair 8x8mm, w/solid rose cc30mm, 33-49mm	14.3111.02.010
Pair 8x8mm, w/solid rose cc30mm, 49-65mm	14.3111.02.020
Pair 8x8mm, w/solid rose cc38mm, 33-49mm	14.3112.02.010
Pair 8x8mm, w/solid rose cc38mm, 49-65mm	14.3112.02.020
Pair 8x8mm, w/snap on cover rose cc30/38mm, 33-49mm	14.3116.02.013
Pair 8x8mm, w/snap on cover rose cc30/38mm, 49-65mm	14.3116.02.021
Pair 8x8mm, w/snap on cover rose + threaded lugs cc38mm, 33-49mm	14.3119.02.010
Pair 8x8mm, w/snap on cover rose + threaded lugs cc38mm, 49-65mm	14.3119.02.020
Pair 9x9mm, w/snap on cover rose cc38mm, 33-49mm	14.3136.02.010
Pair 9x9mm, w/snap on cover rose cc38mm, 49-65mm	14.3136.02.020
Half set 7x7mm, w/snap on cover rose cc30/38mm	14.3156.02.900
Half set 8x8mm, w/solid rose cc30mm	14.3111.02.900
Half set 8x8mm, w/solid rose cc38mm	14.3112.02.900
Half set 8x8mm, w/snap on cover rose cc30/38mm	14.3116.02.901
Half set 8x8mm, w/snap on cover rose + threaded lugs cc38mm, M4 bush	14.3119.02.901
Half set 8x8mm, w/snap on cover rose + threaded lugs cc38mm, M4,5 bush	14.3119.02.902
Half set dummy function, w/o rose, M6 (for mounting on dummy back plate or rose)	14.3110.02.800
Half set 9x9mm, w/snap on cover rose cc38mm	14.3136.02.901
Half set 9x9mm, w/snap on cover rose + threaded lugs cc38mm, M4 bush	14.3139.02.901
Half set 9x9mm, w/snap on cover rose + threaded lugs cc38mm, M4,5 bush	14.3139.02.902
Half set 7x7mm, f/use with ball bearing rose	14.3150.02.900
Half set 8x8mm, f/use with ball bearing rose	14.3110.02.900
Half set 9x9mm, f/use with ball bearing rose	14.3130.02.900
Half set 7x7mm, f/use with back plate	14.3150.02.700
Half set 8x8mm, f/use with back plate	14.3110.02.700
Half set 9x9mm, f/use with back plate	14.3130.02.700



Lever approved  
for fire doors  
according to  
DIN 18273

# PRODUCT DOCUMENTATION



**Product Name:** Ball knob handle Ø50 half set  
for dummyfunction M6

**Article Number:** 14.3110.02.800  
*Satin stainless steel*  
16.3110.01.800  
*Polished stainless steel*

**Photo:**



**Drawing:**

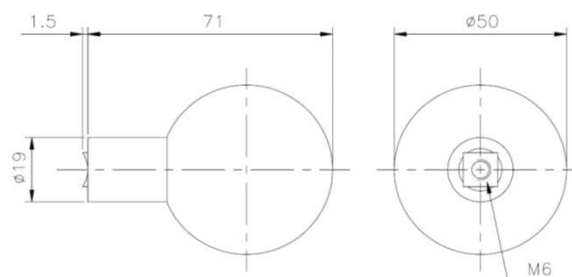

**Product Information:**

Material: AISI 316 stainless steel  
Surface finish: Satin 320 grain or polished  
Material thickness/radius: Ø50 mm  
Height: 71 mm      Width: 50 mm      Depth: 72,5 mm

**Product Specification:**

d line Ball knob handle Ø50, halft set, for dummy function M6, AISI 316 sss  
  
d line Ball knob handle Ø50, halft set, for dummy function M6, AISI 316 pss

Certificate: EN 1906, Class 4  
Warranty: 20 years (non-mechanical/-electronic parts)

d line products are always produced in the highest quality stainless steel AISI 316. d line is a simple and functional design, but the minimalistic exterior hides advanced technic that ensures the hardware's strenght and durability for many years.

**Spare Parts/Accessories:**

14.9706.02.612      Machine screw M6x12mm unbraco  
14.9808.00.009      Accessories

**Related Products:**

**Mounting:**

See instruction supplied with the product

**Packing:**

1 pair in a bag, 5 bags per box

**Maintenance:**

Wash down with mild detergent, rinse off with clean water, and dry off with soft dry cloth. Please do not use scouring powders, steel wool or aggressive cleaning products as these may damage the surface. If spots appear on the surface it is not due to the stainless steel, but to impurities in the environment or the use of aggressive cleaning agents.

**Environment:**

No environmental risk and no risk of fire.