

CHAPMAN & BOSE



1"
25mm

Approx.
0.25" (6mm)

LP02 Leather Loop Pull

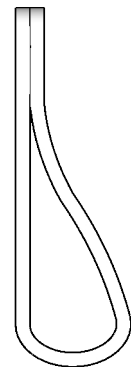

Size
5" (128mm) flat length

Leather
Black, Taupe, Whiskey brown, Chocolate brown
White, Natural, Yellow, Blue, Green, Red

Fixing Hardware
Black, Brass, Nickel
Fixing hole diameter (0.25" / 6mm)