

35 (1.38")

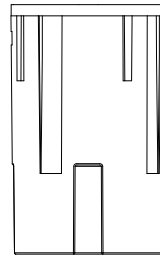

62.1  
(2.45")

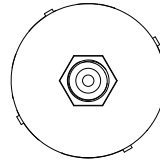
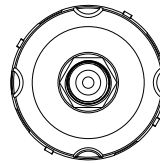

25 (1")

FUNCTION: cable F connector

MATERIALS: polycarbonate casing, electrical components

CONFIGURATION: for use in all 22.2 alternate mounting plates

INPUT / OUTPUT: 24V DC, 500mA max

#### DESCRIPTION

The 22 system is a complete suite of interior surface accessories that challenge the traditional, tired and ubiquitous cover plate concept. The 22 is designed to "mud" directly into drywall without a visible cover plate or trim. Alternatively, it may be set flush into millwork, marble, glass or any other surface. 22 operative components include: power outlets, data & communication, telephone receptacles, cable and HDMI connectors, line voltage on/off switches, keypad controls, and USB.

#### APPLICATIONS

The 22.3.5L is a cable F connector electrical receptacle. The 22.3.5L can be inserted into any of the 22.2 series alternate mounting plates. The suffix "L" refers to the extended barrel length for use with thick finish materials.

#### NOTES

- + Mounting plates sold separately
- + Purchase additional components at [www.bocci.com/shop/22](http://www.bocci.com/shop/22)

Worldwide utility patents pending  
US Patent # 7,956,295 B2 & 8,912,439 B2

Made in Vancouver, Canada

Vancouver  
sales@bocci.com  
www.bocci.com

Berlin  
europe@bocci.com  
www.bocci.com



CABLE F CONNECTOR - LONG BARREL

# 22.3.5L

Design by Omer Arbel  
PRODUCT SPECIFICATION

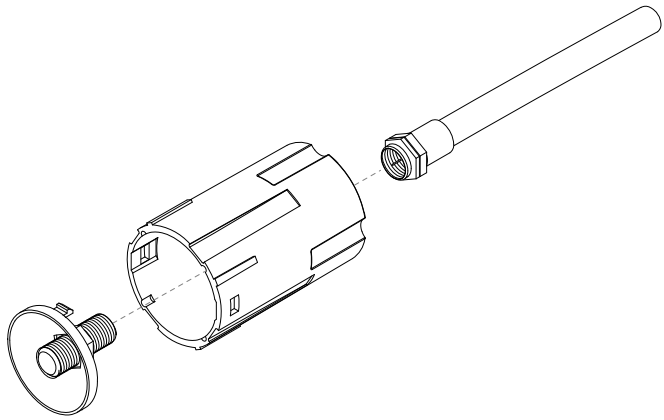

1

Thread the coaxial RF cable through the barrel as illustrated

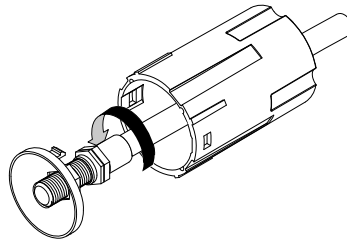

2

Screw the coaxial cable onto the threaded stem and snap the barrel onto the face plate.

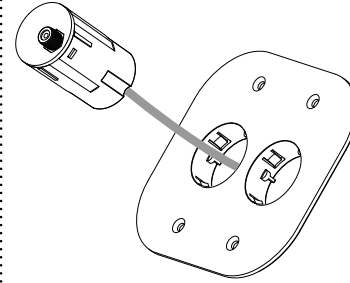

3

Insert the assembled module into the mounting plate.

**Best practice statement: For ease of future access or maintenance, we recommend a single incoming wire to the junction box (no J-box splices) immediately behind the 22 receptacles.**

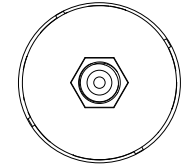

4

Refer to the 22.2 mounting plate installation instructions for more details.

For additional assistance, please contact Bocci:

Vancouver  
sales@bocci.com  
www.bocci.com

Berlin  
europe@bocci.com  
www.bocci.com

Worldwide utility patents pending  
US Patent # 7,956,295 B2 & 8,912,439 B2

Made in Vancouver, Canada



CABLE F CONNECTOR - LONG BARREL

# 22.3.5L

Design by Omer Arbel  
PRODUCT INSTALLATION INSTRUCTIONS

© 2020, Bocci Design and Manufacturing Inc. All rights reserved. Any inquiries should be directed to: info@bocci.com

# BOCCI