

www.nautos.com.br

Corporate Headquarters

Nautos[®]

Nestor Carlos Fedrizzi, 150
CEP: 95052 - 103
Caxias do Sul - RS - Brasil
+55 54 3026 1600
www.nautos.com.br

USA

Nautos[®]
USA

5636 SW 164th Terrace
Fort Lauderdale 33331
Florida - USA
+1 954 235 2674
www.nautos-usa.com

Europe

HOLT[®]

10 Burnham Business Park
Burnham-On-Crouch
Essex - CM0 8TE - UK
+44 (0)1621 787080
www.holt.eu

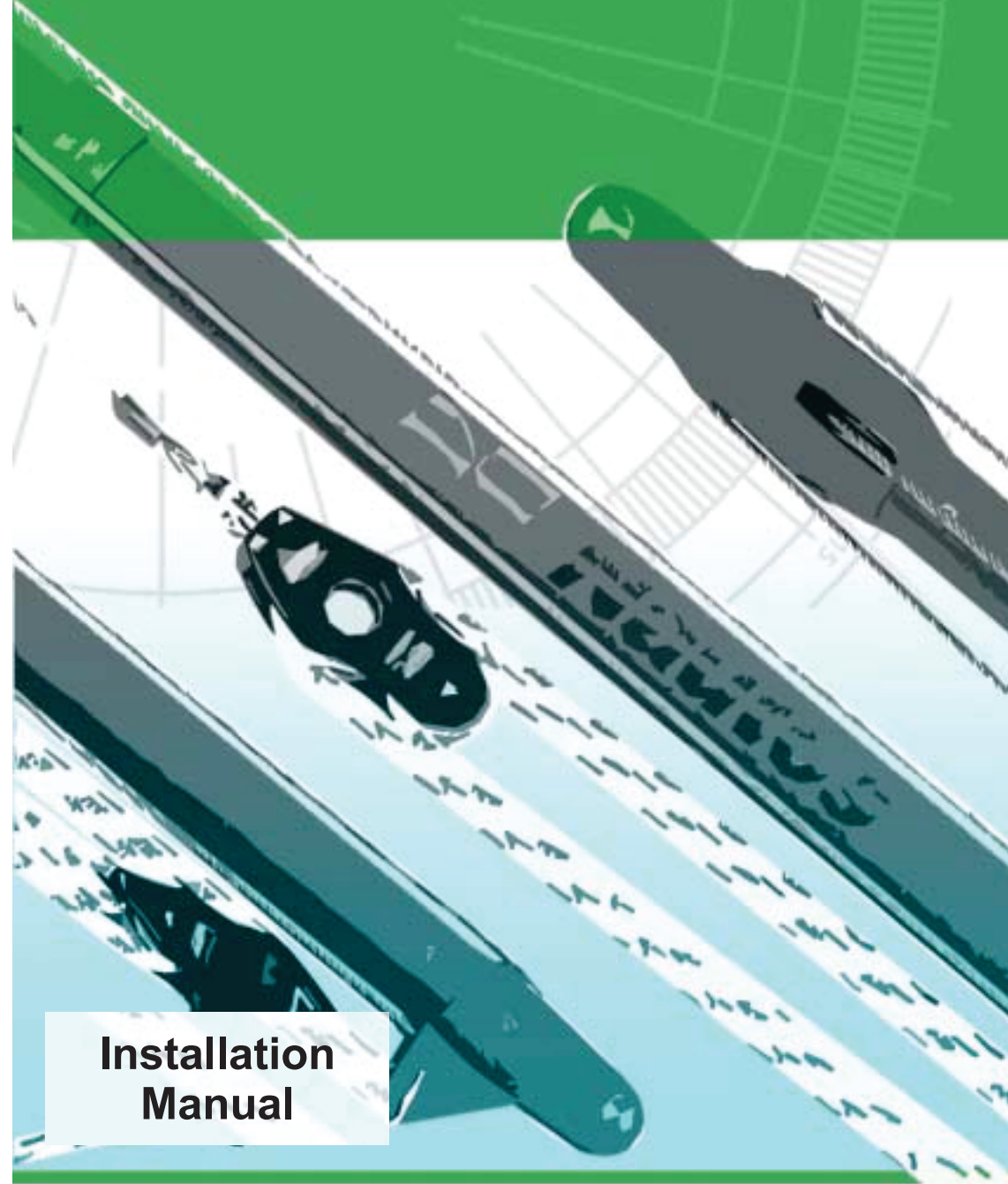

Installation
Manual

Nautos[™]

Installation and regulation

Vangs

For the vang installation, some details must be observed to facilitate your work:

The fixing hardware in the mast must be placed in the position as far as possible from the goose neck, for the vang be fitted in the angle most favorable to its functioning. The ideal angle is around 30° in relation to the boom, however, depending on the boat, you may need to use a lesser angle.

Be sure that the screw of opening regulation is in position H (more closed). Check in the assembly plan, the hole by length of the vang model to be fitted.

Based on figures in the table, and with the boom in the horizontal position, put the vang in the position that it would be fixed to the mast and check the point in the boom that the hardware must be attached.

Check that the tip of the vang to be placed near the mast, is that fixed to the external pipe, which is of bigger diameter and contains the regulations holes. **Attention:** the #0 is the exception, being the thinnest part facing the mast.

The articulated hardware must be attached to the mast and fixed hardware must be attached to the boom. Take care to assemble them with the angle of tip in the correct direction. The mast's one to point upwards and the boom's one in direction to the mast.

Use the table to confirm these positions and measurements.

To regulate the pressure of the spring, remove the screw H and lift the boom up to about 5° of the position of sail. Put the screw in again. The boom must come back to the horizontal position, being supported by the pressure of the spring.

Be sure there is enough course of spring to sheet in the sail, to the maximum and in the center of the track. If that doesn't happen it stop in the end of course and without having sheet in the sail, this puts the integrity of the device at great risk.

In boats with very heavy or long boom, it may be necessary maintain the topping lift, to rest the spring, while the boat remains stopped for long period.

Obs.: in the currently manufactured vang, the internal rope, which was in Stainless Steel, has been replaced by Spectra rope, lighter, durable and free of electrolysis.

The "Telescopicvang" is a compact, mechanical system which replaces the classic vang, and topping lift features. The telescopicvang body already possesses an internal reduction between 3: and 5:1 depending on the model. In conjunction with an external tackle, it provides more power, with a relation up to 40:1, making it an economical and viable alternative to hydraulic system. The stainless steel spring allows for the boom to be positioned at the ideal height substituting the topping lift. This facilitates the reefing maneuvers, eliminating the need for an additional operation. The hardware for mounting the vang on the boom and mast, as well the external tackles, are sold separately.

Dimensions table

Vangs

Part N°	# vang	Boat length ft	Sail area m ²	Internal ratio	Open length* mm	Closed length* mm
91329	0 inox	32'	25	2:1	1360	1160
91342	0	32'	25	2:1	1360	1160
91330	1	37'	35	3:1	1860	1560
91334	2	44'	45	4:1	2125	1825
91338	3	55'	60	5:1	2500	2300

* Attention: Dimension with the spring free.

Part N°	Fixing course H - I mm	Spring course mm	Pins ø J mm	Mast fit space L mm	Boom fit space k mm	Weight kgf	SWL kgf
91329	200	140	10	6,5	10,5	3,8	150
91342	200	140	10	16	8	2,4	150
91330	300	150	13	16	16	6,0	300
91334	300	150	16	16	16	7,0	450
91338	350	180	16	20	20	12,0	450

Mast Fittings

Part N°	# vang	Dim A mm	Dim B mm	Ø D mm	Fixing size mm
91312	0 inox	116	45	10	M6 X 20
91343	0	137	48	10	M6 X 20
91332	1	138	49	13	M6 X 20
91336	2	148	55	16	M6 X 20
91340	3	173	60	16	M6 X 20

Boom Fittings

Part N°	# vang	Dim A mm	Dim B mm	Ø D mm	Fixing size mm
91311	0 inox	150	31	10	M6 X 15
91344	0	160	48	10	M6 X 15
91333	1	210	45	13	M6 X 15
91337	2	250	46	16	M6 X 15
91341	3	320	54	16	M6 X 15

Assembly view

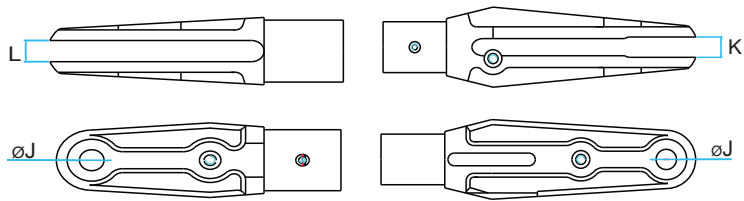

Attention: you will find the assembly manual whit your Purchase Order or on www.nautos.com.br

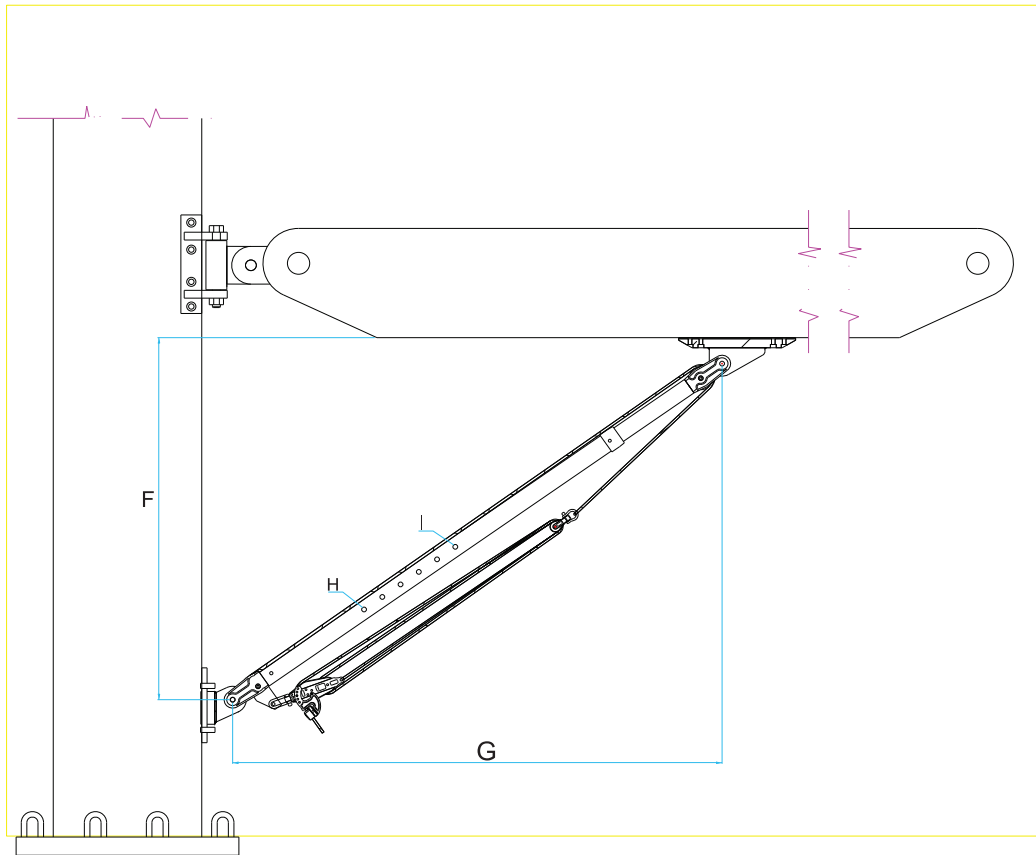

Nautos™

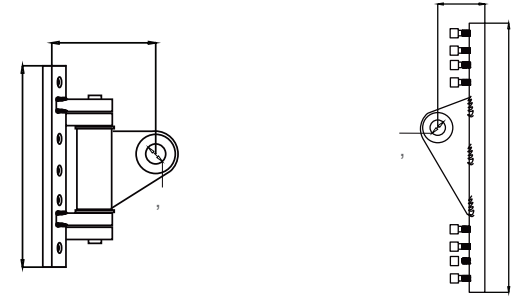
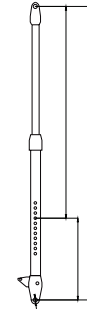

#0	F mm	G mim.mm	G max. mm
	1000	570	910
	900	720	1010
	800	830	1090
	700	910	1150

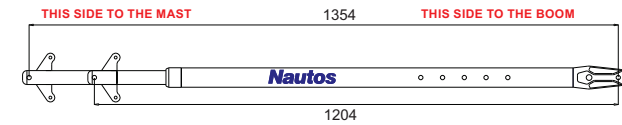

#1	F mm	G mim.mm	G max. mm
	1000	1190	1565
	900	1270	1630
	800	1340	1680
	700	1390	1720

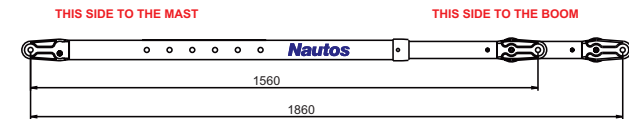

#2	F mm	G mim.mm	G max. mm
	1000	1530	1875
	900	1590	1930
	800	1640	1970
	700	1685	2010

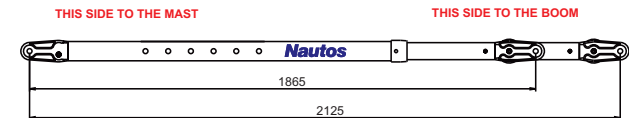

#3	F mm	G mim.mm	G max. mm
	1000	2080	2295
	900	2120	2330
	800	2150	2370
	700	2190	2400

