

# Daysailers Furler

From 18' to 25'

## Manual



**Nautos**<sup>TM</sup>

# Assembly Instructions

## Introduction

This manual contains basic information designed EXCLUSIVELY to specialized or trained people to installation such equipment. Not qualified persons may have serious difficulties and mounting may cause harm to themselves or to the equipment.

Nautos is not responsible for any incident caused on assembly the product by unskilled personnel.

## Sail Information

The Nautos Furler for boats up to 25', has a total length of A + B (bellow drawing), which should be subtracted to the fullest extent of the sail and subtract to the measured length of the forestay.

See sail maker instruction on page 6.

## Application

For Daysailers from 18' to 25'

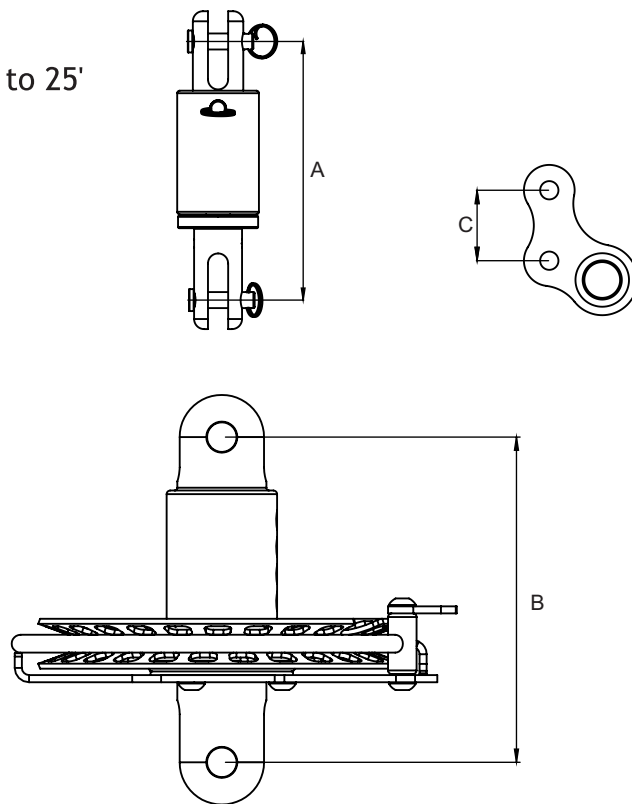

Furler size	A	B	C	Working Load	Breaking Load
#2.5	103	91	25	500kg	1100kg

Measures in mm

# Assembling the line on the Furlers

## The line

Use a good quality line, softcover 8mm. This cable must be formed into a loop of sufficient length to circulate the drum and reach the cockpit or appropriate place.

Check with your sailmaker or order it from Nautos. This line can remain at the deck when the Furler is removed or it can be removed with the system.

If the line is permanent, can be passed through blocks. If disassembled, the loop must contain the blocks with links to be fixed on stanchions.

Figure A) With the Furler still disconnected from the sail and cable, pass a line loop through the opening.

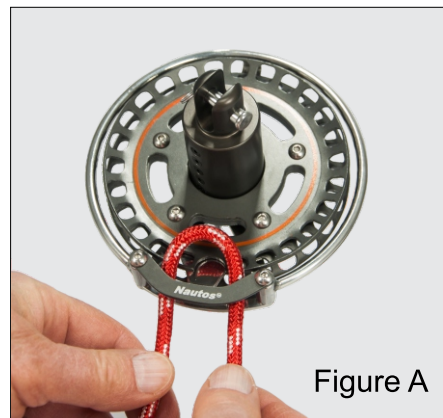

Figure B) Pull the handle to have some looseness. Plug the line into the disc opening and rotate the disc to accommodate the line.

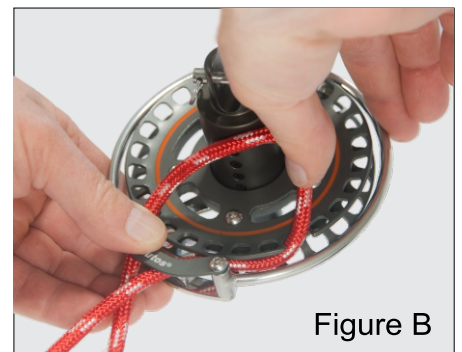
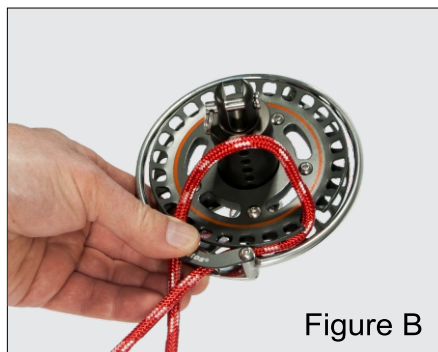
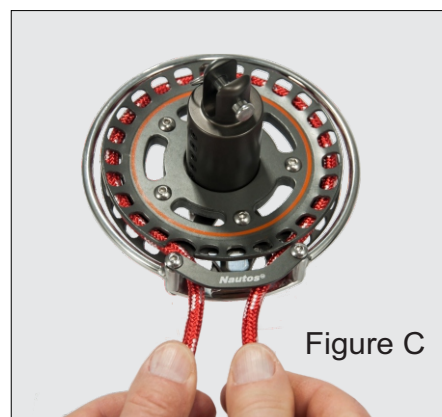

Figure C) Make sure everything is tight and the line is organized.



# Operating the Furler

Nautos strongly advises that to operate this equipment for the first time must be accompanied by experienced person in this operation and it must be in calm weather conditions.

If you choose to assemble it directly on the bow use a security harness connected to a reliable point.

Using a 5mm Allen wrench loose and rotate the disc protection according to the desired direction (Figure D)

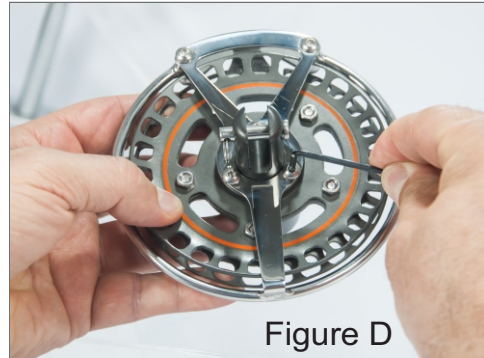

Attach the cable to the upper swivel and the swivel must be attached to an adequate halyard (Figure E and F).

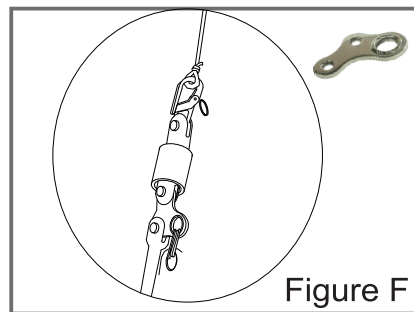

Attach the sail to the bottom Furler (figure G). Attach the Furler to the bow or to the bowsprit. Be sure that everything is free, sheets properly reeved and the line loop organized and locked.

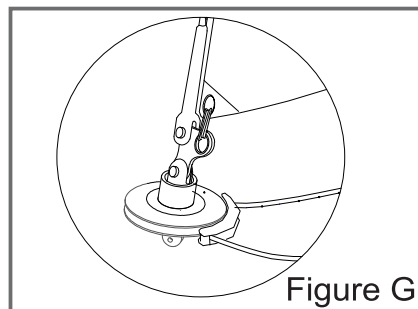

Hoist up the sail until correct tension in the halyard .

Check all systems, make sure the sheets are organized and the loop is in normal path.

**Be sure to use proper gloves**

Start unroll pulling by the leeward sheet, with little wind, the sail will unfurl itself. Attention to de running line, do not attempt to secure it or severe burn may occur.

# Furlers #2.5

## For Daysailers from 18' to 25'

### FURLING

With the halyard moderately stretched, start pulling the cable on the way to roll it, if the conditions are above of moderate, easy enough to reduce the pressure on the leeward , however do not allow the sail to flutter. Keep the sheet with some tension also, operate in stages.

### SPECIFICATIONS

Furler size	Sail type	Maximum sail area	Line Ø	If used as a fore stay max wire Ø
#2.5	Fixed on the stay	15m	8 mm	4 mm
	Endless loop	135'	5/16'	5/32"
	The sail furls on stay			



Upper swivel



Forestay and sail connector

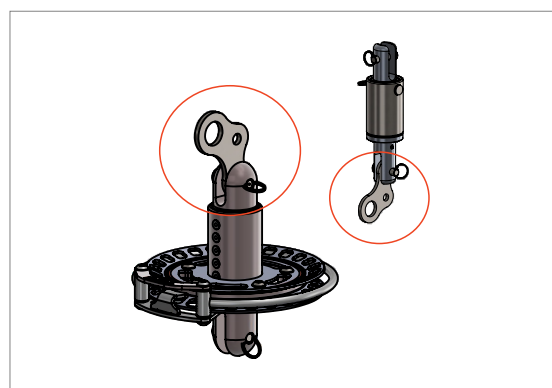

Optional

96433.81  
Intermediary swivel

# Furlers #2.5

## For Daysailers from 18' to 25'

### Application

Sail with straight forehead

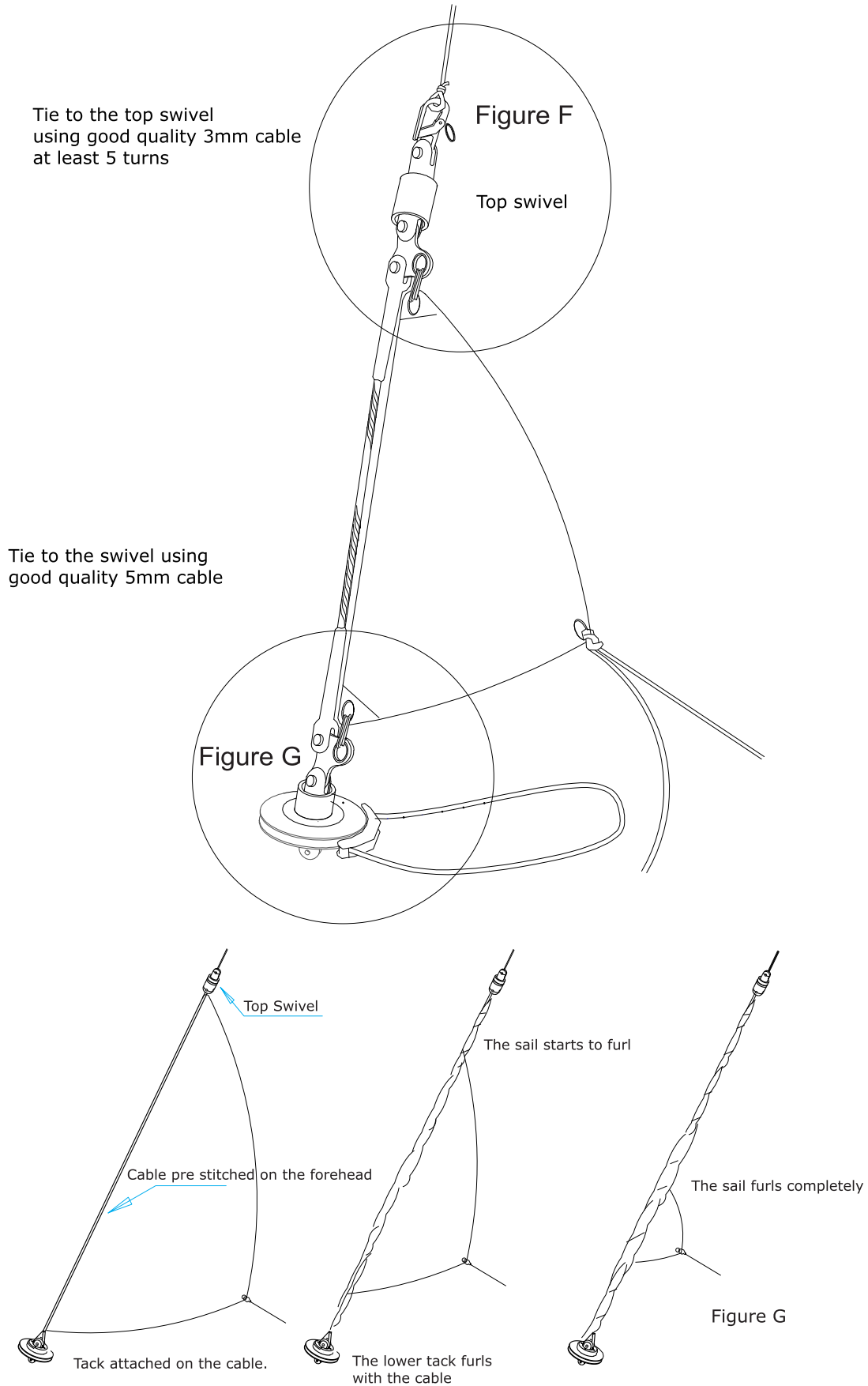

# Sailmaker instruction

For this type of furling the luff will be sewn in to the fore stay (1/19 stainless steel) and the sail will be stretched using 3 mm rope through grommets at top and bottom. The sail remains in the boat and can be removed if a temporary fore support for the mast is provided

**IMPORTANT :** Always furl the sail turning the drum in direction tightening the strands of wire, otherwise the cable may fail

***Nautos***<sup>TM</sup>

Nautos Indústria Metalúrgica Ltda.  
Caxias do Sul - RS - Brasil  
[www.nautos.com.br](http://www.nautos.com.br)