

Remote Control User Guide

Certus Massage Chair

MENU

Displays the main menu.

MASSAGE TECHNIQUE

Indicates which massage technique is currently in use.

POSITION

Displays the Position Adjust screen.

PAUSE

Tap to pause or resume all massage functions.

POWER/RESTORE

- Tap to activate the tablet. When the tablet is active, the icon lights red.
- Tap again to stop the massage immediately and return the chair to the upright position

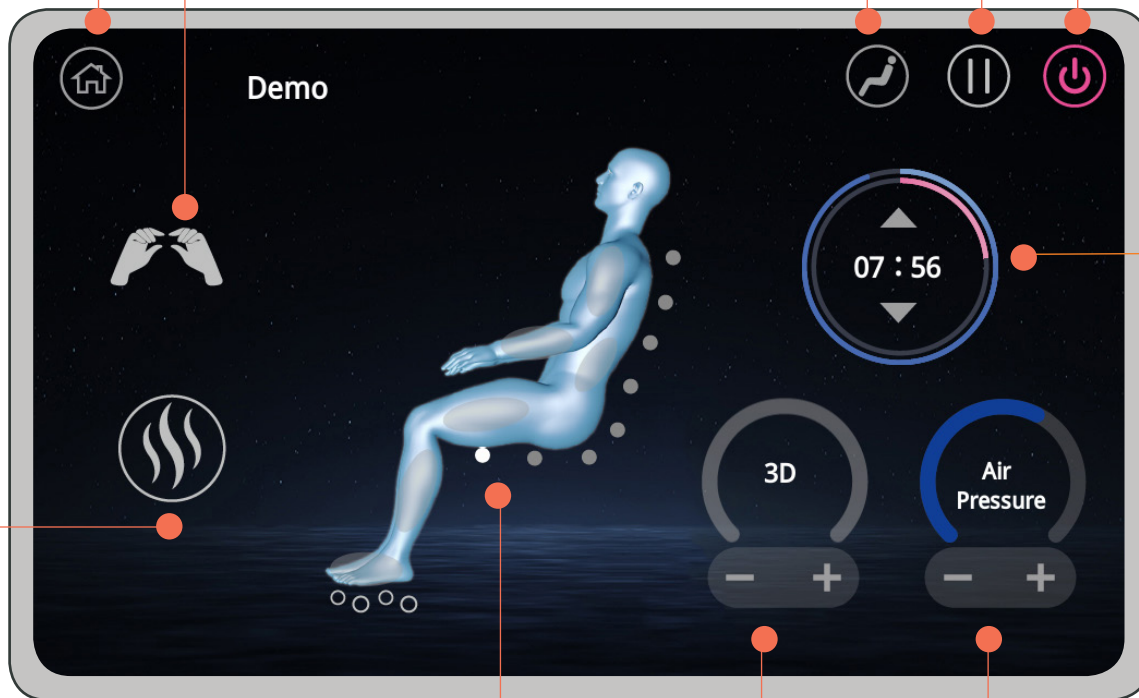

HEAT

Tap to toggle heat on and off in both back and legs. Lights red to indicate heat is on.

MASSAGE AREA

Indicates current massage focus area.

MASSAGE

Tap to increase or decrease robotic massage intensity.

AIR PRESSURE

Tap to increase or decrease the Cloud Touch air massage intensity.

TIME REMAINING

Displays the time remaining in the massage session. Tap the arrows to increase/decrease massage in ten-minute increments (up to 30 minutes).

For more detailed operation instructions, please see the Use and Care Manual.

Remote Control User Guide

Certus Massage Chair

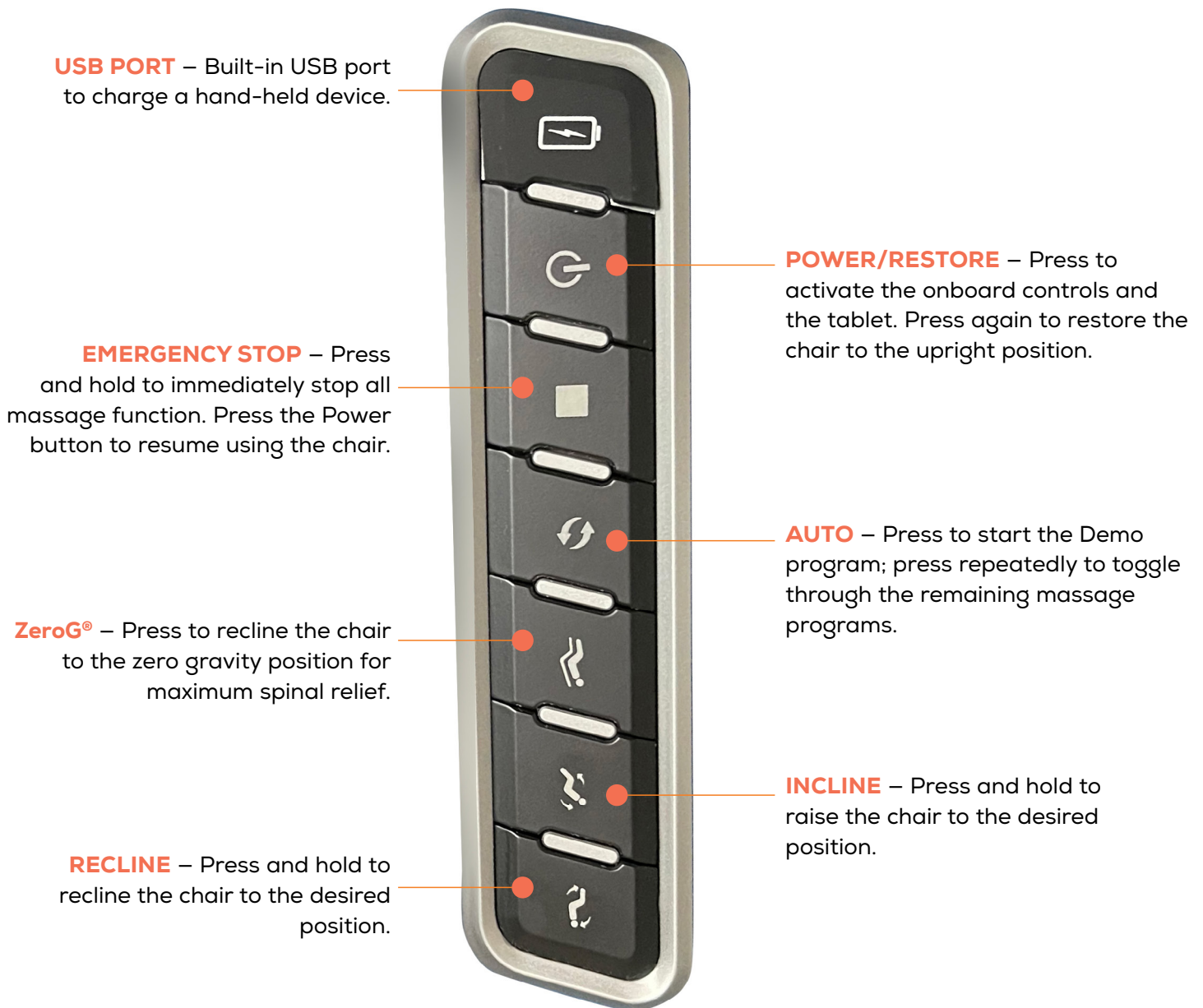

For more detailed operation instructions, please see the Use and Care Manual.