

REQUIRED TOOLS

- APPLICATION SOLUTION (spray bottle & baby shampoo)
- TAPE MEASURE
- UTILITY KNIFE (with snap-off blades)
- PLASTIC HARDCARD SQUEEGEE
- PAPER TOWELS
- LINT FREE TOWEL (recommended)
- DROP CLOTH

PRIOR TO BEGINNING THE INSTALLATION

- CREATE YOUR OWN **APPLICATION SOLUTION** BY FILLING UP A STANDARD 32oz SPRAY BOTTLE WITH WATER AND ADDING 3 DROPS OF BABY SHAMPOO or NON-LOTION CONTAINING LIQUID DETERGENT (**NOT HAND SOAP**).
- PLACE AN ABSORBENT DROP CLOTH UNDERNEATH THE WINDOW AREA TO COLLECT EXCESSIVE SOLUTION RUNOFF.
- MEASURE THE HEIGHT & WIDTH OF THE GLASS SURFACE FROM WITHIN THE FRAME.
- PRE-CUT FILM WITH AT LEAST AN ADDITIONAL 3/4" ON ALL SIDES TO ALLOW FOR TRIMMING THE FILM TO ITS FINAL SIZE.

TIPS & PRECAUTIONS :

- THOROUGHLY CLEAN THE GLASS SURFACE TO WHICH THE FILM WILL BE APPLIED BY REMOVING ALL DIRT, GRIME, DUST PARTICLES AND SILICONE.
- IF HAVING TROUBLE PEELING THE LINER, APPLY TAPE TO THE CORNER OF BOTH THE FILM AND THE LINER SIDE AND PEEL APART.
- WHILE REMOVING THE RELEASE LINER, **WET THE NEWLY EXPOSED ADHESIVE SIDE** AND USE CAUTION TO AVOID ALLOWING THE FILM TO ROLL OVER ONTO ITSELF WHICH WILL CAUSE IT TO STICK AND WILL BE DIFFICULT TO PULL APART.

STEP 1: SURFACE PREPARATION

- SPRAY WINDOW WITH APPLICATION SOLUTION AND THOROUGHLY CLEAN THE GLASS SURFACE AND FRAME OF ALL DIRT, DUST, GRIME, CAULKING, ETC.
- DRY GLASS SURFACE AND FRAME EDGES WITH CLEAN LINT FREE TOWEL.

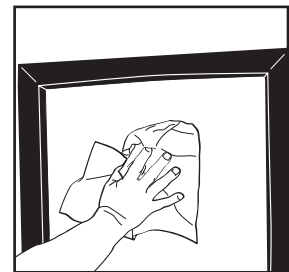

STEP 2: REMOVING THE LINER

- LAY THE FILM FLAT ON A TABLE OR HAVE AN ASSISTANT HOLD THE FILM FOR YOU AS YOU PEEL THE RELEASE LINER STARTING FROM THE CORNER OF THE FILM.
- WHILE PEELING THE LINER, **THOROUGHLY SPRAY THE NEWLY EXPOSED ADHESIVE SURFACE OF THE FILM**. AVOID ALLOWING THE FILM TO ROLL ONTO ITSELF WHICH WILL CAUSE IT TO STICK AND WILL BE DIFFICULT TO PULL APART.

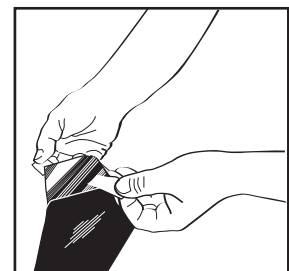

STEP 3 : SPRAY THE GLASS

- A. APPLY A GENEROUS AMOUNT OF THE APPLICATION SOLUTION TO THE GLASS SURFACE.
- B. SPRAY AND WET THE ADHESIVE SIDE OF THE FILM WITH THE APPLICATION SOLUTION.

NOTE (APPLICATION SOLUTION PREVENTS THE FILM FROM IMMEDIATELY ADHERING TO THE GLASS, THUS ALLOWING MORE TIME TO PROPERLY POSITION THE FILM). IT WILL ALSO HELP PREVENT THE FILM FROM STICKING TO ITSELF.

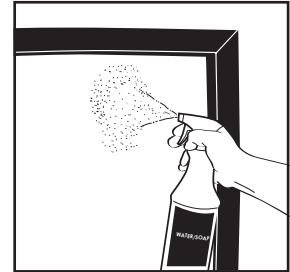

STEPS 4 : APPLY THE FILM

- A. PLACE THE WET FILM ONTO THE GLASS SURFACE MAKING SURE THAT ALL OF THE GLASS EDGES HAVE FILM OVERLAPPING.
- B. SPRAY THE FACE OF THE FILM TO BE SQUEEGEED.

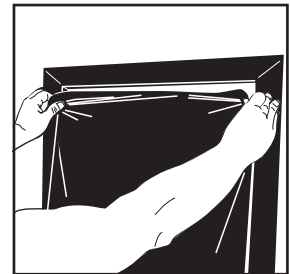

STEP 5 : SQUEEGEE THE FILM

- A. WRAP THE PLASTIC HARDCARD WITH A PAPER TOWEL TO PREVENT SCRATCHING THE FILM.
- B. SQUEEGEE THE FILM FROM THE CENTER OUT TOWARDS THE EDGES TO REMOVE AIR BUBBLES & THE APPLICATION SOLUTION. REPOSITION OR USE NEW PAPER TOWELS AS NEEDED.
- C. CLOSELY EXAMINE THE FILM TO SEE THAT IT IS FLAT AND SMOOTH AND THAT NO AIR OR WATER BUBBLES REMAIN. IF SO CONTINUE TO SQUEEGEE THEM OUT TOWARDS THE NEAREST EDGE.

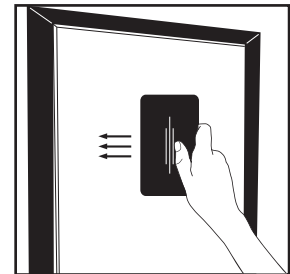

STEP 6 : CUT THE FILM

- A. TRIM THE EXCESS FILM FROM EDGES OF THE SURFACE USING THE PLASTIC HARDCARD AND UTILITY KNIFE. FOR BEST RESULTS, TRY TO CUT IN ONE CONTINUOUS MOTION.
- B. USE THE HARDCARD WHILE WRAPPED WITH A PAPER TOWEL TO PUSH OUT AND ABSORB REMAINING WATER NEAR THE EDGES.
- C. FILM MAY TAKE A FEW WEEKS TO COMPLETELY ADHERE TO THE GLASS SURFACE. DURING THE DRYING PROCESS, THERE MAY BE A CLOUDY OR MILKY APPEARANCE WHICH IS NORMAL AND WILL DISIPATE ONCE THE FILM COMPLETELY DRIES.

